

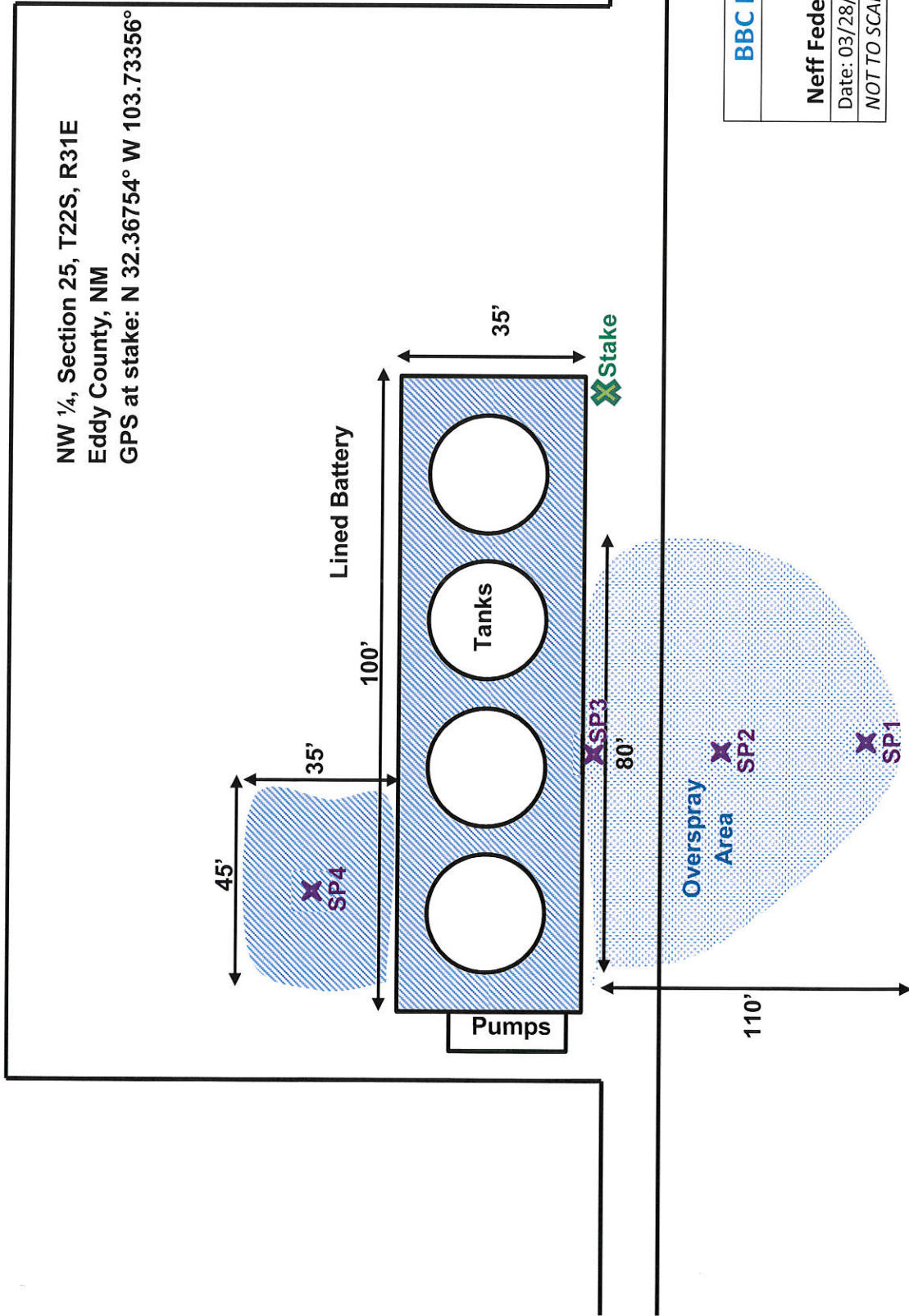

Oxy

# Neff Federal #1 and #3 SWD Battery



BBC International, Inc.	
Oxy	
Neff Federal #1 & #3 SWD Battery	
Date: 03/28/14	DRWG by: K. Purvis
NOT TO SCALE	File: Oxy 2014



# Groundwater Plot

## Oxy Neff Federal #1 & #3 SWD Battery

County  
Eddy

Unit Letter  
NW ¼

Section  
25

Township  
22S

Range  
31E

Trend Map 175'-200'

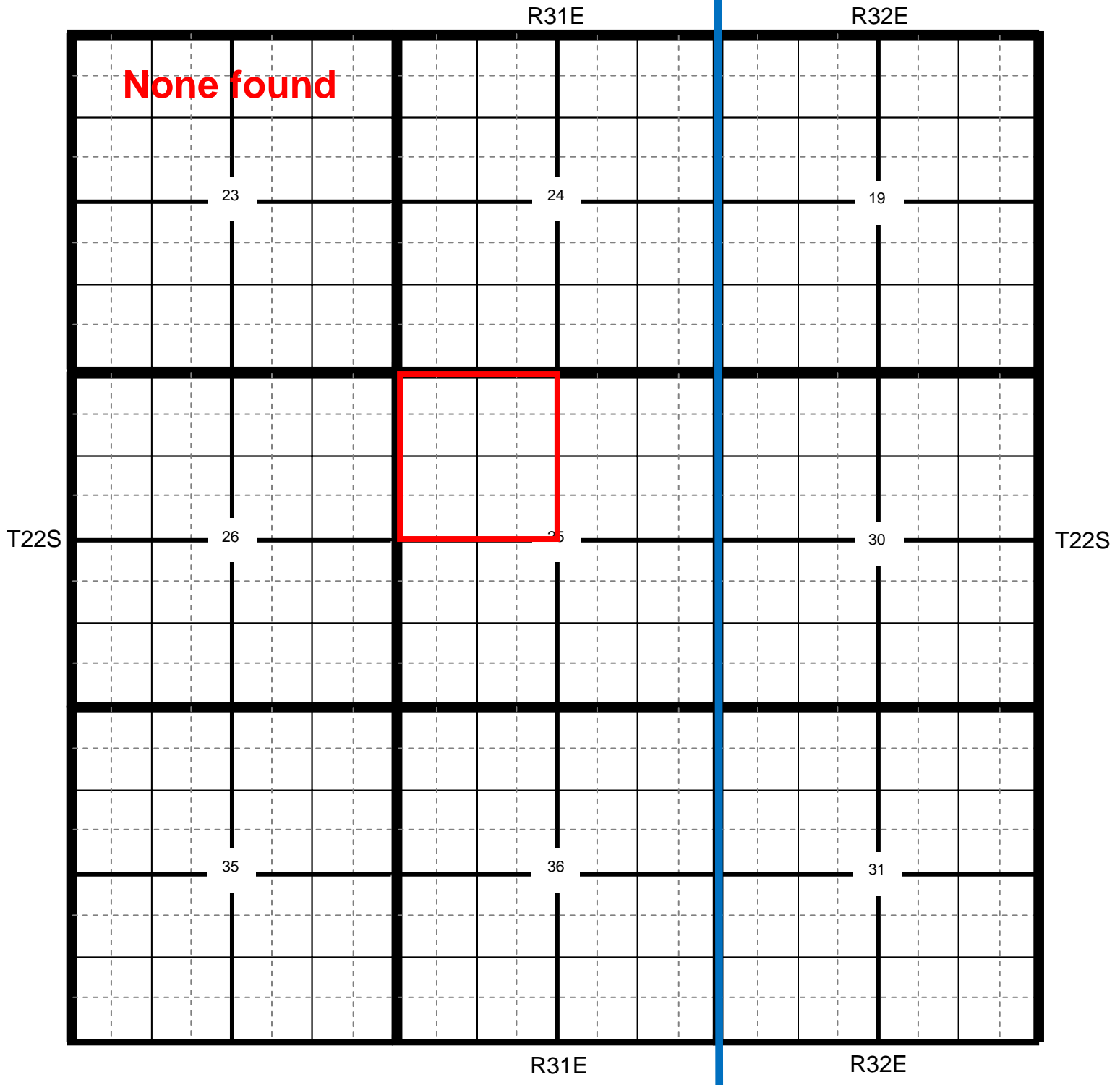

Location

OCD

USGS

SEO

All Databases

## Oxy Neff Federal #1 & #3 SWD Battery

**County** Eddy      **Unit Letter** NW ¼      **Section** 25      **Township** 22S      **Range** 31E

Trend Map 175'-200'

1		2	
NW/NW	NE/NW	NW/NE	NE/NE
Unit Letter D	Unit Letter C	Unit Letter B	Unit Letter A
SW/NW	SE/NW	SW/NE	SE/NE
Unit Letter E	Unit Letter F	Unit Letter G	Unit Letter H
NW/SW	NE/SW	NW/SE	NE/SE
Unit Letter L	Unit Letter K	Unit Letter J	Unit Letter I
SW/SW	SE/SW	SW/SE	SE/SE
Unit Letter M	Unit Letter N	Unit Letter O	Unit Letter P
3		4	

**None found**

**Laboratory Analytical Results Summary  
Neff Federal #1 and #3 SWD Battery**

		Sample	SP1 @ SURFACE	SP1 @ 1'
Analyte	Method	Date	4/18/14	4/18/14
			mg/Kg	mg/Kg
<b>Benzene</b>	BTEX 8021B		n/a	<0.050
<b>Toluene</b>	BTEX 8021B		n/a	<0.050
<b>Ethylbenzene</b>	BTEX 8021B		n/a	<0.050
<b>Total Xylenes</b>	BTEX 8021B		n/a	<0.150
<b>Total BTEX</b>	BTEX 8021B		n/a	<0.300
<b>Chloride</b>	SM4500Cl-B		<b>384</b>	<16.0
<b>GRO</b>	TPH 8015M		n/a	<10.0
<b>DRO</b>	TPH 8015M		n/a	<10.0

		Sample	SP2 @ SURFACE	SP2 @ 1'
Analyte	Method	Date	4/18/14	4/18/14
			mg/Kg	mg/Kg
<b>Benzene</b>	BTEX 8021B		n/a	<0.050
<b>Toluene</b>	BTEX 8021B		n/a	<0.050
<b>Ethylbenzene</b>	BTEX 8021B		n/a	<0.050
<b>Total Xylenes</b>	BTEX 8021B		n/a	<0.150
<b>Total BTEX</b>	BTEX 8021B		n/a	<0.300
<b>Chloride</b>	SM4500Cl-B		<b>1230</b>	<b>80</b>
<b>GRO</b>	TPH 8015M		n/a	<10.0
<b>DRO</b>	TPH 8015M		n/a	<10.0

		Sample	SP3 @ SURFACE	SP3 @ 1'	SP3 @ 3'	SP3 @ 6'	SP3 @ 9'	SP3 @ 12'	SP3 @ 14'
Analyte	Method	Date	4/18/14	4/18/14	4/18/14	4/21/14	4/21/14	4/21/14	4/21/14
			mg/Kg	mg/Kg	mg/Kg	mg/Kg	mg/Kg	mg/Kg	mg/Kg
<b>Benzene</b>	BTEX 8021B		<0.200	<0.050	<0.050	n/a	n/a	n/a	n/a
<b>Toluene</b>	BTEX 8021B		<0.200	<0.050	<0.050	n/a	n/a	n/a	n/a
<b>Ethylbenzene</b>	BTEX 8021B		<0.200	<0.050	<0.050	n/a	n/a	n/a	n/a
<b>Total Xylenes</b>	BTEX 8021B		<0.600	<0.150	<0.150	n/a	n/a	n/a	n/a
<b>Total BTEX</b>	BTEX 8021B		<1.20	<0.300	<0.300	n/a	n/a	n/a	n/a
<b>Chloride</b>	SM4500Cl-B		<b>9860</b>	<b>192</b>	<b>10800</b>	<b>2000</b>	<b>2800</b>	<b>2000</b>	<b>240</b>
<b>GRO</b>	TPH 8015M		<200	<10.0	<10.0	n/a	n/a	n/a	n/a
<b>DRO</b>	TPH 8015M		<b>12800</b>	<10.0	<b>35.1</b>	n/a	n/a	n/a	n/a

		Sample	SP4 @ SURFACE	SP4 @ 1'	SP4 @ 3'	SP4 @ 5'
Analyte	Method	Date	4/18/14	4/18/14	4/18/14	4/21/14
			mg/Kg	mg/Kg	mg/Kg	mg/Kg
<b>Benzene</b>	BTEX 8021B		<0.200	<0.050	<0.050	n/a
<b>Toluene</b>	BTEX 8021B		<0.200	<0.050	<0.050	n/a
<b>Ethylbenzene</b>	BTEX 8021B		<0.200	<0.050	<0.050	n/a
<b>Total Xylenes</b>	BTEX 8021B		<0.600	<0.150	<0.150	n/a
<b>Total BTEX</b>	BTEX 8021B		<1.20	<0.300	<0.300	n/a
<b>Chloride</b>	SM4500Cl-B		<b>10900</b>	<b>448</b>	<b>784</b>	<b>176</b>
<b>GRO</b>	TPH 8015M		<200	<10.0	<10.0	n/a
<b>DRO</b>	TPH 8015M		<b>14700</b>	<10.0	<10.0	n/a



PHONE (575) 393-2326 ° 101 E. MARLAND ° HOBBS, NM 88240

---

May 01, 2014

Cliff Brunson

BBC International, Inc.

P.O. Box 805

Hobbs, NM 88241

RE: NEFF FEDERAL #1 & #3 SWD BATTERY

Enclosed are the results of analyses for samples received by the laboratory on 04/24/14 12:03.

Cardinal Laboratories is accredited through Texas NELAP under certificate number T104704398-13-5. Accreditation applies to drinking water, non-potable water and solid and chemical materials. All accredited analytes are denoted by an asterisk (\*). For a complete list of accredited analytes and matrices visit the TCEQ website at [www.tceq.texas.gov/field/qa/lab\\_accred\\_certif.html](http://www.tceq.texas.gov/field/qa/lab_accred_certif.html).

Cardinal Laboratories is accredited through the State of Colorado Department of Public Health and Environment for:

Method EPA 552.2	Haloacetic Acids (HAA-5)
Method EPA 524.2	Total Trihalomethanes (TTHM)
Method EPA 524.4	Regulated VOCs (V1, V2, V3)

Accreditation applies to public drinking water matrices.

This report meets NELAP requirements and is made up of a cover page, analytical results, and a copy of the original chain-of-custody. If you have any questions concerning this report, please feel free to contact me.

Sincerely,

A handwritten signature in black ink that reads "Celey D. Keene". The signature is written in a cursive style with a large, stylized 'C' and 'K'.

Celey D. Keene

Lab Director/Quality Manager

**Analytical Results For:**

BBC International, Inc.  
Cliff Brunson  
P.O. Box 805  
Hobbs NM, 88241  
Fax To: (575) 397-0397

Received:	04/24/2014	Sampling Date:	04/18/2014
Reported:	05/01/2014	Sampling Type:	Soil
Project Name:	NEFF FEDERAL #1 & #3 SWD BATTERY	Sampling Condition:	Cool & Intact
Project Number:	NONE GIVEN	Sample Received By:	Jodi Henson
Project Location:	EDDY COUNTY, NM		

**Sample ID: SP 1 @ SURFACE (H401235-01)**

Chloride, SM4500Cl-B		mg/kg		Analyzed By: AP						
Analyte	Result	Reporting Limit	Analyzed	Method Blank	BS	% Recovery	True Value QC	RPD	Qualifier	
Chloride	384	16.0	04/25/2014	ND	416	104	400	0.00		

**Sample ID: SP 1 @ 1' (H401235-02)**

BTEX 8260B		mg/kg		Analyzed By: ck					
Analyte	Result	Reporting Limit	Analyzed	Method Blank	BS	% Recovery	True Value QC	RPD	Qualifier
Benzene*	<0.050	0.050	04/29/2014	ND	2.35	118	2.00	6.15	
Toluene*	<0.050	0.050	04/29/2014	ND	2.13	106	2.00	8.09	
Ethylbenzene*	<0.050	0.050	04/29/2014	ND	2.03	102	2.00	7.15	
Total Xylenes*	<0.150	0.150	04/29/2014	ND	6.25	104	6.00	8.15	
Total BTEX	<0.300	0.300	04/29/2014	ND					

Surrogate: Dibromofluoromethane 96.2 % 61.3-142

Surrogate: Toluene-d8 99.8 % 71.3-129

Surrogate: 4-Bromofluorobenzene 101 % 65.7-141

Chloride, SM4500Cl-B		mg/kg		Analyzed By: AP						
Analyte	Result	Reporting Limit	Analyzed	Method Blank	BS	% Recovery	True Value QC	RPD	Qualifier	
Chloride	<16.0	16.0	04/25/2014	ND	416	104	400	0.00		

TPH 8015M		mg/kg		Analyzed By: CK					
Analyte	Result	Reporting Limit	Analyzed	Method Blank	BS	% Recovery	True Value QC	RPD	Qualifier
GRO C6-C10	<10.0	10.0	04/25/2014	ND	186	92.9	200	11.1	
DRO >C10-C28	<10.0	10.0	04/25/2014	ND	207	103	200	12.5	

Cardinal Laboratories

\*=Accredited Analyte

PLEASE NOTE: Liability and Damages. Cardinal's liability and client's exclusive remedy for any claim arising, whether based in contract or tort, shall be limited to the amount paid by client for analyses. All claims, including those for negligence and any other cause whatsoever shall be deemed waived unless made in writing and received by Cardinal within thirty (30) days after completion of the applicable service. In no event shall Cardinal be liable for incidental or consequential damages, including, without limitation, business interruptions, loss of use, or loss of profits incurred by client, its subsidiaries, affiliates or successors arising out of or related to the performance of the services hereunder by Cardinal, regardless of whether such claim is based upon any of the above stated reasons or otherwise. Results relate only to the samples identified above. This report shall not be reproduced except in full with written approval of Cardinal Laboratories.



Celey D. Keene, Lab Director/Quality Manager

**Analytical Results For:**

BBC International, Inc.  
Cliff Brunson  
P.O. Box 805  
Hobbs NM, 88241  
Fax To: (575) 397-0397

Received:	04/24/2014	Sampling Date:	04/18/2014
Reported:	05/01/2014	Sampling Type:	Soil
Project Name:	NEFF FEDERAL #1 & #3 SWD BATTERY	Sampling Condition:	Cool & Intact
Project Number:	NONE GIVEN	Sample Received By:	Jodi Henson
Project Location:	EDDY COUNTY, NM		

**Sample ID: SP 1 @ 1' (H401235-02)**

TPH 8015M		mg/kg		Analyzed By: CK					
Analyte	Result	Reporting Limit	Analyzed	Method Blank	BS	% Recovery	True Value QC	RPD	Qualifier
Surrogate: 1-Chlorooctane	111 %	65.2-140							
Surrogate: 1-Chlorooctadecane	108 %	63.6-154							

**Sample ID: SP 2 @ SURFACE (H401235-03)**

Chloride, SM4500Cl-B		mg/kg		Analyzed By: AP					
Analyte	Result	Reporting Limit	Analyzed	Method Blank	BS	% Recovery	True Value QC	RPD	Qualifier
Chloride	1230	16.0	04/25/2014	ND	416	104	400	0.00	

Cardinal Laboratories

\*=Accredited Analyte

PLEASE NOTE: Liability and Damages. Cardinal's liability and client's exclusive remedy for any claim arising, whether based in contract or tort, shall be limited to the amount paid by client for analyses. All claims, including those for negligence and any other cause whatsoever shall be deemed waived unless made in writing and received by Cardinal within thirty (30) days after completion of the applicable service. In no event shall Cardinal be liable for incidental or consequential damages, including, without limitation, business interruptions, loss of use, or loss of profits incurred by client, its subsidiaries, affiliates or successors arising out of or related to the performance of the services hereunder by Cardinal, regardless of whether such claim is based upon any of the above stated reasons or otherwise. Results relate only to the samples identified above. This report shall not be reproduced except in full with written approval of Cardinal Laboratories.



Celey D. Keene, Lab Director/Quality Manager

**Analytical Results For:**

BBC International, Inc.  
Cliff Brunson  
P.O. Box 805  
Hobbs NM, 88241  
Fax To: (575) 397-0397

Received:	04/24/2014	Sampling Date:	04/18/2014
Reported:	05/01/2014	Sampling Type:	Soil
Project Name:	NEFF FEDERAL #1 & #3 SWD BATTERY	Sampling Condition:	Cool & Intact
Project Number:	NONE GIVEN	Sample Received By:	Jodi Henson
Project Location:	EDDY COUNTY, NM		

**Sample ID: SP 2 @ 1' (H401235-04)**

BTX 8260B		mg/kg		Analyzed By: ck						
Analyte	Result	Reporting Limit	Analyzed	Method Blank	BS	% Recovery	True Value QC	RPD	Qualifier	
Benzene*	<0.050	0.050	04/29/2014	ND	2.35	118	2.00	6.15		
Toluene*	<0.050	0.050	04/29/2014	ND	2.13	106	2.00	8.09		
Ethylbenzene*	<0.050	0.050	04/29/2014	ND	2.03	102	2.00	7.15		
Total Xylenes*	<0.150	0.150	04/29/2014	ND	6.25	104	6.00	8.15		
Total BTX	<0.300	0.300	04/29/2014	ND						

Surrogate: Dibromofluoromethane 101 % 61.3-142  
Surrogate: Toluene-d8 102 % 71.3-129  
Surrogate: 4-Bromofluorobenzene 103 % 65.7-141

Chloride, SM4500Cl-B		mg/kg		Analyzed By: AP						
Analyte	Result	Reporting Limit	Analyzed	Method Blank	BS	% Recovery	True Value QC	RPD	Qualifier	
Chloride	80.0	16.0	04/25/2014	ND	416	104	400	0.00		

TPH 8015M		mg/kg		Analyzed By: CK					
Analyte	Result	Reporting Limit	Analyzed	Method Blank	BS	% Recovery	True Value QC	RPD	Qualifier
GRO C6-C10	<10.0	10.0	04/25/2014	ND	187	93.6	200	2.79	
DRO >C10-C28	<10.0	10.0	04/25/2014	ND	202	101	200	2.79	

Surrogate: 1-Chlorooctane 114 % 65.2-140  
Surrogate: 1-Chlorooctadecane 110 % 63.6-154

Cardinal Laboratories

\*=Accredited Analyte

PLEASE NOTE: Liability and Damages. Cardinal's liability and client's exclusive remedy for any claim arising, whether based in contract or tort, shall be limited to the amount paid by client for analyses. All claims, including those for negligence and any other cause whatsoever shall be deemed waived unless made in writing and received by Cardinal within thirty (30) days after completion of the applicable service. In no event shall Cardinal be liable for incidental or consequential damages, including, without limitation, business interruptions, loss of use, or loss of profits incurred by client, its subsidiaries, affiliates or successors arising out of or related to the performance of the services hereunder by Cardinal, regardless of whether such claim is based upon any of the above stated reasons or otherwise. Results relate only to the samples identified above. This report shall not be reproduced except in full with written approval of Cardinal Laboratories.



Celey D. Keene, Lab Director/Quality Manager



**Analytical Results For:**

BBC International, Inc.  
Cliff Brunson  
P.O. Box 805  
Hobbs NM, 88241  
Fax To: (575) 397-0397

Received:	04/24/2014	Sampling Date:	04/18/2014
Reported:	05/01/2014	Sampling Type:	Soil
Project Name:	NEFF FEDERAL #1 & #3 SWD BATTERY	Sampling Condition:	Cool & Intact
Project Number:	NONE GIVEN	Sample Received By:	Jodi Henson
Project Location:	EDDY COUNTY, NM		

**Sample ID: SP 3 @ SURFACE (H401235-05)**

BTX 8021B		mg/kg		Analyzed By: MS					
Analyte	Result	Reporting Limit	Analyzed	Method Blank	BS	% Recovery	True Value QC	RPD	Qualifier
Benzene*	<0.200	0.200	04/30/2014	ND	2.06	103	2.00	5.94	
Toluene*	<0.200	0.200	04/30/2014	ND	2.06	103	2.00	6.37	
Ethylbenzene*	<0.200	0.200	04/30/2014	ND	2.06	103	2.00	6.68	
Total Xylenes*	<0.600	0.600	04/30/2014	ND	6.18	103	6.00	6.99	
Total BTX	<1.20	1.20	04/30/2014	ND					

Surrogate: 4-Bromofluorobenzene (PID) 119 % 89.4-126

Chloride, SM4500Cl-B		mg/kg		Analyzed By: AP					
Analyte	Result	Reporting Limit	Analyzed	Method Blank	BS	% Recovery	True Value QC	RPD	Qualifier
Chloride	9860	16.0	04/25/2014	ND	416	104	400	0.00	

TPH 8015M		mg/kg		Analyzed By: CK					S-06	
Analyte	Result	Reporting Limit	Analyzed	Method Blank	BS	% Recovery	True Value QC	RPD	Qualifier	
GRO C6-C10	<200	200	04/25/2014	ND	187	93.6	200	2.79		
DRO >C10-C28	12800	200	04/25/2014	ND	202	101	200	2.79		

Surrogate: 1-Chlorooctane 100 % 65.2-140

Surrogate: 1-Chlorooctadecane 425 % 63.6-154

Cardinal Laboratories

\*=Accredited Analyte

PLEASE NOTE: Liability and Damages. Cardinal's liability and client's exclusive remedy for any claim arising, whether based in contract or tort, shall be limited to the amount paid by client for analyses. All claims, including those for negligence and any other cause whatsoever shall be deemed waived unless made in writing and received by Cardinal within thirty (30) days after completion of the applicable service. In no event shall Cardinal be liable for incidental or consequential damages, including, without limitation, business interruptions, loss of use, or loss of profits incurred by client, its subsidiaries, affiliates or successors arising out of or related to the performance of the services hereunder by Cardinal, regardless of whether such claim is based upon any of the above stated reasons or otherwise. Results relate only to the samples identified above. This report shall not be reproduced except in full with written approval of Cardinal Laboratories.



Celey D. Keene, Lab Director/Quality Manager

**Analytical Results For:**

BBC International, Inc.  
Cliff Brunson  
P.O. Box 805  
Hobbs NM, 88241  
Fax To: (575) 397-0397

Received:	04/24/2014	Sampling Date:	04/18/2014
Reported:	05/01/2014	Sampling Type:	Soil
Project Name:	NEFF FEDERAL #1 & #3 SWD BATTERY	Sampling Condition:	Cool & Intact
Project Number:	NONE GIVEN	Sample Received By:	Jodi Henson
Project Location:	EDDY COUNTY, NM		

**Sample ID: SP 3 @ 1' (H401235-06)**

BTX 8021B		mg/kg		Analyzed By: MS						
Analyte	Result	Reporting Limit	Analyzed	Method Blank	BS	% Recovery	True Value QC	RPD	Qualifier	
Benzene*	<0.050	0.050	04/30/2014	ND	2.06	103	2.00	5.94		
Toluene*	<0.050	0.050	04/30/2014	ND	2.06	103	2.00	6.37		
Ethylbenzene*	<0.050	0.050	04/30/2014	ND	2.06	103	2.00	6.68		
Total Xylenes*	<0.150	0.150	04/30/2014	ND	6.18	103	6.00	6.99		
Total BTX	<0.300	0.300	04/30/2014	ND						

Surrogate: 4-Bromofluorobenzene (PID) 108 % 89.4-126

Chloride, SM4500Cl-B		mg/kg		Analyzed By: AP					
Analyte	Result	Reporting Limit	Analyzed	Method Blank	BS	% Recovery	True Value QC	RPD	Qualifier
Chloride	192	16.0	04/25/2014	ND	416	104	400	0.00	

TPH 8015M		mg/kg		Analyzed By: CK					
Analyte	Result	Reporting Limit	Analyzed	Method Blank	BS	% Recovery	True Value QC	RPD	Qualifier
GRO C6-C10	<10.0	10.0	04/25/2014	ND	187	93.6	200	2.79	
DRO >C10-C28	<10.0	10.0	04/25/2014	ND	202	101	200	2.79	

Surrogate: 1-Chlorooctane 113 % 65.2-140

Surrogate: 1-Chlorooctadecane 111 % 63.6-154

Cardinal Laboratories

\*=Accredited Analyte

PLEASE NOTE: Liability and Damages. Cardinal's liability and client's exclusive remedy for any claim arising, whether based in contract or tort, shall be limited to the amount paid by client for analyses. All claims, including those for negligence and any other cause whatsoever shall be deemed waived unless made in writing and received by Cardinal within thirty (30) days after completion of the applicable service. In no event shall Cardinal be liable for incidental or consequential damages, including, without limitation, business interruptions, loss of use, or loss of profits incurred by client, its subsidiaries, affiliates or successors arising out of or related to the performance of the services hereunder by Cardinal, regardless of whether such claim is based upon any of the above stated reasons or otherwise. Results relate only to the samples identified above. This report shall not be reproduced except in full with written approval of Cardinal Laboratories.



Celey D. Keene, Lab Director/Quality Manager

**Analytical Results For:**

BBC International, Inc.  
Cliff Brunson  
P.O. Box 805  
Hobbs NM, 88241  
Fax To: (575) 397-0397

Received:	04/24/2014	Sampling Date:	04/18/2014
Reported:	05/01/2014	Sampling Type:	Soil
Project Name:	NEFF FEDERAL #1 & #3 SWD BATTERY	Sampling Condition:	Cool & Intact
Project Number:	NONE GIVEN	Sample Received By:	Jodi Henson
Project Location:	EDDY COUNTY, NM		

**Sample ID: SP 3 @ 3' (H401235-07)**

BTX 8021B		mg/kg		Analyzed By: MS						
Analyte	Result	Reporting Limit	Analyzed	Method Blank	BS	% Recovery	True Value QC	RPD	Qualifier	
Benzene*	<0.050	0.050	04/30/2014	ND	2.06	103	2.00	5.94		
Toluene*	<0.050	0.050	04/30/2014	ND	2.06	103	2.00	6.37		
Ethylbenzene*	<0.050	0.050	04/30/2014	ND	2.06	103	2.00	6.68		
Total Xylenes*	<0.150	0.150	04/30/2014	ND	6.18	103	6.00	6.99		
Total BTX	<0.300	0.300	04/30/2014	ND						

Surrogate: 4-Bromofluorobenzene (PID) 112 % 89.4-126

Chloride, SM4500CI-B		mg/kg		Analyzed By: AP					
Analyte	Result	Reporting Limit	Analyzed	Method Blank	BS	% Recovery	True Value QC	RPD	Qualifier
Chloride	10800	16.0	04/25/2014	ND	416	104	400	0.00	

TPH 8015M		mg/kg		Analyzed By: CK					
Analyte	Result	Reporting Limit	Analyzed	Method Blank	BS	% Recovery	True Value QC	RPD	Qualifier
GRO C6-C10	<10.0	10.0	04/25/2014	ND	187	93.6	200	2.79	
DRO >C10-C28	35.1	10.0	04/25/2014	ND	202	101	200	2.79	

Surrogate: 1-Chlorooctane 110 % 65.2-140

Surrogate: 1-Chlorooctadecane 108 % 63.6-154

**Sample ID: SP 3 @ 6' (H401235-08)**

Chloride, SM4500Cl-B		mg/kg		Analyzed By: AP					
Analyte	Result	Reporting Limit	Analyzed	Method Blank	BS	% Recovery	True Value QC	RPD	Qualifier
Chloride	2000	16.0	04/25/2014	ND	416	104	400	0.00	

Cardinal Laboratories

\*=Accredited Analyte

PLEASE NOTE: Liability and Damages. Cardinal's liability and client's exclusive remedy for any claim arising, whether based in contract or tort, shall be limited to the amount paid by client for analyses. All claims, including those for negligence and any other cause whatsoever shall be deemed waived unless made in writing and received by Cardinal within thirty (30) days after completion of the applicable service. In no event shall Cardinal be liable for incidental or consequential damages, including, without limitation, business interruptions, loss of use, or loss of profits incurred by client, its subsidiaries, affiliates or successors arising out of or related to the performance of the services hereunder by Cardinal, regardless of whether such claim is based upon any of the above stated reasons or otherwise. Results relate only to the samples identified above. This report shall not be reproduced except in full with written approval of Cardinal Laboratories.



Celey D. Keene, Lab Director/Quality Manager

**Analytical Results For:**

 BBC International, Inc.  
 Cliff Brunson  
 P.O. Box 805  
 Hobbs NM, 88241  
 Fax To: (575) 397-0397

Received:	04/24/2014	Sampling Date:	04/21/2014
Reported:	05/01/2014	Sampling Type:	Soil
Project Name:	NEFF FEDERAL #1 & #3 SWD BATTERY	Sampling Condition:	Cool & Intact
Project Number:	NONE GIVEN	Sample Received By:	Jodi Henson
Project Location:	EDDY COUNTY, NM		

**Sample ID: SP 3 @ 9' (H401235-09)**

Chloride, SM4500Cl-B		mg/kg		Analyzed By: AP						
Analyte	Result	Reporting Limit	Analyzed	Method Blank	BS	% Recovery	True Value QC	RPD	Qualifier	
Chloride	2800	16.0	04/25/2014	ND	416	104	400	0.00		

**Sample ID: SP 3 @ 12' (H401235-10)**

Chloride, SM4500Cl-B		mg/kg		Analyzed By: AP					
Analyte	Result	Reporting Limit	Analyzed	Method Blank	BS	% Recovery	True Value QC	RPD	Qualifier
Chloride	2000	16.0	04/25/2014	ND	432	108	400	3.64	

**Sample ID: SP 3 @ 14' (H401235-11)**

Chloride, SM4500Cl-B		mg/kg		Analyzed By: CK					
Analyte	Result	Reporting Limit	Analyzed	Method Blank	BS	% Recovery	True Value QC	RPD	Qualifier
Chloride	240	16.0	04/25/2014	ND	416	104	400	0.00	

Cardinal Laboratories

\*=Accredited Analyte

PLEASE NOTE: Liability and Damages. Cardinal's liability and client's exclusive remedy for any claim arising, whether based in contract or tort, shall be limited to the amount paid by client for analyses. All claims, including those for negligence and any other cause whatsoever shall be deemed waived unless made in writing and received by Cardinal within thirty (30) days after completion of the applicable service. In no event shall Cardinal be liable for incidental or consequential damages, including, without limitation, business interruptions, loss of use, or loss of profits incurred by client, its subsidiaries, affiliates or successors arising out of or related to the performance of the services hereunder by Cardinal, regardless of whether such claim is based upon any of the above stated reasons or otherwise. Results relate only to the samples identified above. This report shall not be reproduced except in full with written approval of Cardinal Laboratories.



Celey D. Keene, Lab Director/Quality Manager

**Analytical Results For:**

BBC International, Inc.  
Cliff Brunson  
P.O. Box 805  
Hobbs NM, 88241  
Fax To: (575) 397-0397

Received:	04/24/2014	Sampling Date:	04/21/2014
Reported:	05/01/2014	Sampling Type:	Soil
Project Name:	NEFF FEDERAL #1 & #3 SWD BATTERY	Sampling Condition:	Cool & Intact
Project Number:	NONE GIVEN	Sample Received By:	Jodi Henson
Project Location:	EDDY COUNTY, NM		

**Sample ID: SP 4 @ SURFACE (H401235-12)**

BTX 8021B		mg/kg		Analyzed By: MS					
Analyte	Result	Reporting Limit	Analyzed	Method Blank	BS	% Recovery	True Value QC	RPD	Qualifier
Benzene*	<0.200	0.200	04/30/2014	ND	2.06	103	2.00	5.94	
Toluene*	<0.200	0.200	04/30/2014	ND	2.06	103	2.00	6.37	
Ethylbenzene*	<0.200	0.200	04/30/2014	ND	2.06	103	2.00	6.68	
Total Xylenes*	<0.600	0.600	04/30/2014	ND	6.18	103	6.00	6.99	
Total BTX	<1.20	1.20	04/30/2014	ND					

Surrogate: 4-Bromofluorobenzene (PID) 117 % 89.4-126

Chloride, SM4500Cl-B		mg/kg		Analyzed By: AP						
Analyte	Result	Reporting Limit	Analyzed	Method Blank	BS	% Recovery	True Value QC	RPD	Qualifier	
Chloride	10900	16.0	04/25/2014	ND	432	108	400	3.64		

TPH 8015M		mg/kg		Analyzed By: CK				S-06	
Analyte	Result	Reporting Limit	Analyzed	Method Blank	BS	% Recovery	True Value QC	RPD	Qualifier
GRO C6-C10	<200	200	04/25/2014	ND	187	93.6	200	2.79	
DRO >C10-C28	14700	200	04/25/2014	ND	202	101	200	2.79	

Surrogate: 1-Chlorooctane 93.3 % 65.2-140

Surrogate: 1-Chlorooctadecane 477 % 63.6-154

Cardinal Laboratories

\*=Accredited Analyte

PLEASE NOTE: Liability and Damages. Cardinal's liability and client's exclusive remedy for any claim arising, whether based in contract or tort, shall be limited to the amount paid by client for analyses. All claims, including those for negligence and any other cause whatsoever shall be deemed waived unless made in writing and received by Cardinal within thirty (30) days after completion of the applicable service. In no event shall Cardinal be liable for incidental or consequential damages, including, without limitation, business interruptions, loss of use, or loss of profits incurred by client, its subsidiaries, affiliates or successors arising out of or related to the performance of the services hereunder by Cardinal, regardless of whether such claim is based upon any of the above stated reasons or otherwise. Results relate only to the samples identified above. This report shall not be reproduced except in full with written approval of Cardinal Laboratories.



Celey D. Keene, Lab Director/Quality Manager

**Analytical Results For:**

BBC International, Inc.  
Cliff Brunson  
P.O. Box 805  
Hobbs NM, 88241  
Fax To: (575) 397-0397

Received:	04/24/2014	Sampling Date:	04/21/2014
Reported:	05/01/2014	Sampling Type:	Soil
Project Name:	NEFF FEDERAL #1 & #3 SWD BATTERY	Sampling Condition:	Cool & Intact
Project Number:	NONE GIVEN	Sample Received By:	Jodi Henson
Project Location:	EDDY COUNTY, NM		

**Sample ID: SP 4 @ 1' (H401235-13)**

BTX 8021B		mg/kg		Analyzed By: MS					
Analyte	Result	Reporting Limit	Analyzed	Method Blank	BS	% Recovery	True Value QC	RPD	Qualifier
Benzene*	<0.050	0.050	04/30/2014	ND	2.06	103	2.00	5.94	
Toluene*	<0.050	0.050	04/30/2014	ND	2.06	103	2.00	6.37	
Ethylbenzene*	<0.050	0.050	04/30/2014	ND	2.06	103	2.00	6.68	
Total Xylenes*	<0.150	0.150	04/30/2014	ND	6.18	103	6.00	6.99	
Total BTX	<0.300	0.300	04/30/2014	ND					

Surrogate: 4-Bromofluorobenzene (PID) 112 % 89.4-126

Chloride, SM4500Cl-B		mg/kg		Analyzed By: AP					
Analyte	Result	Reporting Limit	Analyzed	Method Blank	BS	% Recovery	True Value QC	RPD	Qualifier
Chloride	448	16.0	04/25/2014	ND	432	108	400	3.64	

TPH 8015M		mg/kg		Analyzed By: CK					
Analyte	Result	Reporting Limit	Analyzed	Method Blank	BS	% Recovery	True Value QC	RPD	Qualifier
GRO C6-C10	<10.0	10.0	04/25/2014	ND	187	93.6	200	2.79	
DRO >C10-C28	<10.0	10.0	04/25/2014	ND	202	101	200	2.79	

Surrogate: 1-Chlorooctane 112 % 65.2-140

Surrogate: 1-Chlorooctadecane 107 % 63.6-154

Cardinal Laboratories

\*=Accredited Analyte

PLEASE NOTE: Liability and Damages. Cardinal's liability and client's exclusive remedy for any claim arising, whether based in contract or tort, shall be limited to the amount paid by client for analyses. All claims, including those for negligence and any other cause whatsoever shall be deemed waived unless made in writing and received by Cardinal within thirty (30) days after completion of the applicable service. In no event shall Cardinal be liable for incidental or consequential damages, including, without limitation, business interruptions, loss of use, or loss of profits incurred by client, its subsidiaries, affiliates or successors arising out of or related to the performance of the services hereunder by Cardinal, regardless of whether such claim is based upon any of the above stated reasons or otherwise. Results relate only to the samples identified above. This report shall not be reproduced except in full with written approval of Cardinal Laboratories.



Celey D. Keene, Lab Director/Quality Manager

**Analytical Results For:**

BBC International, Inc.  
Cliff Brunson  
P.O. Box 805  
Hobbs NM, 88241  
Fax To: (575) 397-0397

Received:	04/24/2014	Sampling Date:	04/22/2014
Reported:	05/01/2014	Sampling Type:	Soil
Project Name:	NEFF FEDERAL #1 & #3 SWD BATTERY	Sampling Condition:	Cool & Intact
Project Number:	NONE GIVEN	Sample Received By:	Jodi Henson
Project Location:	EDDY COUNTY, NM		

**Sample ID: SP 4 @ 3' (H401235-14)**

BTX 8021B		mg/kg		Analyzed By: MS						
Analyte	Result	Reporting Limit	Analyzed	Method Blank	BS	% Recovery	True Value QC	RPD	Qualifier	
Benzene*	<0.050	0.050	04/30/2014	ND	2.06	103	2.00	5.94		
Toluene*	<0.050	0.050	04/30/2014	ND	2.06	103	2.00	6.37		
Ethylbenzene*	<0.050	0.050	04/30/2014	ND	2.06	103	2.00	6.68		
Total Xylenes*	<0.150	0.150	04/30/2014	ND	6.18	103	6.00	6.99		
Total BTX	<0.300	0.300	04/30/2014	ND						

Surrogate: 4-Bromofluorobenzene (PID) 110 % 89.4-126

Chloride, SM4500CI-B		mg/kg		Analyzed By: AP					
Analyte	Result	Reporting Limit	Analyzed	Method Blank	BS	% Recovery	True Value QC	RPD	Qualifier
Chloride	784	16.0	04/25/2014	ND	432	108	400	3.64	

TPH 8015M		mg/kg		Analyzed By: CK					
Analyte	Result	Reporting Limit	Analyzed	Method Blank	BS	% Recovery	True Value QC	RPD	Qualifier
GRO C6-C10	<10.0	10.0	04/25/2014	ND	187	93.6	200	2.79	
DRO >C10-C28	<10.0	10.0	04/25/2014	ND	202	101	200	2.79	

Surrogate: 1-Chlorooctane 117 % 65.2-140

Surrogate: 1-Chlorooctadecane 111 % 63.6-154

**Sample ID: SP 4 @ 5' (H401235-15)**

Chloride, SM4500Cl-B		mg/kg		Analyzed By: AP					
Analyte	Result	Reporting Limit	Analyzed	Method Blank	BS	% Recovery	True Value QC	RPD	Qualifier
Chloride	176	16.0	04/25/2014	ND	432	108	400	3.64	

Cardinal Laboratories

\*=Accredited Analyte

PLEASE NOTE: Liability and Damages. Cardinal's liability and client's exclusive remedy for any claim arising, whether based in contract or tort, shall be limited to the amount paid by client for analyses. All claims, including those for negligence and any other cause whatsoever shall be deemed waived unless made in writing and received by Cardinal within thirty (30) days after completion of the applicable service. In no event shall Cardinal be liable for incidental or consequential damages, including, without limitation, business interruptions, loss of use, or loss of profits incurred by client, its subsidiaries, affiliates or successors arising out of or related to the performance of the services hereunder by Cardinal, regardless of whether such claim is based upon any of the above stated reasons or otherwise. Results relate only to the samples identified above. This report shall not be reproduced except in full with written approval of Cardinal Laboratories.



Celey D. Keene, Lab Director/Quality Manager

### Notes and Definitions

S-06	The recovery of this surrogate is outside control limits due to sample dilution required from high analyte concentration and/or matrix interference's.
ND	Analyte NOT DETECTED at or above the reporting limit
RPD	Relative Percent Difference
**	Samples not received at proper temperature of 6°C or below.
***	Insufficient time to reach temperature.
-	Chloride by SM4500Cl-B does not require samples be received at or below 6°C Samples reported on an as received basis (wet) unless otherwise noted on report

---

Cardinal Laboratories

\*=Accredited Analyte

PLEASE NOTE: Liability and Damages. Cardinal's liability and client's exclusive remedy for any claim arising, whether based in contract or tort, shall be limited to the amount paid by client for analyses. All claims, including those for negligence and any other cause whatsoever shall be deemed waived unless made in writing and received by Cardinal within thirty (30) days after completion of the applicable service. In no event shall Cardinal be liable for incidental or consequential damages, including, without limitation, business interruptions, loss of use, or loss of profits incurred by client, its subsidiaries, affiliates or successors arising out of or related to the performance of the services hereunder by Cardinal, regardless of whether such claim is based upon any of the above stated reasons or otherwise. Results relate only to the samples identified above. This report shall not be reproduced except in full with written approval of Cardinal Laboratories.



---

Celey D. Keene, Lab Director/Quality Manager





**CARDINAL LABORATORIES**  
101 East Marland, Hobbs, NM 88240  
(505) 393-2326 FAX (505) 393-2476

**CHAIN-OF-CUSTODY AND ANALYSIS REQUEST**

1057

**BILL TO**

**ANALYSIS REQUEST**

Company Name: BBC International, Inc.

Project Manager: Cliff Brunson

Address: P.O. Box 805

City: Hobbs

Phone #: 575-397-6388

Project #:

Project Name: Neff Federal #1 & #3 SWD Btry

Project Location: Eddy County, NM

Sampler Name: Jeff Ornelas

P.O. #:

Company:

Attn:

Address:

City:

State: Zip:

Phone #:

Fax #:

FOR LAB USE ONLY

Lab I.D.

Sample I.D.

1401235

SP1 @ SURFACE

SP1 @ 1'

SP2 @ SURFACE

SP2 @ 1'

SP3 @ SURFACE

SP3 @ 1'

SP3 @ 3'

SP3 @ 6'

SP3 @ 9'

SP3 @ 12'

(G)RAB OR (C)OMP.

# CONTAINERS

GROUNDWATER

WASTEWATER

SOIL

OIL

SLUDGE

OTHER :

ACID/BASE:

ICE / COOL

OTHER :

DATE

TIME

CL

TPH

BTEX

PLEASE NOTE: Liability and Damages: Cardinal's liability and client's exclusive remedy for any claim arising whether based in contract or tort, shall be limited to the amount paid by the client for the analyses. All claims, including those for negligence and any other cause whatsoever shall be deemed waived unless made in writing and received by Cardinal within 30 days after completion of the applicable service. In no event shall Cardinal be liable for incidental or consequential damages, including without limitation, business interruptions, loss of use, or loss of profits incurred by client, its subsidiaries, affiliates or successors arising out of or related to the performance of services hereunder by Cardinal, regardless of whether such claim is based upon any of the above stated reasons or otherwise.

Relinquished By:

Jeff Ornelas

Received By:

Facile Jimio

Relinquished By:

Facile Jimio

Sampler - UPS - Bus - Other:

0.40

Sample Condition  
Cool ☒ Intact ☒  
Yes ☒ No ☒

CHECKED BY:

(Initials)

Phone Result: ☐ Yes ☐ No Add'l Phone #:  
Fax Result: ☐ Yes ☐ No Add'l Fax #:

REMARKS:

† Cardinal cannot accept verbal changes. Please fax written changes to 505-393-2476

1054



# CARDINAL LABORATORIES

101 East Marland, Hobbs, NM 88240  
(505) 393-2326 FAX (505) 393-2476

## CHAIN-OF-CUSTODY AND ANALYSIS REQUEST

287

Company Name: BBC International, Inc.

Project Manager: Cliff Brunson

Address: P.O. Box 805

City: Hobbs

Phone #: 575-397-6388

Project #:

Project Name: Neff Federal #1 & #3 SWD Btry

Project Location: Eddy County, NM

Sampler Name: Jeff Ornelas

P.O. #:

Company:

Attn:

Address:

City:

State: Zip:

Phone #:

Fax #:

### ANALYSIS REQUEST

Lab I.D.	Sample I.D.	(G)RAB OR (C)OMP.	# CONTAINERS	MATRIX						DATE	TIME										
				GROUNDWATER	WASTEWATER	SOIL	OIL	SLUDGE	OTHER :												
11	SP3 @ 14' -		1							4/21/14	1:49 PM	✓	✓	✓	✓	✓	✓	✓	✓	✓	✓
12	SP4 @ SURFACE -		1							4/21/14	2:19 PM	✓	✓	✓	✓	✓	✓	✓	✓	✓	✓
13	SP4 @ 1' -		1							4/21/14	2:38 PM	✓	✓	✓	✓	✓	✓	✓	✓	✓	✓
14	SP4 @ 3' -		1							4/22/14	8:41 AM	✓	✓	✓	✓	✓	✓	✓	✓	✓	✓
15	SP4 @ 5' -		1							4/22/14	9:47 AM	✓	✓	✓	✓	✓	✓	✓	✓	✓	✓
VJP 4/24/14																					

PLEASE NOTE: Liability and Damages: Cardinal's liability and client's exclusive remedy for any claim arising whether based in contract or tort, shall be limited to the amount paid by the client for the analyses. All claims, including those for negligence and any other cause whatsoever shall be deemed waived unless made in writing and received by Cardinal within 30 days after completion of the applicable service. In no event shall Cardinal be liable for incidental or consequential damages, including without limitation, business interruptions, loss of use, or loss of profits incurred by client, its subsidiaries, affiliates or successors resulting out of or related to the performance of services hereunder by Cardinal, regardless of whether such claim is based upon any of the above stated reasons or otherwise.

Relinquished By:

Jeff Ornelas

Received By:

Relinquished By:

Delivered By: (Circle One)

Sampler - UPS - Bus - Other:

Date: 4/21/14  
Time: 5:00 PM  
Date: 4/24/14  
Time: 12:43 PM

Received By: Jeff Ornelas  
CHECKED BY: (Initials)  
Sample Condition: Cool ☒ Intact ☒  
Yes ☒ No ☐

Phone Result: ☐ Yes ☐ No Add'l Phone #:  
Fax Result: ☐ Yes ☐ No Add'l Fax #:

REMARKS:

† Cardinal cannot accept verbal changes. Please fax written changes to 505-393-2476

#54



District I  
1625 N. French Dr., Hobbs, NM 88240  
District II  
811 S. First St., Artesia, NM 88210  
District III  
1000 Rio Brazos Road, Aztec, NM 87410  
District IV  
1220 S. St. Francis Dr., Santa Fe, NM 87505

State of New Mexico  
Energy Minerals and Natural Resources

Oil Conservation Division  
1220 South St. Francis Dr.  
Santa Fe, NM 87505

Form C-141  
Revised August 8, 2011

Submit 1 Copy to appropriate District Office in  
accordance with 19.15.29 NMAC.

### Release Notification and Corrective Action

#### OPERATOR

☒ Initial Report ☐ Final Report

Name of Company	Oxy Permian Ltd.	Contact	Chancey Summers
Address	1017 W. Stanolind Rd, Hobbs, NM 88240	Telephone No.	(575) 397-8216
Facility Name	Neff Federal #1 and #3 SWD Battery	Facility Type	Battery
Surface Owner	BLM	Mineral Owner	API No.30-015-28281(nearest well)

#### LOCATION OF RELEASE

Unit Letter	Section	Township	Range	Feet from the	North/South Line	Feet from the	East/West Line	County
	25	22S	31E					Eddy County, NM

Latitude N 32.367782° Longitude W 103.733851°

#### NATURE OF RELEASE

Type of Release	Oil and Produced water	Volume of Release	4 bbls oil, 400 bbls produced water	Volume Recovered	400 bbls
Source of Release	High winds caused power pole trip which lead to the tanks spilling over	Date and Hour of Occurrence	03/17/2014	Date and Hour of Discovery	
Was Immediate Notice Given?	<input checked="" type="checkbox"/> Yes <input type="checkbox"/> No <input type="checkbox"/> Not Required	If YES, To Whom?	Mike Bratcher, NMOCD and Jennifer VanCuren, BLM		
By Whom?	Kathy Purvis, BBC International	Date and Hour	03/18/2014 @ 9:24 am		
Was a Watercourse Reached?	<input type="checkbox"/> Yes <input checked="" type="checkbox"/> No	If YES, Volume Impacting the Watercourse.			

If a Watercourse was Impacted, Describe Fully.\*

Describe Cause of Problem and Remedial Action Taken.\*

High winds caused the power pole line fuse to trip which lead to the tanks overflowing and spilling 400 bbls of produced water and 4 bbls of oil onto the ground. A vacuum truck recovered 400 bbls of fluids and the power was restored to the battery location.

Describe Area Affected and Cleanup Action Taken.\*

The affected area is 20' x 60' inside the containment area and 15' x 20' outside the containment area. Remediation will be completed in accordance with a remediation plan approved by NMOCD and the BLM.

I hereby certify that the information given above is true and complete to the best of my knowledge and understand that pursuant to NMOCD rules and regulations all operators are required to report and/or file certain release notifications and perform corrective actions for releases which may endanger public health or the environment. The acceptance of a C-141 report by the NMOCD marked as "Final Report" does not relieve the operator of liability should their operations have failed to adequately investigate and remediate contamination that pose a threat to ground water, surface water, human health or the environment. In addition, NMOCD acceptance of a C-141 report does not relieve the operator of responsibility for compliance with any other federal, state, or local laws and/or regulations.

Signature: 	<b>OIL CONSERVATION DIVISION</b>		
Printed Name: Chancey Summers	Approved by Environmental Specialist:		
Title: HES Specialist	Approval Date:	Expiration Date:	
E-mail Address: <u>Chancey.Summers@oxy.com</u>	Conditions of Approval:		Attached <input type="checkbox"/>
Date: <u>3-18-14</u> Phone: (575) 397-8216			

\* Attach Additional Sheets If Necessary