

Basin Environmental Service Technologies, LLC

3100 Plains Highway
P. O. Box 301
Lovington, New Mexico 88260

jwlowry@basinenv.com

Office: (575) 396-2378

Fax: (575) 396-1429



REMEDIATION SUMMARY AND SITE CLOSURE REQUEST

**BOPCO, LP
JAMES RANCH UNIT #124H TANK BATTERY
Eddy County, New Mexico
Unit Letter "F" (SE/NW), Section 17, Township 23 South, Range 31 East
Latitude 32.305372° North, Longitude 103.802373° West
NMOCD Reference #2RP-2252**

Prepared For:

**BOPCO, LP
522 W. Mermod, Suite 704
Carlsbad, New Mexico 88220**

Prepared By:

**Basin Environmental Service Technologies, LLC
3100 Plains Highway
Lovington, New Mexico 88260**

July 2014

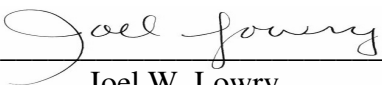

Joel W. Lowry
Project Manager

TABLE OF CONTENTS

1.0 INTRODUCTION & BACKGROUND INFORMATION.....	1
2.0 NMOCD SITE CLASSIFICATION.....	1
3.0 SUMMARY OF SOIL REMEDIATION ACTIVITIES.....	2
4.0 QA/QC PROCEDURES.....	3
4.1 Soil Sampling.....	3
4.2 Decontamination of Equipment.....	3
4.3 Laboratory Protocol.....	3
5.0 SITE CLOSURE REQUEST.....	3
6.0 LIMITATIONS.....	4
7.0 DISTRIBUTION.....	5

FIGURES

Figure 1 – Site Location Map

Figure 2 – Site & Sample Location Map

TABLES

Table 1 – Concentrations of Benzene, BTEX, TPH & Chloride in Soil

APPENDICES

Appendix A – Release Notification and Corrective Action (Form C-141)

Appendix B – Photographs

Appendix C – Laboratory Analytical Reports

1.0 INTRODUCTION & BACKGROUND INFORMATION

Basin Environmental Service Technologies, LLC (Basin), on behalf of BOPCO, LP (BOPCO), has prepared this *Remediation Summary and Site Closure Request* for the release site known as James Ranch Unit #124H Tank Battery (JRU #124). The legal description of the release site is Unit Letter "F" (SE/NW), Section 17, Township 23 South, Range 31 East, in Eddy County, New Mexico. The geographic coordinates of the release site are 32.305372° North latitude and 103.802373° West longitude. The property affected by the release is owned by the United States Department of the Interior - Bureau of Land Management (BLM). A "Site Location Map" is provided as Figure 1.

On March 27, 2014, BOPCO discovered a release had occurred at the JRU #124 Tank Battery. Failure of a three-inch (3") transfer pump resulted in the release of approximately twenty-five barrels (25 bbls) of produced water. The "Release Notification and Corrective Action" (Form C-141) indicated high winds spread the release over approximately 17,600 ft² of pasture land; the heavily impacted vegetated area measured approximately 4,000 ft². The New Mexico Oil Conservation Division (NMOCD) Artesia District Office was notified of the release immediately upon discovery. During initial response activities, a vacuum truck was used to recovery approximately ten barrels (10 bbls) of produced water from the containment area. The affected pump has since been repaired. The Form C-141 is provided as Appendix A. General photographs of the release site are provided as Appendix B.

2.0 NMOCD SITE CLASSIFICATION

A search of the New Mexico Water Rights Reporting System (NMWRRS) database maintained by the New Mexico Office of the State Engineer (NMOSE) indicated information was unavailable for Section 17, Township 23 South, Range 31 East. A depth to groundwater reference map utilized by the NMOCD indicates groundwater should be encountered at approximately one hundred feet (100') below ground surface (bgs). Based on the NMOCD ranking system, zero (0) points will be assigned to the site as a result of this criterion.

A search of the NMWRRS database indicated there are no water wells within one thousand feet (1,000') of the release. Based on the NMOCD ranking system, zero (0) points will be assigned to the site as a result of this criterion.

There are no surface water bodies within one thousand feet (1,000') of the release. Based on the NMOCD ranking system, zero (0) points will be assigned to the site as a result of this criterion.

NMOCD guidelines indicate the JRU #124 release site has an initial ranking score of zero (0) points. The soil remediation levels for a site with a ranking score of zero (0) points are as follows:

- Benzene – 10 mg/Kg (ppm)
- Benzene, Toluene, Ethylbenzene, and Xylenes (BTEX) – 50 mg/Kg (ppm)
- Total Petroleum Hydrocarbons (TPH) – 5,000 mg/Kg (ppm)

The New Mexico Administrative Code (NMAC) does not currently specify a remediation level for chloride concentrations in soil. Chloride remediation levels are set by the NMOCD on a site-specific basis.

3.0 SUMMARY OF SOIL REMEDIATION ACTIVITIES

On June 6, 2014, Basin began excavating impacted soil at the release site. The floor and sidewalls of the excavation were advanced until field tests suggested concentrations of BTEX, TPH and chloride were below NMOCD regulatory standards. Excavated soil was stockpiled on-site, pending final disposition.

On June 12, 2014, eight (8) confirmation soil sample (SSW #1, SSW #2, SSW #3, S. Floor #1, S. Floor #2, S. Floor #3, Middle Floor #1 and Middle Floor #2) were collected from the excavated area and submitted to the laboratory for analysis of chloride concentrations. Laboratory analytical results indicated the chloride concentrations ranged from 48.0 ppm for soil sample SSW #1 to 208 ppm for soil sample S. Floor #2. Soil samples South Floor #2 and Middle Floor #1 were also analyzed for concentrations of BTEX and TPH. Laboratory analytical results indicated BTEX and TPH concentrations were less than the appropriate laboratory method detection limit (MDL) in each of the samples. A summary of “Concentrations of Benzene, BTEX, TPH & Chloride in Soil” is provided in Table 1. A “Site & Sample Location Map” is provided as Figure 2. Laboratory analytical reports are provided as Appendix C.

On June 13, 2014, ten (10) confirmation soil samples (NSW #1, NSW #2, NSW #3, ESW #1, ESW #2, WSW #3, Middle Floor #3, N. Floor #1, N. Floor #2 and N. Floor #3) were collected from the excavated area and submitted to the laboratory for analysis of chloride concentrations. Laboratory analytical results indicated chloride concentrations ranged from 32.0 ppm for soil sample WSW #3 to 416 ppm for soil sample NSW #3. Soil samples Middle Floor #3, N. Floor #1, N. Floor #2 and N. Floor #3 were also analyzed for concentrations of BTEX and TPH. Laboratory analytical results indicated BTEX and TPH concentrations were less than the appropriate laboratory MDL in each of the samples.

In addition, one soil sample (WSW #1 In-Situ) was collected from the west side wall adjacent to the tank battery containment in an effort to characterize impacted soils left in-situ. Soil sample WSW #1 In-Situ was submitted to the laboratory for analysis of chloride concentrations, which were determined to be 1,100 ppm. Further advancement of the excavation in the area represented by soil sample WSW #1 In-Situ was limited by the presence of the tank battery containment and multiple active pipelines.

Between June 13 and 18, 2014, approximately nine hundred and sixty cubic yards (960 yd³) of impacted material was transported to Lea Land, Inc. (NMOCD Permit #WM-01-035), for disposal. The final dimensions of the excavation were one hundred and twenty-five feet (125') in width, one hundred and thirty feet (130') in length and eighteen inches (18") to four and one-half feet (4.5') in depth. Upon receiving laboratory analytical data from confirmation soil samples, the excavated area was backfilled with locally purchased, non-impacted soil. Following backfilling, areas affected by the remediation activities were compacted and contoured to match the surrounding topography.

The site will be reseeded with a BLM-approved seed mixture at a time more conducive to germination.

4.0 QA/QC PROCEDURES

4.1 Soil Sampling

Soil samples were delivered to Cardinal Laboratories, Inc., in Hobbs, New Mexico, for BTEX, TPH and/or chloride analyses using the methods described below:

- BTEX concentrations in accordance with EPA Method SW-846 8021b
- TPH concentrations in accordance with EPA Method SW-846 8015M
- Chloride concentrations in accordance with EPA Method 4500 Cl-B

4.2 Decontamination of Equipment

Cleaning of the sampling equipment was the responsibility of the environmental technician. Prior to use, and between each sample, the sampling equipment was cleaned with Liqui-Nox® detergent and rinsed with distilled water.

4.3 Laboratory Protocol

The laboratory was responsible for proper QA/QC procedures after signing the chain-of-custody form(s). These procedures were either transmitted with the laboratory reports or are on file at the laboratory.

5.0 SITE CLOSURE REQUEST

Confirmation soil samples collected from the floor and sidewalls of the JRU #124 excavation were analyzed by an NMOCD-approved laboratory. Concentrations of BTEX, TPH and chloride were less than NMOCD regulatory standards in each of the submitted soil samples with the exception of soil sample WSW #1 (In-Situ), which exhibited a chloride concentration of 1,100 ppm. Impacted soil characterized by soil sample WSW #1 (In-Situ) will be remediated upon abandonment of the facility. Based on these laboratory analytical results, Basin recommends BOPCO provide the NMOCD-Artesia District Office and the BLM a copy of this *Remediation Summary and Site Closure Request* and request the NMOCD grant site closure to the JRU #124 release site.

6.0 LIMITATIONS

Basin Environmental Service Technologies, LLC, has prepared this *Remediation Summary and Site Closure Request* to the best of its ability. No other warranty, expressed or implied, is made or intended. Basin has examined and relied upon documents referenced in the report and on oral statements made by certain individuals. Basin has not conducted an independent examination of the facts contained in referenced materials and statements. Basin has presumed the genuineness of these documents and statements and that the information provided therein is true and accurate. Basin has prepared this report in a professional manner, using the degree of skill and care exercised by similar environmental consultants. Basin notes that the facts and conditions referenced in this report may change over time, and the conclusions and recommendations set forth herein are applicable only to the facts and conditions as described at the time of this report.

This report has been prepared for the benefit of BOPCO, LP. The information contained in this report, including all exhibits and attachments, may not be used by any other party without the express consent of Basin Environmental Service Technologies, LLC, and/or BOPCO, LP.

7.0 DISTRIBUTION:

- Copy 1: Mike Bratcher
New Mexico Energy, Minerals and Natural Resources Department
Oil Conservation Division (District 2)
1301 E. Grand Avenue
Artesia, NM 88210
- Copy 2: James Amos
Bureau of Land Management
602 E. Greene Street
Carlsbad, New Mexico 88220
- Copy 3: Tony Savoie
BOPCO, LP
522 W. Mermod, Suite 704
Carlsbad, NM 88220
- Copy 4: Basin Environmental Service Technologies, LLC
P.O. Box 301
Lovington, NM 88260

FIGURES

Oilfield Access Road

Steel Flow Lines

6" Steel BPL

8" Steel BPL

JRU #124 Tank Battery

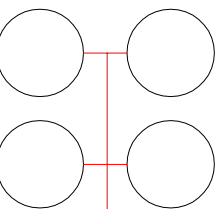

Release Point X

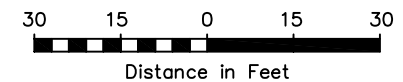
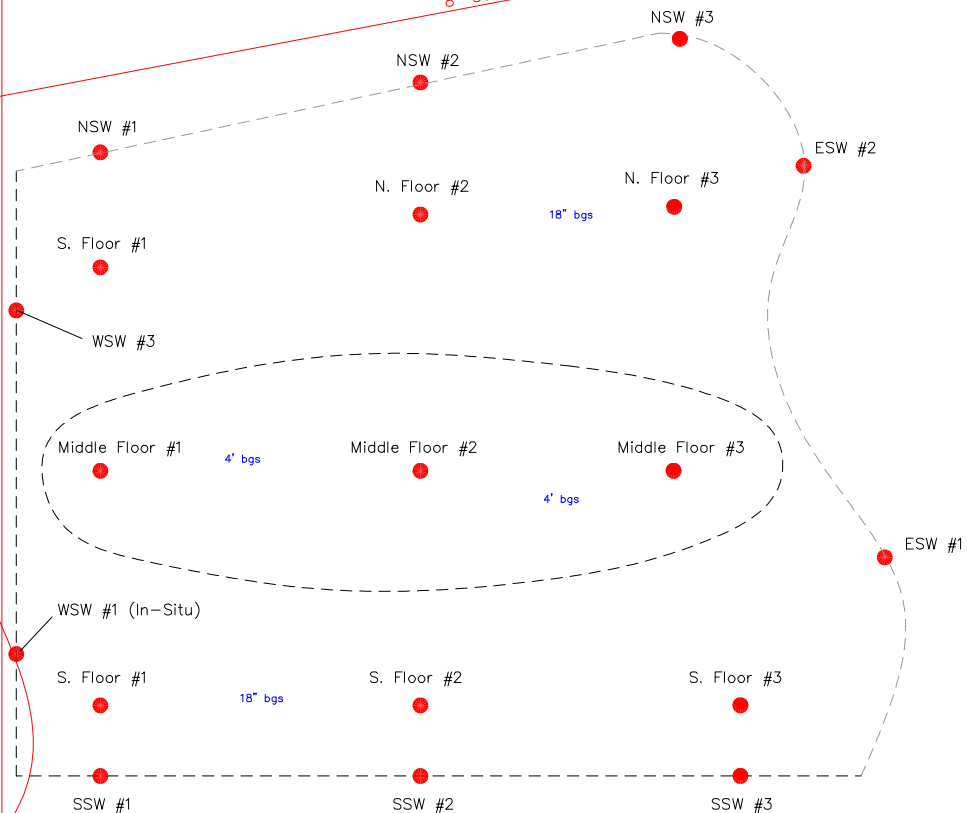

Legend:

- Sample Location
- Pipeline
- Excavation Extent
- Caliche Well Pad
- X

Figure 2
Site & Sample Location Map
BOPCO, L.P.
James Ranch Unit #124 Tank Battery
NMOCD Ref # 2RP-2252
Eddy County, New Mexico

Basin Environmental Service Technologies

Prep By: JWL	Checked By: BJA
July 3, 2014	Scale 1"=30'

TABLES

TABLE 1
CONCENTRATIONS OF BENZENE, BTEX, TPH & CHLORIDE IN SOIL

BOPCO, LP
JAMES RANCH UNIT #124H TANK BATTERY
EDDY COUNTY, NEW MEXICO
NMOCD REFERENCE #: 2RP-2252

SAMPLE LOCATION	SAMPLE DEPTH (BGS)	SAMPLE DATE	SOIL STATUS	METHOD: EPA SW 846-8021B, 5030					METHOD: 8015M			TOTAL TPH C ₆ -C ₃₅ (mg/Kg)	4500 CI-B CHLORIDE (mg/Kg)
				BENZENE (mg/Kg)	TOLUENE (mg/Kg)	ETHYL- BENZENE (mg/Kg)	TOTAL XYLENES (mg/Kg)	TOTAL BTEX (mg/Kg)	GRO C ₆ -C ₁₂ (mg/Kg)	DRO C ₁₂ -C ₂₈ (mg/Kg)	ORO C ₂₈ -C ₃₅ (mg/Kg)		
SSW #1	1'	6/12/2014	In-Situ	-	-	-	-	-	-	-	-	-	48.0
SSW #2	1'	6/12/2014	In-Situ	-	-	-	-	-	-	-	-	-	176
SSW #3	1'	6/12/2014	In-Situ	-	-	-	-	-	-	-	-	-	96.0
S. Floor #1	1.5'	6/12/2014	In-Situ	-	-	-	-	-	-	-	-	-	80.0
S. Floor #2	1.5'	6/12/2014	In-Situ	<0.050	<0.050	<0.050	<0.150	<0.300	<10.0	<10.0	<10.0	<10.0	208
S. Floor #3	1.5'	6/12/2014	In-Situ	-	-	-	-	-	-	-	-	-	96.0
Middle Floor #1	4.5'	6/12/2014	In-Situ	<0.050	<0.050	<0.050	<0.150	<0.300	<10.0	<10.0	<10.0	<10.0	272
Middle Floor #2	4.5'	6/12/2014	In-Situ	-	-	-	-	-	-	-	-	-	64.0
NSW #1	1'	6/13/2014	In-Situ	-	-	-	-	-	-	-	-	-	112
NSW #2	1'	6/13/2014	In-Situ	-	-	-	-	-	-	-	-	-	80.0
NSW #3	1'	6/13/2014	In-Situ	-	-	-	-	-	-	-	-	-	416
ESW #1	1'	6/13/2014	In-Situ	-	-	-	-	-	-	-	-	-	80.0
ESW #2	1'	6/13/2014	In-Situ	-	-	-	-	-	-	-	-	-	336
WSW #3	1'	6/13/2014	In-Situ	-	-	-	-	-	-	-	-	-	32.0
Middle Floor #3	4.5'	6/13/2014	In-Situ	<0.050	<0.050	<0.050	<0.150	<0.300	<10.0	<10.0	<10.0	<10.0	224
N. Floor #1	1.5'	6/13/2014	In-Situ	<0.050	<0.050	<0.050	<0.150	<0.300	<10.0	<10.0	<10.0	<10.0	112
N. Floor #2	1.5'	6/13/2014	In-Situ	<0.050	<0.050	<0.050	<0.150	<0.300	<10.0	<10.0	<10.0	<10.0	160
N. Floor #3	1.5'	6/13/2014	In-Situ	<0.050	<0.050	<0.050	<0.150	<0.300	<10.0	<10.0	<10.0	<10.0	240
WSW #1 (In-Situ)	1'	6/13/2014	In-Situ	-	-	-	-	-	-	-	-	-	1,100
NMOCD Criteria				10				50				5,000	1,000

- = Not analyzed.

APPENDICES

Appendix A
Release Notification and Corrective Action
(Form C-141)

District I
1625 N. French Dr., Hobbs, NM 88240
District II
811 S. First St., Artesia, NM 88210
District III
1000 Rio Brazos Road, Aztec, NM 87410
District IV
1220 S. St. Francis Dr., Santa Fe, NM 87505

State of New Mexico
Energy Minerals and Natural Resources

Oil Conservation Division
1220 South St. Francis Dr.
Santa Fe, NM 87505

Form C-141
Revised August 8, 2011

Submit 1 Copy to appropriate District Office in
accordance with 19.15.29 NMAC.

Release Notification and Corrective Action

nHMP1410129629

OPERATOR

☒ Initial Report ☐ Final Report

Name of Company: BOPCO, L.P.	260737	Contact: Tony Savoie
Address: 522 W. Mermod, Suite 704 Carlsbad, N.M. 88220		Telephone No. 575-887-7329
Facility Name: JRU-124H Tank Battery		Facility Type: Exploration and Production

Surface Owner: Federal	Mineral Owner: Federal	API No. 30-015-38113
------------------------	------------------------	----------------------

LOCATION OF RELEASE

Unit Letter F	Section 17	Township 23S	Range 31E	Feet from the 2450	North/South Line NORTH	Feet from the 1430	East/West Line WEST	County: Eddy
------------------	---------------	-----------------	--------------	-----------------------	---------------------------	-----------------------	------------------------	-----------------

Latitude N 32.305372 Longitude W 103.802373

NATURE OF RELEASE

Type of Release: Produced Water	Volume of Release: 25 bbls	Volume Recovered: 10 bbls
Source of Release: Water Transfer Pump	Date and Hour of Occurrence: Date 3/27/14 Time unknown	Date and Hour of Discovery: Date 3/27/14 at 1:00 p.m.
Was Immediate Notice Given? <input checked="" type="checkbox"/> Yes <input type="checkbox"/> No <input type="checkbox"/> Not Required	If YES, To Whom? NMOCD Emergency #104 and the BLM	
By Whom? Tony Savoie	Date and Hour: 3/27/14 at 3:00 p.m.	
Was a Watercourse Reached? <input type="checkbox"/> Yes <input checked="" type="checkbox"/> No	If YES, Volume Impacting the Watercourse.	

If a Watercourse was Impacted, Describe Fully.*

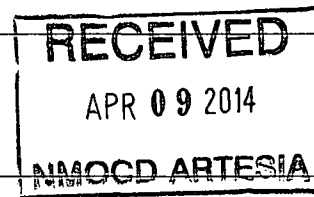

Describe Cause of Problem and Remedial Action Taken.*

A fitting on the 3" water transfer pump failed due to excessive vibration. The pump was shut down, the fittings were replaced and the pump was repaired.

Describe Area Affected and Cleanup Action Taken.*

The pump was located inside a 0 perm containment around the tanks and pumping equipment, due to the pressure at the release point approximately 17,600 total area of pasture land was impacted by the water being carried east due to high winds. Approximately 10 bbls of fluid was recovered from the containment area. The heavily impacted vegetated area measured approximately 4,000 sq.ft.
The spill area will be cleaned up in accordance with the NMOCD and BLM remediation guidelines.

I hereby certify that the information given above is true and complete to the best of my knowledge and understand that pursuant to NMOCD rules and regulations all operators are required to report and/or file certain release notifications and perform corrective actions for releases which may endanger public health or the environment. The acceptance of a C-141 report by the NMOCD marked as "Final Report" does not relieve the operator of liability should their operations have failed to adequately investigate and remediate contamination that pose a threat to ground water, surface water, human health or the environment. In addition, NMOCD acceptance of a C-141 report does not relieve the operator of responsibility for compliance with any other federal, state, or local laws and/or regulations.

Signature: Tony Savoie		OIL CONSERVATION DIVISION	
Printed Name: Tony Savoie		Approved by Environmental Specialist: [Signature]	
Title: Waste Management and Remediation Specialist		Approval Date: 4/11/14	Expiration Date: NA
E-mail Address: tasavoie@basspet.com		Conditions of Approval:	
Date: 4/9/14 Phone: 432-556-8730		Remediation per OCD Rule & Guidelines. SUBMIT REMEDIATION PROPOSAL NO LATER THAN:	
		Attached <input type="checkbox"/>	

* Attach Additional Sheets If Necessary

5/11/14

2PP-2252

Appendix B

Photographs



Photograph of the initial release at the JRU #124H Tank Battery Release Site.



Photograph of the initial release at the JRU #124H Tank Battery Release Site.



Photograph of the excavated area at the JRU #124H Tank Battery Release Site.



Photograph of the excavated area at the JRU #124H Tank Battery Release Site.



Photograph of backfilling activities at the JRU #124H Tank Battery Release Site.



Photograph of backfilling activities at the JRU #124H Tank Battery Release Site.

Appendix C

Laboratory Analytical Reports

June 20, 2014

JOEL LOWRY

Basin Environmental Service

P.O. Box 301

Lovington, NM 88260

RE: JRU #124 TANK BATTERY

Enclosed are the results of analyses for samples received by the laboratory on 06/13/14 10:45.

Cardinal Laboratories is accredited through Texas NELAP under certificate number T104704398-13-5. Accreditation applies to drinking water, non-potable water and solid and chemical materials. All accredited analytes are denoted by an asterisk (*). For a complete list of accredited analytes and matrices visit the TCEQ website at www.tceq.texas.gov/field/qa/lab_accred_certif.html.

Cardinal Laboratories is accredited through the State of Colorado Department of Public Health and Environment for:

Method EPA 552.2	Haloacetic Acids (HAA-5)
Method EPA 524.2	Total Trihalomethanes (TTHM)
Method EPA 524.4	Regulated VOCs (V1, V2, V3)

Accreditation applies to public drinking water matrices.

This report meets NELAP requirements and is made up of a cover page, analytical results, and a copy of the original chain-of-custody. If you have any questions concerning this report, please feel free to contact me.

Sincerely,



Celey D. Keene

Lab Director/Quality Manager

Analytical Results For:

Basin Environmental Service
JOEL LOWRY
P.O. Box 301
Lovington NM, 88260
Fax To: (575) 396-1429

Received: 06/13/2014
Reported: 06/20/2014
Project Name: JRU #124 TANK BATTERY
Project Number: NONE GIVEN
Project Location: EDDY COUNTY, NM

Sampling Date: 06/12/2014
Sampling Type: Soil
Sampling Condition: Cool & Intact
Sample Received By: Jodi Henson

Sample ID: SSW #1 (H401808-01)

Chloride, SM4500CI-B		mg/kg		Analyzed By: HM					
Analyte	Result	Reporting Limit	Analyzed	Method Blank	BS	% Recovery	True Value QC	RPD	Qualifier
Chloride	48.0	16.0	06/18/2014	ND	400	100	400	7.69	

Sample ID: SSW #2 (H401808-02)

Chloride, SM4500CI-B		mg/kg		Analyzed By: HM					
Analyte	Result	Reporting Limit	Analyzed	Method Blank	BS	% Recovery	True Value QC	RPD	Qualifier
Chloride	176	16.0	06/18/2014	ND	400	100	400	7.69	

Sample ID: SSW #3 (H401808-03)

Chloride, SM4500CI-B		mg/kg		Analyzed By: HM					
Analyte	Result	Reporting Limit	Analyzed	Method Blank	BS	% Recovery	True Value QC	RPD	Qualifier
Chloride	96.0	16.0	06/18/2014	ND	400	100	400	7.69	

Sample ID: S. FLOOR #1 (H401808-04)

Chloride, SM4500CI-B		mg/kg		Analyzed By: HM					
Analyte	Result	Reporting Limit	Analyzed	Method Blank	BS	% Recovery	True Value QC	RPD	Qualifier
Chloride	80.0	16.0	06/18/2014	ND	400	100	400	7.69	

Cardinal Laboratories

*=Accredited Analyte

PLEASE NOTE: Liability and Damages. Cardinal's liability and client's exclusive remedy for any claim arising, whether based in contract or tort, shall be limited to the amount paid by client for analyses. All claims, including those for negligence and any other cause whatsoever shall be deemed waived unless made in writing and received by Cardinal within thirty (30) days after completion of the applicable service. In no event shall Cardinal be liable for incidental or consequential damages, including, without limitation, business interruptions, loss of use, or loss of profits incurred by client, its subsidiaries, affiliates or successors arising out of or related to the performance of the services hereunder by Cardinal, regardless of whether such claim is based upon any of the above stated reasons or otherwise. Results relate only to the samples identified above. This report shall not be reproduced except in full with written approval of Cardinal Laboratories.



Celey D. Keene, Lab Director/Quality Manager

Analytical Results For:

Basin Environmental Service
JOEL LOWRY
P.O. Box 301
Lovington NM, 88260
Fax To: (575) 396-1429

Received: 06/13/2014
Reported: 06/20/2014
Project Name: JRU #124 TANK BATTERY
Project Number: NONE GIVEN
Project Location: EDDY COUNTY, NM

Sampling Date: 06/12/2014
Sampling Type: Soil
Sampling Condition: Cool & Intact
Sample Received By: Jodi Henson

Sample ID: S. FLOOR #2 (H401808-05)

BTEx 8021B		mg/kg		Analyzed By: CK						
Analyte	Result	Reporting Limit	Analyzed	Method Blank	BS	% Recovery	True Value QC	RPD	Qualifier	
Benzene*	<0.050	0.050	06/17/2014	ND	2.08	104	2.00	0.303		
Toluene*	<0.050	0.050	06/17/2014	ND	2.23	112	2.00	0.554		
Ethylbenzene*	<0.050	0.050	06/17/2014	ND	2.01	101	2.00	0.264		
Total Xylenes*	<0.150	0.150	06/17/2014	ND	6.21	103	6.00	0.529		
Total BTEx	<0.300	0.300	06/17/2014	ND						

Surrogate: 4-Bromofluorobenzene (PID) 111 % 89.4-126

Chloride, SM4500Cl-B		mg/kg		Analyzed By: HM					
Analyte	Result	Reporting Limit	Analyzed	Method Blank	BS	% Recovery	True Value QC	RPD	Qualifier
Chloride	208	16.0	06/18/2014	ND	400	100	400	7.69	

TPH 8015M		mg/kg		Analyzed By: MS					
Analyte	Result	Reporting Limit	Analyzed	Method Blank	BS	% Recovery	True Value QC	RPD	Qualifier
GRO C6-C10	<10.0	10.0	06/19/2014	ND	174	87.0	200	4.35	
DRO >C10-C28	<10.0	10.0	06/19/2014	ND	195	97.5	200	4.36	
EXT DRO >C28-C35	<10.0	10.0	06/19/2014	ND					

Surrogate: 1-Chlorooctane 87.3 % 65.2-140

Surrogate: 1-Chlorooctadecane 93.3 % 63.6-154

Cardinal Laboratories

*=Accredited Analyte

PLEASE NOTE: Liability and Damages. Cardinal's liability and client's exclusive remedy for any claim arising, whether based in contract or tort, shall be limited to the amount paid by client for analyses. All claims, including those for negligence and any other cause whatsoever shall be deemed waived unless made in writing and received by Cardinal within thirty (30) days after completion of the applicable service. In no event shall Cardinal be liable for incidental or consequential damages, including, without limitation, business interruptions, loss of use, or loss of profits incurred by client, its subsidiaries, affiliates or successors arising out of or related to the performance of the services hereunder by Cardinal, regardless of whether such claim is based upon any of the above stated reasons or otherwise. Results relate only to the samples identified above. This report shall not be reproduced except in full with written approval of Cardinal Laboratories.



Celey D. Keene, Lab Director/Quality Manager

Analytical Results For:

Basin Environmental Service
JOEL LOWRY
P.O. Box 301
Lovington NM, 88260
Fax To: (575) 396-1429

Received: 06/13/2014
Reported: 06/20/2014
Project Name: JRU #124 TANK BATTERY
Project Number: NONE GIVEN
Project Location: EDDY COUNTY, NM

Sampling Date: 06/12/2014
Sampling Type: Soil
Sampling Condition: Cool & Intact
Sample Received By: Jodi Henson

Sample ID: S. FLOOR #3 (H401808-06)

Chloride, SM4500Cl-B		mg/kg		Analyzed By: HM					
Analyte	Result	Reporting Limit	Analyzed	Method Blank	BS	% Recovery	True Value QC	RPD	Qualifier
Chloride	96.0	16.0	06/18/2014	ND	400	100	400	7.69	

Cardinal Laboratories

*=Accredited Analyte

PLEASE NOTE: Liability and Damages. Cardinal's liability and client's exclusive remedy for any claim arising, whether based in contract or tort, shall be limited to the amount paid by client for analyses. All claims, including those for negligence and any other cause whatsoever shall be deemed waived unless made in writing and received by Cardinal within thirty (30) days after completion of the applicable service. In no event shall Cardinal be liable for incidental or consequential damages, including, without limitation, business interruptions, loss of use, or loss of profits incurred by client, its subsidiaries, affiliates or successors arising out of or related to the performance of the services hereunder by Cardinal, regardless of whether such claim is based upon any of the above stated reasons or otherwise. Results relate only to the samples identified above. This report shall not be reproduced except in full with written approval of Cardinal Laboratories.



Celey D. Keene, Lab Director/Quality Manager

Analytical Results For:

Basin Environmental Service
JOEL LOWRY
P.O. Box 301
Lovington NM, 88260
Fax To: (575) 396-1429

Received: 06/13/2014
Reported: 06/20/2014
Project Name: JRU #124 TANK BATTERY
Project Number: NONE GIVEN
Project Location: EDDY COUNTY, NM

Sampling Date: 06/12/2014
Sampling Type: Soil
Sampling Condition: Cool & Intact
Sample Received By: Jodi Henson

Sample ID: MIDDLE FLOOR #1 (H401808-07)

BTEx 8021B		mg/kg		Analyzed By: CK					
Analyte	Result	Reporting Limit	Analyzed	Method Blank	BS	% Recovery	True Value QC	RPD	Qualifier
Benzene*	<0.050	0.050	06/17/2014	ND	2.08	104	2.00	0.303	
Toluene*	<0.050	0.050	06/17/2014	ND	2.23	112	2.00	0.554	
Ethylbenzene*	<0.050	0.050	06/17/2014	ND	2.01	101	2.00	0.264	
Total Xylenes*	<0.150	0.150	06/17/2014	ND	6.21	103	6.00	0.529	
Total BTEx	<0.300	0.300	06/17/2014	ND					

Surrogate: 4-Bromofluorobenzene (PID) 111 % 89.4-126

Chloride, SM4500Cl-B		mg/kg		Analyzed By: HM					
Analyte	Result	Reporting Limit	Analyzed	Method Blank	BS	% Recovery	True Value QC	RPD	Qualifier
Chloride	272	16.0	06/18/2014	ND	400	100	400	7.69	

TPH 8015M		mg/kg		Analyzed By: MS					
Analyte	Result	Reporting Limit	Analyzed	Method Blank	BS	% Recovery	True Value QC	RPD	Qualifier
GRO C6-C10	<10.0	10.0	06/19/2014	ND	174	87.0	200	4.35	
DRO >C10-C28	<10.0	10.0	06/19/2014	ND	195	97.5	200	4.36	
EXT DRO >C28-C35	<10.0	10.0	06/19/2014	ND					

Surrogate: 1-Chlorooctane 91.8 % 65.2-140

Surrogate: 1-Chlorooctadecane 98.2 % 63.6-154

Cardinal Laboratories

*=Accredited Analyte

PLEASE NOTE: Liability and Damages. Cardinal's liability and client's exclusive remedy for any claim arising, whether based in contract or tort, shall be limited to the amount paid by client for analyses. All claims, including those for negligence and any other cause whatsoever shall be deemed waived unless made in writing and received by Cardinal within thirty (30) days after completion of the applicable service. In no event shall Cardinal be liable for incidental or consequential damages, including, without limitation, business interruptions, loss of use, or loss of profits incurred by client, its subsidiaries, affiliates or successors arising out of or related to the performance of the services hereunder by Cardinal, regardless of whether such claim is based upon any of the above stated reasons or otherwise. Results relate only to the samples identified above. This report shall not be reproduced except in full with written approval of Cardinal Laboratories.



Celey D. Keene, Lab Director/Quality Manager

Analytical Results For:

Basin Environmental Service
JOEL LOWRY
P.O. Box 301
Lovington NM, 88260
Fax To: (575) 396-1429

Received: 06/13/2014
Reported: 06/20/2014
Project Name: JRU #124 TANK BATTERY
Project Number: NONE GIVEN
Project Location: EDDY COUNTY, NM

Sampling Date: 06/12/2014
Sampling Type: Soil
Sampling Condition: Cool & Intact
Sample Received By: Jodi Henson

Sample ID: MIDDLE FLOOR #2 (H401808-08)**Chloride, SM4500Cl-B****mg/kg****Analyzed By: HM**

Analyte	Result	Reporting Limit	Analyzed	Method Blank	BS	% Recovery	True Value QC	RPD	Qualifier
Chloride	64.0	16.0	06/18/2014	ND	400	100	400	7.69	

Cardinal Laboratories

*=Accredited Analyte

PLEASE NOTE: Liability and Damages. Cardinal's liability and client's exclusive remedy for any claim arising, whether based in contract or tort, shall be limited to the amount paid by client for analyses. All claims, including those for negligence and any other cause whatsoever shall be deemed waived unless made in writing and received by Cardinal within thirty (30) days after completion of the applicable service. In no event shall Cardinal be liable for incidental or consequential damages, including, without limitation, business interruptions, loss of use, or loss of profits incurred by client, its subsidiaries, affiliates or successors arising out of or related to the performance of the services hereunder by Cardinal, regardless of whether such claim is based upon any of the above stated reasons or otherwise. Results relate only to the samples identified above. This report shall not be reproduced except in full with written approval of Cardinal Laboratories.



Celey D. Keene, Lab Director/Quality Manager

Notes and Definitions

ND	Analyte NOT DETECTED at or above the reporting limit
RPD	Relative Percent Difference
**	Samples not received at proper temperature of 6°C or below.
***	Insufficient time to reach temperature.
-	Chloride by SM4500Cl-B does not require samples be received at or below 6°C Samples reported on an as received basis (wet) unless otherwise noted on report

Cardinal Laboratories

*=Accredited Analyte

PLEASE NOTE: Liability and Damages. Cardinal's liability and client's exclusive remedy for any claim arising, whether based in contract or tort, shall be limited to the amount paid by client for analyses. All claims, including those for negligence and any other cause whatsoever shall be deemed waived unless made in writing and received by Cardinal within thirty (30) days after completion of the applicable service. In no event shall Cardinal be liable for incidental or consequential damages, including, without limitation, business interruptions, loss of use, or loss of profits incurred by client, its subsidiaries, affiliates or successors arising out of or related to the performance of the services hereunder by Cardinal, regardless of whether such claim is based upon any of the above stated reasons or otherwise. Results relate only to the samples identified above. This report shall not be reproduced except in full with written approval of Cardinal Laboratories.



Celey D. Keene, Lab Director/Quality Manager



101 East Marland, Hobbs, NM 88240

(575) 393-2326 FAX (575) 393-2476

CHAIN-OF-CUSTODY AND ANALYSIS REQUEST

PLEASE NOTE: Liability and Damages. Cardinal's liability and client's exclusive remedy for any claim arising whether based in contract or tort, shall be limited to the amount paid by the client for the analyses. All claims, including those for negligence and any other cause whatsoever shall be deemed waived unless made in writing and received by Cardinal within 30 days after completion of the applicable service. In no event shall Cardinal be liable for incidental or consequential damages, including without limitation, business interruptions, loss of use, or loss of profits incurred by client, its subsidiaries, or affiliates. The sole remedy of either party for the other's breach of this agreement shall be the payment of the amount paid by the client for the analyses. The sole remedy of either party for the other's breach of this agreement shall be the payment of the amount paid by the client for the analyses.

11

CHECKED BY:
(Initials)

☒ Yes ☒ Yes

* Cardinal cannot accept verbal changes. Please fax written changes to 575-393-2476



PHONE (575) 393-2326 ° 101 E. MARLAND ° HOBBS, NM 88240

July 02, 2014

JOEL LOWRY

Basin Environmental Service

P.O. Box 301

Lovington, NM 88260

RE: JRU #124 TANK BATTERY

Enclosed are the results of analyses for samples received by the laboratory on 06/27/14 9:45.

Cardinal Laboratories is accredited through Texas NELAP under certificate number T104704398-13-5. Accreditation applies to drinking water, non-potable water and solid and chemical materials. All accredited analytes are denoted by an asterisk (*). For a complete list of accredited analytes and matrices visit the TCEQ website at www.tceq.texas.gov/field/qa/lab_accred_certif.html.

Cardinal Laboratories is accredited through the State of Colorado Department of Public Health and Environment for:

Method EPA 552.2	Haloacetic Acids (HAA-5)
Method EPA 524.2	Total Trihalomethanes (TTHM)
Method EPA 524.4	Regulated VOCs (V1, V2, V3)

Accreditation applies to public drinking water matrices.

This report meets NELAP requirements and is made up of a cover page, analytical results, and a copy of the original chain-of-custody. If you have any questions concerning this report, please feel free to contact me.

Sincerely,

Celey D. Keene

Lab Director/Quality Manager

Analytical Results For:

Basin Environmental Service
JOEL LOWRY
P.O. Box 301
Lovington NM, 88260
Fax To: (575) 396-1429

Received: 06/27/2014
Reported: 07/02/2014
Project Name: JRU #124 TANK BATTERY
Project Number: NONE GIVEN
Project Location: EDDY COUNTY, NM

Sampling Date: 06/13/2014
Sampling Type: Soil
Sampling Condition: Cool & Intact
Sample Received By: Jodi Henson

Sample ID: WSW #1 (IN-SITU) (H401944-01)**Chloride, SM4500Cl-B****mg/kg****Analyzed By: AP**

Analyte	Result	Reporting Limit	Analyzed	Method Blank	BS	% Recovery	True Value QC	RPD	Qualifier
Chloride	1100	16.0	06/30/2014	ND	416	104	400	0.00	

Cardinal Laboratories

*=Accredited Analyte

PLEASE NOTE: Liability and Damages. Cardinal's liability and client's exclusive remedy for any claim arising, whether based in contract or tort, shall be limited to the amount paid by client for analyses. All claims, including those for negligence and any other cause whatsoever shall be deemed waived unless made in writing and received by Cardinal within thirty (30) days after completion of the applicable service. In no event shall Cardinal be liable for incidental or consequential damages, including, without limitation, business interruptions, loss of use, or loss of profits incurred by client, its subsidiaries, affiliates or successors arising out of or related to the performance of the services hereunder by Cardinal, regardless of whether such claim is based upon any of the above stated reasons or otherwise. Results relate only to the samples identified above. This report shall not be reproduced except in full with written approval of Cardinal Laboratories.



Celey D. Keene, Lab Director/Quality Manager

Notes and Definitions

ND	Analyte NOT DETECTED at or above the reporting limit
RPD	Relative Percent Difference
**	Samples not received at proper temperature of 6°C or below.
***	Insufficient time to reach temperature.
-	Chloride by SM4500Cl-B does not require samples be received at or below 6°C Samples reported on an as received basis (wet) unless otherwise noted on report

Cardinal Laboratories

*=Accredited Analyte

PLEASE NOTE: Liability and Damages. Cardinal's liability and client's exclusive remedy for any claim arising, whether based in contract or tort, shall be limited to the amount paid by client for analyses. All claims, including those for negligence and any other cause whatsoever shall be deemed waived unless made in writing and received by Cardinal within thirty (30) days after completion of the applicable service. In no event shall Cardinal be liable for incidental or consequential damages, including, without limitation, business interruptions, loss of use, or loss of profits incurred by client, its subsidiaries, affiliates or successors arising out of or related to the performance of the services hereunder by Cardinal, regardless of whether such claim is based upon any of the above stated reasons or otherwise. Results relate only to the samples identified above. This report shall not be reproduced except in full with written approval of Cardinal Laboratories.



Celey D. Keene, Lab Director/Quality Manager



CARDINAL LABORATORIES

101 East Marland, Hobbs, NM 88240

(575) 393-2326 FAX (575) 393-2476

CHAIN-OF-CUSTODY AND ANALYSIS REQUEST

Company Name: Basin Environmental Service Technologies, LLC

Project Manager: Joel Lowry

Address: P.O. Box 301

City: Lovington

Phone #: (575)396-2378

Project #:

Project Name: JRU #124 Tank Battery

Project Location: Eddy Co., NM

Sampler Name: 3002 Lowry

FOR LAB USE ONLY

Lab I.D.

Sample I.D.

H4D1944

1

WSW #1 (In-Situ)

9

1

X

6/13/14

1200

X

(G)RAB OR (C)OMP.

CONTAINERS

GROUNDWATER

WASTEWATER

SOIL

OIL

SLUDGE

OTHER :

ACID/BASE:

ICE / COOL

OTHER :

DATE

TIME

Chloride

TPH (8015M)

BTEX (8021B)

HOLD FOR TPH

ANALYSIS REQUEST

CLORIDE

TPH (8015M)

BTEX (8021B)

HOLD FOR TPH

ANALYSIS REQUEST

CLORIDE

TPH (8015M)

BTEX (8021B)

HOLD FOR TPH

ANALYSIS REQUEST

CLORIDE

TPH (8015M)

BTEX (8021B)

HOLD FOR TPH

ANALYSIS REQUEST

CLORIDE

TPH (8015M)

BTEX (8021B)

HOLD FOR TPH

ANALYSIS REQUEST

CLORIDE

TPH (8015M)

BTEX (8021B)

HOLD FOR TPH

ANALYSIS REQUEST

CLORIDE

PLEASE NOTE: Liability and Damages. Cardinal's liability and client's exclusive remedy for any claim arising whether based in contract or tort, shall be limited to the amount paid by the client for the analyses. All claims including those for negligence and any other cause whatsoever shall be deemed waived unless made in writing and received by Cardinal within 30 days after completion of the applicable service. In no event shall Cardinal be liable for incidental or consequential damages, including without limitation, business interruptions, loss of use, or loss of profits incurred by client, its subsidiaries, affiliates or successors arising out of or related to the performance of services hereunder by Cardinal, regardless of whether such claim is based upon any of the above stated reasons or otherwise.

Relinquished By:

Date:

Received By:

Phone Result:

Fax Result:

REMARKS:

Relinquished By:

Date:

Received By:

Phone Result:

Fax Result:

REMARKS:

Delivered By: (Circle One)

Date:

Received By:

Phone Result:

Fax Result:

REMARKS:

Sampler - UPS - Bus - Other:

Date:

Received By:

Phone Result:

Fax Result:

REMARKS:

Sample Condition

CHECKED BY:

Sample Condition
☒ Yes ☐ No
Cool ☒ Yes ☐ No
Intact ☒ Yes ☐ No

HOLD FOR TPH

Please email results to pm@basinenv.com,
TASavoie@BassPet.com & SJWalters@BassPet.com

FORM-006

Revision 1.0

† Cardinal cannot accept verbal changes. Please fax written changes to 575-393-2476

June 20, 2014

BEN J. ARGUIJO

Basin Environmental Service

P.O. Box 301

Lovington, NM 88260

RE: JRU #124 TANK BATTERY

Enclosed are the results of analyses for samples received by the laboratory on 06/17/14 8:50.

Cardinal Laboratories is accredited through Texas NELAP under certificate number T104704398-13-5. Accreditation applies to drinking water, non-potable water and solid and chemical materials. All accredited analytes are denoted by an asterisk (*). For a complete list of accredited analytes and matrices visit the TCEQ website at www.tceq.texas.gov/field/qa/lab_accred_certif.html.

Cardinal Laboratories is accredited through the State of Colorado Department of Public Health and Environment for:

Method EPA 552.2	Haloacetic Acids (HAA-5)
Method EPA 524.2	Total Trihalomethanes (TTHM)
Method EPA 524.4	Regulated VOCs (V1, V2, V3)

Accreditation applies to public drinking water matrices.

This report meets NELAP requirements and is made up of a cover page, analytical results, and a copy of the original chain-of-custody. If you have any questions concerning this report, please feel free to contact me.

Sincerely,



Celey D. Keene

Lab Director/Quality Manager

Analytical Results For:

Basin Environmental Service
BEN J. ARGUIJO
P.O. Box 301
Lovington NM, 88260
Fax To: (575) 396-1429

Received: 06/17/2014
Reported: 06/20/2014
Project Name: JRU #124 TANK BATTERY
Project Number: NONE GIVEN
Project Location: EDDY COUNTY, NM

Sampling Date: 06/13/2014
Sampling Type: Soil
Sampling Condition: Cool & Intact
Sample Received By: Jodi Henson

Sample ID: NSW #1 (H401831-01)

Chloride, SM4500Cl-B		mg/kg		Analyzed By: HM					
Analyte	Result	Reporting Limit	Analyzed	Method Blank	BS	% Recovery	True Value QC	RPD	Qualifier
Chloride	112	16.0	06/18/2014	ND	416	104	400	0.00	

Sample ID: NSW #2 (H401831-02)

Chloride, SM4500Cl-B		mg/kg		Analyzed By: HM					
Analyte	Result	Reporting Limit	Analyzed	Method Blank	BS	% Recovery	True Value QC	RPD	Qualifier
Chloride	80.0	16.0	06/18/2014	ND	416	104	400	0.00	

Sample ID: NSW #3 (H401831-03)

Chloride, SM4500Cl-B		mg/kg		Analyzed By: HM					
Analyte	Result	Reporting Limit	Analyzed	Method Blank	BS	% Recovery	True Value QC	RPD	Qualifier
Chloride	416	16.0	06/18/2014	ND	400	100	400	0.00	

Sample ID: ESW #1 (H401831-04)

Chloride, SM4500Cl-B		mg/kg		Analyzed By: HM					
Analyte	Result	Reporting Limit	Analyzed	Method Blank	BS	% Recovery	True Value QC	RPD	Qualifier
Chloride	80.0	16.0	06/18/2014	ND	400	100	400	0.00	

Cardinal Laboratories

*=Accredited Analyte

PLEASE NOTE: Liability and Damages. Cardinal's liability and client's exclusive remedy for any claim arising, whether based in contract or tort, shall be limited to the amount paid by client for analyses. All claims, including those for negligence and any other cause whatsoever shall be deemed waived unless made in writing and received by Cardinal within thirty (30) days after completion of the applicable service. In no event shall Cardinal be liable for incidental or consequential damages, including, without limitation, business interruptions, loss of use, or loss of profits incurred by client, its subsidiaries, affiliates or successors arising out of or related to the performance of the services hereunder by Cardinal, regardless of whether such claim is based upon any of the above stated reasons or otherwise. Results relate only to the samples identified above. This report shall not be reproduced except in full with written approval of Cardinal Laboratories.



Celey D. Keene, Lab Director/Quality Manager

Analytical Results For:

Basin Environmental Service
BEN J. ARGUIJO
P.O. Box 301
Lovington NM, 88260
Fax To: (575) 396-1429

Received:	06/17/2014	Sampling Date:	06/13/2014
Reported:	06/20/2014	Sampling Type:	Soil
Project Name:	JRU #124 TANK BATTERY	Sampling Condition:	Cool & Intact
Project Number:	NONE GIVEN	Sample Received By:	Jodi Henson
Project Location:	EDDY COUNTY, NM		

Sample ID: ESW #2 (H401831-05)

Chloride, SM4500Cl-B		mg/kg		Analyzed By: HM						
Analyte	Result	Reporting Limit	Analyzed	Method Blank	BS	% Recovery	True Value QC	RPD	Qualifier	
Chloride	336	16.0	06/18/2014	ND	400	100	400	0.00		

Sample ID: WSW #3 (H401831-06)

Chloride, SM4500Cl-B		mg/kg		Analyzed By: HM						
Analyte	Result	Reporting Limit	Analyzed	Method Blank	BS	% Recovery	True Value QC	RPD	Qualifier	
Chloride	32.0	16.0	06/18/2014	ND	400	100	400	0.00		

Cardinal Laboratories

*=Accredited Analyte

PLEASE NOTE: Liability and Damages. Cardinal's liability and client's exclusive remedy for any claim arising, whether based in contract or tort, shall be limited to the amount paid by client for analyses. All claims, including those for negligence and any other cause whatsoever shall be deemed waived unless made in writing and received by Cardinal within thirty (30) days after completion of the applicable service. In no event shall Cardinal be liable for incidental or consequential damages, including, without limitation, business interruptions, loss of use, or loss of profits incurred by client, its subsidiaries, affiliates or successors arising out of or related to the performance of the services hereunder by Cardinal, regardless of whether such claim is based upon any of the above stated reasons or otherwise. Results relate only to the samples identified above. This report shall not be reproduced except in full with written approval of Cardinal Laboratories.



Celey D. Keene, Lab Director/Quality Manager

Analytical Results For:

Basin Environmental Service
BEN J. ARGUIJO
P.O. Box 301
Lovington NM, 88260
Fax To: (575) 396-1429

Received: 06/17/2014
Reported: 06/20/2014
Project Name: JRU #124 TANK BATTERY
Project Number: NONE GIVEN
Project Location: EDDY COUNTY, NM

Sampling Date: 06/13/2014
Sampling Type: Soil
Sampling Condition: Cool & Intact
Sample Received By: Jodi Henson

Sample ID: MIDDLE FLOOR #3 (H401831-07)

BTEx 8021B		mg/kg		Analyzed By: CK					
Analyte	Result	Reporting Limit	Analyzed	Method Blank	BS	% Recovery	True Value QC	RPD	Qualifier
Benzene*	<0.050	0.050	06/18/2014	ND	2.10	105	2.00	0.112	
Toluene*	<0.050	0.050	06/18/2014	ND	2.25	112	2.00	0.494	
Ethylbenzene*	<0.050	0.050	06/18/2014	ND	2.04	102	2.00	0.631	
Total Xylenes*	<0.150	0.150	06/18/2014	ND	6.31	105	6.00	1.19	
Total BTEx	<0.300	0.300	06/18/2014	ND					

Surrogate: 4-Bromofluorobenzene (PID) 114 % 89.4-126

Chloride, SM4500Cl-B		mg/kg		Analyzed By: HM					
Analyte	Result	Reporting Limit	Analyzed	Method Blank	BS	% Recovery	True Value QC	RPD	Qualifier
Chloride	224	16.0	06/18/2014	ND	400	100	400	0.00	

TPH 8015M		mg/kg		Analyzed By: MS					
Analyte	Result	Reporting Limit	Analyzed	Method Blank	BS	% Recovery	True Value QC	RPD	Qualifier
GRO C6-C10	<10.0	10.0	06/20/2014	ND	174	86.9	200	2.32	
DRO >C10-C28	<10.0	10.0	06/20/2014	ND	208	104	200	4.18	
EXT DRO >C28-C35	<10.0	10.0	06/20/2014	ND					

Surrogate: 1-Chlorooctane 96.9 % 65.2-140

Surrogate: 1-Chlorooctadecane 105 % 63.6-154

Cardinal Laboratories

*=Accredited Analyte

PLEASE NOTE: Liability and Damages. Cardinal's liability and client's exclusive remedy for any claim arising, whether based in contract or tort, shall be limited to the amount paid by client for analyses. All claims, including those for negligence and any other cause whatsoever shall be deemed waived unless made in writing and received by Cardinal within thirty (30) days after completion of the applicable service. In no event shall Cardinal be liable for incidental or consequential damages, including, without limitation, business interruptions, loss of use, or loss of profits incurred by client, its subsidiaries, affiliates or successors arising out of or related to the performance of the services hereunder by Cardinal, regardless of whether such claim is based upon any of the above stated reasons or otherwise. Results relate only to the samples identified above. This report shall not be reproduced except in full with written approval of Cardinal Laboratories.



Celey D. Keene, Lab Director/Quality Manager

Analytical Results For:

 Basin Environmental Service
 BEN J. ARGUIJO
 P.O. Box 301
 Lovington NM, 88260
 Fax To: (575) 396-1429

 Received: 06/17/2014
 Reported: 06/20/2014
 Project Name: JRU #124 TANK BATTERY
 Project Number: NONE GIVEN
 Project Location: EDDY COUNTY, NM

 Sampling Date: 06/13/2014
 Sampling Type: Soil
 Sampling Condition: Cool & Intact
 Sample Received By: Jodi Henson

Sample ID: N. FLOOR #1 (H401831-08)

BTEx 8021B		mg/kg		Analyzed By: CK					
Analyte	Result	Reporting Limit	Analyzed	Method Blank	BS	% Recovery	True Value QC	RPD	Qualifier
Benzene*	<0.050	0.050	06/18/2014	ND	2.10	105	2.00	0.112	
Toluene*	<0.050	0.050	06/18/2014	ND	2.25	112	2.00	0.494	
Ethylbenzene*	<0.050	0.050	06/18/2014	ND	2.04	102	2.00	0.631	
Total Xylenes*	<0.150	0.150	06/18/2014	ND	6.31	105	6.00	1.19	
Total BTEx	<0.300	0.300	06/18/2014	ND					

Surrogate: 4-Bromofluorobenzene (PID) 114 % 89.4-126

Chloride, SM4500CI-B		mg/kg		Analyzed By: HM					
Analyte	Result	Reporting Limit	Analyzed	Method Blank	BS	% Recovery	True Value QC	RPD	Qualifier
Chloride	112	16.0	06/18/2014	ND	400	100	400	0.00	

TPH 8015M		mg/kg		Analyzed By: MS					
Analyte	Result	Reporting Limit	Analyzed	Method Blank	BS	% Recovery	True Value QC	RPD	Qualifier
GRO C6-C10	<10.0	10.0	06/20/2014	ND	174	86.9	200	2.32	
DRO >C10-C28	<10.0	10.0	06/20/2014	ND	208	104	200	4.18	
EXT DRO >C28-C35	<10.0	10.0	06/20/2014	ND					

Surrogate: 1-Chlorooctane 95.6 % 65.2-140

Surrogate: 1-Chlorooctadecane 103 % 63.6-154

Cardinal Laboratories

*=Accredited Analyte

PLEASE NOTE: Liability and Damages. Cardinal's liability and client's exclusive remedy for any claim arising, whether based in contract or tort, shall be limited to the amount paid by client for analyses. All claims, including those for negligence and any other cause whatsoever shall be deemed waived unless made in writing and received by Cardinal within thirty (30) days after completion of the applicable service. In no event shall Cardinal be liable for incidental or consequential damages, including, without limitation, business interruptions, loss of use, or loss of profits incurred by client, its subsidiaries, affiliates or successors arising out of or related to the performance of the services hereunder by Cardinal, regardless of whether such claim is based upon any of the above stated reasons or otherwise. Results relate only to the samples identified above. This report shall not be reproduced except in full with written approval of Cardinal Laboratories.



Celey D. Keene, Lab Director/Quality Manager

Analytical Results For:

Basin Environmental Service
BEN J. ARGUIJO
P.O. Box 301
Lovington NM, 88260
Fax To: (575) 396-1429

Received: 06/17/2014
Reported: 06/20/2014
Project Name: JRU #124 TANK BATTERY
Project Number: NONE GIVEN
Project Location: EDDY COUNTY, NM

Sampling Date: 06/13/2014
Sampling Type: Soil
Sampling Condition: Cool & Intact
Sample Received By: Jodi Henson

Sample ID: N. FLOOR #2 (H401831-09)

BTEx 8021B		mg/kg		Analyzed By: CK						
Analyte	Result	Reporting Limit	Analyzed	Method Blank	BS	% Recovery	True Value QC	RPD	Qualifier	
Benzene*	<0.050	0.050	06/18/2014	ND	2.10	105	2.00	0.112		
Toluene*	<0.050	0.050	06/18/2014	ND	2.25	112	2.00	0.494		
Ethylbenzene*	<0.050	0.050	06/18/2014	ND	2.04	102	2.00	0.631		
Total Xylenes*	<0.150	0.150	06/18/2014	ND	6.31	105	6.00	1.19		
Total BTEx	<0.300	0.300	06/18/2014	ND						

Surrogate: 4-Bromofluorobenzene (PID) 112 % 89.4-126

Chloride, SM4500Cl-B		mg/kg		Analyzed By: HM					
Analyte	Result	Reporting Limit	Analyzed	Method Blank	BS	% Recovery	True Value QC	RPD	Qualifier
Chloride	160	16.0	06/18/2014	ND	400	100	400	0.00	

TPH 8015M		mg/kg		Analyzed By: MS					
Analyte	Result	Reporting Limit	Analyzed	Method Blank	BS	% Recovery	True Value QC	RPD	Qualifier
GRO C6-C10	<10.0	10.0	06/20/2014	ND	174	86.9	200	2.32	
DRO >C10-C28	<10.0	10.0	06/20/2014	ND	208	104	200	4.18	
EXT DRO >C28-C35	<10.0	10.0	06/20/2014	ND					

Surrogate: 1-Chlorooctane 102 % 65.2-140

Surrogate: 1-Chlorooctadecane 106 % 63.6-154

Cardinal Laboratories

*=Accredited Analyte

PLEASE NOTE: Liability and Damages. Cardinal's liability and client's exclusive remedy for any claim arising, whether based in contract or tort, shall be limited to the amount paid by client for analyses. All claims, including those for negligence and any other cause whatsoever shall be deemed waived unless made in writing and received by Cardinal within thirty (30) days after completion of the applicable service. In no event shall Cardinal be liable for incidental or consequential damages, including, without limitation, business interruptions, loss of use, or loss of profits incurred by client, its subsidiaries, affiliates or successors arising out of or related to the performance of the services hereunder by Cardinal, regardless of whether such claim is based upon any of the above stated reasons or otherwise. Results relate only to the samples identified above. This report shall not be reproduced except in full with written approval of Cardinal Laboratories.



Celey D. Keene, Lab Director/Quality Manager

Analytical Results For:

 Basin Environmental Service
 BEN J. ARGUIJO
 P.O. Box 301
 Lovington NM, 88260
 Fax To: (575) 396-1429

 Received: 06/17/2014
 Reported: 06/20/2014
 Project Name: JRU #124 TANK BATTERY
 Project Number: NONE GIVEN
 Project Location: EDDY COUNTY, NM

 Sampling Date: 06/13/2014
 Sampling Type: Soil
 Sampling Condition: Cool & Intact
 Sample Received By: Jodi Henson

Sample ID: N. FLOOR #3 (H401831-10)

BTX 8021B		mg/kg		Analyzed By: CK					
Analyte	Result	Reporting Limit	Analyzed	Method Blank	BS	% Recovery	True Value QC	RPD	Qualifier
Benzene*	<0.050	0.050	06/18/2014	ND	2.10	105	2.00	0.112	
Toluene*	<0.050	0.050	06/18/2014	ND	2.25	112	2.00	0.494	
Ethylbenzene*	<0.050	0.050	06/18/2014	ND	2.04	102	2.00	0.631	
Total Xylenes*	<0.150	0.150	06/18/2014	ND	6.31	105	6.00	1.19	
Total BTX	<0.300	0.300	06/18/2014	ND					

Surrogate: 4-Bromofluorobenzene (PID) 111 % 89.4-126

Chloride, SM4500Cl-B		mg/kg		Analyzed By: HM					
Analyte	Result	Reporting Limit	Analyzed	Method Blank	BS	% Recovery	True Value QC	RPD	Qualifier
Chloride	240	16.0	06/18/2014	ND	400	100	400	0.00	

TPH 8015M		mg/kg		Analyzed By: MS					
Analyte	Result	Reporting Limit	Analyzed	Method Blank	BS	% Recovery	True Value QC	RPD	Qualifier
GRO C6-C10	<10.0	10.0	06/20/2014	ND	174	86.9	200	2.32	
DRO >C10-C28	<10.0	10.0	06/20/2014	ND	208	104	200	4.18	
EXT DRO >C28-C35	<10.0	10.0	06/20/2014	ND					

Surrogate: 1-Chlorooctane 100 % 65.2-140

Surrogate: 1-Chlorooctadecane 103 % 63.6-154

Cardinal Laboratories

*=Accredited Analyte

PLEASE NOTE: Liability and Damages. Cardinal's liability and client's exclusive remedy for any claim arising, whether based in contract or tort, shall be limited to the amount paid by client for analyses. All claims, including those for negligence and any other cause whatsoever shall be deemed waived unless made in writing and received by Cardinal within thirty (30) days after completion of the applicable service. In no event shall Cardinal be liable for incidental or consequential damages, including, without limitation, business interruptions, loss of use, or loss of profits incurred by client, its subsidiaries, affiliates or successors arising out of or related to the performance of the services hereunder by Cardinal, regardless of whether such claim is based upon any of the above stated reasons or otherwise. Results relate only to the samples identified above. This report shall not be reproduced except in full with written approval of Cardinal Laboratories.



Celey D. Keene, Lab Director/Quality Manager

Notes and Definitions

ND	Analyte NOT DETECTED at or above the reporting limit
RPD	Relative Percent Difference
**	Samples not received at proper temperature of 6°C or below.
***	Insufficient time to reach temperature.
-	Chloride by SM4500Cl-B does not require samples be received at or below 6°C Samples reported on an as received basis (wet) unless otherwise noted on report

Cardinal Laboratories

*=Accredited Analyte

PLEASE NOTE: Liability and Damages. Cardinal's liability and client's exclusive remedy for any claim arising, whether based in contract or tort, shall be limited to the amount paid by client for analyses. All claims, including those for negligence and any other cause whatsoever shall be deemed waived unless made in writing and received by Cardinal within thirty (30) days after completion of the applicable service. In no event shall Cardinal be liable for incidental or consequential damages, including, without limitation, business interruptions, loss of use, or loss of profits incurred by client, its subsidiaries, affiliates or successors arising out of or related to the performance of the services hereunder by Cardinal, regardless of whether such claim is based upon any of the above stated reasons or otherwise. Results relate only to the samples identified above. This report shall not be reproduced except in full with written approval of Cardinal Laboratories.



Celey D. Keene, Lab Director/Quality Manager

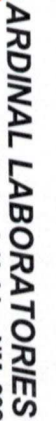

101 East Marland, Hobbs, NM 88240
(575) 393-2326 FAX (575) 393-2476

BILL TO

Sample	Condition
Cool	Intact
<input checked="" type="checkbox"/> Yes	<input checked="" type="checkbox"/> Yes
<input type="checkbox"/> No	<input type="checkbox"/> No

+ Cardinal cannot accept verbal changes. Please fax written changes to 575-393-2476