



Lupe Carrasco
Environmental Coordinator

August 15, 2014

Oil Conservation Division
District 2 – Artesia
811 S. First St.
Artesia, NM 88210

Re: Foster Eddy #014
30-015-37136
Sec. 17, T17S-R31E
Eddy County, NM

Mr. Mike Bratcher,

COG Operating LLC would like to submit the enclosed documents for closure of the Foster Eddy #014 release reported on the C-141 Initial submitted January 2, 2014.

The release was due to a stuffing box failure on the wellhead causing a release of 12 B/O and 3 B/PW of which 11 B/O and 2 B/PW were recovered. All fluids remained on the location. The impacted area was scraped and all impacted soil was hauled to a NMOCD approved facility for disposal.

The release area was sampled at depths of 1' and 3' for S1 and S2. S2 was sampled further to a depth of 6' for chloride delineation. Sample results for TPH and BTEX levels are non-detect for the release area. An attached site diagram depicts the release area along with approximate sample points and a table summarizing the analytical results.

A signed C-141 Final is enclosed for your consideration. Please feel free to contact me with any further questions or concerns at (575) 748-6933.

Sincerely,

A handwritten signature in black ink, appearing to read "Lupe Carrasco".

Lupe Carrasco
Environmental Coordinator

Enclosed: Site Diagram
Analytical Results
C-141 Initial (Copy)
C-141 Final

August 15, 2014

Foster Eddy #014





Section 17, T17S-R31E

December 31, 2013

Released: 12 B/O, 3 B/PW

Recovered: 11 B/O, 2 B/PW

Legend

-  Feature 1
-  Foster Eddy

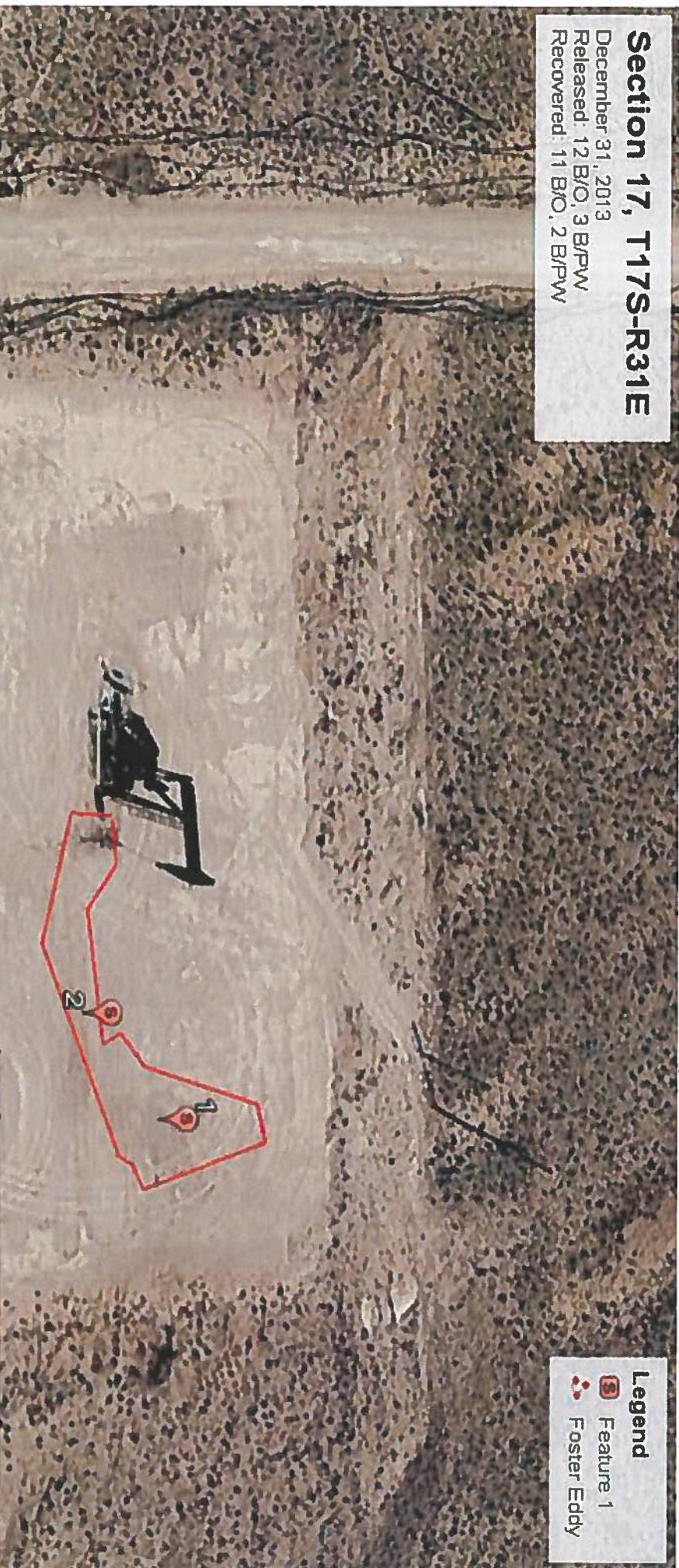

Site Ranking: Zero

Depth to GW per Trend Map: ~325'

S1	DRO	GRO	TPH	BTEX	Cl-
1'	ND	ND	ND	ND	1920
3'					16
S2	DRO	GRO	TPH	BTEX	Cl-
1'	ND	ND	ND	ND	448
3'					2360
6'					32

Bold values exceed RRALs per NMOCD Guidelines (1993)

Google earth

200+ GPM

100 ft





PHONE (575) 393-2326 • 101 E. MARLAND • HOBBS, NM 88240

August 01, 2014

LUPE CARRASCO
COG OPERATING
P. O. BOX 1630
ARTESIA, NM 88210

RE: FOSTER EDDY #14

Enclosed are the results of analyses for samples received by the laboratory on 07/25/14 15:15.

Cardinal Laboratories is accredited through Texas NELAP under certificate number T104704398-13-5. Accreditation applies to drinking water, non-potable water and solid and chemical materials. All accredited analytes are denoted by an asterisk (*). For a complete list of accredited analytes and matrices visit the TCEQ website at www.tceq.texas.gov/field/ga/lab_accred_certif.html.

Cardinal Laboratories is accredited through the State of Colorado Department of Public Health and Environment for:

Method EPA 552.2	Haloacetic Acids (HAA-5)
Method EPA 524.2	Total Trihalomethanes (TTHM)
Method EPA 524.4	Regulated VOCs (V1, V2, V3)

Accreditation applies to public drinking water matrices.

This report meets NELAP requirements and is made up of a cover page, analytical results, and a copy of the original chain-of-custody. If you have any questions concerning this report, please feel free to contact me.

Sincerely,

Hope S. Moreno For Celey D. Keene
Lab Director/Quality Manager

Analytical Results For:

COG OPERATING
LUPE CARRASCO
P. O. BOX 1630
ARTESIA NM, 88210
Fax To: NONE

Received: 07/25/2014
Reported: 08/01/2014
Project Name: FOSTER EDDY #14
Project Number: NONE GIVEN
Project Location: NOT GIVEN

Sampling Date: 07/25/2014
Sampling Type: Soil
Sampling Condition: Cool & Intact
Sample Received By: Jodi Henson

Sample ID: S1 1' (H402293-01)

BTEX 8021B			mg/ kg		Analyzed By: MS				
Analyte	Result	Reporting Limit	Analyzed	Method Blank	BS	% Recovery	True Value QC	RPD	Qualifier
Benzene*	<0.050	0.050	07/29/2014	ND	1.96	98.1	2.00	7.18	
Toluene*	<0.050	0.050	07/29/2014	ND	2.00	100	2.00	6.57	
Ethylbenzene*	<0.050	0.050	07/29/2014	ND	2.02	101	2.00	6.74	
Total Xylenes*	<0.150	0.150	07/29/2014	ND	6.09	102	6.00	6.61	
Total BTEX	<0.300	0.300	07/29/2014	ND					

Surrogate: 4-Bromofluorobenzene (PIC) 122 % 89.4-126

Chloride, SM4500Cl-B			mg/kg		Analyzed By: AP					
Analyte	Result	Reporting Limit	Analyzed	Method Blank	BS	% Recovery	True Value QC	RPD	Qualifier	
Chloride	1920	16.0	07/31/2014	ND	416	104	400	3.77		

TPH 8015M		mg/kg		Analyzed By: MS					
Analyte	Result	Reporting Limit	Analyzed	Method Blank	BS	% Recovery	True Value QC	RPD	Qualifier
GRO C6-C10	<10.0	10.0	07/28/2014	ND	171	85.6	200	0.932	
DRO >C10-C28	<10.0	10.0	07/28/2014	ND	178	89.0	200	3.57	

Surrogate: 1-Chlorooctane 133 % 65.2-140

Surrogate: 1-Chlorooctadecane 144 % 63.6-154

Sample ID: S1 3' (H402293-02)

Chloride, SM4500Cl-B			mg/kg		Analyzed By: AP					
Analyte	Result	Reporting Limit	Analyzed	Method Blank	BS	% Recovery	True Value QC	RPD	Qualifier	
Chloride	16.0	16.0	07/31/2014	ND	416	104	400	3.77		

Cardinal Laboratories

*=Accredited Analyte

PLEASE NOTE: Liability and Damages. Cardinal's liability and client's exclusive remedy for any claim arising, whether based in contract or tort, shall be limited to the amount paid by client for analyses. All claims, including those for negligence and any other cause whatsoever shall be deemed waived unless made in writing and received by Cardinal within thirty (30) days after completion of the applicable service. In no event shall Cardinal be liable for incidental or consequential damages, including, without limitation, business interruptions, loss of use, or loss of profits incurred by client, its subsidiaries, affiliates or successors arising out of or related to the performance of the services hereunder by Cardinal, regardless of whether such claim is based upon any of the above stated reasons or otherwise. Results relate only to the samples identified above. This report shall not be reproduced except in full with written approval of Cardinal Laboratories.



Hope S. Moreno For Celey D. Keene, Lab Director/Quality Manager

Analytical Results For:

COG OPERATING
LUPE CARRASCO
P. O. BOX 1630
ARTESIA NM, 88210
Fax To: NONE

Received: 07/25/2014
Reported: 08/01/2014
Project Name: FOSTER EDDY #14
Project Number: NONE GIVEN
Project Location: NOT GIVEN

Sampling Date: 07/25/2014
Sampling Type: Soil
Sampling Condition: Cool & Intact
Sample Received By: Jodi Henson

Sample ID: S2 1' (H402293-03)

BTEX 8021B			mg/kg		Analyzed By: MS				
Analyte	Result	Reporting Limit	Analyzed	Method Blank	BS	% Recovery	True Value QC	RPD	Qualifier
Benzene*	<0.050	0.050	07/29/2014	ND	1.96	98.1	2.00	7.18	
Toluene*	<0.050	0.050	07/29/2014	ND	2.00	100	2.00	6.57	
Ethylbenzene*	<0.050	0.050	07/29/2014	ND	2.02	101	2.00	6.74	
Total Xylenes*	<0.150	0.150	07/29/2014	ND	6.09	102	6.00	6.61	
Total BTEX	<0.300	0.300	07/29/2014	ND					

Surrogate: 4-Bromofluorobenzene (PIE) 123 % 89.4-126

Chloride, SM4500Cl-B		mg/kg		Analyzed By: AP					
Analyte	Result	Reporting Limit	Analyzed	Method Blank	BS	% Recovery	True Value QC	RPD	Qualifier
Chloride	448	16.0	07/31/2014	ND	416	104	400	3.77	

TPH 8015M		mg/kg		Analyzed By: MS					
Analyte	Result	Reporting Limit	Analyzed	Method Blank	BS	% Recovery	True Value QC	RPD	Qualifier
GRO C6-C10	<10.0	10.0	07/28/2014	ND	171	85.6	200	0.932	
DRO >C10-C28	<10.0	10.0	07/28/2014	ND	178	89.0	200	3.57	

Surrogate: 1-Chlorooctane 116 % 65.2-140

Surrogate: 1-Chlorooctadecane 124 % 63.6-154

Sample ID: S2 3' (H402293-04)

Chloride, SM4500Cl-B			mg/kg		Analyzed By: AP				
Analyte	Result	Reporting Limit	Analyzed	Method Blank	BS	% Recovery	True Value QC	RPD	Qualifier
Chloride	2360	16.0	07/31/2014	ND	416	104	400	3.77	

Cardinal Laboratories

*=Accredited Analyte

PLEASE NOTE: Liability and Damages. Cardinal's liability and client's exclusive remedy for any claim arising, whether based in contract or tort, shall be limited to the amount paid by client for analyses. All claims, including those for negligence and any other cause whatsoever shall be deemed waived unless made in writing and received by Cardinal within thirty (30) days after completion of the applicable service. In no event shall Cardinal be liable for incidental or consequential damages, including, without limitation, business interruptions, loss of use, or loss of profits incurred by client, its subsidiaries, affiliates or successors arising out of or related to the performance of the services hereunder by Cardinal, regardless of whether such claim is based upon any of the above stated reasons or otherwise. Results relate only to the samples identified above. This report shall not be reproduced except in full with written approval of Cardinal Laboratories.



Hope S. Moreno For Celey D. Keene, Lab Director/Quality Manager

Notes and Definitions

S-04	The surrogate recovery for this sample is outside of established control limits due to a sample matrix effect.
QM-4X	The spike recovery was outside of QC acceptance limits for the MS and/or MSD due to analyte concentration at 4 times or greater the spike concentration. The QC batch was accepted based on LCS and/or LCSD recoveries within the acceptance limits.
ND	Analyte NOT DETECTED at or above the reporting limit
RPD	Relative Percent Difference
**	Samples not received at proper temperature of 6°C or below.
***	Insufficient time to reach temperature.
-	Chloride by SM4500Cl-B does not require samples be received at or below 6°C Samples reported on an as received basis (wet) unless otherwise noted on report

Cardinal Laboratories

*=Accredited Analyte

PLEASE NOTE: Liability and Damages. Cardinal's liability and client's exclusive remedy for any claim arising, whether based in contract or tort, shall be limited to the amount paid by client for analyses. All claims, including those for negligence and any other cause whatsoever shall be deemed waived unless made in writing and received by Cardinal within thirty (30) days after completion of the applicable service. In no event shall Cardinal be liable for incidental or consequential damages, including, without limitation, business interruptions, loss of use, or loss of profits incurred by client, its subsidiaries, affiliates or successors arising out of or related to the performance of the services hereunder by Cardinal, regardless of whether such claim is based upon any of the above stated reasons or otherwise. Results relate only to the samples identified above. This report shall not be reproduced except in full with written approval of Cardinal Laboratories.

Hope S. Moreno

Hope S. Moreno For Celey D. Keene, Lab Director/Quality Manager



101 East Marland, Hobbs, NM 88240
(575) 393-2326 FAX (575) 393-2476

CHAIN-OF-CUSTODY AND ANALYSIS REQUEST

Company Name: COG Operating LLC

Project Manager: Lupe Carrasco

Address: 2208 West Main

City: Artesia

State: NM Zip: 88210

Phone #: (575) 748-6940

Fax #:

Project Name: Foster Eddy #14

Project Location:

Sampler Name: Lupe Carrasco

FOR LAB USE ONLY

P.O. #:

Company: COG Operating LLC

Attn: Robert McNeill

Address: 600 W Illinois

City: Midland

State: TX Zip: 79701

Phone #: (432) 221-0388

Fax #:

BILL TO

ANALYSIS REQUEST

Lab I.D.

Sample I.D.

(G)RAB OR (C)OMP

CONTAINERS

GROUNDWATER

WASTEWATER

SOIL

OIL

SLUDGE

OTHER

ACID/BASE

ICE / COOL

OTHER

DATE

TIME

BTEX

TPH

Chloride

1 S1-1'
2 S1-3'
3 S2-1'
4 S2-3'

7/25/14

7/25/14

7/25/14

X

X

X

X

X

X

X

X

X

X

X

X

X

X

X

PLEASE NOTE: Liability and Damages: Cardinal's liability and client's exclusive remedy for any claim arising whether based in contract or tort, shall be limited to the amount paid by the client for the analysis. All claims including those for negligence and any other cause whatsoever shall be deemed waived unless made in writing and received by Cardinal within 30 days after completion of the applicable service. In no event shall Cardinal be liable for incidental or consequential damages, including without limitation, business interruptions, loss of use, or loss of profits incurred by client, its subsidiaries, affiliates or successors arising out of or related to the performance of services hereunder by Cardinal, regardless of whether such claim is based upon any of the above stated reasons or otherwise.

Relinquished By:

Date: 7/25/14

Received By:

Phone Result:

Yes

No

Add'l Phone #:

Fax Result:

Yes

No

Add'l Fax #:

REMARKS:

gcarrasco@concho.com

Relinquished By:

Date: 7/25/14

Received By:

Phone Result:

Yes

No

Add'l Phone #:

Fax Result:

Yes

No

Add'l Fax #:

REMARKS:

gcarrasco@concho.com

Delivered By: (Circle One)

Sampler - UPS - Bus - Other:

4.80

Sample Condition
Cool ☒ Intact ☒
Yes ☒ No ☐

CHECKED BY:

Phone Result:

Yes

No

Add'l Phone #:

Fax Result:

Yes

No

Add'l Fax #:

REMARKS:

gcarrasco@concho.com

† Cardinal cannot accept verbal changes. Please fax written changes to 575-393-2476



PHONE (575) 393-2326 • 101 E. MARLAND • HOBBS, NM 88240

August 12, 2014

LUPE CARRASCO

COG OPERATING

P. O. BOX 1630

ARTESIA, NM 88210

RE: FOSTER EDDY #14

Enclosed are the results of analyses for samples received by the laboratory on 08/06/14 14:30.

Cardinal Laboratories is accredited through Texas NELAP under certificate number T104704398-13-5. Accreditation applies to drinking water, non-potable water and solid and chemical materials. All accredited analytes are denoted by an asterisk (*). For a complete list of accredited analytes and matrices visit the TCEQ website at www.tceq.texas.gov/field/ga/lab_accred_certif.html.

Cardinal Laboratories is accredited through the State of Colorado Department of Public Health and Environment for:

Method EPA 552.2	Haloacetic Acids (HAA-5)
Method EPA 524.2	Total Trihalomethanes (TTHM)
Method EPA 524.4	Regulated VOCs (V1, V2, V3)

Accreditation applies to public drinking water matrices.

This report meets NELAP requirements and is made up of a cover page, analytical results, and a copy of the original chain-of-custody. If you have any questions concerning this report, please feel free to contact me.

Sincerely,

Celey D. Keene

Lab Director/Quality Manager

Analytical Results For:COG OPERATING
LUPE CARRASCO
P. O. BOX 1630
ARTESIA NM, 88210
Fax To: NONEReceived: 08/06/2014
Reported: 08/12/2014
Project Name: FOSTER EDDY #14
Project Number: NONE GIVEN
Project Location: NOT GIVENSampling Date: 07/25/2014
Sampling Type: Soil
Sampling Condition: Cool & Intact
Sample Received By: Kathy Perez**Sample ID: S2-6' (H402424-01)**

Chloride, SM4500Cl-B		mg/kg		Analyzed By: AP					
Analyte	Result	Reporting Limit	Analyzed	Method Blank	BS	% Recovery	True Value QC	RPD	Qualifier
Chloride	32.0	16.0	08/11/2014	ND	400	100	400	0.00	

Cardinal Laboratories

* = Accredited Analyte

PLEASE NOTE: Liability and Damages. Cardinal's liability and client's exclusive remedy for any claim arising, whether based in contract or tort, shall be limited to the amount paid by client for analyses. All claims, including those for negligence and any other cause whatsoever shall be deemed waived unless made in writing and received by Cardinal within thirty (30) days after completion of the applicable service. In no event shall Cardinal be liable for incidental or consequential damages, including, without limitation, business interruptions, loss of use, or loss of profits incurred by client, its subsidiaries, affiliates or successors arising out of or related to the performance of the services hereunder by Cardinal, regardless of whether such claim is based upon any of the above stated reasons or otherwise. Results relate only to the samples identified above. This report shall not be reproduced except in full with written approval of Cardinal Laboratories.



Celey D. Keene, Lab Director/Quality Manager

Notes and Definitions

ND	Analyte NOT DETECTED at or above the reporting limit
RPD	Relative Percent Difference
**	Samples not received at proper temperature of 6°C or below.
***	Insufficient time to reach temperature.
-	Chloride by SM4500Cl-B does not require samples be received at or below 6°C Samples reported on an as received basis (wet) unless otherwise noted on report

Cardinal Laboratories

* = Accredited Analyte

PLEASE NOTE: Liability and Damages. Cardinal's liability and client's exclusive remedy for any claim arising, whether based in contract or tort, shall be limited to the amount paid by client for analyses. All claims, including those for negligence and any other cause whatsoever shall be deemed waived unless made in writing and received by Cardinal within thirty (30) days after completion of the applicable service. In no event shall Cardinal be liable for incidental or consequential damages, including, without limitation, business interruptions, loss of use, or loss of profits incurred by client, its subsidiaries, affiliates or successors arising out of or related to the performance of the services hereunder by Cardinal, regardless of whether such claim is based upon any of the above stated reasons or otherwise. Results relate only to the samples identified above. This report shall not be reproduced except in full with written approval of Cardinal Laboratories.



Celey D. Keene, Lab Director/Quality Manager



(575) 393-2326 FAX (575) 393-2476

Phone Result:	<input type="checkbox"/> Yes	<input type="checkbox"/> No	Add'l Phone #:
Fax Result:	<input type="checkbox"/> Yes	<input type="checkbox"/> No	Add'l Fax #:
REMARKS:	9cattasco@concho.com		

District I
1625 N. French Dr., Hobbs, NM 88240
District II
1301 W. Grand Avenue, Artesia, NM 88210
District III
1000 Rio Brazos Road, Aztec, NM 87410
District IV
1220 S. St. Francis Dr., Santa Fe, NM 87505

State of New Mexico
Energy Minerals and Natural Resources

Oil Conservation Division
1220 South St. Francis Dr.
Santa Fe, NM 87505

Form C-141
Revised October 10, 2003

Submit 2 Copies to appropriate
District Office in accordance
with Rule 116 on back
side of form

Release Notification and Corrective Action

OPERATOR

☒ Initial Report ☐ Final Report

Name of Company	COG OPERATING LLC	Contact	Robert McNeill
Address	600 West Illinois Avenue, Midland, TX 79701	Telephone No.	432-230-0077
Facility Name	Foster Eddy #014	Facility Type	Well Pad
Surface Owner	Federal	Mineral Owner	
		Lease No. (API#)	30-015-37136

LOCATION OF RELEASE

Unit Letter	Section	Township	Range	Feet from the	North/South Line	Feet from the	East/West Line	County
F	17	17S	31E					Eddy

Latitude 32.83705

Longitude 103.89302

NATURE OF RELEASE

Type of Release	Oil and produced water	Volume of Release	12bbls of oil 3bbls of Produced water	Volume Recovered	11bbls of oil 2bbls of produced water
Source of Release	Wellhead	Date and Hour of Occurrence	12-31-2013	Date and Hour of Discovery	12-31-2013 08:30am
Was Immediate Notice Given?	<input type="checkbox"/> Yes <input checked="" type="checkbox"/> No <input checked="" type="checkbox"/> Not Required	If YES, To Whom?			
By Whom?		Date and Hour			
Was a Watercourse Reached?	<input type="checkbox"/> Yes <input checked="" type="checkbox"/> No	If YES, Volume Impacting the Watercourse.			
If a Watercourse was Impacted, Describe Fully.*					
Describe Cause of Problem and Remedial Action Taken.*					
Stuffing box leak. Repacked stuffing box and tightened connections.					
Describe Area Affected and Cleanup Action Taken.*					
Initially 12bbls of oil and 3bbls of water were released from the stuffing box on the wellhead. We were able to recover 11bbls of oil and 2bbls of produced water with a vacuum truck. All free fluids have been recovered. Tetra Tech will sample the spill site area to delineate any possible contamination from the release and we will present a remediation work plan to the NMOCD/BLM for approval prior to any significant remediation work.					
I hereby certify that the information given above is true and complete to the best of my knowledge and understand that pursuant to NMOCD rules and regulations all operators are required to report and/or file certain release notifications and perform corrective actions for releases which may endanger public health or the environment. The acceptance of a C-141 report by the NMOCD marked as "Final Report" does not relieve the operator of liability should their operations have failed to adequately investigate and remediate contamination that pose a threat to ground water, surface water, human health or the environment. In addition, NMOCD acceptance of a C-141 report does not relieve the operator of responsibility for compliance with any other federal, state, or local laws and/or regulations.					
Signature: 		OIL CONSERVATION DIVISION			
Printed Name: Robert Grubbs Jr.		Approved by District Supervisor:			
Title: Senior Environmental Coordinator		Approval Date:		Expiration Date:	
E-mail Address: rgrubbs@concho.com		Conditions of Approval:			Attached <input type="checkbox"/>
Date: 01-02-2014		Phone: 432-661-6601			

* Attach Additional Sheets If Necessary

District I
1625 N. French Dr., Hobbs, NM 88240
District II
1301 W. Grand Avenue, Artesia, NM 88210
District III
1000 Rio Brazos Road, Aztec, NM 87410
District IV
1220 S. St. Francis Dr., Santa Fe, NM 87505

State of New Mexico
Energy Minerals and Natural Resources
Oil Conservation Division
1220 South St. Francis Dr.
Santa Fe, NM 87505

Form C-141
Revised October 10, 2003

Submit 2 Copies to appropriate
District Office in accordance
with Rule 116 on back
side of form

Release Notification and Corrective Action

OPERATOR

☐ Initial Report ☒ Final Report

Name of Company	COG OPERATING LLC	Contact	Robert McNeill
Address	600 West Illinois Avenue, Midland, TX 79701	Telephone No.	432-230-0077
Facility Name	Foster Eddy #014	Facility Type	Well Pad
Surface Owner	Federal	Mineral Owner	
		Lease No. (API#)	30-015-37136

LOCATION OF RELEASE

Unit Letter	Section	Township	Range	Feet from the	North/South Line	Feet from the	East/West Line	County
F	17	17S	31E					Eddy

Latitude 32.83705

Longitude 103.89302

NATURE OF RELEASE

Type of Release	Oil and produced water	Volume of Release	12bbls of oil 3bbls of Produced water	Volume Recovered	11bbls of oil 2bbls of produced water
Source of Release	Wellhead	Date and Hour of Occurrence	12-31-2013	Date and Hour of Discovery	12-31-2013 08:30am
Was Immediate Notice Given?	<input type="checkbox"/> Yes <input checked="" type="checkbox"/> No <input checked="" type="checkbox"/> Not Required	If YES, To Whom?			
By Whom?		Date and Hour			
Was a Watercourse Reached?	<input type="checkbox"/> Yes <input checked="" type="checkbox"/> No	If YES, Volume Impacting the Watercourse.			
If a Watercourse was Impacted, Describe Fully.*					
Describe Cause of Problem and Remedial Action Taken.* Stuffing box leak. Repacked stuffing box and tightened connections.					
Describe Area Affected and Cleanup Action Taken.* Initially 12bbls of oil and 3bbls of water were released from the stuffing box on the wellhead. We were able to recover 11bbls of oil and 2bbls of produced water with a vacuum truck. All free fluids have been recovered. COG Operating, LLC sampled the spill site area to delineate any possible contamination from the release and is submitting this document to NMOCD/BLM for closure of the release.					
I hereby certify that the information given above is true and complete to the best of my knowledge and understand that pursuant to NMOCD rules and regulations all operators are required to report and/or file certain release notifications and perform corrective actions for releases which may endanger public health or the environment. The acceptance of a C-141 report by the NMOCD marked as "Final Report" does not relieve the operator of liability should their operations have failed to adequately investigate and remediate contamination that pose a threat to ground water, surface water, human health or the environment. In addition, NMOCD acceptance of a C-141 report does not relieve the operator of responsibility for compliance with any other federal, state, or local laws and/or regulations.					
Signature: 		OIL CONSERVATION DIVISION			
Printed Name: Lupe Carrasco		Approved by District Supervisor:			
Title: Environmental Coordinator		Approval Date:		Expiration Date:	
E-mail Address: gcarrasco@concho.com		Conditions of Approval:			Attached <input type="checkbox"/>
Date: 8/18/2014		Phone: 575-748-2010			

* Attach Additional Sheets If Necessary