

Figures

Initial Sampling Data

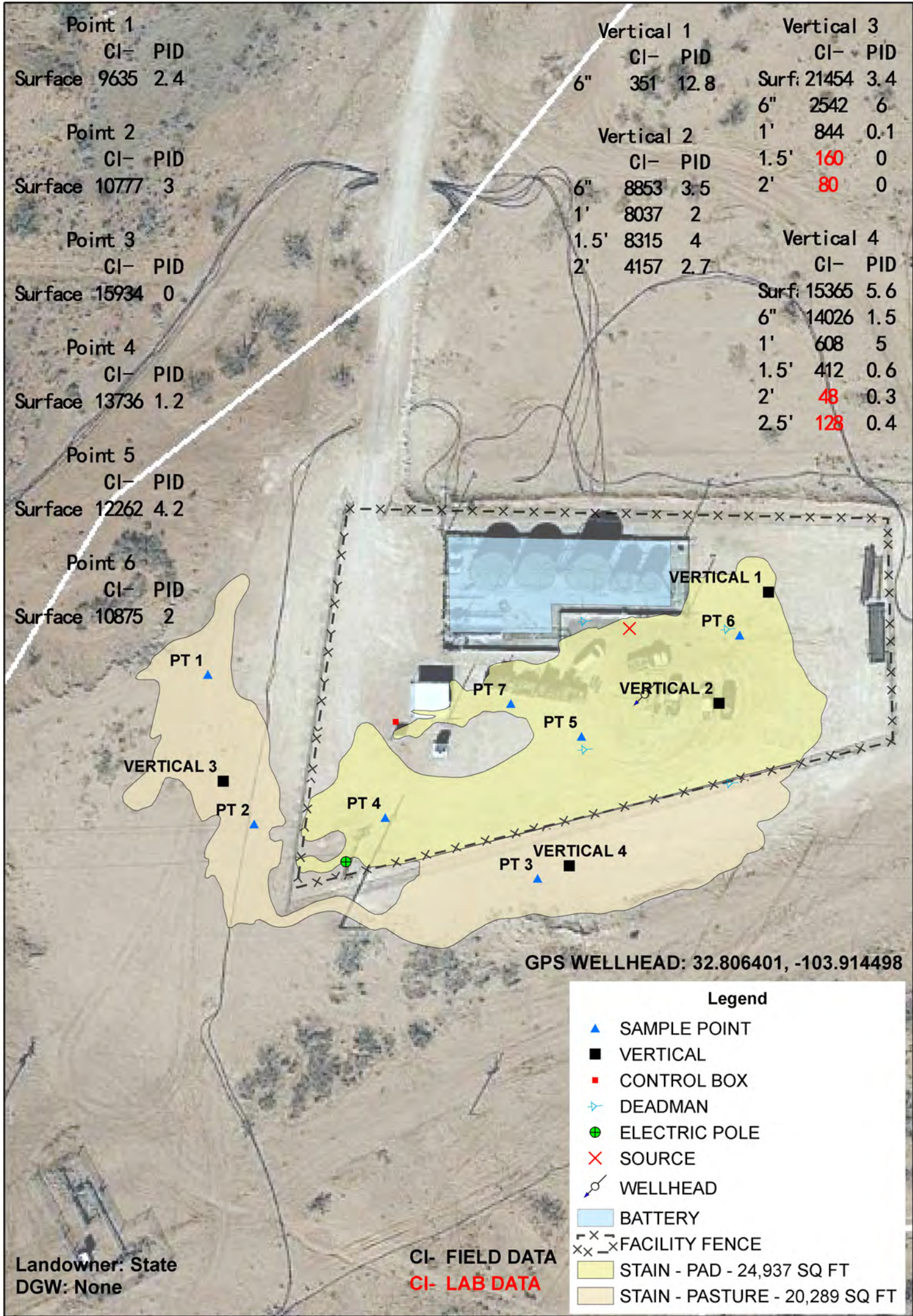

**APACHE
STATE SWD #3**
UL E SECTION 30
T-17-S R-31-E
EDDY COUNTY, NM

Figure 1

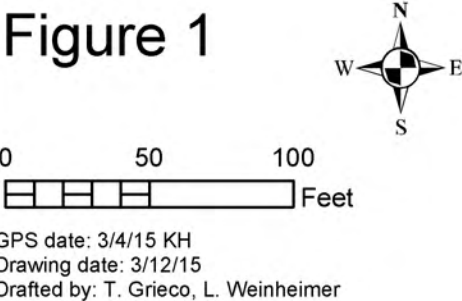

Excavation Data

Final Sampling Data

	CI-	PID
West Wall 1	48	0
West Wall 2	96	0
West Wall 3	1020	1
West Wall 4	80	2
East Wall 1	208	3.7
East Wall 2	32	2.8
East Wall 3	320	1.5
East Wall 4	1680	1
North Wall	256	
5 Pt bottom comp.	128	3
3 Pt bottom comp.	816	0

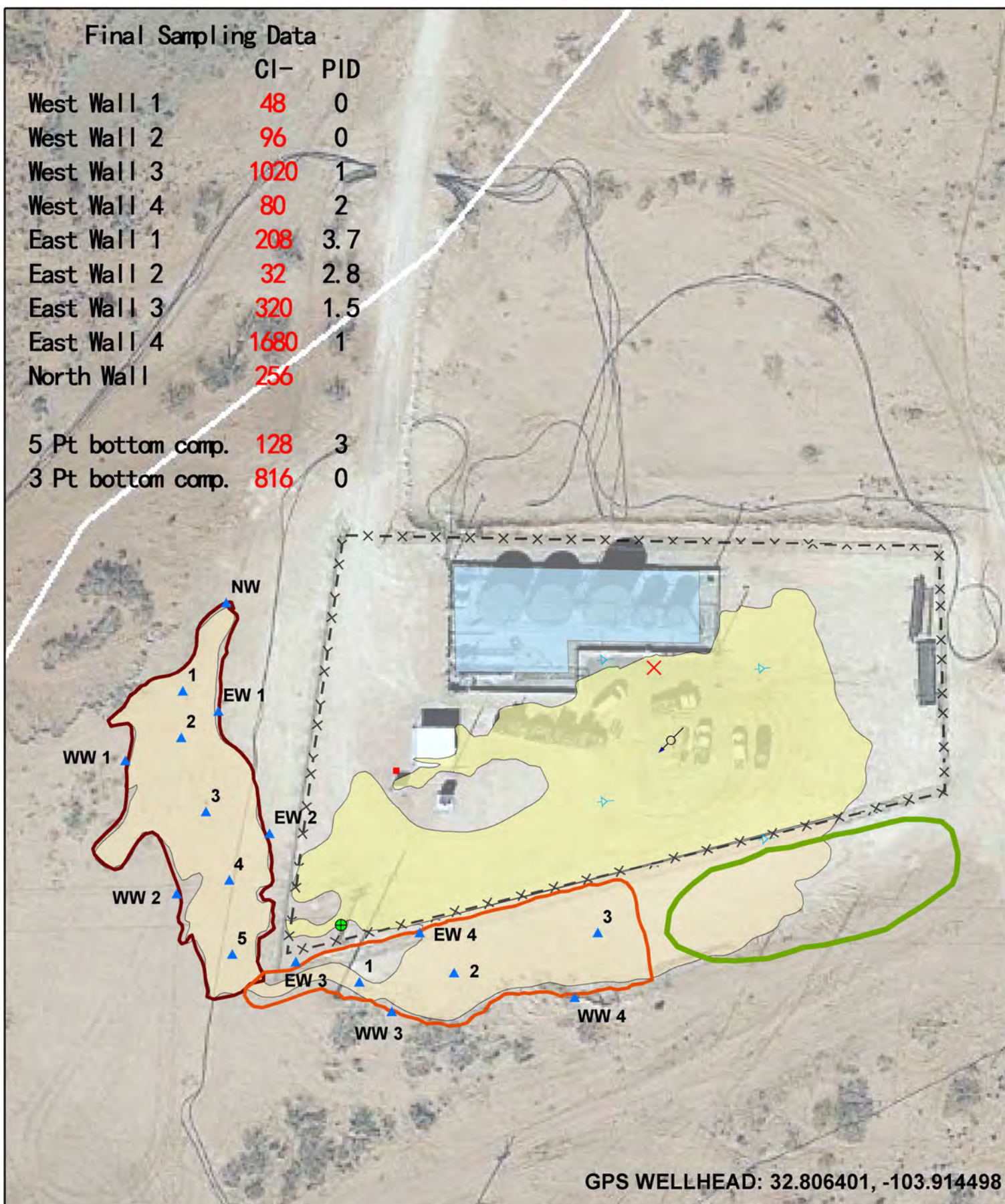

GPS WELLHEAD: 32.806401, -103.914498

Legend	
■ CONTROL BOX	EXCAVATION @ 1 FT
⚡ DEADMAN	EXCAVATION @ 1.5 FT
⊕ ELECTRIC POLE	SPOIL PILE
▲ SAMPLE POINT	BATTERY
✕ SOURCE	⌘ FACILITY FENCE
⊕ WELLHEAD	STAIN - PAD - 24,937 SQ FT
	STAIN - PASTURE - 20,289 SQ FT

Landowner: State
DGW: None

CI- FIELD DATA
CI- LAB DATA



**APACHE
STATE SWD #3**
UL E SECTION 30
T-17-S R-31-E
EDDY COUNTY, NM

Figure 2

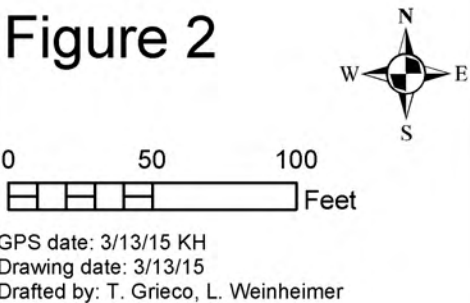

GPS date: 3/13/15 KH
Drawing date: 3/13/15
Drafted by: T. Grieco, L. Weinheimer

Appendix A

Laboratory Analyses

RICE Environmental Consulting and Safety (RECS)
P.O. Box 2948 Hobbs, NM 88241
Phone 575.393.2967



PHONE (575) 393-2326 ° 101 E. MARLAND ° HOBBS, NM 88240

March 23, 2015

BRUCE BAKER

APACHE CORP - HOBBS

2350 W. MARLAND BLVD.

HOBBS, NM 88240

RE: STATE SWD #3

Enclosed are the results of analyses for samples received by the laboratory on 03/20/15 16:30.

Cardinal Laboratories is accredited through Texas NELAP under certificate number T104704398-13-5. Accreditation applies to drinking water, non-potable water and solid and chemical materials. All accredited analytes are denoted by an asterisk (*). For a complete list of accredited analytes and matrices visit the TCEQ website at www.tceq.texas.gov/field/qa/lab_accred_certif.html.

Cardinal Laboratories is accredited through the State of Colorado Department of Public Health and Environment for:

Method EPA 552.2	Haloacetic Acids (HAA-5)
Method EPA 524.2	Total Trihalomethanes (TTHM)
Method EPA 524.4	Regulated VOCs (V1, V2, V3)

Accreditation applies to public drinking water matrices.

This report meets NELAP requirements and is made up of a cover page, analytical results, and a copy of the original chain-of-custody. If you have any questions concerning this report, please feel free to contact me.

Sincerely,

A handwritten signature in black ink that reads "Celey D. Keene".

Celey D. Keene

Lab Director/Quality Manager

Analytical Results For:

 APACHE CORP - HOBBS
 BRUCE BAKER
 2350 W. MARLAND BLVD.
 HOBBS NM, 88240
 Fax To: (575) 393-2432

Received:	03/20/2015	Sampling Date:	03/05/2015
Reported:	03/23/2015	Sampling Type:	Soil
Project Name:	STATE SWD #3	Sampling Condition:	Cool & Intact
Project Number:	NONE GIVEN	Sample Received By:	Celey D. Keene
Project Location:	NOT GIVEN		

Sample ID: VERT 3 @ 1.5 FT (H500765-01)

Chloride, SM4500CI-B		mg/kg		Analyzed By: AP					
Analyte	Result	Reporting Limit	Analyzed	Method Blank	BS	% Recovery	True Value QC	RPD	Qualifier
Chloride	160	16.0	03/23/2015	ND	416	104	400	3.77	

Sample ID: VERT 3 @ 2 FT (H500765-02)

Chloride, SM4500CI-B		mg/kg		Analyzed By: AP					
Analyte	Result	Reporting Limit	Analyzed	Method Blank	BS	% Recovery	True Value QC	RPD	Qualifier
Chloride	80.0	16.0	03/23/2015	ND	416	104	400	3.77	

Sample ID: VERT 4 @ 2 FT (H500765-03)

Chloride, SM4500CI-B		mg/kg		Analyzed By: AP					
Analyte	Result	Reporting Limit	Analyzed	Method Blank	BS	% Recovery	True Value QC	RPD	Qualifier
Chloride	48.0	16.0	03/23/2015	ND	416	104	400	3.77	

Sample ID: VERT 4 @ 2.5 FT (H500765-04)

Chloride, SM4500CI-B		mg/kg		Analyzed By: AP					
Analyte	Result	Reporting Limit	Analyzed	Method Blank	BS	% Recovery	True Value QC	RPD	Qualifier
Chloride	128	16.0	03/23/2015	ND	416	104	400	3.77	

Cardinal Laboratories

*=Accredited Analyte

PLEASE NOTE: Liability and Damages. Cardinal's liability and client's exclusive remedy for any claim arising, whether based in contract or tort, shall be limited to the amount paid by client for analyses. All claims, including those for negligence and any other cause whatsoever shall be deemed waived unless made in writing and received by Cardinal within thirty (30) days after completion of the applicable service. In no event shall Cardinal be liable for incidental or consequential damages, including, without limitation, business interruptions, loss of use, or loss of profits incurred by client, its subsidiaries, affiliates or successors arising out of or related to the performance of the services hereunder by Cardinal, regardless of whether such claim is based upon any of the above stated reasons or otherwise. Results relate only to the samples identified above. This report shall not be reproduced except in full with written approval of Cardinal Laboratories.



Celey D. Keene, Lab Director/Quality Manager

Notes and Definitions

ND	Analyte NOT DETECTED at or above the reporting limit
RPD	Relative Percent Difference
**	Samples not received at proper temperature of 6°C or below.
***	Insufficient time to reach temperature.
-	Chloride by SM4500Cl-B does not require samples be received at or below 6°C Samples reported on an as received basis (wet) unless otherwise noted on report

Cardinal Laboratories

*=Accredited Analyte

PLEASE NOTE: Liability and Damages. Cardinal's liability and client's exclusive remedy for any claim arising, whether based in contract or tort, shall be limited to the amount paid by client for analyses. All claims, including those for negligence and any other cause whatsoever shall be deemed waived unless made in writing and received by Cardinal within thirty (30) days after completion of the applicable service. In no event shall Cardinal be liable for incidental or consequential damages, including, without limitation, business interruptions, loss of use, or loss of profits incurred by client, its subsidiaries, affiliates or successors arising out of or related to the performance of the services hereunder by Cardinal, regardless of whether such claim is based upon any of the above stated reasons or otherwise. Results relate only to the samples identified above. This report shall not be reproduced except in full with written approval of Cardinal Laboratories.



Celey D. Keene, Lab Director/Quality Manager



CARDINAL LABORATORIES

101 East Marland, Hobbs, NM 88240 2111 Beechwood, Abilene, TX 79603
(505) 393-2326 FAX (505) 393-2476 (325) 673-7001 FAX (325) 673-7020

CHAIN-OF-CUSTODY AND ANALYSIS REQUEST

Company Name: Apco				BILL TO				ANALYSIS REQUEST																			
Project Manager: BRUCE DARR				P.O. #:				<div style="display: flex; flex-direction: column; align-items: center;"> <div>Chlorides</div> <div>TPH 8015 M</div> <div>BTEX</div> <div>Texas TPH</div> <div>Complete Cations/Anions</div> <div>TDS</div> </div>																			
Address:				Company:																							
City: Hobbs State: NM Zip: 88240				Attn:																							
Phone #: Fax #:				Address:																							
Project #: Project Owner:				City:																							
Project Name:				State: Zip:																							
Project Location: St-to SLD #3				Phone #:																							
Sampler Name: Kyle Humphreys				Fax #:																							
FOR LAB USE ONLY				MATRIX		PRESERV.		SAMPLING																			
Lab I.D.	Sample I.D.	(G)RAB OR (C)OMP.	# CONTAINERS	GROUNDWATER	WASTEWATER	SOIL	OIL	SLUDGE	OTHER:	ACID/BASE:	ICE / COOL	OTHER:	DATE	TIME													
H500765																											
	01 Vert. 3 @ 1.5 ft	6	1			1					1		3-5-15	2:05	1												
	02 Vert. 3 @ 2 ft	6	1			1					1		3-5-15	2:10	1												
	03 Vert. 4 @ 2 ft	6	1			1					1		3-5-15	2:20	1												
	04 Vert. 4 @ 2.5 ft	6	1			1					1		3-5-15	2:25	1												

PLEASE NOTE: Liability and Damages. Cardinal's liability and client's exclusive remedy for any claim arising whether based in contract or tort, shall be limited to the amount paid by the client for the analyses. All claims including those for negligence and any other cause whatsoever shall be deemed waived unless made in writing and received by Cardinal within 30 days after completion of the applicable service. In no event shall Cardinal be liable for incidental or consequential damages, including without limitation, business interruptions, loss of use, or loss of profits incurred by client, its subsidiaries, affiliates or successors arising out of or related to the performance of services hereunder by Cardinal, regardless of whether such claim is based upon any of the above stated reasons or otherwise.

Relinquished By: K. Humphreys	Date: 3/20/15	Received By: C. Humphreys	Phone Result: <input type="checkbox"/> Yes <input checked="" type="checkbox"/> No	Add'l Phone #:
Relinquished By:	Date: 3/20/15	Received By:	Fax Result: <input type="checkbox"/> Yes <input checked="" type="checkbox"/> No	Add'l Fax #:
Delivered By: (Circle One)	Time: 4:30	Sample Condition: 1.6°C	REMARKS:	
Sampler - UPS - Bus - Other:		Checked By: COH	email: hconder@riceswd.com; lflores@rice-ecs.com;	
			lweinheimer@rice-ecs.com; knorman@rice-ecs.com;	
			jkamplain@rice-ecs.com; sedwards@rice-ecs.com;	
			cursanic@rice-ecs.com	
			Environmental Tech: @rice-ecs.com	

† Cardinal cannot accept verbal changes. Please fax written changes to 505-393-2476

#54

RUSH!!



PHONE (575) 393-2326 ° 101 E. MARLAND ° HOBBS, NM 88240

March 20, 2015

BRUCE BAKER

APACHE CORP - HOBBS

2350 W. MARLAND BLVD.

HOBBS, NM 88240

RE: STATE SWD #3

Enclosed are the results of analyses for samples received by the laboratory on 03/18/15 10:12.

Cardinal Laboratories is accredited through Texas NELAP under certificate number T104704398-13-5. Accreditation applies to drinking water, non-potable water and solid and chemical materials. All accredited analytes are denoted by an asterisk (*). For a complete list of accredited analytes and matrices visit the TCEQ website at www.tceq.texas.gov/field/qa/lab_accred_certif.html.

Cardinal Laboratories is accredited through the State of Colorado Department of Public Health and Environment for:

Method EPA 552.2	Haloacetic Acids (HAA-5)
Method EPA 524.2	Total Trihalomethanes (TTHM)
Method EPA 524.4	Regulated VOCs (V1, V2, V3)

Accreditation applies to public drinking water matrices.

This report meets NELAP requirements and is made up of a cover page, analytical results, and a copy of the original chain-of-custody. If you have any questions concerning this report, please feel free to contact me.

Sincerely,

Celey D. Keene

Lab Director/Quality Manager

Analytical Results For:

 APACHE CORP - HOBBS
 BRUCE BAKER
 2350 W. MARLAND BLVD.
 HOBBS NM, 88240
 Fax To: (575) 393-2432

Received:	03/18/2015	Sampling Date:	03/13/2015
Reported:	03/20/2015	Sampling Type:	Soil
Project Name:	STATE SWD #3	Sampling Condition:	Cool & Intact
Project Number:	NONE GIVEN	Sample Received By:	Jodi Henson
Project Location:	NOT GIVEN		

Sample ID: WEST WALL 1 (H500733-01)

Chloride, SM4500Cl-B		mg/kg		Analyzed By: AP					
Analyte	Result	Reporting Limit	Analyzed	Method Blank	BS	% Recovery	True Value QC	RPD	Qualifier
Chloride	48.0	16.0	03/19/2015	ND	416	104	400	0.00	

Sample ID: WEST WALL 2 (H500733-02)

Chloride, SM4500Cl-B		mg/kg		Analyzed By: AP					
Analyte	Result	Reporting Limit	Analyzed	Method Blank	BS	% Recovery	True Value QC	RPD	Qualifier
Chloride	96.0	16.0	03/19/2015	ND	416	104	400	0.00	

Sample ID: WEST WALL 3 (H500733-03)

Chloride, SM4500Cl-B		mg/kg		Analyzed By: AP					
Analyte	Result	Reporting Limit	Analyzed	Method Blank	BS	% Recovery	True Value QC	RPD	Qualifier
Chloride	1020	16.0	03/19/2015	ND	416	104	400	0.00	

Sample ID: WEST WALL 4 (H500733-04)

Chloride, SM4500Cl-B		mg/kg		Analyzed By: AP					
Analyte	Result	Reporting Limit	Analyzed	Method Blank	BS	% Recovery	True Value QC	RPD	Qualifier
Chloride	80.0	16.0	03/19/2015	ND	416	104	400	0.00	

Cardinal Laboratories

*=Accredited Analyte

PLEASE NOTE: Liability and Damages. Cardinal's liability and client's exclusive remedy for any claim arising, whether based in contract or tort, shall be limited to the amount paid by client for analyses. All claims, including those for negligence and any other cause whatsoever shall be deemed waived unless made in writing and received by Cardinal within thirty (30) days after completion of the applicable service. In no event shall Cardinal be liable for incidental or consequential damages, including, without limitation, business interruptions, loss of use, or loss of profits incurred by client, its subsidiaries, affiliates or successors arising out of or related to the performance of the services hereunder by Cardinal, regardless of whether such claim is based upon any of the above stated reasons or otherwise. Results relate only to the samples identified above. This report shall not be reproduced except in full with written approval of Cardinal Laboratories.



Celey D. Keene, Lab Director/Quality Manager

Analytical Results For:

APACHE CORP - HOBBS
BRUCE BAKER
2350 W. MARLAND BLVD.
HOBBS NM, 88240
Fax To: (575) 393-2432

Received: 03/18/2015
Reported: 03/20/2015
Project Name: STATE SWD #3
Project Number: NONE GIVEN
Project Location: NOT GIVEN

Sampling Date: 03/13/2015
Sampling Type: Soil
Sampling Condition: Cool & Intact
Sample Received By: Jodi Henson

Sample ID: EAST WALL 1 (H500733-05)

Chloride, SM4500Cl-B		mg/kg		Analyzed By: AP					
Analyte	Result	Reporting Limit	Analyzed	Method Blank	BS	% Recovery	True Value QC	RPD	Qualifier
Chloride	208	16.0	03/19/2015	ND	416	104	400	0.00	

Sample ID: EAST WALL 2 (H500733-06)

Chloride, SM4500CI-B		mg/kg		Analyzed By: AP					
Analyte	Result	Reporting Limit	Analyzed	Method Blank	BS	% Recovery	True Value QC	RPD	Qualifier
Chloride	32.0	16.0	03/19/2015	ND	416	104	400	0.00	

Sample ID: EAST WALL 3 (H500733-07)

Chloride, SM4500CI-B		mg/kg		Analyzed By: AP						
Analyte	Result	Reporting Limit	Analyzed	Method Blank	BS	% Recovery	True Value QC	RPD	Qualifier	
Chloride	320	16.0	03/19/2015	ND	416	104	400	0.00		

Sample ID: EAST WALL 4 (H500733-08)

Chloride, SM4500CI-B		mg/kg		Analyzed By: AP					
Analyte	Result	Reporting Limit	Analyzed	Method Blank	BS	% Recovery	True Value QC	RPD	Qualifier
Chloride	1680	16.0	03/19/2015	ND	416	104	400	0.00	

Sample ID: 5 PT. BOTTOM COMP (H500733-09)

Chloride, SM4500Cl-B		mg/kg		Analyzed By: AP					
Analyte	Result	Reporting Limit	Analyzed	Method Blank	BS	% Recovery	True Value QC	RPD	Qualifier
Chloride	128	16.0	03/19/2015	ND	416	104	400	0.00	

Cardinal Laboratories

*=Accredited Analyte

PLEASE NOTE: Liability and Damages. Cardinal's liability and client's exclusive remedy for any claim arising, whether based in contract or tort, shall be limited to the amount paid by client for analyses. All claims, including those for negligence and any other cause whatsoever shall be deemed waived unless made in writing and received by Cardinal within thirty (30) days after completion of the applicable service. In no event shall Cardinal be liable for incidental or consequential damages, including, without limitation, business interruptions, loss of use, or loss of profits incurred by client, its subsidiaries, affiliates or successors arising out of or related to the performance of the services hereunder by Cardinal, regardless of whether such claim is based upon any of the above stated reasons or otherwise. Results relate only to the samples identified above. This report shall not be reproduced except in full with written approval of Cardinal Laboratories.



Celey D. Keene, Lab Director/Quality Manager

Analytical Results For:APACHE CORP - HOBBS
BRUCE BAKER
2350 W. MARLAND BLVD.
HOBBS NM, 88240
Fax To: (575) 393-2432

Received:	03/18/2015	Sampling Date:	03/13/2015
Reported:	03/20/2015	Sampling Type:	Soil
Project Name:	STATE SWD #3	Sampling Condition:	Cool & Intact
Project Number:	NONE GIVEN	Sample Received By:	Jodi Henson
Project Location:	NOT GIVEN		

Sample ID: 3 PT. BOTTOM COMP (H500733-10)

Chloride, SM4500Cl-B		mg/kg		Analyzed By: AP					
Analyte	Result	Reporting Limit	Analyzed	Method Blank	BS	% Recovery	True Value QC	RPD	Qualifier
Chloride	816	16.0	03/19/2015	ND	416	104	400	0.00	

Sample ID: NORTH WALL (H500733-11)

Chloride, SM4500Cl-B		mg/kg		Analyzed By: AP					
Analyte	Result	Reporting Limit	Analyzed	Method Blank	BS	% Recovery	True Value QC	RPD	Qualifier
Chloride	256	16.0	03/19/2015	ND	416	104	400	0.00	

Cardinal Laboratories

*=Accredited Analyte

PLEASE NOTE: Liability and Damages. Cardinal's liability and client's exclusive remedy for any claim arising, whether based in contract or tort, shall be limited to the amount paid by client for analyses. All claims, including those for negligence and any other cause whatsoever shall be deemed waived unless made in writing and received by Cardinal within thirty (30) days after completion of the applicable service. In no event shall Cardinal be liable for incidental or consequential damages, including, without limitation, business interruptions, loss of use, or loss of profits incurred by client, its subsidiaries, affiliates or successors arising out of or related to the performance of the services hereunder by Cardinal, regardless of whether such claim is based upon any of the above stated reasons or otherwise. Results relate only to the samples identified above. This report shall not be reproduced except in full with written approval of Cardinal Laboratories.



Celey D. Keene, Lab Director/Quality Manager

Notes and Definitions

ND	Analyte NOT DETECTED at or above the reporting limit
RPD	Relative Percent Difference
**	Samples not received at proper temperature of 6°C or below.
***	Insufficient time to reach temperature.
-	Chloride by SM4500Cl-B does not require samples be received at or below 6°C Samples reported on an as received basis (wet) unless otherwise noted on report

Cardinal Laboratories

*=Accredited Analyte

PLEASE NOTE: Liability and Damages. Cardinal's liability and client's exclusive remedy for any claim arising, whether based in contract or tort, shall be limited to the amount paid by client for analyses. All claims, including those for negligence and any other cause whatsoever shall be deemed waived unless made in writing and received by Cardinal within thirty (30) days after completion of the applicable service. In no event shall Cardinal be liable for incidental or consequential damages, including, without limitation, business interruptions, loss of use, or loss of profits incurred by client, its subsidiaries, affiliates or successors arising out of or related to the performance of the services hereunder by Cardinal, regardless of whether such claim is based upon any of the above stated reasons or otherwise. Results relate only to the samples identified above. This report shall not be reproduced except in full with written approval of Cardinal Laboratories.



Celey D. Keene, Lab Director/Quality Manager



CHAIN-OF-CUSTODY AND ANALYSIS REQUEST

Page 6 of 7

Company Name: APechd Project Manager: Bruce Becker Address: City: Hobbs State: NM Zip: 88240 Phone #: Fax #: Project #: Project Owner: Project Name: Project Location: State SWD H3 Sampler Name: Kyle Humphrey				BILL TO P.O. #: Company: Attn: Address: City: State: Zip: Phone #: Fax #:				ANALYSIS REQUEST <div style="display: flex; justify-content: space-around; align-items: center;"> <div style="writing-mode: vertical-rl; transform: rotate(180deg);">Chlorides</div> <div style="writing-mode: vertical-rl; transform: rotate(180deg);">TPH 8015 M</div> <div style="writing-mode: vertical-rl; transform: rotate(180deg);">BTEX</div> <div style="writing-mode: vertical-rl; transform: rotate(180deg);">Texas TPH</div> <div style="writing-mode: vertical-rl; transform: rotate(180deg);">Complete Cations/Anions</div> <div style="writing-mode: vertical-rl; transform: rotate(180deg);">TDS</div> </div>																								
FOR LAB USE ONLY				MATRIX				PRESERV.		SAMPLING																						
Lab I.D.	Sample I.D.	(GRAB OR (COMP. # CONTAINERS	GROUNDWATER	WASTEWATER	SOIL	OIL	SLUDGE	OTHER:	ACID/BASE:	ICE / COOL	OTHER:	DATE	TIME																			
H500733																																
1	WEST Well 1	6	1			/				/		2-12-15	1:00	/																		
2	WEST Well 2	6	1			/				/			1:05	/																		
3	WEST Well 3	6	1			/				/			1:10	/																		
4	WEST Well 4	6	1			/				/			1:15	/																		
5	EAST Well 1	6	1			/				/			1:20	/																		
6	EAST Well 2	6	1			/				/			1:25	/																		
7	EAST Well 3	6	1			/				/			1:30	/																		
8	EAST Well 4	6	1			/				/			1:35	/																		
9	5 pt Bottom Comp	6	1			/				/			1:45	/																		
10	3 pt Bottom Comp	6	1			/				/			1:40	/																		

PLEASE NOTE: Liability and Damages. Cardinal's liability and client's exclusive remedy for any claim arising whether based in contract or tort, shall be limited to the amount paid by the client for the analyses. All claims including those for negligence and any other cause whatsoever shall be deemed waived unless made in writing and received by Cardinal within 30 days after completion of the applicable service. In no event shall Cardinal be liable for incidental or consequential damages, including without limitation, business interruptions, loss of use, or loss of profits incurred by client, its subsidiaries, affiliates or successors arising out of or related to the performance of services hereunder by Cardinal, regardless of whether such claim is based upon any of the above stated reasons or otherwise.

Relinquished By: NQR	Date: 3/18/15 Time: 10:12	Received By: Jodi Henson	Phone Result: <input type="checkbox"/> Yes <input checked="" type="checkbox"/> No Fax Result: <input type="checkbox"/> Yes <input checked="" type="checkbox"/> No Add'l Phone #: Add'l Fax #: REMARKS:
Relinquished By:	Date: Time:	Received By:	email results Knorman@rice-ecs.com KJones@riceswd.com; jkamplain@rice-ecs.com hconder@rice-ecs.com; Lweinheimer@rice-ecs.com Khumphrey@rice-ecs.com sedwards@rice-ecs.com, lflores@rice-ecs.com

Delivered By: (Circle One) Sampler - UPS - Bus - Other:	Sample Condition Cool Intact <input type="checkbox"/> Yes <input type="checkbox"/> No <input type="checkbox"/> Yes <input type="checkbox"/> No	CHECKED BY: [Signature]	Temperature: -6.8°C
--	--	--------------------------------	----------------------------

† Cardinal cannot accept verbal changes. Please fax written changes to 505-393-2476

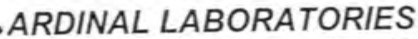

CHAIN-OF-CUSTODY AND ANALYSIS REQUEST

PLEASE NOTE: Liability and Damages. Cardinal's liability and client's exclusive remedy for any claim arising whether based in contract or tort, shall be limited to the amount paid by the client for the analyses. All claims including those for negligence and any other cause whatsoever shall be deemed waived unless made in writing and received by Cardinal within 30 days after completion of the applicable service. In no event shall Cardinal be liable for incidental or consequential damages, including without limitation, business interruptions, loss of use, or loss of profits incurred by client, its subsidiaries, affiliates or successors arising out of or related to the performance of services hereunder by Cardinal, regardless of whether such claim is based upon any of the above stated reasons or otherwise.

Relinquished By: <i>Mae Hany</i>		Date: <i>3/18/15</i>		Received By: <i>Jodi Henson</i>		Phone Result: <input type="checkbox"/> Yes <input type="checkbox"/> No		Add'l Phone #:	
		Time: <i>10:12</i>				Fax Result: <input type="checkbox"/> Yes <input checked="" type="checkbox"/> No		Add'l Fax #:	
Relinquished By: <i>[Signature]</i>		Date:		Received By:		REMARKS:			
		Time:				email: hconder@riceswd.com; lflores@rice-ecs.com; lweinheimer@rice-ecs.com; knorman@rice-ecs.com; jkamplain@rice-ecs.com; sedwards@rice-ecs.com; cursanic@rice-ecs.com Environmental Tech: @rice-ecs.com			
Delivered By: (Circle One)				Sample Condition		CHECKED BY:			
Sampler - UPS - Bus - Other:				Cool <input checked="" type="checkbox"/> Intact <input checked="" type="checkbox"/>		(Initials)			
				Yes <input checked="" type="checkbox"/> No <input type="checkbox"/>					

† Cardinal cannot accept verbal changes. Please fax written changes to 505-393-2476

#54

Appendix B

Photo Document

RICE Environmental Consulting and Safety (RECS)
P.O. Box 2948 Hobbs, NM 88241
Phone 575.393.2967

Apache State SWD #3

Unit Letter E, Section 30, T17S, R31E



Initial release area, facing west

3/4/15



Initial release area, facing northwest

3/4/15



Initial release area, facing west

3/4/15



Initial release area, facing east

3/4/15



Initial release area, facing northwest

3/4/15



Scraping wet material, facing southeast

3/5/15



Moving contaminated soil to spoil pile, facing southeast
3/5/15



Facility liner discovered in Vertical 2

3/5/15



Scraping west of battery, facing east

3/9/15