

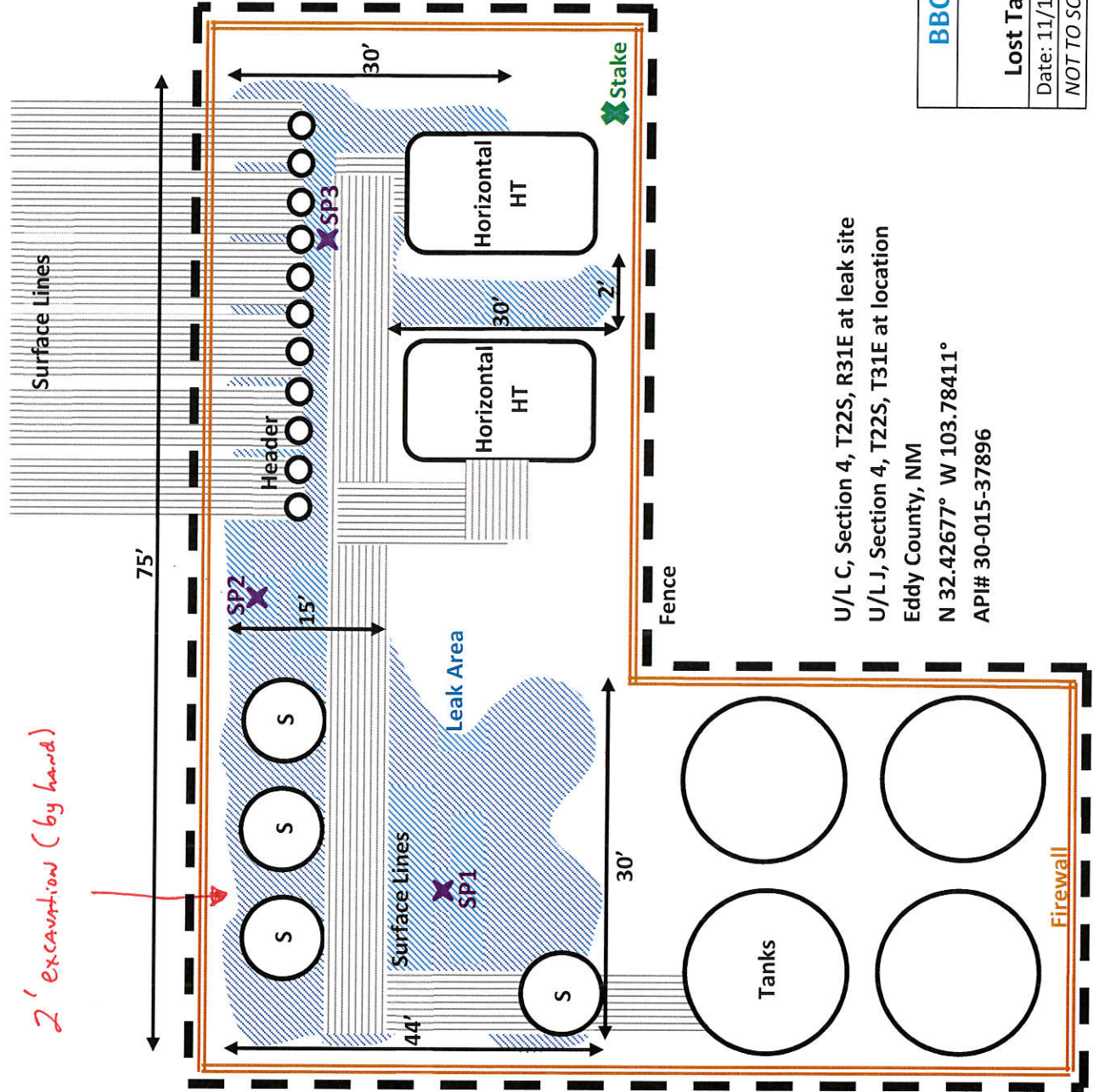

Oxy

Lost Tank 4 Federal #19 Battery



U/L C, Section 4, T22S, R31E at leak site
U/L J, Section 4, T22S, T31E at location
Eddy County, NM
N 32.42677° W 103.78411°
API# 30-015-37896

BBC International, Inc.

Oxy

Lost Tank 4 Federal #19 Battery

Date: 11/13/14 DRWG by: K. Purvis

NOT TO SCALE File: Oxy 2014



Groundwater Plot

Oxy Lost Tank 4 Federal #19 Battery

County
Eddy

Unit Letter
C

Section
4

Township
22S

Range
31E

Trend Map 125'-150'

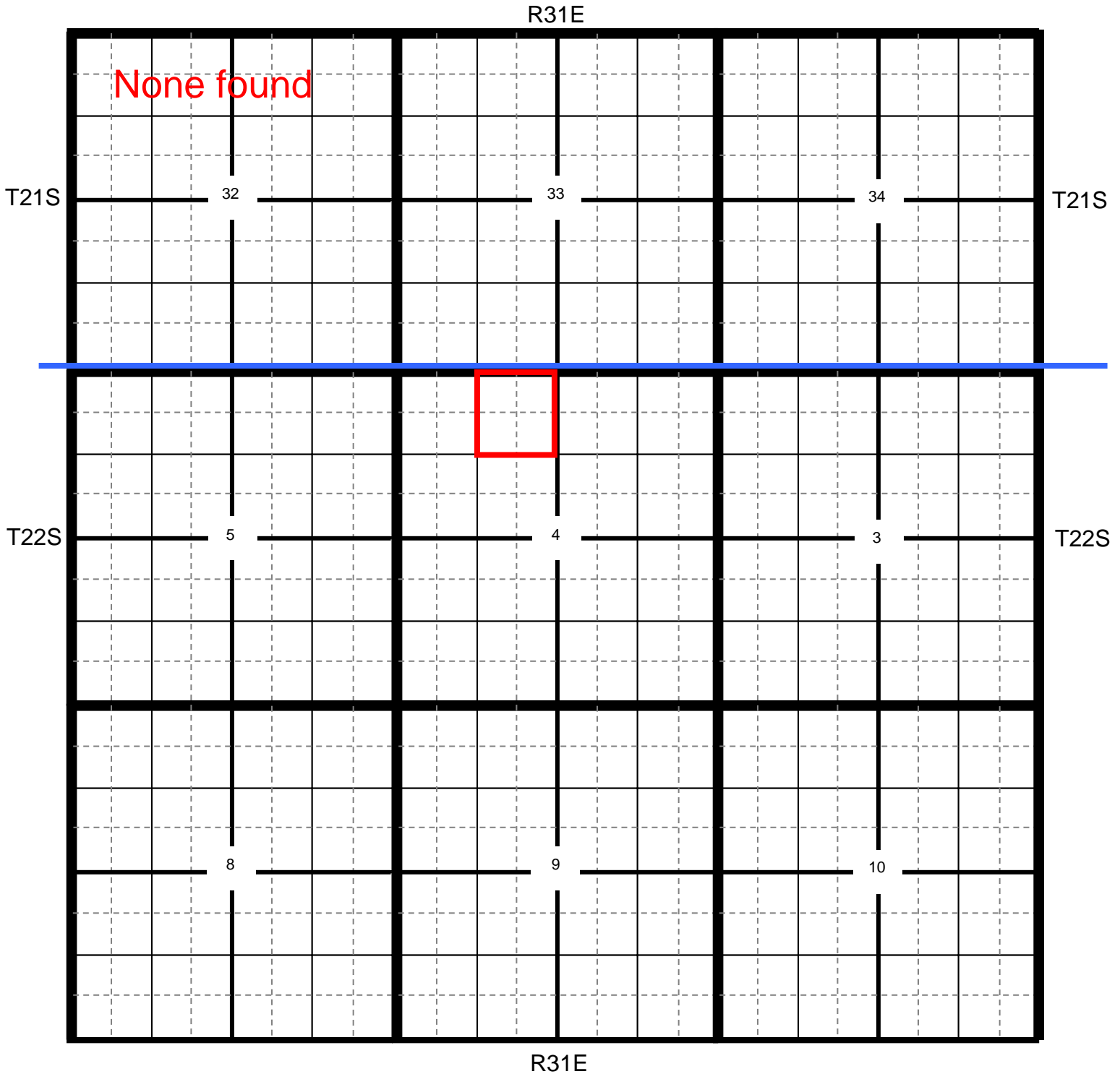

★ Location

● OCD

● USGS

● SEO

● All Databases

Oxy Lost Tank 4 Federal #19 Battery

County Eddy **Unit Letter** C **Section** 4 **Township** 22S **Range** 31E

Trend Map 125'-150'

1

2

NW/NW None found Unit Letter D	NE/NW Unit Letter C	NW/NE Unit Letter B	NE/NE Unit Letter A
SW/NW Unit Letter E	SE/NW Unit Letter F	SW/NE Unit Letter G	SE/NE Unit Letter H
NW/SW Unit Letter L	NE/SW Unit Letter K	NW/SE Unit Letter J	NE/SE Unit Letter I
SW/SW Unit Letter M	SE/SW Unit Letter N	SW/SE Unit Letter O	SE/SE Unit Letter P

3

4

**Laboratory Analytical Results Summary
Lost Tank 4 Federal #19**

		Sample	SP1 @ 1'	SP1 @ 3'	SP1 @ 5'	SP1 @ 7'
Analyte	Method	Date	3/3/15	3/3/15	3/3/15	3/3/15
			mg/Kg	mg/Kg	mg/Kg	mg/Kg
Benzene	BTEX 8021B		<0.050	<0.050	<0.050	<0.050
Toluene	BTEX 8021B		<0.050	<0.050	<0.050	<0.050
Ethylbenzene	BTEX 8021B		<0.050	<0.050	<0.050	<0.050
Total Xylenes	BTEX 8021B		<0.150	<0.150	<0.150	<0.150
Total BTEX	BTEX 8021B		<0.300	<0.300	<0.300	<0.300
Chloride	SM4500Cl-B		1120	960	512	<16.0
GRO	TPH 8015M		<10.0	<10.0	<10.0	<10.0
DRO	TPH 8015M		25.8	25.3	<10.0	<10.0

		Sample	SP2 @ 1'	SP2 @ 3'	SP2 @ 5'	SP2 @ 7'
Analyte	Method	Date	3/3/15	3/3/15	3/3/15	3/3/15
			mg/Kg	mg/Kg	mg/Kg	mg/Kg
Benzene	BTEX 8021B		<0.050	<0.050	<0.050	<0.050
Toluene	BTEX 8021B		<0.050	<0.050	<0.050	<0.050
Ethylbenzene	BTEX 8021B		<0.050	<0.050	<0.050	<0.050
Total Xylenes	BTEX 8021B		<0.150	<0.150	<0.150	<0.150
Total BTEX	BTEX 8021B		<0.300	<0.300	<0.300	<0.300
Chloride	SM4500Cl-B		4640	720	208	<16.0
GRO	TPH 8015M		<10.0	<10.0	<10.0	<10.0
DRO	TPH 8015M		<10.0	<10.0	<10.0	<10.0

		Sample	SP3 @ 1'	SP3 @ 3'	SP3 @ 4'	SP3 @ 6'
Analyte	Method	Date	3/3/15	3/3/15	3/3/15	3/3/15
			mg/Kg	mg/Kg	mg/Kg	mg/Kg
Benzene	BTEX 8021B		<0.050	<0.050	<0.050	<0.050
Toluene	BTEX 8021B		<0.050	<0.050	<0.050	<0.050
Ethylbenzene	BTEX 8021B		<0.050	<0.050	<0.050	<0.050
Total Xylenes	BTEX 8021B		<0.150	<0.150	<0.150	<0.150
Total BTEX	BTEX 8021B		<0.300	<0.300	<0.300	<0.300
Chloride	SM4500Cl-B		2240	752	208	64
GRO	TPH 8015M		<10.0	<10.0	<10.0	<10.0
DRO	TPH 8015M		81.3	<10.0	<10.0	<10.0



PHONE (575) 393-2326 ° 101 E. MARLAND ° HOBBS, NM 88240

March 10, 2015

Cliff Brunson

BBC International, Inc.

P.O. Box 805

Hobbs, NM 88241

RE: LOST TANK 4 FEDERAL #19

Enclosed are the results of analyses for samples received by the laboratory on 03/05/15 9:45.

Cardinal Laboratories is accredited through Texas NELAP under certificate number T104704398-13-5. Accreditation applies to drinking water, non-potable water and solid and chemical materials. All accredited analytes are denoted by an asterisk (*). For a complete list of accredited analytes and matrices visit the TCEQ website at www.tceq.texas.gov/field/qa/lab_accred_certif.html.

Cardinal Laboratories is accredited through the State of Colorado Department of Public Health and Environment for:

Method EPA 552.2	Haloacetic Acids (HAA-5)
Method EPA 524.2	Total Trihalomethanes (TTHM)
Method EPA 524.4	Regulated VOCs (V1, V2, V3)

Accreditation applies to public drinking water matrices.

This report meets NELAP requirements and is made up of a cover page, analytical results, and a copy of the original chain-of-custody. If you have any questions concerning this report, please feel free to contact me.

Sincerely,

A handwritten signature in black ink that reads "Celey D. Keene". The signature is written in a cursive, flowing style.

Celey D. Keene

Lab Director/Quality Manager

Analytical Results For:

BBC International, Inc.
Cliff Brunson
P.O. Box 805
Hobbs NM, 88241
Fax To: (575) 397-0397

Received:	03/05/2015	Sampling Date:	03/03/2015
Reported:	03/10/2015	Sampling Type:	Soil
Project Name:	LOST TANK 4 FEDERAL #19	Sampling Condition:	Cool & Intact
Project Number:	NONE GIVEN	Sample Received By:	Jodi Henson
Project Location:	WIPP		

Sample ID: SP 1 @ 1' (H500610-01)

BTX 8021B			mg/kg		Analyzed By: ms				
Analyte	Result	Reporting Limit	Analyzed	Method Blank	BS	% Recovery	True Value QC	RPD	Qualifier
Benzene*	<0.050	0.050	03/07/2015	ND	1.98	99.0	2.00	10.2	
Toluene*	<0.050	0.050	03/07/2015	ND	1.77	88.4	2.00	10.1	
Ethylbenzene*	<0.050	0.050	03/07/2015	ND	2.07	103	2.00	10.6	
Total Xylenes*	<0.150	0.150	03/07/2015	ND	5.64	94.0	6.00	11.2	
Total BTX	<0.300	0.300	03/07/2015	ND					

Surrogate: 4-Bromofluorobenzene (PID) 115 % 61-154

Chloride, SM4500Cl-B			mg/kg		Analyzed By: AP				
Analyte	Result	Reporting Limit	Analyzed	Method Blank	BS	% Recovery	True Value QC	RPD	Qualifier
Chloride	1120	16.0	03/05/2015	ND	400	100	400	0.00	

TPH 8015M			mg/kg		Analyzed By: MS				
Analyte	Result	Reporting Limit	Analyzed	Method Blank	BS	% Recovery	True Value QC	RPD	Qualifier
GRO C6-C10	<10.0	10.0	03/06/2015	ND	188	94.0	200	1.83	
DRO >C10-C28	25.8	10.0	03/06/2015	ND	196	98.2	200	1.27	

Surrogate: 1-Chlorooctane 81.2 % 47.2-157

Surrogate: 1-Chlorooctadecane 92.8 % 52.1-176

Cardinal Laboratories

*=Accredited Analyte

PLEASE NOTE: Liability and Damages. Cardinal's liability and client's exclusive remedy for any claim arising, whether based in contract or tort, shall be limited to the amount paid by client for analyses. All claims, including those for negligence and any other cause whatsoever shall be deemed waived unless made in writing and received by Cardinal within thirty (30) days after completion of the applicable service. In no event shall Cardinal be liable for incidental or consequential damages, including, without limitation, business interruptions, loss of use, or loss of profits incurred by client, its subsidiaries, affiliates or successors arising out of or related to the performance of the services hereunder by Cardinal, regardless of whether such claim is based upon any of the above stated reasons or otherwise. Results relate only to the samples identified above. This report shall not be reproduced except in full with written approval of Cardinal Laboratories.



Celey D. Keene, Lab Director/Quality Manager

Analytical Results For:

BBC International, Inc.
Cliff Brunson
P.O. Box 805
Hobbs NM, 88241
Fax To: (575) 397-0397

Received:	03/05/2015	Sampling Date:	03/03/2015
Reported:	03/10/2015	Sampling Type:	Soil
Project Name:	LOST TANK 4 FEDERAL #19	Sampling Condition:	Cool & Intact
Project Number:	NONE GIVEN	Sample Received By:	Jodi Henson
Project Location:	WIPP		

Sample ID: SP 1 @ 3' (H500610-02)

BTX 8021B		mg/kg		Analyzed By: ms					
Analyte	Result	Reporting Limit	Analyzed	Method Blank	BS	% Recovery	True Value QC	RPD	Qualifier
Benzene*	<0.050	0.050	03/07/2015	ND	1.98	99.0	2.00	10.2	
Toluene*	<0.050	0.050	03/07/2015	ND	1.77	88.4	2.00	10.1	
Ethylbenzene*	<0.050	0.050	03/07/2015	ND	2.07	103	2.00	10.6	
Total Xylenes*	<0.150	0.150	03/07/2015	ND	5.64	94.0	6.00	11.2	
Total BTX	<0.300	0.300	03/07/2015	ND					

Surrogate: 4-Bromofluorobenzene (PID) 115 % 61-154

Chloride, SM4500CI-B		mg/kg		Analyzed By: AP					
Analyte	Result	Reporting Limit	Analyzed	Method Blank	BS	% Recovery	True Value QC	RPD	Qualifier
Chloride	960	16.0	03/05/2015	ND	400	100	400	0.00	

TPH 8015M		mg/kg		Analyzed By: MS					
Analyte	Result	Reporting Limit	Analyzed	Method Blank	BS	% Recovery	True Value QC	RPD	Qualifier
GRO C6-C10	<10.0	10.0	03/06/2015	ND	188	94.0	200	1.83	
DRO >C10-C28	25.3	10.0	03/06/2015	ND	196	98.2	200	1.27	

Surrogate: 1-Chlorooctane 89.2 % 47.2-157

Surrogate: 1-Chlorooctadecane 93.7 % 52.1-176

Cardinal Laboratories

*=Accredited Analyte

PLEASE NOTE: Liability and Damages. Cardinal's liability and client's exclusive remedy for any claim arising, whether based in contract or tort, shall be limited to the amount paid by client for analyses. All claims, including those for negligence and any other cause whatsoever shall be deemed waived unless made in writing and received by Cardinal within thirty (30) days after completion of the applicable service. In no event shall Cardinal be liable for incidental or consequential damages, including, without limitation, business interruptions, loss of use, or loss of profits incurred by client, its subsidiaries, affiliates or successors arising out of or related to the performance of the services hereunder by Cardinal, regardless of whether such claim is based upon any of the above stated reasons or otherwise. Results relate only to the samples identified above. This report shall not be reproduced except in full with written approval of Cardinal Laboratories.



Celey D. Keene, Lab Director/Quality Manager

Analytical Results For:

BBC International, Inc.
Cliff Brunson
P.O. Box 805
Hobbs NM, 88241
Fax To: (575) 397-0397

Received:	03/05/2015	Sampling Date:	03/03/2015
Reported:	03/10/2015	Sampling Type:	Soil
Project Name:	LOST TANK 4 FEDERAL #19	Sampling Condition:	Cool & Intact
Project Number:	NONE GIVEN	Sample Received By:	Jodi Henson
Project Location:	WIPP		

Sample ID: SP 1 @ 5' (H500610-03)

BTEx 8021B		mg/kg		Analyzed By: ms					
Analyte	Result	Reporting Limit	Analyzed	Method Blank	BS	% Recovery	True Value QC	RPD	Qualifier
Benzene*	<0.050	0.050	03/07/2015	ND	1.98	99.0	2.00	10.2	
Toluene*	<0.050	0.050	03/07/2015	ND	1.77	88.4	2.00	10.1	
Ethylbenzene*	<0.050	0.050	03/07/2015	ND	2.07	103	2.00	10.6	
Total Xylenes*	<0.150	0.150	03/07/2015	ND	5.64	94.0	6.00	11.2	
Total BTEx	<0.300	0.300	03/07/2015	ND					

Surrogate: 4-Bromofluorobenzene (PID) 116 % 61-154

Chloride, SM4500Cl-B		mg/kg		Analyzed By: AP					
Analyte	Result	Reporting Limit	Analyzed	Method Blank	BS	% Recovery	True Value QC	RPD	Qualifier
Chloride	512	16.0	03/05/2015	ND	400	100	400	0.00	

TPH 8015M		mg/kg		Analyzed By: MS					
Analyte	Result	Reporting Limit	Analyzed	Method Blank	BS	% Recovery	True Value QC	RPD	Qualifier
GRO C6-C10	<10.0	10.0	03/06/2015	ND	188	94.0	200	1.83	
DRO >C10-C28	<10.0	10.0	03/06/2015	ND	196	98.2	200	1.27	

Surrogate: 1-Chlorooctane 84.7 % 47.2-157

Surrogate: 1-Chlorooctadecane 90.5 % 52.1-176

Cardinal Laboratories

*=Accredited Analyte

PLEASE NOTE: Liability and Damages. Cardinal's liability and client's exclusive remedy for any claim arising, whether based in contract or tort, shall be limited to the amount paid by client for analyses. All claims, including those for negligence and any other cause whatsoever shall be deemed waived unless made in writing and received by Cardinal within thirty (30) days after completion of the applicable service. In no event shall Cardinal be liable for incidental or consequential damages, including, without limitation, business interruptions, loss of use, or loss of profits incurred by client, its subsidiaries, affiliates or successors arising out of or related to the performance of the services hereunder by Cardinal, regardless of whether such claim is based upon any of the above stated reasons or otherwise. Results relate only to the samples identified above. This report shall not be reproduced except in full with written approval of Cardinal Laboratories.



Celey D. Keene, Lab Director/Quality Manager

Analytical Results For:

BBC International, Inc.
Cliff Brunson
P.O. Box 805
Hobbs NM, 88241
Fax To: (575) 397-0397

Received:	03/05/2015	Sampling Date:	03/03/2015
Reported:	03/10/2015	Sampling Type:	Soil
Project Name:	LOST TANK 4 FEDERAL #19	Sampling Condition:	Cool & Intact
Project Number:	NONE GIVEN	Sample Received By:	Jodi Henson
Project Location:	WIPP		

Sample ID: SP 1 @ 7' (H500610-04)

BTX 8021B		mg/kg		Analyzed By: ms					
Analyte	Result	Reporting Limit	Analyzed	Method Blank	BS	% Recovery	True Value QC	RPD	Qualifier
Benzene*	<0.050	0.050	03/09/2015	ND	1.96	97.8	2.00	10.5	
Toluene*	<0.050	0.050	03/09/2015	ND	1.84	91.9	2.00	6.52	
Ethylbenzene*	<0.050	0.050	03/09/2015	ND	2.09	105	2.00	7.91	
Total Xylenes*	<0.150	0.150	03/09/2015	ND	5.64	94.0	6.00	9.81	
Total BTX	<0.300	0.300	03/09/2015	ND					

Surrogate: 4-Bromofluorobenzene (PID) 115 % 61-154

Chloride, SM4500CI-B		mg/kg		Analyzed By: AP						
Analyte	Result	Reporting Limit	Analyzed	Method Blank	BS	% Recovery	True Value QC	RPD	Qualifier	
Chloride	<16.0	16.0	03/05/2015	ND	400	100	400	0.00		

TPH 8015M		mg/kg		Analyzed By: MS					
Analyte	Result	Reporting Limit	Analyzed	Method Blank	BS	% Recovery	True Value QC	RPD	Qualifier
GRO C6-C10	<10.0	10.0	03/06/2015	ND	188	94.0	200	1.83	
DRO >C10-C28	<10.0	10.0	03/06/2015	ND	196	98.2	200	1.27	

Surrogate: 1-Chlorooctane 84.4 % 47.2-157

Surrogate: 1-Chlorooctadecane 93.8 % 52.1-176

Cardinal Laboratories

*=Accredited Analyte

PLEASE NOTE: Liability and Damages. Cardinal's liability and client's exclusive remedy for any claim arising, whether based in contract or tort, shall be limited to the amount paid by client for analyses. All claims, including those for negligence and any other cause whatsoever shall be deemed waived unless made in writing and received by Cardinal within thirty (30) days after completion of the applicable service. In no event shall Cardinal be liable for incidental or consequential damages, including, without limitation, business interruptions, loss of use, or loss of profits incurred by client, its subsidiaries, affiliates or successors arising out of or related to the performance of the services hereunder by Cardinal, regardless of whether such claim is based upon any of the above stated reasons or otherwise. Results relate only to the samples identified above. This report shall not be reproduced except in full with written approval of Cardinal Laboratories.



Celey D. Keene, Lab Director/Quality Manager

Analytical Results For:

BBC International, Inc.
Cliff Brunson
P.O. Box 805
Hobbs NM, 88241
Fax To: (575) 397-0397

Received:	03/05/2015	Sampling Date:	03/03/2015
Reported:	03/10/2015	Sampling Type:	Soil
Project Name:	LOST TANK 4 FEDERAL #19	Sampling Condition:	Cool & Intact
Project Number:	NONE GIVEN	Sample Received By:	Jodi Henson
Project Location:	WIPP		

Sample ID: SP 2 @ 1' (H500610-05)

BTX 8021B		mg/kg		Analyzed By: ms						
Analyte	Result	Reporting Limit	Analyzed	Method Blank	BS	% Recovery	True Value QC	RPD	Qualifier	
Benzene*	<0.050	0.050	03/09/2015	ND	1.96	97.8	2.00	10.5		
Toluene*	<0.050	0.050	03/09/2015	ND	1.84	91.9	2.00	6.52		
Ethylbenzene*	<0.050	0.050	03/09/2015	ND	2.09	105	2.00	7.91		
Total Xylenes*	<0.150	0.150	03/09/2015	ND	5.64	94.0	6.00	9.81		
Total BTX	<0.300	0.300	03/09/2015	ND						

Surrogate: 4-Bromofluorobenzene (PID) 114 % 61-154

Chloride, SM4500CI-B		mg/kg		Analyzed By: AP					
Analyte	Result	Reporting Limit	Analyzed	Method Blank	BS	% Recovery	True Value QC	RPD	Qualifier
Chloride	4640	16.0	03/05/2015	ND	400	100	400	0.00	

TPH 8015M		mg/kg		Analyzed By: MS					
Analyte	Result	Reporting Limit	Analyzed	Method Blank	BS	% Recovery	True Value QC	RPD	Qualifier
GRO C6-C10	<10.0	10.0	03/06/2015	ND	188	94.0	200	1.83	
DRO >C10-C28	<10.0	10.0	03/06/2015	ND	196	98.2	200	1.27	

Surrogate: 1-Chlorooctane 86.5 % 47.2-157

Surrogate: 1-Chlorooctadecane 93.7 % 52.1-176

Cardinal Laboratories

*=Accredited Analyte

PLEASE NOTE: Liability and Damages. Cardinal's liability and client's exclusive remedy for any claim arising, whether based in contract or tort, shall be limited to the amount paid by client for analyses. All claims, including those for negligence and any other cause whatsoever shall be deemed waived unless made in writing and received by Cardinal within thirty (30) days after completion of the applicable service. In no event shall Cardinal be liable for incidental or consequential damages, including, without limitation, business interruptions, loss of use, or loss of profits incurred by client, its subsidiaries, affiliates or successors arising out of or related to the performance of the services hereunder by Cardinal, regardless of whether such claim is based upon any of the above stated reasons or otherwise. Results relate only to the samples identified above. This report shall not be reproduced except in full with written approval of Cardinal Laboratories.



Celey D. Keene, Lab Director/Quality Manager

Analytical Results For:

BBC International, Inc.
Cliff Brunson
P.O. Box 805
Hobbs NM, 88241
Fax To: (575) 397-0397

Received:	03/05/2015	Sampling Date:	03/03/2015
Reported:	03/10/2015	Sampling Type:	Soil
Project Name:	LOST TANK 4 FEDERAL #19	Sampling Condition:	Cool & Intact
Project Number:	NONE GIVEN	Sample Received By:	Jodi Henson
Project Location:	WIPP		

Sample ID: SP 2 @ 3' (H500610-06)

BTEx 8021B		mg/kg		Analyzed By: ms					
Analyte	Result	Reporting Limit	Analyzed	Method Blank	BS	% Recovery	True Value QC	RPD	Qualifier
Benzene*	<0.050	0.050	03/09/2015	ND	1.96	97.8	2.00	10.5	
Toluene*	<0.050	0.050	03/09/2015	ND	1.84	91.9	2.00	6.52	
Ethylbenzene*	<0.050	0.050	03/09/2015	ND	2.09	105	2.00	7.91	
Total Xylenes*	<0.150	0.150	03/09/2015	ND	5.64	94.0	6.00	9.81	
Total BTEx	<0.300	0.300	03/09/2015	ND					

Surrogate: 4-Bromofluorobenzene (PID) 108 % 61-154

Chloride, SM4500CI-B		mg/kg		Analyzed By: AP					
Analyte	Result	Reporting Limit	Analyzed	Method Blank	BS	% Recovery	True Value QC	RPD	Qualifier
Chloride	720	16.0	03/05/2015	ND	400	100	400	0.00	

TPH 8015M		mg/kg		Analyzed By: MS					
Analyte	Result	Reporting Limit	Analyzed	Method Blank	BS	% Recovery	True Value QC	RPD	Qualifier
GRO C6-C10	<10.0	10.0	03/06/2015	ND	188	94.0	200	1.83	
DRO >C10-C28	<10.0	10.0	03/06/2015	ND	196	98.2	200	1.27	

Surrogate: 1-Chlorooctane 80.2 % 47.2-157

Surrogate: 1-Chlorooctadecane 88.8 % 52.1-176

Cardinal Laboratories

*=Accredited Analyte

PLEASE NOTE: Liability and Damages. Cardinal's liability and client's exclusive remedy for any claim arising, whether based in contract or tort, shall be limited to the amount paid by client for analyses. All claims, including those for negligence and any other cause whatsoever shall be deemed waived unless made in writing and received by Cardinal within thirty (30) days after completion of the applicable service. In no event shall Cardinal be liable for incidental or consequential damages, including, without limitation, business interruptions, loss of use, or loss of profits incurred by client, its subsidiaries, affiliates or successors arising out of or related to the performance of the services hereunder by Cardinal, regardless of whether such claim is based upon any of the above stated reasons or otherwise. Results relate only to the samples identified above. This report shall not be reproduced except in full with written approval of Cardinal Laboratories.



Celey D. Keene, Lab Director/Quality Manager

Analytical Results For:

 BBC International, Inc.
 Cliff Brunson
 P.O. Box 805
 Hobbs NM, 88241
 Fax To: (575) 397-0397

Received:	03/05/2015	Sampling Date:	03/03/2015
Reported:	03/10/2015	Sampling Type:	Soil
Project Name:	LOST TANK 4 FEDERAL #19	Sampling Condition:	Cool & Intact
Project Number:	NONE GIVEN	Sample Received By:	Jodi Henson
Project Location:	WIPP		

Sample ID: SP 2 @ 5' (H500610-07)

BTEx 8021B		mg/kg		Analyzed By: ms					
Analyte	Result	Reporting Limit	Analyzed	Method Blank	BS	% Recovery	True Value QC	RPD	Qualifier
Benzene*	<0.050	0.050	03/09/2015	ND	1.96	97.8	2.00	10.5	
Toluene*	<0.050	0.050	03/09/2015	ND	1.84	91.9	2.00	6.52	
Ethylbenzene*	<0.050	0.050	03/09/2015	ND	2.09	105	2.00	7.91	
Total Xylenes*	<0.150	0.150	03/09/2015	ND	5.64	94.0	6.00	9.81	
Total BTEx	<0.300	0.300	03/09/2015	ND					

Surrogate: 4-Bromofluorobenzene (PID) 113 % 61-154

Chloride, SM4500Cl-B		mg/kg		Analyzed By: AP					
Analyte	Result	Reporting Limit	Analyzed	Method Blank	BS	% Recovery	True Value QC	RPD	Qualifier
Chloride	208	16.0	03/05/2015	ND	400	100	400	0.00	

TPH 8015M		mg/kg		Analyzed By: MS					
Analyte	Result	Reporting Limit	Analyzed	Method Blank	BS	% Recovery	True Value QC	RPD	Qualifier
GRO C6-C10	<10.0	10.0	03/06/2015	ND	188	94.0	200	1.83	
DRO >C10-C28	<10.0	10.0	03/06/2015	ND	196	98.2	200	1.27	

Surrogate: 1-Chlorooctane 84.2 % 47.2-157

Surrogate: 1-Chlorooctadecane 91.1 % 52.1-176

Cardinal Laboratories

*=Accredited Analyte

PLEASE NOTE: Liability and Damages. Cardinal's liability and client's exclusive remedy for any claim arising, whether based in contract or tort, shall be limited to the amount paid by client for analyses. All claims, including those for negligence and any other cause whatsoever shall be deemed waived unless made in writing and received by Cardinal within thirty (30) days after completion of the applicable service. In no event shall Cardinal be liable for incidental or consequential damages, including, without limitation, business interruptions, loss of use, or loss of profits incurred by client, its subsidiaries, affiliates or successors arising out of or related to the performance of the services hereunder by Cardinal, regardless of whether such claim is based upon any of the above stated reasons or otherwise. Results relate only to the samples identified above. This report shall not be reproduced except in full with written approval of Cardinal Laboratories.



Celey D. Keene, Lab Director/Quality Manager

Analytical Results For:

BBC International, Inc.
Cliff Brunson
P.O. Box 805
Hobbs NM, 88241
Fax To: (575) 397-0397

Received:	03/05/2015	Sampling Date:	03/03/2015
Reported:	03/10/2015	Sampling Type:	Soil
Project Name:	LOST TANK 4 FEDERAL #19	Sampling Condition:	Cool & Intact
Project Number:	NONE GIVEN	Sample Received By:	Jodi Henson
Project Location:	WIPP		

Sample ID: SP 2 @ 7' (H500610-08)

BTX 8021B		mg/kg		Analyzed By: ms						
Analyte	Result	Reporting Limit	Analyzed	Method Blank	BS	% Recovery	True Value QC	RPD	Qualifier	
Benzene*	<0.050	0.050	03/09/2015	ND	1.96	97.8	2.00	10.5		
Toluene*	<0.050	0.050	03/09/2015	ND	1.84	91.9	2.00	6.52		
Ethylbenzene*	<0.050	0.050	03/09/2015	ND	2.09	105	2.00	7.91		
Total Xylenes*	<0.150	0.150	03/09/2015	ND	5.64	94.0	6.00	9.81		
Total BTX	<0.300	0.300	03/09/2015	ND						

Surrogate: 4-Bromofluorobenzene (PID) 114 % 61-154

Chloride, SM4500CI-B		mg/kg		Analyzed By: AP					
Analyte	Result	Reporting Limit	Analyzed	Method Blank	BS	% Recovery	True Value QC	RPD	Qualifier
Chloride	<16.0	16.0	03/05/2015	ND	400	100	400	0.00	

TPH 8015M		mg/kg		Analyzed By: MS					
Analyte	Result	Reporting Limit	Analyzed	Method Blank	BS	% Recovery	True Value QC	RPD	Qualifier
GRO C6-C10	<10.0	10.0	03/06/2015	ND	188	94.0	200	1.83	
DRO >C10-C28	<10.0	10.0	03/06/2015	ND	196	98.2	200	1.27	

Surrogate: 1-Chlorooctane 87.7 % 47.2-157

Surrogate: 1-Chlorooctadecane 92.1 % 52.1-176

Cardinal Laboratories

*=Accredited Analyte

PLEASE NOTE: Liability and Damages. Cardinal's liability and client's exclusive remedy for any claim arising, whether based in contract or tort, shall be limited to the amount paid by client for analyses. All claims, including those for negligence and any other cause whatsoever shall be deemed waived unless made in writing and received by Cardinal within thirty (30) days after completion of the applicable service. In no event shall Cardinal be liable for incidental or consequential damages, including, without limitation, business interruptions, loss of use, or loss of profits incurred by client, its subsidiaries, affiliates or successors arising out of or related to the performance of the services hereunder by Cardinal, regardless of whether such claim is based upon any of the above stated reasons or otherwise. Results relate only to the samples identified above. This report shall not be reproduced except in full with written approval of Cardinal Laboratories.



Celey D. Keene, Lab Director/Quality Manager

Analytical Results For:

BBC International, Inc.
Cliff Brunson
P.O. Box 805
Hobbs NM, 88241
Fax To: (575) 397-0397

Received:	03/05/2015	Sampling Date:	03/03/2015
Reported:	03/10/2015	Sampling Type:	Soil
Project Name:	LOST TANK 4 FEDERAL #19	Sampling Condition:	Cool & Intact
Project Number:	NONE GIVEN	Sample Received By:	Jodi Henson
Project Location:	WIPP		

Sample ID: SP 3 @ 1' (H500610-09)

BTX 8021B		mg/kg		Analyzed By: ms					
Analyte	Result	Reporting Limit	Analyzed	Method Blank	BS	% Recovery	True Value QC	RPD	Qualifier
Benzene*	<0.050	0.050	03/09/2015	ND	1.96	97.8	2.00	10.5	
Toluene*	<0.050	0.050	03/09/2015	ND	1.84	91.9	2.00	6.52	
Ethylbenzene*	<0.050	0.050	03/09/2015	ND	2.09	105	2.00	7.91	
Total Xylenes*	<0.150	0.150	03/09/2015	ND	5.64	94.0	6.00	9.81	
Total BTX	<0.300	0.300	03/09/2015	ND					

Surrogate: 4-Bromofluorobenzene (PID) 116 % 61-154

Chloride, SM4500CI-B		mg/kg		Analyzed By: AP					
Analyte	Result	Reporting Limit	Analyzed	Method Blank	BS	% Recovery	True Value QC	RPD	Qualifier
Chloride	2240	16.0	03/05/2015	ND	400	100	400	0.00	

TPH 8015M		mg/kg		Analyzed By: MS					
Analyte	Result	Reporting Limit	Analyzed	Method Blank	BS	% Recovery	True Value QC	RPD	Qualifier
GRO C6-C10	<10.0	10.0	03/06/2015	ND	188	94.0	200	1.83	
DRO >C10-C28	81.3	10.0	03/06/2015	ND	196	98.2	200	1.27	

Surrogate: 1-Chlorooctane 91.0 % 47.2-157

Surrogate: 1-Chlorooctadecane 97.1 % 52.1-176

Cardinal Laboratories

*=Accredited Analyte

PLEASE NOTE: Liability and Damages. Cardinal's liability and client's exclusive remedy for any claim arising, whether based in contract or tort, shall be limited to the amount paid by client for analyses. All claims, including those for negligence and any other cause whatsoever shall be deemed waived unless made in writing and received by Cardinal within thirty (30) days after completion of the applicable service. In no event shall Cardinal be liable for incidental or consequential damages, including, without limitation, business interruptions, loss of use, or loss of profits incurred by client, its subsidiaries, affiliates or successors arising out of or related to the performance of the services hereunder by Cardinal, regardless of whether such claim is based upon any of the above stated reasons or otherwise. Results relate only to the samples identified above. This report shall not be reproduced except in full with written approval of Cardinal Laboratories.



Celey D. Keene, Lab Director/Quality Manager

Analytical Results For:

BBC International, Inc.
Cliff Brunson
P.O. Box 805
Hobbs NM, 88241
Fax To: (575) 397-0397

Received:	03/05/2015	Sampling Date:	03/03/2015
Reported:	03/10/2015	Sampling Type:	Soil
Project Name:	LOST TANK 4 FEDERAL #19	Sampling Condition:	Cool & Intact
Project Number:	NONE GIVEN	Sample Received By:	Jodi Henson
Project Location:	WIPP		

Sample ID: SP 3 @ 3' (H500610-10)

BTEx 8021B		mg/kg		Analyzed By: ms					
Analyte	Result	Reporting Limit	Analyzed	Method Blank	BS	% Recovery	True Value QC	RPD	Qualifier
Benzene*	<0.050	0.050	03/09/2015	ND	1.96	97.8	2.00	10.5	
Toluene*	<0.050	0.050	03/09/2015	ND	1.84	91.9	2.00	6.52	
Ethylbenzene*	<0.050	0.050	03/09/2015	ND	2.09	105	2.00	7.91	
Total Xylenes*	<0.150	0.150	03/09/2015	ND	5.64	94.0	6.00	9.81	
Total BTEx	<0.300	0.300	03/09/2015	ND					

Surrogate: 4-Bromofluorobenzene (PID) 116 % 61-154

Chloride, SM4500CI-B		mg/kg		Analyzed By: AP					
Analyte	Result	Reporting Limit	Analyzed	Method Blank	BS	% Recovery	True Value QC	RPD	Qualifier
Chloride	752	16.0	03/05/2015	ND	400	100	400	0.00	

TPH 8015M		mg/kg		Analyzed By: MS					
Analyte	Result	Reporting Limit	Analyzed	Method Blank	BS	% Recovery	True Value QC	RPD	Qualifier
GRO C6-C10	<10.0	10.0	03/06/2015	ND	188	94.0	200	1.83	
DRO >C10-C28	<10.0	10.0	03/06/2015	ND	196	98.2	200	1.27	

Surrogate: 1-Chlorooctane 82.7 % 47.2-157

Surrogate: 1-Chlorooctadecane 89.1 % 52.1-176

Cardinal Laboratories

*=Accredited Analyte

PLEASE NOTE: Liability and Damages. Cardinal's liability and client's exclusive remedy for any claim arising, whether based in contract or tort, shall be limited to the amount paid by client for analyses. All claims, including those for negligence and any other cause whatsoever shall be deemed waived unless made in writing and received by Cardinal within thirty (30) days after completion of the applicable service. In no event shall Cardinal be liable for incidental or consequential damages, including, without limitation, business interruptions, loss of use, or loss of profits incurred by client, its subsidiaries, affiliates or successors arising out of or related to the performance of the services hereunder by Cardinal, regardless of whether such claim is based upon any of the above stated reasons or otherwise. Results relate only to the samples identified above. This report shall not be reproduced except in full with written approval of Cardinal Laboratories.



Celey D. Keene, Lab Director/Quality Manager

Analytical Results For:

BBC International, Inc.
Cliff Brunson
P.O. Box 805
Hobbs NM, 88241
Fax To: (575) 397-0397

Received:	03/05/2015	Sampling Date:	03/03/2015
Reported:	03/10/2015	Sampling Type:	Soil
Project Name:	LOST TANK 4 FEDERAL #19	Sampling Condition:	Cool & Intact
Project Number:	NONE GIVEN	Sample Received By:	Jodi Henson
Project Location:	WIPP		

Sample ID: SP 3 @ 4' (H500610-11)

BTX 8021B		mg/kg		Analyzed By: ms						
Analyte	Result	Reporting Limit	Analyzed	Method Blank	BS	% Recovery	True Value QC	RPD	Qualifier	
Benzene*	<0.050	0.050	03/09/2015	ND	1.96	97.8	2.00	10.5		
Toluene*	<0.050	0.050	03/09/2015	ND	1.84	91.9	2.00	6.52		
Ethylbenzene*	<0.050	0.050	03/09/2015	ND	2.09	105	2.00	7.91		
Total Xylenes*	<0.150	0.150	03/09/2015	ND	5.64	94.0	6.00	9.81		
Total BTX	<0.300	0.300	03/09/2015	ND						

Surrogate: 4-Bromofluorobenzene (PID) 116 % 61-154

Chloride, SM4500Cl-B		mg/kg		Analyzed By: AP					
Analyte	Result	Reporting Limit	Analyzed	Method Blank	BS	% Recovery	True Value QC	RPD	Qualifier
Chloride	208	16.0	03/05/2015	ND	400	100	400	0.00	

TPH 8015M		mg/kg		Analyzed By: MS					
Analyte	Result	Reporting Limit	Analyzed	Method Blank	BS	% Recovery	True Value QC	RPD	Qualifier
GRO C6-C10	<10.0	10.0	03/06/2015	ND	188	94.0	200	1.83	
DRO >C10-C28	<10.0	10.0	03/06/2015	ND	196	98.2	200	1.27	

Surrogate: 1-Chlorooctane 83.9 % 47.2-157

Surrogate: 1-Chlorooctadecane 89.5 % 52.1-176

Cardinal Laboratories

*=Accredited Analyte

PLEASE NOTE: Liability and Damages. Cardinal's liability and client's exclusive remedy for any claim arising, whether based in contract or tort, shall be limited to the amount paid by client for analyses. All claims, including those for negligence and any other cause whatsoever shall be deemed waived unless made in writing and received by Cardinal within thirty (30) days after completion of the applicable service. In no event shall Cardinal be liable for incidental or consequential damages, including, without limitation, business interruptions, loss of use, or loss of profits incurred by client, its subsidiaries, affiliates or successors arising out of or related to the performance of the services hereunder by Cardinal, regardless of whether such claim is based upon any of the above stated reasons or otherwise. Results relate only to the samples identified above. This report shall not be reproduced except in full with written approval of Cardinal Laboratories.



Celey D. Keene, Lab Director/Quality Manager

Analytical Results For:

BBC International, Inc.
Cliff Brunson
P.O. Box 805
Hobbs NM, 88241
Fax To: (575) 397-0397

Received:	03/05/2015	Sampling Date:	03/03/2015
Reported:	03/10/2015	Sampling Type:	Soil
Project Name:	LOST TANK 4 FEDERAL #19	Sampling Condition:	Cool & Intact
Project Number:	NONE GIVEN	Sample Received By:	Jodi Henson
Project Location:	WIPP		

Sample ID: SP 3 @ 6' (H500610-12)

BTEx 8021B		mg/kg		Analyzed By: ms					
Analyte	Result	Reporting Limit	Analyzed	Method Blank	BS	% Recovery	True Value QC	RPD	Qualifier
Benzene*	<0.050	0.050	03/09/2015	ND	1.96	97.8	2.00	10.5	
Toluene*	<0.050	0.050	03/09/2015	ND	1.84	91.9	2.00	6.52	
Ethylbenzene*	<0.050	0.050	03/09/2015	ND	2.09	105	2.00	7.91	
Total Xylenes*	<0.150	0.150	03/09/2015	ND	5.64	94.0	6.00	9.81	
Total BTEx	<0.300	0.300	03/09/2015	ND					

Surrogate: 4-Bromofluorobenzene (PID) 116 % 61-154

Chloride, SM4500CI-B		mg/kg		Analyzed By: AP					
Analyte	Result	Reporting Limit	Analyzed	Method Blank	BS	% Recovery	True Value QC	RPD	Qualifier
Chloride	64.0	16.0	03/05/2015	ND	400	100	400	0.00	

TPH 8015M		mg/kg		Analyzed By: MS					
Analyte	Result	Reporting Limit	Analyzed	Method Blank	BS	% Recovery	True Value QC	RPD	Qualifier
GRO C6-C10	<10.0	10.0	03/06/2015	ND	188	94.0	200	1.83	
DRO >C10-C28	<10.0	10.0	03/06/2015	ND	196	98.2	200	1.27	

Surrogate: 1-Chlorooctane 85.9 % 47.2-157

Surrogate: 1-Chlorooctadecane 89.8 % 52.1-176

Cardinal Laboratories

*=Accredited Analyte

PLEASE NOTE: Liability and Damages. Cardinal's liability and client's exclusive remedy for any claim arising, whether based in contract or tort, shall be limited to the amount paid by client for analyses. All claims, including those for negligence and any other cause whatsoever shall be deemed waived unless made in writing and received by Cardinal within thirty (30) days after completion of the applicable service. In no event shall Cardinal be liable for incidental or consequential damages, including, without limitation, business interruptions, loss of use, or loss of profits incurred by client, its subsidiaries, affiliates or successors arising out of or related to the performance of the services hereunder by Cardinal, regardless of whether such claim is based upon any of the above stated reasons or otherwise. Results relate only to the samples identified above. This report shall not be reproduced except in full with written approval of Cardinal Laboratories.



Celey D. Keene, Lab Director/Quality Manager

Notes and Definitions

ND	Analyte NOT DETECTED at or above the reporting limit
RPD	Relative Percent Difference
**	Samples not received at proper temperature of 6°C or below.
***	Insufficient time to reach temperature.
-	Chloride by SM4500Cl-B does not require samples be received at or below 6°C Samples reported on an as received basis (wet) unless otherwise noted on report

Cardinal Laboratories

*=Accredited Analyte

PLEASE NOTE: Liability and Damages. Cardinal's liability and client's exclusive remedy for any claim arising, whether based in contract or tort, shall be limited to the amount paid by client for analyses. All claims, including those for negligence and any other cause whatsoever shall be deemed waived unless made in writing and received by Cardinal within thirty (30) days after completion of the applicable service. In no event shall Cardinal be liable for incidental or consequential damages, including, without limitation, business interruptions, loss of use, or loss of profits incurred by client, its subsidiaries, affiliates or successors arising out of or related to the performance of the services hereunder by Cardinal, regardless of whether such claim is based upon any of the above stated reasons or otherwise. Results relate only to the samples identified above. This report shall not be reproduced except in full with written approval of Cardinal Laboratories.



Celey D. Keene, Lab Director/Quality Manager



ARDINAL LABORATORIES

101 East Marland, Hobbs, NM 88240
(505) 393-2326 FAX (505) 393-2476

CHAIN-OF-CUSTODY AND ANALYSIS REQUEST

Company Name: BBC International, Inc.

Project Manager: Cliff Brunson

Address: P.O. Box 805

City: Hobbs

Phone #: 575-397-6388

Project #:

Project Name: Lost Tank 4 Federal #19

Project Location: WIPP

Sampler Name: Jeff Deneles

FOR LAB USE ONLY

Lab I.D.

Sample I.D.

H500101D

SP101

SP201

SP301

SP401

SP501

SP601

SP701

SP801

SP901

SP1001

SP1101

SP1201

SP1301

SP1401

SP1501

SP1601

SP1701

SP1801

SP1901

SP2001

(G)RAB OR (C)OMP.

CONTAINERS

GROUNDWATER

WASTEWATER

SOIL

OIL

SLUDGE

OTHER :

ACID/BASE:

ICE / COOL

OTHER :

DATE

TIME

TPH

BTEX

CL-

BILL TO

P.O. #:

Company:

Attn:

Address:

City:

State:

Phone #:

Fax #:

ANALYSIS REQUEST

PLEASE NOTE: Liability and Damages. Cardinal's liability and clients' exclusive remedy for any claim arising whether based in contract or tort, shall be limited to the amount paid by the client for the analyses. All claims, including those for negligence and any other cause whatsoever shall be deemed waived unless made in writing and received by Cardinal within 30 days after completion of the applicable service. In no event shall Cardinal be liable for incidental or consequential damages, including without limitation, business interruptions, loss of use, or loss of profits incurred by client, its subsidiaries, affiliates or successors arising out of or related to the performance of services hereunder by Cardinal, regardless of whether such claim is based upon any of the above stated reasons or otherwise.

Relinquished By:

Received By:

Phone Result:

Add'l Phone #:

Add'l Fax #:

REMARKS:

Relinquished By:

Received By:

Phone Result:

Add'l Phone #:

Add'l Fax #:

REMARKS:

Delivered By: (Circle One)

Sampler - UPS - Bus - Other:

3.4e

† Cardinal cannot accept verbal changes. Please fax written changes to 505-393-2476

#54



CARDINAL LABORATORIES

101 East Marland, Hobbs, NM 88240
(505) 393-2326 FAX (505) 393-2476

CHAIN-OF-CUSTODY AND ANALYSIS REQUEST

Company Name: BBC International, Inc.

Project Manager: Cliff Brunson

Address: P.O. Box 805

City: Hobbs

Phone #: 575-397-6388

Project #:

Project Name:

Project Location:

Sampler Name:

P.O. #:

Company:

Attn:

Address:

City:

State:

Zip:

Phone #:

Fax #:

BILL TO

ANALYSIS REQUEST

FOR LAB USE ONLY

Lab I.D.

Sample I.D.

H500610

11

3304

3/3/15

(G)RAB OR (C)OMP.

CONTAINERS

GROUNDWATER

WASTEWATER

SOIL

OIL

SLUDGE

OTHER :

ACID/BASE:

ICE / COOL

OTHER :

DATE

TIME

TPH
BTEX
CI-

PLEASE NOTE: Liability and Damages. Cardinal's liability and client's exclusive remedy for any claim arising from this contract or tort, shall be limited to the amount paid by the client for the analysis. All claims including those for negligence and any other cause whatsoever shall be deemed waived unless made in writing and received by Cardinal within 30 days after completion of the applicable service. In no event shall Cardinal be liable for incidental or consequential damages, including without limitation, business interruptions, loss of use, or loss of profits incurred by client, its subsidiaries, affiliates or successors arising out of or related to the performance of services hereunder by Cardinal, regardless of whether such claim is based upon any of the above stated reasons or otherwise.

Relinquished By:

Received By:

Phone Result: ☐ Yes ☐ No Add'l Phone #:

Fax Result: ☐ Yes ☐ No Add'l Fax #:

REMARKS:

Relinquished By:

Date:

Time:

Received By:

Time:

Delivered By: (Circle One)

Sampler - UPS - Bus - Other:

Sample Condition

Cool ☐ Intact ☐

Yes ☐ No ☐

CHECKED BY:

(Initials)

† Cardinal cannot accept verbal changes. Please fax written changes to 505-393-2476

#54

District I
1625 N. French Dr., Hobbs, NM 88240
District II
811 S. First St., Artesia, NM 88210
District III
1000 Rio Brazos Road, Aztec, NM 87410
District IV
1220 S. St. Francis Dr., Santa Fe, NM 87505

State of New Mexico
Energy Minerals and Natural Resources

Oil Conservation Division
1220 South St. Francis Dr.
Santa Fe, NM 87505

Form C-141
Revised August 8, 2011

Submit 1 Copy to appropriate District Office in
accordance with 19.15.29 NMAC.

Release Notification and Corrective Action

OPERATOR

☒ Initial Report ☐ Final Report

Name of Company	Oxy Permian Ltd.	Contact	Chancey Summers
Address	1017 W. Stanolind Rd, Hobbs, NM 88240	Telephone No.	(575) 397-8216
Facility Name	Lost Tank 4 Federal #19 Battery	Facility Type	Well/Battery
Surface Owner	Mineral Owner	API No.	30-015-37896

LOCATION OF RELEASE

Unit Letter	Section	Township	Range	Feet from the	North/South Line	Feet from the	East/West Line	County
J	4	22S	31E					Eddy County, NM

Latitude N 32.41907° Longitude W 103.78400°

NATURE OF RELEASE

Type of Release	Oil and produced water	Volume of Release	10 bbls oil, 30 bbls produced water	Volume Recovered	0 bbls
Source of Release	Corrosion of a 2" steel production flow line	Date and Hour of Occurrence	11/03/2014	Date and Hour of Discovery	
Was Immediate Notice Given?	<input checked="" type="checkbox"/> Yes <input type="checkbox"/> No <input type="checkbox"/> Not Required	If YES, To Whom?	Mike Bratcher- NMOCD, Sol Hughes- BLM		
By Whom?	Kathy Purvis, BBC International	Date and Hour	11/04/2014 @ 4:29 pm		
Was a Watercourse Reached?	<input type="checkbox"/> Yes <input checked="" type="checkbox"/> No	If YES, Volume Impacting the Watercourse.			

If a Watercourse was Impacted, Describe Fully.*

Describe Cause of Problem and Remedial Action Taken.*

Corrosion of a 2" steel production flow line caused 10 bbls of oil and 30 bbls of produced water to leak onto the ground. No fluids were recovered and the line was repaired/replaced.

Describe Area Affected and Cleanup Action Taken.*

The affected area is approximately 90' x 60' on and off location. Remediation will be completed in accordance with a remediation plan approved by NMOCD and the BLM.

I hereby certify that the information given above is true and complete to the best of my knowledge and understand that pursuant to NMOCD rules and regulations all operators are required to report and/or file certain release notifications and perform corrective actions for releases which may endanger public health or the environment. The acceptance of a C-141 report by the NMOCD marked as "Final Report" does not relieve the operator of liability should their operations have failed to adequately investigate and remediate contamination that pose a threat to ground water, surface water, human health or the environment. In addition, NMOCD acceptance of a C-141 report does not relieve the operator of responsibility for compliance with any other federal, state, or local laws and/or regulations.

Signature: 	<u>OIL CONSERVATION DIVISION</u>		
Printed Name: Chancey Summers	Approved by Environmental Specialist:		
Title: HES Advisor	Approval Date:	Expiration Date:	
E-mail Address: Chancey.Summers@oxy.com	Conditions of Approval:		Attached <input type="checkbox"/>
Date: 11-13-14	Phone: (575) 397-8216		

* Attach Additional Sheets If Necessary