

Excavation Map

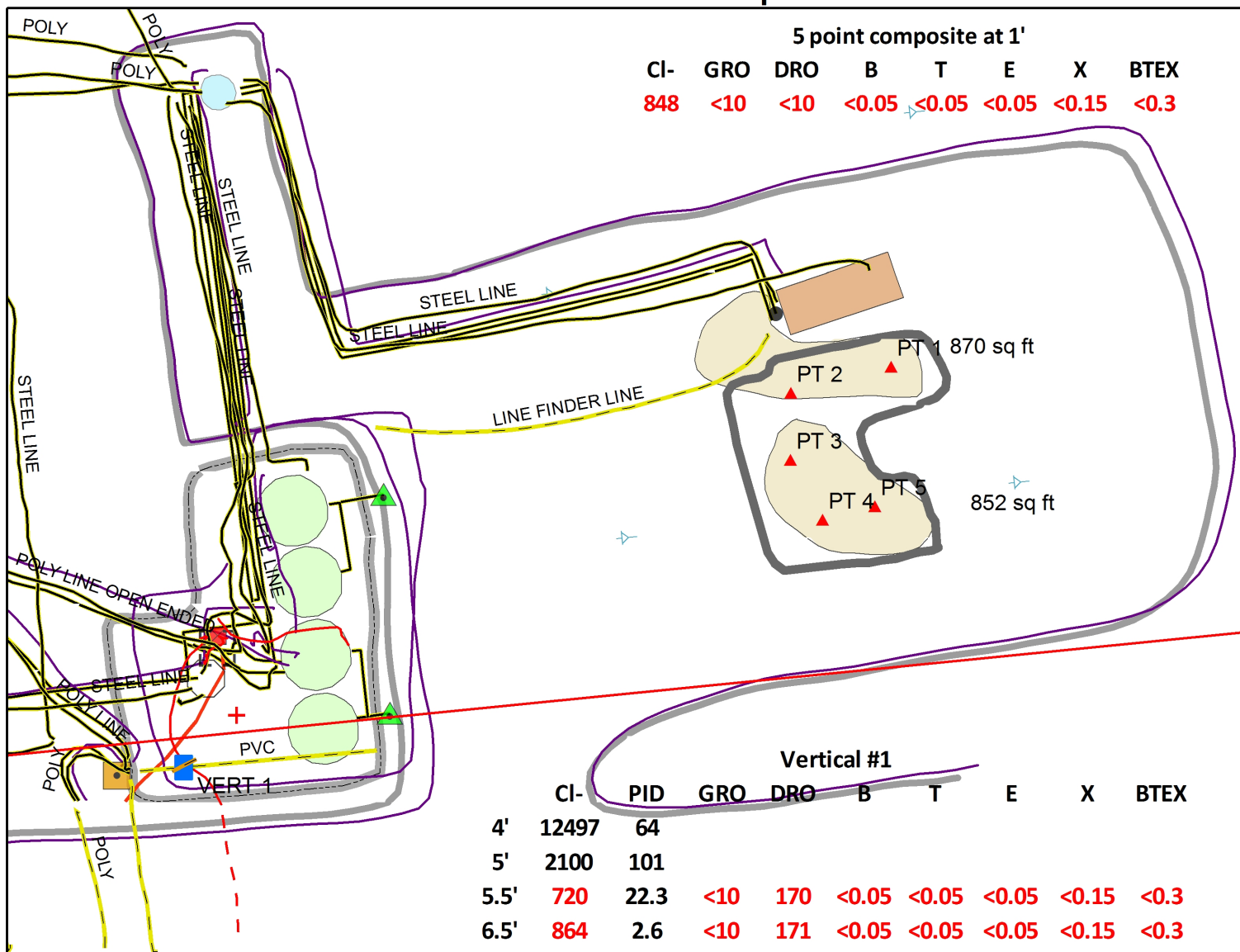

Legend

- | | | |
|--------------------------|----------------|------------------|
| HYDROVAC POINT - ROCK | ELECTRIC MOTOR | ELECTRICAL LINE |
| BURIED PVC PIPELINE | ELECTRICAL BOX | PAD/ROAD EDGE |
| 5 PT. COMP SAMPLE POINTS | WELLHEAD | SURFACE PIPELINE |
| VERTICAL | LOAD BOX | SCRAPE |
| BURIED ELECTRICAL LINE | OPEN TANK | PUMP JACK |
| BURIED PIPELINE | OTHER | STAIN |
| OVERHEAD ELECTRICAL | VALVE | STORAGE TANK |
| SURFACE PIPELINE | LINE | TREATER |
| DEADMAN | BERM | |

Landowner = BLM DGW = 58 ft



**GP II ENERGY
LITTLEFIELD BO
FEDERAL #2 BATTERY
(2RP-1738)**
LEGALS: UL/A Sec. 34
T26S - R29E
EDDY COUNTY, NM

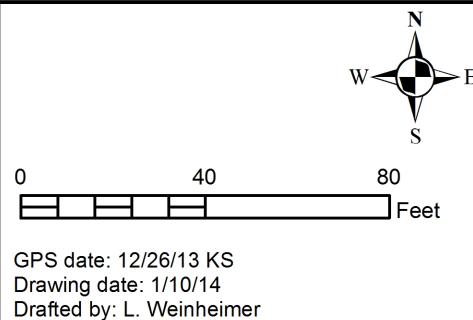

GP II Energy Littlefield Bo #2 Battery

Unit Letter A, Section 34, T26S, R29E



Vertical abandoned due to unmarked pipeline discovered 10/3/13



Rock at base of vertical 12/26/13



Excavating with hydrovac, facing south 12/26/13



Vertical completed, facing south 12/26/13



Checking for rock, facing north

12/26/13



Rock evident at base of vertical

12/26/13