



Turner B #043

REMEDIATION WORK PLAN

API No. 30-015-05314

Release Date: February 29, 2012

Unit Letter M, Section 20, Township 17 South, Range 31 East

NMOCD Case #: 2R-1111

June 9, 2016

Prepared by:

Michael Burton

Environmental Department
Diversified Field Service, Inc.

206 W. Snyder

Hobbs, NM 88240

Phone: (575)964-8394

Fax: (575)393-8396

Mike Bratcher
Environmental Specialist
NM Oil Conservation District – Division 2
811 S. First St.
Artesia, NM 88210

RE: Linn Energy – Turner B #043 – Remediation Work Plan
UL/L, Section 29, T17S, R31E
API No. 30-015-05314
NMOCD Case #: 2R-1111

Mr. Bratcher,

Linn Energy (Linn) has retained Diversified Field Service, Inc. (DFSI) to address environmental issues for the site detailed herein.

The site is located west of Maljamar, NM, in Eddy County. On February 29, 2012, the spill resulted from an accidental opening of a produced water valve, releasing a total of 6 barrels of produced water, with none recovered. The impacted area is on the east side of the location. An initial C-141 was submitted to the NMOCD on April 16, 2012, and approved on May 7, 2012 (Appendix I).

Site Assessment and Delineation

On May 10, 2016, DFSI personnel were on site to obtain samples within the leak area (Appendix II). Twelve samples were obtained and field sampled for chloride levels, as well as BTEX (Figure 2). The BTEX samples were performed using a Mini Rae Photoionization Detector (PID). Field samples were submitted for analysis at Cardinal Laboratories of Hobbs, NM to obtain confirmation, resulting in chloride and TPH concentrations that decreased with depth to below or near regulatory guidelines. BTEX concentrations were below regulatory guidelines throughout (Appendix III).

DFSI has conducted a groundwater study of the area and has determined, according to the New Mexico Office of the State Engineer, there is no groundwater beneath this site. Therefore, no eminent danger of groundwater impact or threat to life is anticipated (Appendix IV).

Conclusion

After careful review DFSI, on behalf of Linn Energy, would like to propose the following:

Excavate the area around SP1, SP2, SP5 and SP9 to a depth of 4' bgs. At the base of the excavation, a 20-mil reinforced poly liner or river rock layer will be installed to inhibit the downward migration of constituents. The area around SP6 will be excavated to a depth of 2' bgs. The area around SP3, SP4 and SP7 will be scraped 6". The excavated areas will be backfilled with clean, imported soil to ground surface and contoured to the surrounding area. The excavated areas will be backfilled with clean, imported soil to ground surface and contoured to the surrounding area. The release area, including the remainder of the release area, SP8, SP10, SP11 and SP12, will seeded with an approved BLM-NMOCD mix (Figure 2).

Following the approval of the above plan, DFSI will submit all proper closure documentation to the NMOCD and BLM in accordance to the State and Federal Guidelines set forth.

Please feel free to contact me with any questions concerning this remediation plan request.

Sincerely,



Michael Burton
Environmental Operations Director | Diversified Field Service, Inc.
206 West Snyder | Hobbs, NM 88240
Office: (575)964-8394 | Mobile: (575)390-5454
Fax: (575)964-8396 | Email: mburton@diversifiedfsi.com

cc Shelly Tucker

Figure 1 – Site Map
Figure 2 – Proposed Work
Appendix I – Initial C-141
Appendix II – Site Photos
Appendix III – Laboratory Analysis
Appendix IV – Groundwater Study

Soil Delineation

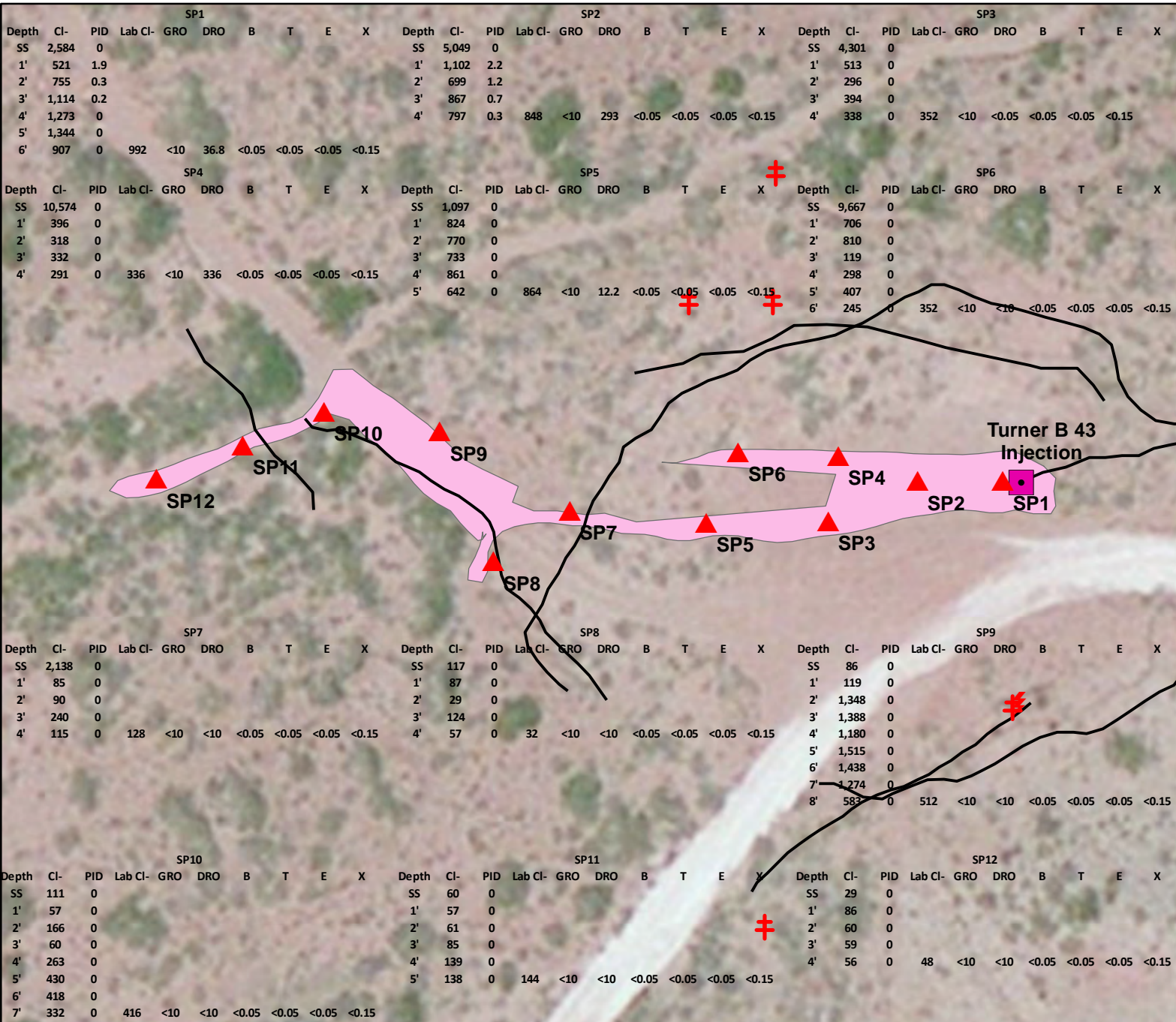

SP1									
Depth	Cl-	PID	Lab Cl-	GRO	DRO	B	T	E	X
SS	2,584	0							
1'	521	1.9							
2'	755	0.3							
3'	1,114	0.2							
4'	1,273	0							
5'	1,344	0							
6'	907	0	992	<10	36.8	<0.05	<0.05	<0.05	<0.15

SP2									
Depth	Cl-	PID	Lab Cl-	GRO	DRO	B	T	E	X
SS	5,049	0							
1'	1,102	2.2							
2'	699	1.2							
3'	867	0.7							
4'	797	0.3	848	<10	293	<0.05	<0.05	<0.05	<0.15

SP3									
Depth	Cl-	PID	Lab Cl-	GRO	DRO	B	T	E	X
SS	4,301	0							
1'	513	0							
2'	296	0							
3'	394	0							
4'	338	0	352	<10	<0.05	<0.05	<0.05	<0.05	<0.15

SP4									
Depth	Cl-	PID	Lab Cl-	GRO	DRO	B	T	E	X
SS	10,574	0							
1'	396	0							
2'	318	0							
3'	332	0							
4'	291	0	336	<10	336	<0.05	<0.05	<0.05	<0.15

SP5									
Depth	Cl-	PID	Lab Cl-	GRO	DRO	B	T	E	X
SS	1,097	0							
1'	824	0							
2'	770	0							
3'	733	0							
4'	861	0							
5'	642	0	864	<10	12.2	<0.05	<0.05	<0.05	<0.15

SP6									
Depth	Cl-	PID	Lab Cl-	GRO	DRO	B	T	E	X
SS	9,667	0							
1'	706	0							
2'	810	0							
3'	119	0							
4'	298	0							
5'	407	0							
6'	245	0	352	<10	<10	<0.05	<0.05	<0.05	<0.15

SP7									
Depth	Cl-	PID	Lab Cl-	GRO	DRO	B	T	E	X
SS	2,138	0							
1'	85	0							
2'	90	0							
3'	240	0							
4'	115	0	128	<10	<10	<0.05	<0.05	<0.05	<0.15

SP8									
Depth	Cl-	PID	Lab Cl-	GRO	DRO	B	T	E	X
SS	117	0							
1'	87	0							
2'	29	0							
3'	124	0							
4'	57	0	32	<10	<10	<0.05	<0.05	<0.05	<0.15

SP9									
Depth	Cl-	PID	Lab Cl-	GRO	DRO	B	T	E	X
SS	86	0							
1'	119	0							
2'	1,348	0							
3'	1,388	0							
4'	1,180	0							
5'	1,515	0							
6'	1,438	0							
7'	1,274	0							
8'	583	0	512	<10	<10	<0.05	<0.05	<0.05	<0.15

SP10									
Depth	Cl-	PID	Lab Cl-	GRO	DRO	B	T	E	X
SS	111	0							
1'	57	0							
2'	166	0							
3'	60	0							
4'	263	0							
5'	430	0							
6'	418	0							
7'	332	0	416	<10	<10	<0.05	<0.05	<0.05	<0.15

SP11									
Depth	Cl-	PID	Lab Cl-	GRO	DRO	B	T	E	X
SS	60	0							
1'	57	0							
2'	61	0							
3'	85	0							
4'	139	0							
5'	138	0	144	<10	<10	<0.05	<0.05	<0.05	<0.15

SP12									
Depth	Cl-	PID	Lab Cl-	GRO	DRO	B	T	E	X
SS	29	0							
1'	86	0							
2'	60	0							
3'	59	0							
4'	56	0	48	<10	<10	<0.05	<0.05	<0.05	<0.15

Legend

- Sample Points
- Electrical Box
- Power Pole
- Injection
- Above Ground Line
- Produced Water (4,858 sq ft)

Source: Esri, DigitalGlobe, GeoEye, Earthstar Geographics, CNES/Airbus DS, USDA, USGS, AEX, Getmapping, Aerogrid, IGN, IGP, swisstopo, and the GIS User Community



Linn
Turner B #043
Unit Letter M, Section 20, T17S, R31E
Eddy County, NM
API #: 30-015-05314
NMOCD Case #: 2R-1111







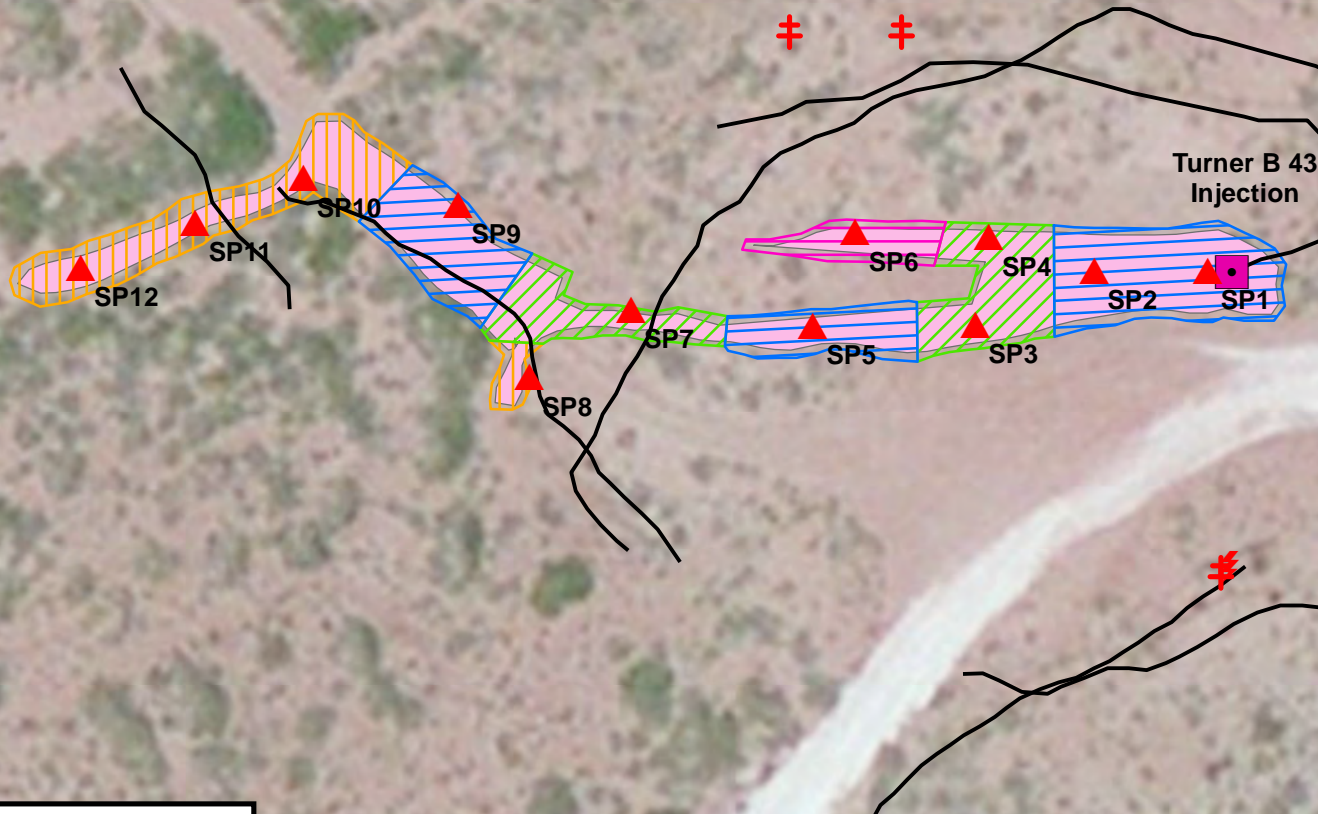



Mapped: 04/14/2014 LC
 Drafted by: L. Flores
 04/21/2016

0 10 20 40 60 80 Feet

Proposed Work



Legend

-  Sample Points
-  Electrical Box
-  Power Pole
-  Injection
-  Above Ground Line
-  Proposed Excavation to 4' bgs
-  Proposed Excavation to 2' bgs
-  Proposed 6" Scrape
-  Seeding
-  Produced Water (4,858 sq ft)

Source: Esri, DigitalGlobe, GeoEye, Earthstar Geographics, CNES/Airbus DS, USDA, USGS, AEX, Getmapping, Aerogrid, IGN, IGP, swisstopo, and the GIS User Community



Linn
Turner B #043
Unit Letter M, Section 20, T17S, R31E
Eddy County, NM
API #: 30-015-05314
NMOCD Case #: 2R-1111

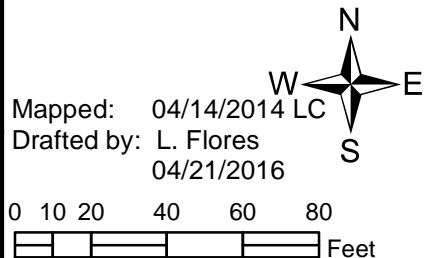

Appendix I

INITIAL C-141

Diversified Field Service, Inc.
206 W. Snyder
Hobbs, NM 88240
(575) 964-8394

District I
1625 N French Dr., Hobbs, NM 88240
District II
1301 W Grand Avenue, Artesia, NM 88210
District III
1000 Rio Brazos Road, Aztec, NM 87410
District IV
1220 S St. Francis Dr., Santa Fe, NM 87505

State of New Mexico
Energy Minerals and Natural Resources
Oil Conservation Division
1220 South St. Francis Dr.
Santa Fe, NM 87505

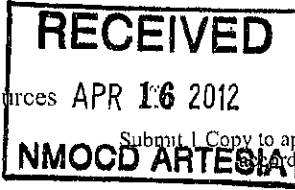

Form C-141
Revised October 10, 2003

Submit 1 Copy to appropriate District Office in accordance with 19.15.29 NMAC

Release Notification and Corrective Action

NMLB 121285/135

OPERATOR		<input checked="" type="checkbox"/> Initial Report	<input type="checkbox"/> Final Report
Name of Company: Linn Operating <i>269324</i>	Contact: Joe Hernandez		
Address: 2130 W. Bender Hobbs, NM 88240	Telephone No.: 575-738-1739		
Facility Name: Turner B #43	Facility Type: Injection		
Surface Owner: Federal	Mineral Owner: Federal	API No.: 3001505314	

LOCATION OF RELEASE

Unit Letter M	Section 20	Township 17S	Range 31E	Feet from the 660	North/South Line South	Feet from the 560	East/West Line West	County Eddy
------------------	---------------	-----------------	--------------	----------------------	---------------------------	----------------------	------------------------	----------------

Latitude: 32.8146093770074 Longitude: -103.898657187642

NATURE OF RELEASE

Type of Release: Produced Water	Volume of Release: 6	Volume Recovered: 0
Source of Release: Valve	Date and Hour of Occurrence: 2/29/2012 7am	Date and Hour of Discovery: 2/29/2012 7:30am
Was Immediate Notice Given? <input checked="" type="checkbox"/> Yes <input type="checkbox"/> No <input type="checkbox"/> Not Required	If YES, To Whom? M. Bratcher-NM OCD Terry Gregston-BLM	
By Whom? Joe Hernandez	Date and Hour 2/29/2012 2pm	
Was a Watercourse Reached? <input type="checkbox"/> Yes <input checked="" type="checkbox"/> No	If YES, Volume Impacting the Watercourse.	
If a Watercourse was Impacted, Describe Fully.*:		
Describe Cause of Problem and Remedial Action Taken.*: Cow rubbed his back and opened 1/2" valve which was missing safety lock. Produced water leaked from well 187 ft L x 3 1/2ft W east of location/ wellhead. Valve handles have been removed from all injection wellheads.		
Describe Area Affected and Cleanup Action Taken * : Pending		
I hereby certify that the information given above is true and complete to the best of my knowledge and understand that pursuant to NMOCD rules and regulations all operators are required to report and/or file certain release notifications and perform corrective actions for releases which may endanger public health or the environment. The acceptance of a C-141 report by the NMOCD marked as "Final Report" does not relieve the operator of liability should their operations have failed to adequately investigate and remediate contamination that pose a threat to ground water, surface water, human health or the environment. In addition, NMOCD acceptance of a C-141 report does not relieve the operator of responsibility for compliance with any other federal, state, or local laws and/or regulations.		
Signature: <i>Joe Hernandez</i>	OIL CONSERVATION DIVISION	
Printed Name: Joe Hernandez	Signed By <i>Mike Hernandez</i> Approved by District Supervisor:	
Title: Production Foreman	Approval Date: MAY 07 2012	Expiration Date:
E-mail Address: jhernandez@linenergy.com	Conditions of Approval:	Attached <input type="checkbox"/>
Date: 04/16/2012 Phone: 575-942-9492	Remediation per OCD Rules & Guidelines. SUBMIT REMEDIATION PROPOSAL NOT LATER THAN: 6/17/2012	

* Attach Additional Sheets If Necessary

2RP-1111

Appendix II

SITE PHOTOS



May 19, 2016

DENNIS POTTER
LINN OPERATING-HOBBS
2130 W. BENDER
HOBBS, NM 88240

RE: TURNER B #43

Enclosed are the results of analyses for samples received by the laboratory on 05/16/16 8:45.

Cardinal Laboratories is accredited through Texas NELAP under certificate number T104704398-15-7. Accreditation applies to drinking water, non-potable water and solid and chemical materials. All accredited analytes are denoted by an asterisk (*). For a complete list of accredited analytes and matrices visit the TCEQ website at www.tceq.texas.gov/field/qa/lab_accred_certif.html.

Cardinal Laboratories is accredited through the State of Colorado Department of Public Health and Environment for:

Method EPA 552.2	Haloacetic Acids (HAA-5)
Method EPA 524.2	Total Trihalomethanes (TTHM)
Method EPA 524.4	Regulated VOCs (V1, V2, V3)

Accreditation applies to public drinking water matrices.

This report meets NELAP requirements and is made up of a cover page, analytical results, and a copy of the original chain-of-custody. If you have any questions concerning this report, please feel free to contact me.

Sincerely,

A handwritten signature in black ink that reads "Celey D. Keene". The signature is written in a cursive style.

Celey D. Keene
Lab Director/Quality Manager

Analytical Results For:

 LINN OPERATING-HOBBS
 DENNIS POTTER
 2130 W. BENDER
 HOBBS NM, 88240
 Fax To: (575) 738-1740

Received:	05/16/2016	Sampling Date:	05/13/2016
Reported:	05/19/2016	Sampling Type:	Soil
Project Name:	TURNER B #43	Sampling Condition:	Cool & Intact
Project Number:	NONE GIVEN	Sample Received By:	Jodi Henson
Project Location:	NOT GIVEN		

Sample ID: SAMPLE PT. 1 @ 6' (H601060-01)

BTEX 8021B		mg/kg		Analyzed By: MS					
Analyte	Result	Reporting Limit	Analyzed	Method Blank	BS	% Recovery	True Value QC	RPD	Qualifier
Benzene*	<0.050	0.050	05/16/2016	ND	2.15	108	2.00	0.544	
Toluene*	<0.050	0.050	05/16/2016	ND	2.11	105	2.00	1.46	
Ethylbenzene*	<0.050	0.050	05/16/2016	ND	1.94	97.0	2.00	1.62	
Total Xylenes*	<0.150	0.150	05/16/2016	ND	6.19	103	6.00	0.856	
Total BTEX	<0.300	0.300	05/16/2016	ND					

Surrogate: 4-Bromofluorobenzene (PID) 99.1 % 73.6-140

Chloride, SM4500Cl-B		mg/kg		Analyzed By: AP					
Analyte	Result	Reporting Limit	Analyzed	Method Blank	BS	% Recovery	True Value QC	RPD	Qualifier
Chloride	992	16.0	05/17/2016	ND	416	104	400	0.00	

TPH 8015M		mg/kg		Analyzed By: MS					
Analyte	Result	Reporting Limit	Analyzed	Method Blank	BS	% Recovery	True Value QC	RPD	Qualifier
GRO C6-C10	<10.0	10.0	05/16/2016	ND	165	82.3	200	7.88	
DRO >C10-C28	36.8	10.0	05/16/2016	ND	178	88.8	200	13.1	QR-03

Surrogate: 1-Chlorooctane 77.0 % 35-147

Surrogate: 1-Chlorooctadecane 93.7 % 28-171

Cardinal Laboratories

*=Accredited Analyte

PLEASE NOTE: Liability and Damages. Cardinal's liability and client's exclusive remedy for any claim arising, whether based in contract or tort, shall be limited to the amount paid by client for analyses. All claims, including those for negligence and any other cause whatsoever shall be deemed waived unless made in writing and received by Cardinal within thirty (30) days after completion of the applicable service. In no event shall Cardinal be liable for incidental or consequential damages, including, without limitation, business interruptions, loss of use, or loss of profits incurred by client, its subsidiaries, affiliates or successors arising out of or related to the performance of the services hereunder by Cardinal, regardless of whether such claim is based upon any of the above stated reasons or otherwise. Results relate only to the samples identified above. This report shall not be reproduced except in full with written approval of Cardinal Laboratories.



Celey D. Keene, Lab Director/Quality Manager

Analytical Results For:

 LINN OPERATING-HOBBS
 DENNIS POTTER
 2130 W. BENDER
 HOBBS NM, 88240
 Fax To: (575) 738-1740

Received:	05/16/2016	Sampling Date:	05/10/2016
Reported:	05/19/2016	Sampling Type:	Soil
Project Name:	TURNER B #43	Sampling Condition:	Cool & Intact
Project Number:	NONE GIVEN	Sample Received By:	Jodi Henson
Project Location:	NOT GIVEN		

Sample ID: SAMPLE PT. 2 @ 4' (H601060-02)

BTEX 8021B		mg/kg		Analyzed By: MS						
Analyte	Result	Reporting Limit	Analyzed	Method Blank	BS	% Recovery	True Value QC	RPD	Qualifier	
Benzene*	<0.050	0.050	05/16/2016	ND	2.15	108	2.00	0.544		
Toluene*	<0.050	0.050	05/16/2016	ND	2.11	105	2.00	1.46		
Ethylbenzene*	<0.050	0.050	05/16/2016	ND	1.94	97.0	2.00	1.62		
Total Xylenes*	<0.150	0.150	05/16/2016	ND	6.19	103	6.00	0.856		
Total BTEX	<0.300	0.300	05/16/2016	ND						

Surrogate: 4-Bromofluorobenzene (PID) 98.1 % 73.6-140

Chloride, SM4500Cl-B		mg/kg		Analyzed By: AP						
Analyte	Result	Reporting Limit	Analyzed	Method Blank	BS	% Recovery	True Value QC	RPD	Qualifier	
Chloride	848	16.0	05/17/2016	ND	416	104	400	0.00		

TPH 8015M		mg/kg		Analyzed By: MS						
Analyte	Result	Reporting Limit	Analyzed	Method Blank	BS	% Recovery	True Value QC	RPD	Qualifier	
GRO C6-C10	<10.0	10.0	05/16/2016	ND	165	82.3	200	7.88		
DRO >C10-C28	293	10.0	05/16/2016	ND	178	88.8	200	13.1		

Surrogate: 1-Chlorooctane 97.1 % 35-147

Surrogate: 1-Chlorooctadecane 150 % 28-171

Cardinal Laboratories

* = Accredited Analyte

PLEASE NOTE: Liability and Damages. Cardinal's liability and client's exclusive remedy for any claim arising, whether based in contract or tort, shall be limited to the amount paid by client for analyses. All claims, including those for negligence and any other cause whatsoever shall be deemed waived unless made in writing and received by Cardinal within thirty (30) days after completion of the applicable service. In no event shall Cardinal be liable for incidental or consequential damages, including, without limitation, business interruptions, loss of use, or loss of profits incurred by client, its subsidiaries, affiliates or successors arising out of or related to the performance of the services hereunder by Cardinal, regardless of whether such claim is based upon any of the above stated reasons or otherwise. Results relate only to the samples identified above. This report shall not be reproduced except in full with written approval of Cardinal Laboratories.



Celey D. Keene, Lab Director/Quality Manager

Analytical Results For:

 LINN OPERATING-HOBBS
 DENNIS POTTER
 2130 W. BENDER
 HOBBS NM, 88240
 Fax To: (575) 738-1740

Received:	05/16/2016	Sampling Date:	05/10/2016
Reported:	05/19/2016	Sampling Type:	Soil
Project Name:	TURNER B #43	Sampling Condition:	Cool & Intact
Project Number:	NONE GIVEN	Sample Received By:	Jodi Henson
Project Location:	NOT GIVEN		

Sample ID: SAMPLE PT. 3 @ 4' (H601060-03)

BTEX 8021B		mg/kg		Analyzed By: MS						
Analyte	Result	Reporting Limit	Analyzed	Method Blank	BS	% Recovery	True Value QC	RPD	Qualifier	
Benzene*	<0.050	0.050	05/16/2016	ND	2.15	108	2.00	0.544		
Toluene*	<0.050	0.050	05/16/2016	ND	2.11	105	2.00	1.46		
Ethylbenzene*	<0.050	0.050	05/16/2016	ND	1.94	97.0	2.00	1.62		
Total Xylenes*	<0.150	0.150	05/16/2016	ND	6.19	103	6.00	0.856		
Total BTEX	<0.300	0.300	05/16/2016	ND						

Surrogate: 4-Bromofluorobenzene (PID) 98.9 % 73.6-140

Chloride, SM4500Cl-B		mg/kg		Analyzed By: AP						
Analyte	Result	Reporting Limit	Analyzed	Method Blank	BS	% Recovery	True Value QC	RPD	Qualifier	
Chloride	352	16.0	05/17/2016	ND	416	104	400	0.00		

TPH 8015M		mg/kg		Analyzed By: MS						
Analyte	Result	Reporting Limit	Analyzed	Method Blank	BS	% Recovery	True Value QC	RPD	Qualifier	
GRO C6-C10	<10.0	10.0	05/16/2016	ND	165	82.3	200	7.88		
DRO >C10-C28	13.4	10.0	05/16/2016	ND	178	88.8	200	13.1		

Surrogate: 1-Chlorooctane 77.1 % 35-147

Surrogate: 1-Chlorooctadecane 92.5 % 28-171

Cardinal Laboratories

* = Accredited Analyte

PLEASE NOTE: Liability and Damages. Cardinal's liability and client's exclusive remedy for any claim arising, whether based in contract or tort, shall be limited to the amount paid by client for analyses. All claims, including those for negligence and any other cause whatsoever shall be deemed waived unless made in writing and received by Cardinal within thirty (30) days after completion of the applicable service. In no event shall Cardinal be liable for incidental or consequential damages, including, without limitation, business interruptions, loss of use, or loss of profits incurred by client, its subsidiaries, affiliates or successors arising out of or related to the performance of the services hereunder by Cardinal, regardless of whether such claim is based upon any of the above stated reasons or otherwise. Results relate only to the samples identified above. This report shall not be reproduced except in full with written approval of Cardinal Laboratories.



Celey D. Keene, Lab Director/Quality Manager

Analytical Results For:

 LINN OPERATING-HOBBS
 DENNIS POTTER
 2130 W. BENDER
 HOBBS NM, 88240
 Fax To: (575) 738-1740

Received:	05/16/2016	Sampling Date:	05/10/2016
Reported:	05/19/2016	Sampling Type:	Soil
Project Name:	TURNER B #43	Sampling Condition:	Cool & Intact
Project Number:	NONE GIVEN	Sample Received By:	Jodi Henson
Project Location:	NOT GIVEN		

Sample ID: SAMPLE PT. 4 @ 4' (H601060-04)

BTEX 8021B		mg/kg		Analyzed By: MS						
Analyte	Result	Reporting Limit	Analyzed	Method Blank	BS	% Recovery	True Value QC	RPD	Qualifier	
Benzene*	<0.050	0.050	05/16/2016	ND	2.15	108	2.00	0.544		
Toluene*	<0.050	0.050	05/16/2016	ND	2.11	105	2.00	1.46		
Ethylbenzene*	<0.050	0.050	05/16/2016	ND	1.94	97.0	2.00	1.62		
Total Xylenes*	<0.150	0.150	05/16/2016	ND	6.19	103	6.00	0.856		
Total BTEX	<0.300	0.300	05/16/2016	ND						

Surrogate: 4-Bromofluorobenzene (PID) 97.8 % 73.6-140

Chloride, SM4500Cl-B		mg/kg		Analyzed By: AP						
Analyte	Result	Reporting Limit	Analyzed	Method Blank	BS	% Recovery	True Value QC	RPD	Qualifier	
Chloride	336	16.0	05/17/2016	ND	416	104	400	0.00		

TPH 8015M		mg/kg		Analyzed By: MS						
Analyte	Result	Reporting Limit	Analyzed	Method Blank	BS	% Recovery	True Value QC	RPD	Qualifier	
GRO C6-C10	<10.0	10.0	05/16/2016	ND	165	82.3	200	7.88		
DRO >C10-C28	336	10.0	05/16/2016	ND	178	88.8	200	13.1		

Surrogate: 1-Chlorooctane 83.9 % 35-147

Surrogate: 1-Chlorooctadecane 92.9 % 28-171

Cardinal Laboratories

* = Accredited Analyte

PLEASE NOTE: Liability and Damages. Cardinal's liability and client's exclusive remedy for any claim arising, whether based in contract or tort, shall be limited to the amount paid by client for analyses. All claims, including those for negligence and any other cause whatsoever shall be deemed waived unless made in writing and received by Cardinal within thirty (30) days after completion of the applicable service. In no event shall Cardinal be liable for incidental or consequential damages, including, without limitation, business interruptions, loss of use, or loss of profits incurred by client, its subsidiaries, affiliates or successors arising out of or related to the performance of the services hereunder by Cardinal, regardless of whether such claim is based upon any of the above stated reasons or otherwise. Results relate only to the samples identified above. This report shall not be reproduced except in full with written approval of Cardinal Laboratories.



Celey D. Keene, Lab Director/Quality Manager

Analytical Results For:

 LINN OPERATING-HOBBS
 DENNIS POTTER
 2130 W. BENDER
 HOBBS NM, 88240
 Fax To: (575) 738-1740

Received:	05/16/2016	Sampling Date:	05/13/2016
Reported:	05/19/2016	Sampling Type:	Soil
Project Name:	TURNER B #43	Sampling Condition:	Cool & Intact
Project Number:	NONE GIVEN	Sample Received By:	Jodi Henson
Project Location:	NOT GIVEN		

Sample ID: SAMPLE PT. 5 @ 5' (H601060-05)

BTEX 8021B		mg/kg		Analyzed By: MS					
Analyte	Result	Reporting Limit	Analyzed	Method Blank	BS	% Recovery	True Value QC	RPD	Qualifier
Benzene*	<0.050	0.050	05/16/2016	ND	2.15	108	2.00	0.544	
Toluene*	<0.050	0.050	05/16/2016	ND	2.11	105	2.00	1.46	
Ethylbenzene*	<0.050	0.050	05/16/2016	ND	1.94	97.0	2.00	1.62	
Total Xylenes*	<0.150	0.150	05/16/2016	ND	6.19	103	6.00	0.856	
Total BTEX	<0.300	0.300	05/16/2016	ND					

Surrogate: 4-Bromofluorobenzene (PID) 98.2 % 73.6-140

Chloride, SM4500Cl-B		mg/kg		Analyzed By: AP					
Analyte	Result	Reporting Limit	Analyzed	Method Blank	BS	% Recovery	True Value QC	RPD	Qualifier
Chloride	864	16.0	05/17/2016	ND	416	104	400	0.00	

TPH 8015M		mg/kg		Analyzed By: MS					
Analyte	Result	Reporting Limit	Analyzed	Method Blank	BS	% Recovery	True Value QC	RPD	Qualifier
GRO C6-C10	<10.0	10.0	05/16/2016	ND	165	82.3	200	7.88	
DRO >C10-C28	12.2	10.0	05/16/2016	ND	178	88.8	200	13.1	

Surrogate: 1-Chlorooctane 79.2 % 35-147

Surrogate: 1-Chlorooctadecane 90.6 % 28-171

Cardinal Laboratories

*=Accredited Analyte

PLEASE NOTE: Liability and Damages. Cardinal's liability and client's exclusive remedy for any claim arising, whether based in contract or tort, shall be limited to the amount paid by client for analyses. All claims, including those for negligence and any other cause whatsoever shall be deemed waived unless made in writing and received by Cardinal within thirty (30) days after completion of the applicable service. In no event shall Cardinal be liable for incidental or consequential damages, including, without limitation, business interruptions, loss of use, or loss of profits incurred by client, its subsidiaries, affiliates or successors arising out of or related to the performance of the services hereunder by Cardinal, regardless of whether such claim is based upon any of the above stated reasons or otherwise. Results relate only to the samples identified above. This report shall not be reproduced except in full with written approval of Cardinal Laboratories.



Celey D. Keene, Lab Director/Quality Manager

Analytical Results For:

 LINN OPERATING-HOBBS
 DENNIS POTTER
 2130 W. BENDER
 HOBBS NM, 88240
 Fax To: (575) 738-1740

Received:	05/16/2016	Sampling Date:	05/13/2016
Reported:	05/19/2016	Sampling Type:	Soil
Project Name:	TURNER B #43	Sampling Condition:	Cool & Intact
Project Number:	NONE GIVEN	Sample Received By:	Jodi Henson
Project Location:	NOT GIVEN		

Sample ID: SAMPLE PT. 6 @ 6' (H601060-06)

BTEX 8021B		mg/kg		Analyzed By: MS					
Analyte	Result	Reporting Limit	Analyzed	Method Blank	BS	% Recovery	True Value QC	RPD	Qualifier
Benzene*	<0.050	0.050	05/17/2016	ND	2.06	103	2.00	0.327	
Toluene*	<0.050	0.050	05/17/2016	ND	2.07	104	2.00	0.419	
Ethylbenzene*	<0.050	0.050	05/17/2016	ND	1.93	96.3	2.00	1.39	
Total Xylenes*	<0.150	0.150	05/17/2016	ND	6.00	99.9	6.00	1.84	
Total BTEX	<0.300	0.300	05/17/2016	ND					

Surrogate: 4-Bromofluorobenzene (PID) 100 % 73.6-140

Chloride, SM4500CI-B		mg/kg		Analyzed By: AP					
Analyte	Result	Reporting Limit	Analyzed	Method Blank	BS	% Recovery	True Value QC	RPD	Qualifier
Chloride	352	16.0	05/17/2016	ND	416	104	400	0.00	

TPH 8015M		mg/kg		Analyzed By: MS					
Analyte	Result	Reporting Limit	Analyzed	Method Blank	BS	% Recovery	True Value QC	RPD	Qualifier
GRO C6-C10	<10.0	10.0	05/16/2016	ND	165	82.3	200	7.88	
DRO >C10-C28	<10.0	10.0	05/16/2016	ND	178	88.8	200	13.1	

Surrogate: 1-Chlorooctane 78.4 % 35-147

Surrogate: 1-Chlorooctadecane 100 % 28-171

Cardinal Laboratories

* = Accredited Analyte

PLEASE NOTE: Liability and Damages. Cardinal's liability and client's exclusive remedy for any claim arising, whether based in contract or tort, shall be limited to the amount paid by client for analyses. All claims, including those for negligence and any other cause whatsoever shall be deemed waived unless made in writing and received by Cardinal within thirty (30) days after completion of the applicable service. In no event shall Cardinal be liable for incidental or consequential damages, including, without limitation, business interruptions, loss of use, or loss of profits incurred by client, its subsidiaries, affiliates or successors arising out of or related to the performance of the services hereunder by Cardinal, regardless of whether such claim is based upon any of the above stated reasons or otherwise. Results relate only to the samples identified above. This report shall not be reproduced except in full with written approval of Cardinal Laboratories.



Celey D. Keene, Lab Director/Quality Manager

Analytical Results For:

 LINN OPERATING-HOBBS
 DENNIS POTTER
 2130 W. BENDER
 HOBBS NM, 88240
 Fax To: (575) 738-1740

Received:	05/16/2016	Sampling Date:	05/10/2016
Reported:	05/19/2016	Sampling Type:	Soil
Project Name:	TURNER B #43	Sampling Condition:	Cool & Intact
Project Number:	NONE GIVEN	Sample Received By:	Jodi Henson
Project Location:	NOT GIVEN		

Sample ID: SAMPLE PT. 7 @ 4' (H601060-07)

BTEX 8021B		mg/kg		Analyzed By: MS						
Analyte	Result	Reporting Limit	Analyzed	Method Blank	BS	% Recovery	True Value QC	RPD	Qualifier	
Benzene*	<0.050	0.050	05/17/2016	ND	2.06	103	2.00	0.327		
Toluene*	<0.050	0.050	05/17/2016	ND	2.07	104	2.00	0.419		
Ethylbenzene*	<0.050	0.050	05/17/2016	ND	1.93	96.3	2.00	1.39		
Total Xylenes*	<0.150	0.150	05/17/2016	ND	6.00	99.9	6.00	1.84		
Total BTEX	<0.300	0.300	05/17/2016	ND						

Surrogate: 4-Bromofluorobenzene (PID) 100 % 73.6-140

Chloride, SM4500Cl-B		mg/kg		Analyzed By: AP						
Analyte	Result	Reporting Limit	Analyzed	Method Blank	BS	% Recovery	True Value QC	RPD	Qualifier	
Chloride	128	16.0	05/17/2016	ND	416	104	400	0.00		

TPH 8015M		mg/kg		Analyzed By: MS						
Analyte	Result	Reporting Limit	Analyzed	Method Blank	BS	% Recovery	True Value QC	RPD	Qualifier	
GRO C6-C10	<10.0	10.0	05/16/2016	ND	165	82.3	200	7.88		
DRO >C10-C28	<10.0	10.0	05/16/2016	ND	178	88.8	200	13.1		

Surrogate: 1-Chlorooctane 86.3 % 35-147

Surrogate: 1-Chlorooctadecane 113 % 28-171

Cardinal Laboratories

* = Accredited Analyte

PLEASE NOTE: Liability and Damages. Cardinal's liability and client's exclusive remedy for any claim arising, whether based in contract or tort, shall be limited to the amount paid by client for analyses. All claims, including those for negligence and any other cause whatsoever shall be deemed waived unless made in writing and received by Cardinal within thirty (30) days after completion of the applicable service. In no event shall Cardinal be liable for incidental or consequential damages, including, without limitation, business interruptions, loss of use, or loss of profits incurred by client, its subsidiaries, affiliates or successors arising out of or related to the performance of the services hereunder by Cardinal, regardless of whether such claim is based upon any of the above stated reasons or otherwise. Results relate only to the samples identified above. This report shall not be reproduced except in full with written approval of Cardinal Laboratories.



Celey D. Keene, Lab Director/Quality Manager

Analytical Results For:

 LINN OPERATING-HOBBS
 DENNIS POTTER
 2130 W. BENDER
 HOBBS NM, 88240
 Fax To: (575) 738-1740

Received:	05/16/2016	Sampling Date:	05/10/2016
Reported:	05/19/2016	Sampling Type:	Soil
Project Name:	TURNER B #43	Sampling Condition:	Cool & Intact
Project Number:	NONE GIVEN	Sample Received By:	Jodi Henson
Project Location:	NOT GIVEN		

Sample ID: SAMPLE PT. 8 @ 4' (H601060-08)

BTEX 8021B		mg/kg		Analyzed By: MS					
Analyte	Result	Reporting Limit	Analyzed	Method Blank	BS	% Recovery	True Value QC	RPD	Qualifier
Benzene*	<0.050	0.050	05/17/2016	ND	2.06	103	2.00	0.327	
Toluene*	<0.050	0.050	05/17/2016	ND	2.07	104	2.00	0.419	
Ethylbenzene*	<0.050	0.050	05/17/2016	ND	1.93	96.3	2.00	1.39	
Total Xylenes*	<0.150	0.150	05/17/2016	ND	6.00	99.9	6.00	1.84	
Total BTEX	<0.300	0.300	05/17/2016	ND					

Surrogate: 4-Bromofluorobenzene (PID) 98.8 % 73.6-140

Chloride, SM4500Cl-B		mg/kg		Analyzed By: AP					
Analyte	Result	Reporting Limit	Analyzed	Method Blank	BS	% Recovery	True Value QC	RPD	Qualifier
Chloride	32.0	16.0	05/17/2016	ND	416	104	400	0.00	

TPH 8015M		mg/kg		Analyzed By: MS					
Analyte	Result	Reporting Limit	Analyzed	Method Blank	BS	% Recovery	True Value QC	RPD	Qualifier
GRO C6-C10	<10.0	10.0	05/16/2016	ND	165	82.3	200	7.88	
DRO >C10-C28	<10.0	10.0	05/16/2016	ND	178	88.8	200	13.1	

Surrogate: 1-Chlorooctane 71.4 % 35-147

Surrogate: 1-Chlorooctadecane 92.9 % 28-171

Cardinal Laboratories

*=Accredited Analyte

PLEASE NOTE: Liability and Damages. Cardinal's liability and client's exclusive remedy for any claim arising, whether based in contract or tort, shall be limited to the amount paid by client for analyses. All claims, including those for negligence and any other cause whatsoever shall be deemed waived unless made in writing and received by Cardinal within thirty (30) days after completion of the applicable service. In no event shall Cardinal be liable for incidental or consequential damages, including, without limitation, business interruptions, loss of use, or loss of profits incurred by client, its subsidiaries, affiliates or successors arising out of or related to the performance of the services hereunder by Cardinal, regardless of whether such claim is based upon any of the above stated reasons or otherwise. Results relate only to the samples identified above. This report shall not be reproduced except in full with written approval of Cardinal Laboratories.



Celey D. Keene, Lab Director/Quality Manager

Analytical Results For:

 LINN OPERATING-HOBBS
 DENNIS POTTER
 2130 W. BENDER
 HOBBS NM, 88240
 Fax To: (575) 738-1740

Received:	05/16/2016	Sampling Date:	05/13/2016
Reported:	05/19/2016	Sampling Type:	Soil
Project Name:	TURNER B #43	Sampling Condition:	Cool & Intact
Project Number:	NONE GIVEN	Sample Received By:	Jodi Henson
Project Location:	NOT GIVEN		

Sample ID: SAMPLE PT. 9 @ 8' (H601060-09)

BTEX 8021B		mg/kg		Analyzed By: MS					
Analyte	Result	Reporting Limit	Analyzed	Method Blank	BS	% Recovery	True Value QC	RPD	Qualifier
Benzene*	<0.050	0.050	05/17/2016	ND	2.06	103	2.00	0.327	
Toluene*	<0.050	0.050	05/17/2016	ND	2.07	104	2.00	0.419	
Ethylbenzene*	<0.050	0.050	05/17/2016	ND	1.93	96.3	2.00	1.39	
Total Xylenes*	<0.150	0.150	05/17/2016	ND	6.00	99.9	6.00	1.84	
Total BTEX	<0.300	0.300	05/17/2016	ND					

Surrogate: 4-Bromofluorobenzene (PID) 100 % 73.6-140

Chloride, SM4500CI-B		mg/kg		Analyzed By: AP					
Analyte	Result	Reporting Limit	Analyzed	Method Blank	BS	% Recovery	True Value QC	RPD	Qualifier
Chloride	512	16.0	05/17/2016	ND	416	104	400	0.00	

TPH 8015M		mg/kg		Analyzed By: MS					
Analyte	Result	Reporting Limit	Analyzed	Method Blank	BS	% Recovery	True Value QC	RPD	Qualifier
GRO C6-C10	<10.0	10.0	05/16/2016	ND	165	82.3	200	7.88	
DRO >C10-C28	<10.0	10.0	05/16/2016	ND	178	88.8	200	13.1	

Surrogate: 1-Chlorooctane 72.9 % 35-147

Surrogate: 1-Chlorooctadecane 94.8 % 28-171

Cardinal Laboratories

* = Accredited Analyte

PLEASE NOTE: Liability and Damages. Cardinal's liability and client's exclusive remedy for any claim arising, whether based in contract or tort, shall be limited to the amount paid by client for analyses. All claims, including those for negligence and any other cause whatsoever shall be deemed waived unless made in writing and received by Cardinal within thirty (30) days after completion of the applicable service. In no event shall Cardinal be liable for incidental or consequential damages, including, without limitation, business interruptions, loss of use, or loss of profits incurred by client, its subsidiaries, affiliates or successors arising out of or related to the performance of the services hereunder by Cardinal, regardless of whether such claim is based upon any of the above stated reasons or otherwise. Results relate only to the samples identified above. This report shall not be reproduced except in full with written approval of Cardinal Laboratories.



Celey D. Keene, Lab Director/Quality Manager

Analytical Results For:

 LINN OPERATING-HOBBS
 DENNIS POTTER
 2130 W. BENDER
 HOBBS NM, 88240
 Fax To: (575) 738-1740

Received:	05/16/2016	Sampling Date:	05/13/2016
Reported:	05/19/2016	Sampling Type:	Soil
Project Name:	TURNER B #43	Sampling Condition:	Cool & Intact
Project Number:	NONE GIVEN	Sample Received By:	Jodi Henson
Project Location:	NOT GIVEN		

Sample ID: SAMPLE PT. 10 @ 7' (H601060-10)

BTEX 8021B		mg/kg		Analyzed By: MS						
Analyte	Result	Reporting Limit	Analyzed	Method Blank	BS	% Recovery	True Value QC	RPD	Qualifier	
Benzene*	<0.050	0.050	05/17/2016	ND	2.06	103	2.00	0.327		
Toluene*	<0.050	0.050	05/17/2016	ND	2.07	104	2.00	0.419		
Ethylbenzene*	<0.050	0.050	05/17/2016	ND	1.93	96.3	2.00	1.39		
Total Xylenes*	<0.150	0.150	05/17/2016	ND	6.00	99.9	6.00	1.84		
Total BTEX	<0.300	0.300	05/17/2016	ND						

Surrogate: 4-Bromofluorobenzene (PID) 99.7 % 73.6-140

Chloride, SM4500Cl-B		mg/kg		Analyzed By: AP						
Analyte	Result	Reporting Limit	Analyzed	Method Blank	BS	% Recovery	True Value QC	RPD	Qualifier	
Chloride	416	16.0	05/17/2016	ND	416	104	400	0.00		

TPH 8015M		mg/kg		Analyzed By: MS						
Analyte	Result	Reporting Limit	Analyzed	Method Blank	BS	% Recovery	True Value QC	RPD	Qualifier	
GRO C6-C10	<10.0	10.0	05/16/2016	ND	165	82.3	200	7.88		
DRO >C10-C28	<10.0	10.0	05/16/2016	ND	178	88.8	200	13.1		

Surrogate: 1-Chlorooctane 72.9 % 35-147

Surrogate: 1-Chlorooctadecane 97.6 % 28-171

Cardinal Laboratories

*=Accredited Analyte

PLEASE NOTE: Liability and Damages. Cardinal's liability and client's exclusive remedy for any claim arising, whether based in contract or tort, shall be limited to the amount paid by client for analyses. All claims, including those for negligence and any other cause whatsoever shall be deemed waived unless made in writing and received by Cardinal within thirty (30) days after completion of the applicable service. In no event shall Cardinal be liable for incidental or consequential damages, including, without limitation, business interruptions, loss of use, or loss of profits incurred by client, its subsidiaries, affiliates or successors arising out of or related to the performance of the services hereunder by Cardinal, regardless of whether such claim is based upon any of the above stated reasons or otherwise. Results relate only to the samples identified above. This report shall not be reproduced except in full with written approval of Cardinal Laboratories.



Celey D. Keene, Lab Director/Quality Manager

Analytical Results For:

 LINN OPERATING-HOBBS
 DENNIS POTTER
 2130 W. BENDER
 HOBBS NM, 88240
 Fax To: (575) 738-1740

Received:	05/16/2016	Sampling Date:	05/12/2016
Reported:	05/19/2016	Sampling Type:	Soil
Project Name:	TURNER B #43	Sampling Condition:	Cool & Intact
Project Number:	NONE GIVEN	Sample Received By:	Jodi Henson
Project Location:	NOT GIVEN		

Sample ID: SAMPLE PT. 11 @ 4' (H601060-11)

BTEX 8021B		mg/kg		Analyzed By: MS						
Analyte	Result	Reporting Limit	Analyzed	Method Blank	BS	% Recovery	True Value QC	RPD	Qualifier	
Benzene*	<0.050	0.050	05/17/2016	ND	2.06	103	2.00	0.327		
Toluene*	<0.050	0.050	05/17/2016	ND	2.07	104	2.00	0.419		
Ethylbenzene*	<0.050	0.050	05/17/2016	ND	1.93	96.3	2.00	1.39		
Total Xylenes*	<0.150	0.150	05/17/2016	ND	6.00	99.9	6.00	1.84		
Total BTEX	<0.300	0.300	05/17/2016	ND						

Surrogate: 4-Bromofluorobenzene (PID) 99.2 % 73.6-140

Chloride, SM4500Cl-B		mg/kg		Analyzed By: AP						
Analyte	Result	Reporting Limit	Analyzed	Method Blank	BS	% Recovery	True Value QC	RPD	Qualifier	
Chloride	144	16.0	05/17/2016	ND	416	104	400	0.00		

TPH 8015M		mg/kg		Analyzed By: MS						
Analyte	Result	Reporting Limit	Analyzed	Method Blank	BS	% Recovery	True Value QC	RPD	Qualifier	
GRO C6-C10	<10.0	10.0	05/16/2016	ND	165	82.3	200	7.88		
DRO >C10-C28	<10.0	10.0	05/16/2016	ND	178	88.8	200	13.1		

Surrogate: 1-Chlorooctane 83.9 % 35-147

Surrogate: 1-Chlorooctadecane 113 % 28-171

Cardinal Laboratories

*=Accredited Analyte

PLEASE NOTE: Liability and Damages. Cardinal's liability and client's exclusive remedy for any claim arising, whether based in contract or tort, shall be limited to the amount paid by client for analyses. All claims, including those for negligence and any other cause whatsoever shall be deemed waived unless made in writing and received by Cardinal within thirty (30) days after completion of the applicable service. In no event shall Cardinal be liable for incidental or consequential damages, including, without limitation, business interruptions, loss of use, or loss of profits incurred by client, its subsidiaries, affiliates or successors arising out of or related to the performance of the services hereunder by Cardinal, regardless of whether such claim is based upon any of the above stated reasons or otherwise. Results relate only to the samples identified above. This report shall not be reproduced except in full with written approval of Cardinal Laboratories.



Celey D. Keene, Lab Director/Quality Manager

Analytical Results For:

 LINN OPERATING-HOBBS
 DENNIS POTTER
 2130 W. BENDER
 HOBBS NM, 88240
 Fax To: (575) 738-1740

Received:	05/16/2016	Sampling Date:	05/12/2016
Reported:	05/19/2016	Sampling Type:	Soil
Project Name:	TURNER B #43	Sampling Condition:	Cool & Intact
Project Number:	NONE GIVEN	Sample Received By:	Jodi Henson
Project Location:	NOT GIVEN		

Sample ID: SAMPLE PT. 12 @ 4' (H601060-12)

BTEX 8021B		mg/kg		Analyzed By: MS						
Analyte	Result	Reporting Limit	Analyzed	Method Blank	BS	% Recovery	True Value QC	RPD	Qualifier	
Benzene*	<0.050	0.050	05/17/2016	ND	2.06	103	2.00	0.327		
Toluene*	<0.050	0.050	05/17/2016	ND	2.07	104	2.00	0.419		
Ethylbenzene*	<0.050	0.050	05/17/2016	ND	1.93	96.3	2.00	1.39		
Total Xylenes*	<0.150	0.150	05/17/2016	ND	6.00	99.9	6.00	1.84		
Total BTEX	<0.300	0.300	05/17/2016	ND						

Surrogate: 4-Bromofluorobenzene (PID) 103 % 73.6-140

Chloride, SM4500Cl-B		mg/kg		Analyzed By: AP						
Analyte	Result	Reporting Limit	Analyzed	Method Blank	BS	% Recovery	True Value QC	RPD	Qualifier	
Chloride	48.0	16.0	05/17/2016	ND	416	104	400	0.00		

TPH 8015M		mg/kg		Analyzed By: MS						
Analyte	Result	Reporting Limit	Analyzed	Method Blank	BS	% Recovery	True Value QC	RPD	Qualifier	
GRO C6-C10	<10.0	10.0	05/16/2016	ND	165	82.3	200	7.88		
DRO >C10-C28	<10.0	10.0	05/16/2016	ND	178	88.8	200	13.1		

Surrogate: 1-Chlorooctane 81.3 % 35-147

Surrogate: 1-Chlorooctadecane 106 % 28-171

Cardinal Laboratories

* = Accredited Analyte

PLEASE NOTE: Liability and Damages. Cardinal's liability and client's exclusive remedy for any claim arising, whether based in contract or tort, shall be limited to the amount paid by client for analyses. All claims, including those for negligence and any other cause whatsoever shall be deemed waived unless made in writing and received by Cardinal within thirty (30) days after completion of the applicable service. In no event shall Cardinal be liable for incidental or consequential damages, including, without limitation, business interruptions, loss of use, or loss of profits incurred by client, its subsidiaries, affiliates or successors arising out of or related to the performance of the services hereunder by Cardinal, regardless of whether such claim is based upon any of the above stated reasons or otherwise. Results relate only to the samples identified above. This report shall not be reproduced except in full with written approval of Cardinal Laboratories.



Celey D. Keene, Lab Director/Quality Manager

Notes and Definitions

- QR-03 The RPD value for the sample duplicate or MS/MSD was outside of QC acceptance limits due to matrix interference. QC batch accepted based on LCS and/or LCS/D recovery and/or RPD values.
- ND Analyte NOT DETECTED at or above the reporting limit
- RPD Relative Percent Difference
- ** Samples not received at proper temperature of 6°C or below.
- *** Insufficient time to reach temperature.
- Chloride by SM4500Cl-B does not require samples be received at or below 6°C
- Samples reported on an as received basis (wet) unless otherwise noted on report





101 East Marland, Hobbs, NM 88240
 (575) 393-2326 FAX (575) 393-2476

CHAIN-OF-CUSTODY AND ANALYSIS REQUEST

Company Name: LIUN P.O. #:

Project Manager: Denis Pelher Company:

Address: State: Zip: Attn:

City: Address: Project #: Project Owner: City: State: Zip:

Project Name: LIUN Project Location: Turner B #413 Phone #: Fax #:

Sampler Name: Chris Flores Fax #: PRESERV/ SAMPLING

FOR LAB USE ONLY

Lab I.D.	Sample I.D.	(G)RAB OR (C)OMP.	# CONTAINERS	MATRIX						DATE	TIME	Chloride	TPH	BTEX
				GROUNDWATER	WASTEWATER	SOIL	OIL	SLUDGE	OTHER:					
1	Sample Point 1 @ 6'	G	1	V						5/13/2016	11:30 AM	X	X	X
2	Sample Point 2 @ 4'	G	1	V						5/10/2016	10:00 AM	X	X	X
3	Sample Point 3 @ 4'	G	1	V						?		X	X	X
4	Sample Point 4 @ 4'	G	1	V						?		X	X	X
5	Sample Point 5 @ 5'	G	1	V						5/13/2016	9:30 AM	X	X	X
6	Sample Point 6 @ 6'	G	1	V						?		X	X	X
7	Sample Point 7 @ 4'	G	1	V						5/10/2016	3:00 PM	X	X	X
8	Sample Point 8 @ 4'	G	1	V						?		X	X	X
9	Sample Point 9 @ 8'	G	1	V						5/13/2016	2:30 PM	X	X	X
10	Sample Point 10 @ 7'	G	1	V						?		X	X	X

PLEASE NOTE: Liability and Damages, quantum's liability and client's exclusive remedy for any claim arising whether based in contract or tort, shall be limited to the amount paid by the client for the analysis. All claims including those for negligence and any other cause whatsoever shall be deemed waived unless made in writing and received by Cardinal within 30 days after completion of the applicable service. In no event shall Cardinal be liable for incidental or consequential damages, including without limitation, business interruption, loss of use, or loss of profits incurred by client, its subsidiaries, affiliates or successors arising out of or related to the performance of services hereunder by Cardinal. Regardless of whether such claim is based upon any of the above stated reasons or otherwise.

Relinquished By: [Signature] Date: 5/16/2016 Type: 8:45 Received By: Chris Flores

Relinquished By: [Signature] Date: Time: Received By: [Signature]

Delivered By: (Circle One) 5.60 Sample Condition: Cool Intact Yes No No

Sampler - UPS - Bus - Other: 5.70 CHECKED BY: [Signature] (initials)

REMARKS: Good to Flores Drivers Fred's account

Phone Result: Yes No Add'l Phone #:

Fax Result: Yes No Add'l Fax #:

Walters @
in bus @
in person @
Flores @

† Cardinal cannot accept verbal changes. Please fax written changes to (575) 393-2326
corrected 5.70 #54

CHAIN-OF-CUSTODY AND ANALYSIS REQUEST

101 East Marland, Hobbs, NM 88240
 (575) 393-2326 FAX (575) 393-2476

BILL TO

ANALYSIS REQUEST

Company Name: LINN P.O. #: _____
 Project Manager: Dennis Peltier Company: _____
 Address: _____ Attn: _____
 City: _____ State: _____ Zip: _____
 Phone #: _____ Fax #: _____
 Project #: _____ Project Owner: _____
 Project Name: LINN City: _____ State: _____ Zip: _____
 Project Location: Turner B #1043 Phone #: _____
 Sampler Name: Chris Flores Fax #: _____

FOR LAB USE ONLY

Lab I.D.	Sample I.D.	(G)RAB OR (C)OMP.	# CONTAINERS	MATRIX						DATE	TIME	ANALYSIS REQUEST					
				GROUNDWATER	WASTEWATER	SOIL	OIL	SLUDGE	OTHER :			ACID/BASE:	ICE / COOL	OTHER :	Yes	No	Add'l Phone #:
<u>H100100</u>	<u>11 Sample Point 11 @ 4'</u>	<u>G</u>	<u>1</u>			<u>✓</u>				<u>5/12/2016</u>	<u>9:00 AM</u>	<u>X</u>	<u>X</u>	<u>X</u>			
	<u>12 Sample Point 12 @ 4'</u>	<u>G</u>	<u>1</u>							<u>5/12/2016</u>	<u>11:00 AM</u>	<u>X</u>	<u>X</u>	<u>X</u>			

REMARKS: Chloride
TPN
BTEX

Relinquished By: _____ Date: 5/16/2016 Time: 8:45
 Received By: Scotti Johnson
 Delivered By: (Circle One) UPS - Bus - Other: 5.102
 Sample - UPS - Bus - Other: 5.102

Sample Condition: Intact Cool Yes No
 CHECKED BY: [Signature]

Phone Result: Yes No Add'l Phone #: _____
 Fax Result: Yes No Add'l Fax #: _____

REMARKS: email to Flores @ Diversified FSI - row
refuses @
injection @
up @ Johnson @
Flores @

† Cardinal cannot accept verbal changes. Please fax written changes to (575) 393-2326
 #54 corrected 5.7.16

Appendix III

LABORATORY ANALYSIS

Diversified Field Service, Inc.
206 W. Snyder
Hobbs, NM 88240
(575) 964-8394

Turner B #043

Unit Letter M, Section 20, T17S, R31E | NMOCD Case #: 2R-1111

PHOTO PAGE



Site prior, facing northeast 7/20/2012



Site prior, facing west 2/7/2014



Collecting samples, facing west 5/10/2016



Utilizing PID, facing northwest 5/10/2016

Appendix IV

GROUNDWATER STUDY

Diversified Field Service, Inc.
206 W. Snyder
Hobbs, NM 88240
(575) 964-8394



New Mexico Office of the State Engineer

Water Column/Average Depth to Water

No records found.

PLSS Search:

Section(s): 16, 17, 18, 19,
20, 21, 28, 29,
30 **Township:** 17S **Range:** 31E