



November 18, 2016

**Mike Bratcher**

**New Mexico Energy, Minerals & Natural Resources Oil Conservation Division,  
Environmental Bureau - District 2  
811 S. First St.  
Artesia, NM 88210**

**RE: Corrective Action Plan**

**Burnett Oil Co., Inc. - Gissler A 43  
UL/B sec. 23 T17S R30E**

Mr. Bratcher

The above location is located approximately 2 miles northeast of Loco Hills, New Mexico at UL/B sec.23 T17S R30E. The site is located in an area of no known groundwater.

On April 21, 2016, a release of 58 barrels of total fluid was discovered. The release occurred when a steel injection line coming into the well ruptured and come to surface. The release impacted a 300'x10'-1" area and a 150'x 5'-1' area on the well pad location (API # 30-015-41177). The BLM and the NMOCD were both notified of the release on April 21, 2016 with the initial C-141 being filed on the same day.

**Corrective Action Plan**

To remediate the impacted soil, Burnett Oil Co., Inc. has hired Aspen Grow LLC. to apply their Detox chloride bonding agents to the impacted area in the pasture. The Detox remediation bonding agents will be applied with water and aid in the remediation of the impacted soil, as well as help move the chlorides 3' below surface level. There will be four applications of the bonding agents in each installation. After each installment of bonding agents, Burnett Oil Co., Inc. will collect samples for verification of remediation success. Once the hydrocarbons chlorides have been remediated and/or pushed below the root zone below and analytical is below regulatory standards the impacted pasture area will be reseeded with BLM #2 seed mix. The area will then be observed until sufficient regrowth occurs.



November 18, 2016

Following the approval of the plan and after the remediation has taken place, Burnett Oil Co., Inc. will submit all proper closure documentation to the NMOCD and the BLM in accordance to the State and Federal Guidelines set forth.

Please feel free to contact me with any questions concerning this remediation plan request.

Sincerely,

A handwritten signature in blue ink, appearing to read 'JT', with a large, sweeping horizontal stroke extending to the right.

Johnny Titsworth  
HSE Coordinator  
Burnett Oil Co., Inc.  
P.O. Box 188 / CR 220 North  
Loco Hills, NM 88255  
(432)-425-2891  
Email: jtitsworth@burnettoil.com

District I  
1625 N. French Dr., Hobbs, NM 88240  
District II  
811 S. First St., Artesia, NM 88210  
District III  
1000 Rio Brazos Road, Aztec, NM 87410  
District IV  
1220 S. St. Francis Dr., Santa Fe, NM 87505

State of New Mexico  
Energy Minerals and Natural Resources

Oil Conservation Division  
1220 South St. Francis Dr.  
Santa Fe, NM 87505

Form C-141  
Revised August 8, 2011

Submit 1 Copy to appropriate District Office in  
accordance with 19.15.29 NMAC.

**Release Notification and Corrective Action**

**OPERATOR**

☒ Initial Report ☐ Final Report

Name of Company	Burnett Oil Co., Inc	Contact	Leslie Garvis
Address	801 Cherry Street, Ste 1500, Fort Worth, Texas 76102	Telephone No.	817-583-8730
Facility Name	Gissler A 43	Facility Type	Well
Surface Owner	BLM	Mineral Owner	BLM
		API No.	30-015-41177

**LOCATION OF RELEASE**

Unit Letter	Section	Township	Range	Feet from the	North/South Line	Feet from the	East/West Line	County
B	23	17S	30E	990	North	1650	East	Eddy

Latitude \_\_\_\_\_ Longitude \_\_\_\_\_

**NATURE OF RELEASE**

Type of Release	Oil/Water	Volume of Release	18 BO/40 BW	Volume Recovered	10BO/30BW
Source of Release	Cracked Line at Well Head	Date and Hour of Occurrence		Date and Hour of Discovery	4/21/16/11:00am
Was Immediate Notice Given?	<input checked="" type="checkbox"/> Yes <input type="checkbox"/> No <input type="checkbox"/> Not Required	If YES, To Whom?	Phone Call to BLM - S. Tucker, OCD - H. Patterson		
By Whom?	Leslie Garvis	Date and Hour	4/21/16 1530		
Was a Watercourse Reached?	<input type="checkbox"/> Yes <input checked="" type="checkbox"/> No	If YES, Volume Impacting the Watercourse.	N/A		
If a Watercourse was Impacted, Describe Fully.* N/A					
Describe Cause of Problem and Remedial Action Taken.* There was a crack in a 1" line coming off the well head. Line has been repaired and put back into service.					
Describe Area Affected and Cleanup Action Taken.* The total areas affected were approx. 300'x10'x1' and 150'x5'x1'. Of this total amount, the sections that ran off the pad measured approx. 30'x2' and 20'x20'. All standing fluid has been picked up. The impacted area will be assessed and remediated per regulatory standards.					

I hereby certify that the information given above is true and complete to the best of my knowledge and understand that pursuant to NMOCD rules and regulations all operators are required to report and/or file certain release notifications and perform corrective actions for releases which may endanger public health or the environment. The acceptance of a C-141 report by the NMOCD marked as "Final Report" does not relieve the operator of liability should their operations have failed to adequately investigate and remediate contamination that pose a threat to ground water, surface water, human health or the environment. In addition, NMOCD acceptance of a C-141 report does not relieve the operator of responsibility for compliance with any other federal, state, or local laws and/or regulations.

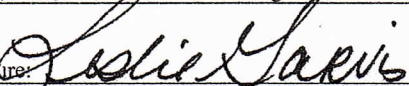
Signature: 	<b>OIL CONSERVATION DIVISION</b>		
Printed Name: Leslie Garvis	Approved by Environmental Specialist:		
Title: Regulatory Coordinator	Approval Date:	Expiration Date:	
E-mail Address: lgarvis@burnettoil.com	Conditions of Approval:		Attached <input type="checkbox"/>
Date: 4/21/16	Phone: 817-583-8730		

\* Attach Additional Sheets If Necessary



4/21/16

Grissler A 43

30-015-41177

Sec 23 T17S R30E Unit B

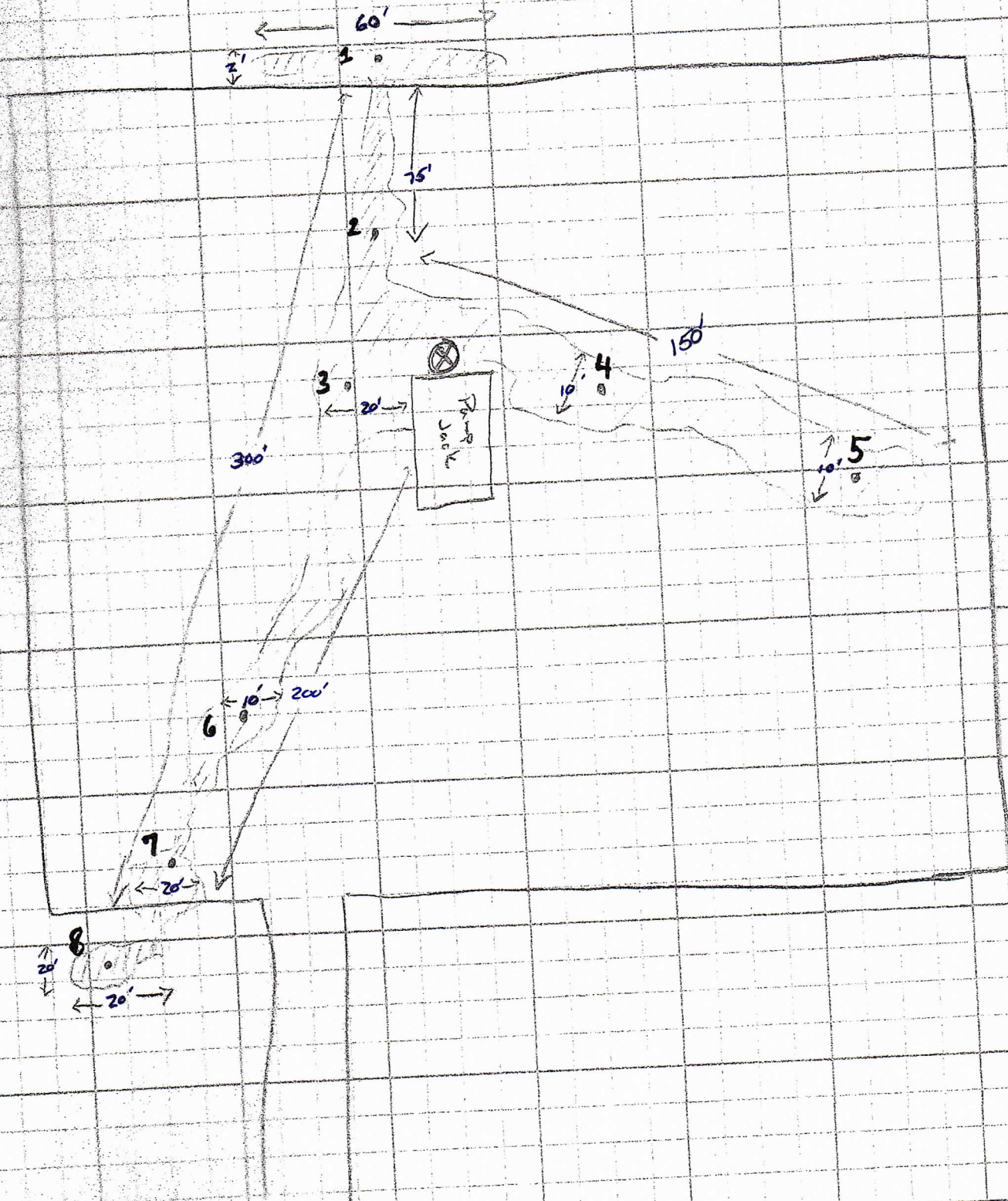

Table 1 - Analytical Results

Date	Sample ID	Depth	Chloride	TPH - GRO	TPH - DRO	Total TPH	Benzene	Toluene	Ethylbenzene	Xylene	BTEX
9/13/2016	SP-1	0-1'		1960	12150	14200	ND	0.242	0.248	2.98	
9/13/2016		1'-1.5'		2150	5959	8120					
9/13/2016		2'-2.5'		3530	9490	1300					
9/13/2016		3'-3.5'		1170	4538	5710					
9/13/2016		4'-4.5'		ND	82	82					
9/13/2016	SP-2	0-1'		4690	16700	21400					
9/13/2016		1'-1.5'		63	300	363					
9/13/2016	SP-3	0-1'		996	8055	9050	ND	ND	ND	0.00494	
9/13/2016		1'-1.5'		118	280	398					
9/13/2016	SP-4	0-1'		ND	ND	ND					
9/13/2016	SP-5	0-1'		1980	7791	9770	ND	0.0447	1.47	3.67	
9/13/2016		1'-1.5'		ND	90	90					



## Table 1 - Analytical Results

[illegible]