

N.M. Oil Cons. DIV-Dist. 2  
1301 W. Grand Avenue  
Artesia, NM 88210

Form 3160-3  
(August 1999)

UNITED STATES  
DEPARTMENT OF THE INTERIOR  
BUREAU OF LAND MANAGEMENT

RECEIVED

MAR 30 2004

APPLICATION FOR PERMIT TO DRILL OR REENTER OIL-ARTESIA

0

OMB No. 1004-0136  
Expires November 30, 2000

5. Lease Serial No.

NM-101575

6. If Indian, Allottee or Tribe Name

Not Applicable

7. If Unit or CA Agreement, Name and No.

Not Applicable

8. Lease Name and Well No.

Cooker BCB Federal Com. #2

9. API Well No.

30-005-63648

10. Field and Pool, or Exploratory

Wildcat Precambrian

11. Sec., T., R., M., or Blk. and Survey or Area

Section 21, T6S-R26E

12. County or Parish

Chaves County

13. State

NM

1a. Type of Work:



DRILL



REENTER

b. Type of Well:



Oil Well



Gas  
Well



Other



Single  
Zone



Multiple Zone

2. Name of Operator

Yates Petroleum Corporation

3A. Address 105 South Fourth Street

Artesia, New Mexico 88210

3b. Phone No. (include area code)

(505) 748-1471

4. Location of Well (Report location clearly and in accordance with any State requirements. \*)

At surface

960' FNL and 990' FEL

At proposed prod. Zone

same as above

14. Distance in miles and direction from nearest town or post office\*

Approximately twenty-four (24) miles NE of Roswell, NM

12. County or Parish

Chaves County

13. State

NM

15. Distance from proposed\*

location to nearest  
property or lease line, ft.  
(Also to nearest drig. unit line, if any)

990'

16. No. of Acres in lease

960

17. Spacing Unit dedicated to this well

320 acres

18. Distance from proposed location\*  
to nearest well, drilling, completed,  
applied for, on this lease, ft.

3330'

19. Proposed Depth

5650'

20. BLM/BIA Bond No. on file

NM-2811

21. Elevations (Show whether DF, KDB, RT, GL, etc.)

3636' GL

22. Approximate date work will start\*

ASAP

23. Estimated duration

30 Days

24. Attachments

The following, completed in accordance with the requirements of Onshore Oil and Gas Order No. 1, shall be attached to this form:

1. Well plat certified by a registered surveyor.

2. A Drilling Plan.

3. A Surface Use Plan (if the location is on National Forest System Lands, the  
SUPO shall be filed with the appropriate Forest Service Office.

4. Bond to cover the operations unless covered by an existing bond on file (see  
Item 20 above).

5. Operator certification.

6. Such other site specific information and/or plans as may be required by the  
authorized office.

25. Signature

Name (Printed/Typed)

Date

Robert Asher

3/10/04

Title:

Regulatory Agent

Approved by (Signature)

/S/LARRY D. BRAY

Name (Printed/Typed)

/S/LARRY D. BRAY

Date

MAR 29 2004

Title

Assistant Field Manager,  
Lands And Minerals

Office

ROSWELL FIELD OFFICE

APPROVED FOR 1 YEAR

Application approval does not warrant or certify that the applicant holds legal or equitable title to those rights in the subject lease which would entitle the applicant to conduct operations thereon.

Conditions of approval, if any, are attached.

Title 18 U.S.C. Section 1001 and Title 43 U.S.C. Section 1212, make it a crime for any person knowingly and willfully to make to any department or agency of the United States any false, fictitious or fraudulent statements or representations as to any matter within its jurisdiction.

\*(Instructions on reverse)

FROM : GENERAL SURVEYING Co  
DISTRICT I

1820 N. French Dr., Hobbs, NM 88240

DISTRICT II

811 South First, Artesia, NM 88210

DISTRICT III

1000 Rio Brazos Rd., Aztec, NM 87410

DISTRICT IV

2040 South Pacheco, Santa Fe, NM 87505

FAX NO. : 5053930023

STATE OF NEW MEXICO

Energy, Minerals and Natural Resources Department

Mar. 09 2004 04:02PM P1

Revised March 17, 1999

Instruction on back

Submit to Appropriate District Office

State Lease - 4 Copies

Fee Lease - 3 Copies

# OIL CONSERVATION DIVISION

P.O. Box 2088

Santa Fe, New Mexico 87504-2088

☐ AMENDED REPORT

## WELL LOCATION AND ACREAGE DEDICATION PLAT

API Number	Pool Code	Pool Name Wildcat Precambrian
Property Code	Property Name COOKER "BCB" FEDERAL COM.	Well Number 2
OGRID No. 025575	Operator Name YATES PETROLEUM CORPORATION	Elevation 3636

### Surface Location

UL or lot No.	Section	Township	Range	Lot Idn	Feet from the	North/South line	Feet from the	East/West line	County
A	21	6S	26E		960	NORTH	990	EAST	CHAVES

### Bottom Hole Location If Different From Surface

UL or lot No.	Section	Township	Range	Lot Idn	Feet from the	North/South line	Feet from the	East/West line	County

Dedicated Acres	Joint or Infill	Consolidation Code	Order No.
320			

NO ALLOWABLE WILL BE ASSIGNED TO THIS COMPLETION UNTIL ALL INTERESTS HAVE BEEN CONSOLIDATED  
OR A NON-STANDARD UNIT HAS BEEN APPROVED BY THE DIVISION

	<b>OPERATOR CERTIFICATION</b> I hereby certify the the information contained herein is true and complete to the best of my knowledge and belief.  Signature Robert Asher Printed Name Regulatory Agent Title 3/10/2004 Date	
	<b>SURVEYOR CERTIFICATION</b> I hereby certify that the well location shown on this plat was plotted from field notes of actual surveys made by me or under my supervision, and that the same is true and correct to the best of my belief. 3/09/2004 Date Surveyed  Signature Herschel Jones Printed Name 3640 Certificate No.	
	FEE NM-101575	
	GENERAL SURVEYING COMPANY	

0 550' 600' 650' 1050' 1080' 2310' 1080' 1050' 900' 600' 330' 0'

**YATES PETROLEUM CORPORATION**  
**Cooker BCB Federal #2**  
 960' FNL and 990' FEL  
 Section 21-T6S-R26E  
 Chaves County, New Mexico

1. The estimated tops of geologic markers are as follows:

San Andres	680'	Spear Zone	4830'
Glorieta	1630'	Cisco	5090'
Yeso	1750'	Strawn	5305'
Tubb	3165'	Siluro-Devonian	5435'
Abo	3810'	Precambrian	5510'
Wolfcamp	4505'	TD	5650'

2. The estimated depths at which anticipated water, oil or gas formations are expected to be encountered:

Water: 150'-300'  
 Oil or Gas: Basement formations.

3. Pressure Control Equipment: BOPE will be installed on the 11 3/4" casing and rated for 2000# BOP systems will be consistent with API RP 53. Pressure tests will be conducted before drilling out from under all casing strings, which are set and cemented in place. Blowout Preventor controls will be installed prior to drilling the surface plug and will remain in use until the well is completed or abandoned. Preventors will be inspected and operated at least daily to ensure good mechanical working order, and this inspection recorded on the daily drilling report. See Exhibit C.

**Auxiliary Equipment:**

- A. Auxiliary Equipment: Kelly cock, pit level indicators, flow sensor equipment and a sub with full opening valve to fit the drill pipe and collars will be available on the rig floor in the open position at all times for use when kelly is not in use.

4. THE PROPOSED CASING AND CEMENTING PROGRAM:

- A. Casing Program: (All New)

<u>Hole Size</u>	<u>Casing Size</u>	<u>Wt./Ft</u>	<u>Grade</u>	<u>Coupling</u>	<u>Interval</u>	<u>Length</u>
14 3/4"	11 3/4"	42#	H-40	ST&C	0-950'	950'
11"	8 5/8" *	24#	J-55	ST&C	0-1500'	1500'
7 7/8"	5 1/2"	15.5#	J-55	ST&C	0-5745'	5745'

\* - 8 5/8" will only be set if lost circulation is encountered

1. Minimum Casing Design Factors: Collapse 1.125, Burst 1.0, and Tensile Strength 1.8.
2. A 2,000 psi BOP will be nipped up on the 11 3/4" casing and tested to 1000 psi. YPC requests a variance to be granted in requiring the casing and BOPE to be tested to 2000 psi to testing the casing and BOPE to 1000 psi. The rig pumps will be used to test the casing and BOPE. Rig pumps used in this area cannot safely test above 1000 psi. We would have to go to the greater expense of hiring an independent service company to do the testing. Also, the bottom hole pressure in this field is proven to be near 2200 psi. A shut in surface pressure would be less than 1000 psi. We feel that a 1100 psi test will demonstrate that the BOPE is functioning properly, and in the unlikely event of a gas influx that the BOPE would be sufficient to control the well.

## Cooker BCB Federal #2

### Page 2

#### A. CEMENTING PROGRAM:

Surface Casing: 350 sx Lite "C" (YLD 2.0 WT 12.5). Tail with 200 sx C + 2% CaCl<sub>2</sub> (YLD 1.33 WT 15.6).

Intermediate Casing: 250 sx Class C + 2% CaCl<sub>2</sub> (YLD 1.32 WT 14.8).  
TOC – 750'. (NOTE: 8 5/8" casing will only be set if lost circulation is present)

Production Casing: 650 sx Pecos Valley Lite (YLD 1.34 WT 13.0). TOC 3300'.

#### 5. MUD PROGRAM AND AUXILIARY EQUIPMENT:

<u>Interval</u>	<u>Type</u>	<u>Weight</u>	<u>Viscosity</u>	<u>Fluid Loss</u>
0-950'	FW GEL/Paper/LCM	8.6-9.2	32-34	N/C
950'-1500'	Cut Brine	9.4	28	N/C
1500'-3700'	Brine	9.5-10.0	28	N/C
3750'-5650'	Starch/Salt Gel/KCL	9.8-10.0	45-55	<6CC

Sufficient mud material(s) to maintain mud properties, control lost circulation and contain a blow out will be available at the well site during drilling operations. Mud will be checked hourly by rig personnel.

#### 6. EVALUATION PROGRAM:

Samples: 10' samples from surface to TD.

Logging: Platform Express; CNL/LDT/NGT TD - Surf Csg, CNL/GR TD - Surf Csg.  
DLL/MSFL TD - Surf Csg, BHC Sonic TD - Surf Csg.

Coring: None

DST's: None

#### 7. ABNORMAL CONDITIONS, BOTTOM HOLE PRESSURE, AND POTENTIAL HAZARDS:

Anticipated BHP:

From: 0	TO: 950'	Anticipated Max. BHP: 450 PSI
From: 950'	TO: 5650'	Anticipated Max. BHP: 2950 PSI

Abnormal Pressures Anticipated: None

Lost Circulation Zones Anticipated: None.

H<sub>2</sub>S Zones Anticipated: None Anticipated

Maximum Bottom Hole Temperature: 110 F

#### 8. ANTICIPATED STARTING DATE:

Plans are to drill this well as soon as possible after receiving approval. It should take approximately 10 days to drill the well with completion taking another 20 days.

**MULTI-POINT SURFACE USE AND OPERATIONS PLAN**  
**YATES PETROLEUM CORPORATION**  
**Cooker BCB Federal #2**  
960' FNL and 990' FEL  
Section 21-T6S-R26E  
Chaves County, New Mexico

This plan is submitted with Form 3160-3, Application for Permit to Drill, covering the above described well. The purpose of this plan is to describe the location of the proposed well, the proposed construction activities and operations plan, the magnitude of the surface disturbance involved and the procedures to be followed in rehabilitating the surface after completion of the operations, so that a complete appraisal can be made of the environmental effect associated with the operations.

**1. EXISTING ROADS:**

Exhibit A is a portion of the BLM map showing the well and roads in the vicinity of the proposed location. The proposed well site is located approximately 24 miles northeast of Roswell, New Mexico and the access route to the location is indicated in red and green on Exhibit A.

**DIRECTIONS:**

Go to the intersection of 70/285 in Roswell, NM. Take Hwy 70, east for approx. 14 miles to Aztec road. Turn north and go approximately 14.6 miles to cattle guard right before corrals, drive past corrals and continue for approximately 1.2 miles to another set of corrals. Turn left and go around the west side of the corrals, the road turns left (west), continue for approximately 2.3 miles. The road turns left at the Bobwhite BBH Deep Federal Com. #1 battery, turn left and continue for approximately 2.0 miles. The access road is staked to the left, turn left (east) and continue for approximately 300' to the NW corner of the location.

**2. PLANNED ACCESS ROAD:**

- A. The proposed new access will be approximately 300' in length from the point of origin to the northwest corner of the drilling pad. The road will lie in a west to east direction.
- B. The new road will be 14 feet in width (driving surface) and will be adequately drained to control runoff and soil erosion.
- C. The new road will be bladed with drainage on both sides. No traffic turnout will be built.

**3. LOCATION OF EXISTING WELL:**

- A. There is drilling activity within a one-mile radius of the well site.
- B. Exhibit A shows existing wells within a one-mile radius of the proposed well site.

**4. LOCATION OF EXISTING AND/OR PROPOSED FACILITIES:**

- A. There are no production facilities on this lease at the present time.
- B. In the event that the well is productive, the necessary production facilities will be installed on the drilling pad. If the well is productive oil, a gas or diesel self-contained unit will be used to provide the necessary power. No power will be required if the well is productive of gas.

5. LOCATION AND TYPE OF WATER SUPPLY:

- A. It is planned to drill the proposed well with a fresh water system. The water will be obtained from commercial sources, and will be hauled to the location by truck over the existing and proposed roads shown in Exhibit A.

6. SOURCE OF CONSTRUCTION MATERIALS:

The dirt contractor will locate nearest pit and will obtain any permits and materials needed for construction.

7. METHODS OF HANDLING WASTE DISPOSAL:

- A. Drill cuttings will be disposed of in the reserve pits.
- B. Drilling fluids will be allowed to evaporate in the reserve pits until the pits are dry.
- C. Water produced during operations will be collected in tanks until hauled to an approved disposal system, or separate disposal application will be submitted.
- D. Oil produced during operations will be stored in tanks until sold.
- E. Current laws and regulations pertaining to the disposal of human waste will be complied with.
- F. All trash, junk, and other waste materials will be contained in trash cages or bins to prevent scattering and will be removed and deposited in an approved sanitary landfill. Burial on site is not approved.

8. ANCILLARY FACILITIES: NONE

9. WELLSITE LAYOUT:

- A. Exhibit D shows the relative location and dimensions of the well pad, the reserve pits, the location of the drilling equipment, rig orientation and access road approach. **Note: Pits to the west.**
- B. The reserve pits will be plastic lined.
- C. A 600' x 600' area has been staked and flagged.

10. PLANS FOR RESTORATION:

- A. After finishing drilling and/or completion operations, all equipment and other material not needed for further operations will be removed. The location will be cleaned of all trash and junk to leave the well site in as aesthetically pleasing a condition as possible.
- B. Unguarded pits, if any, containing fluids will be fenced until they have dried and been leveled.
- C. If the proposed well is non-productive, all rehabilitation and/or vegetation requirements of the Bureau of Land Management will be complied with and will be accomplished as expeditiously as possible. All pits will be filled level after they have evaporated and dried.

11. SURFACE OWNERSHIP: Bureau of Land Management – Roswell, NM.
12. OTHER INFORMATION:
- A. Topography: Refer to the existing archaeological report for a description of the topography, flora, fauna, soil characteristics, dwellings, and historical and cultural sites.
- B. The primary surface use is for grazing.
13. OPERATOR'S REPRESENTATIVE:
- |                                |  |
|--------------------------------|--|
| A. Through A.P.D. Approval:    | B. Through Drilling, Completions & Prod. |
| Robert Asher, Regulatory Agent | Pinson McWhorter, Operations Manager     |
| Yates Petroleum Corporation    | Yates Petroleum Corporation              |
| 105 South Fourth Street        | 105 South Fourth Street                  |
| Artesia, New Mexico 88210      | Artesia, New Mexico 88210                |
| Phone (505) 748-1471           | Phone (505) 748-1471                     |
14. CERTIFICATION:

I hereby certify that I, or persons under my direct supervision, have inspected the proposed drill site and access route, that I am familiar with the conditions which presently exist; that the statements made in this plan are to the best of my knowledge, true and correct; and, that the work associated with the operations proposed herein will be performed by Yates Petroleum Corporation and its contractors and subcontractors in conformity with this plan and the terms and conditions under which it is approved. This statement is subject to the provisions of 18 U.S.C. 1001 for the filing of a false statement.

3/10/2004

  
\_\_\_\_\_  
Regulatory Agent

Yates Petroleum Corporation  
Cooker BCB Federal Com. #2  
960' FNL and 990' FEL  
Section 21-T6S-R26E  
Chaves County, New Mexico  
Exhibit "A"

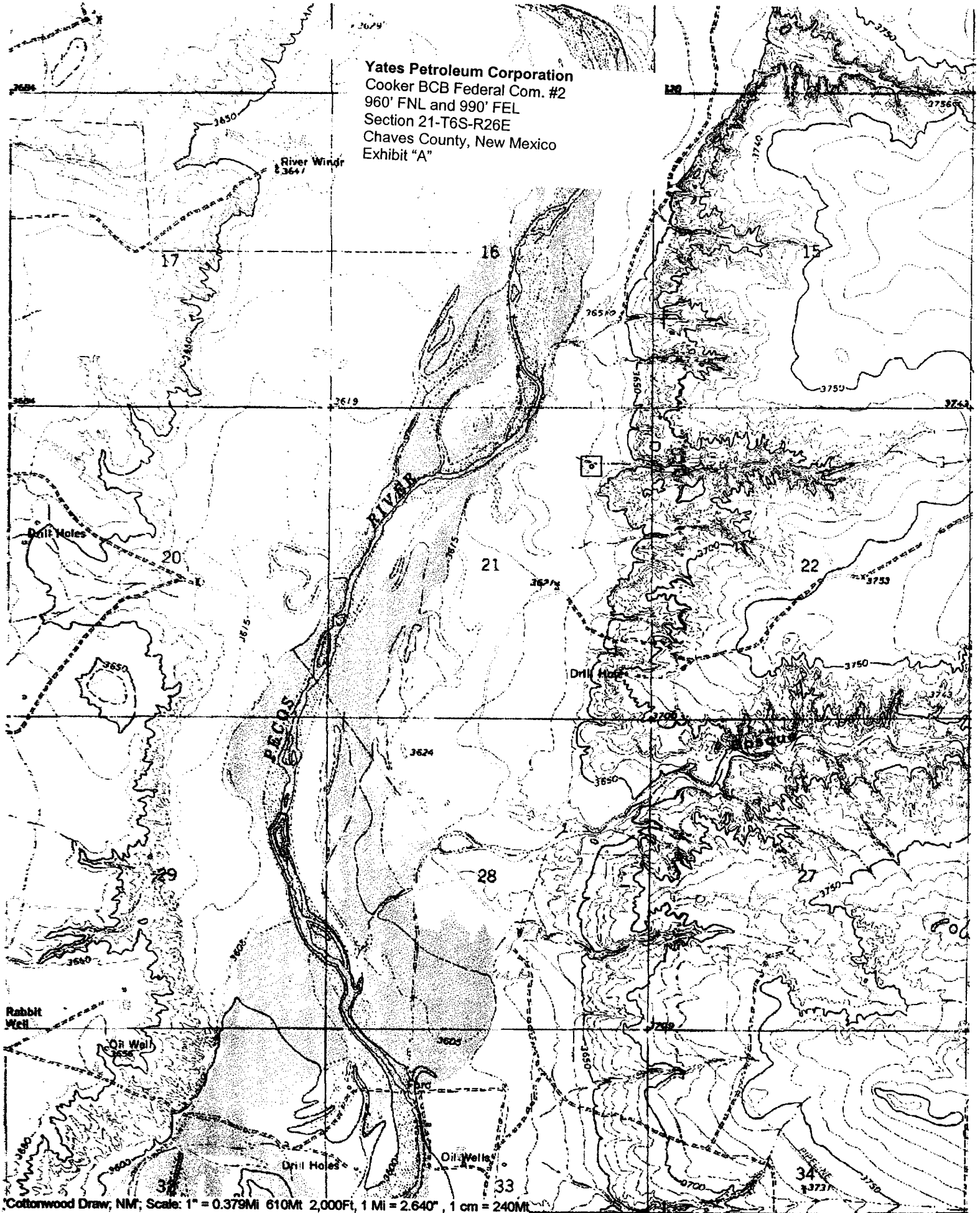

Cottonwood Draw, NM; Scale: 1" = 0.379Mi 610Mtr 2,000Ft, 1 Mi = 2.640" , 1 cm = 240Mtr

Yates Petroleum Corporation  
Cooker BCB Federal Com. #2  
960' FNL and 990' FEL  
Section 21-T6S-R26E  
Chaves County, New Mexico  
Exhibit "B"

# Yates Petroleum Corporation

BOP-2

## Typical 2,000 psi Pressure System Schematic Double Ram Preventer Stack

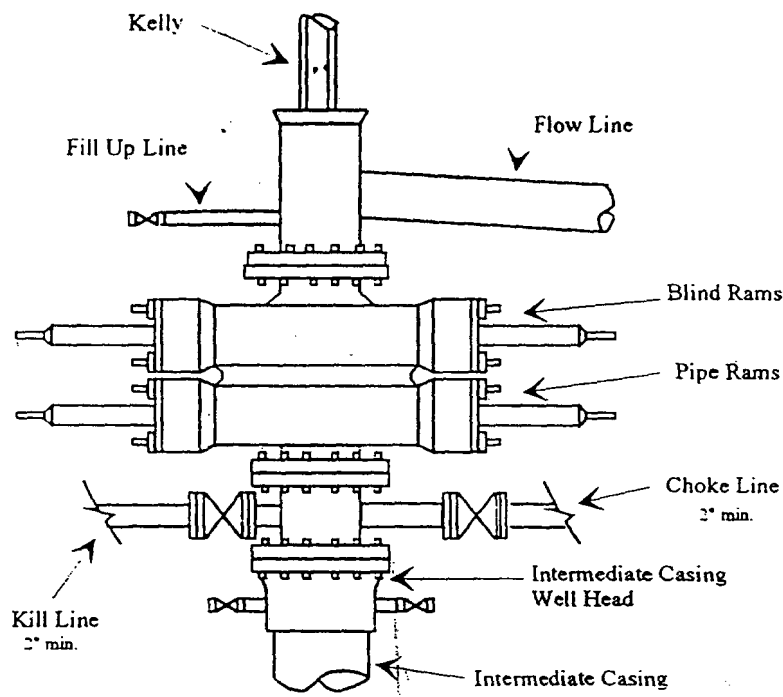

Typical 2,000 psi choke manifold assembly with at least these minimum features

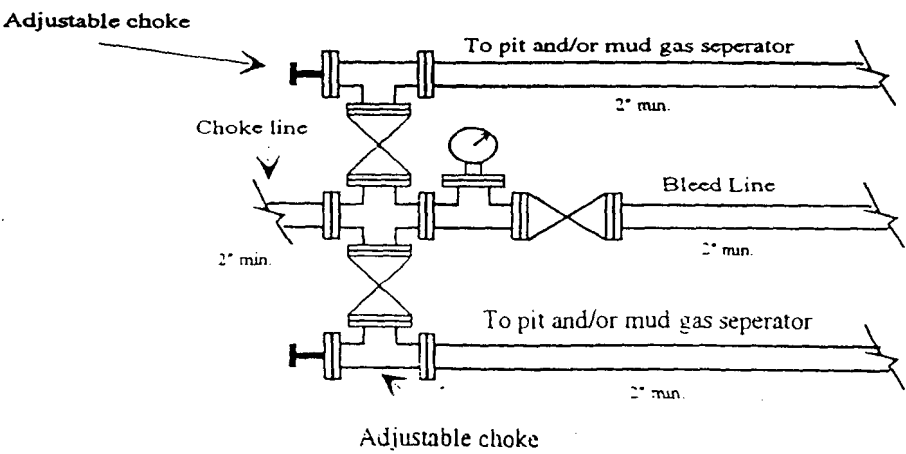

Yates Petroleum Corporation  
 Cooker BCB Federal Com. #2  
 960' FNL and 990' FEL  
 Section 21-T6S-R26E  
 Chaves County, New Mexico  
 Exhibit "C"

PB - L1

# Yates Petroleum Corporation

## Location Layout for Permian Basin

### Up to 12,000'

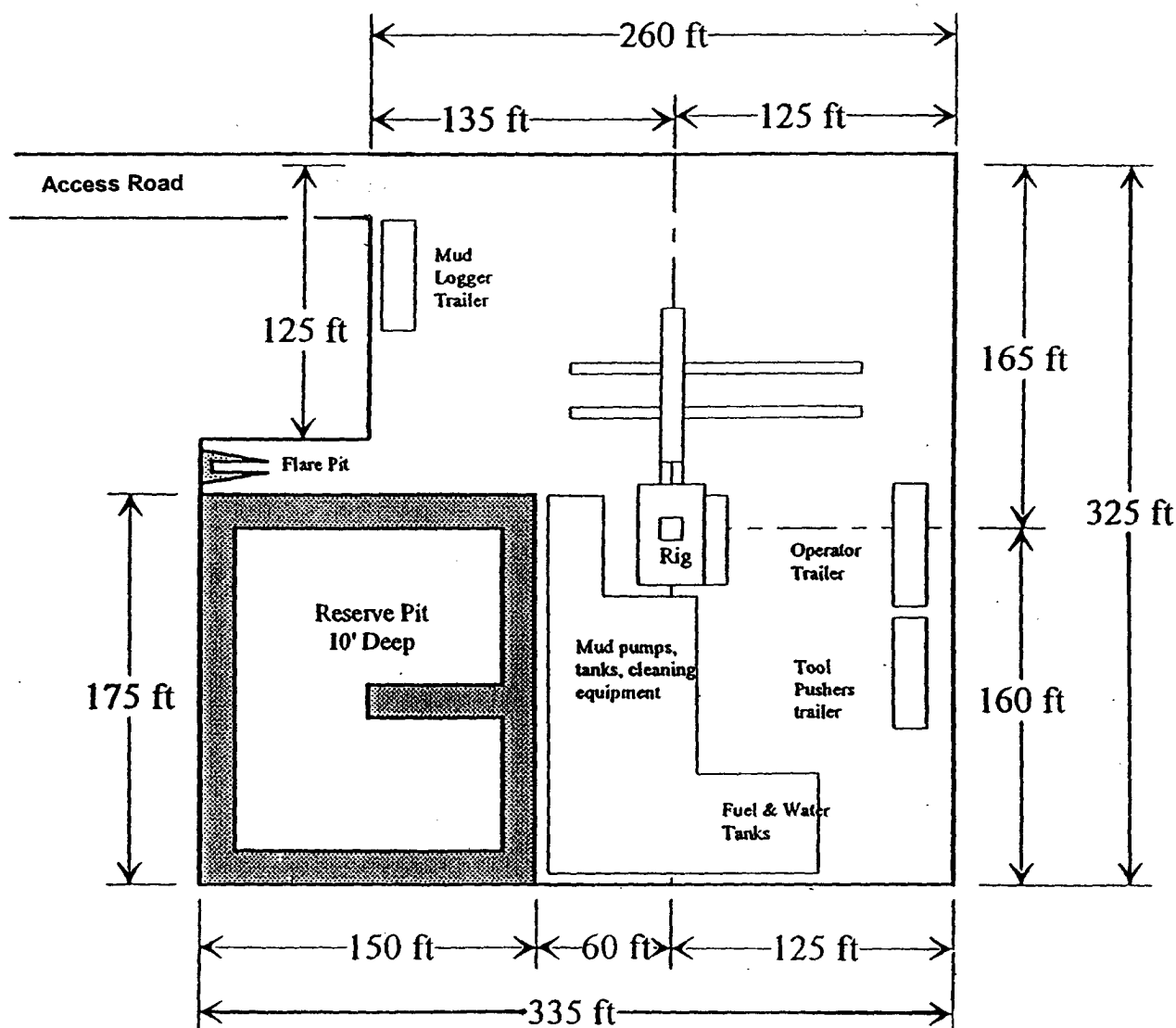
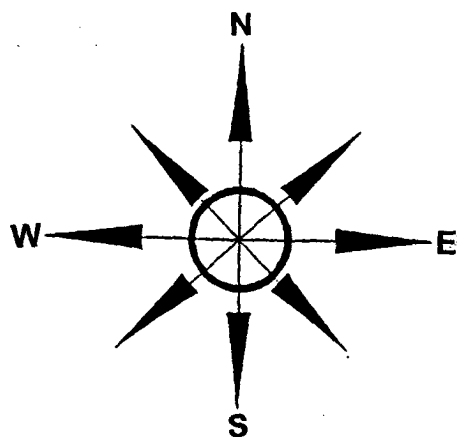

Distance from Well  
 Head to Reserve Pit  
 will vary between rigs

The above dimension  
 should be a maximum

25 State  
Yates Drlg  
3-1-2003  
90510  
1200

U.S.  
40  
MAP Reliance  
Op.  
10-1-2003  
VA 1831  
1563  
40  
36  
Mesa Pet.  
Crockett St.  
TD 4799  
DA 1120-79  
40  
State

41 Yates Pet, etal 21  
10-1-2003 State 2 v 5372  
10/97

Yates Pet. et al  
5/1/2003  
90861  
1000

Yates Pet. et al  
12-10-2006 11-5-2006  
8-20-2006 7-16-2006  
12-20-2004  
1 Smith Mobil  
Smith Est. & H.J. Hughes  
Walter Fisher  
14  
Yates Pet. et al  
12-1-2006  
101575 U.S.  
1000  
U.S.  
Yates (S)

23

ROSCHE

U. S.

Yates Pet. et al  
HBP  
25866

26

Elliott  
Cronde  
TO 4496  
DIA 3-23

U.S.  
McKay Oil  
12253  
Petrol Yates Pet  
C NW/4 12253  
523 10676  
35 1000  
2 2-x  
J/A 1256 J.G. Brown  
U.S. Govt.  
Slaughter Oil  
P37  
"Mariola - Fed."  
U.S.

Yates Pet., et al  
469  
CG-7458

2

"Galleta - St."  
State