

District I
1625 N. French Dr., Hobbs, NM 88240
District II
1301 W. Grand Avenue, Artesia, NM 88210
District III
1000 Rio Brazos Road, Aztec, NM 87410
District IV
1220 S. St. Francis Dr., Santa Fe, NM 87505

State of New Mexico
Energy Minerals and Natural Resources

Form C-101
March 4, 2004

Oil Conservation Division
1220 South St. Francis Dr.
Santa Fe, NM 87505

RECEIVED

Submit to appropriate District Office
State Lease - 6 Copies
Fee Lease - 5 Copies

OCD-ARTESIA

☐ AMENDED REPORT

APPLICATION FOR PERMIT TO DRILL, RE-ENTER, DEEPEN, PLUGBACK, OR ADD A ZONE

¹ Operator Name and Address Yates Petroleum Corporation 105 South Fourth Street Artesia, NM 88210		² OGRID Number 025575 API Number 30 - 015 - 25732
³ Property Code 28888	⁵ Property Name Parish IV Deep Corn.	⁶ Well No. 1

⁷ Surface Location

UL or lot no.	Section	Township	Range	Lot Idn	Feet from the	North/South line	Feet from the	East/West line	County
J	19	19S	25E		1980'	South	1980'	East	Eddy

⁸ Proposed Bottom Hole Location If Different From Surface

UL or lot no.	Section	Township	Range	Lot Idn	Feet from the	North/South line	Feet from the	East/West line	County
⁹ Proposed Pool 1 Undes. Cemetery; Merion					¹⁰ Proposed Pool 2				

Drilling Pit Location and Other Information

UL or lot no. J	Section 19	Township 19S	Range 25E	Lot Idn	Feet from the 1980'	North/South line South	Feet from the 1980'	East/West line East	County Eddy
Depth to ground water 150'				Distance from nearest fresh water well 1.5 mile			Distance from nearest surface water .3 mile		
¹¹ Work Type Code E		¹² Well Type Code G		¹³ Cable/Rotary R		¹⁴ Lease Type Code P		¹⁵ Ground Level Elevation 3565'	
¹⁶ Multiple No		¹⁷ Proposed Depth 9400'		¹⁸ Formation Mississippian		¹⁹ Contractor Not Determined		²⁰ Spud Date ASAP	

²¹ Proposed Casing and Cement Program

Hole Size	Casing Size	Casing weight/foot	Setting Depth	Sacks of Cement	Estimated TOC
14 3/4"	9 5/8"	36 #	1147'	1200	In Place
8 3/4"	7"	23 # & 26 #	8115'	675	In Place
6 1/8"	4 1/2" Liner	11.6 #	9400'	200	TOC 7600'

²² Describe the proposed program. If this application is to DEEPEN or PLUG BACK, give the data on the present productive zone and proposed new productive zone. Describe the blowout prevention program, if any. Use additional sheets if necessary.
See Attached Page

²³ I hereby certify that the information given above is true and complete to the best of my knowledge and belief. I further certify that the drilling pit will be constructed according to NMOCD guidelines ☐, a general permit ☒ or an (attached) alternative OCD-approved plan ☐.

Signature:

Cy Cowan

Printed name: Cy Cowan

Title: Regulatory Agent / Land Department

E-mail Address: debbiec@ypcn.com

Date: August 16, 2004

Phone: (505) 748-4372

OIL CONSERVATION DIVISION

Approved by:

TIM W. GUM
DISTRICT II SUPERVISOR

Title:

Approval Date: AUG 24 2004

Expiration Date: AUG 24 2005

Conditions of Approval:

Attached ☐

YATES PETROLEUM CORPORATION

Parish IV Deep Corn.#1

Drilling Prognosis

Page 2

This well was originally drilled by Yates Petroleum Corporation. It was spudded on March 14, 1987 and TD was reached April 8, 1987.

Yates Petroleum Corporation proposes to re-enter this well with a pulling unit and reverse unit. The 9 5/8" and 7" casing are set and cemented in place. The pulling unit will squeeze off the existing perforations (7692'-8008') and clean out the well to the old TD of 8115'. A drilling rig will then move in and deepen the well to 9400' with a 6 1/8" bit. The 4 1/2" liner will then be set from 7600' to 9400' and cemented in place with 200 sacks Super C Modified.

MUD PROGRAM: 0-8115' Cut Brine (Weight: 9.0-9.2, Vis: 30-34).
8115'-9400' Salt Gel/Starch/Drispac (Weight 9.2-9.8 Vis 30-38)

BOPE PROGRAM: 3000 # BOPE will be nipped up on 7" casing.



6 1/8" hole

NON-STANDARD UNIT HAS BEEN APPROVED BY THE DIVISION				<div style="border: 1px solid black; padding: 5px;"> <div style="text-align: right;">16</div> </div>
				<div style="border: 1px solid black; padding: 5px;"> <div style="text-align: right;">17</div> <div style="text-align: center;">OPERATOR CERTIFICATION</div> <p>I hereby certify that the information contained herein is true and complete to the best of my knowledge and belief.</p> <div style="text-align: right; font-family: cursive; font-size: 1.2em;">Cy Cowan</div> <div style="border-top: 1px solid black; margin-top: 5px;">Signature</div> <div style="border-top: 1px solid black; margin-top: 5px;">Cy Cowan Printed Name</div> <div style="border-top: 1px solid black; margin-top: 5px;">Regulatory Agent Title</div> <div style="border-top: 1px solid black; margin-top: 5px;">08/16/2004 Date</div> </div>
				<div style="border: 1px solid black; padding: 5px;"> <div style="text-align: right;">18</div> <div style="text-align: center;">SURVEYOR CERTIFICATION</div> <p>I hereby certify that the well location shown on this plat was plotted from field notes of actual surveys made by me or under my supervision, and that the same is true and correct to the best of my belief.</p> <div style="border-top: 1px solid black; margin-top: 5px;">Date of Survey</div> <div style="border-top: 1px solid black; margin-top: 5px;">Signature and Seal of Professional Surveyor:</div> <div style="border-top: 1px solid black; margin-top: 5px;">Refer to Original Plat</div> <div style="border-top: 1px solid black; margin-top: 5px;">Certificate Number</div> </div>
				<div style="border: 1px solid black; padding: 5px;"> <div style="text-align: right;">19</div> </div>
FEE	FEE	FEE	NM-0557142	FEE

DISTRICT II
611 South First, Artesia, NM 86210

DISTRICT III
1000 Rio Brazos Rd., Artec, NM 87410

DISTRICT IV
2040 South Pacheco, Santa Fe, NM 87506

Energy, Minerals and Natural Resources Department

Revised March 17, 1964

Instruction on back

Submit to Appropriate District Office

State Loan = 4.6%

Free Loans - 3 Cops

OIL CONSERVATION DIVISION

P.O. Box 2088

Santa Fe, New Mexico 87504-2088

☐ AMENDED REPORT

WELL LOCATION AND ACREAGE DEDICATION PLAT

API Number		Pool Code	Pool Name
			Wildcat
Property Code	Property Name		Well Number
	Parish IV Deep Com.		1
OCHD No.	Operator Name		Elevation
025577	YATES PETROLEUM CORPORATION		3565'

Surface Location

UL or lot No.	Section	Township	Range	Lot Idn	Feet from the	North/South line	Feet from the	East/West line	County
---------------	---------	----------	-------	---------	---------------	------------------	---------------	----------------	--------

Bottom Hole Location If Different From Surface

UL or lot No.	Section	Township	Range	Lot Idn	Feet from the	North/South line	Feet from the	East/West line	County
J	19	19S	25E		1980'	South	1980'	East	Eddy
Dedicated Acres	Joint or Infill	Consolidation Code	Order No.						
320									

**NO ALLOWABLE WILL BE ASSIGNED TO THIS COMPLETION UNTIL ALL INTERESTS HAVE BEEN CONSOLIDATED
OR A NON-STANDARD UNIT HAS BEEN APPROVED BY THE DIVISION**

	<p style="text-align: center;">OPERATOR CERTIFICATION</p> <p><i>I hereby certify that the information contained herein is true and complete to the best of my knowledge and belief.</i></p> <p style="text-align: right; font-size: 1.2em;"><i>Cy Cowan</i></p> <p>Signature _____</p> <p style="text-align: right;">Cy Cowan</p> <p>Printed Name _____</p> <p style="text-align: right;">Regulatory Agent</p> <p>Title _____</p> <p style="text-align: right;">September 18, 2001</p> <p>Date _____</p>
<p style="text-align: center; font-size: 1.5em;">FEE</p>	<p style="text-align: center;">SURVEYOR CERTIFICATION</p> <p><i>I hereby certify that the well location shown on this plat was plotted from field notes of actual surveys made by me or under my supervision, and that the same is true and correct to the best of my belief.</i></p> <p style="text-align: right;">1980'</p> <p style="text-align: right;">NM-0557142</p> <p style="text-align: right;">FEE</p>
<p style="text-align: center; font-size: 1.5em;">FEE</p>	<p style="text-align: center;">REFER TO ORIGINAL PLAT</p> <p>Date Surveyed _____</p> <p>Signature & Seal of _____</p> <p>Professional Surveyor _____</p>
<p style="text-align: center; font-size: 1.5em;">FEE</p>	<p style="text-align: center;">Certification No. Herschel L. Jones RLS 3640</p> <p style="text-align: center;">GENERAL SURVEYING COMPANY</p>



Yates Petroleum Corporation

BOP-3

Typical 3,000 psi Pressure System Schematic Annular with Double Ram Preventer Stack

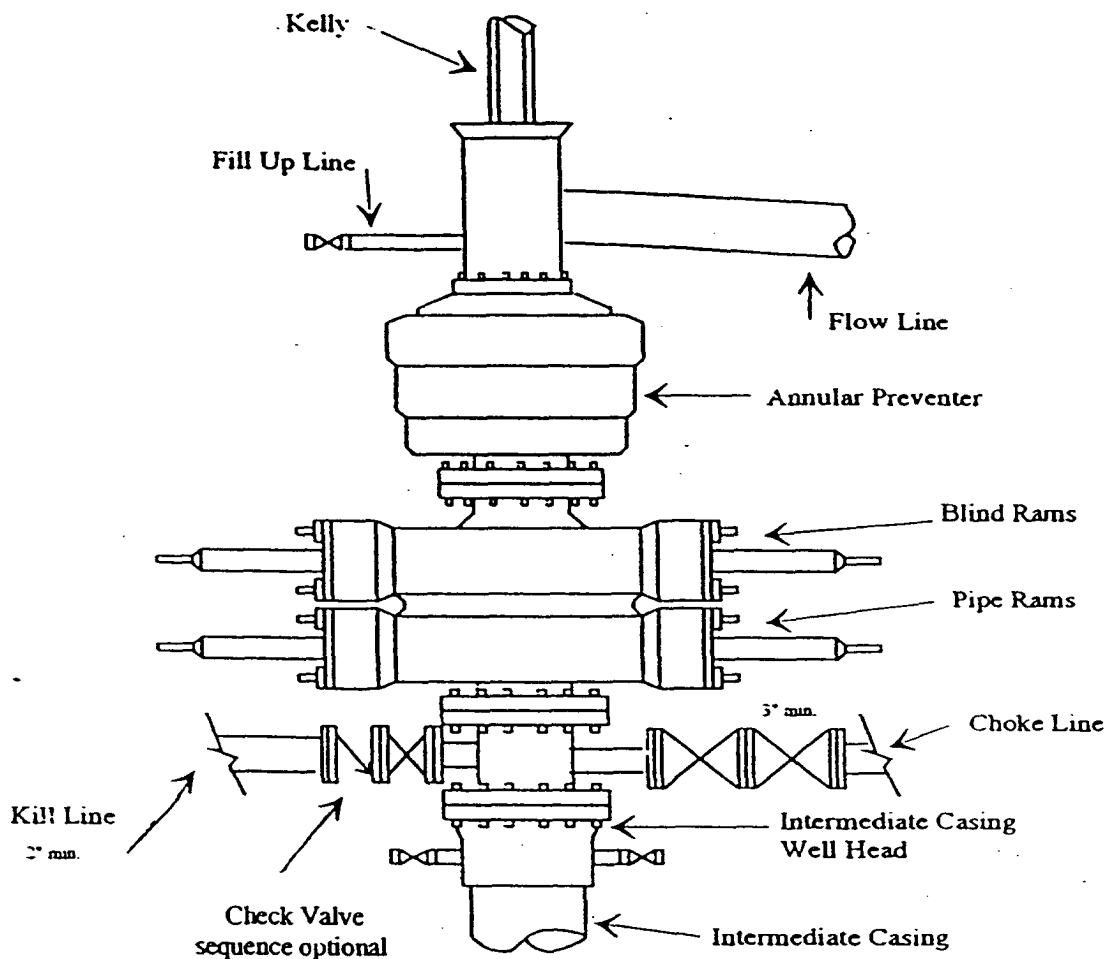

Typical 3,000 psi choke manifold assembly with at least these minimum features

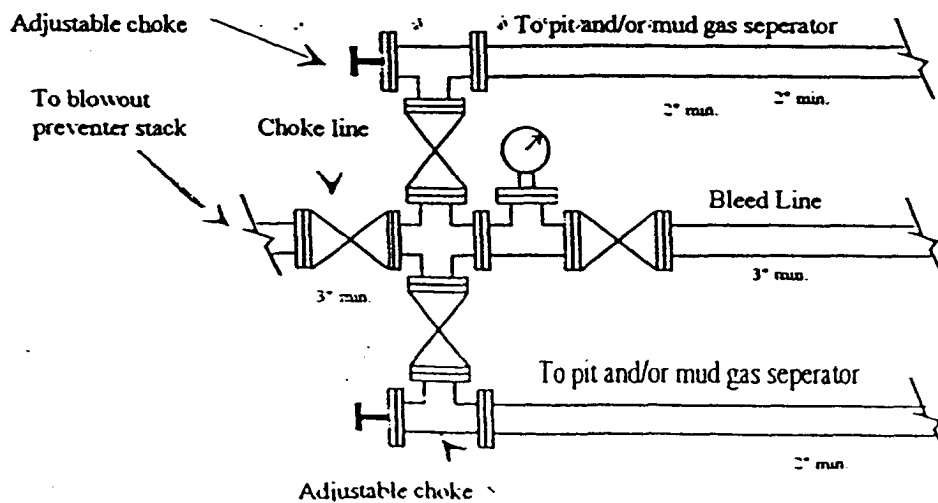

**NEW MEXICO OIL CONSERVATION COMMISSION
WELL LOCATION AND ACREAGE DEDICATION PLAT**

Form C-102
Supersedes C-101
Effective 1-1-87

All distances must be from the outer boundaries of the Section.

Operator YATES PETROLEUM CORPORATION			Lease Parish IV Com		Well No. 1
Unit Letter J	Section 19	Township 19 South	Range 25 East	County Eddy	
Actual Footage Location of Well: <div style="display: flex; justify-content: space-between;"> 1980 feet from the South line and 1980 feet from the East line </div>					
Ground Level Elev. 3565.	Producing Formation CISCO-CANYON	Pool UNDES. North Daggar Draw Upper Penn		Dedicated Acreage: 160 Acres.	

1. Outline the acreage dedicated to the subject well by colored pencil or hachure marks on the plat below.
2. If more than one lease is dedicated to the well, outline each and identify the ownership thereof (both as to working interest and royalty).
3. If more than one lease of different ownership is dedicated to the well, have the interests of all owners been consolidated by communitization, unitization, force-pooling, etc?

☐ Yes ☒ No If answer is "yes," type of consolidation _____

If answer is "no," list the owners and tract descriptions which have actually been consolidated. (Use reverse side of this form if necessary.) _____

No allowable will be assigned to the well until all interests have been consolidated (by communitization, unitization, forced-pooling, or otherwise) or until a non-standard unit, eliminating such interests, has been approved by the Commission.

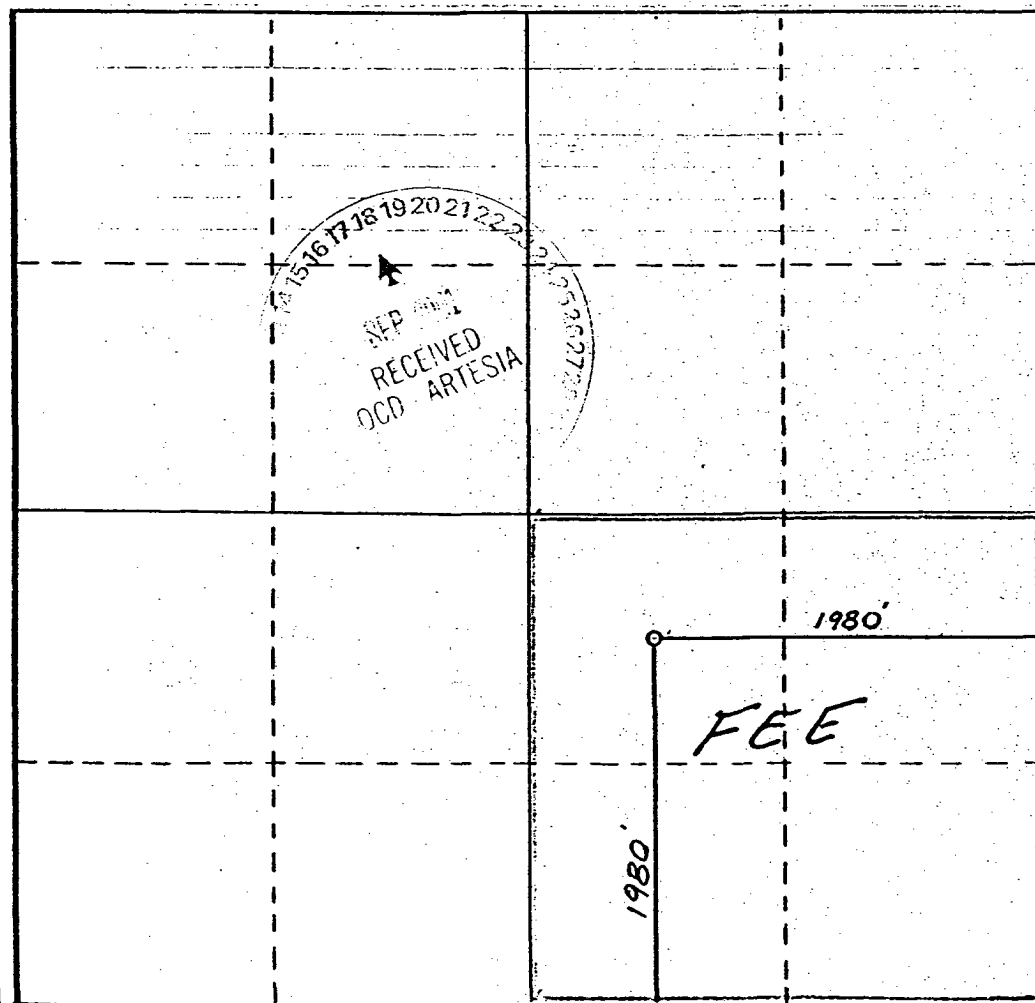

CERTIFICATION

I hereby certify that the information contained herein is true and complete to the best of my knowledge and belief.

Cy Cowan

Name
Regulatory Agent

Position
Yates Petroleum Corporation

Company
February 18, 1987

Date

I hereby certify the well location shown on this plat was plotted from field notes of actual surveys made by me or under my supervision, and that the same is true and correct to the best of my knowledge and belief.

Date Surveyed
February 13, 1987

Registered Professional Engineer and/or Land Surveyor

Dan R. Reddy

Certificate No.
NM PE&LS NO. 5412

All distances must be from the outer boundaries of the Section.

Operator Yates Petroleum Corp		Lease PARISH IV Com		Well No. 1
Unit Letter J	Section 19	Township 19 South	Range 25 East	County EDDY
Actual Footage Location of Well: 1980 feet from the South line and 1980 feet from the EAST line				
Ground Level Elev. 3565'	Producing Formation CISCO-CANYON		WIDES North Dagger Draw Upper Penn	Dedicated Acreage: 160

- Outline the acreage dedicated to the subject well by colored pencil or hatchure marks on the plat below.
- If more than one lease is dedicated to the well, outline each and identify the ownership thereof (both as to well interest and royalty).
- If more than one lease of different ownership is dedicated to the well, have the interests of all owners been consolidated by communitization, unitization, force-pooling, etc?

☒ Yes ☐ No If answer is "yes," type of consolidation Communitization

If answer is "no," list the owners and tract descriptions which have actually been consolidated. (Use reverse side of this form if necessary.)

No allowable will be assigned to the well until all interests have been consolidated (by communitization, unitization, force-pooling, or otherwise) or until a non-standard unit, eliminating such interests, has been approved by the Div

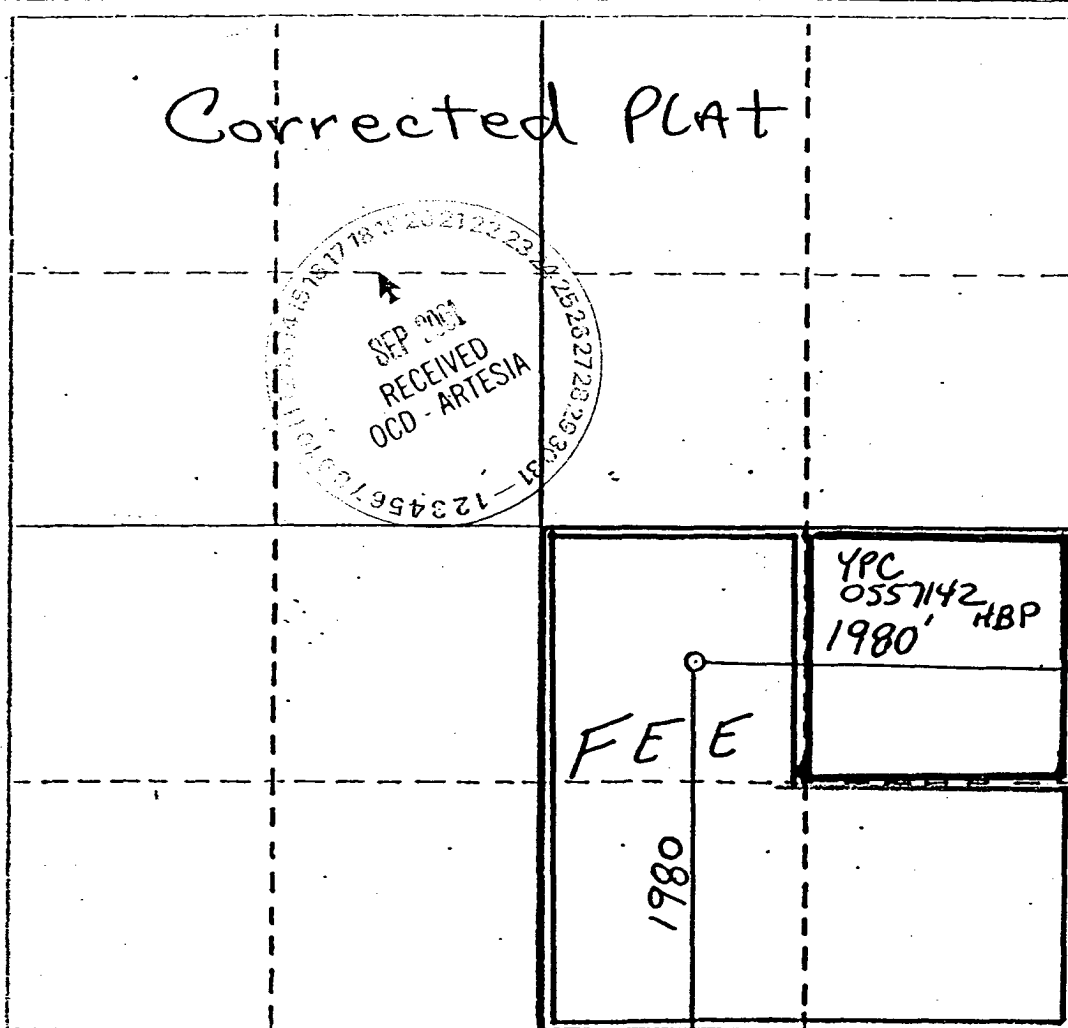

CERTIFICATION

I hereby certify that the information contained herein is true and complete to the best of my knowledge and belief.

Cy Gowan
Name

Cy Gowan
Position

Regulatory Age
Company

Yates Petroleum
Date

2-23-87

I hereby certify that the well location shown on this plot was plotted from notes of actual surveys made by me under my supervision, and that the same is true and correct to the best of my knowledge and belief.

Refer to Original
Date Surveyed

PLAT

Registered Professional Engineer
and/or Land Surveyor

Certificate No.

