

District I
1625 N. French Dr., Hobbs, NM 88240
District II
1301 W. Grand Avenue, Artesia, NM 88210
District III
1000 Rio Brazos Road, Aztec, NM 87410
District IV
1220 S. St. Francis Dr., Santa Fe, NM 87505

State of New Mexico
Energy Minerals and Natural Resources

Form C-101
May 27, 2004

Oil Conservation Division
1220 South St. Francis Dr.
Santa Fe, NM 87505

RECEIVED Submit to appropriate District Office

AUG 20 2004

☐ AMENDED REPORT

OCD-ARTESIA

APPLICATION FOR PERMIT TO DRILL, RE-ENTER, DEEPEN, PLUGBACK, OR ADD A ZONE

¹ Operator Name and Address Edge Petroleum Operating Company, Inc. 1301 Travis, Suite 1700 Houston, Texas 77002		² OGRID Number 224400
		³ API Number 30 - 015 - 23580
⁴ Property Code	⁵ Property Name Red Lake 36 A State	⁶ Well No. #1
⁹ Proposed Pool 1 Red Lake; Glorieta-Yeso, Northeast		¹⁰ Proposed Pool 2 Red Lake; Queen - Grayburg - San Andres

⁷ Surface Location

UL or lot no.	Section	Township	Range	Lot Idn	Feet from the	North/South line	Feet from the	East/West line	County
A	36	17-S	27-E		330'	North	990'	East	Eddy

⁸ Proposed Bottom Hole Location If Different From Surface

UL or lot no.	Section	Township	Range	Lot Idn	Feet from the	North/South line	Feet from the	East/West line	County

Additional Well Information

¹¹ Work Type Code N	¹² Well Type Code O	¹³ Cable/Rotary R	¹⁴ Lease Type Code S	¹⁵ Ground Level Elevation 3615'
¹⁶ Multiple No	¹⁷ Proposed Depth 3700'	¹⁸ Formation Yeso	¹⁹ Contractor United Drilling	²⁰ Spud Date September 1, 2004
Depth to Groundwater 250'		Distance from nearest fresh water well Over 1000'		Distance from nearest surface water Over 1000'
Pit: Liner: Synthetic <input checked="" type="checkbox"/> 12_mils thick Clay <input type="checkbox"/> Pit Volume: _____ bbls Drilling Method: Closed-Loop System <input type="checkbox"/> Fresh Water <input checked="" type="checkbox"/> Brine <input checked="" type="checkbox"/> Diesel/Oil-based <input type="checkbox"/> Gas/Air <input type="checkbox"/>				

²¹ Proposed Casing and Cement Program

Hole Size	Casing Size	Casing weight/foot	Setting Depth	Sacks of Cement	Estimated TOC
12 1/4	8 5/8	24#	400'	300	Surface
7 7/8	5 1/2	14#	3700'	450	Surface

²² Describe the proposed program. If this application is to DEEPEN or PLUG BACK, give the data on the present productive zone and proposed new productive zone. Describe the blowout prevention program, if any. Use additional sheets if necessary.

Drill, case and complete well in the Glorieta-Yeso, Northeast or Queen-Grayburg-San Andres formation

BOP's include: 1) Hydrill double Ram 10" X 3000 psi

2) Double Ram 10" X 3000 psi

3) Choke Manifold 3" X 3000 psi

4) Three Station accumulator closing unit with remote control

Sources at Edge Petroleum Operating Company, Inc advised me that they do not anticipate enough H₂S from the surface to TD to meet the OCD's minimum requirements for the submission of a contingency plan per Rule 118, however H₂S monitoring equipment will be on location from below surface casing to TD.

Mud program attached.

²³ I hereby certify that the information given above is true and complete to the best of my knowledge and belief. I further certify that the drilling pit will be constructed according to NMOCD guidelines ☒, a general permit ☐, or an (attached) alternative OCD-approved plan ☐.

Printed name: Randell K. Ford

Title: Consultant

E-mail Address: Randell@rkford.com

Date: August 19, 2004

Phone: (432)682-0440

Approved by:

TIM W. GUM
DISTRICT II SUPERVISOR

Title:

Approval Date: **AUG 25 2004**

Expiration Date: **AUG 25 2005**

Conditions of Approval Attached ☐

State of New Mexico

DISTRICT I

1625 N. FRENCH DR., HOBBS, NM 88240

Energy, Minerals and Natural Resources Department

DISTRICT II

1301 W. GRAND AVENUE, ARTESIA, NM 88210

DISTRICT III

1000 Rio Brazos Rd., Aztec, NM 87410

DISTRICT IV

1220 S. ST. FRANCIS DR., SANTA FE, NM 87505

OIL CONSERVATION DIVISION

1220 SOUTH ST. FRANCIS DR.
Santa Fe, New Mexico 87505Form C-102
Revised JUNE 10, 2003
Submit to Appropriate District Office
State Lease - 4 Copies
Fee Lease - 3 Copies

WELL LOCATION AND ACREAGE DEDICATION PLAT

☐ AMENDED REPORT

API Number		Pool Code	Pool Name
Property Code	Property Name RED LAKE 36 A STATE		Well Number 1
OGRID No.	Operator Name EDGE PETROLEUM OPERATING COMPANY, INC		Elevation 3615'

Surface Location

UL or lot No.	Section	Township	Range	Lot Idn	Feet from the	North/South line	Feet from the	East/West line	County
A	36	17-S	27-E		330	NORTH	990	EAST	EDDY

Bottom Hole Location If Different From Surface

UL or lot No.	Section	Township	Range	Lot Idn	Feet from the	North/South line	Feet from the	East/West line	County
Dedicated Acres 40		Joint or Infill	Consolidation Code		Order No.				

NO ALLOWABLE WILL BE ASSIGNED TO THIS COMPLETION UNTIL ALL INTERESTS HAVE BEEN CONSOLIDATED
OR A NON-STANDARD UNIT HAS BEEN APPROVED BY THE DIVISION

GEODETTIC COORDINATES
NAD 27 NME

Y=653597.5 N
X=532891.6 E

LAT.=32°47'48.42" N
LONG.=104°13'34.66" W

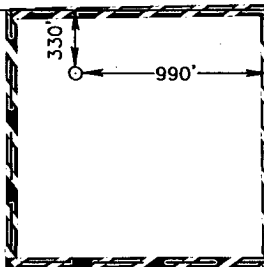

OPERATOR CERTIFICATION

I hereby certify the the information
contained herein is true and complete to the
best of my knowledge and belief.

Randall K Ford
Signature

Randell K. Ford
Printed Name

Consultant
Title

August 16, 2004
Date

SURVEYOR CERTIFICATION

I hereby certify that the well location shown
on this plat was plotted from field notes of
actual surveys made by me or under my
supervision, and that the same is true and
correct to the best of my belief.

JULY 29, 2004

Date Surveyed JR

Signature & Seal of
Professional Surveyor

Gary E. Edson
04.11.0945

Certificate No. GARY EDSON 12641

SECTION 36, TOWNSHIP 17 SOUTH, RANGE 27 EAST, N.M.P.M.,
EDDY COUNTY, NEW MEXICO

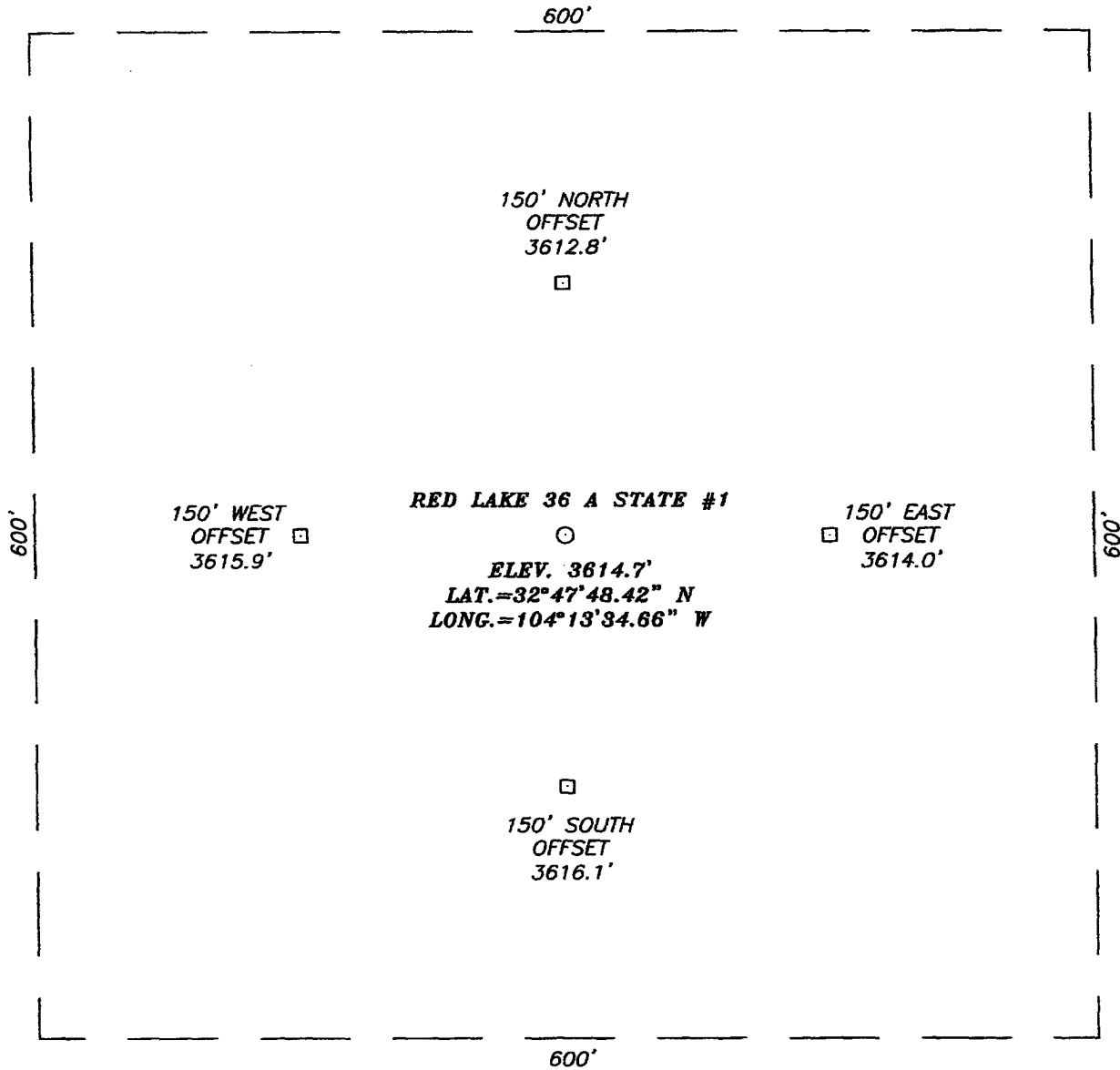

DIRECTIONS TO LOCATION

FROM THE INTERSECTION OF U.S. HWY. #82 AND
 CO. RD. #204 (HILLTOP RD.) GO S/SE ON CO.
 RD. #204 FOR APPROX. 0.8 MILES TO A CALICHE
 ROAD ON THE LEFT. TURN LEFT (EAST) AND
 FOLLOW ROAD E/SE APPROX. 0.3 MILES.
 PROPOSED LOCATION IS APPROX. 300' SOUTH.

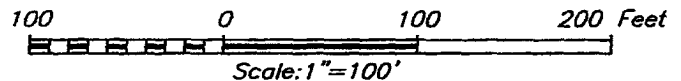

EDGE PETROLEUM OPERATING COMPANY, INC

RED LAKE 36 A STATE #1 WELL
 LOCATED 330 FEET FROM THE NORTH LINE
 AND 990 FEET FROM THE EAST LINE OF SECTION 36,
 TOWNSHIP 17 SOUTH, RANGE 27 EAST, N.M.P.M.,
 EDDY COUNTY, NEW MEXICO.

Survey Date: 07/29/04	Sheet 1 of 1 Sheets
W.O. Number: 04.11.0945	Dr By: J. RIVERO Rev 1:N/A
Date: 08/03/04	Disk: CD#10 04110945 Scale: 1"=100'

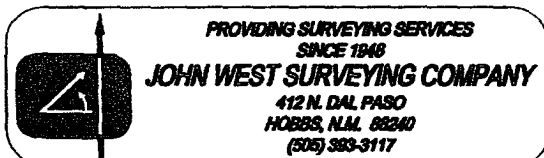

VICINITY MAP

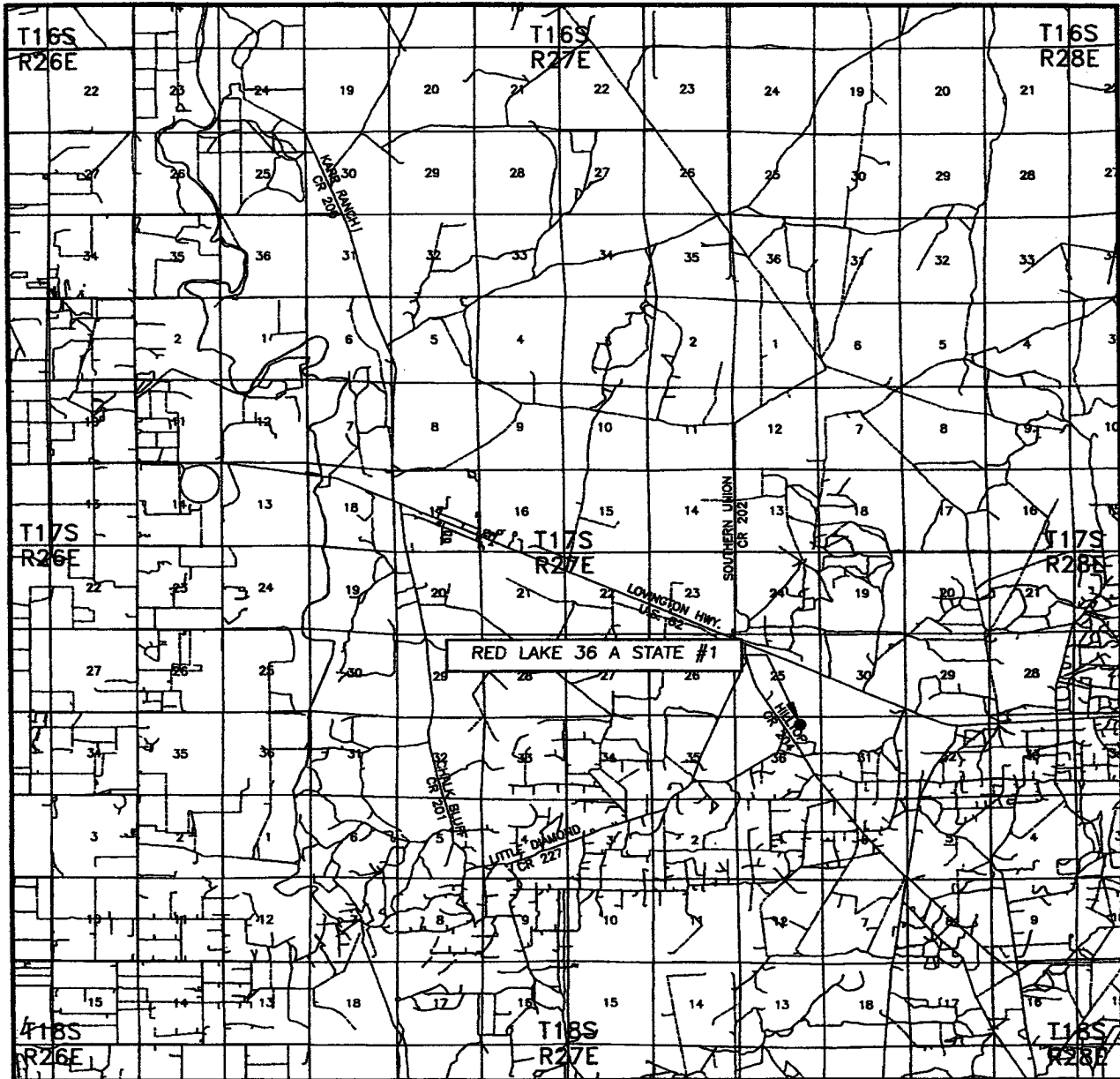

SCALE: 1" = 2 MILES

SEC. 36 TWP. 17-S RGE. 27-E

SURVEY N.M.P.M.

COUNTY EDDY

DESCRIPTION 330' FNL & 990' FEL

ELEVATION 3615'

OPERATOR EDGE PETROLEUM
OPERATING COMPANY, INC

LEASE RED LAKE 36 A STATE

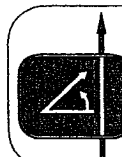

PROVIDING SURVEYING SERVICES
SINCE 1948
JOHN WEST SURVEYING COMPANY
412 N. DAL. PASO
HOBBS, N.M. 88240
(505) 383-3117

LOCATION VERIFICATION MAP

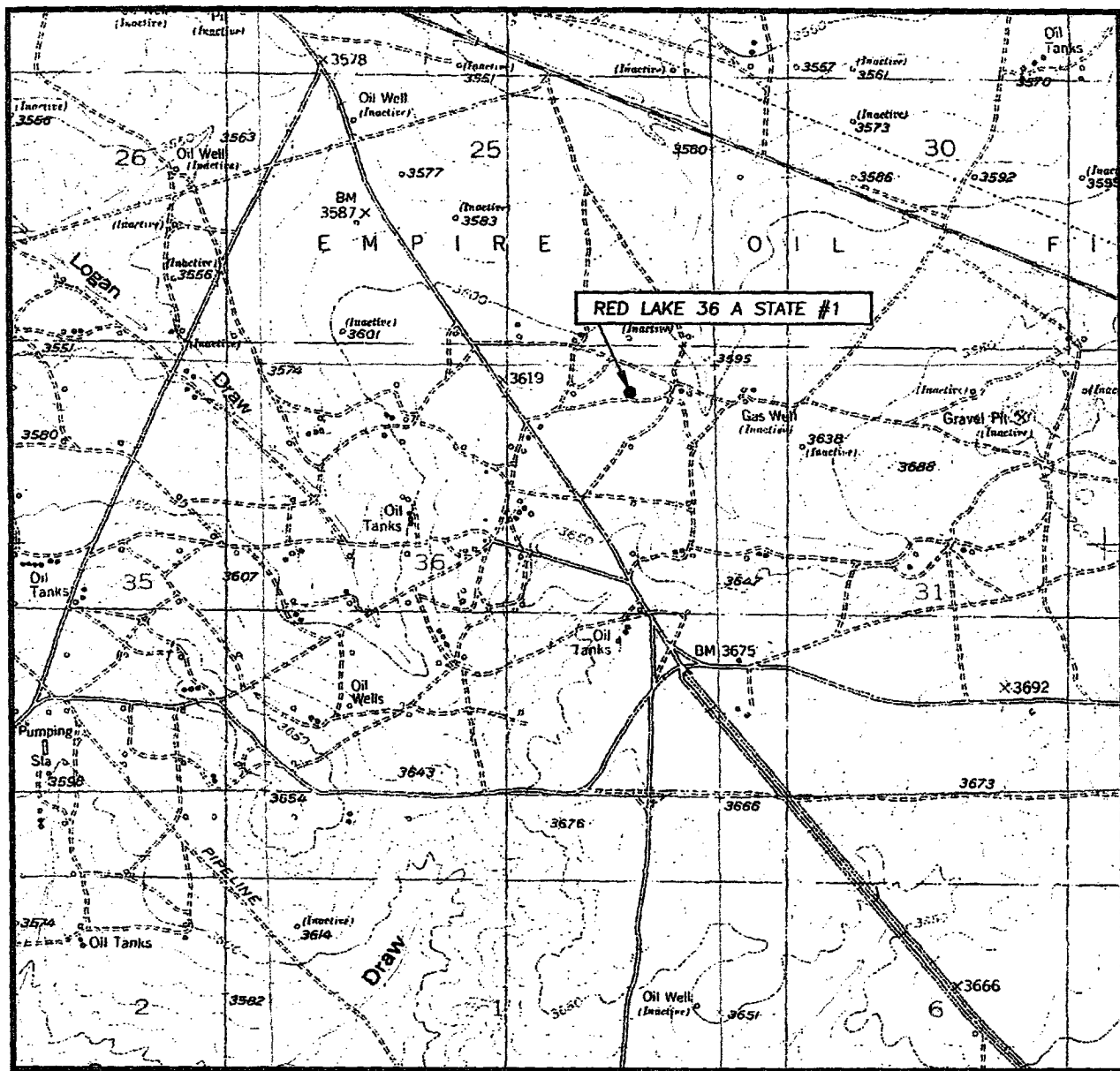

SCALE: 1" = 2000'

CONTOUR INTERVAL:
REDLAKE, N.M. - 10'

SEC. 36 TWP. 17-S RGE. 27-E

SURVEY N.M.P.M.

COUNTY EDDY

DESCRIPTION 330' FNL & 990' FEL

ELEVATION 3615'

EDGE PETROLEUM
OPERATOR OPERATING COMPANY, INC

LEASE RED LAKE 36 A STATE

U.S.G.S. TOPOGRAPHIC MAP
REDLAKE, N.M.

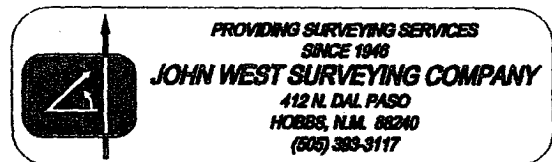



Newpark Drilling Fluids, LLC



Edge Petroleum Operating Company Inc.
Red Lake 36 "A" State No. 1
Section 36, T-17-S, R-27-E
Eddy County, New Mexico

Mud Program Summary

<u>Depth</u>	<u>Hole Size</u>	<u>Casing</u>	<u>Mud Wt.</u>	<u>Viscosity</u>	<u>Fluid Loss</u>	<u>pH</u>
0' – 400'	12-1/4"	8-5/8"	8.6-8.8	32-34	N/C	N/C
400' – 2,500'	7-7/8"	-	9.0-9.5	28-29	N/C	9-10
2,500' – 3,700'	7-7/8"	5-1/2"	9.4-9.5	30-38	8-10	9-10

Potential Problems

Surface Interval 0 – 400'

- Severe seepage.
- Poorly consolidated formations, may require higher than normal viscosity.

Intermediate Interval 400' – 2,500'

- Moderate seepage.

Production Interval 2,500' – 3,700'

- Moderate seepage.