

District I
1625 N. French Dr., Hobbs, NM 88240
District II
1301 W. Grand Avenue, Artesia, NM 88210
District III
1000 Rio Brazos Road, Aztec, NM 87410
District IV
1220 S. St. Francis Dr., Santa Fe, NM 87505

State of New Mexico
Energy Minerals and Natural Resources

Form C-101
May 27, 2004

Oil Conservation Division
1220 South St. Francis Dr.
Santa Fe, NM 87505

Submit to appropriate District Office

☐ AMENDED REPORT

APPLICATION FOR PERMIT TO DRILL, RE-ENTER, DEEPEN, PLUGBACK, OR ADD A ZONE

¹ Operator Name and Address POGO PRODUCING COMPANY P.O. BOX 10340 MIDLAND, TEXAS 79702-7340		² OGRID Number 17891
³ Property Code		⁴ API Number 30-015-33706
⁵ Property Name OSAGE COM.		⁶ Well No. 2
⁷ Proposed Pool 1 CEMETARY-MORROW (GAS) (74640)		⁸ Proposed Pool 2

Surface Location

UL or lot no. M	Section 18	Township 20S	Range 25E	Lot Idn	Feet from the 1140'	North/South line SOUTH	Feet from the 1310'	East/West line WEST	County EDDY
--------------------	---------------	-----------------	--------------	---------	------------------------	---------------------------	------------------------	------------------------	----------------

Proposed Bottom Hole Location If Different From Surface

UL or lot no.	Section	Township	Range	Lot Idn	Feet from the	North/South line	Feet from the	East/West line	County
---------------	---------	----------	-------	---------	---------------	------------------	---------------	----------------	--------

Additional Well Information

¹¹ Work Type Code N	¹² Well Type Code G	¹³ Cable/Rotary ROTARY	¹⁴ Lease Type Code	¹⁵ Ground Level Elevation 3574'
¹⁶ Multiple NO	¹⁷ Proposed Depth 990'	¹⁸ Formation MORROW	¹⁹ Contractor UNKNOWN	²⁰ Spud Date WHEN APPROVED
Depth to Groundwater 170'		Distance from nearest fresh water well 1.5 Mi.		Distance from nearest surface water Unknown
Pit: Liner: Synthetic <input checked="" type="checkbox"/> 12_mils thick Clay <input type="checkbox"/> Pit Volume: 2M_bbls Drilling Method: Closed-Loop System <input type="checkbox"/> Fresh Water <input checked="" type="checkbox"/> Brine <input checked="" type="checkbox"/> Diesel/Oil-based <input type="checkbox"/> Gas/Air <input type="checkbox"/>				

Proposed Casing and Cement Program

Hole Size	Casing Size	Casing weight/foot	Setting Depth	Sacks of Cement	Estimated TOC
25"	20"	NA Conductor	40'	Redi-mix	Surface
17 1/2"	13 3/8"	48	500'	550 Sx.	Surface
11"	8 5/8"	32	2200'	600 Sx.	Surface
7 7/8"	5 1/2"	17	9900'	1000 Sx.	2000'±

²² Describe the proposed program. If this application is to DEEPEN or PLUG BACK, give the data on the present productive zone and proposed new productive zone. Describe the blowout prevention program, if any. Use additional sheets if necessary.

SEE ATTACHED SHEET

RECEIVED
OCT 29 2004
OCD-ARTESIA

²³ I hereby certify that the information given above is true and complete to the best of my knowledge and belief. I further certify that the drilling pit will be constructed according to NMOCD guidelines <input checked="" type="checkbox"/> a general permit <input type="checkbox"/> or an (attached) alternative OCD-approved plan <input type="checkbox"/>		OIL CONSERVATION DIVISION	
Printed name: Joe T. Janica		Approved by: TIM W. GUM	
Title: Agent		Title: DISTRICT II SUPERVISOR	
E-mail Address:		Approval Date: NOV 08 2004 Expiration Date: NOV 08 2005	
Date: 10/28/04	Phone: 505-391-8503	Conditions of Approval Attached <input type="checkbox"/>	

NOTIFY OCD OF SPUD & TIME TO
WITNESS CEMENTING OF
SURFACE & INTERMEDIATE
CASING

POGO PRODUCING COMPANY
OSAGE COM. # 2
UNIT "M" SECTION 18
T20S-R25E EDDY CO. NM

1. Drill 25" hole to 40'. Set 40' of 20" conductor pipe and cement to surface with Redi-mix.
2. Drill 17½" hole to 500'. Run and set 500' of 13 3/8" 48# H-40 ST&C casing. Cement with 550 Sx. of Class "C" cement + 2% CaCl, + ¼# Flocele/Sx. circulate cement to surface.
3. Drill 11" hole to 2200'. Run and set 2200' of 8 5/8" 32# J-55 ST&C casing. Cement with 600 Sx. of Class "C" cement ¼# Flocele/Sx. + other additives, circulate cement to surface.
4. Drill 7 7/8" hole to 9900'. Run and set 9900' of 5½" 17# L-80 LT&C casing. Cement in twl stages with DV Tool at 4500'±. Cement 1st stage with 650 Sx. of Class "H" Premium Plus cement + additives, cement 2nd stage with 350 Sx. of Class "C" cement + additives, estimate top of cement 2000' from surface.

District I
1625 N. French Dr., Hobbs, NM 88240
District II
1301 W. Grand Avenue, Artesia, NM 88210
District III
1000 Rio Brazos Road, Aztec, NM 87410
District IV
1220 S. St. Francis Dr., Santa Fe, NM 87505

State of New Mexico
Energy Minerals and Natural Resources

Oil Conservation Division
1220 South St. Francis Dr.
Santa Fe, NM 87505

Form C
March 12.

For drilling and production facilities, submit appropriate NMOCD District Office.
For downstream facilities, submit to Santa Fe office

Pit or Below-Grade Tank Registration or Closure

Is pit or below-grade tank covered by a "general plan"? Yes ☐ No ☒

Type of action: Registration of a pit or below-grade tank ☒ Closure of a pit or below-grade tank ☐

Operator: Pogo Producing Company Telephone: 432-685-8100 e-mail address: wrightc@pogoproducing.com
Address: P. O. Box 10340, Midland, TX 79702-7340

Facility or well name: Osage 18 Fed #2 API #: _____ U/L or Qtr/Qtr M Sec 18 T 20S R 25E

County: Eddy Latitude 32:34:09.68N Longitude 104:31:41.33W NAD: 1927 ☒ 1983 ☐ Surface Owner Federal ☒ State ☐ Private ☐ Indian

Pit	Below-grade tank
Type: Drilling <input checked="" type="checkbox"/> Production <input type="checkbox"/> Disposal <input type="checkbox"/> Workover <input type="checkbox"/> Emergency <input type="checkbox"/> Lined <input checked="" type="checkbox"/> Unlined <input type="checkbox"/> Liner type: Synthetic <input checked="" type="checkbox"/> Thickness <u>12</u> mil Clay <input type="checkbox"/> Volume <u>16000</u> bbl	Volume: _____ bbl Type of fluid: _____ Construction material: _____ Double-walled, with leak detection? Yes <input type="checkbox"/> If not, explain why not. _____
Depth to ground water (vertical distance from bottom of pit to seasonal high water elevation of ground water.)	Less than 50 feet (20 points) 50 feet or more, but less than 100 feet (10 points) 100 feet or more X (0 points) 0
Wellhead protection area: (Less than 200 feet from a private domestic water source, or less than 1000 feet from all other water sources.)	Yes (20 points) No X (0 points) 0
Distance to surface water: (horizontal distance to all wetlands, playas, irrigation canals, ditches, and perennial and ephemeral watercourses.)	Less than 200 feet (20 points) 200 feet or more, but less than 1000 feet (10 points) 1000 feet or more X (0 points) 0
Ranking Score (Total Points) 0	

If this is a pit closure: (1) attach a diagram of the facility showing the pit's relationship to other equipment and tanks. (2) Indicate disposal location:

onsite ☐ offsite ☐ If offsite, name of facility: _____ (3) Attach a general description of remedial action taken including remediation start date and end date. (4) Groundwater encountered: No ☐ Yes ☐ If yes, show depth below ground surface _____ ft. and attach sample results. (5) Attach soil sample results and a diagram of sample locations and excavations.

I hereby certify that the information above is true and complete to the best of my knowledge and belief. I further certify that the above-described pit or below-grade tank been/will be constructed or closed according to NMOCD guidelines ☒, a general permit ☐, or an (attached) alternative OCD-approved plan ☐.

Date: 10/08/04

Printed Name/Title: Cathy Wright, Sr Eng Tech

Signature: Cathy Wright

Your certification and NMOCD approval of this application/closure does not relieve the operator of liability should the contents of the pit or tank contaminate ground water or otherwise endanger public health or the environment. Nor does it relieve the operator of its responsibility for compliance with any other federal, state, or local laws and/or regulations.

Approved: OCT 13 2004

Date: _____

Printed Name/Title: _____

Signature: [Signature]



Water Resources

Data Category:

Site Information

Geographic Area:

New Mexico

GO

Site Map for New Mexico

USGS 323328104301201 20S.25E.20.41114

Available data for this site

Station site map

GO

Eddy County, New Mexico

Hydrologic Unit Code

Latitude 32°33'28", Longitude 104°30'12" NAD27

Gage datum 3,504.00 feet above sea level NGVD29

Location of the site in New Mexico.

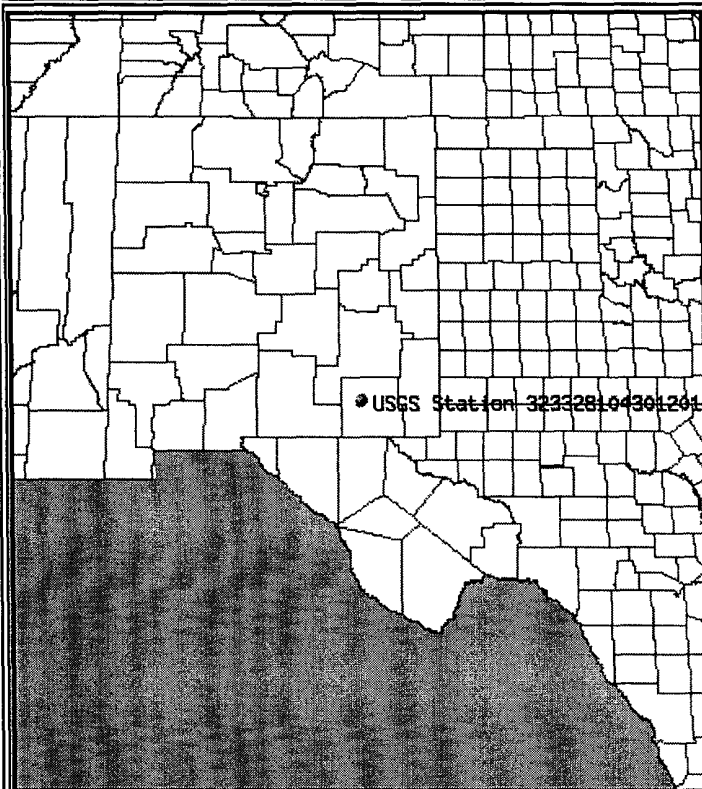

Site map.

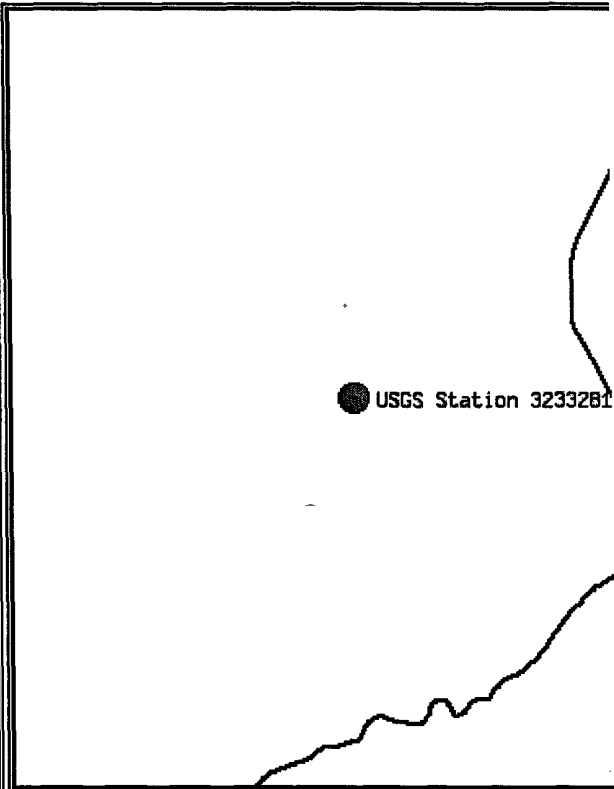

ZOOM IN 2X, 4X, 6X, 8X, or ZOOM OUT 2X, 4X, 6X, 8X.

Maps are generated by US Census Bureau TIGER Mapping Service.

[Questions about data](#) [New Mexico NWISWeb Data Inquiries](#)[Feedback on this website](#) [New Mexico NWISWeb Maintainer](#)[NWIS Site Inventory for New Mexico: Site Map](#)<http://waterdata.usgs.gov/nm/nwis/nwismap?>[Top](#)[Explanation of terms](#)

Water Resources

Data Category:

Ground Water

Geographic Area:

New Mexico

go

Ground-water levels for New Mexico

Search Results -- 1 sites found

Search Criteria

site_no list = • 323328104301201

[Save file of selected sites to local disk for future upload](#)
USGS 323328104301201 20S.25E.20.41114

Available data for this site

Ground-water: Levels

GO

Eddy County, New Mexico

Hydrologic Unit Code

Latitude 32°33'28", Longitude 104°30'12" NAD27

Gage datum 3,504.00 feet above sea level NGVD29

The depth of the well is 314.0 feet below land surface.

This well is completed in ARTESIA GROUP (313ARTS)

Output formats

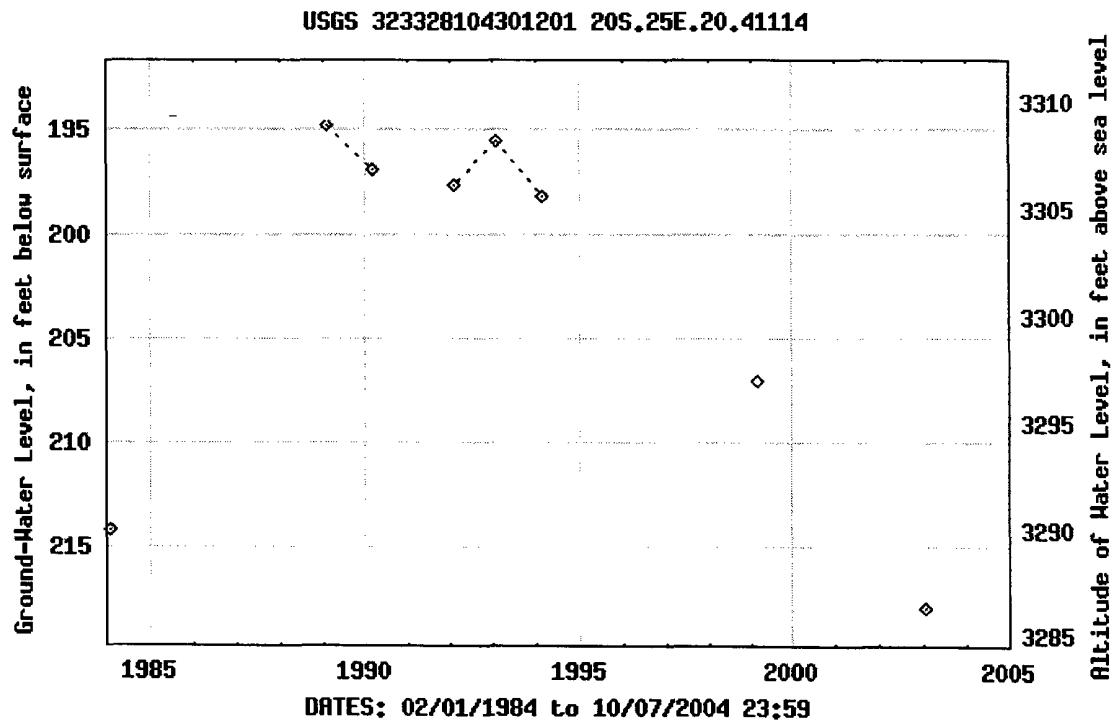
[Table of data](#)[Tab-separated data](#)[Graph of data](#)[Reselect period](#)

Breaks in the plot represent a gap of at least one calendar year between two consecutive points.

Great Circle Calculator.

By Ed Williams

You need Javascript enabled if you want this page to do anything useful! For Netscape, it's under Options/Network Preferences/Languages.

Compute true course and distance between points.

Enter lat/lon of points, select distance units and earth model and click "compute". Lat/lons may be entered in DD.DD, DD:MM.MM or DD:MM:SS.SS formats.

Note that if either point is very close to a pole, the course may be inaccurate, because of its extreme sensitivity to position and inevitable rounding error.

Input Data

Lat1		Lon1	
32:34:09.68	N	104:31:41.33	W
Lat2		Lon2	
32:33:28	N	104:30:12	W

Output

Course 1-2	Course 2-1	Distance
118.962936	298.976286	1.43423748

Distance Units: Earth model:

Compute lat/lon given radial and distance from a known point

Enter lat/lon of initial point, true course and distance. Select distance units and earth model and click "compute". Lat/lons may be entered in DD.DD, DD:MM.MM or DD:MM:SS.SS formats.

Note that the starting point cannot be a pole.

Input data

Lat1		Lon1	
0:00.00	N	0:00.00	W
Course 1-2		Distance 1-2	

State of New Mexico

DISTRICT I

1625 N. FRENCH DR., HOBBS, NM 88240

Energy, Minerals and Natural Resources Department

Form C-102

DISTRICT II

1501 W. GRAND AVENUE, ARTESIA, NM 88210

OIL CONSERVATION DIVISION

1220 SOUTH ST. FRANCIS DR.
Santa Fe, New Mexico 87505

Revised JUNE 10, 2003
Submit to Appropriate District Office
State Lease - 4 Copies
Fee Lease - 3 Copies

DISTRICT III

1000 Rio Brazos Rd., Aztec, NM 87410

DISTRICT IV

1220 S. ST. FRANCIS DR., SANTA FE, NM 87505

WELL LOCATION AND ACREAGE DEDICATION PLAT

☐ AMENDED REPORT

API Number	Pool Code 74640	Pool Name CEMETARY-MORROW GAS
Property Code	Property Name OSAGE 18 FEDERAL	Well Number 2
OGRD No. 17891	Operator Name POGO PRODUCING COMPANY	Elevation 3574'

Surface Location

UL or lot No.	Section	Township	Range	Lot Idn	Feet from the	North/South line	Feet from the	East/West line	County
M	18	20-S	25-E		1140	SOUTH	1310	WEST	EDDY

Bottom Hole Location If Different From Surface

UL or lot No.	Section	Township	Range	Lot Idn	Feet from the	North/South line	Feet from the	East/West line	County
Dedicated Acres 320	Joint or Infill	Consolidation Code	Order No.						

NO ALLOWABLE WILL BE ASSIGNED TO THIS COMPLETION UNTIL ALL INTERESTS HAVE BEEN CONSOLIDATED
OR A NON-STANDARD UNIT HAS BEEN APPROVED BY THE DIVISION

	OPERATOR CERTIFICATION I hereby certify the the information contained herein is true and complete to the best of my knowledge and belief. Signature Joe T. Janica Printed Name Agent Title 10/28/04 Date
	SURVEYOR CERTIFICATION I hereby certify that the well location shown on this plat was plotted from field notes of actual surveys made by me or under my supervision, and that the same is true and correct to the best of my belief. SEPTEMBER 9, 2004 Date Surveyed Signature & Seal of Professional Surveyor Gary E. Eason 9/11/04 Certificate No. GARY EASON 12041

SECTION 18, TOWNSHIP 20 SOUTH, RANGE 25 EAST, N.M.P.M.,
EDDY COUNTY, NEW MEXICO

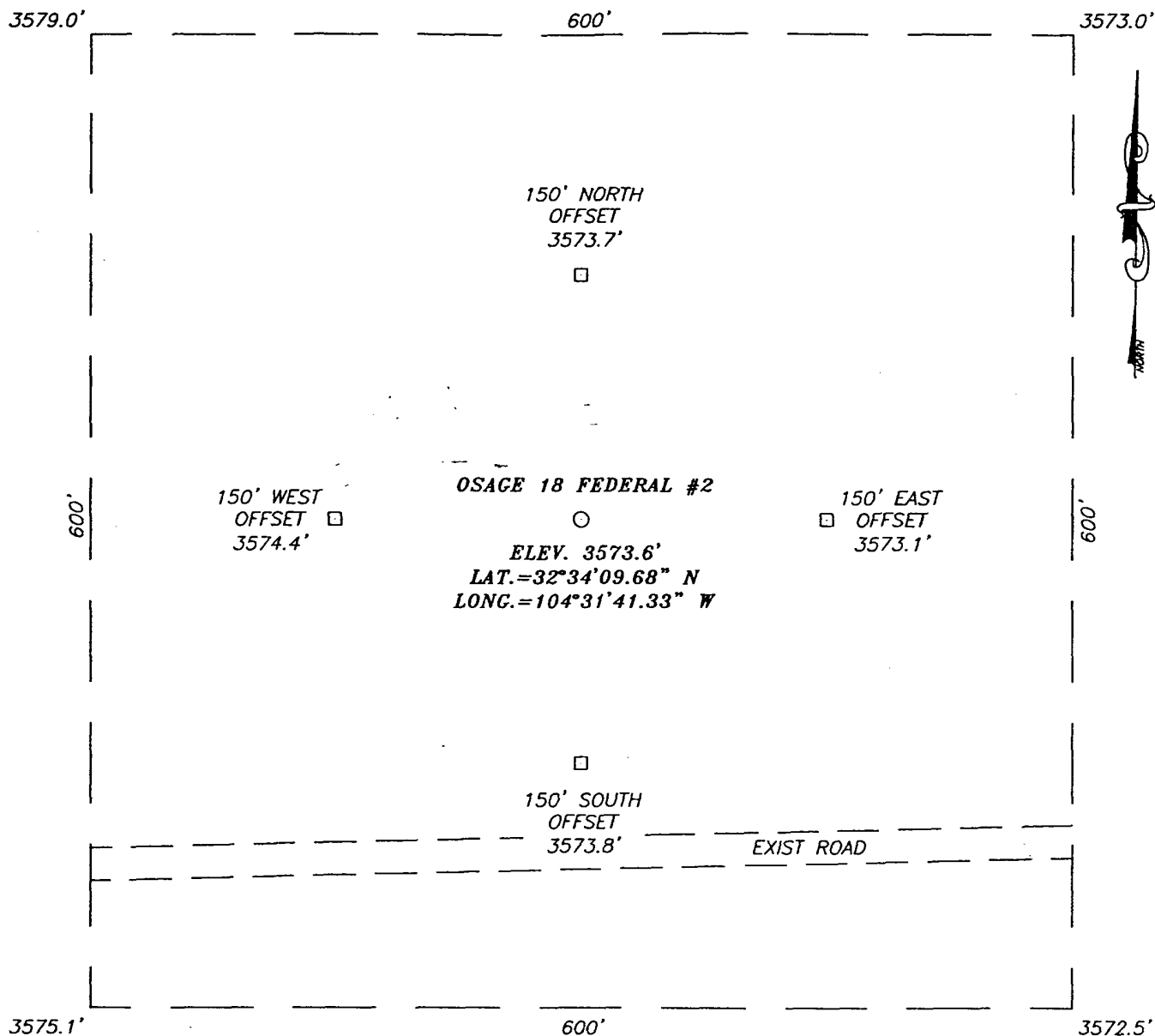

DIRECTIONS TO LOCATION

FROM THE INTERSECTION OF U.S. HWY #285 AND
 CO. RD. #28 (WHITE PINE RD.) GO WEST ON CO.
 RD. #28 FOR APPROX. 4.0 MILES TO CO. RD.
 #27 (PICKETT RD.) TURN RIGHT (NORTH) ON CO.
 RD. #27 AND FOLLOW ROAD NORTH TO WEST. GO
 WEST APPROX. 2.8 MILES TO PROPOSED LOCATION

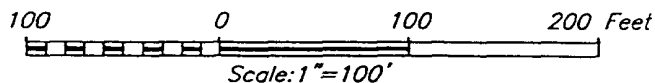

POGO PRODUCING COMPANY

OSAGE 18 FEDERAL #2 WELL
 LOCATED 1140 FEET FROM THE SOUTH LINE
 AND 1310 FEET FROM THE WEST LINE OF SECTION 18,
 TOWNSHIP 20 SOUTH, RANGE 25 EAST, N.M.P.M.,
 EDDY COUNTY, NEW MEXICO.

Survey Date: 09/9/04	Sheet 1 of 1 Sheets
W.O. Number: 04.11.1166	Dr By: J.R.
Date: 09/10/04	Disk: CD#10
04111166	Scale: 1"=100'

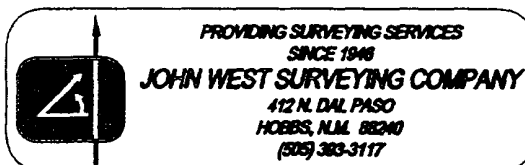

VICINITY MAP

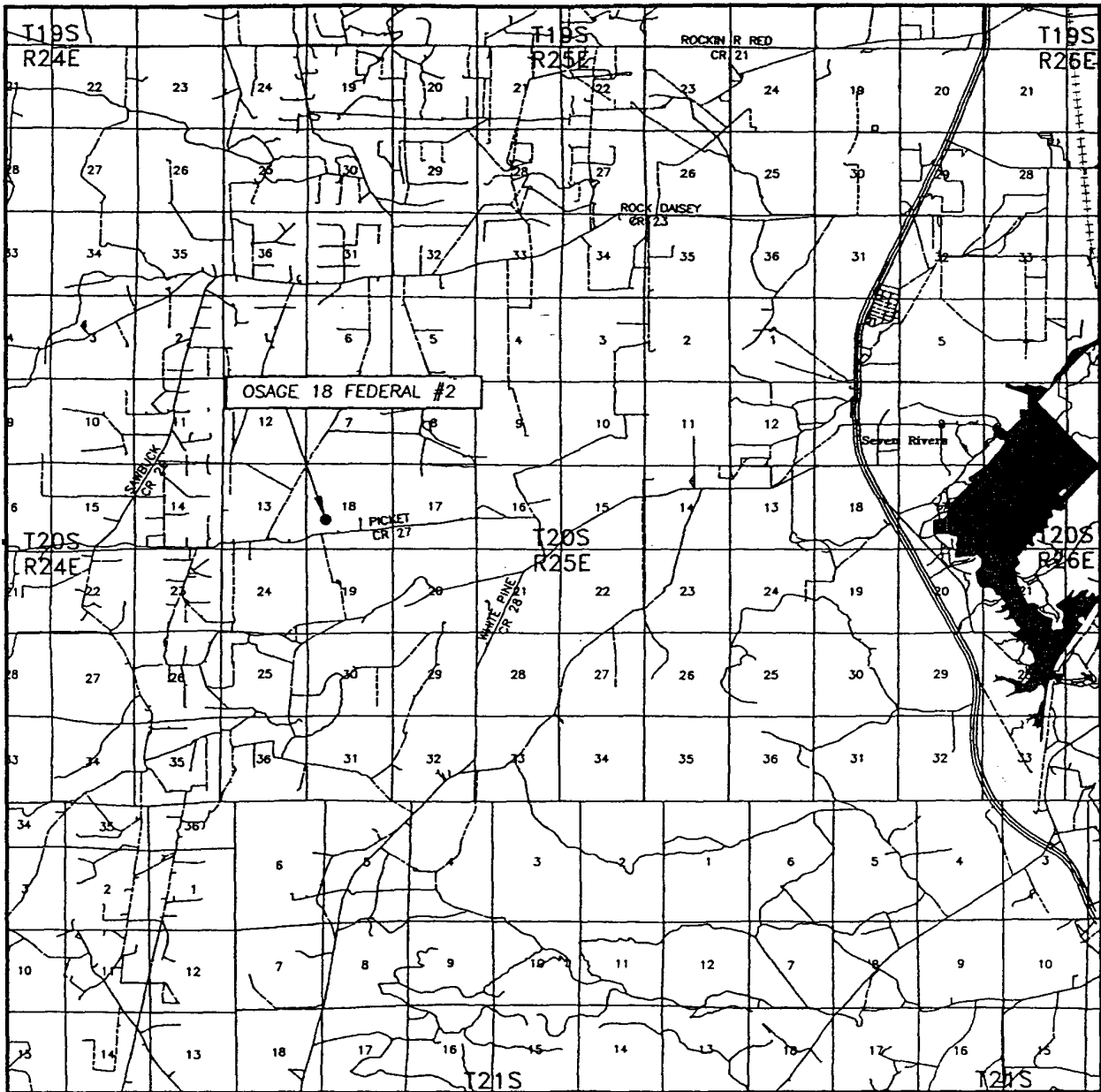

SCALE: 1" = 2 MILES

SEC. 18 TWP. 20-S RGE. 25-E
 SURVEY N.M.P.M.
 COUNTY EDDY
 DESCRIPTION 1140' FSL & 1310' FWL
 ELEVATION 3574'
 OPERATOR POGO PRODUCING COMPANY
 LEASE OSAGE 18 FEDERAL



PROVIDING SURVEYING SERVICES
 SINCE 1946
JOHN WEST SURVEYING COMPANY
 412 N. DAL PASO
 HOBBS, N.M. 88240
 (505) 393-3117

LOCATION VERIFICATION MAP

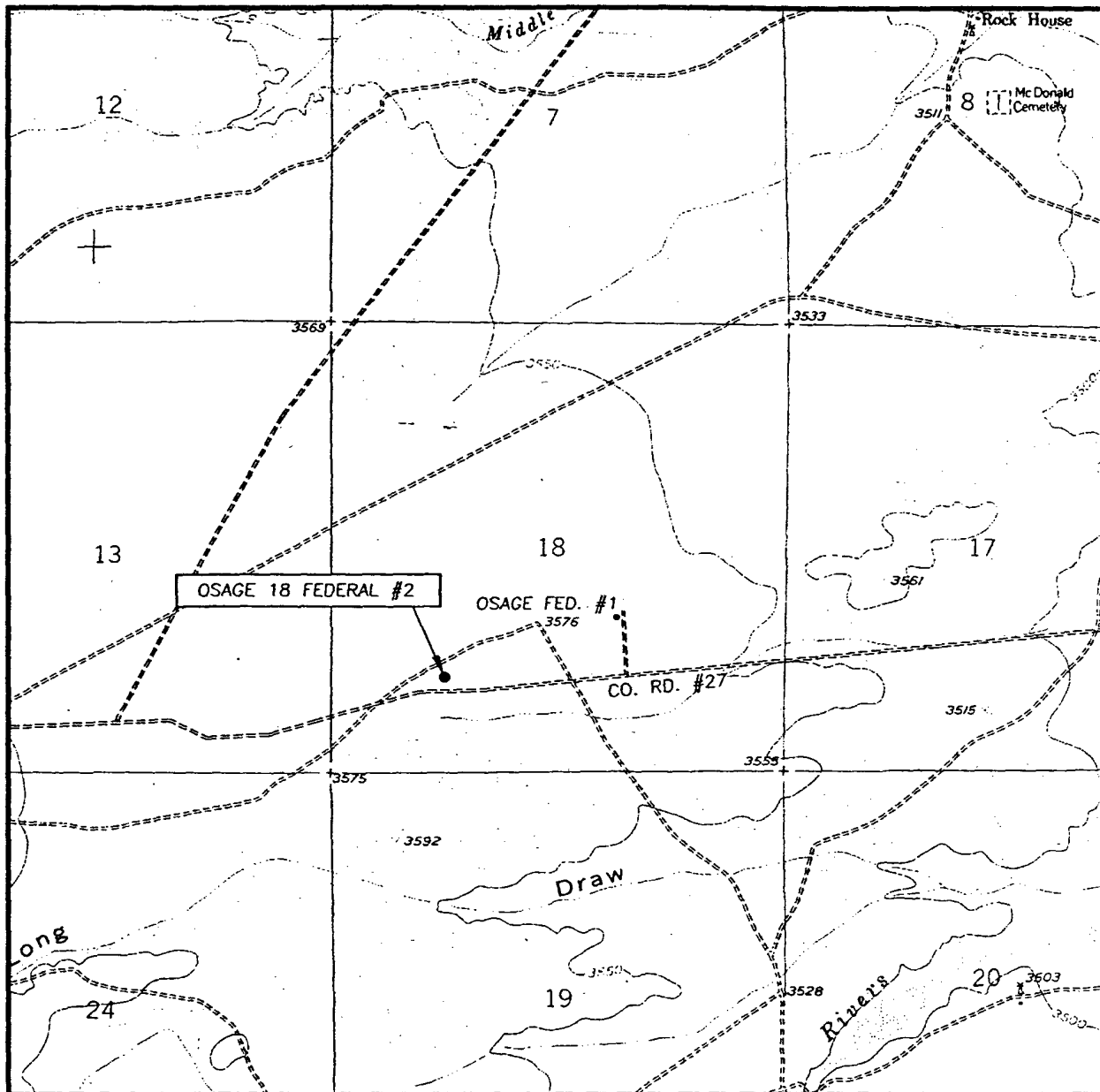

SCALE: 1" = 2000'

CONTOUR INTERVAL:
FOSTER RANCH, N.M. - 10'

SEC. 18 TWP. 20-S RGE. 25-E

SURVEY N.M.P.M.

COUNTY EDDY

DESCRIPTION 1140' FSL & 1310' FWL

ELEVATION 3574'

OPERATOR POGO PRODUCING COMPANY

LEASE OSAGE 18 FEDERAL

U.S.G.S. TOPOGRAPHIC MAP
FOSTER RANCH, N.M.

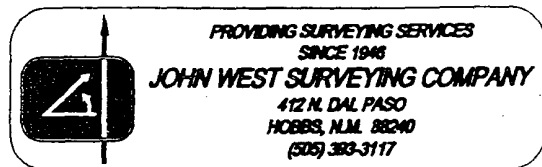

H₂S CONTINGEMCY PLAN FOR

POGO PRODUCING COMPANY
OSAGE COM. # 2
UNIT "M" SECTION 18
T20S-R25E EDDY CO. NM

There is no known presence of and H₂S in the area near or around this proposed well. Other wells drilled in T20S-R25E have not encountered any H₂S while drilling.

There are no dwellings located within 2 miles of this well location, Co Road 27 (Picket Road) is South of location approximately 180'. Warning signs will be placed at the access road leading to the location.

Should there be any indication of the presence of H₂S detection and safety equipment will be immediately installed and proper authorities will be notified. Admittance to the location will be restricted to only the necessary personnel.

Attached is a list of telephone numbers of all personnel that should be contacted.

If at this time the supervising person determines the release of H2S cannot be contained to the site location and the general public is in harms way he will take the necessary steps to protect the workers and the public.

EMERGENCY CALL LIST: (Start and continue until ONE of these people have been contacted)

	<u>OFFICE</u>	<u>MOBILE</u>	<u>HOME</u>
POGO Producing Co.	432 685 8100		
Richard Wright	432 685 8140	432 556 7595	432 699 7108
Barrett Smith	432 685 8141	432 425 0149	432 520 7337
Rex Jasper	432 685 8143	432 631 0127	432 694 1839
Donny Davis	pgr 432 563 6944	432 556 5927	432 570 9555
Jerry Cooper	432 685 8101		432 697 4629

EMERGENCY RESPONSE NUMBERS:

State Police:	Eddy County		505 748 9718
State Police:	Lea County		505 392 5588
Sheriff	Eddy County		505 746 2701
Sheriff	Lea County		
Emergency Medical Ser (Ambulance)	Eddy County		911 or 505 746 2701
	Lea County	Eunice	911 or 505 394 3258
Emergency Response	Eddy County SERC		505 476 9620
	Lea County		
Artesia Police Dept			505 746 5001

Artesia Fire Dept		505 746 5001
Carlsbad Police Dept		505 885 2111
Carlsbad Fire Dept		505 885 3125
Loco Hills Police Dept		505 677 2349
Jal Police Dept		505 395 2501
Jal Fire Dept		505 395 2221
Jal ambulance		505 395 2221
Eunice Police Dept		505 394 0112
Eunice Fire Dept		505 394 3258
Eunice Ambulance		505 394 3258
Hobbs Police Dept		
NMOCD	District 1 (Lea, Roosevelt, Curry)	505 393 6161
	District 2 (Eddy Chavez)	505 748 1283
Lea County Information		505 393 8203
Callaway Safety	Lea/Eddy County	505 392 2973
BJ Services	Artesia	505 746 3140
	Hobbs	505 392 5556
Halliburton	Artesia	1 800 523 2482
	Hobbs	1 800 523 2482
Wild Well Control	Midland	432 550 6202
	Mobile	432 553 1166

BLOWOUT PREVENTER SYSTEM

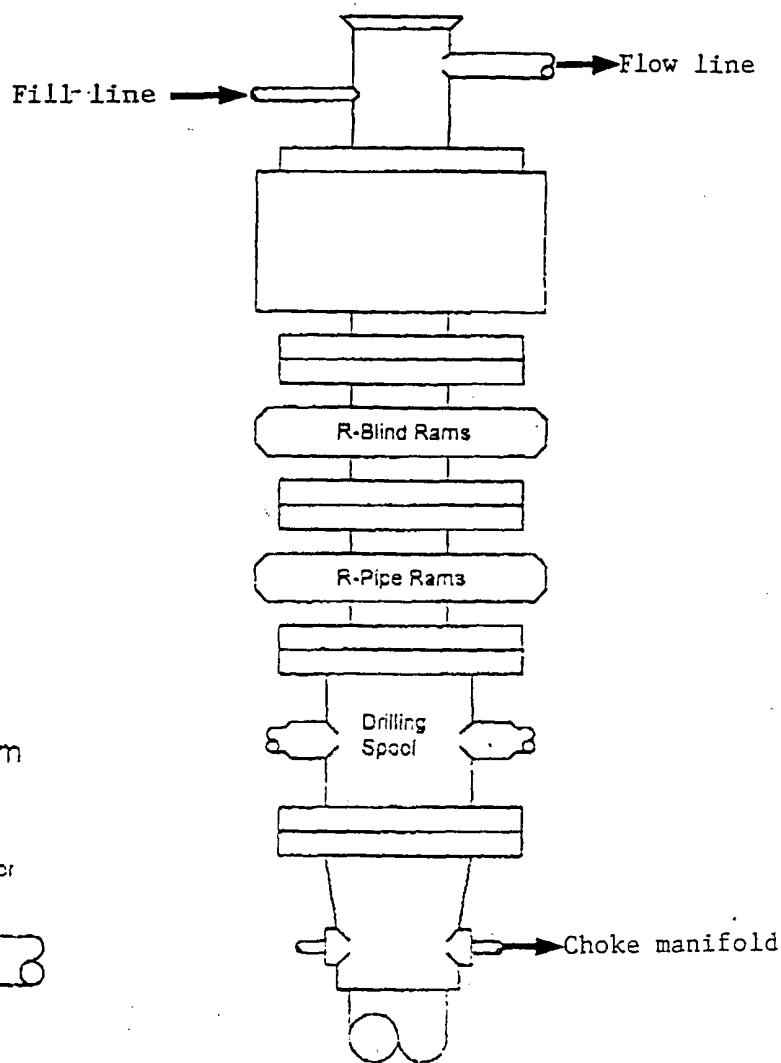

Type 900 Series
3000 psi WP

Choke Manifold Assembly for 3M WP System

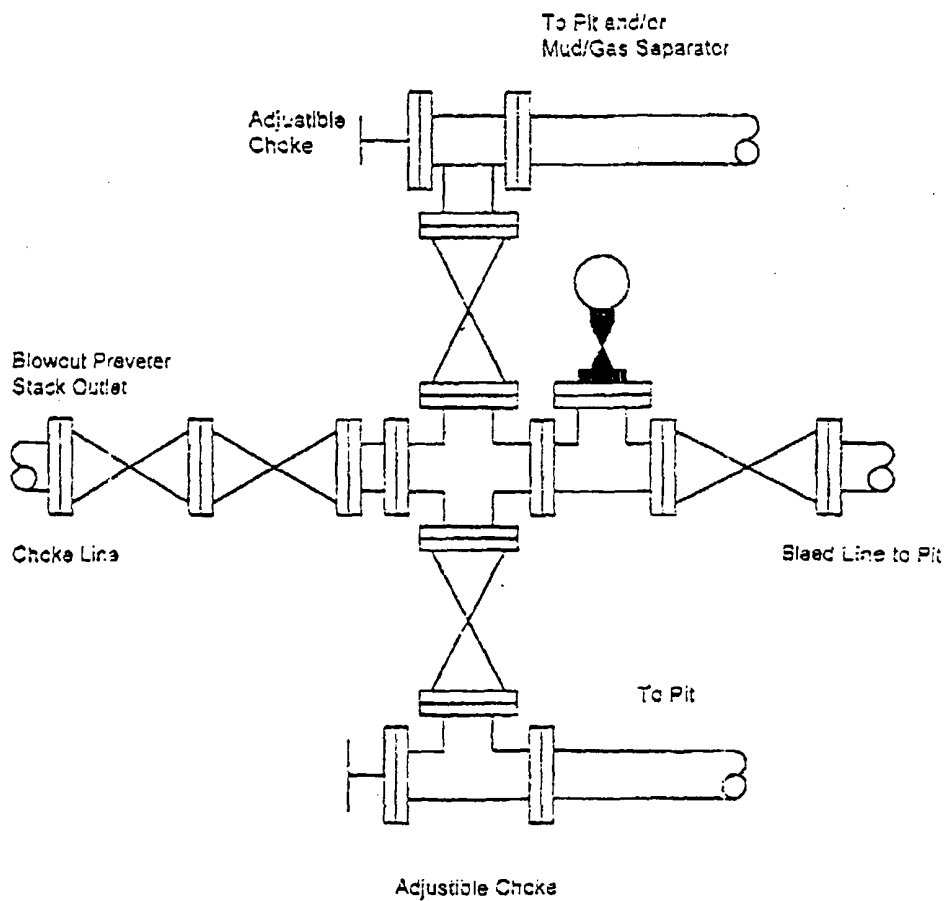

There is no known presence of H_2S in the area near or around this proposed well. Other wells in the area have not encountered any H_2S while drilling to TD.

There are no dwellings within 2 miles of the proposed location.

Should there be any indication of the presence of H_2S while drilling this well

H_2S test