

District I
1625 N. French Dr., Hobbs, NM 88240
District II
1301 W. Grand Avenue, Artesia, NM 88210
District III
1000 Rio Brazos Road, Aztec, NM 87410
District IV
1220 S. St. Francis Dr., Santa Fe, NM 87505

State of New Mexico
Energy Minerals and Natural Resources

Form C-101
May 27, 2004

Oil Conservation Division
1220 South St. Francis Dr.
Santa Fe, NM 87505

Submit to appropriate District Office

☐ AMENDED REPORT

APPLICATION FOR PERMIT TO DRILL, RE-ENTER, DEEPEN, PLUGBACK, OR ADD A ZONE

| | | |
|---|--|---|
| ¹ Operator Name and Address DEVON LOUISIANA CORPORATION 20 North Broadway, Suite 1500 OKC, OK 73102-8260 | | ² OGRID Number 169355 |
| ³ Property Code 23438 | | ⁴ Property Name Parkway West Unit |
| ⁵ Proposed Pool 1 Parkway, Atoka, West Pro Gas 82600 | | ⁶ Well No. 2 |
| ⁷ Surface Location | | ⁸ Proposed Pool 2 |

| UL or lot no. | Section | Township | Range | Lot Idn | Feet from the | North/South line | Feet from the | East/West line | County |
|---------------|---------|----------|-------|---------|---------------|------------------|---------------|----------------|--------|
| G | 29 | 19S | 29E | | 1980 | North | 1980 | East | Eddy |

⁸ Proposed Bottom Hole Location If Different From Surface

| UL or lot no. | Section | Township | Range | Lot Idn | Feet from the | North/South line | Feet from the | East/West line | County |
|---------------|---------|----------|-------|---------|---------------|------------------|---------------|----------------|--------|
| | | | | | | | | | |

Additional Well Information

| | | | | |
|---|---|--|------------------------------------|--|
| ¹¹ Work Type Code P | ¹² Well Type Code G | ¹³ Cable/Rotary Rotary | ¹⁴ Lease Type Code S | ¹⁵ Ground Level Elevation 3287 |
| ¹⁶ Multiple | ¹⁷ Proposed Depth 11,000' | ¹⁸ Formation Atoka | ¹⁹ Contractor | ²⁰ Spud Date |
| Depth to Groundwater NO PIT | | Distance from nearest fresh water well | | Distance from nearest surface water |
| Pit: Liner: Synthetic <input type="checkbox"/> _____ mils thick Clay <input type="checkbox"/> Pit Volume: _____ bbls Drilling Method: _____ Closed-Loop System <input type="checkbox"/> Fresh Water <input type="checkbox"/> Brine <input type="checkbox"/> Diesel/Oil-based <input type="checkbox"/> Gas/Air <input type="checkbox"/> | | | | |

²¹ Proposed Casing and Cement Program

| Hole Size | Casing Size | Casing weight/foot | Setting Depth | Sacks of Cement | Estimated TOC |
|-----------|-------------|--------------------|---------------|-----------------|---------------|
| | | | | | |
| | | | | | |
| | | | | | |
| | | | | | |
| | | | | | |

²² Describe the proposed program. If this application is to DEEPEN or PLUG BACK, give the data on the present productive zone and proposed new productive zone. Describe the blowout prevention program, if any. Use additional sheets if necessary.

1. MIRUPU. POOH w/ existing packer & tubing.
2. RIH setting Composite Bridge plug at approx 11,000', isolating Morrow perms @ 11,110-14 and 11,142-49.
3. MIRUWL and perf Atoka from 10,642-10648 at 6 spf.
4. POOH RD WL. RIH w/ 2 3/8" tbg and packer, setting pkr @ approx 10,620'.
5. Swab well in and acidize Atoka perms if necessary.
6. Return well to production, producing Atoka formation up 2 3/8" tbg.

RECEIVED

DEC - 8 2004

OOD-ARTESIA

Oper to use pressure control device

²³ I hereby certify that the information given above is true and complete to the best of my knowledge and belief. I further certify that the drilling pit will be constructed according to NMOCD guidelines ☐ a general permit ☐ or an (attached) alternative OCD-approved plan ☐ NO PIT

OIL CONSERVATION DIVISION

Approved by:

Printed name: Linda Guthrie
Title: Regulatory Specialist

Title:

TIM W. GUM
DISTRICT II SUPERVISOR

Approval Date:

DEC 16 2004

Expiration Date:

DEC 16 2005

E-mail Address: linda.guthrie@dv.com

Date:

Phone: 405-228-8209

Conditions of Approval Attached ☐



Duke Energy Field Services, LP.

370 17th Street, #2500 Denver CO 80202

Gas Analysis Certificate Report

10/19/2004
13:51:03
belanda

Analysis ID: 13135172

Alternate ID: Parkwy W13 Ato
Company Name: OCEAN ENERGY INC

| | | |
|-----------------------------------|----------------------|------------------------------|
| Effective Date: 11/01/2003 07:00 | Saturated HV: 1148.0 | Sample Date: 11/01/2003 |
| Valid Thru Date: 01/18/2038 00:00 | | Sample ID: 0 |
| Last Update: 01/01/1970 00:00 | Dry HV: 1168.0 | Sample Type: Spot |
| Analysis Origin: Gas Analysis Lab | Gravity: 0.6756 | Sample Pressure Base: 14.650 |
| Analysis Type: Lab analysis | Source: Import | Sample Temperature: 90.0 |
| | | Sample Pressure: 227.5 |

| Component | % Mol | GPM | | |
|-----------|----------|--------|------------------------|--------|
| Methane | 85.9480 | | C4 lighter STCond | 0.0000 |
| Ethane | 6.9780 | 1.8548 | C5 heavier STCond | 0.0000 |
| Propane | 2.9500 | 0.8078 | 26 # Gasoline @14.65 | 0.0000 |
| I Butane | 0.5220 | 0.1698 | 26 Lbs. excess | 0.0000 |
| N Butane | 0.7690 | 0.2411 | Stock Tank Bbl/mm | 0.0000 |
| I Pentane | 0.2800 | 0.1019 | H2O GPMs | 0.0000 |
| Pentane | 0.1870 | 0.0674 | FWS Factor | 0.0000 |
| Hexanes+ | 0.8200 | 0.3558 | FWS C6+or C7+ GPM | 0.000 |
| | | | Reject Override Code | 0 |
| | | | GC Unnormalized Mol% | 0 |
| | | | TestCar GPM Permian | 0.000 |
| | | | TestCar GPM Permhandle | 0.000 |
| Nitrogen | 1.2630 | | Run Number | 0 |
| CO2 | 0.2630 | | H2S Test Type | 0 |
| Oxygen | 0.0000 | | H2S Units | 0 |
| H2O | 0.0000 | | H2S PPM | 0 |
| CO | 0.0000 | | TestCar GPM MidCon | 0.000 |
| H2S | 0.0000 | | | |
| Hydrogen | 0.0000 | | | |
| Helium | 0.0000 | | | |
| Argon | 0.0000 | | | |
| Total | 100.0000 | 3.5986 | | |

Comments:

COP Acquisition
COP Upload

NEW MEXICO OIL CONSERVATION COMMISSION
WELL LOCATION AND ACREAGE DEDICATION PLAT

Form O-1-1
Supervised Copy
Effective 1-1-73

All distances must be from the outer boundaries of the Section

| | | | | |
|--|-------------------------------------|-------------------------------------|---------------------------------|-----------------------|
| Operator Devon Louisiana Corporation | | Lease PARKWAY WEST UNIT | | Well No. 2 |
| Unit Letter G | Section 29 | Township 19 SOUTH | Range 29 EAST | County EDDY |
| Actual Footage Location of Well: | | | | |
| 1980 feet from the NORTH line and | | 1980 feet from the EAST line | | |
| Ground Level Elev. 3287.35 | Producing Formation Atoka | Pool: | Leasehold Acreage 320 | |

1. Outline the acreage dedicated to the subject well by colored pencil or hachure marks on the plat below.
2. If more than one lease is dedicated to the well, outline each and identify the ownership thereof (both as to working interest and royalty).
3. If more than one lease of different ownership is dedicated to the well, have the interests of all owners been consolidated by communitization, unitization, force-pooling, etc?

☒ Yes ☐ No If answer is "yes," type of consolidation Unitization

If answer is "no," list the owners and tract descriptions which have actually been consolidated. (Use reverse side of this form if necessary.)

No allowable will be assigned to the well until all interests have been consolidated (by communitization, unitization, forced-pooling, or otherwise) or until a non-standard unit, eliminating such interests, has been approved by the Commission.

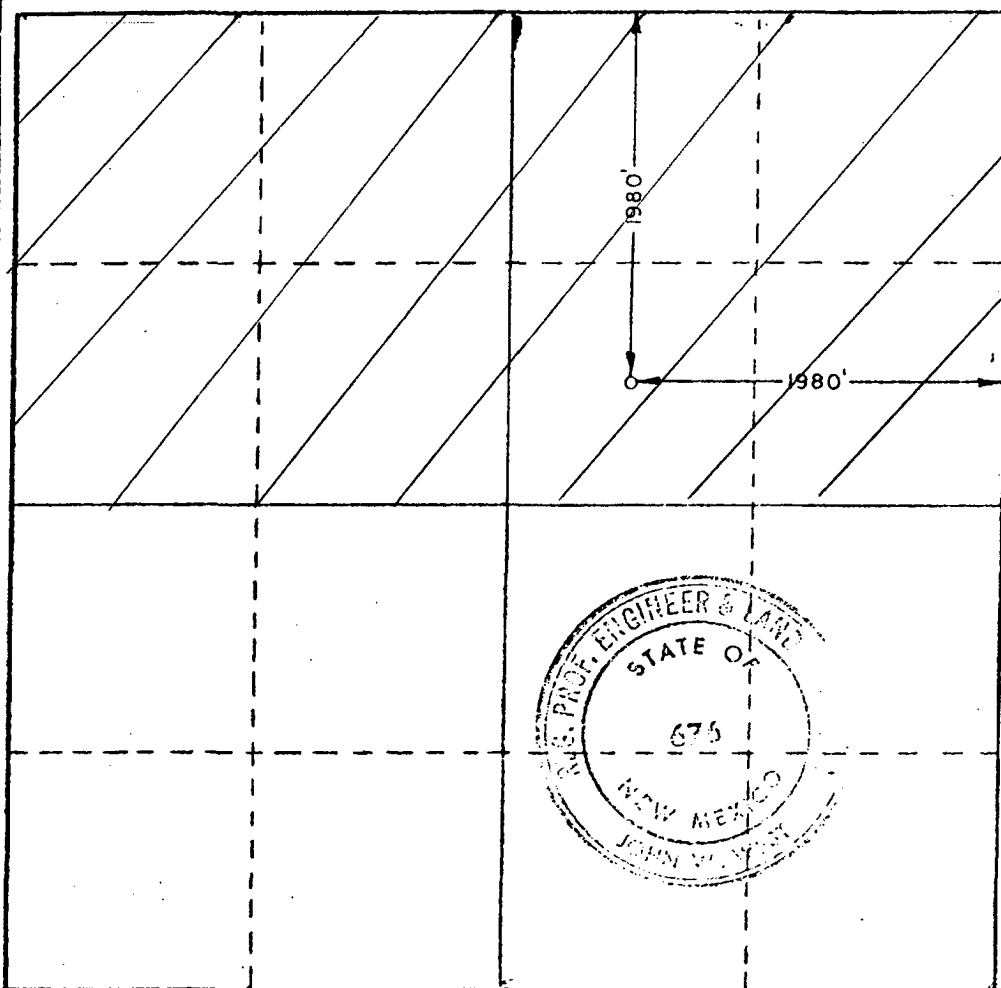

CERTIFICATION

I hereby certify that the information contained herein is true and complete to the best of my knowledge and belief.

Linda B Guthrie

Name
Linda B Guthrie
Position
Regulatory Specialist
Employer
Devon
Date
12/07/04

I hereby certify that the well location shown on this plat was plotted from field notes of actual surveys made by me or under my supervision, and that the same is true and correct to the best of my knowledge and belief.

Date Surveyed
OCTOBER 24, 1973

Registered Professional Engineer and/or Land Surveyor

John W. Wat

Certificate No. **676**

