

Submit to Appropriate

District Office

State Lease - 6 copies

Fee Lease - 5 copies

DISTRICT I

P.O. Box 1980, Hobbs, NM 88240

DISTRICT II

P.O. Drawer DD, Artesia, NM 88210

DISTRICT III

1000 Rio Brazos Rd., Aztec, NM 87410

State of New Mexico
Energy, Minerals and Natural Resources Department

Form C-105

Revised 1-1-89

OIL CONSERVATION DIVISION

P.O. Box 2088

Santa Fe, New Mexico 87504-2088

WELL API NO.

30-015-32497

5. Indicate Type of Lease

STATE ☒FEE ☐

6. State Oil & Gas Lease No.

K4990

7. Lease Name or Unit Agreement Name

ALLIED

8. Well No.

2

9. Pool name or Wildcat

AVALON MORROW

WELL COMPLETION OR RECOMPLETION REPORT AND LOG

1a. Type of Well: OIL WELL ☐ GAS WELL ☒ DRY ☐ OTHER ☐

b. Type of Completion:

NEW WELL ☒ WORK OVER ☐ DEEPEN ☐ PLUG BACK ☐ DIFFERENTIAL ☐ OTHER ☐

2. Name of Operator

SAGA PETROLEUM LLC

3. Address of Operator

415 W. Wall, Suite 1900, Midland, TX 79701

4. Well Location

Unit Letter M : 660 Feet From The S Line and 660 Feet From The W LineSection 22Township 20SRange 27E

NMPM Eddy

County

10. Date Spudded

01/05/2003

11. Date T.D. Reached

02/16/2003

12. Date Compl. (Ready to Prod.)

04/06/2003

13. Elevations (DF & RKB, RT, GR, etc.)

3261' Gr

14. Elev. Casinghead

15. Total Depth

11,051

16. Plug Back T.D.

10,949

17. If Multiple Compl. How Many Zones?

18. Intervals Drilled By

Rotary Tools

11,051

Cable Tools

19. Producing Interval(s), of this completion - Top, Bottom, Name

10,768'-10,780' - Morrow

20. Was Directional Survey Made

Yes

21. Type Electric and Other Logs Run

GR-CBL-LS Sonic

22. Was Well Cored

No

23. CASING RECORD (Report all strings set in well)

CASING SIZE	WEIGHT LB./FT.	DEPTH SET	HOLE SIZE	CEMENTING RECORD	AMOUNT PULLED
13-3/8"	48# H-40	400'	17-1/2"	600 sx Class C	circ surf
9-5/8"	36# J-55	2822'	12-1/4"	950 sx Class C	circ surf
5-1/2"	17# P-110 & N-80	11,051'	7-7/8"	1100 sx Class H & C	TOC 3530'

24. LINER RECORD

SIZE	TOP	BOTTOM	SACKS CEMENT	SCREEN

25. TUBING RECORD

SIZE	DEPTH SET	PACKER SET
2-7/8"	10,647	10,647

26. Perforation record (interval, size, and number)

4 JSPF 48 holes 2-1/2" w/millennium HMX charges .35 EHD, 30.7" penetration

10,768'-10,780'

27. ACID, SHOT, FRACTURE, CEMENT, SQUEEZE, ETC.

DEPTH INTERVAL

10,768'-10,780'

AMOUNT AND KIND MATERIAL USED

Frac w/331 bbls binary foam &

38,000# sd 500 gal 7-1/2% NEFE

28. PRODUCTION

Date First Production 04/04/2003		Production Method (Flowing, gas lift, pumping - Size and type pump) Flowing				Well Status (Prod. or Shut-in) Prod	
Date of Test 04/25/2003	Hours Tested 24	Choke Size 14/64"	Prod'n For Test Period 9	Oil - Bbl. 1920	Gas - MCF 4	Water - Bbl. 213,333	Gas - Oil Ratio
Flow Tubing Press. 510	Casing Pressure	Calculated 24-Hour Rate	Oil - Bbl. 9	Gas - MCF 1920	Water - Bbl. 4	Oil Gravity - API - (Corr.) 57	

29. Disposition of Gas (Sold, used for fuel, vented, etc.)

sold

Test Witnessed By

30. List Attachments

logs, Multipoint test, Inclination Report

31. I hereby certify that the information shown on both sides of this form is true and complete to the best of my knowledge and belief

Signature

Bonnie Husband

Printed Name

Bonnie Husband

Title Production Analyst

Date 04/28/2003

INSTRUCTIONS

This form is to be filed with the appropriate District Office of the Division not later than 20 days after the completion of any newly-drilled or deepened well. It shall be accompanied by one copy of all electrical and radio-activity logs run on the well and a summary of all special tests conducted, including drill stem tests. All depths reported shall be measured depths. In the case of directionally drilled wells, true vertical depths shall also be reported. For multiple completions, Items 25 through 29 shall be reported for each zone. The form is to be filed in quintuplicate except on state land, where six copies are required. See Rule 1105.

INDICATE FORMATION TOPS IN CONFORMANCE WITH GEOGRAPHICAL SECTION OF STATE

Southeastern New Mexico

T. Anhy _____	T. Canyon _____
T. Salt _____	T. Strawn _____ 9680
B. Salt _____	T. Atoka _____ 10020
T. Yates _____ 720	T. Miss _____ 10945
T. 7 Rivers _____ 827	T. Devonian _____
T. Queen _____	T. Silurian _____
T. Grayburg _____	T. Montoya _____
T. San Andres _____	T. Simpson _____
T. Glorieta _____	T. McKee _____
T. Paddock _____	T. Ellenburger _____
T. Blinbry _____	T. Gr. Wash _____
T. Tubb _____	T. Delaware Sand _____ 2338
T. Drinkard _____	T. Bone Springs _____ 4100
T. Abo _____	T. 1st Bone Spr _____ 5873
T. Wolfcamp _____ 8480	T. _____
T. Penn _____ 9118	T. 3rd Bone Spr _____ 7912
T. Cisco (Bough C) _____	T. Morrow _____ 10547

Northwestern New Mexico

T. Ojo Alamo _____	T. Penn. "B" _____
T. Kirtland-Fruitland _____	T. Penn. "C" _____
T. Pictured Cliffs _____	T. Penn. "D" _____
T. Cliff House _____	T. Leadville _____
T. Menefee _____	T. Madison _____
T. Point Lookout _____	T. Elbert _____
T. Mancos _____	T. McCracken _____
T. Gallup _____	T. Ignacio Otzte _____
Base Greenhorn _____	T. Granite _____
T. Dakota _____	T. Capitan _____ 1537
T. Morrison _____	T. _____
T. Todilto _____	T. _____
T. Entrada _____	T. _____
T. Wingate _____	T. _____
T. Chinle _____	T. _____
T. Permain _____	T. _____
T. Penn "A" _____	T. _____

OIL OR GAS SANDS OR ZONES

No. 1, from 10657 _____ to 10670 _____	No. 3, from 10768 _____ to 10778 _____
No. 2, from 10720 _____ to 10738 _____	No. 4, from _____ to _____

IMPORTANT WATER SANDS

Include data on rate of water inflow and elevation to which water rose in hole.

No. 1, from _____ to _____ feet _____
No. 2, from _____ to _____ feet _____
No. 3, from _____ to _____ feet _____

LITHOLOGY RECORD (Attach additional sheet if necessary)

From	To	Thickness in Feet	Lithology	From	To	Thickness in Feet	Lithology
200	1335	1535	Anhydrite, salt, sand				
1535	2338	803	Dolomite				
2338	4100	1762	Sand & Dolomite				
4100	5873	1773	Limestone, Sand & Shale				
5873	6080	207	Sand, Shale & limestone				
6080	7960	1880	Limestone & Shale				
7960	8460	500	Sand, Shale, Limestone				
8460	8520	60	Limestone				
8520	9120	600	Shale & Limestone				
9120	9380	260	Limestone & Shale				
9380	9680	300	Shale & Limestone				
9680	10610	930	Limestone & Shale				
10610	10960	350	Sand, Shale & Limestone				
10960	11050	90	Shale				

Allied #2

Sec. 22, T20S, R27E

Eddy County, New Mexico

(Give Unit, Section, Township and Range)

LEASE & WELL

OPERATOR

SAGA PETROLEUM 415 W. WALL, STE 1900 MIDLAND, TEXAS 79701

DRILLING CONTRACTOR

NABORS DRILLING USA, LP

The Undersigned hereby certifies that he is an authorized representative of the drilling contractor who drilled the above-described well and that he has conducted deviation tests and obtained the following results:

DEGREES @ DEPTH		DEGREES @ DEPTH		DEGREES @ DEPTH		DEGREES @ DEPTH	
1/2	250	1 1/4	4953	1	9210		
1 3/4	399	1 3/4	5050	2	9609		
1/2	885	1 3/4	5147	1	10169		
1/2	1365	1 1/4	5244	1 1/4	10782		
3/4	1870	1 1/4	5475				
1 1/4	3280	1 1/4	5735				
1 1/2	3763	1	6249				
2	4150	1	6763				
2 1/2	4278	1	7245				
1 3/4	4411	3	7724				
1 1/2	4438	2 3/4	7823				
1 1/2	4536	2 1/2	7916				
1 3/4	4632	2 1/4	8013				
1 1/2	4727	1 3/4	8458				
1 1/4	4857	1 1/2	8786				

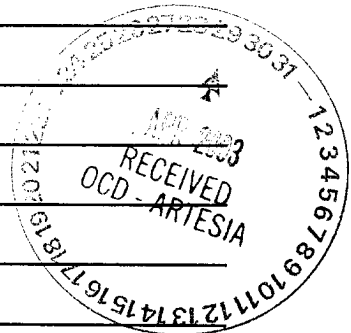

Drilling Contractor

Nabors Drilling USA, LP

By

Joe Harris-Drilling Superintendent

Subscribed and sworn to before me this 26th day of March, 2003

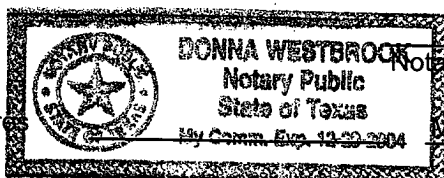

My Commision Expires

MIDLAND

County

TEXAS

DISTRICT I
P.O. Box 1980, Hobbs, NM 88241-1980

DISTRICT II
P.O. Drawer DD, Artesia, NM 88211-0719

DISTRICT III
1000 Rio Brazos Rd., Artec, NM 87410

DISTRICT IV
P.O. BOX 2088, SANTA FE, N.M. 87504-2088

State of New Mexico
Energy, Minerals and Natural Resources Department

OIL CONSERVATION DIVISION
P.O. Box 2088
Santa Fe, New Mexico 87504-2088

Form C-102
Revised February 10, 1994
Submit to Appropriate District Office
State Lease - 4 Copies
Fee Lease - 3 Copies

WELL LOCATION AND ACREAGE DEDICATION PLAT

☐ AMENDED REPORT

API Number 30-015-		Pool Code 70920	Pool Name AVALON MORROW
Property Code	Property Name ALLIED		Well Number 2
OGRID No. 148967	Operator Name SAGA PETROLEUM LLC		Elevation 3261'

Surface Location

UL or lot No.	Section	Township	Range	Lot Idn	Feet from the	North/South line	Feet from the	East/West line	County
M	22	20-S	27-E		660'	SOUTH	660'	WEST	EDDY

Bottom Hole Location If Different From Surface

UL or lot No.	Section	Township	Range	Lot Idn	Feet from the	North/South line	Feet from the	East/West line	County
Dedicated Acres 320		Joint or Infill Jt	Consolidation Code		Order No.				

NO ALLOWABLE WILL BE ASSIGNED TO THIS COMPLETION UNTIL ALL INTERESTS HAVE BEEN CONSOLIDATED
OR A NON-STANDARD UNIT HAS BEEN APPROVED BY THE DIVISION

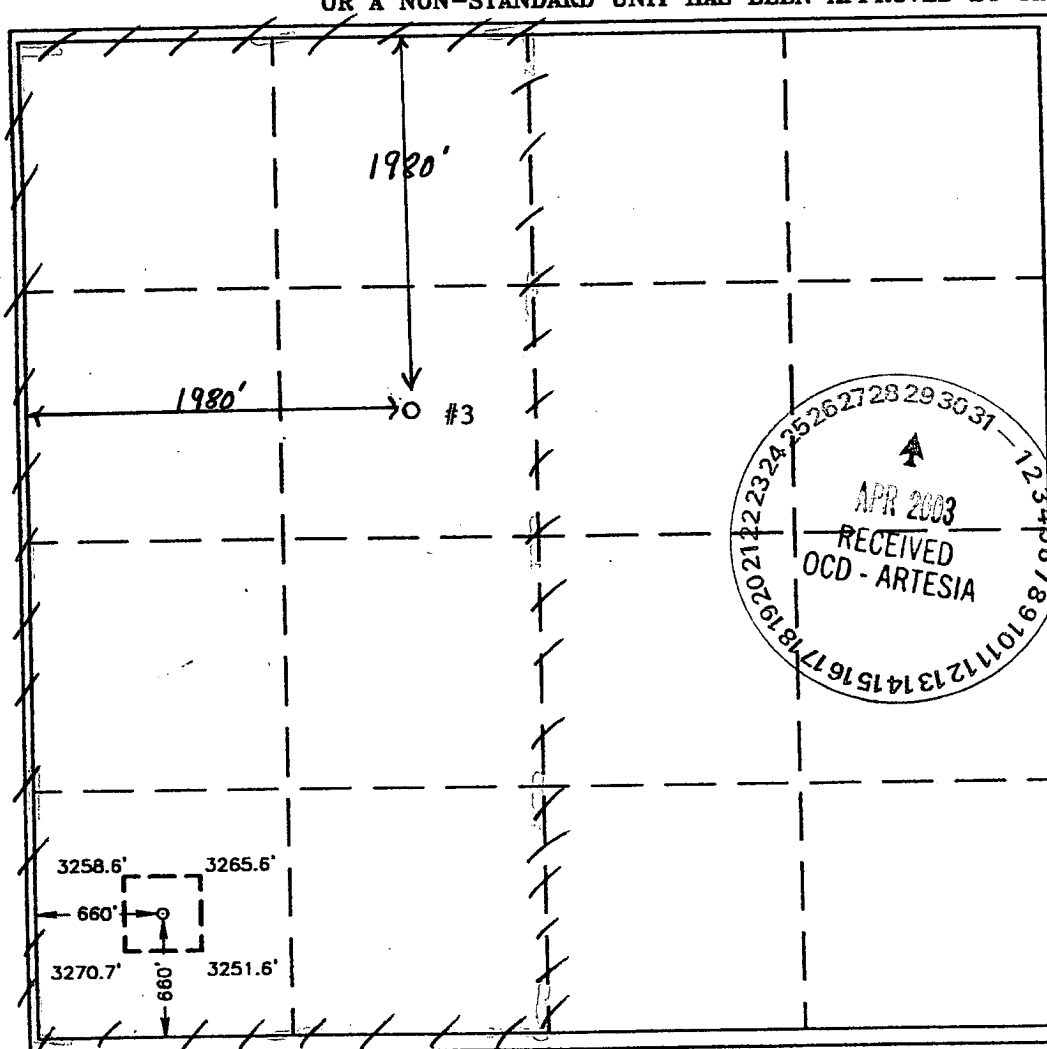

OPERATOR CERTIFICATION

I hereby certify the the information
contained herein is true and complete to the
best of my knowledge and belief.

Bonnie Husband
Signature

Bonnie Husband

Printed Name
Production Analyst

Title
October 23, 2002

Date

SURVEYOR CERTIFICATION

I hereby certify that the well location shown
on this plat was plotted from field notes of
actual surveys made by me or under my
supervision, and that the same is true and
correct to the best of my belief.

OCTOBER 07, 2002

Date Surveyed
Signature & Seal of
Professional Surveyor

Ronald A. Edson
Professional Surveyor
02.11.0726

Certificate No. RONALD A. EDSON 3239
OARY EDSON 12841