

1625 N. French Dr., Hobbs, NM 88240
District I
1301 W. Grand Avenue, Artesia, NM 88210
District II
1000 Rio Brazos Road, Aztec, NM 87410
District III
1220 S. St. Francis Dr., Santa Fe, NM 87505
District IV

State of New Mexico
Energy Minerals and Natural Resources

Oil Conservation Division
1220 South St. Francis Dr.
Santa Fe, NM 87505

Form C-1
March 12, 2005

For drilling and production facilities, submit
appropriate NMOCD District Office.
For downstream facilities, submit to Santa Fe
office

Pit or Below-Grade Tank Registration or Closure

Is pit or below-grade tank covered by a "general plan"? Yes ☐ No ☒

Type of action: Registration of a pit or below-grade tank ☐ Closure of a pit or below-grade tank ☒

Operator: Pogo Producing Company Telephone: 432-685-8100 e-mail address: wrightc@pogoproducing.com
Address: P.O. Box 10340, Midland, TX 79702-7340
Facility or well name: Pecos 33 Fed #3 API #: 30-015-32679 U/L or Qtr/Qtr B Sec 33 T 19 R 27
County: Eddy Latitude 32:37:345N Longitude 104:16:895W NAD: 1927 ☒ 1983 ☐ Surface Owner Federal ☒ State ☐ Private ☐ Indian ☐

Pit

Type: Drilling ☐ Production ☐ Disposal ☐
Workover ☐ Emergency ☐
Lined ☐ Unlined ☐
Liner type: Synthetic ☐ Thickness _____ mil Clay ☐ Volume
_____ bbl

Below-grade tank

Volume: _____ bbl Type of fluid: _____
Construction material: _____
Double-walled, with leak detection? Yes ☐ If not, explain why not.

Depth to ground water (vertical distance from bottom of pit to seasonal high water elevation of ground water.)	Less than 50 feet	(20 points)
	50 feet or more, but less than 100 feet	(10 points)
	100 feet or more	(0 points)
Wellhead protection area: (Less than 200 feet from a private domestic water source, or less than 1000 feet from all other water sources.)	Yes	(20 points)
	No	(0 points)
Distance to surface water: (horizontal distance to all wetlands, playas, irrigation canals, ditches, and perennial and ephemeral watercourses.)	Less than 200 feet	(20 points)
	200 feet or more, but less than 1000 feet	(10 points)
	1000 feet or more	(0 points)
Ranking Score (Total Points)		

If this is a pit closure: (1) attach a diagram of the facility showing the pit's relationship to other equipment and tanks. (2) Indicate disposal location:

onsite ☒ offsite ☐ If offsite, name of facility _____. (3) Attach a general description of remedial action taken including remediation start date and end date. (4) Groundwater encountered: No ☒ Yes ☐ If yes, show depth below ground surface _____ ft. and attach sample results. (5) Attach soil sample results and a diagram of sample locations and excavations.

I hereby certify that the information above is true and complete to the best of my knowledge and belief. I further certify that the above-described pit or below-grade tank has been/will be constructed or closed according to NMOCD guidelines ☒, a general permit ☐, or an (attached) alternative OCD-approved plan ☐.

Date: 1/26/05

Printed Name/Title Cathy Wright, Sr Eng Tech

Signature

Your certification and NMOCD approval of this application/closure does not relieve the operator of liability should the contents of the pit or tank contaminate ground water or otherwise endanger public health or the environment. Nor does it relieve the operator of its responsibility for compliance with any other federal, state, or local laws and/or regulations.

Approval:

Date: FEB 7 2005

Printed Name/Title

Signature

Pit Closing Procedure:

Pits are dewatered. Dirt contractor digs a deep bury pit adjacent to the drilling pit. Deep bury pit is lined with 12 mil plastic. Dirt contractor pushes contents of drilling pit into ~~the~~ ^{liner} deep bury pit. Deep bury pit is capped with 20 mil plastic then covered with 3 feet of fill dirt.

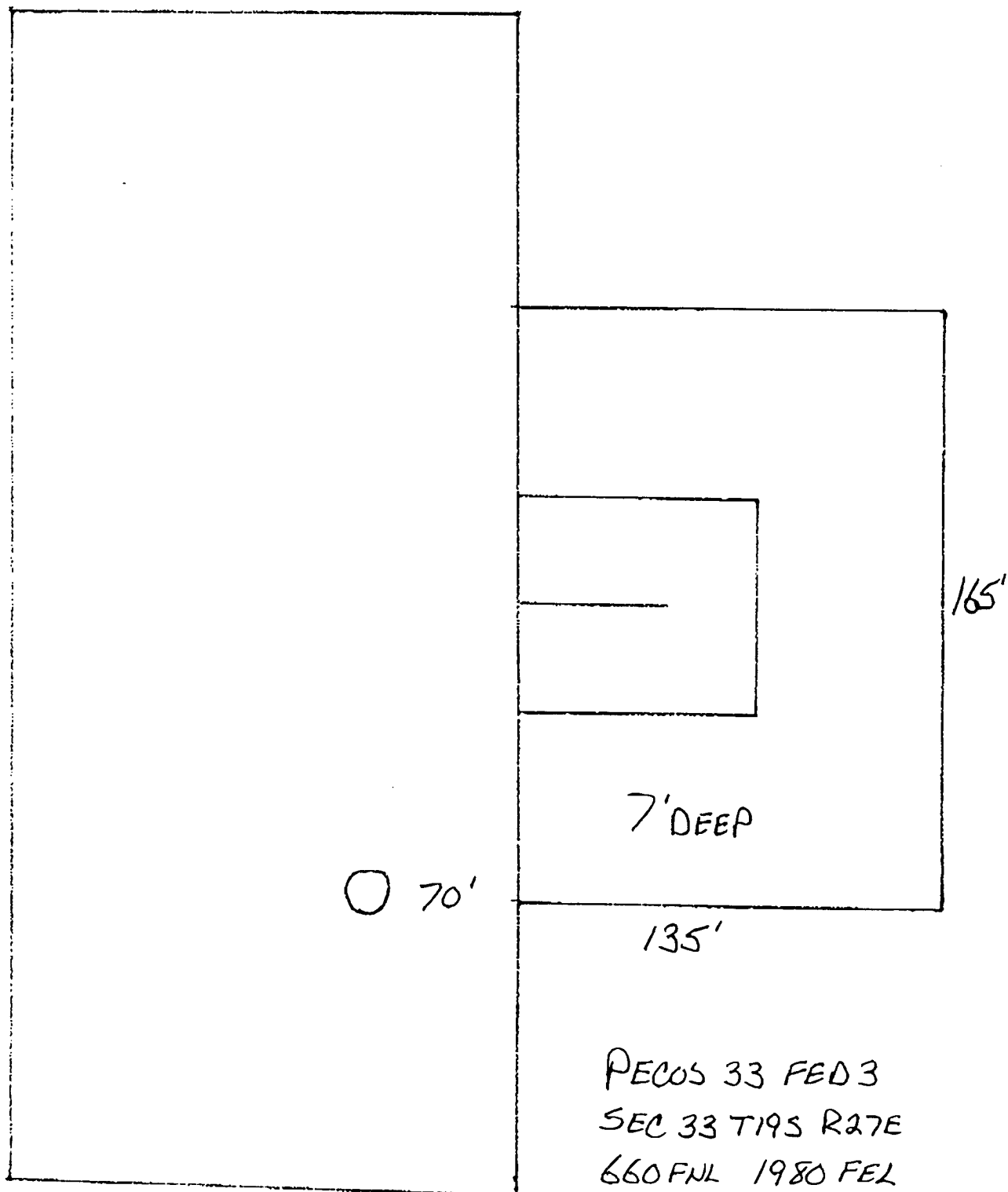

30-015-32679
 32:37:345 N
 104:16:895 W

PECOS 33 FED 3
 SEC 33 T19S R27E
 660 FNL 1980 FEL
 EADY CO.