

DISTRICT I
1625 N. FRENCH DR., HOBBS, NM 88240

State of New Mexico
Energy, Minerals and Natural Resources Department

Form C-102

Revised October 12, 2005

Submit to Appropriate District Office

State Lease - 4 Copies

Fee Lease - 3 Copies

DISTRICT II
1301 W. GRAND AVENUE, ARTESIA, NM 88210

OIL CONSERVATION DIVISION

12310 SOUTH ST. FRANCIS DR.

Santa Fe, New Mexico 87505

DISTRICT III
1000 RIO BRAZOS RD., AZTEC, NM 87410

DISTRICT IV
12310 S. ST. FRANCIS DR., SANTA FE, NM 87505

WELL LOCATION AND ACREAGE DEDICATION PLAT

☐ AMENDED REPORT

API Number 30-015 - 39213	Pool Code 96831	Pool Name Cedar Lake; Glorieta-Yeso
Property Code 308142	Property Name FOSTER EDDY	Well Number 29
OGRID No. 229137	Operator Name COG OPERATING, LLC	Elevation 3730'

Surface Location

UL or lot No G	Section 17	Township 17-S	Range 31-E	Lot Idn	Feet from the 2310	North/South line NORTH	Feet from the 1650	East/West line EAST	County EDDY
-------------------	---------------	------------------	---------------	---------	-----------------------	---------------------------	-----------------------	------------------------	----------------

Bottom Hole Location If Different From Surface

UL or lot No	Section	Township	Range	Lot Idn	Feet from the	North/South line	Feet from the	East/West line	County
Dedicated Acres		Joint or Infill	Consolidation Code	Order No					

NO ALLOWABLE WILL BE ASSIGNED TO THIS COMPLETION UNTIL ALL INTERESTS HAVE BEEN CONSOLIDATED
OR A NON-STANDARD UNIT HAS BEEN APPROVED BY THE DIVISION

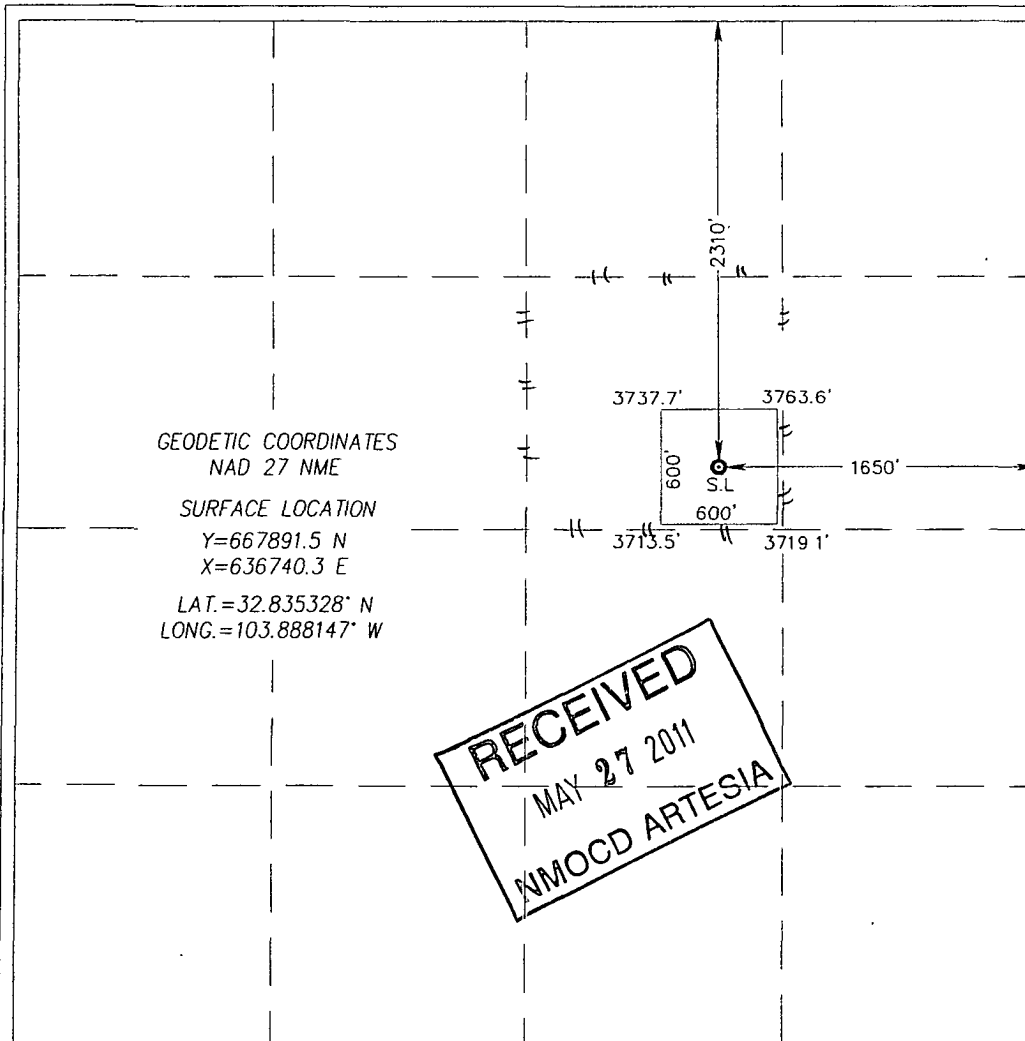

OPERATOR CERTIFICATION

I hereby certify that the information herein is true and complete to the best of my knowledge and belief, and that this organization either owns a working interest or unleased mineral interest in the land including the proposed bottom hole location or has a right to drill this well at this location pursuant to a contract with an owner of such mineral or working interest, or to a voluntary pooling agreement or a compulsory pooling order heretofore entered by the division.

Signature: *Kelly J. Holly* Date: 12-16-10

Printed Name: Kelly J. Holly

SURVEYOR CERTIFICATION

I hereby certify that the well location shown on this plat was plotted from field notes of actual surveys made by me or under my supervision, and that the same is true and correct to the best of my belief.

NOVEMBER 23, 2010

Date Surveyed: NOVEMBER 23, 2010 DSS

Signature & Seal of Professional Surveyor

Signature: *Ronald J. Eidson* Date: 12/14/2010
Professional Surveyor No. 10.11.1662

Certificate No. GARY G. EIDSON 12641
RONALD J. EIDSON 3239