

District I  
1625 N. French Dr., Hobbs, NM 88240  
District II  
811 S. First St., Artesia, NM 88210  
District III  
1000 Rio Brazos Road, Aztec, NM 87410  
District IV  
1220 S. St. Francis Dr., Santa Fe, NM 87505

State of New Mexico  
Energy Minerals and Natural Resources  
Department  
Oil Conservation Division  
1220 South St. Francis Dr.  
Santa Fe, NM 87505

Form C-144 CLEZ  
Revised August 1, 2011

For closed-loop systems that only use above ground steel tanks or haul-off bins and propose to implement waste removal for closure, submit to the appropriate NMOCD District Office.

**Closed-Loop System Permit or Closure Plan Application**

*(that only use above ground steel tanks or haul-off bins and propose to implement waste removal for closure)*

Type of action: ☒ Permit ☐ Closure

**Instructions:** Please submit one application (Form C-144 CLEZ) per individual closed-loop system request. For any application request other than for a closed-loop system that only use above ground steel tanks or haul-off bins and propose to implement waste removal for closure, please submit a Form C-144.

Please be advised that approval of this request does not relieve the operator of liability should operations result in pollution of surface water, ground water or the environment. Nor does approval relieve the operator of its responsibility to comply with any other applicable governmental authority's rules, regulations or ordinances.

1. Operator: JALAPENO CORPORATION OGRID #: 26307  
Address: P O BOX 1608: ALBUQUERQUE, NEW MEXICO 87103-1608  
Facility or well name: CRONY FEDERAL #1  
API Number: 30-005-64155 OCD Permit Number: 212467  
U/L or Qtr/Qtr P Section 1 Township 9S Range 27E County: CHAVES  
Center of Proposed Design: Latitude 33.555475' N Longitude 104.138424' W NAD: ☐ 1927 ☐ 1983  
Surface Owner: ☒ Federal ☐ State ☐ Private ☐ Tribal Trust or Indian Allotment

2. ☐ **Closed-loop System:** Subsection H of 19.15.17.11 NMAC  
Operation: ☒ Drilling a new well ☐ Workover or Drilling (Applies to activities which require prior approval of a permit or notice of intent) ☐ P&A  
☐ Above Ground Steel Tanks or ☒ Haul-off Bins

3. **Signs:** Subsection C of 19.15.17.11 NMAC  
☐ 12"x 24", 2" lettering, providing Operator's name, site location, and emergency telephone numbers  
☒ Signed in compliance with 19.15.16.8 NMAC

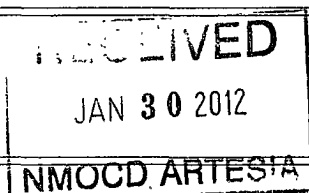

4. **Closed-loop Systems Permit Application Attachment Checklist:** Subsection B of 19.15.17.9 NMAC  
**Instructions:** Each of the following items must be attached to the application. Please indicate, by a check mark in the box, that the documents are attached.  
☒ Design Plan - based upon the appropriate requirements of 19.15.17.11 NMAC  
☒ Operating and Maintenance Plan - based upon the appropriate requirements of 19.15.17.12 NMAC  
☒ Closure Plan (Please complete Box 5) - based upon the appropriate requirements of Subsection C of 19.15.17.9 NMAC and 19.15.17.13 NMAC  
☐ Previously Approved Design (attach copy of design) API Number: \_\_\_\_\_  
☐ Previously Approved Operating and Maintenance Plan API Number: \_\_\_\_\_

5. **Waste Removal Closure For Closed-loop Systems That Utilize Above Ground Steel Tanks or Haul-off Bins Only:** (19.15.17.13.D NMAC)  
**Instructions:** Please identify the facility or facilities for the disposal of liquids, drilling fluids and drill cuttings. Use attachment if more than two facilities are required.  
Disposal Facility Name: GANDY MARLEY LANDFARM Disposal Facility Permit Number: NM 711-01-0019  
Disposal Facility Name: \_\_\_\_\_ Disposal Facility Permit Number: \_\_\_\_\_  
Will any of the proposed closed-loop system operations and associated activities occur on or in areas that will not be used for future service and operations?  
☐ Yes (If yes, please provide the information below) ☒ No  
**Required for impacted areas which will not be used for future service and operations:**  
☐ Soil Backfill and Cover Design Specifications - based upon the appropriate requirements of Subsection H of 19.15.17.13 NMAC  
☐ Re-vegetation Plan - based upon the appropriate requirements of Subsection I of 19.15.17.13 NMAC  
☐ Site Reclamation Plan - based upon the appropriate requirements of Subsection G of 19.15.17.13 NMAC

6. **Operator Application Certification:**  
I hereby certify that the information submitted with this application is true, accurate and complete to the best of my knowledge and belief.  
Name (Print): H. EMMONS YATES, III Title: GEOLOGICAL ANALYST  
Signature: [Signature] Date: Jan 9, 2012  
e-mail address: e.yates@jalapeno corp.com Telephone: 505-242-2050

7. **OCD Approval:** ☒ Permit Application (including closure plan) ☐ Closure Plan (only)

OCD Representative Signature: RDade Approval Date: 02/06/2012

Title: DIST # Supervisor OCD Permit Number: 212467

8. **Closure Report (required within 60 days of closure completion):** Subsection K of 19.15.17.13 NMAC

*Instructions: Operators are required to obtain an approved closure plan prior to implementing any closure activities and submitting the closure report. The closure report is required to be submitted to the division within 60 days of the completion of the closure activities. Please do not complete this section of the form until an approved closure plan has been obtained and the closure activities have been completed.*

☐ Closure Completion Date: \_\_\_\_\_

9. **Closure Report Regarding Waste Removal Closure For Closed-loop Systems That Utilize Above Ground Steel Tanks or Haul-off Bins Only:**

*Instructions: Please identify the facility or facilities for where the liquids, drilling fluids and drill cuttings were disposed. Use attachment if more than two facilities were utilized.*

Disposal Facility Name: \_\_\_\_\_ Disposal Facility Permit Number: \_\_\_\_\_

Disposal Facility Name: \_\_\_\_\_ Disposal Facility Permit Number: \_\_\_\_\_

Were the closed-loop system operations and associated activities performed on or in areas that *will not* be used for future service and operations?

☐ Yes (If yes, please demonstrate compliance to the items below) ☐ No

*Required for impacted areas which will not be used for future service and operations:*

- ☐ Site Reclamation (Photo Documentation)  
☐ Soil Backfilling and Cover Installation  
☐ Re-vegetation Application Rates and Seeding Technique

10. **Operator Closure Certification:**

I hereby certify that the information and attachments submitted with this closure report is true, accurate and complete to the best of my knowledge and belief. I also certify that the closure complies with all applicable closure requirements and conditions specified in the approved closure plan.

Name (Print): \_\_\_\_\_ Title: \_\_\_\_\_

Signature: \_\_\_\_\_ Date: \_\_\_\_\_

e-mail address: \_\_\_\_\_ Telephone: \_\_\_\_\_

# **Jalapeño Corporation**

**CRONY FEDERAL #1**

**330' FSL & 330' FEL**

**SECTION 1, T. 9-S, R. 27-E**

**CHAVES COUNTY, NEW MEXICO**

## **DESIGN PLAN**

- We will design the closed-loop system to contain all liquids and solids and prevent contamination of fresh water and protect public health and the environment.
- We will stockpile the available topsoil for use as the final cover at the time of closure.
- A 12" x 24" sign will be provided in accordance with Sub. C of 19.15.17.11.
- A surrounding perimeter fence will be installed around the entire well site.
- Drilling cuttings will be blown into and maintained in a haul-off bin.

## **OPERATING AND MAINTENANCE PLAN**

- We will operate and maintain the closed-loop system to contain all liquids and solids and prevent contamination of fresh water and protect public health and the environment.
- The equipment will be continuously monitored during operations.
- Should any leaks develop in the closed-loop system, we will remove all liquids and notify the BLM's Field office with 48 hours and we will immediately repair or replace the equipment.
- Drilling cuttings will be blown into a haul-off bin.
- All contaminated drilling fluids and cuttings in the haul-off bins will be transported to an approved disposal facilities (Gandy-Marley Landfarm, Permit #NM-0010019).

## **CLOSURE PLAN**

- Once we are no longer using the area associated with a closed-loop system, we will reclaim all areas associated with the closed-loop system to a safe and stable condition that blends with the surrounding undisturbed area in accordance with OCD rules and regulations.

# JALAPENO CORPORATION

## CRONY FEDERAL #1

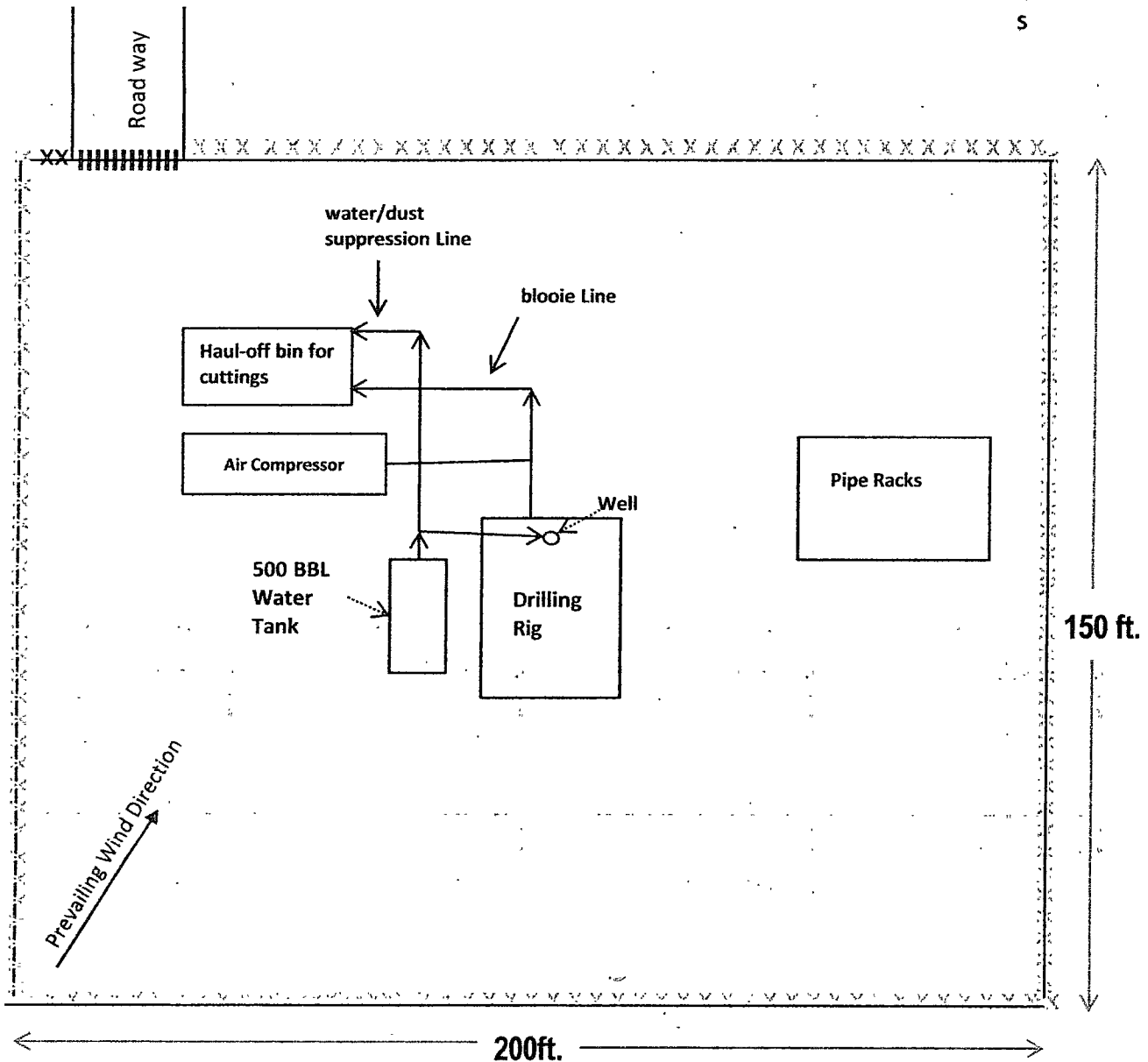
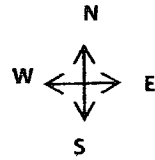

LEGEND	
	Fence
	Cattle guard

SEC. 1 TWP. 09S RGE. 27E  
COUNTY CHAVES STATE NEW MEXICO  
DESCRIPTION 330' FSL & 330' FEL  
LEASE NM 100542

**PECOS DISTRICT - RFO  
CONDITIONS OF APPROVAL**

OPERATORS NAME: Jalapeno Corporation

WELL NAME & NO: Crony Federal No.1

LEASE NO.: NM-100542

SURFACE HOLE FOOTAGE: 330' FSL & 330' FEL

LOCATION: Section 1, T. 9 S., R. 27 E., NMPM

COUNTY: Chaves County, New Mexico

**V. DRILLING**

**A. DRILLING OPERATIONS REQUIREMENTS:**

1. Call the Roswell Field Office, 2909 West Second St., Roswell, NM 88201. During office hours call (575) 627-0205 or after office hours call (575) 420-2832. Engineer on call during office hours call (575) 627-0275 or after office hours call (575) 626-5749.
2. The BLM is to be notified a minimum of 24 hours in advance for a representative to witness:
  - a. Spudding well
  - b. Setting and/or Cementing of all casing strings
  - c. BOPE Tests

A follow-up report on Form 3160-5 confirming the date and time of the actual spud shall be submitted to this office within 5 working days from the date of spud.

3. Unless the production casing has been run and cemented or the well has been properly plugged, the drilling rig shall not be removed from over the hole without prior approval.
4. Include the API Number assigned to well by NMOCD on the subsequent report of setting the first casing string.
5. **The operator will accurately measure the drilling rate in ft/min to set the base of the usable water protection casing string(s) opposite competent rock. The record of the drilling rate along with the caliper-gamma ray-neutron well log run to surface will be submitted to this office as well as all other logs run on the borehole 30 days from completion.**
6. Fresh water and fresh water foam will be used to drill to the base of the usable water protection casing string(s). Any polymers used will be water based and non-toxic.

**B. CASING:**

1. The **8-5/8** inch usable water protection casing string(s) shall be set in any competent bed (15' to 25') at an approximate minimum depth of 400 ft. and cemented to the surface.
  - a. If cement does not circulate to the surface, the Roswell Field Office shall be notified and a temperature survey utilizing an electronic type temperature survey with a surface log readout will be used or a cement bond log shall be run to verify the top of the cement.

b. Wait on cement (WOC) time for a primary cement job will be a minimum 18 hours for a water basin or 500 pounds compression strength, whichever is greater. (This is to include the lead cement).

c. Wait on cement (WOC) time for a remedial job will be a minimum of 4 hours after bringing cement to surface or 500 pounds compression strength, whichever is greater.

d. If cement falls back, remedial action will be done prior to drilling out that string.

2. The minimum required fill of cement behind the 5-1/2 inch production casing is **sufficient to tie back 500 feet above the top of the uppermost perforation in the pay zone.** If cement does not circulate to the surface, a temperature survey utilizing an electronic type temperature survey with a surface log readout will be used or a cement bond log shall be run to verify the top of the cement.

3. If hardband drill pipe is rotated inside casing, returns will be monitored for metal. If metal is found in samples, drill pipe will be pulled and rubber protectors which have a larger diameter than the tool joints of the drill pipe will be installed prior to continuing drilling operations.

4. All casing shall be new or reconditioned and tested casing and meet API standards for new casing. The use of reconditioned and tested casing shall be subject to approval by the authorized officer. Approval will be contingent upon the wall thickness of any casing being verified to be at least 87-1/2 per cent of the nominal wall thickness of new casing.

### **C. PRESSURE CONTROL:**

1. Before drilling below the 8-5/8 inch surface casing shoe, the blowout preventer assembly shall consist of a minimum of One Annular Preventer or Two Ram-Type Preventers and a Kelly Cock/Stabbing Valve.

2. Before drilling below the 8-5/8 inch surface casing shoe, minimum working pressure of the blowout preventer and related equipment (BOPE) shall be **2000** psi.

3. The BOPE shall be installed before drilling below the 8-5/8 inch surface casing and shall be tested as described in Onshore Order No. 2. Any equipment failing to test satisfactorily shall be repaired or replaced.

a. The BLM Roswell Field office shall be notified a minimum of 24 hours in advance for a representative to witness the tests.

b. The tests shall be done by an independent service company.

c. The BOP/BOPE test shall include a low pressure test from 250 to 300 psi. The test will be held for a minimum of 10 minutes if test is done with a test plug and 30 minutes without a test plug.

d. All tests are required to be recorded on a calibrated test chart. A copy of the BOP/BOPE test chart and a copy of independent service company test will be submitted to the BLM Roswell Field Office at 2909 West Second Street, Roswell, New Mexico 88201.

e. Testing fluid must be water or an appropriate clear liquid suitable for sub-freezing temperatures. Use of drilling mud for testing is not permitted since it can mask small leaks.

f. Testing must be done in a safe workman like manner. Hard line connections shall be required.

**D. MUD PROGRAM REQUIREMENTS:**

The drilling operations of this well will be conducted in accordance with the Onshore Oil and Gas Order No. 2 as provided in 43 CFR 3164.1. This includes well control equipment and its testing, mud system and associated equipment, and the casing and cementing.

a. Sufficient quantities of mud materials shall be maintained at the well site, at all times, for the purpose of assuring well control.

b. A mud test shall be performed at least every 24 hours after mudding up to determine, as applicable density, viscosity, gel strength, filtration, and PH.

c. Visual mud monitoring equipment shall be in place to detect volume changes indicating loss or gain of circulating fluid volume.

**E. SPECIAL STIPULATION:**

If frac ponds are necessary submit for approval a right-of-way application or sundry notice (Form 3160-5) to the BLM, Roswell Field Office 2909 West Second, Roswell, NM 88201. If frac pond is located on private/State surface and support the enhanced production of federal minerals BLM approval is necessary.

The frac pond will only be authorized to contain freshwater and testing of water quality is required. Additives are not allowed without consent of the authorized officer. If at any time the water in the frac pond becomes polluted with salts or other contaminants, use of the frac pond will cease and desist, and all liquids will be removed from the frac pond and disposed of properly. Mineral materials extracted during construction of the frac pond will be stored on-location and/or used for constructing the frac pond.

**Jalapeno Corporation**  
**P.O. Box 1608**  
**Albuquerque, NM 87103-1608**  
**Phone: (505) 242-2050 Fax: (505) 242-8501**

January 30, 2012

State of New Mexico  
Energy Minerals and Natural Resources Dept.  
Oil Conservation Division  
811 S. First Street  
Artesia, NM 88210

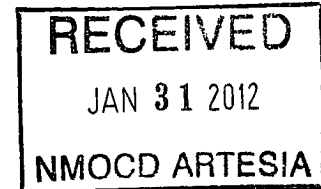

RE: Crony Federal #1

Ladies and Gentlemen:

Enclosed, please find one copy of the OCD (Form C-144 CLEZ) Closed-Loop System Permit or Closure Plan Application for the Crony Federal #1.

Please note that the BLM (Form 3160-3) Application for Permit to Drill or Reenter which includes the OCD (Form C-102) Well Location and Acreage Dedication Plat, the Surface Use Plan of Operations, the Drilling & Operations Program and the Hydrogen Sulfide Drilling Operation Plan) for the Crony Federal #1 well along with a filing-fee check has been sent to the BLM Office in Roswell on January 9<sup>th</sup>.

If you have any questions or need further information, I can be reached at the numbers listed above or by e-mail at [rcandelaria@jalapenocorp.com](mailto:rcandelaria@jalapenocorp.com).

Sincerely,

A handwritten signature in black ink, appearing to read "Renee Candelaria".

Renee Candelaria

enclosures