

DISTRICT I  
1025 N. French Dr., Hobbs, NM 88240  
Phone (575) 393-6181 Fax: (575) 393-0720

DISTRICT II  
1301 W. Grand Avenue, Artesia, NM 88210  
Phone (575) 746-1283 Fax: (575) 746-9720

DISTRICT III  
1000 Rio Brazos Rd., Aztec, NM 87410  
Phone (505) 334-6178 Fax: (505) 334-6170

DISTRICT IV  
1220 S. St. Francis Dr., Santa Fe, NM 87505  
Phone (505) 476-3460 Fax: (505) 476-3462

State of New Mexico  
Energy, Minerals and Natural Resources Department

OIL CONSERVATION DIVISION  
1220 South St. Francis  
Santa Fe, New Mexico 87505

RECEIVED

APR 19 2012

NM OGD ARTESIA

Form C-102  
Revised August 1, 2011

Submit one copy to appropriate  
District Office

WELL LOCATION AND ACREAGE DEDICATION PLAT

☒ AMENDED REPORT

API Number 30-015-39792	Pool Code 96473	Pool Name Pierce Crossing; Bone Spring
Property Code 38990	Property Name DOC "BHU" STATE COM	Well Number 5H
OGRID No. 025575	Operator Name YATES PETROLEUM CORP.	Elevation 3189'

Surface Location

UL or lot No. 0	Section 6	Township 25 S	Range 30 E	Lot Idn	Feet from the 430	North/South line SOUTH	Feet from the 2310	East/West line EAST	County EDDY
--------------------	--------------	------------------	---------------	---------	----------------------	---------------------------	-----------------------	------------------------	----------------

Bottom Hole Location If Different From Surface

UL or lot No. 0	Section 5	Township 25 S	Range 30 E	Lot Idn	Feet from the 430	North/South line SOUTH	Feet from the 1650	East/West line EAST	County EDDY
--------------------	--------------	------------------	---------------	---------	----------------------	---------------------------	-----------------------	------------------------	----------------

Dedicated Acres 200.00	Joint or Infill	Consolidation Code	Order No.
---------------------------	-----------------	--------------------	-----------

NO ALLOWABLE WILL BE ASSIGNED TO THIS COMPLETION UNTIL ALL INTERESTS HAVE BEEN CONSOLIDATED  
OR A NON-STANDARD UNIT HAS BEEN APPROVED BY THE DIVISION.

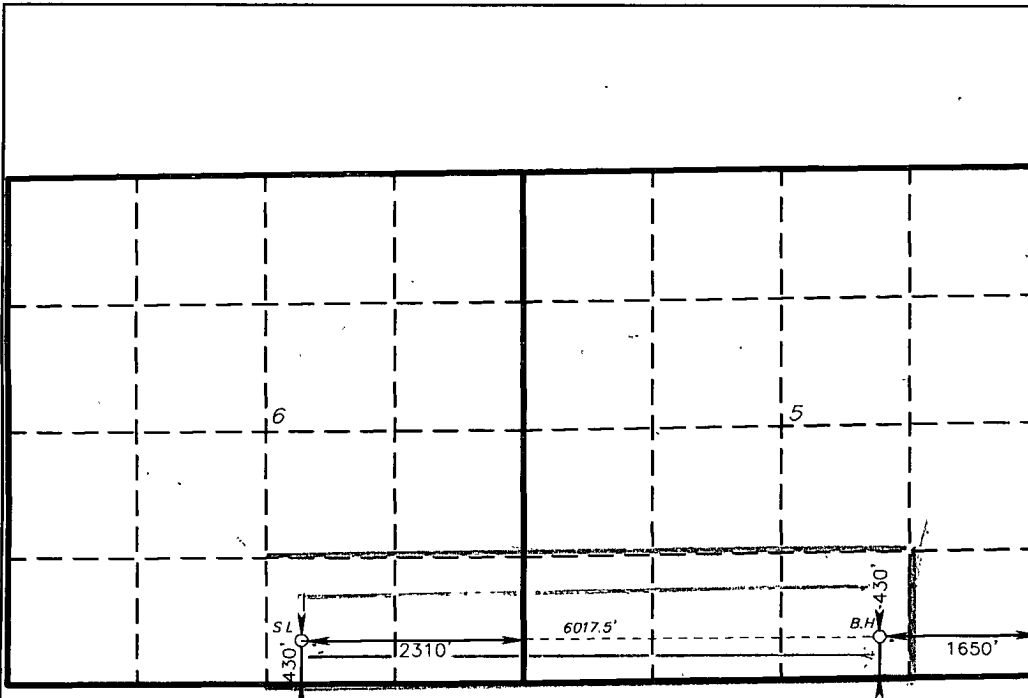

SURFACE LOCATION

Lat - N 32°09'11.62"  
Long - W 103°55'10.42"  
NMSPCE- N 419725.829  
E 669388.905  
(NAD-83)

PROPOSED BOTTOM  
HOLE LOCATION

Lat - N 32°09'12.14"  
Long - W 103°54'00.42"  
NMSPCE- N 419802.27  
E 675405.96  
(NAD-83)

OPERATOR CERTIFICATION

I hereby certify that the information contained herein is true and complete to the best of my knowledge and belief, and that this organization either owns a working interest or unleased mineral interest in the land including the proposed bottom hole location or has a right to drill this well at this location pursuant to a contract with an owner of such a mineral or working interest, or to a voluntary pooling agreement or a compulsory pooling order heretofore entered by the division.

Clifton May 4/18/12  
Signature Date

Clifton May

Printed Name

cliff@yatespetroleum.com

Email Address

SURVEYOR CERTIFICATION

I hereby certify that the well location shown on this plat was plotted from field notes of actual surveys made by me or under my supervision, and that the same is true and correct to the best of my belief.

NOVEMBER 12 2011

Date Surveyed

Signature & Seal of Professional Surveyor

7977

No. 25594

Certificate No. Gary L. Jones 7977

Basin Surveys 25594