

Submit 3 Copies To Appropriate District  
Office  
District I  
1625 N. French Dr., Hobbs, NM 87240  
District II  
1301 W. Grand Ave., Artesia, NM 88210  
District III  
1000 Rio Brazos Rd., Aztec, NM 87410  
District IV  
1220 S. St. Francis Dr., Santa Fe, NM  
87505

State of New Mexico  
Energy, Minerals and Natural Resources

OIL CONSERVATION DIVISION  
1220 South St. Francis Dr.  
Santa Fe, NM 87505

Form C-103  
June 19, 2008

WELL API NO. <b>30-015-37590</b>
5. Indicate Type of Lease STATE <input checked="" type="checkbox"/> FEE <input type="checkbox"/>
6. State Oil & Gas Lease No.
7. Lease Name or Unit Agreement Name: <b>Elk Wallow 11 State</b>
8. Well Number <b>3H</b>
9. OGRID Number <b>7377</b>
10. Pool name or Wildcat <b>Pierce Crossing; Bone Spring, East</b>

**SUNDRY NOTICES AND REPORTS ON WELLS**  
(DO NOT USE THIS FORM FOR PROPOSALS TO DRILL OR TO DEEPEN OR PLUG BACK TO A DIFFERENT RESERVOIR. USE "APPLICATION FOR PERMIT" (FORM C-101) FOR SUCH PROPOSALS.)

1. Type of Well: Oil Well <input checked="" type="checkbox"/> Gas Well <input type="checkbox"/> Other
2. Name of Operator <b>EOG Resources, Inc.</b>
3. Address of Operator <b>P.O. Box 2267 Midland, TX 79702</b>
4. Well Location Unit Letter <b>B</b> : <b>140</b> feet from the <b>North</b> line and <b>1650</b> feet from the <b>East</b> line Section <b>11</b> Township <b>25S</b> Range <b>29E</b> NMPM County <b>Eddy</b>
11. Elevation (Show whether DR, RKB, RT, GR, etc.) <b>3061' GR</b>

12. Check Appropriate Box to Indicate Nature of Notice, Report, or Other Data

NOTICE OF INTENTION TO:

PERFORM REMEDIAL WORK ☐ PLUG AND ABANDON ☐  
TEMPORARILY ABANDON ☐ CHANGE PLANS ☒  
PULL OR ALTER CASING ☐ MULTIPLE COMPL ☐  
DOWNHOLE COMMINGLE ☐

OTHER: ☐

SUBSEQUENT REPORT OF:

REMEDIAL WORK ☐ ALTERING CASING ☐  
COMMENCE DRILLING OPNS. ☐ P AND A ☐  
CASING/CEMENT JOB ☐

OTHER: ☐

13. Describe proposed or completed operations. (Clearly state all pertinent details, and give pertinent dates, including estimated date of starting any proposed work). SEE RULE 1103. For Multiple Completions: Attach wellbore diagram of proposed completion or recompletion.

EOG Resources requests the approved APD location for the Elk Wallow 11 State 3H be amended to:

140' FNL & 1650' FEL, U/L B (SHL)  
330' FSL & 1880' FEL, U/L O (BHL)  
Section 11, T25S, R29E, Eddy County



Spud Date:

Rig Release Date:

I hereby certify that the information above is true and complete to the best of my knowledge and belief.

SIGNATURE Stan Wagner TITLE Regulatory Analyst DATE 10/26/11

Type or print name Stan Wagner E-mail address: \_\_\_\_\_ PHONE 432-686-3689

For State Use Only  
APPROVED BY T.C. Shepard TITLE Geologist DATE OCT 31 2011

Conditions of Approval (if any):

District I  
1625 N. French Dr., Hobbs, NM 88240  
District II  
1301 W. Grand Avenue, Artesia, NM 88210  
District III  
1000 Rio Brozos Rd., Aztec, NM 87410  
District IV  
1220 S. St. Francis Dr., Santa Fe, NM 87505

State of New Mexico  
Energy, Minerals & Natural Resources Department  
OIL CONSERVATION DIVISION  
1220 South St. Francis Dr.  
Santa Fe, NM 87505

Form C-402  
Revised October 12, 2005  
Submit to Appropriate District Office  
State Lease- 4 Copies  
Fee Lease- 3 Copies

☐ AMENDED REPORT

WELL LOCATION AND ACREAGE DEDICATION PLAT

API Number 30-015-37590	Pool Code 96473	Pool Name Pierce Crossing; Bone Spring, East
Property Code 38036	Property Name ELK WALLOW "11" STATE	Well Number 3H
OCRID No. 7377	Operator Name EOG RESOURCES, INC.	Elevation 3061.7'

Surface Location

UL or lot no. B	Section 11	Township 25 SOUTH	Range 29 EAST, N.M.P.M.	Lot Idn	Feet from the 140'	North/South line NORTH	Feet from the 1650'	East/West line EAST	County EDDY
--------------------	---------------	----------------------	----------------------------	---------	-----------------------	---------------------------	------------------------	------------------------	----------------

Bottom Hole Location If Different From Surface

UL or lot no. O	Section 11	Township 25 SOUTH	Range 29 EAST, N.M.P.M.	Lot Idn	Feet from the 330'	North/South line SOUTH	Feet from the 1880'	East/West line EAST	County EDDY
Dedicated Acres 160	Joint or Infill	Consolidation Code	Order No.						

No allowable will be assigned to this completion until all interests have been consolidated or a non-standard unit has been approved by the division.

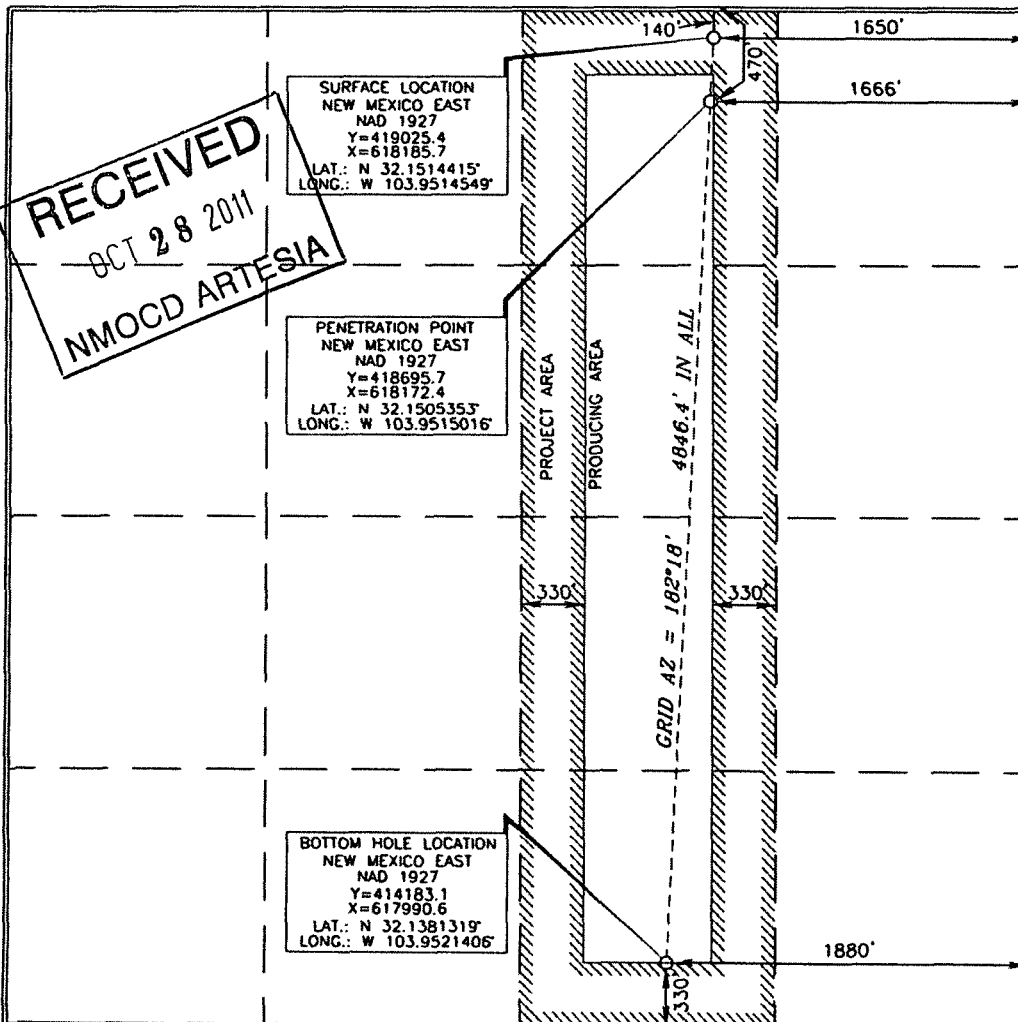

OPERATOR CERTIFICATION

I hereby certify that the information contained herein is true and complete to the best of my knowledge and belief, and that this organization either owns a working interest or unleased mineral interest in the land including the proposed bottom hole location or has a right to drill this well at this location pursuant to a contract with an owner of such a mineral or working interest, or to a voluntary pooling agreement or a compulsory pooling order heretofore entered by the division.

*Stan Wagner* 10/26/11  
Signature Date

Stan Wagner  
Printed Name

SURVEYOR CERTIFICATION

I hereby certify that the well location shown on this plat was reported from field notes of actual surveys made by me or under my supervision, and that the same is true and correct to the best of my belief.

SEP 29 2011  
Date of Survey

Signature of Professional Surveyor

*Terry J. Paul* 10/12/2011  
Certificate Number 15079

WO# 110929WL-d (KA)