

N.M. Oil Cons. DIV-Dist. 2
1301 W. Grand Avenue
Artesia, NM 88210

UNITED STATES
DEPARTMENT OF THE INTERIOR
BUREAU OF LAND MANAGEMENT

RECEIVED

MAY 02 2005

0
OMB No. 1004-0136
Expires November 30, 2000

APPLICATION FOR PERMIT TO DRILL OR REENTER

1a. Type of Work: <input checked="" type="checkbox"/> DRILL <input type="checkbox"/> REENTER		5. Lease Serial No. NM-107360	
b. Type of Well: <input type="checkbox"/> Oil Well <input checked="" type="checkbox"/> Gas Well <input type="checkbox"/> Other <input type="checkbox"/> Single Zone <input type="checkbox"/> Multiple Zone		6. If Indian, Allottee or Tribe Name	
2. Name of Operator Yates Petroleum Corporation		7. If Unit or CA Agreement, Name and No.	
3A. Address 105 South Fourth Street Artesia, New Mexico 88210		8. Lease Name and Well No. Bamboozled BBX Federal Com. #1	
3B. Phone No. (include area code) (505) 748-1471 Cement		9. API Well No. 30-015 34101	
4. Location of Well (Report location clearly and in accordance with any State requirements. *) At surface 4772' FSL and 806' FEL At proposed prod. Zone 4620' FSL and 806' FEL		10. Field and Pool, or Exploratory Morrow	
14. Distance in miles and direction from nearest town or post office* Approximately 15 miles Northeast of Carlsbad, New Mexico.		11. Sec., T., R., M., or Blk. and Survey or Area Section 3, T21S-R24E	
15. Distance from proposed* location to nearest property or lease line, ft. (Also to nearest drig. unit line, if any) 806	16. No. of Acres in lease 421.15	17. Spacing Unit dedicated to this well 320	
18. Distance from proposed* location to nearest well, drilling, completed, applied for, on this lease, ft. 1.3 miles	19. Proposed Depth 10400	20. BLM/BIA Bond No. on file NM-2811	
21. Elevations (Show whether DF, KDB, RT, GL, etc.) 3825' GL	22. Approximate date work will start*	23. Estimated duration	

24. Attachments

CARLSBAD CONTROLLED WATER BASIN

The following, completed in accordance with the requirements of Onshore Oil and Gas Order No. 1, shall be attached to this form:

- | | |
|---|---|
| 1. Well plat certified by a registered surveyor. | 4. Bond to cover the operations unless covered by an existing bond on file (see Item 20 above). |
| 2. A Drilling Plan. | 5. Operator certification. |
| 3. A Surface Use Plan (if the location is on National Forest System Lands, the SUPO shall be filed with the appropriate Forest Service Office). | 6. Such other site specific information and/or plans as may be required by the authorized office. |

25. Signature <i>Debbie L. Caffall</i>	Name (Printed/Typed) Debbie L. Caffall	Date 3/28/05
Title: Regulatory Technician		
Approved by (Signature) <i>/s/ Joe G. Lara</i>	Name (Printed/Typed) /s/ Joe G. Lara	Date APR 29 2005
Title ACTING FIELD MANAGER		
Office CARLSBAD FIELD OFFICE		

Application approval does not warrant or certify that the applicant holds legal or equitable title to those rights in the subject lease which would entitle the applicant to conduct operations thereon.

Conditions of approval, if any, are attached.

APPROVAL FOR 1 YEAR

Title 18 U.S.C. Section 1001 and Title 43 U.S.C. Section 1212, make it a crime for any person knowingly and willfully to make to any department or agency of the United States any false, fictitious or fraudulent statements or representations as to any matter within its jurisdiction.

*(Instructions on reverse)

Previously Approved

C-144 attached

APPROVAL SUBJECT TO
GENERAL REQUIREMENTS
AND SPECIAL STIPULATIONS
ATTACHED **>9.5**

WITNESS **9 5/8" Cement Job**

District I
25 N. French Dr., Hobbs, NM 88240
District II
1301 W. Grand Avenue, Artesia, NM 88210
District III
1000 Rio Brazos Road, Aztec, NM 87410
District IV
1220 S. St. Francis Dr., Santa Fe, NM 87505

State of New Mexico
Energy Minerals and Natural Resources

Oil Conservation Division
1220 South St. Francis Dr.
Santa Fe, NM 87505

Form C-144
March 12, 2004

For drilling and production facilities, submit to appropriate NMOCD District Office.
For downstream facilities, submit to Santa Fe office

Pit or Below-Grade Tank Registration or Closure

Is pit or below-grade tank covered by a "general plan"? Yes ☒ No ☐

Type of action: Registration of a pit or below-grade tank ☒ Closure of a pit or below-grade tank ☐

Operator: Yates Petroleum Corporation Telephone: (505) 748-4372 e-mail address: debbiec@ypcnm.com

Address: 105 South 4th Street, Artesia, NM 88210

Facility or well name: Bamboozled BBX Federal #1 API #: _____ U/L or Qtr/Qtr Lot 9 Sec 3 T 21S R 24E

County: Eddy Latitude N.32°30'53.7" Longitude W.104°28'51.5" NAD: 1927 ☐ 1983 ☒ Surface Owner Federal ☒ State ☐ Private ☐ Indian ☐

Pit Type: Drilling ☒ Production ☐ Disposal ☐

Workover ☐ Emergency ☐

Lined ☒ Unlined ☐

Liner type: Synthetic ☒ Thickness 12 mi Clay ☐ Volume _____ bbl

Below-grade tank

Volume: _____ bbl Type of fluid: _____

Construction material: _____

Double-walled, with leak detection? Yes ☐ If not, explain why not. _____

RECEIVED

Depth to ground water (vertical distance from bottom of pit to seasonal high water elevation of ground water.)

Less than 50 feet

(20 points)

50 feet or more, but less than 100 feet

(10 points)

100 feet or more

(0 points)

Wellhead protection area: (Less than 200 feet from a private domestic water source, or less than 1000 feet from all other water sources.)

Yes

(20 points)

No

(0 points)

Distance to surface water: (horizontal distance to all wetlands, playas, irrigation canals, ditches, and perennial and ephemeral watercourses.)

Less than 200 feet

(20 points)

200 feet or more, but less than 1000 feet

(10 points)

1000 feet or more

(0 points)

Ranking Score (Total Points)

Points 30 Points

If this is a pit closure: (1) attach a diagram of the facility showing the pit's relationship to other equipment and tanks. (2) Indicate disposal location:

onsite ☐ offsite ☐ If offsite, name of facility _____ (3) Attach a general description of remedial action taken including remediation start date and end date. (4) Groundwater encountered: No ☐ Yes ☐ If yes, show depth below ground surface _____ ft. and attach sample results. (5) Attach soil sample results and a diagram of sample locations and excavations.

I hereby certify that the information above is true and complete to the best of my knowledge and belief. I further certify that the above-described pit or below-grade tank has been/will be constructed or closed according to NMOCD guidelines ☐, a general permit ☒, or an (attached) alternative OCD-approved plan ☐.

Date: October 18, 2004

Printed Name/Title Cy Cowan/Regulatory Agent Signature Debbie S. Caffrell for Cy Cowan

Your certification and NMOCD approval of this application/closure does not relieve the operator of liability should the contents of the pit or tank contaminate ground water or otherwise endanger public health or the environment. Nor does it relieve the operator of its responsibility for compliance with any other federal, state, or local laws and/or regulations.

Approval: OCT 21 2004

Date: _____

Printed Name/Title _____

Signature _____

**As a condition of approval
a detailed closure plan
must be filed before
closure may commence.**

DISTRICT I
99 N. French Dr., Hobbs, NM 88240
DISTRICT II
811 South First, Artesia, NM 88210
DISTRICT III
1800 Rio Brazos Rd., Aztec, NM 87410
DISTRICT IV
2048 South Puebloa, Santa Fe, NM 87506

State of New Mexico
Energy, Minerals and Natural Resources Department

Form C-102
Revised March 17, 1999
Instruction on back
Submit to Appropriate District Office
State Lease - 4 Copies
Fee Lease - 3 Copies

OIL CONSERVATION DIVISION
P.O. Box 2088
Santa Fe, New Mexico 87504-2088

☐ AMENDED REPORT

WELL LOCATION AND ACREAGE DEDICATION PLAT

API Number	Pool Code	Pool Name Wildcat Morrow
Property Code	Property Name Bamboozled Federal	Well Number 1
OCRD No. 025575	Operator Name YATES PETROLEUM CORPORATION	Elevation 3825'

Surface Location

UL or Lot No.	Section	Township	Range	Lot 1/4	Feet from the	North/South Line	Feet from the	East/West Line	County
Lot 9	3	21S	24E		4772'	South	806'	East	Eddy

Bottom Hole Location If Different From Surface

UL or Lot No.	Section	Township	Range	Lot 1/4	Feet from the	North/South Line	Feet from the	East/West Line	County
Lot 9	3	21S	24E		4620'	South	806'	East	Eddy
Dedicated Acres 404.60	Joint or Infill	Consolidation Code	Order No.						

NO ALLOWABLE WILL BE ASSIGNED TO THIS COMPLETION UNTIL ALL INTERESTS HAVE BEEN CONSOLIDATED
OR A NON-STANDARD UNIT HAS BEEN APPROVED BY THE DIVISION

Lot 12	Lot 11	Lot 10	SL BHL 806' Lot 9
			4620'
		NM-107360	

OPERATOR CERTIFICATION

I hereby certify that the information contained herein is true and complete to the best of my knowledge and belief.

Cy Cowan
Signature
Cy Cowan
Printed Name
Regulatory Agent
Title
April 7, 2004
Date

SURVEYOR CERTIFICATION

I hereby certify that the well location shown on this plat was plotted from field notes of actual surveys made by me or under my supervision, and that the same is true and correct to the best of my belief.

REFER TO ORIGINAL PLAT.

Date Surveyed
Signature & Seal of Professional Surveyor

Certificate No. Herschel L. Jones RLS 3640
GENERAL SURVEYING COMPANY

DISTRICT I
M. French Dr., Hobbs, NM 88240
DISTRICT II
811 South First, Artesia, NM 88210
DISTRICT III
1000 Rio Brazos Rd., Aztec, NM 87410
DISTRICT IV
2040 South Pecos, Santa Fe, NM 87506

State of New Mexico
Energy, Minerals and Natural Resources Department

Form C-102
Revised March 17, 1999
Instruction on back
Submit to Appropriate District Office
State Lease - 4 Copies
Fee Lease - 3 Copies

OIL CONSERVATION DIVISION

P.O. Box 2088
Santa Fe, New Mexico 87504-2088

☐ AMENDED REPORT

WELL LOCATION AND ACREAGE DEDICATION PLAT

API Number	Pool Code	Pool Name Wildcat Morrow
Property Code	Property Name BAMBOOZLED FEDERAL	Well Number 1
OCRID No. 025575	Operator Name YATES PETROLEUM CORPORATION	Elevation 3825

Surface Location

UL or lot No.	Section	Township	Range	Lot Idn	Feet from the	North/South line	Feet from the	East/West line	County
LOT 9	3	21S	24E		4772	SOUTH	806	EAST	EDDY

Bottom Hole Location If Different From Surface

UL or lot No.	Section	Township	Range	Lot Idn	Feet from the	North/South line	Feet from the	East/West line	County
Dedicated Acres 404.60	Joint or Infill	Consolidation Code	Order No.						

NO ALLOWABLE WILL BE ASSIGNED TO THIS COMPLETION UNTIL ALL INTERESTS HAVE BEEN CONSOLIDATED
OR A NON-STANDARD UNIT HAS BEEN APPROVED BY THE DIVISION

LOT 12	LOT 11	N.32°30'53.7" W.104°28'51.5" LOT 10 NM-107360	3846 3854 3833 3819 LOT 9
LOT 13	LOT 14	LOT 15	LOT 16
			4772'

OPERATOR CERTIFICATION

I hereby certify that the information contained herein is true and complete to the best of my knowledge and belief.

Cy Cowan
Signature
Cy Cowan
Printed Name
Regulatory Agent
Title
February 24, 2003
Date

SURVEYOR CERTIFICATION

I hereby certify that the well location shown on this plat was plotted from field notes of actual surveys made by me or under my supervision, and that the same is true and correct to the best of my belief.

2/18/2003
Date Surveyed
Signature
Professional Seal
Professional Surveyor
3640
Certificate No. 3640
BAMBOOZLED
GENERAL SURVEYING COMPANY

0 330' 660' 990' 1650' 1980' 2310' 2310' 1980' 1650' 990' 660' 330' 0'

YATES PETROLEUM CORPORATION
Bamboozled BBX Federal Com. #1
 4772' FSL and 806' FEL (Surface Location)
 4620' FSL and 806' FEL (Bottom Hole Location)
 Section 3, T21S-R24E
 Eddy County, New Mexico

1. The estimated tops of geologic markers are as follows:

San Andres	1320'	Strawn	9165'
Bone Spring Lime	3530'	Atoka	9585'
1 st Bone Spring Lime	3980'	Upper Morrow	9970'
2 nd Bone Spring Lime	4945'	Middle Morrow	10020'
3 rd Bone Springs Lime	6530'	Lower Morrow	10180'
Wolfcamp	6945'	Base of Morrow	10245'
Cisco	8395'	TD	10400'

2. The estimated depths at which anticipated water, oil or gas formations are expected to be encountered:

Water: 200' - 300'
 Oil or Gas: All potential zones

3. Pressure Control Equipment: BOPE will be installed on the 9 5/8" casing and rated for 5000 BOP systems will be consistent with API RP 53. Pressure tests will be conducted before drilling out from under all casing strings which are set and cemented in place. Blowout Preventor controls will be installed prior to drilling the surface plug and will remain in use until the well is completed or abandoned. Preventors will be inspected and operated at least daily to ensure good mechanical working order, and this inspection recorded on the daily drilling report. See Exhibit B.

Auxiliary Equipment:

A. Auxiliary Equipment: Kelly cock, pit level indicators, flow sensor equipment and a sub with full opening valve to fit the drill pipe and collars will be available on the rig floor in the open position at all times for use when kelly is not in use.

4. THE PROPOSED CASING AND CEMENTING PROGRAM:

A. Casing Program: (All New)

<u>Hole Size</u>	<u>Casing Size</u>	<u>Wt./Ft</u>	<u>Grade</u>	<u>Thread</u>	<u>Interval</u>	<u>Length</u>
17 1/2"	13 3/8"	48#	J-55	H-40	0-400'	400'
12 1/4"	9 5/8"	36#	J-55	ST&C	0-3550'	3550'
8 3/4"	5 1/2"	17#	L-80	LT&C	0-900'	900'
8 3/4"	5 1/2"	17#	J-55	LT&C	900'-1600'	700'
8 3/4"	5 1/2"	15.5#	J-55	LT&C	1600'-6400'	4800'
8 3/4"	5 1/2"	17#	J-55	LT&C	6400'-8200'	1800'
8 3/4"	5 1/2"	17#	L-80	LT&C	8200'-10400'	2200'

Minimum Casing Design Factors: Collapse 1.125, Burst 1.0, Tensile Strength 1.8

B. CEMENTING PROGRAM:

Surface casing: 450 sx 'C' + 2% CaCl₂(YLD 1.64 WT 13.0).

Intermediate casing: 1300 sx Lite C (Yld 1.98 WT 12.5) Tail in w/200 sx
Class C (YLD 1.34 WT 14.8).

Production Casing: TOC 3050', Lead w/1400 sx Lite 'C' (YLD 1.95 WT 12.5)
Tail in w/650 sx Super 'C' Modified (YLD 1.58 WT 13.2).

5. Mud Program and Auxiliary Equipment:

<u>Interval</u>	<u>Type</u>	<u>Weight</u>	<u>Viscosity</u>	<u>Fluid Loss</u>
Spud to 400'	FW/Spud Mud	8.4-8.6	34-36	N/C
400'-3550'	Fresh Water	8.4-8.6	28	N/C
3550'-6935'	Cut Brine	8.8-8.9	28	N/C
6935'-8395'	Cut Brine	9.2-9.4	28	N/C
8395'-9230'	Cut Brine	9.4-9.6	28	N/C
9230'-10400'	SW/Gel/Starch/4% KCL	9.6-9.8	30-32	<10cc

Sufficient mud material(s) to maintain mud properties, control lost circulation and contain a blow out will be available at the well site during drilling operations. Mud will be checked hourly by rig personnel.

6. EVALUATION PROGRAM:

Samples: 10' out from under intermediate casing to TD.

Logging: Platform Express/HALS/NGT.

Coring: None anticipated.

DST's: As Warranted, possible from Cisco to TD.

7. Abnormal Conditions, Bottom hole pressure and potential hazards:

Anticipated BHP:

From: 0	TO 400'	Anticipated Max. BHP: 175	PSI
From: 400'	TO 3550'	Anticipated Max. BHP: 1600	PSI
From: 3550'	TO 10400'	Anticipated Max. BHP: 5300	PSI

Abnormal Pressures Anticipated: None

Lost Circulation Zones Anticipated: None

H₂S Zones Anticipated: None

Maximum Bottom Hole Temperature: 189° F

8. ANTICIPATED STARTING DATE:

Plans are to drill this well as soon as possible after receiving approval. It should take approximately 30 days to drill the well with completion taking another 15 days.

MULTI-POINT SURFACE USE AND OPERATIONS PLAN

Yates Petroleum Corporation

Bamboozled BBX Federal Com. #1

4772' FSL and 806' FEL (Surface Location)

4620' FSL and 806' (Bottom Hole Location)

Section 3, T21S-R24E

Eddy County, New Mexico

This plan is submitted with Form 3160-3, Application for Permit to Drill, covering the above described well. The purpose of this plan is to describe the location of the proposed well, the proposed construction activities and operations plan, the magnitude of the surface disturbance involved and the procedures to be followed in rehabilitating the surface after completion of the operations, so that a complete appraisal can be made of the environmental effect associated with the operations.

1. EXISTING ROADS:

Exhibit A is a portion of the BLM map showing the well and roads in the vicinity of the proposed location. The proposed wellsite is located approximately 15 miles Northwest of Carlsbad, New Mexico and the access route to the location is indicated in red and green on Exhibit A.

DIRECTIONS:

Go south of Artesia of Highway 285 to White Pine Road. (CR 28) Turn right on White Pine Road and go approx. 6.2 miles. Turn left here and go to the Mystery AYM Federal #1 well location. The new road will start going from the southeast corner of the Mystery AYM Federal #1, east on existing two track for approx. 0.3 of a mile. Turn right here on a two-track road and go approx. 1.2 miles to the northeast corner of the proposed well location.

2. PLANNED ACCESS ROAD:

- A. The proposed new access will be approximately 1.5 miles in length from the point of origin to the northeast corner of drilling pad. The road will lie in an east then south direction.
- B. The new road will be 14 feet in width (driving surface) and will be adequately drained to control runoff and soil erosion.
- C. The new road will be bladed with drainage on one side. Traffic turnouts may be built.
- D. The route of the road is visible.
- E. Existing roads will be maintained in the same or better condition.

3. LOCATION OF EXISTING WELL

- A. There is drilling activity within a one-mile radius of the wellsite.
- B. Exhibit D shows existing wells within a one-mile radius of the proposed wellsite.

4. LOCATION OF EXISTING AND/OR PROPOSED FACILITIES

- A. There are no production facilities on this lease at the present time.
- B. In the event that the well is productive, the necessary production facilities will be installed on the drilling pad. If the well is productive oil, a gas or diesel self-contained unit will be used to provide the necessary power. No power will be required if the well is productive of gas.

5. LOCATION AND TYPE OF WATER SUPPLY:

- A. It is planned to drill the proposed well with a fresh water system. The water will be obtained from commercial sources and will be hauled to the location by truck over the existing and proposed roads shown in Exhibit A.

6. SOURCE OF CONSTRUCTION MATERIALS:

The dirt contractor will acquire any materials from the closest source at the time of construction of the well pad.

7. METHODS OF HANDLING WASTE DISPOSAL:

- A. Drill cuttings will be disposed of in the reserve pits.
- B. Drilling fluids will be allowed to evaporate in the reserve pits until the pits are dry.
- C. Water produced during operations will be collected in tanks until hauled to an approved disposal system, or separate disposal application will be submitted.
- D. Oil produced during operations will be stored in tanks until sold.
- E. Current laws and regulations pertaining to the disposal of human waste will be complied with.
- F. All trash, junk, and other waste materials will be contained in trash cages or bins to prevent scattering and will be removed and deposited in an approved sanitary landfill. Burial on site is not approved.

8. ANCILLARY FACILITIES: None

9. WELLSITE LAYOUT:

- A. Exhibit C shows the relative location and dimensions of the well pad, the reserve pits, the location of the drilling equipment, rig orientation and access road approach.
- B. The reserve pits will be plastic lined.
- C. A 400' x 400' area has been staked and flagged.

10. PLANS FOR RESTORATION

- A. After finishing drilling and/or completion operations, all equipment and other material not needed for further operations will be removed. The location will be cleaned of all trash and junk to leave the wellsite in as aesthetically pleasing a condition as possible.
- B. Unguarded pits, if any, containing fluids will be fenced until they have dried and been leveled.
- C. If the proposed well is non-productive, all rehabilitation and/or vegetation requirements of the Bureau of Land Management will be complied with and will be accomplished as expeditiously as possible. All pits will be filled level within 90 days after abandonment.

11. SURFACE OWNERSHIP: Bureau of Land Management, Carlsbad, New Mexico.

12. OTHER INFORMATION:

- A. Topography: Refer to the existing archaeological report for a description of the topography, flora, fauna, soil characteristics, dwellings, historical and cultural sites.
- B. The primary surface use is for grazing.

13. OPERATOR'S REPRESENTATIVE

A. Through A.P.D. Approval:

Cy Cowan, Regulatory Agent
Yates Petroleum Corporation
105 South Fourth Street
Artesia, New Mexico 88210
Phone (505) 748-1471

B. Through Drilling Operations,
Completions and Production:

Pinson McWhorter, Operations Manager
Yates Petroleum Corporation
105 South Fourth Street
Artesia, New Mexico 88210
Phone (505) 748-1471

14. CERTIFICATION:

I hereby certify that I, or persons under my direct supervision, have inspected the proposed drill site and access route, that I am familiar with the conditions which presently exist; that the statements made in this plan are to the best of my knowledge, true and correct; and, that the work associated with the operations proposed herein will be performed by Yates Petroleum Corporation and its contractors and subcontractors in conformity with this plan and the terms and conditions under which it is approved. This statement is subject to the provisions of 18 U.S.C. 1001 for the filing of a false statement.

03/28/2005

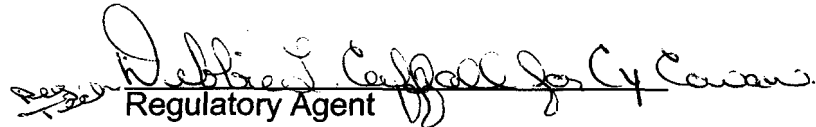
Regulatory Agent

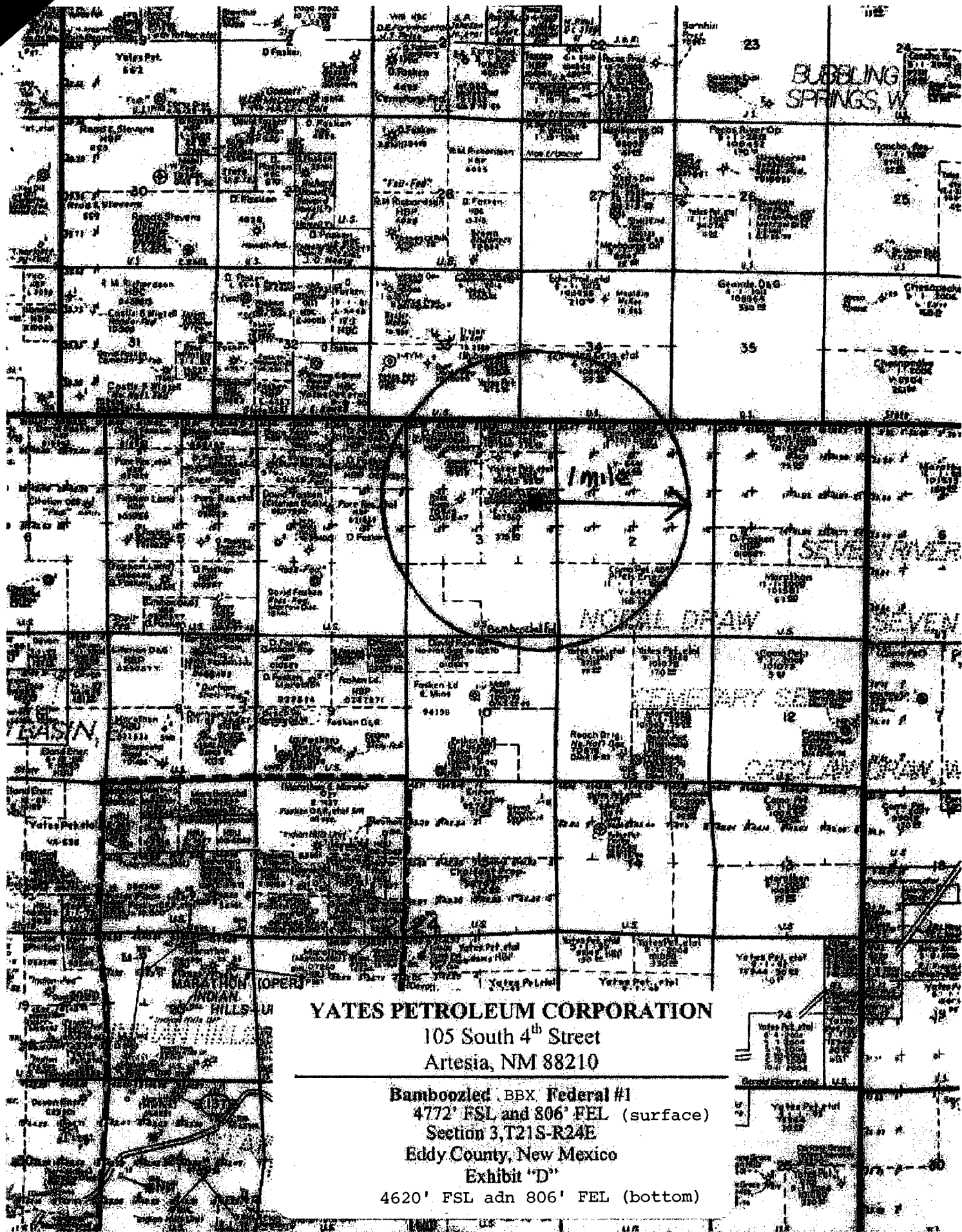

YATES PETROLEUM CORPORATION

105 South 4th Street
Artesia, NM 88210

Bamboozled - BRX Federal #1

4772' FSL and 806' FEL (surface)

Section 3, T21S-R24E
Eddy County, New Mexico

Exhibit "C"

4620' FSL and 806' FEL (bottom)

Yates Petroleum Corporation Location Layout for Permian Basin Up to 12,000'

Pits to the West

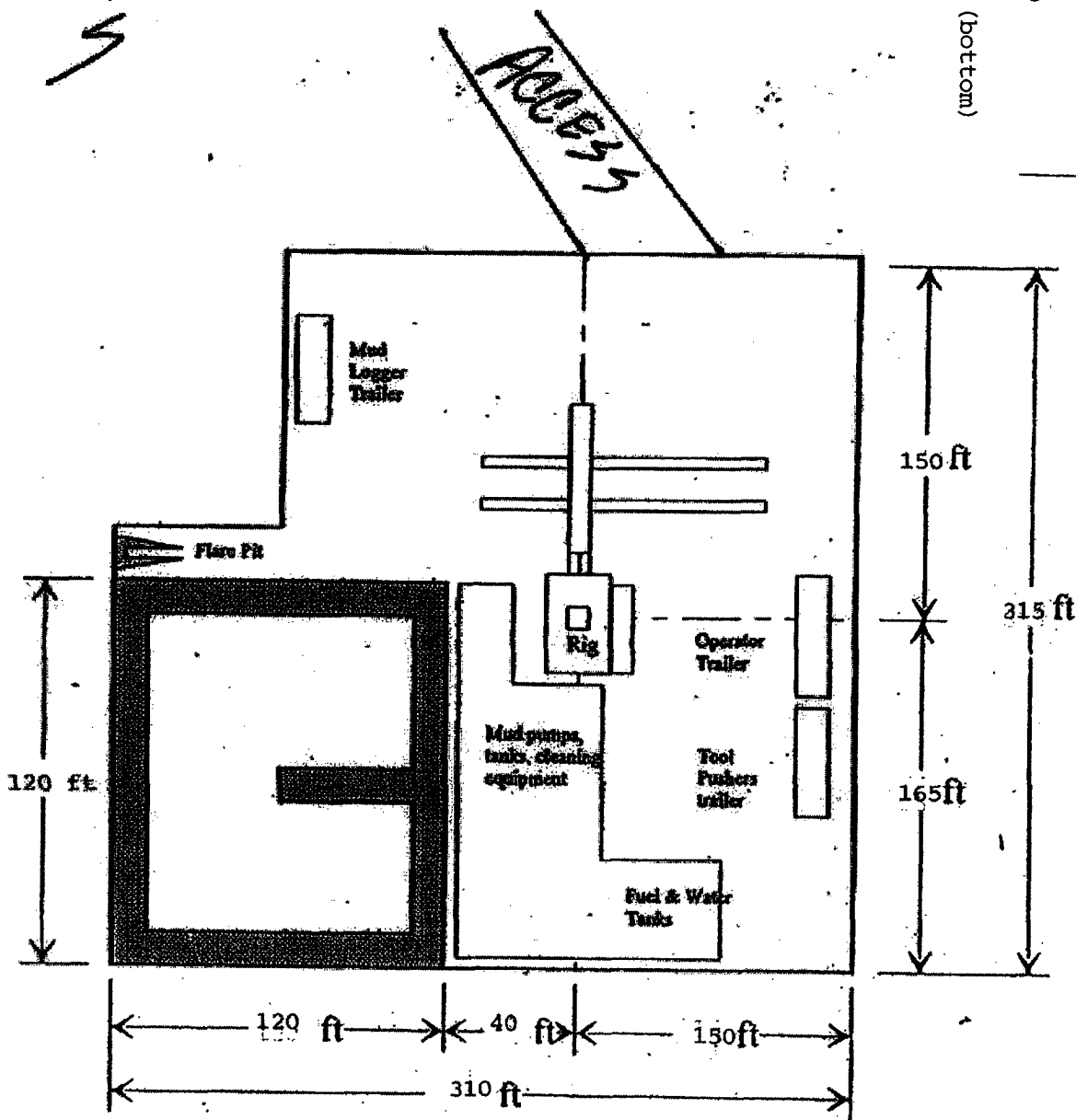
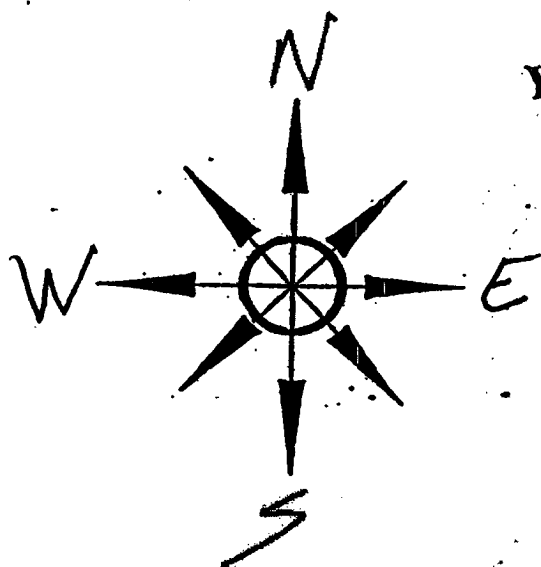

Distance from Well Head to Reserve Pit will vary between rigs

The above dimension should be a maximum

Yates Petroleum Corporation

Typical 5,000 psi Pressure System
Schematic
Annular with Double Ram Preventer Stack

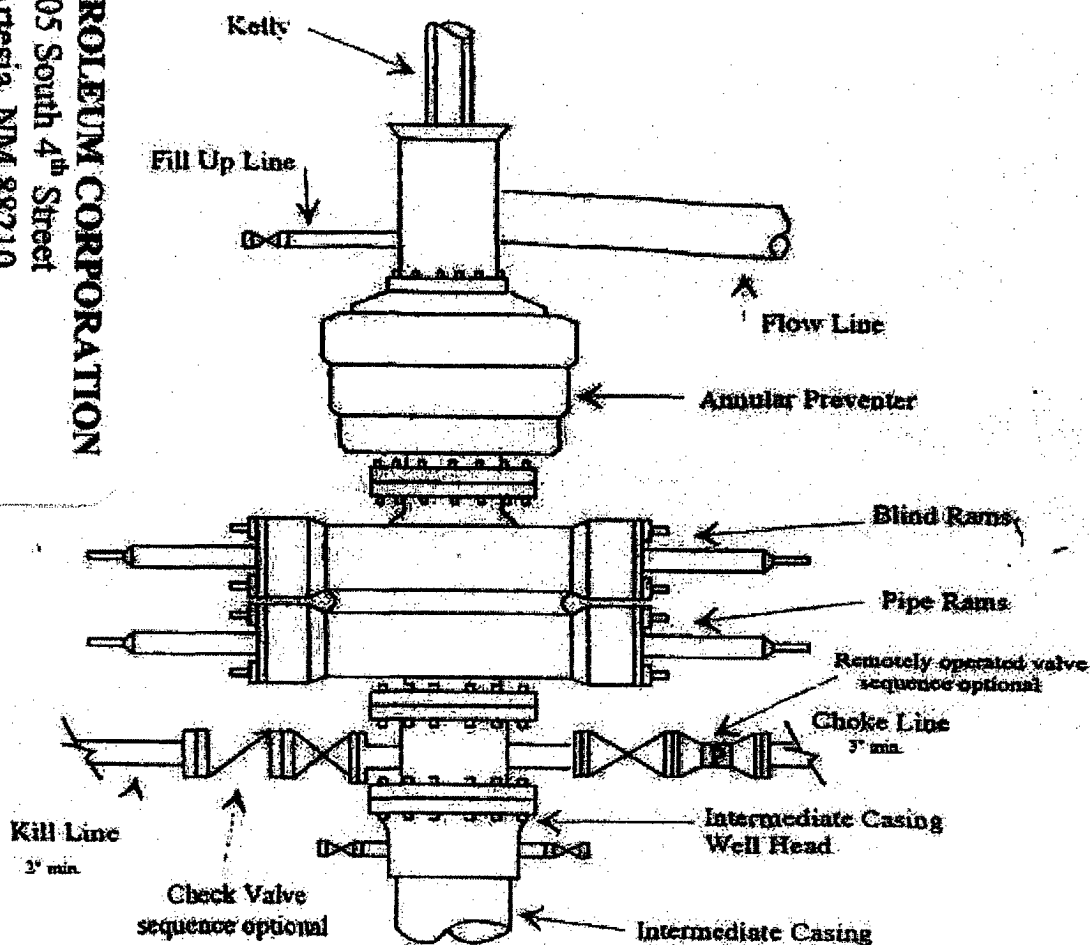

Bambooed BBX Federal #1

4772' FSL and 806' FEL (surface)

Section 3, T21S-R24E

Eddy County, New Mexico

Exhibit "B"

4620' FSL and 806' FEL (bottom)

Typical 5,000 psi choke manifold assembly with at least these minimum features

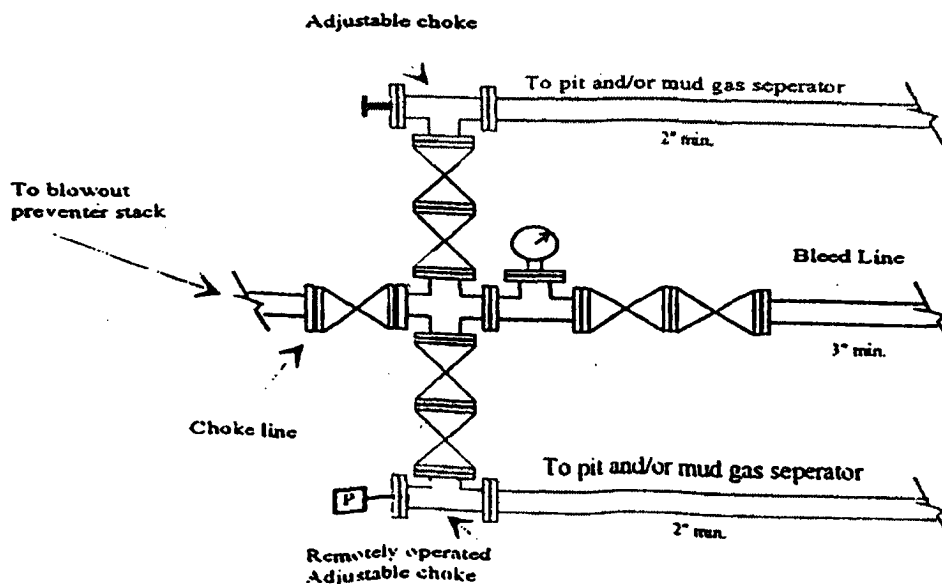

YATES PETROLEUM CORPORATION

105 South 4th Street

Artesia, NM 88210

Bamboozled BBX Federal #1
4772' FSL and 806' FEL (Surface)

4772' FSL and 806' FEL (Surface)

Section 3, T21S-R24E

Eddy County, New Mexico

Exhibit "A"

4620' FSL and 806' FEL (bottom)

