

UNITED STATES
DEPARTMENT OF THE INTERIOR
BUREAU OF LAND MANAGEMENT
N.M. Oil Cons. DIV-Dist. 2
1301 W. Grand Avenue
Artesia, NM 88210

FORM APPROVED
OMB NO. 1004-0136
Expires: November 30, 2000

APPLICATION FOR PERMIT TO DRILL OR REENTER

1a. Type of Work <input checked="" type="checkbox"/> DRILL <input type="checkbox"/> REENTER		5. Lease Serial No. NM-0354232	
1b. Type of Well <input type="checkbox"/> Oil Well <input checked="" type="checkbox"/> Gas Well <input type="checkbox"/> Other <input checked="" type="checkbox"/> Single Zone <input type="checkbox"/> Multiple Zone		6. If Indian, Allottee or Tribe Name	
2. Name of Operator OXY USA WTP Limited Partnership		7. Unit or CA Agreement Name and No. 27682	
3a. Address P.O. Box 50250 Midland, TX 79710-0250		8. Lease Name and Well No. Elizando A Federal #7	
3b. Phone No. (include area code) 432-685-5717		9. API Well No. 30-015- 34149	
4. Location of Well (Report location clearly and in accordance with any State requirements)* At surface 1650 FSL 660 FEL NESE(I) per SN dated 4/19/05 At proposed prod. zone 1980 RECEIVED		10. Field and Pool, or Exploratory Burton Flat Morrow 73280	
14. Distance in miles and direction from nearest town or post office* 3 miles northeast from Carlsbad, NM		11. Sec., T., R., M., or Blk. and Survey or Area Sec 21 T21S R27E	
15. Distance from proposed* location to nearest property or lease line, ft. (Also to nearest drg. unit line, if any) 660'		12. County or Parish Eddy	
16. No. of Acres in lease 320		13. State NM	
17. Spacing Unit dedicated to this well 320		20. BLM/BIA Bond No. on file 9312774	
18. Distance from proposed location* to nearest well, drilling, completed, applied for, on this lease, ft. 2849'		21. Elevations (Show whether DF, KDB, RT, GL, etc.) 3225'	
22. Approximate date work will start* 9/1/05		23. Estimated duration 30 days	

24. Attachments

CARLSBAD CONTROLLED WATER BASIN

The following, completed in accordance with the requirements of Onshore Oil and Gas Order No. 1, shall be attached to this form:

1. Well plat certified by a registered surveyor.
2. A Drilling Plan
3. A Surface Use Plan (if the location is on National Forest System Lands, the SUPO shall be filed with the appropriate Forest Service Office).
4. Bond to cover the operations unless covered by an existing bond on file (see Item 20 above).
5. Operator certification.
6. Such other site specific information and/or plans as may be required by the authorized officer.

25. Signature 	Name (Printed/Typed) David Stewart	Date 3/1/05
--	---------------------------------------	----------------

Title
Sr. Regulatory Analyst

Approved by (Signautre) /s/ Joe G. Lara	Name (Printed/Typed) /s/ Joe G. Lara	Date JUN - 1 2005
--	---	----------------------

Title ACTING FIELD MANAGER	Office CARLSBAD FIELD OFFICE
-------------------------------	---------------------------------

Application approval does not warrant or certify that the applicant holds legal or equitable title to those rights in the subject lease which would entitle the applicant to conduct operations thereon.
Conditions of approval, if any, are attached.

APPROVAL FOR 1 YEAR

Title 18 U.S.C. Section 1001 and Title 43 U.S.C. Section 1212, make it a crime for any person knowingly and willfully to make to any department or agency of the United States any false, fictitious or fraudulent statements or representations as to any matter within its jurisdiction.

*(Instructions on Reverse)

APPROVAL SUBJECT TO
GENERAL REQUIREMENTS
AND SPECIAL STIPULATIONS
ATTACHED

WITNESS 9 3/8" Cement Job

Attachment C-101
Elizando A Federal #7
1650 FSL 660 FEL NESE(I) SEC 21 T21S R27E Eddy County, NM
Federal Lease No. NM-0354232

PROPOSED TD: 11800' TVD

BOP PROGRAM: 0-600' None

600-2700' 13-3/8" 3M annular preventer, to be used as
divertor only.

2700-11800' 11" 5M blind pipe rams with 5M annular
preventer and rotating head below 8500'.

CASING: Surface: 13-3/8" OD 48# H40 ST&C new casing set at 600'
17-1/2" hole

Intermediate: 9-5/8" OD 36# K55 ST&C new casing from 0-2700'
12-1/4" hole

Production: 5-1/2" OD 17# N80-HP110 LT&C new casing from 0-11800'
8-3/4" hole 8400'-N80 3400'-HP110

CEMENT: Surface - Circulate cement with 360sx HES light premium plus w/ 2%
CaCl₂ + .25#/sx Flocele followed by 250sx PP w/ 2% CaCl₂ + .25#/sx
Flocele.

Intermediate - Circulate cement with 595sx Interfill C w/ .25#/sx
Flocele followed by 200sx PP w/ 2% CaCl₂.

Production - Cement with 350sx Interfill H w/ .1% HR-7 followed by
400sx Super H w/ .5% HR-344 + .4% CFR-3 + 5#/sx Gilsonite + 1#/sx
salt + .2% HR-7. Estimated top of cement is 8000'.

Note: Cement volumes may need to be adjusted to hole caliper.

MUD: 0-600' Fresh water/native mud. Lime for pH control
(9-10). Paper for seepage.
Wt 8.7-9.2 ppg, Vis 32-34 sec

600-2700' Fresh/*Brine water. Lime for pH control (10.0-
10.5). Paper for seepage.
Wt 8.3-9.0/10.0-10.1ppg, Vis 28-29 sec
*Fresh water will be used unless chlorides in
the mud system increases to 20000PPM.

2700-8000' Fresh water. Lime for pH control(9-9.5).. Paper
for seepage.
Wt 8.3-8.5 ppg, Vis 28-29 sec

8000-10000' Cut brine. Lime for pH control (10-10.5)..
Wt 9.6-10.0 ppg, Vis 28-29sec

10000-11800' Mud up with an Duo Vis/Flo Trol mud system.
Wt 9.6-10.0ppg, Vis 32-36sec, WL<10cc

RECEIVED
NOV 10 AM 10:25

District I
625 N. French Dr., Hobbs, NM 88240
District II
1301 W. Grand Avenue, Artesia, NM 88210
District III
1000 Rio Brazos Road, Aztec, NM 87410
District IV
1220 S. St. Francis Dr., Santa Fe, NM 87505

State of New Mexico
Energy Minerals and Natural Resources

Form C-144
March 12, 2004

Oil Conservation Division
1220 South St. Francis Dr.
Santa Fe, NM 87505

For drilling and production facilities, submit to
appropriate NMOCD District Office.
For downstream facilities, submit to Santa Fe
office

Pit or Below-Grade Tank Registration or Closure

Is pit or below-grade tank covered by a "general plan"? Yes ☒ No ☐

Type of action: Registration of a pit or below-grade tank ☒ Closure of a pit or below-grade tank ☐

Operator: Occidental U.S.A. W.T.P. Limited Partnership Telephone: 432.685.5719 e-mail address: Don_Thompson2@oxy.com

Address: P.O. Box 50250, Midland, TX 79710

Facility or well name: Oxy Elizando "A" No. 7 API # 30015-34149 U/L or Qtr/Qtr SESE Sec 21 T 21 S R 27 E

County: Eddy Latitude 32°27'45.47" N Longitude 104°12'16.67" W NAD: 1927 ☒ 1983 ☐ Surface Owner Federal ☐ State ☐ Private ☒ Indian ☐

Pit

Type: Drilling ☒ Production ☐ Disposal ☐

Workover ☐ Emergency ☐

Lined ☒ Unlined ☐

Liner type: Synthetic ☒ Thickness 12 mil Clay ☐ Volume
11,000 bbl

Below-grade tank

Volume: bbl Type of fluid:

Construction material:

Double-walled, with leak detection? Yes ☐ If not, explain why not.

Depth to ground water (vertical distance from bottom of pit to seasonal high
water elevation of ground water.)

Less than 50 feet

(20 points)

50 feet or more, but less than 100 feet

(10 points) 10

100 feet or more

(0 points)

Wellhead protection area: (Less than 200 feet from a private domestic
water source, or less than 1000 feet from all other water sources.)

Yes

(20 points)

No

(0 points) 0

Distance to surface water: (horizontal distance to all wetlands, playas,
irrigation canals, ditches, and perennial and ephemeral watercourses.)

Less than 200 feet

(20 points)

200 feet or more, but less than 1000 feet

(10 points)

1000 feet or more

(0 points) 0

Ranking Score (Total Points)

Total 10

If this is a pit closure: (1) attach a diagram of the facility showing the pit's relationship to other equipment and tanks. (2) Indicate disposal location:

onsite ☐ offsite ☐ If offsite, name of facility (3) Attach a general description of remedial action taken including remediation start date and end
date. (4) Groundwater encountered: No ☐ Yes ☐ If yes, show depth below ground surface ft. and attach sample results. (5) Attach soil sample results and a
diagram of sample locations and excavations.

I hereby certify that the information above is true and complete to the best of my knowledge and belief. I further certify that the above-described pit or below-grade tank has
been/will be constructed or closed according to NMOCD guidelines ☒, a general permit ☐, or an (attached) alternative OCD-approved plan ☐.

Date: 1/19/05

Printed Name/Title Don Thompson/HES Spec.

Signature

Don Thompson

Your certification and NMOCD approval of this application/closure does not relieve the operator of liability should the contents of the pit or tank contaminate ground water or
otherwise endanger public health or the environment. Nor does it relieve the operator of its responsibility for compliance with any other federal, state, or local laws and/or
regulations.

Approval:

Date:

Printed Name/Title

MAR 10 2005

Signature

[Signature]

UNITED STATES
DEPARTMENT OF THE INTERIOR
BUREAU OF LAND MANAGEMENTFORM APPROVED
OMB NO. 1004-0135
Expires: November 30, 2000

SUNDRY NOTICES AND REPORTS ON WELLS

Do not use this form for proposals to drill or to re-enter an abandoned well. Use Form 3160-3 (APD) for such proposals.

SUBMIT IN TRIPLICATE - Other instructions on reverse side

1. Type of Well

☐ Oil Well ☒ Gas Well ☐ Other

2. Name of Operator

OXY USA WTP Limited Partnership

192463

3a. Address

P.O. Box 50250, Midland, TX 79710-0250

3b. Phone No. (include area code)

432-685-5717

4. Location of Well (Footage, Sec., T., R., M., or Survey Description)

1980 FSL 660 FEL NESE(I) Sec 21 T21S R27E

5. Lease Serial No.

NM29271 Nm0354232

6. If Indian, Allottee or Tribe Name

7. If Unit or CA/Agreement, Name and/or No.

8. Well Name and No.

Elizando A Federal #7

9. API Well No.

30-015-

10. Field and Pool, or Exploratory Area

Burton Flat Morrow

11. County or Parish, State

Eddy NM

12. CHECK APPROPRIATE BOX(ES) TO INDICATE NATURE OF NOTICE, REPORT, OR OTHER DATA

TYPE OF SUBMISSION	TYPE OF ACTION			
<input checked="" type="checkbox"/> Notice of Intent	<input type="checkbox"/> Acidize	<input type="checkbox"/> Deepen	<input type="checkbox"/> Production (Start/Resume)	<input type="checkbox"/> Water Shut-Off
<input type="checkbox"/> Subsequent Report	<input type="checkbox"/> Alter Casing	<input type="checkbox"/> Fracture Treat	<input type="checkbox"/> Reclamation	<input type="checkbox"/> Well Integrity
<input type="checkbox"/> Final Abandonment Notice	<input type="checkbox"/> Casing Repair	<input type="checkbox"/> New Construction	<input type="checkbox"/> Recomplete	<input checked="" type="checkbox"/> Other <u>Move</u>
	<input type="checkbox"/> Change Plans	<input type="checkbox"/> Plug and Abandon	<input type="checkbox"/> Temporarily Abandon	<u>Surface Location</u>
	<input type="checkbox"/> Convert to Injection	<input type="checkbox"/> Plug Back	<input type="checkbox"/> Water Disposal	

13. Describe Proposed or Completed Operation (clearly state all pertinent details, including estimated starting date of any proposed work and approximate duration thereof. If the proposal is to deepen directionally or recomple horizontally, give subsurface locations and measured and true vertical depths of all pertinent markers and zones. Attach the Bond under which the work will be performed or provide the Bond No. on file with BLM/BIA. Required subsequent reports shall be filed within 30 days following completion of the involved operations. If the operation results in a multiple completion or recomple in a new interval, a Form 3160-4 shall be filed once testing has been completed. Final Abandonment Notices shall be filed only after all requirements, including reclamation, have been completed, and the operator has determined that the final site is ready for final inspection.)

Per BLM Request the surface location was moved. Please see attached for an amended C-102 plat and Exhibit's B.

New Location: 1980 FSL 660 FEL NESE(I) Sec 21 T21S R27E

Old Location: 1650 FSL 660 FEL NESE(I) Sec 21 T21S R27E

14. I hereby certify that the foregoing is true and correct
Name (Printed/Typed)

David Stewart

Title

Sr. Regulatory Analyst

Date

4/19/05

THIS SPACE FOR FEDERAL OR STATE OFFICE USE

Approved by

/s/ Joe G. Lara

Title

ACTING FIELD MANAGER

Date

JUN - 1 2005

Conditions of approval, if any, are attached. Approval of this notice does not warrant or certify that the applicant holds legal or equitable title to those rights in the subject lease which would entitle the applicant to conduct operations thereon.

Office

CARLSBAD FIELD OFFICE

Title 18 U.S.C. Section 1001, and Title 43 U.S.C. Section 1212, makes it a crime for any person knowingly and willfully to make to any department or agency of the United States any false, fictitious or fraudulent statements or representations as to any matter within its jurisdiction.

DISTRICT I
1025 N. FRENCH DR., ROOBS, NM 88240

State of New Mexico
Energy, Minerals and Natural Resources Department

DISTRICT II
1301 W. GRAND AVENUE, ARTESIA, NM 88210

DISTRICT III
1000 Rio Brazos Rd., Aztec, NM 87410

DISTRICT IV
1220 S. ST. FRANCIS DR., SANTA FE, NM 87505

OIL CONSERVATION DIVISION
1220 SOUTH ST. FRANCIS DR.
Santa Fe, New Mexico 87505

Form C-102
Revised JUNE 10, 2003
Submit to Appropriate District Office
State Lease - 4 Copies
Fee Lease - 3 Copies

WELL LOCATION AND ACREAGE DEDICATION PLAT

AMENDED REPORT

API Number 30-015-	Pool Code 73 280	Pool Name Butan Flat Morrow
Property Code	Property Name ELIZANDO A Federal	Well Number 7
OGRID No. 192463	Operator Name OXY U.S.A. W.T.P., LP	Elevation 3226'

Surface Location

UL or lot No.	Section	Township	Range	Lot Idn	Feet from the	North/South line	Feet from the	East/West line	County
1	21	21-S	27-E		1980	SOUTH	660	EAST	EDDY

Bottom Hole Location If Different From Surface

UL or lot No.	Section	Township	Range	Lot Idn	Feet from the	North/South line	Feet from the	East/West line	County
Dedicated Acres 320	Joint or Infill Y	Consolidation Code	Order No.						

NO ALLOWABLE WILL BE ASSIGNED TO THIS COMPLETION UNTIL ALL INTERESTS HAVE BEEN CONSOLIDATED
OR A NON-STANDARD UNIT HAS BEEN APPROVED BY THE DIVISION

<div><p>GEODETIC COORDINATES NAD 27 NME</p><p>Y=532379.0 N X=544834.0 E</p><p>LAT.=32°27'48.74" N LONG.=104°11'16.69" W</p><p>2-21160 24-21337 2847' 660' 1980'</p></div>	<div><p>OPERATOR CERTIFICATION</p><p>I hereby certify the the information contained herein is true and complete to the best of my knowledge and belief.</p><p>Signature <i>David Stewart</i> Printed Name David Stewart Title Sp. Res. Analyst Date 4/19/05</p><p>SURVEYOR CERTIFICATION</p><p>I hereby certify that the well location shown on this plat was plotted from field notes of actual surveys made by me or under my supervision, and that the same is true and correct to the best of my belief.</p><p>MARCH 22, 2005</p><p>Date Surveyed Signature of Gary Edson Professional Surveyor NEW MEXICO GARY EDSON 05.11.0493 Certificate No. GARY EDSON 12641</p></div>
---	--

SECTION 21, TOWNSHIP 21 SOUTH, RANGE 27 EAST, N.M.P.M.,

EDDY COUNTY,

NEW MEXICO

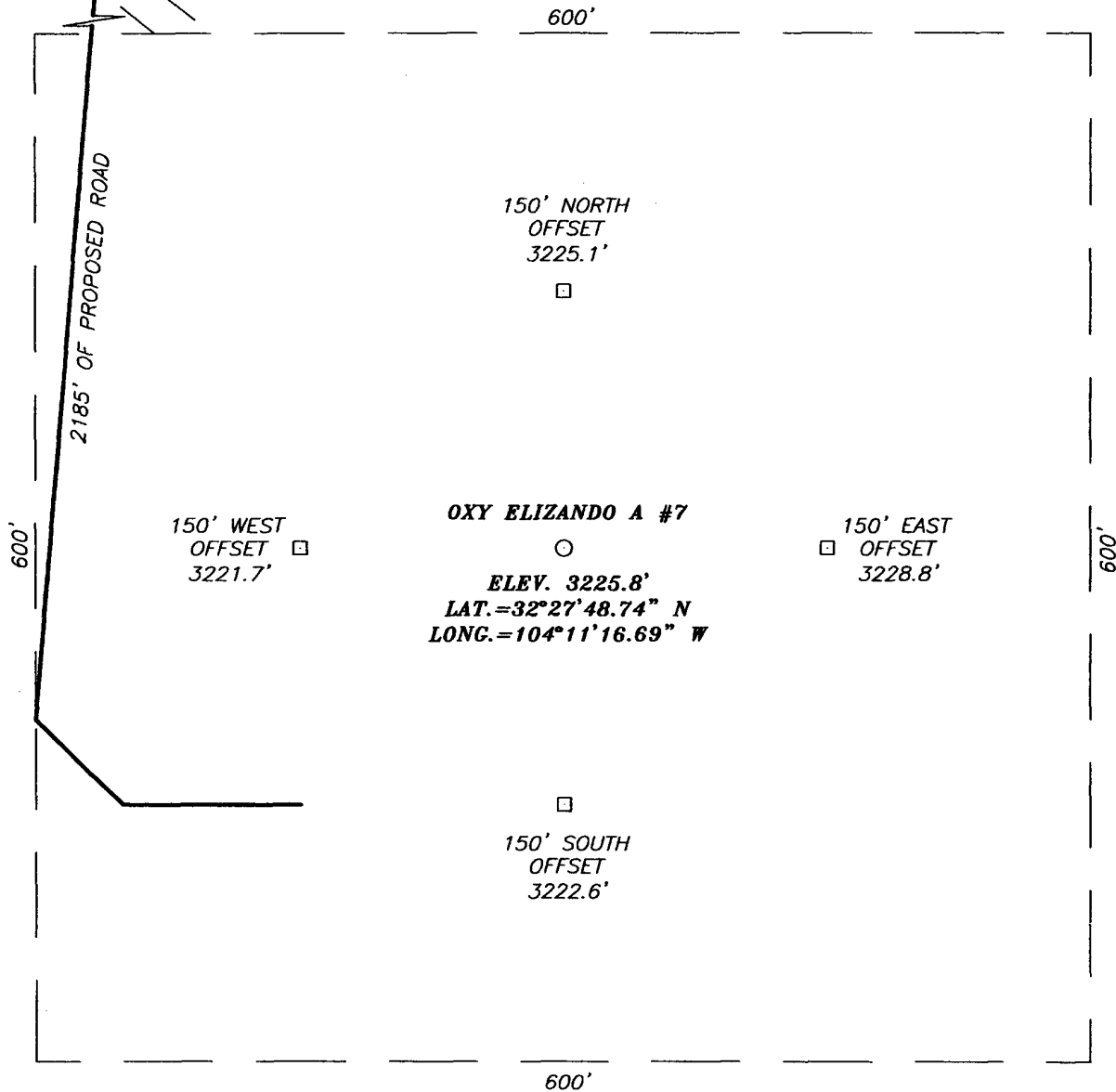

DIRECTIONS TO LOCATION

FROM THE INTERSECTION OF U.S. HWY 62-180 AND N.M. STATE ROAD #200 (RELIEF ROUTE) GO NORTH AND THEN WEST ON RELIEF ROUTE APPROX. 2.8 MILES. TURN LEFT AND GO THRU CATTLEGUARD. ROAD TURNS LEFT (EAST) AND GOES APPROX. 0.25 MILES. BEND RIGHT AND GO SE APPROX. 0.4 MILES TO A PROPOSED ROAD SURVEY. FOLLOW PROPOSED ROAD SURVEY SOUTH FOR APPROX. 1300' TO THIS LOCATION.

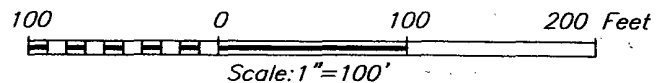

OXY U.S.A. W.T.P., LP

OXY ELIZANDO A #7 WELL
LOCATED 1980 FEET FROM THE SOUTH LINE
AND 660 FEET FROM THE EAST LINE OF SECTION 21,
TOWNSHIP 21 SOUTH, RANGE 27 EAST, N.M.P.M.,
EDDY COUNTY, NEW MEXICO.

Survey Date: 3/22/05	Sheet 1 of 1 Sheets
W.O. Number: 05.11.0493	Dr By: J.R.
Date: 3/29/05	Rev 1: N/A
Disk: CD#5	05110493
Scale: 1"=100'	

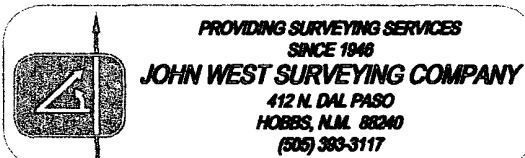

VICINITY MAP

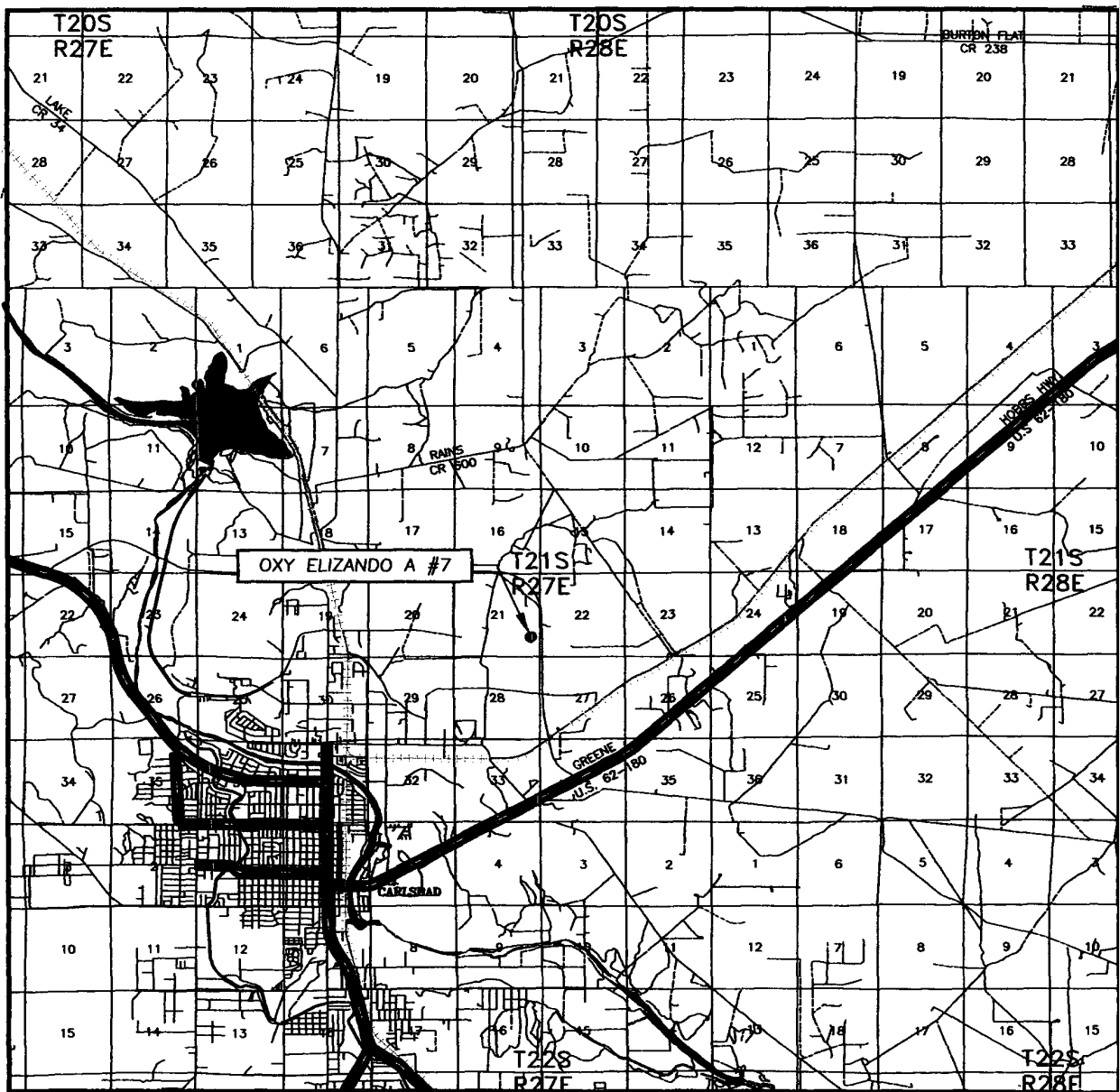

SCALE: 1" = 2 MILES

SEC. 21 TWP. 21-S RGE. 27-E

SURVEY N.M.P.M.

COUNTY EDDY

DESCRIPTION 1980' FSL & 660' FEL

ELEVATION 3226'

OPERATOR OXY U.S.A. W.T.P., LP

LEASE OXY ELIZANDO A

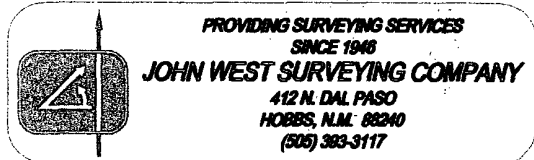

LOCATION VERIFICATION MAP

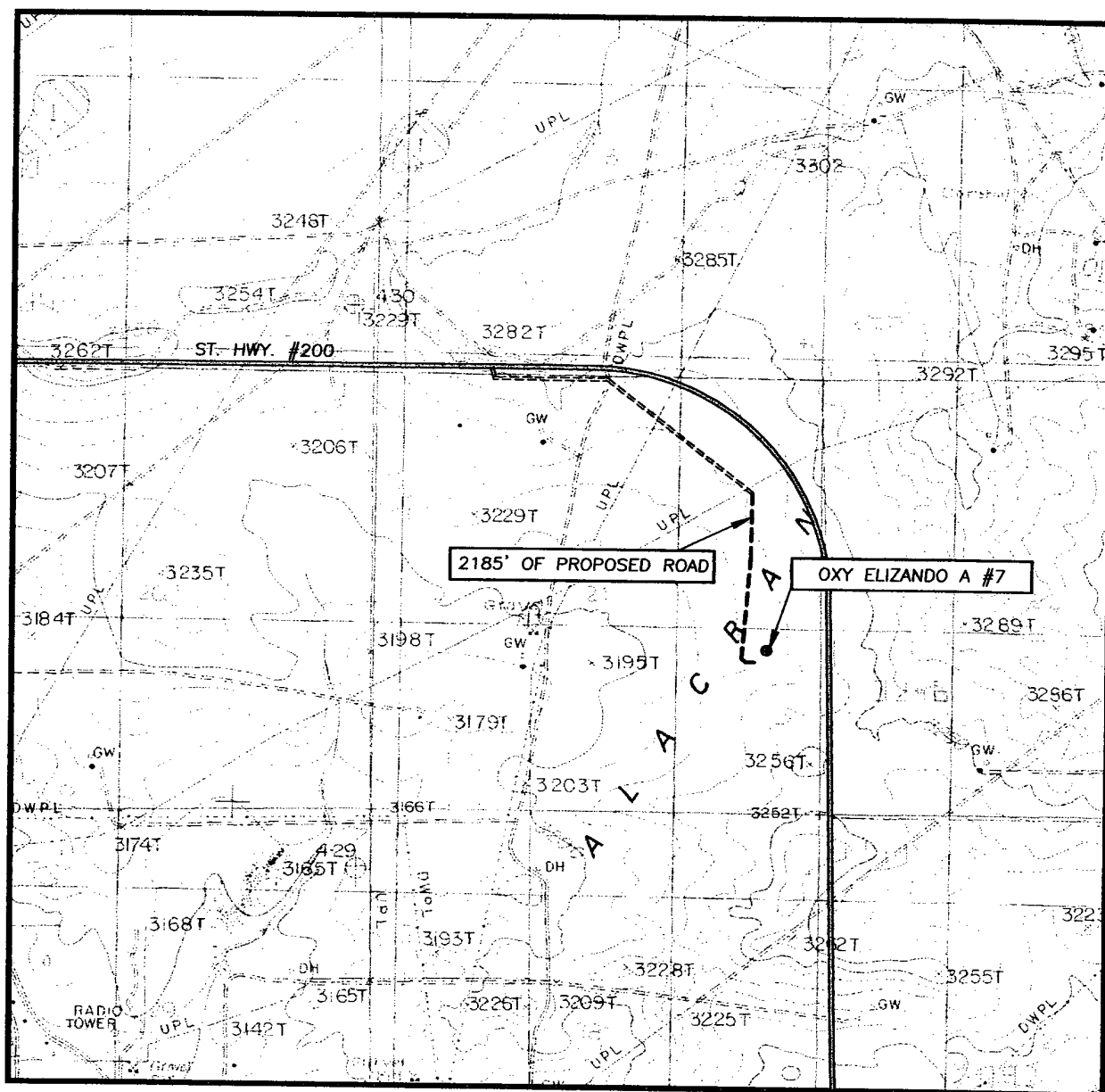

SCALE: 1" = 2000'

CONTOUR INTERVAL:
CARLSBAD EAST, N.M. - 10'

SEC. 21 TWP. 21-S RGE. 27-E

SURVEY N.M.P.M.

COUNTY EDDY

DESCRIPTION 1980' FSL & 660' FEL

ELEVATION 3226'

OPERATOR OXY U.S.A. W.T.P., LP

LEASE OXY ELIZANDO A

U.S.G.S. TOPOGRAPHIC MAP
CARLSBAD EAST, N.M.

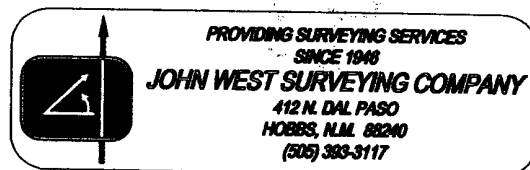
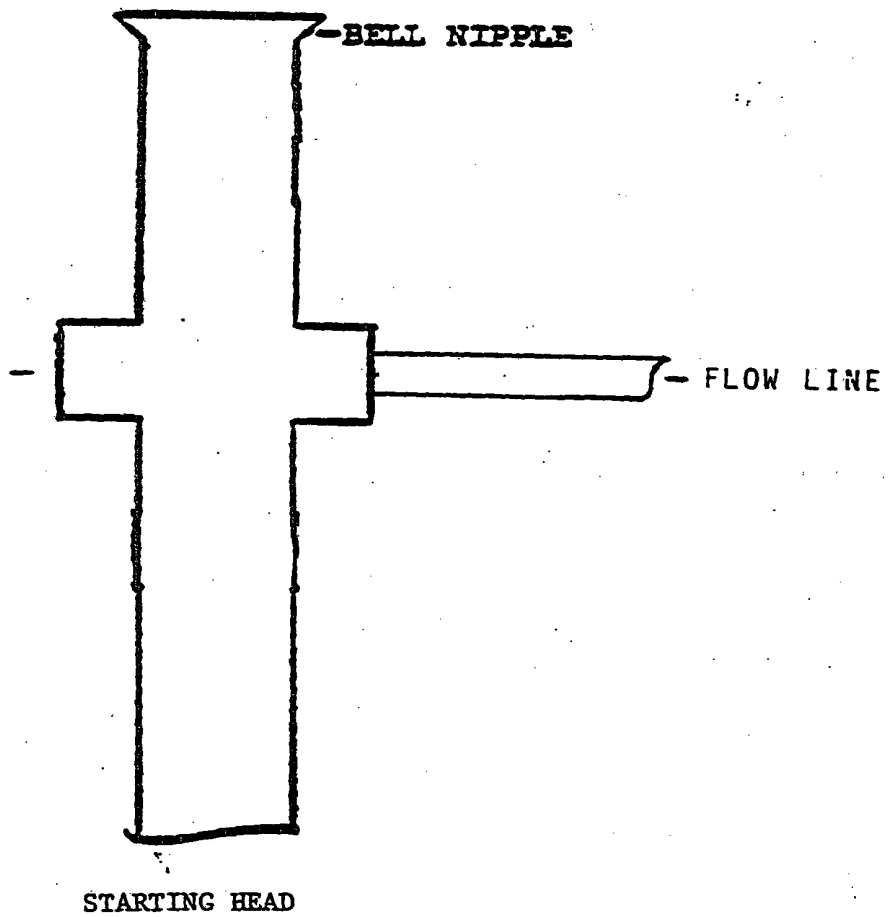

EXHIBIT A

ANNULAR PREVENTOR
TO BE USED AS DIVERTOR ONLY



BLOWOUT PREVENTOR SCHEME

EXHIBIT A

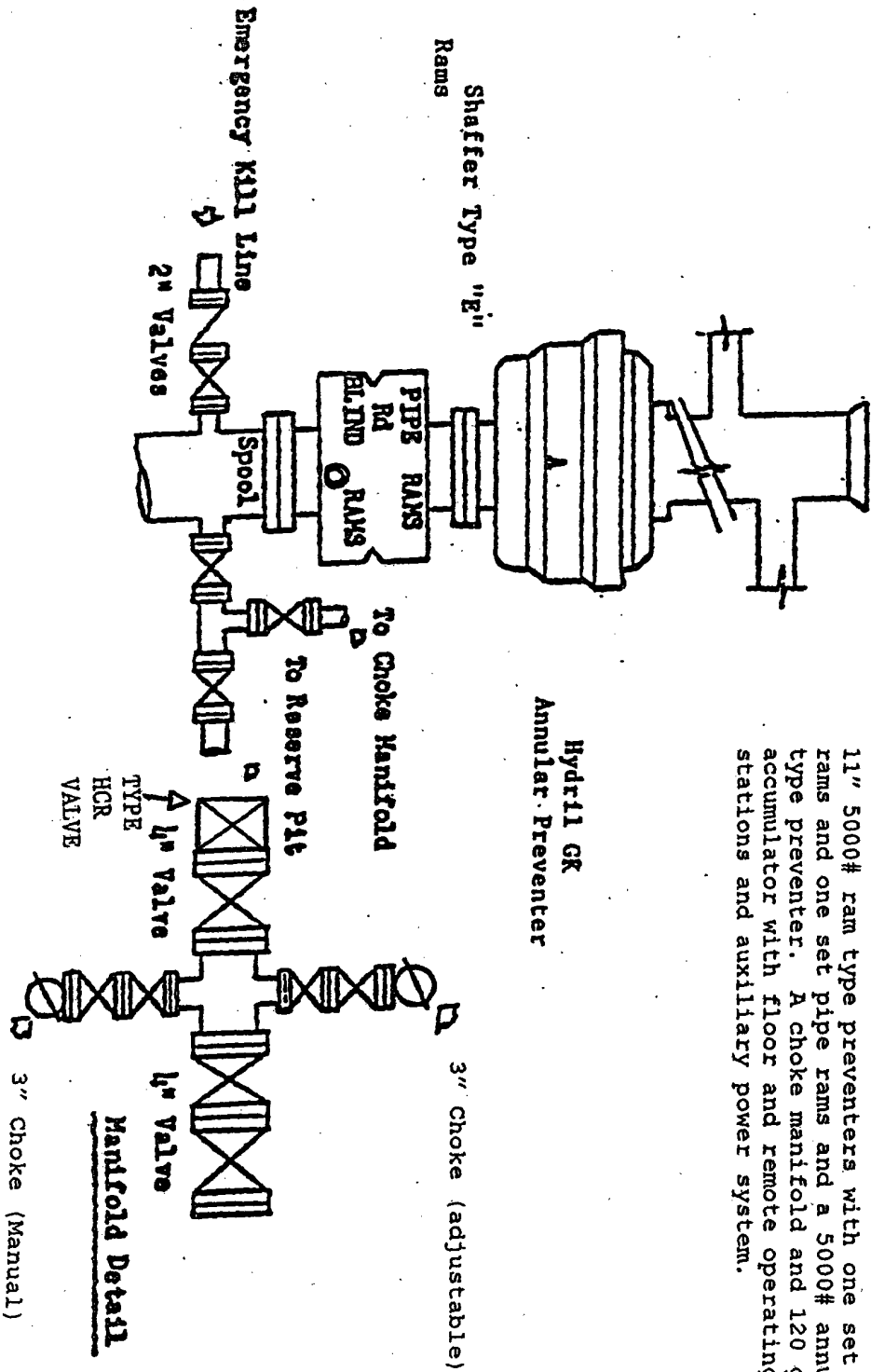

11" 5000# ram type preventers with one set blind rams and one set pipe rams and a 5000# annular type preventer. A choke manifold and 120 gallon accumulator with floor and remote operating stations and auxiliary power system.

Multi-Point Surface Use and Operations Plan

Elizando A Federal #7

Page 4

- H. The well site, if a producer, will be maintained and kept clean of all trash and litter which detracts from the surrounding environment. Equipment will be maintained in accordance with good operating practice.
- I. After the wellsite is cleaned and pits and sumps backfilled, any obstruction to the natural drainage will be corrected by ditching or terracing. All disturbed areas, including any access road no longer needed, will be ripped. Those areas will be reseeded with grass if, in the opinion of the land owner, it is required.

13. Operator's Representatives and Certification

The field representative responsible for assuring compliance with the approved surface use and operations plan are as follows:

John Erickson
Production Coordinator
P.O. Box 69
Hobbs, New Mexico 88240
Office Phone: 505-393-2174
Cellular: 505-390-6426

Joe Fleming
Drilling Coordinator
P.O. Box 50250
Midland, TX 79710-0250
Office Phone: 915-685-5858

Calvin C. (Dusty) Weaver
Operation Specialist
P.O. Box 2000
Levelland, TX 79336
Office Phone: 806-229-9467
Cellular: 806-893-3067

Terry Asel
Operation Specialist
1017 W. Stanolind Rd.
Hobbs, NM 88240
Office Phone: 505-397-8217
Cellular: 505-631-0393

I hereby certify that I, or persons under my direct supervision, have inspected the proposed drill site and access route; that I am familiar with the conditions which presently exist; that the statements made in this plan are, to the best of my knowledge, true and correct; and, that the work associated with the operations proposed herein will be performed by OXY USA WTP Limited Partnership and its contractors and sub-contractors in conformity with this plan and the terms and conditions under which it is approved.

3/8/2005

DATE

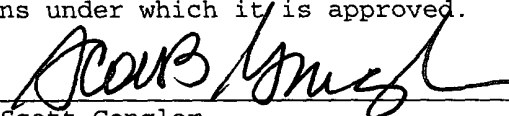

Scott Gengler
Engineering Advisor
432-685-5825
South Permian Asset Team
OXY USA WTP Limited Partnership

EDDY COUNTY.

NEW MEXICO

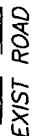

FROM THE INTERSECTION OF HWY U.S. 62-180 AND N.M. STATE ROAD #200 (RELIEF ROUTE) GO NORTH ON RELIEF ROUTE FOR 1 MILE TO CALICHE ROAD ON THE LEFT, TURN LEFT (WEST) AND GO 0.6 MILES TO INTERSECTION, TURN NORTH AND GO N/NW 0.6 MILES TO PROPOSED ROAD SURVEY. FOLLOW ROAD SURVEY FOR 2507' EAST AND 251' NORTH TO THIS LOCATION.



OXY ELIZANDO "A" #7 WELL
LOCATED 1650 FEET FROM THE SOUTH LINE
AND 660 FEET FROM THE EAST LINE OF SECTION 21,
TOWNSHIP 21 SOUTH, RANGE 27 EAST, N.M.P.M.,
EDDY COUNTY, NEW MEXICO.



**PROVIDING SURVEYING SERVICES
SINCE 1946**

JOHN WEST SURVEYING COMPANY

**412 N. DAL PASO
HOBBS, N.M. 88240
(505) 393-3117**

Survey Date: 06/14/04		Sheet 1 of 1 Sheets	
W.O. Number: 04.11.0694		Dr By: J. RIVERO	Rev 1:N/A
Date: 06/17/04	Disk: CD#10	04110694	Scale: 1"=100'

**OXY USA WTP
Limited Partnership
PO Box 50250
Midland, TX 79710**

**Hydrogen Sulfide (H₂S)
Contingency Plan**

For

**Elizando "A" No. 7
1650 ft. FSL, 660 ft. FEL
Sec 21, T21S, R27E
Eddy County, NM**

And

McVay Drilling Co., Rig No. 8

TABLE OF CONTENTS

<u>ITEM</u>	<u>PAGE</u>
PREFACE	3
LOCATION MAP.....	4
RIG SKETCH.....	5
EMERGENCY RESPONSE ACTIVATION AND GENERAL RESPONSIBILITIES	6
SPECIFIC EMERGENCY GUIDANCE	
- H2S Release	8
- Well Control	10
PUBLIC RELATIONS	13
PHONE CONTACTS – OP DOWNHOLE SERVICES GROUP	14
EMERGENCY PERSONELL NOTIFICATION NUMBERS.....	13
PHONE CONTACTS – OP PRODUCTION AND PLANT PERSONNEL	15
PHONE CONTACTS – OP HES PERSONNEL	16

PREFACE

An effective and viable Contingency Plan is intended to provide prior planning and guidance in responding to emergency incidents. The primary considerations in its development are protection of personnel, the public, company and public property, and the environment.

Although the plan addresses varied emergency situations which may occur, it recognizes that flexibility and the use of the organization's knowledge and experience is critical to safe resolution of emergency incidents. Response actions outlined in the plan provide a framework, which may be placed into operation without confusion. These actions should promote quick and decisive actions during the critical initial period and immediately following an emergency. As the response progresses, additional guidelines and procedures may need to be implemented as the situation dictates. In addition, all emergency incidents must be properly reported per the Oxy Incident Reporting and Notification Policy, state and federal requirements, etc.

This Contingency Plan is intended for use on Oxy Downhole Services Group projects and the operations within their area of responsibility, such as drilling, critical well work, etc.

Elizando A No. 7
LAT. - 32°27'45.47"
LONG. - 104°12'16.67"W
Y = 532049.0 N
X = 544835.7 E

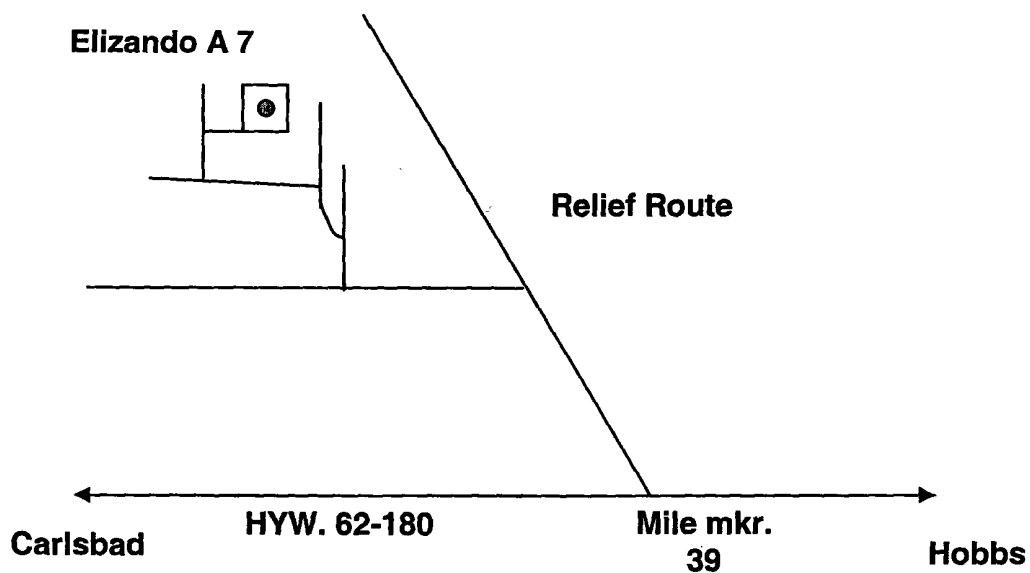
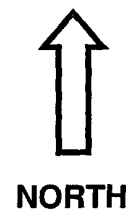

From the intersection of US Hwy. 62-180 and the Carlsbad Relief Route go north-northwest approx. 1 mile and turn left onto a 20' wide caliche road. Go west approx. 0.66 of a mile and turn right at road intersection. Go north 0.6 then turn east and proceed for 0.5 miles

McVay Rig 8

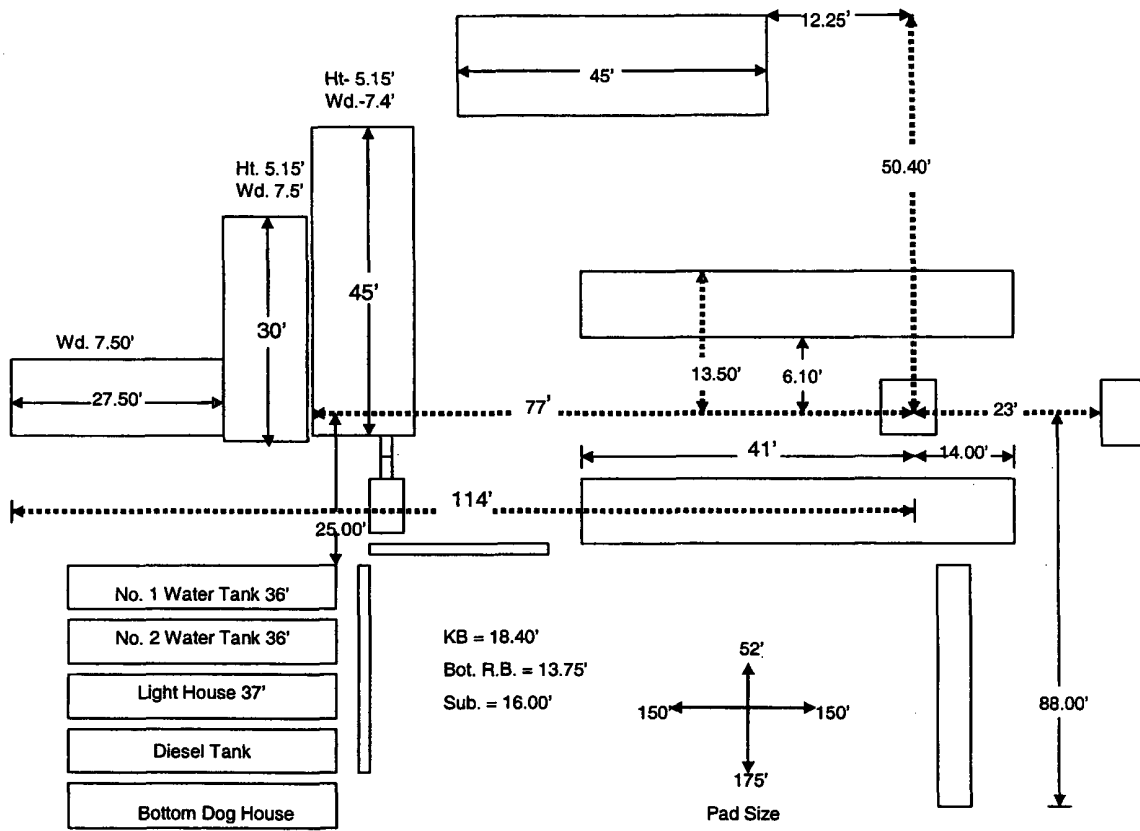

EMERGENCY RESPONSE ACTIVATION AND GENERAL RESPONSIBILITIES

Activation of the Emergency Action Plan

- A. In the event of any emergency situation, all personnel on location should first ensure that the following items are initiated. After that, they should refer to the appropriate Specific Emergency Guidance sections on pages ten (10) through twelve (12) in this document for further responsibilities:
 - 1. Notify the senior ranking contract representative on site.
 - 2. Notify Oxy representative in charge.
 - 3. Notify civil authorities if the Oxy Representative can not be contacted and the situation dictates.
 - 4. Perform rescue and first aid as required (without jeopardizing additional personnel).

General Responsibilities

Oxy Permian Personnel:

- A. Operations Specialist: The Oxy Drilling/Critical Well Servicing Operations Specialist or contract personnel serving in that capacity will serve as Operations Chief Officer for all emergency incidents. The Operations Chief Officer is responsible for:
 - 1. Notification to the Downhole Services Team Leader of the incident occurrence.
 - 2. Notification to the local RMT/PMT leader of the incident occurrence, and the need for the designated local RMT/PMT Incident Commander to act in that capacity for the response effort.
 - 3. Sole control of all tactical activities directed toward reducing the immediate hazard, establishing situational control and restoring the operations to a non-emergency state.
- B. Local RMT/PMT Designated Incident Commander: The Oxy local RMT/PMT Designated Incident Commander will serve as the overall Incident Commander for the drilling or critical well servicing emergency incident. The Incident Commander is responsible for:
 - 1. Coordinating with the Downhole Services Team Leader for notification to the Oxy Crisis Management team of the incident occurrence.
 - 2. Establishing and managing the overall incident command structure and response from inception through restoration of normal activities in the area.
- C. Downhole Services HES Tech: The Downhole Services HES Tech (or his designate) is responsible for reporting to the incident as soon as reasonably possible, to provide support to the response effort as required by the Operations Chief Officer or the Incident Commander.

Contract Drilling Personnel will immediately report to their assigned stations and perform their duties as outlined in the appropriate Specific Emergency Guidance sections on pages ten (10) through twelve (12) in this document.

Other Contractor Personnel will report to the safe briefing area to assist Oxy personnel and civil authorities as requested when it is safe to do so and if they have been adequately trained in their assigned duties.

Civil Authorities (Law Enforcement, Fire, and EMS) will be responsible for:

1. Establishing membership in the Unified Incident Command.
2. As directed by the Incident Commander and the Unified Command, control site access, re-route traffic, and provide escort services for response personnel.
3. Perform all fire control activities in coordination with the Unified Command.
4. Initiate public evacuation plans as instructed by the Incident Commander.
5. Perform rescue or recovery activities with coordination from the Unified Command.
6. Provide medical assistance as dictated by the situation at hand.

H2S RELEASE

The following procedures and responsibilities will be implemented on activation of the H2S siren and lights.

All Personnel:

1. On alarm, don escape unit (if available) and report to upwind briefing area.

Rig Manager/Tool Pusher:

1. Check that all personnel are accounted for and their condition.
2. Administer or arrange for first aid treatment, and /or call EMTs as needed.
3. Identify two people best suited to secure well and perform rescue, and instruct them to don SCBA.
4. Notify Contractor management and Oxy Representative.
5. Remain at the briefing area, assess and monitor personnel and overall situation for hazards or conditions that might warrant a change in the action plan.

Two People Responsible For Shut-in and Rescue:

1. Don SCBA and acquire tools to secure well and perform rescue, i.e., wrenches, retrieval ropes, etc.
2. Utilize the buddy system to secure well and perform rescue(s).
3. Return to the briefing area and stand by for further instructions.

All Other Personnel:

1. Isolate the area and prevent entry by other persons into the 100 ppm ROE. Additionally the first responder(s) must evacuate any public places encompassed by the 100 ppm ROE. First responder(s) must take care not to injure themselves during this operation. Company and/or local officials must be contacted to aid in this operation. Evacuation of the public should be beyond the 100 ppm ROE.

Oxy Representative:

1. Remain at the briefing area, assess and monitor personnel and overall situation for hazards or conditions that might warrant a change in the action plan.
2. Notify Operation Specialists or Team Leader and RMT Leader or Local Incident Commander, and Police, Fire Department, or other local emergency services as required.

Training

All responders must have training in the detection of H2Sm measures for protection against the gas, equipment used for protection and emergency response. Weekly drills by all crews will be conducted and recorded in the IADC daily log. Additionally, responders must be equipped with H2S monitors at all times

Ignition of Gas Source

Should control of the well be considered lost and ignition considered, take care to protect against exposure to Sulfur Dioxide (SO₂). Intentional ignition must be coordinated with the NMOCD and local officials. Additionally the NM State Police shall be the Incident Command of any major release.

Characteristics of H₂S and SO₂

Common Name	Chemical Formula	Specific Gravity	Threshold Limit	Hazardous Limit	Lethal Concentration
Hydrogen Sulfide	H ₂ S	1.189 Air = 1	10 ppm	100 ppm	600 ppm
Sulfur Dioxide	SO ₂	2.21 Air = 1	2 ppm	N/A	1000 ppm

Contacting Authorities

Oxy Permian personnel must liaison with local and state agencies to ensure a proper response to a major release. Additionally, the OCD must be notified of the release as soon as possible but no later than 4 hours. Agencies will ask for information such type and volume of release, wind direction, location of release, etc. Be prepared with all information available. The following call list of essential and potential responders has been prepared for use during a release. This response plan must be in coordination with the State of New Mexico's 'Hazardous Materials Emergency Response Plan' (HMER).

WELL CONTROL

The following procedures will be implemented when a loss of primary control is indicated. Indicators of loss of primary control are flow from the well, an increase in pit volume, or when the drilling fluid used to fill the hole on trips is less than the calculated pipe displacement volume. The emergency signal for well control procedures will be a single long blast of the rig air horn.

Kick While Drilling - Procedures And Responsibilities

Driller:

1. Stop the rotary and hoist the kelly above the rotary table.
2. Stop the mud pump(s).
3. Check for flow.
4. If flowing, sound the alarm immediately.
5. Ensure that all crew members fill their responsibilities to secure the well.
6. Record drill pipe and casing shut-in pressures and pit volume increase and begin kill sheet.

Derrickman:

1. Go to BOP/choke manifold area.
2. Open choke line valve on BOP.
3. Signal to Floorman #1 that the choke line is open.
4. Close chokes after annular or pipe rams are closed.
5. Record shut-in casing pressure and pit volume increase.
6. Report readings and observations to Driller.
7. Verify actual mud weight in suction pit and report to Driller.
8. Be readily available as required for additional tasks.

Floorman # 1:

1. Go to accumulator control station and await signal from Derrickman.
2. Close annular preventer and HCR on signal (if available, if not then close pipe rams).
3. Record accumulator pressures and check for leaks in the BOP or accumulator system.
4. Report to Driller, and be readily available as required for additional tasks.

Floorman # 2:

1. Start water on motor exhausts.
2. Notify Contractor Tool Pusher or Rig Manager of well control situation.
3. Check location for ignition sources and extinguish or turn off, and stop any welding in progress.
4. Report to Driller, and be readily available as required for additional tasks.

Floorman # 3:

1. Stand-by with Driller, and be readily available as required for additional tasks.

Tool Pusher/Rig Manager:

1. Notify Oxy Representative and report to rig floor.
2. Review and verify all pertinent information.
3. Communicate information to Oxy Representative, and confer on an action plan.
4. Finalize well control worksheets, calculations and preparatory work for action plan.
5. Initiate and ensure the action plan is carried out.
6. Communicate any changes in well or site conditions, or any indications that the action plan needs to be revised to the Oxy representative.

Oxy Representative:

1. Notify Operation Specialists or Team Leader and RMT Leader or Local Incident Commander, and Police, Fire Department, or other local emergency services as required.

Kick While Tripping - Procedures and Responsibilities

Driller:

1. Sound the alarm immediately when pipe displacement volume is less than 75% of calculated.
2. Position the upper tool joint just above rotary table and set slips.
3. Check for flow.
4. Ensure that all crew members fill their responsibilities to secure the well.
5. Record drill pipe and casing shut-in pressures and pit volume increase, and begin kill sheets.

Derrickman: (same as while drilling)

Floor Man # 1:

1. Install full opening valve (with help from Floorman #2) in top drill string connection.
2. Tighten valve with make up tongs.
3. Go to accumulator control station and await signal from Derrickman.
4. Close annular preventer and HCR valve on signal (if available, if not then close pipe rams).
5. Record accumulator pressures and check for leaks in the BOP and accumulator system.
6. Report to Driller, and be readily available as required for additional tasks.

Floor Man # 2:

1. Assist installing full opening valve in drill string.
2. Position back-up tongs for valve make-up.
3. Start water on motor exhausts.
4. Notify Contractor Tool Pusher or Rig Manager of well control situation.
5. Check location for ignition sources and extinguish or turn off, and stop any welding in progress.
6. Report to Driller, and be readily available as required for additional tasks.

Floorman # 3, Rig Manager/Tool Pusher, and Oxy Representative: (same as while drilling)

PUBLIC RELATIONS

Oxy recognizes that the news media have a legitimate interest in incidents at Oxy facilities that could affect the public. It is to the company's benefit to cooperate with the news media when incidents occur because these media are our best liaison with the public.

Our objective is to see that all reports of any emergency are factual and represent the company's position fairly and accurately. Cooperation with news media representatives is the most reliable guarantee that this objective will be met.

All contract and Oxy employees are instructed **NOT** to make any statement to the media concerning the emergency incident. If a media representative contacts any employee, they should refer them to the designated Emergency Command Center where they should contact the Incident Commander or his designated relief for any information concerning the incident.

OXY PERMIAN DOWNHOLE SERVICES GROUP

	LOCATION	OFFICE	HOME	CELL	PAGER
<i>Manager Operations Support</i>					
Hardesty, Steve	Midland	432-685-5880	432/694-6441	713-560-8095	
<i>Team Leader</i>					
Pennington, Randy	Midland	432-685-5684	432/689-7642	432-556-0207	713-312-8186
			Toledo Bend =	318-590-2349	
<i>Operations Specialists</i>					
Fleming, Joe	Midland	432-685-5858	432/699-0875	432-425-6075	432-498-3281
Ray, Fred	Midland	432-685-5683	432/362-2857	432-661-3893	432-499-3432
<i>HES Tech</i>					
Thompson, Don	Midland	432-685-5719	432/684-3900	432-556-1505	

Emergency Notification Numbers

Public Authorities		
New Mexico State Police	Artesia	505/746-2704
New Mexico State Police	Carlsbad	505/885-3137
New Mexico State Police	Hobbs	505/392-5588
Eddy County Sheriff's Office	Artesia	505/746-2704
Eddy County Sheriff's Office	Carlsbad	505/887-7551
Lea County Sheriff's Office	Hobbs	505/393-2515
Local Emergency Planning Center	Eddy County	505/887-9511
Local Emergency Planning Center	Lea County	505/397-9231
New Mexico Oil & Gas Commission	Artesia	505/748-1283
New Mexico Oil & Gas Commission	Hobbs	505/393-6161
NM Emergency Response Center	Hobbs	505/827-9222

Emergency Services		
Fire Fighting, Rescue & Ambulance	Artesia	911
Fire Fighting, Rescue & Ambulance	Carlsbad	911
Fire Fighting, Rescue & Ambulance	Hobbs	911
Flight For Life	Lubbock	806/743-9911
Aerocare	Lubbock	806/7478923
Med Flight Air Ambulance	Albuquerque	505/842-4433

Other Emergency Services		
Boots and Coots		1/800-256-9688
Cudd Pressure Control	Midland	432/699-0139
B.J. Services	Artesia	505/746-3569
Halliburton	Artesia	505/746-2757

OXY Permian Production and Plant Personnel
OXY Permian Crisis Team Hotline Notification (713) 935-7210

PERSON	LOCATION	OFFICE	FAX	CELL	PAGER
--------	----------	--------	-----	------	-------

Asset Management-Operations Areas					
OXY Permian General Manager: Tom Menges	Houston	(281) 552-1147	(281) 552-1484	(713) 560-8038	
South Permian Asset: Matt Hyde	Midland	(432) 685-5802	(432) 685-5930	(432) 556-5016	

RMT/PMT Leaders: South Permian Asset					
Frontier RMT:	Midland				

PERSON	LOCATION	OFFICE	FAX	CELL	PAGER
Production Coordinators: S. Permian Asset					
New Mexico: John Erickson	Hobbs	(505) 393-2174	(505) 397-2671	(505) 390-6426	(505) 370-6836

OXY Permian HES Personnel
OXY Permian Crisis Team Hotline Notification (713) 935-7210

PERSON	LOCATION	OFFICE	FAX	CELL	PAGER
HES Coordinators & Area of Responsibility					
Frontier:	Midland				
HES Techs & Area of Responsibility					
Hobbs RMT: Steve Bishop	Hobbs	(505) 397-8251	(505) 397-8204	(505) 390-4784	(877) 339-1954-1118#
Frontier-New Mexico: Rick Kerby	Hobbs	(505) 393-2174	(505) 393-2671	(505) 390-8639	(505) 370-6527

OXY USA WTP Limited Partnership
P.O. Box 50250, Midland, TX 79710-0250

RECEIVED
March 1, 2005
2005 MAR 10 10:25
BUREAU OF LAND MANAGEMENT
ROSWELL, NM

United States Department of the Interior
Bureau of Land Management
Roswell District Office
2909 West Second Street
Roswell, New Mexico 88201

Re: Application for Permit to Drill
OXY USA WTP Limited Partnership
Elizando A Federal #7
Eddy County, New Mexico
Lease No. NM-0354232

Gentlemen:

OXY USA WTP Limited Partnership respectfully requests permission to drill our Elizando A Federal #7 located 1650 FSL and 660 FEL of Section 21, T21S, R27E, Eddy County, New Mexico, Federal Lease No. NM-0354232. The proposed well will be drilled to a TD of approximately 11800' (TVD). The location and work area has been staked. It is approximately 3 miles northeast of Carlsbad, New Mexico.

In accordance with requirements stipulated in Federal Onshore Oil and Gas Order No. 1 under 43 CFR 3162.1, our Application for Permission to Drill and supporting evidence is hereby submitted.

I. Application for Permit to Drill:

1. Form 3160.3, Application for Permit to Drill.
2. Form C-102 Location and Acreage Dedication Plat certified by Gary G. Eidson, Registered Land Surveyor No. 12641 in the State of New Mexico, dated June 14, 2004.
3. The elevation of the unprepared ground is 3225 feet above sea level.
4. The geologic name of the surface formation is Permian Rustler.
5. Rotary drilling equipment will be utilized to drill the well to TD 11800' (TVD), and run casing. This equipment will then be rigged down and the well will be completed with a pulling unit.
6. Proposed total depth is 11800' TVD.
7. Estimated tops of important geologic markers.

Wolfcamp	8700' TVD
Strawn	10200' TVD
Atoka	10700' TVD
Morrow	11000' TVD

8. Estimated depths at which anticipated water, oil, gas or other mineral bearing formations are expected to be encountered:

Primary Objective:	Morrow	11000' TVD
Secondary Objective:	Atoka	10700' TVD

- | | |
|-------------|--|
| 0-600' | None |
| 600-2700' | 13-3/8" 3M annular preventer, to be used as divertor only. Exhibit A |
| 2700-11800' | 11" 5000# ram type preventers with one set blind rams and one set pipe rams and a 5000# annular type preventer. A choke manifold and 120 gallon accumulator with floor and remote operating stations and auxiliary power system. Rotating head below 8000'. Exhibit A. |

A kelly cock will be installed and maintained in operable condition and a drill string safety valve in the open position will be available on the rig floor.

After setting the 9-5/8" casing, the blowout preventers and related control equipment shall be pressure tested to 5000 psi. Any equipment failing to test satisfactorily shall be repaired or replaced. Results of the BOP test will be recorded in the Driller's Log. The BOP's will be maintained ready for use until drilling operations are completed.

BOP drills will be conducted as necessary to assure that equipment is operational and each crew is properly trained to carry out emergency duties.

Accumulator shall maintain a pressure capacity reserve at all times to provide for the close-open-close sequence of the blind and pipe rams of the hydraulic preventers.

12. Mud Program:

0-600'	Fresh water/native mud. Lime for pH control (9-10). Paper for seepage. Wt. 8.7-9.2 ppg, vis 32-34 sec.
600-2700'	Fresh/*brine water. Lime for pH control (10-10.5). Paper for seepage. Wt. 8.3-9.0/10.0-10.1ppg, vis 28-29 sec. *Fresh water will be used unless chlorides in the mud system increase to 20000PPM.
2700-8000'	Fresh water. Lime for pH control (9-9.5). Paper for seepage. Wt. 8.3-8.5 ppg, vis 28-29 sec.
8000-10000'	Cut brine. Lime for pH control (10-10.5). Wt. 9.6-10.0 ppg, vis 28-29 sec.
10000-11800'	Mud up with an Duo Vis/Flo Trol system. Wt. 9.6-10.0 ppg, Vis 32-36sec, WL<10cc.

Mud system monitoring equipment with derrick floor indicators and visual/audio alarms shall be installed and operative prior to drilling into the Wolfcamp formation. This equipment will remain in use until the production casing is run and cemented. Monitoring equipment shall consist of the following:

- 1) A recording pit level indicator.
- 2) A pit volume totalizer.
- 3) A flowline sensor.

13. Testing, Logging and Coring Program:
 - A. Testing program: No DST's are anticipated.
 - B. Mud logging program: One-man unit from 6000' to TD.
 - C. Electric logging program: CNL/LDT/CAL/GR, DLL/CAL/GR.
 - D. Coring program: Possible sidewall rotary cores.
14. No abnormal temperatures, or H2S gas are anticipated. H2S Contingency Plan is attached per NMOC requirements. The highest anticipated pressure gradient would be .55psi/ft. Adequate flare lines will be installed off the mud/gas separator where gas may be flared safely.
15. Anticipated starting date is September 1, 2005. It should take approximately 30 days to drill the well and another 10 days to complete.
16. The Multi-Point Surface Use & Operation Plan is attached.
17. If the Bureau of Land Management needs additional information to evaluate this application, please advise.

Very truly yours,



David Stewart
Sr. Regulatory Analyst
OXY USA WTP LP

DRS/drs

Attachments



NEW MEXICO ENERGY, MINERALS and NATURAL RESOURCES DEPARTMENT

BILL RICHARDSON

Governor

Joanna Prukop

Cabinet Secretary

Mark E. Fesmire, P.E.

Director

Oil Conservation Division

June 13, 2005

OXY USA WTP LIMITED Partnership

P.O. Box 50250

Midland, TX 79710-0250

Attn: Mr. David Stewart or To Whom It May Concern

**RE: APPLICATION FOR PERMIT TO DRILL
ELIZANDO A FEDERAL # 7
Section 21, T21S-R27E, 1980' FSL & 660' FEL
EDDY COUNTY, NEW MEXICO**

Dear David or To Whom It May Concern,

The application for permit to drill identified above has been filed with this office will need to have the following stipulation (in part) for approval:

OXY USA WTP LIMITED Partnership is to catch mud samples from the flow line in order to determine the chloride content of the drilling mud. Samples are to be taken from @ 600' down to the intermediate casing setting depth of @ 2700'.

Results of these tests are to be submitted to our office and the Bureau of land Management.

Thank you for your assistance.

Sincerely,

Bryan G. Arrant

PES, District II Artesia NMOCD