

UNITED STATES  
DEPARTMENT OF THE INTERIOR  
BUREAU OF LAND MANAGEMENT

N.M. Oil Cons. Div-Dist. 2

FORM APPROVED  
OMB No. 1004-0135  
Expires November 30, 2000

## SUNDRY NOTICES AND REPORTS ON WELLS

Do not use this form for proposals to drill or reenter an  
abandoned well. Use Form 3160-3 (APD) for such proposals.

**SUBMIT IN TRIPLICATE - Other instructions on reverse side**

## 1. Type of Well

☐ Oil Well ☒ Gas Well ☐ Other

## 2. Name of Operator

Yates Petroleum Corporation (25575)

## 3a. Address

105 South Fourth Street, Artesia, NM 88210

## 3b. Phone No. (include area code)

(505) 748-1471

## 4. Location of Well (Footage, Sec., T., R., M., or Survey Description)

1980' FSL and 1980' FWL, Unit K  
Section 26, T5S-R24E

## 5. Lease Serial No.

NM-28297

## 6. If Indian, Allottee or Tribe Name

Not Applicable

## 7. If Unit or CA/Agreement, Name and/o

Not Applicable

## 8. Well Name and No.

Everette OO Federal #11 (12233)

## 9. API Well No.

30-005-63724

## 10. Field and Pool, or Exploratory Area

Wildcat PreCambrian

## 11. County or Parish, State

Chaves County, New Mexico

## 12. CHECK APPROPRIATE BOX(ES) TO INDICATE NATURE OF NOTICE, REPORT, OR OTHER DATA

TYPE OF SUBMISSION	TYPE OF ACTION			
<input type="checkbox"/> Notice of Intent	<input type="checkbox"/> Acidize	<input type="checkbox"/> Deepen	<input type="checkbox"/> Production (Start/Resume)	<input type="checkbox"/> Water Shut-Off
<input type="checkbox"/> Subsequent Report	<input type="checkbox"/> Alter Casing	<input type="checkbox"/> Fracture Treat	<input type="checkbox"/> Reclamation	<input type="checkbox"/> Well Integrity
<input type="checkbox"/> Final Abandonment Notice	<input type="checkbox"/> Casing Repair	<input type="checkbox"/> New Construction	<input type="checkbox"/> Recomplete	<input checked="" type="checkbox"/> Other <u>Extend</u>
	<input type="checkbox"/> Change Plans	<input type="checkbox"/> Plug and Abandon	<input type="checkbox"/> Temporarily Abandon	<u>APD</u>
	<input type="checkbox"/> Convert to Injection	<input type="checkbox"/> Plug Back	<input type="checkbox"/> Water Disposal	

13. Describe Proposed or Completed Operations (clearly state all pertinent details, including estimated starting date of any proposed work and approximate duration thereof. If the proposal is to deepen directionally or recompleat horizontally, give subsurface locations and measured and true vertical depths of all pertinent markers and zones. Attach the Bond under which the work will be performed or provide the Bond No. on file with BLM/BIA. Required subsequent reports shall be filed within 30 days following completion of the involved operations. If the operation results in a multiple completion or recompletion in a new interval, a Form 3160-4 shall be filed once Testing has been completed. Final Abandonment Notices shall be filed only after all requirements, including reclamation, have been completed, and the operator has determined that the site is ready for final inspection.)

Yates Petroleum Corporation wishes to extend the captioned well's APD expiration date for one (1) year to August 06, 2006

A drilling pit has been/will be constructed at this well site under Yates Petroleum Corporation general plan approved by the OCD. Approved C144 attached.

Sources at Yates Petroleum Corporation have relayed information to me that they believe there will not be enough H2S anticipated from the surface to the Precambrian formation to meet the OCD's minimum requirements for the submission of a contingency plan per Rule 118.

CEMENT TO COVER ALL OIL,  
GAS AND WATER BEARING  
ZONES ex- Glaciers

SEE ATTACHED FOR  
CONDITIONS OF APPROVAL

Thank you.

## 14. I hereby certify that the foregoing is true and correct

Name (Printed/Typed)

Debbie L. Caffall / debbiec@ypcnm.com

Title

Regulatory Technician / Land Department

Signature

Date

July 21, 2005

THIS SPACE FOR FEDERAL OR STATE USE

Approved by

Title

PE

Date

8/25/05

Conditions of approval, if any, are attached. Approval of this notice does not warrant or certify that the applicant holds legal or equitable title to those rights in the subject lease which would entitle the applicant to conduct operations thereon.

Office

RFO

Title 18 U.S.C. Section 1001, make it a crime for any person knowingly and willfully to make to any department or agency of the United States any false, fictitious or fraudulent statements or representations as to any matter within its jurisdiction.

(Instructions on reverse)

District I  
25 N. French Dr., Hobbs, NM 88240  
District II  
1301 W. Grand Avenue, Artesia, NM 88210  
District III  
1000 Rio Brazos Road, Aztec, NM 87410  
District IV  
1220 S. St. Francis Dr., Santa Fe, NM 87505

State of New Mexico  
Energy Minerals and Natural Resources

Oil Conservation Division  
1220 South St. Francis Dr.  
Santa Fe, NM 87505

WF

Form C-144  
March 12, 2004

For drilling and production facilities, submit to appropriate NMOCD District Office.  
For downstream facilities, submit to Santa Fe office

105 South Fourth Street, Artesia, NM 88210

Pit or Below-Grade Tank Registration or Closure

Is pit or below-grade tank covered by a "general plan"? Yes ☒ CheckBox1

Type of action: Registration of a pit or below-grade tank ☒ Closure of a pit or below-grade tank ☐

Operator: Yates Petroleum Corporation Telephone: 505-748-4376 e-mail address: debbiec@ypcnm.com

Address: 104 South 4<sup>th</sup> Street, Artesia, New Mexico 88210

Facility or well name: Everette OO Federal #11 API #:                      U/L or Qtr/Qtr NESW Sec 26 T 5S R 24E

County: Chaves Latitude                      Longitude                      NAD: 1927 ☐ 1983 ☐ Surface Owner: Federal ☒ State ☐ Private ☐ Indian ☐

Pit

Type: Drilling ☒ Production ☐ Disposal ☐

Workover ☐ Emergency ☐

Lined ☒ Unlined ☐

Liner type: Synthetic ☒ Thickness 12 mil Clay ☐ Volume                      bbl

Below-grade tank

Volume:            bbl Type of fluid:                     

Construction material:                     

Double-walled, with leak detection? Yes ☐ If not, explain why not.                     

Depth to ground water (vertical distance from bottom of pit to seasonal high water elevation of ground water.)

Less than 50 feet

(20 points)

50 feet or more, but less than 100 feet

(10 points)

100 feet or more

( 0 points)

Wellhead protection area: (Less than 200 feet from a private domestic water source, or less than 1000 feet from all other water sources.)

Yes

(20 points)

No

( 0 points)

Distance to surface water: (horizontal distance to all wetlands, playas, irrigation canals, ditches, and perennial and ephemeral watercourses.)

Less than 200 feet

(20 points)

200 feet or more, but less than 1000 feet

(10 points)

1000 feet or more

( 0 points)

Ranking Score (Total Points)

0

If this is a pit closure: (1) attach a diagram of the facility showing the pit's relationship to other equipment and tanks. (2) Indicate disposal location:

onsite ☐ offsite ☐ If offsite, name of facility                     . (3) Attach a general description of remedial action taken including remediation start date and end date. (4) Groundwater encountered: No ☐ Yes ☐ If yes, show depth below ground surface                      ft. and attach sample results. (5) Attach soil sample results and a diagram of sample locations and excavations.

I hereby certify that the information above is true and complete to the best of my knowledge and belief. I further certify that the above-described pit or below-grade tank has been/will be constructed or closed according to NMOCD guidelines ☐, a general permit ☒, or an (attached) alternative OCD-approved plan ☐.

Date: 10/29/2004

Printed Name/Title Robert Asher/Regulatory Agent

Signature                     

Your certification and NMOCD approval of this application/closure does not relieve the operator of liability should the contents of the pit or tank contaminate ground water or otherwise endanger public health or the environment. Nor does it relieve the operator of its responsibility for compliance with any other federal, state, or local laws and/or regulations.

Approval:

Date:                     

Printed Name/Title                     

Signature

# EXHIBIT A

Operator: Yates Petroleum Corporation

BLM Serial Number: NM-28297

Well Name & NO.: Everette "OO" Federal #11

Location: Section 26, T. 5 S., R. 24 E.

1980' FSL & 1980' FWL, Chaves County, N.M.

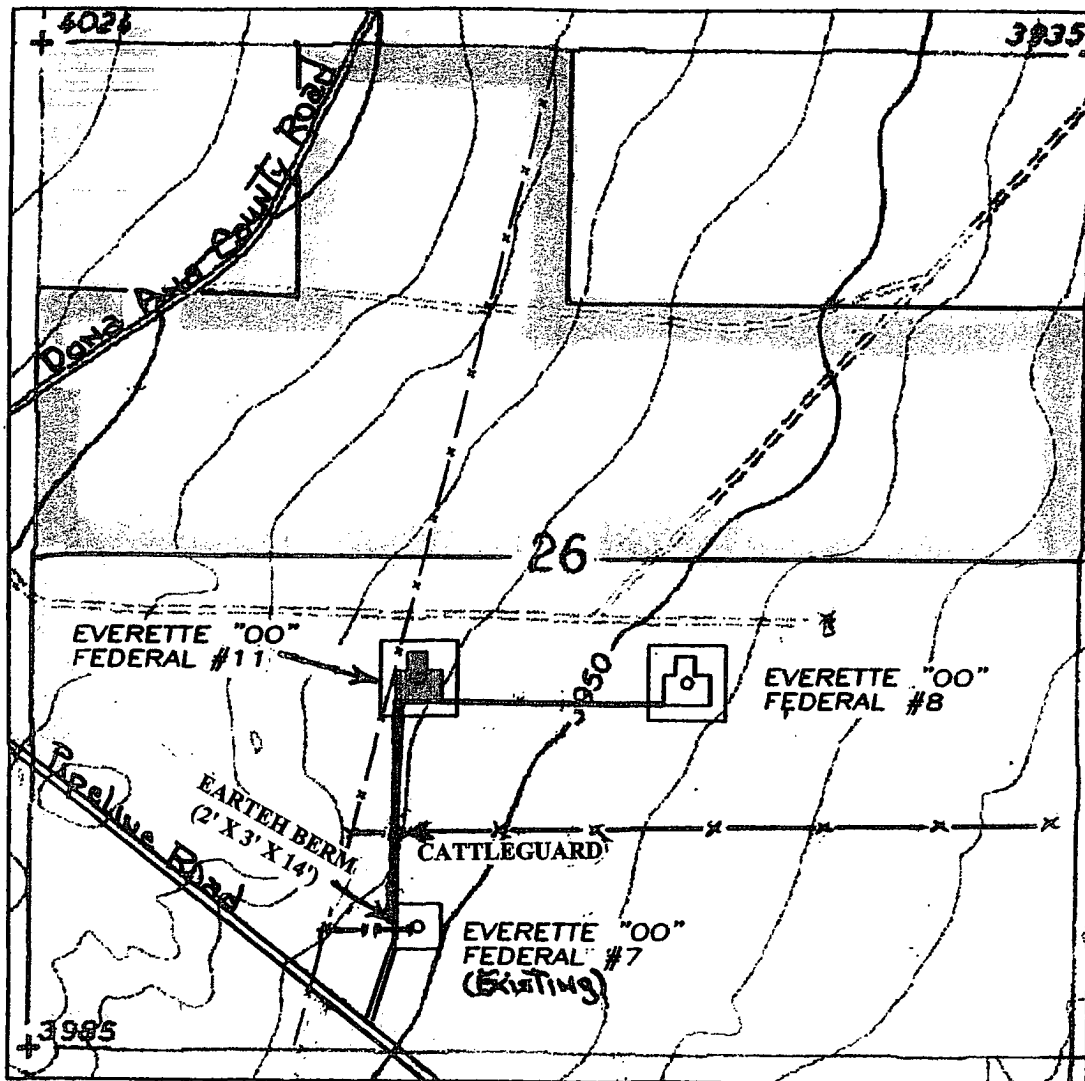

N

## WELL DRILLING REQUIREMENTS

3 of 5 pages

### III. DRILLING OPERATION REQUIREMENTS:

#### A. GENERAL DRILLING REQUIREMENTS:

1. The Bureau of Land Management (BLM) is to be notified at the Roswell Field Office, 2909 West Second St., Roswell NM 88201, (505) 627-0272, in sufficient time for a representative to witness:

A. Spudding      B. Cementing casing: 11¾ inch 8⅝ inch 5½ inch      C. BOP tests

2. Unless the production casing has been run and cemented or the well has been properly plugged, the drilling rig shall not be removed from over the hole without prior approval.

3. Submit a Sundry Notice (Form 3160-5, one original and five copies) for each casing string, describing the casing and cementing operations. Include pertinent information such as; spud date, hole size, casing (size, weight, grade and thread type), cement (type, quantity and top), water zones and problems or hazards encountered. The Sundry shall be submitted within 15 days of completion of each casing string. The reports may be combined into the same Sundry if they fall within the same 15 day time frame.

4. The API No. assigned to the well by NMOCD shall be included on the subsequent report of setting the first casing string.

#### B. CASING:

1. The 11¾ inch surface casing shall be set at 900' and cement circulated to the surface. If cement does not circulate to the surface the appropriate BLM office shall be notified and a temperature survey or cement bond log shall be run to verify the top of the cement. Remedial cementing shall be completed prior to drilling out that string.

2. The minimum required fill of cement behind the 8⅝ inch intermediate casing if run is with sufficient amount of cement bring it up at least 200 above shoe.

3. The minimum required fill of cement behind the 5½ inch production casing is cement shall extend upward a minimum of 500 feet above the uppermost perforation.

#### C. PRESSURE CONTROL:

1. All BOP systems and related equipment shall comply with well control requirements as described in Onshore Oil and Gas Order No. 2. The BOP and related equipment shall be installed and operational before drilling below the 11¾ inch casing shoe and shall be tested as described in Onshore Order No. 2. Any equipment failing to test satisfactorily shall be repaired or replaced.

2. Minimum working pressure of the blowout preventer and related equipment (BOPE) shall be 2000 psi.

3. The appropriate BLM office shall be notified in sufficient time for a representative to witness the tests.

- a. The results of the test shall be reported to the appropriate BLM office.
- b. Testing fluid must be water or an appropriate clear liquid suitable for sub-freezing temperatures. Use of drilling mud for testing is not permitted since it can mask small leaks.
- c. Testing must be done in a safe workman-like manner. Hard line connections shall be required.
- d. BOPE shall be tested before drilling into the Wolfcamp formation.

#### D. DRILLING MUD:

Mud system monitoring equipment, with derrick floor indicators and visual and audio alarms, shall be operating before drilling into the Wolfcamp formation, and shall be used until production casing is run and cemented. Monitoring equipment shall consist of the following:

- a. Recording pit level indicator to indicate volume gains and losses.
- b. Mud measuring device for accurately determining the mud volumes necessary to fill the hole during trips.
- c. Flow-sensor on the flow-line to warn of abnormal mud returns from the well.