

DISTRICT I  
1625 N. French Dr., Hobbs, NM 88240

DISTRICT II  
1301 W. Grand Avenue, Artesia, NM 88210

DISTRICT III  
1000 Rio Brazos Rd., Aztec, NM 87410

DISTRICT IV  
1220 S. St. Francis Dr., Santa Fe, NM 87505

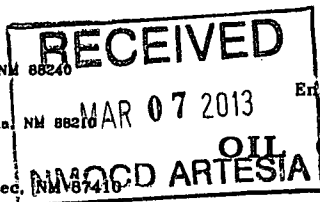

State of New Mexico  
Energy, Minerals and Natural Resources Department

Form C-102  
Revised July 18, 2010

Submit one copy to appropriate  
District Office

**OIL CONSERVATION DIVISION**  
1220 South St. Francis Dr.  
Santa Fe, New Mexico 87505

**WELL LOCATION AND ACREAGE DEDICATION PLAT**

☒ AMENDED REPORT

*As Drilled*

API Number <b>30-015-40500</b>		Pool Code <b>97650</b>	Pool Name <b>WC Williams Sink (Bone Spring)</b>
Property Code <b>305860</b>	Property Name <b>BIG EDDY UNIT</b>		Well Number <b>252H</b>
OGRID No. <b>260737</b>	Operator Name <b>BOPCO, L.P.</b>		Elevation <b>3477'</b>

**Surface Location**

UL or lot No.	Section	Township	Range	Lot Idn	Feet from the	North/South line	Feet from the	East/West line	County
P	35	19 S	31 E		620	SOUTH	10	EAST	EDDY

**Bottom Hole Location If Different From Surface**

UL or lot No.	Section	Township	Range	Lot Idn	Feet from the	North/South line	Feet from the	East/West line	County
P	2	20 S	31 E		333	SOUTH	663	EAST	EDDY

Dedicated Acres <b>200</b>	Joint or Infill	Consolidation Code	Order No.
-------------------------------	-----------------	--------------------	-----------

**NO ALLOWABLE WILL BE ASSIGNED TO THIS COMPLETION UNTIL ALL INTERESTS HAVE BEEN CONSOLIDATED  
OR A NON-STANDARD UNIT HAS BEEN APPROVED BY THE DIVISION**

**SURFACE LOCATION  
BONE SPRINGS 2 PP**

Lat - N 32°36'40.62"  
Long - W 103°49'50.93"  
NMSPC- N 586462.310  
E 654736.505  
(NAD-27)

**BOTTOM  
HOLE LOCATION**

Lat - N 32°35'45.69"  
Long - W 103°49'58.85"  
NMSPC- N 580908.4  
E 654085.8  
(NAD-27)

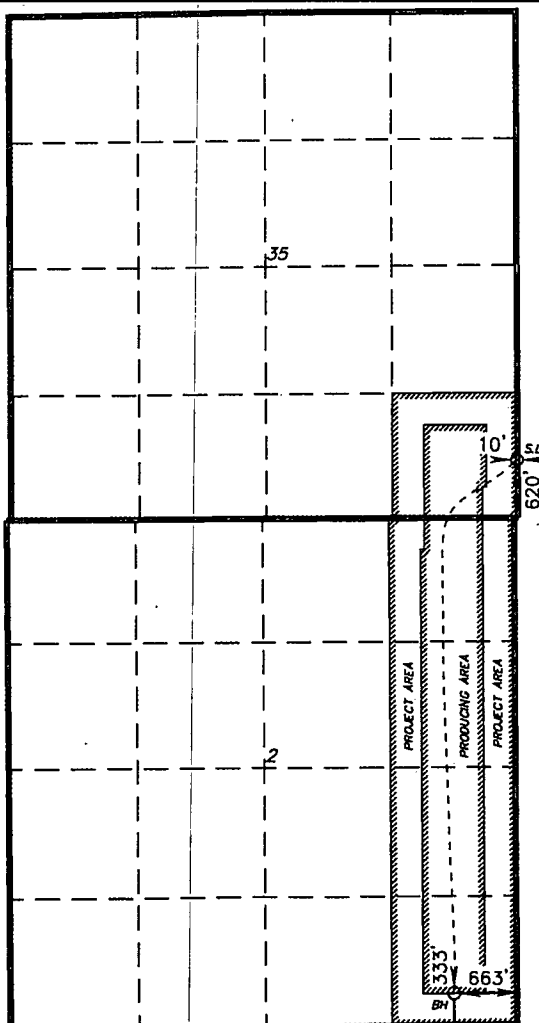

**OPERATOR CERTIFICATION**

I hereby certify that the information contained herein is true and complete to the best of my knowledge and belief, and that this organization either owns a working interest or unleased mineral interest in the land including the proposed bottom hole location or has a right to drill this well at this location pursuant to a contract with an owner of such a mineral or working interest, or to a voluntary pooling agreement or a compulsory pooling order heretofore entered by the division.

*Tracie J Cherry* 03-06-13  
Signature Date

Tracie J Cherry  
Printed Name  
tjcherry@basspet.com  
Email Address

**SURVEYOR CERTIFICATION**

I hereby certify that the well location shown on this plat was plotted from field notes of actual surveys made by me or under my supervision, and that the same is true and correct to the best of my belief.

December 2, 2011  
Date Surveyed  
Signature & Seal of  
Professional Surveyor

Certificate No. Gary L. Jones 7977

**Basin Surveys** 25936