

District I  
1625 N. French Dr., Hobbs, NM 88240  
District II  
1301 W. Grand Avenue, Artesia, NM 88210  
District III  
1000 Rio Brazos Road, Aztec, NM 87410  
District IV  
1220 S. St. Francis Dr., Santa Fe, NM 87505

State of New Mexico  
Energy Minerals and Natural Resources

Oil Conservation Division  
1220 South St. Francis Dr.  
Santa Fe, NM 87505

Form C-144  
March 12, 2004

For drilling and production facilities, submit to appropriate NMOCD District Office.  
For downstream facilities, submit to Santa Fe office

**Pit or Below-Grade Tank Registration or Closure**

Is pit or below-grade tank covered by a "general plan"? Yes ☐ No ☒

Type of action: Registration of a pit or below-grade tank ☒ Closure of a pit or below-grade tank ☐

RECEIVED

SEP 27 2005

OCD-ARTESIA

Operator: Mewbourne Oil Company Telephone: 505-393-5905 e-mail address: \_\_\_\_\_  
Address: PO Box 5270 Hobbs NM 88240  
Facility or well name: Black River "26" St Com #1 API #: 30-015-33686 U/L or Qtr/Qtr\_H Sec 26 T23S R26E  
County: Eddy Latitude 32-16-38.5N Longitude 104-15-25.8W NAD: 1927 ☐ 1983 ☒  
Surface Owner Federal ☐ State ☒ Private ☐ Indian ☐

**Pit**

Type: Drilling ☐ Production ☐ Disposal ☒

Workover ☐ Emergency ☐

Lined ☒ Unlined ☐

Liner type: Synthetic ☒ Thickness 12 mil Clay ☐

Volume 5000 bbl

**Below-grade tank**

Volume: \_\_\_\_\_ bbl Type of fluid: \_\_\_\_\_

Construction material: \_\_\_\_\_

Double-walled, with leak detection? Yes ☐ If not, explain why not. \_\_\_\_\_

Depth to ground water (vertical distance from bottom of pit to seasonal high water elevation of ground water.)

Less than 50 feet

(20 points)

50 feet or more, but less than 100 feet

(10 points)

100 feet or more X

( 0 points) 0

Wellhead protection area: (Less than 200 feet from a private domestic water source, or less than 1000 feet from all other water sources.)

Yes

(20 points)

No X

( 0 points) 0

Distance to surface water: (horizontal distance to all wetlands, playas, irrigation canals, ditches, and perennial and ephemeral watercourses.)

Less than 200 feet

(20 points)

200 feet or more, but less than 1000 feet

(10 points)

1000 feet or more X

( 0 points) 0

**Ranking Score (Total Points)**

0

**If this is a pit closure:** (1) attach a diagram of the facility showing the pit's relationship to other equipment and tanks. (2) Indicate disposal location:

onsite ☒ offsite ☐ If offsite, name of facility \_\_\_\_\_. (3) Attach a general description of remedial action taken including remediation start date and end date. (4) Groundwater encountered: No ☒ Yes ☐ If yes, show depth below ground surface \_\_\_\_\_ ft. and attach sample results. (5) Attach soil sample results and a diagram of sample locations and excavations.

Mewbourne Oil Company proposes to dig a "deep bury" pit to dispose of the reserve pit from this location and the drill cuttings from the Herradura 25 #1 (Sec 25-T22S-R27E).

Enclosed is a diagram of the above location showing the approximate spot of the "deep bury" pit. We will start to reclaim this pit as soon as possible after your approval. We will send closure forms as soon as the remediation is complete.

I hereby certify that the information above is true and complete to the best of my knowledge and belief. I further certify that the above-described pit or below-grade tank has been/will be constructed or closed according to NMOCD guidelines ☒ a general permit ☐, or an (attached) alternative OCD-approved plan ☐.

Date: 09/15/05

Printed Name/Title Kristi Green / Hobbs Regulatory Signature Kristi Green

Your certification and NMOCD approval of this application/closure does not relieve the operator of liability should the contents of the pit or tank contaminate ground water or otherwise endanger public health or the environment. Nor does it relieve the operator of its responsibility for compliance with any other federal, state, or local laws and/or regulations.

Approval **OCT 3 2005**

Date: \_\_\_\_\_

Field Supervisor

Printed Name/Title \_\_\_\_\_ Signature \_\_\_\_\_

**OCD approval conditional.  
Approval must also be  
obtained from landowner.**

MEWBourNE Oil Company  
BLACK RIVER "26" STATE Com #1

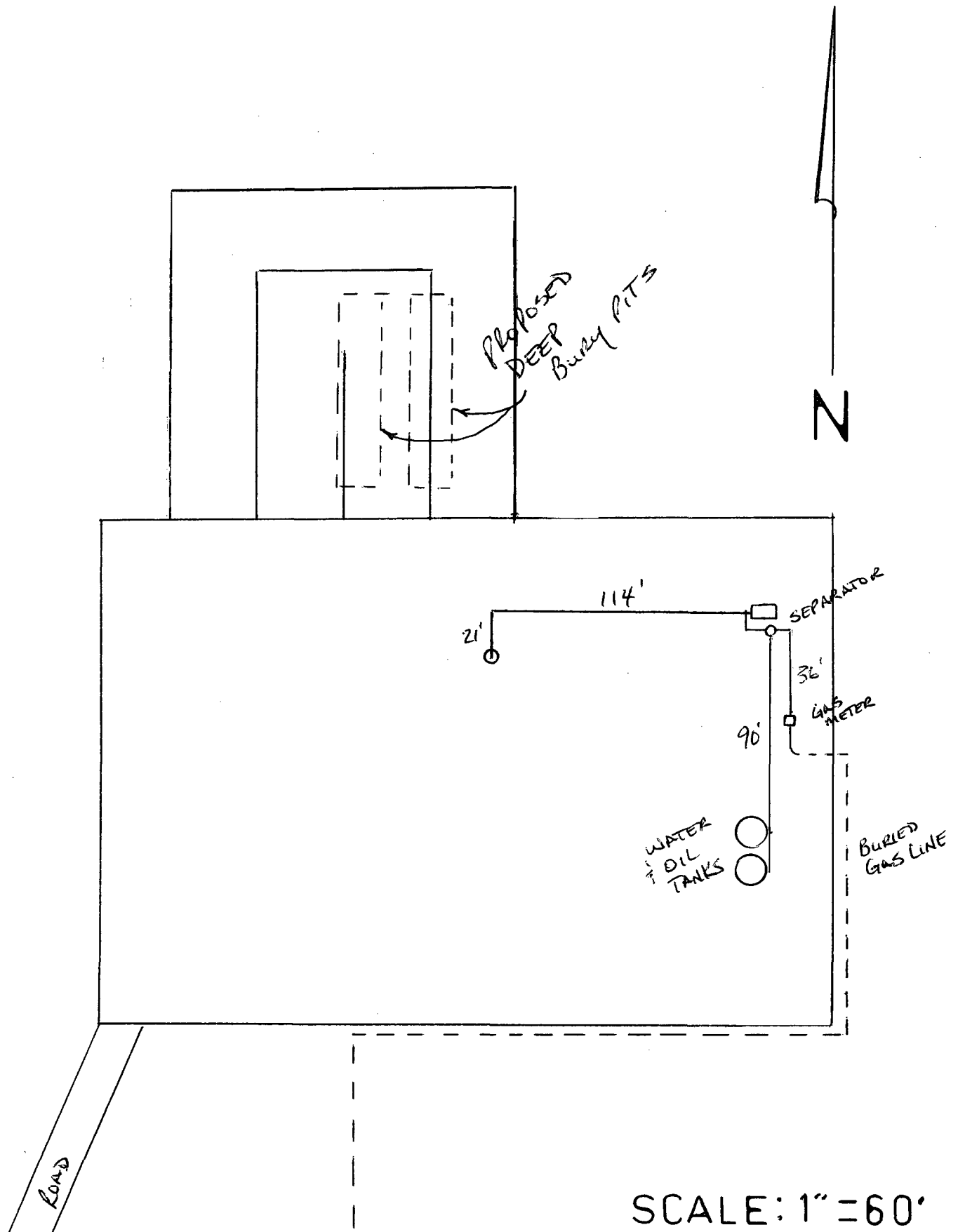

*New Mexico Office of the State Engineer*  
**Well Reports and Downloads**

Township: 23S Range: 26E Sections: 26

NAD27 X: Y: Zone: Search Radius:

County: Basin: Number: Suffix:

Owner Name: (First) (Last) ☐ Non-Domestic ☐ Domestic  
☒ All

Well / Surface Data Report

Avg Depth to Water Report

Water Column Report

Clear Form

WATERS Menu

Help

WELL / SURFACE DATA REPORT 09/24/2005

(acre ft per annum)  
DB File Nbr Use Diversion Owner

Well Number

(que  
(que

No Records found, try again

*New Mexico Office of the State Engineer*  
**Well Reports and Downloads**

Township:  Range:  Sections:

NAD27 X:  Y:  Zone:  Search Radius:

County:  Basin:  Number:  Suffix:

Owner Name: (First)  (Last)  ☐ Non-Domestic ☐ Domestic  
☒ All

Well / Surface Data Report

Avg Depth to Water Report

Water Column Report

Clear Form

WATERS Menu

Help

**AVERAGE DEPTH OF WATER REPORT 09/24/2005**

Bsn	Tws	Rng	Sec	Zone	X	Y	Wells	(Depth Water in Feet)		
								Min	Max	Avg
C	23S	26E	22				2	90	265	178
C	23S	26E	25				4	132	181	161

Record Count: 6