

UNITED STATES  
DEPARTMENT OF THE INTERIOR  
BUREAU OF LAND MANAGEMENTFORM APPROVED  
OMB NO. 1004-0135  
Expires: July 31, 2010**SUNDRY NOTICES AND REPORTS ON WELLS**  
*Do not use this form for proposals to drill or to re-enter an abandoned well. Use form 3160-3 (APD) for such proposals.*5. Lease Serial No.  
NMNM14847

6. If Indian, Allottee or Tribe Name

7. If Unit or CA/Agreement, Name and/or No.

**SUBMIT IN TRIPLICATE - Other instructions on reverse side.**

1. Type of Well

☒ Oil Well ☐ Gas Well ☐ Other8. Well Name and No.  
PERE MARQUETTE 18 FEDERAL 13

2. Name of Operator

Contact: ARICKA EASTERLING

CIMAREX ENERGY COMPANY OF CO-Mail: aeasterling@cimarex.com

9. API Well No.  
30-015-40785-00-X1

3a. Address

600 NORTH MARIENFELD STREET SUITE 600  
MIDLAND, TX 79701

3b. Phone No. (include area code)

Ph: 918-560-7060  
Fx: 918-749-805910. Field and Pool, or Exploratory  
EMPIRE

4. Location of Well (Footage, Sec., T., R., M., or Survey Description)

Sec 18 T17S R29E NENW 1199FNL 1412FWL

11. County or Parish, and State

EDDY COUNTY, NM

## 12. CHECK APPROPRIATE BOX(ES) TO INDICATE NATURE OF NOTICE, REPORT, OR OTHER DATA

TYPE OF SUBMISSION	TYPE OF ACTION			
<input checked="" type="checkbox"/> Notice of Intent	<input type="checkbox"/> Acidize	<input type="checkbox"/> Deepen	<input type="checkbox"/> Production (Start/Resume)	<input type="checkbox"/> Water Shut-Off
<input type="checkbox"/> Subsequent Report	<input type="checkbox"/> Alter Casing	<input type="checkbox"/> Fracture Treat	<input type="checkbox"/> Reclamation	<input type="checkbox"/> Well Integrity
<input type="checkbox"/> Final Abandonment Notice	<input type="checkbox"/> Casing Repair	<input type="checkbox"/> New Construction	<input type="checkbox"/> Recomplete	<input checked="" type="checkbox"/> Other
	<input type="checkbox"/> Change Plans	<input type="checkbox"/> Plug and Abandon	<input type="checkbox"/> Temporarily Abandon	Change to Original A
	<input type="checkbox"/> Convert to Injection	<input type="checkbox"/> Plug Back	<input type="checkbox"/> Water Disposal	PD

13. Describe Proposed or Completed Operation (clearly state all pertinent details, including estimated starting date of any proposed work and approximate duration thereof. If the proposal is to deepen directionally or recompleat horizontally, give subsurface locations and measured and true vertical depths of all pertinent markers and zones. Attach the Bond under which the work will be performed or provide the Bond No. on file with BLM/BIA. Required subsequent reports shall be filed within 30 days following completion of the involved operations. If the operation results in a multiple completion or recompleat in a new interval, a Form 3160-4 shall be filed once testing has been completed. Final Abandonment Notices shall be filed only after all requirements, including reclamation, have been completed, and the operator has determined that the site is ready for final inspection.)

Cimarex Energy Inc. respectfully requests approval to change the rig layout as indicated on the attached diagram.

Cimarex is proposing a 380' X 320' drilling pad in order to accommodate the rig requirements.

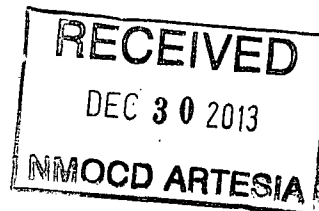
Accepted for record  
NMOCD-15  
12/20/13

14. I hereby certify that the foregoing is true and correct.

Electronic Submission #227270 verified by the BLM Well Information System  
For CIMAREX ENERGY COMPANY OF CO, sent to the Carlsbad  
Committed to AFMSS for processing by KURT SIMMONS on 12/02/2013 (14KMS7627SE)

Name (Printed/Typed) ARICKA EASTERLING

Title REGULATORY ANALYST

Signature (Electronic Submission)

Date 11/19/2013

## THIS SPACE FOR FEDERAL OR STATE OFFICE USE

Approved By JAMES A AMOS

Title SUPERVISOR EPS

Date 12/20/2013

Conditions of approval, if any, are attached. Approval of this notice does not warrant or certify that the applicant holds legal or equitable title to those rights in the subject lease which would entitle the applicant to conduct operations thereon.

Office Carlsbad

Title 18 U.S.C. Section 1001 and Title 43 U.S.C. Section 1212, make it a crime for any person knowingly and willfully to make to any department or agency of the United States any false, fictitious or fraudulent statements or representations as to any matter within its jurisdiction.

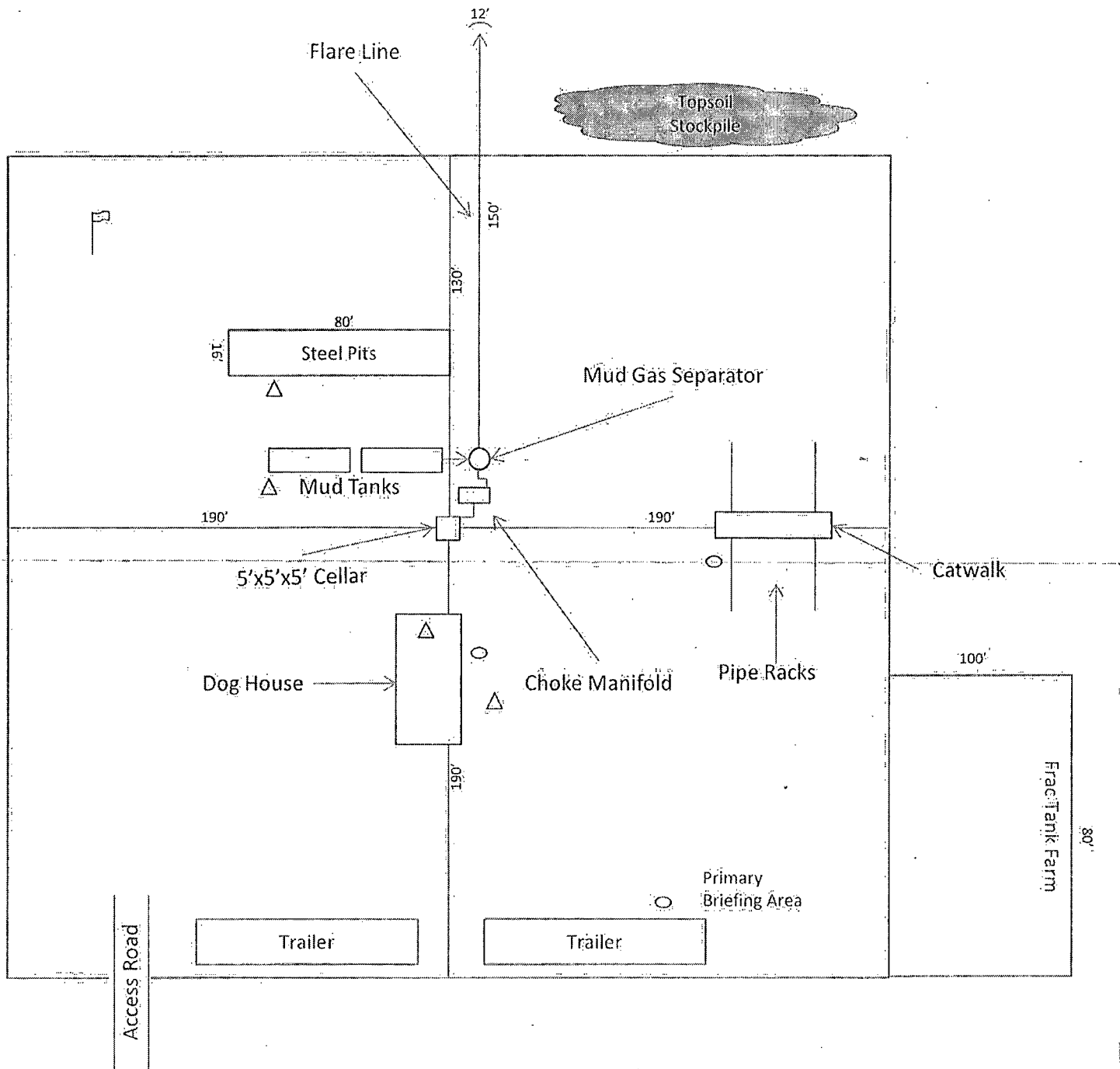

Wind Direction Indicators  
(wind sock or streamers)



• H2S Monitors  
(alarms at bell nipple and shale shaker)



Briefing Areas

N



Exhibit D – Rig Diagram  
Pere Marquette 18 Federal No. 13  
Cimarex Energy Co.  
18-17S-29E  
SHL 1199 FNL & 1412 FWL  
BHL 1199 FNL & 1412 FWL  
Eddy County, NM

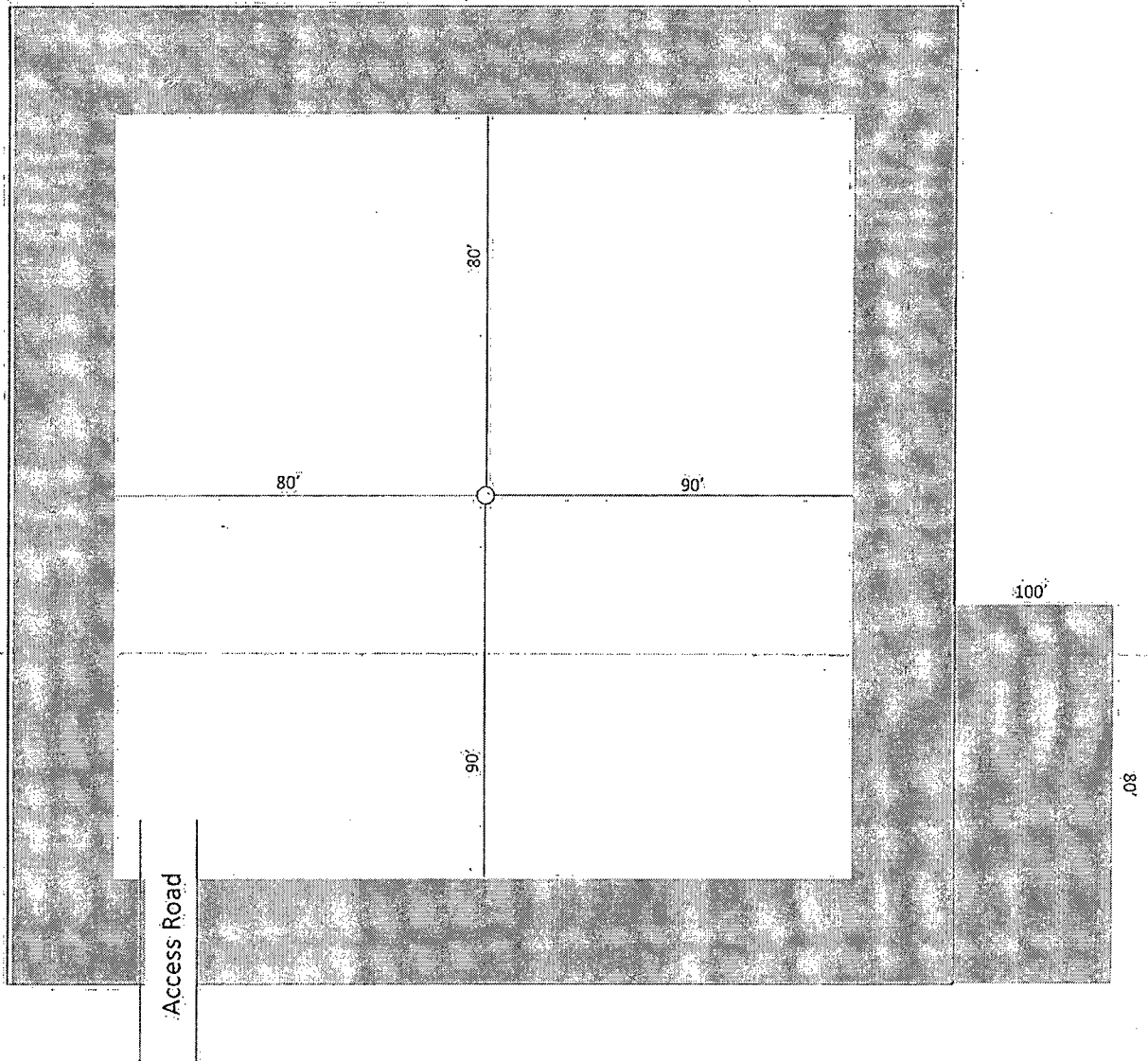

Exhibit D-1 Reclamation Plat  
Pere Marquette 18 Federal No. 13  
Cimarex Energy Co.  
18-17S-29E  
SHL 1199 FNL & 1412 FWL  
BHL 1199 FNL & 1412 FWL  
Eddy County, NM

