

DISTRICT I

1625 N. French Dr., Hobbs, NM 88240

DISTRICT II

1301 W. Grand Avenue, Artesia, NM 88210

DISTRICT III

1000 Rio Brazos Rd., Aztec, NM 87410

DISTRICT IV

1220 S. St. Francis Dr., Santa Fe, NM 87505

State of New Mexico
Energy, Minerals and Natural Resources Department

Form C-102

Revised July 16, 2010

Submit one copy to appropriate
District Office

OIL CONSERVATION DIVISION

1220 South St. Francis Dr.
Santa Fe, New Mexico 87505

WELL LOCATION AND ACREAGE DEDICATION PLAT

X AMENDED REPORT
Pool Transfer; As Drilled

API Number 30-015-41281	Pool Code 96473	Pool Name Pierce Crossing; Bone Spring, E.
Property Code 306402	Property Name POKER LAKE UNIT	Well Number 441H
OGRID No. 260737	Operator Name BOPCO, L.P.	Elevation 3159'

Surface Location

UL or lot No.	Section	Township	Range	Lot Idn	Feet from the	North/South line	Feet from the	East/West line	County
0	18	24 S	30 E		1281	SOUTH	2401	EAST	EDDY

Bottom Hole Location If Different From Surface

UL or lot No.	Section	Township	Range	Lot Idn	Feet from the	North/South line	Feet from the	East/West line	County
G	7	24 S	29 E		2291	NORTH	2387	EAST	EDDY

Dedicated Acres	Joint or Infill	Consolidation Code	Order No.
280			

NO ALLOWABLE WILL BE ASSIGNED TO THIS COMPLETION UNTIL ALL INTERESTS HAVE BEEN CONSOLIDATED
OR A NON-STANDARD UNIT HAS BEEN APPROVED BY THE DIVISION

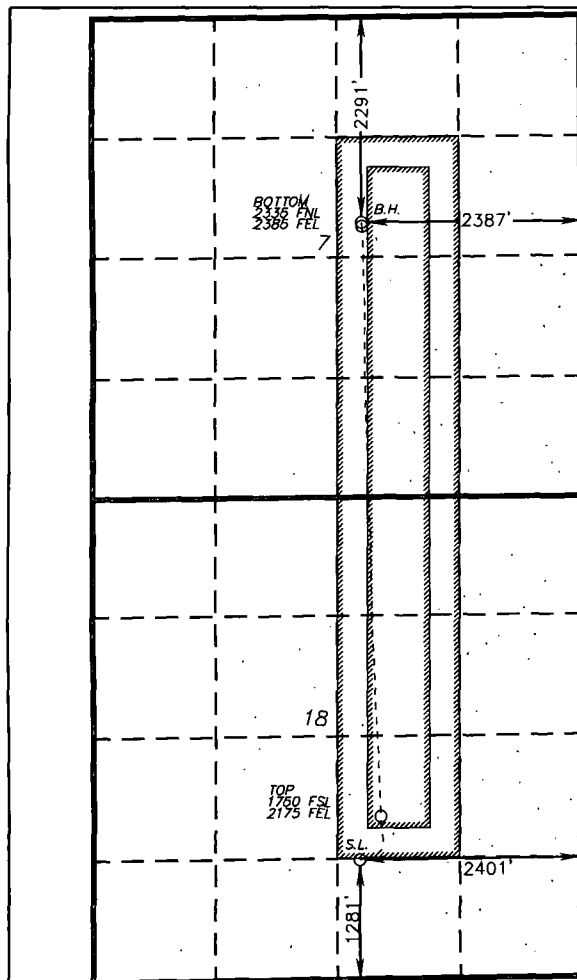

RECEIVED

MAR 25 2014

NMOCD ARTESIA

PROPOSED BOTTOM
HOLE LOCATION

Lat - N 32°13'58.75"
Long - W 103°55'09.84"
NMSPCE - N 448725.7
E 627992.2
(NAD-27)

SURFACE LOCATION

Lat - N 32°12'49.23"
Long - W 103°55'10.12"
NMSPCE - N 441700.319
E 627994.939
(NAD-27)

OPERATOR CERTIFICATION

I hereby certify that the information contained herein is true and complete to the best of my knowledge and belief, and that this organization either owns a working interest or unleased mineral interest in the land including the proposed bottom hole location or has a right to drill this well at this location pursuant to a contract with an owner of such a mineral or working interest, or to a voluntary pooling agreement or a compulsory pooling order heretofore entered by the division.

Signature *Tracie J Cherry* Date 03-24-14

Tracie J Cherry

Printed Name
tjcherry@basspet.com

Email Address

SURVEYOR CERTIFICATION

I hereby certify that the well location shown on this plat was plotted from field notes of actual surveys made by me or under my supervision, and that the same is true and correct to the best of my belief.

NOV 25 2012

Date Surveyed
Signature of
Professional Surveyor

Certificate No. Gary L. Jones 7977

BASIN SURVEYS

27682