

NM OIL CONSERVATION

ARTESIA DISTRICT

DISTRICT I

1625 N. French Dr., Hobbs, NM 88240

DISTRICT II

1301 W. Grand Avenue, Artesia, NM 88210

DISTRICT III

1000 Rio Brazos Rd., Aztec, NM 87410

DISTRICT IV

1220 S. Pl. Francis Dr., Santa Fe, NM 87505

State of New Mexico
Energy, Minerals and Natural Resources Department

OIL CONSERVATION DIVISION
1220 South St. Francis Dr.
Santa Fe, New Mexico 87505

JUN 16 2014

Form C-102

Revised July 16, 2010

Submit one copy to appropriate
District Office

WELL LOCATION AND ACREAGE DEDICATION PLAT

☐ AMENDED REPORT

API Number 30-015-42006	Pool Code 97650	Pool Name Williams Sink; Bone Spring
Property Code 305860	Property Name BIG EDDY UNIT	Well Number 257H
OGRID No. 260737	Operator Name BOPCO, L.P.	Elevation 3454'

Surface Location

UL or lot No.	Section	Township	Range	Lot Idn	Feet from the	North/South line	Feet from the	East/West line	County
J	33	19 S	31 E		1670	SOUTH	2530	EAST	EDDY

Bottom Hole Location If Different From Surface

UL or lot No.	Section	Township	Range	Lot Idn	Feet from the	North/South line	Feet from the	East/West line	County
O	34	19 S	31 E		698	SOUTH	1380	EAST	EDDY

Dedicated Acres	Joint or Infill	Consolidation Code	Order No.
240			

NO ALLOWABLE WILL BE ASSIGNED TO THIS COMPLETION UNTIL ALL INTERESTS HAVE BEEN CONSOLIDATED
OR A NON-STANDARD UNIT HAS BEEN APPROVED BY THE DIVISION

OPERATOR CERTIFICATION

I hereby certify that the information contained herein is true and complete to the best of my knowledge and belief, and that this organization either owns a working interest or unleased mineral interest in the land including the proposed bottom hole location or has a right to drill this well at this location pursuant to a contract with an owner of such a mineral or working interest, or to a voluntary pooling agreement or a compulsory pooling order heretofore entered by the division.

Signature: *Tracie J Cherry* Date: 06/12/14

Tracie J Cherry

Printed Name
tjcherry@basspet.com

Email Address

SURVEYOR CERTIFICATION

I hereby certify that the well location shown on this plat was plotted from field notes of actual surveys made by me or under my supervision, and that the same is true and correct to the best of my belief.

Date: 06/12/14
Signature & Seal of Professional Surveyor
Gary L. Jones
Professional Surveyor No. 25539

Certificate No. Gary L. Jones 7977

BASIN SURVEYS 25539

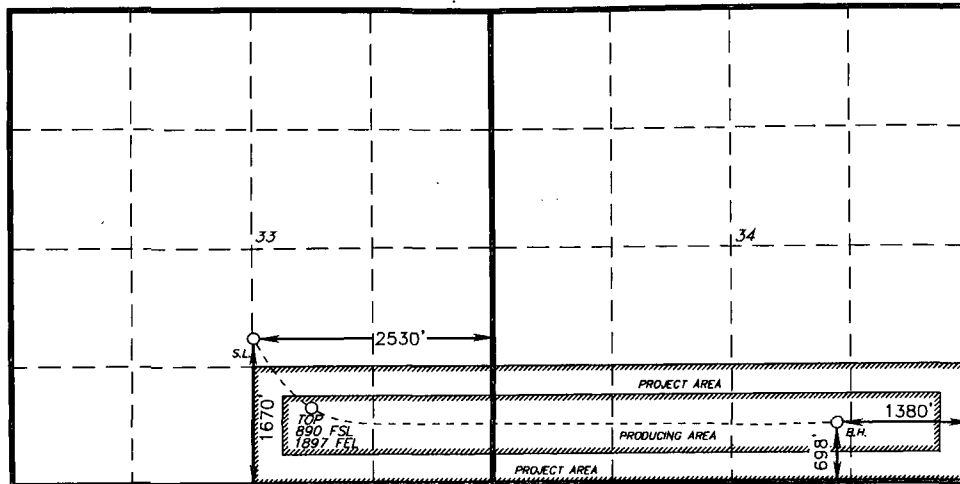

SURFACE LOCATION

Lot - N 32°36'50.82"
Long - W 103°52'23.91"
NMSPC- N 587433.7
E 641647.4
(NAD-27)

BOTTOM HOLE LOCATION

Lot - N 32°36'41.38"
Long - W 103°52'09.44"
NMSPC- N 586485.4
E 642889.3
(NAD-27)