

DISTRICT I  
1625 N. French Dr., Hobbs, NM 88240  
Phone (575) 593-6161 Fax: (575) 393-0720

DISTRICT II  
811 S. First St., Artesia, NM 88210  
Phone (575) 748-1203 Fax: (575) 748-0720

DISTRICT III  
1000 Rio Brazos Rd., Aztec, NM 87410  
Phone (505) 334-6178 Fax: (505) 334-6170

DISTRICT IV  
1220 S. St. Francis Dr., Santa Fe, NM 87505  
Phone (505) 476-3460 Fax: (505) 476-3462

# NM OIL CONSERVATION

ARTESIA DISTRICT

Form C-102

Revised August 1, 2011

State of New Mexico  
Energy, Minerals and Natural Resources Department

JUL 28 2014

Submit one copy to appropriate  
District Office

## OIL CONSERVATION DIVISION

1220 South St. Francis Dr.  
Santa Fe, New Mexico 87505

RECEIVED

### WELL LOCATION AND ACREAGE DEDICATION PLAT

☐ AMENDED REPORT

API Number <b>30-015-41284</b>	Pool Code <b>13354</b>	Pool Name <b>Corral Canyon</b>	<b>BONE SPRING South</b>
Property Code <b>39839</b>	Property Name <b>BRUSHY DRAW 1"DM" FEDERAL</b>		Well Number <b>1H</b>
OGRID No. <b>14744</b>	Operator Name <b>MEWBOURNE OIL COMPANY</b>		Elevation <b>3050'</b>

#### Surface Location

UL or lot No.	Section	Township	Range	Lot Idn	Feet from the	North/South line	Feet from the	East/West line	County
D	1	26 S	29 E		170	NORTH	300	WEST	EDDY

#### Bottom Hole Location If Different From Surface

UL or lot No.	Section	Township	Range	Lot Idn	Feet from the	North/South line	Feet from the	East/West line	County
M	1	26 S	29 E		346	SOUTH	588'	WEST	EDDY
Dedicated Acres 160		Joint or Infill	Consolidation Code		Order No.				

NO ALLOWABLE WILL BE ASSIGNED TO THIS COMPLETION UNTIL ALL INTERESTS HAVE BEEN CONSOLIDATED  
OR A NON-STANDARD UNIT HAS BEEN APPROVED BY THE DIVISION

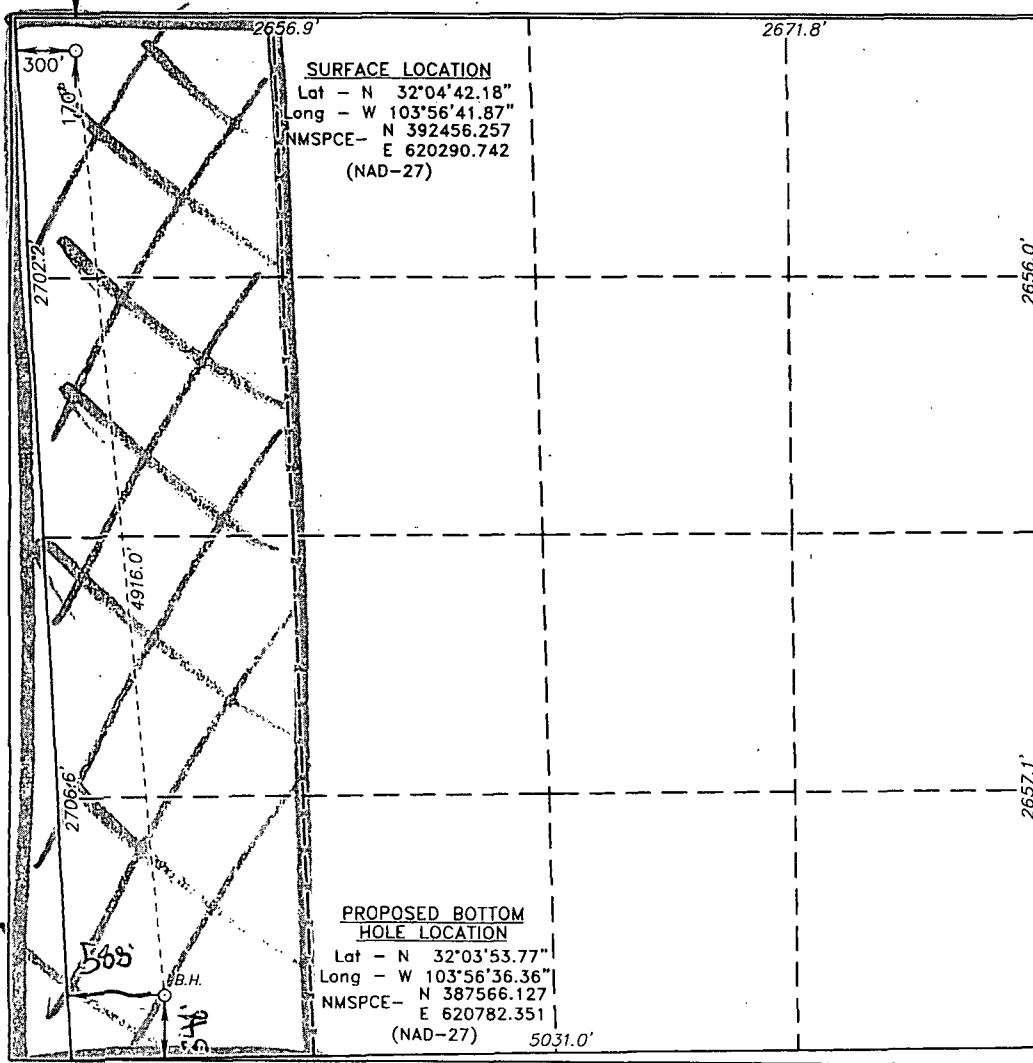

#### OPERATOR CERTIFICATION

I hereby certify that the information contained herein is true and complete to the best of my knowledge and belief, and that this organization either owns a working interest or unleased mineral interest in the land including the proposed bottom hole location or has a right to drill this well at this location pursuant to a contract with an owner of such a mineral or working interest, or to a voluntary pooling agreement or a compulsory pooling order heretofore entered by the division.

J Lathan 7/24/14  
Signature Date

Jackie Lathan  
Printed Name

Email Address

#### SURVEYOR CERTIFICATION

I hereby certify that the well location shown on this plat was plotted from field notes of actual surveys made by me or under my supervision, and that the same is true and correct to the best of my belief.

NOVEMBER 29 2012

Date Surveyed

[Signature]  
Signature of Professional Surveyor

Certificate No. 27689

Basin Surveys

7977

7977

7977

7977

7977

7977

7977

7977

7977