

DISTRICT I  
1625 N. French Dr., Hobbs, NM 88240  
Phone (575) 393-6161 Fax: (575) 393-0720  
DISTRICT II  
811 S. First St., Artesia, NM 88210  
Phone (575) 748-1283 Fax: (575) 748-9720  
DISTRICT III  
1000 Rio Brazos Rd., Aztec, NM 87410  
Phone (505) 334-6178 Fax: (505) 334-6170  
DISTRICT IV  
1220 S. St. Francis Dr., Santa Fe, NM 87505  
Phone (505) 476-3480 Fax: (505) 476-3462

State of New Mexico  
Energy, Minerals and Natural Resources Department  
**OIL CONSERVATION DIVISION**  
1220 South St. Francis Dr.  
Santa Fe, New Mexico 87505

Form C-102  
Revised August 1, 2011

Submit one copy to appropriate  
District Office

RECEIVED

☐ AMENDED REPORT

WELL LOCATION AND ACREAGE DEDICATION PLAT

API Number <b>30-015-42637</b>	Pool Code <b>32503250</b>	Pool Name <b>Atoka; Glorieta-Yeso</b>
Property Code <b>12179</b>	Property Name <b>DAYTON EY</b>	Well Number <b>3H</b>
OGRID No. <b>025575</b>	Operator Name <b>YATES PETROLEUM CORPORATION</b>	Elevation <b>3417</b>

Surface Location

UL or lot No.	Section	Township	Range	Lot Idn	Feet from the	North/South line	Feet from the	East/West line	County
M	21	18 S	26 E		589	SOUTH	200	WEST	EDDY

Bottom Hole Location If Different From Surface

UL or lot No.	Section	Township	Range	Lot Idn	Feet from the	North/South line	Feet from the	East/West line	County
P	21	18 S	26 E		660	SOUTH	330	EAST	EDDY

Dedicated Acres	Joint or Infill	Consolidation Code	Order No.
<b>160.00</b>			

NO ALLOWABLE WILL BE ASSIGNED TO THIS COMPLETION UNTIL ALL INTERESTS HAVE BEEN CONSOLIDATED  
OR A NON-STANDARD UNIT HAS BEEN APPROVED BY THE DIVISION

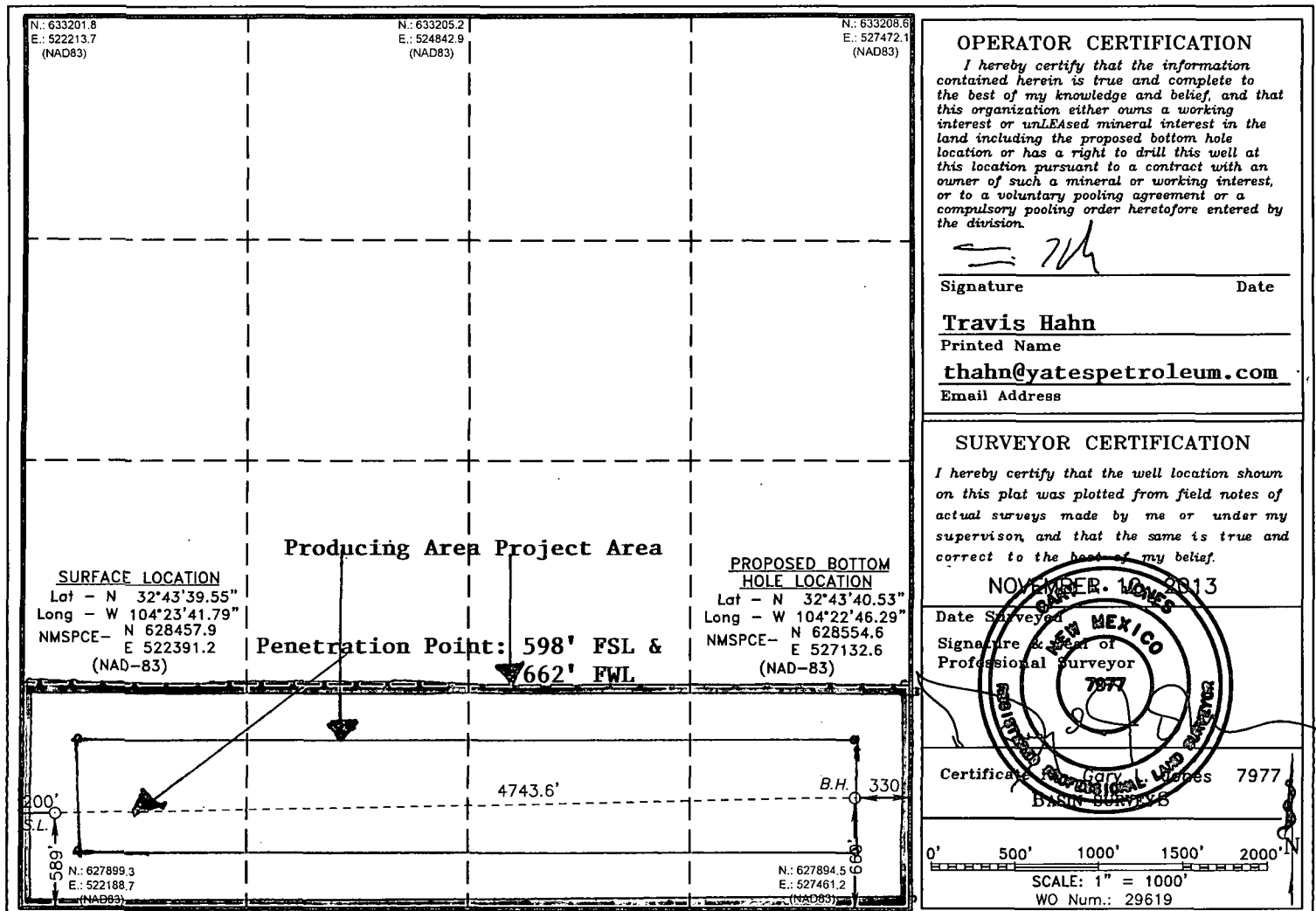

Well Name:	Dayton EY #3H	Tgt N-S:	96.70	
		Tgt E-W:	4741.40	EOC TVD/MD: 2664.62 / 2922.30
Surface Location:	Section 21 , Township 18S Range 26E	VS:	4742.39	
Bottom Hole Location:	Section 21 , Township 18S Range 26E	VS Az:	88.83	EOL TVD/MD: 2800.00 / 7202.32

MD	Inc.	Azi.	TVD	+N-S	+E-W	VS	DLS	Comments
0	0	0	0	0	0	0	0	
165.00	0.00	0.00	165.00	0.00	0.00	0.00	0.00	QUEEN
885.00	0.00	0.00	885.00	0.00	0.00	0.00	0.00	SAN ANDRES
2187.40	0.00	0.00	2187.40	0.00	0.00	0.00	0.00	KOP
2200.00	1.51	88.83	2200.00	0.00	0.17	0.17	12.00	
2225.00	4.51	88.83	2224.96	0.03	1.48	1.48	12.00	
2250.00	7.51	88.83	2249.82	0.08	4.10	4.10	12.00	
2250.18	7.53	88.83	2250.00	0.08	4.12	4.12	12.00	GLORIETA
2275.00	10.51	88.83	2274.51	0.16	8.01	8.01	12.00	
2300.00	13.51	88.83	2298.96	0.27	13.21	13.22	12.00	
2325.00	16.51	88.83	2323.10	0.40	19.69	19.69	12.00	
2350.00	19.51	88.83	2346.88	0.56	27.41	27.42	12.00	
2353.32	19.91	88.83	2350.00	0.58	28.53	28.54	12.00	YESO
2375.00	22.51	88.83	2370.21	0.74	36.38	36.38	12.00	
2400.00	25.51	88.83	2393.04	0.95	46.55	46.56	12.00	
2425.00	28.51	88.83	2415.31	1.18	57.90	57.91	12.00	
2450.00	31.51	88.83	2436.96	1.44	70.40	70.41	12.00	
2475.00	34.51	88.83	2457.92	1.71	84.01	84.03	12.00	
2500.00	37.51	88.83	2478.14	2.01	98.71	98.73	12.00	
2525.00	40.51	88.83	2497.56	2.33	114.44	114.46	12.00	
2550.00	43.51	88.83	2516.14	2.68	131.17	131.19	12.00	
2575.00	46.51	88.83	2533.81	3.04	148.84	148.87	12.00	
2600.00	49.51	88.83	2550.53	3.41	167.42	167.45	12.00	
2625.00	52.51	88.83	2566.26	3.81	186.84	186.88	12.00	
2650.00	55.51	88.83	2580.95	4.22	207.07	207.11	12.00	
2675.00	58.51	88.83	2594.56	4.65	228.03	228.08	12.00	
2700.00	61.51	88.83	2607.05	5.09	249.68	249.73	12.00	
2725.00	64.51	88.83	2618.39	5.55	271.95	272.00	12.00	
2750.00	67.51	88.83	2628.56	6.01	294.78	294.84	12.00	
2775.00	70.51	88.83	2637.51	6.49	318.11	318.18	12.00	
2800.00	73.51	88.83	2645.23	6.97	341.88	341.95	12.00	
2825.00	76.51	88.83	2651.69	7.47	366.03	366.10	12.00	
2850.00	79.51	88.83	2656.89	7.96	390.47	390.55	12.00	
2875.00	82.51	88.83	2660.79	8.47	415.16	415.24	12.00	
2900.00	85.51	88.83	2663.40	8.97	440.01	440.10	12.00	
2922.30	88.19	88.83	2664.62	9.43	462.27	462.37	12.00	YESO TARGET
7202.32	88.19	88.83	2800.00	96.70	4741.40	4742.39	0.00	EOL

# Dayton EY #3H

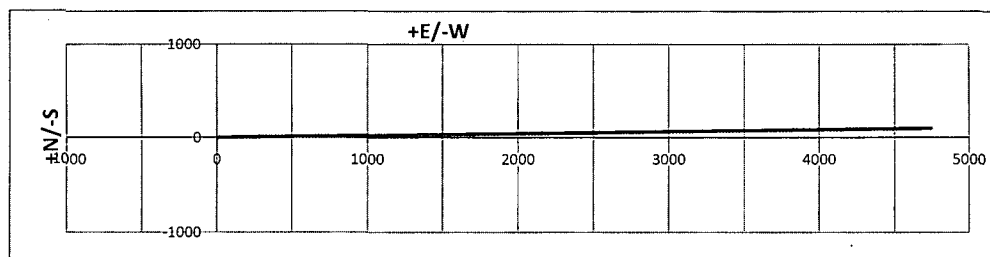
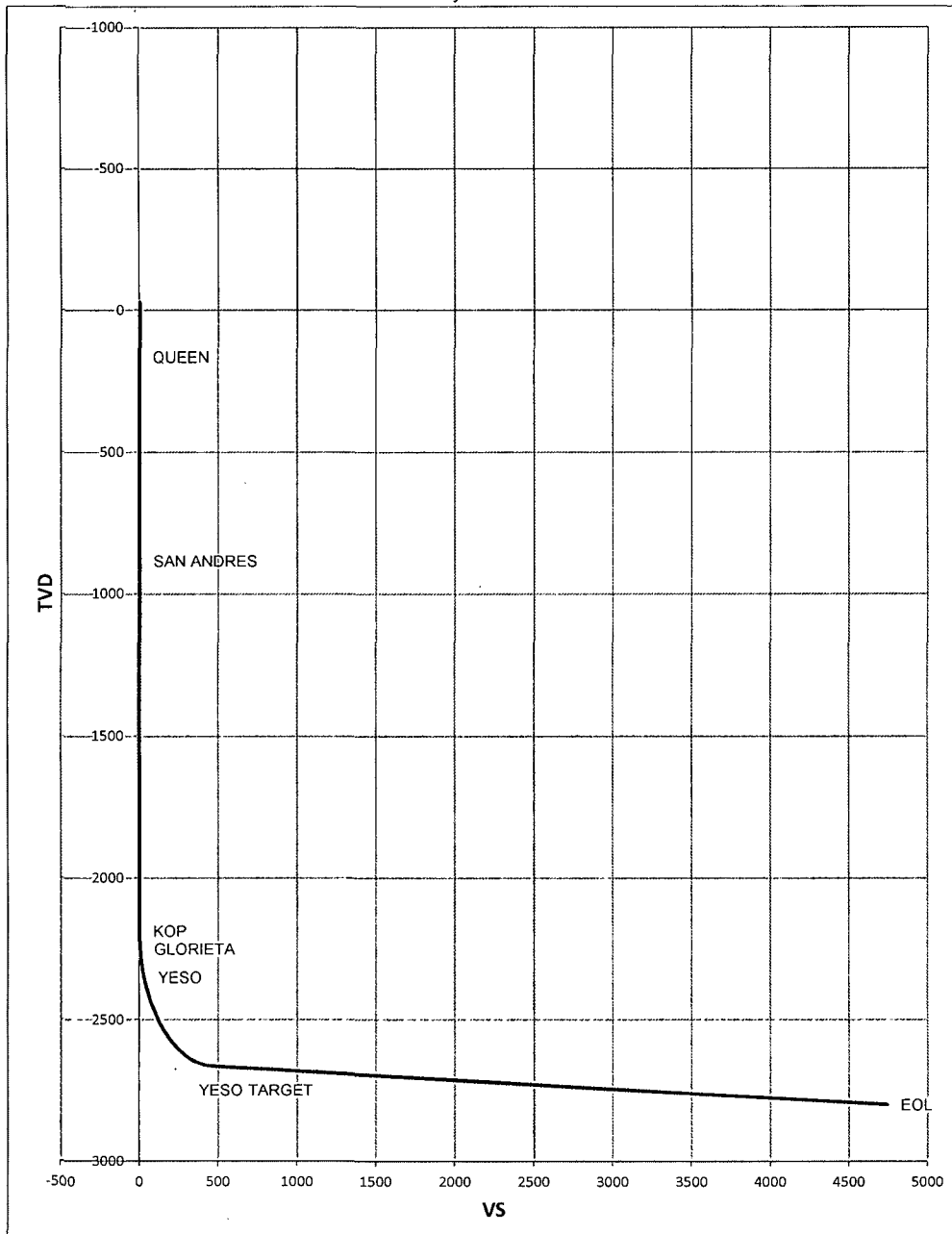

**Dayton EY #3H**

This is an open drilling site. H<sub>2</sub>S monitoring equipment and emergency response equipment will be used within 500' of zones known to contain H<sub>2</sub>S, including warning signs, wind indicators and H<sub>2</sub>S monitor.

**Dayton EY #3H**

This is an open drilling site. H<sub>2</sub>S monitoring equipment and emergency response equipment will be used within 500' of zones known to contain H<sub>2</sub>S, including warning signs, wind indicators and H<sub>2</sub>S monitor.

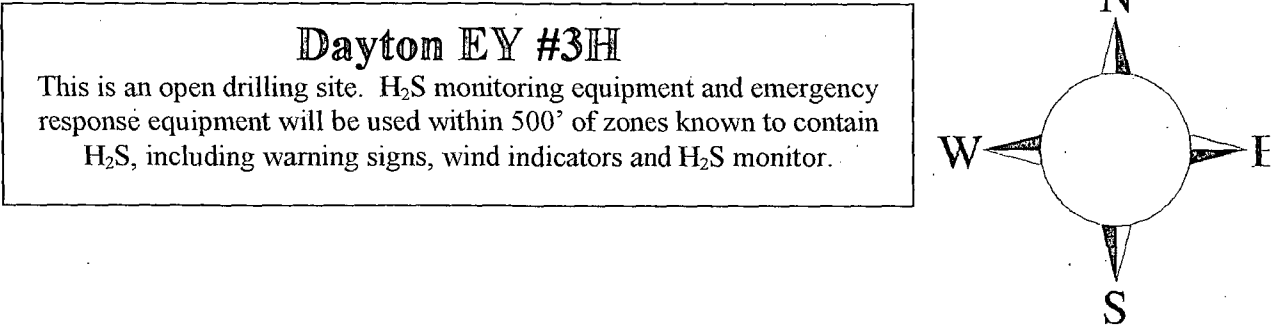

**Assumed 100 ppm ROE = 3000'**  
**100 ppm H2S concentration shall trigger activation of this plan.**

**Assumed 100 ppm ROE = 3000'**  
**100 ppm H2S concentration shall trigger activation of this plan.**

## Yates Petroleum Corporation

### Hydrogen Sulfide Drilling Operation Plan

#### I. HYDROGEN SULFIDE TRAINING

All personnel, whether regularly assigned, contracted, or employed on an unscheduled basis, will receive training from a qualified instructor in the following areas prior to commencing drilling operations on this well:

1. The hazards and characteristics of hydrogen sulfide (H<sub>2</sub>S).
2. The proper use and maintenance of personal protective equipment and life support systems.
3. The proper use of H<sub>2</sub>S detectors, alarms, warning systems, briefing areas, evacuation procedures, and prevailing winds.
4. The proper techniques for first aid and rescue procedures.

In addition, supervisory personnel will be trained in the following areas:

1. The effects of H<sub>2</sub>S on metal components. If high tensile tubular are to be used, personnel will be trained in their special maintenance requirements.
2. Corrective action and shut-in procedures when drilling or reworking a well and blowout prevention and well control procedures.
3. The contents and requirements of the H<sub>2</sub>S Drilling Operations Plan and H<sub>2</sub>S Contingency Plan.

There will be an initial training session just prior to encountering a known or probable H<sub>2</sub>S zone (within 3 days or 500 feet) and weekly H<sub>2</sub>S and well control drills for all personnel in each crew. The initial training session shall include a review of the site specific H<sub>2</sub>S Drilling Operation Plan and the H<sub>2</sub>S Contingency Plan. **The location of this well does not require a Public Protection Plan.**

## II. H2S SAFETY EQUIPMENT AND SYSTEMS

NOTE: All H2S safety equipment and systems will be installed, tested, and operational when drilling reaches a depth of 500 feet above, or three days prior to penetrating the first zone containing or reasonably expected to contain H2S.

### 1. Well Control Equipment:

- A. Flare line
- B. Choke manifold will have a remotely operated adjustable choke system.
- C. Blind rams and pipe rams to accommodate all pipe sizes with properly sized closing unit
- D. Auxiliary equipment may include if applicable: annular preventer & rotating head.
- E. Mud/Gas Separator.

### 2. Protective equipment for essential personnel:

- A. Mark II Survive Air (or equivalent) 30-minute units located in the doghouse and at briefing areas, as indicated on well site diagram.

### 3. H2S detection and monitoring equipment:

- A. 3 portable H2S monitors positioned at: Shale Shaker, Bell Nipple, and Rig Floor. These units have warning lights and audible sirens when H2S levels of 10 PPM are reached.

### 4. Visual warning systems:

- A. Wind direction indicators as shown on well site diagram (attached).
- B. Caution/Danger signs (attached) shall be posted on roads providing direct access to location. Signs will be painted with high visibility yellow with black lettering of a sufficient size to be readable at a reasonable distance from the immediate location. Bilingual signs will be used, when appropriate. See example attached.

### 5. Mud program:

- A. The mud program has been designed to minimize the volume of H2S circulated to the surface. Proper mud weight, safe drilling practices and the use of H2S scavengers will minimize hazards when penetrating H2S bearing zones.

### 6. Metallurgy:

- A. All drill strings, casings, tubing, wellhead, blowout preventer, drilling spool, kill lines, choke manifold and lines, and valves shall be suitable for H2S service.
- B. All elastomers used for packing and seals shall be H2S trim.

**7. Communication:**

- A. Cellular communications in company vehicles.
- B. Land line (telephone) communication at the Office.

**8. Well testing:**

- A. There will be no drill stem testing.

**EXHIBIT**

<b>DANGER</b>	
<b>POISONS GAS</b>	
<b>HYDROGEN SULFIDE</b>	
<input type="checkbox"/>	<b>NORMAL OPERATIONS</b>
(GREEN)	
<b>CAUTION POTENTIAL DANGER</b>	
(YELLOW)	
<input type="checkbox"/>	<b>DANGER POISONS GAS ENCOUNTERED</b>
(RED)	<b>AUTHORIZED PERSONAL ONLY.</b>
<b>LOCATION SECURED.</b>	
<b>1-575-746-1096</b>	
<b>1-877-879-8899</b>	

**EDDY COUNTY EMERGENCY NUMBERS**

ARTESIA FIRE DEPT. 575-746-5050  
ARTESIA POLICE DEPT. 575-746-5000  
EDDY CO. SHERIFF DEPT. 575-746-9888

**LEA COUNTY EMERGENCY NUMBERS**

HOBBS FIRE DEPT. 575-397-9308  
HOBBS POLICE DEPT. 575-397-9285  
LEA CO. SHERIFF DEPT. 575-396-1196

Yates Petroleum Corporation  
105 S. Fourth Street  
Artesia, NM 88210

Hydrogen Sulfide ( $H_2S$ ) Contingency Plan

For

Dayton EY #3H  
589' FSL & 200' FWL  
Section 21, T18S-R26E  
Eddy County, NM



## Emergency Procedures

In the case of a release of gas containing  $H_2S$ , the first responder(s) must isolate the area and prevent entry by other persons into the 100 ppm ROE. Additionally the first responder(s) must evacuate any public places encompassed by the 100 ppm ROE. First responder(s) must take care not to injure themselves during this operation. Company and/or local officials must be contacted to aid in this operation. Evacuation of the public should be beyond the 100 ppm ROE.

All responders must have training in the detection of  $H_2S$ , measures for protection against the gas, equipment used for protection and emergency response. Additionally, responders must be equipped with  $H_2S$  monitors and air packs in order to control the release. Use the "buddy system" to ensure no injuries during the response.

## Ignition of Gas Source

Should control of the well be considered lost and ignition considered, take care to protect against exposure to Sulfur Dioxide ( $SO_2$ ). Intentional ignition must be coordinated with the NMOCD and local officials. Additionally the NM State Police may become involved. NM State Police shall be the Incident Command on scene of any major release. Take care to protect downwind whenever there is an ignition of the gas.

## Characteristics of $H_2S$ and $SO_2$

Common Name	Chemical Formula	Specific Gravity	Threshold Limit	Hazardous Limit	Lethal Concentration
Hydrogen Sulfide	$H_2S$	1.189 Air = 1	10 ppm	100 ppm/hr	600 ppm
Sulfur Dioxide	$SO_2$	2.21 Air = 1	2 ppm	N/A	1000 ppm

## Contacting Authorities

YPC personnel must liaison with local and state agencies to ensure a proper response to a major release. Additionally, the OCD must be notified of the release as soon as possible but no later than 4 hours. Agencies will ask for information such as type and volume of release, wind direction, location of release, etc. Be prepared with all information available. The following call list of essential and potential responders has been prepared for use during a release. YPC Company response must be in coordination with the State of New Mexico's 'Hazardous Materials Emergency Response Plan' (HMER)

## ***Yates Petroleum Corporation Phone Numbers***

---

YPC Office .....	(575) 748-1471
Wade Bennett/Prod Superintendent .....	(575) 748-4236
LeeRoy Richards/Assistant Prod Superintendent .....	(575) 748-4228
Mike Larkin/Drilling .....	(575) 748-4222
Paul Hanes/Prod. Foreman/Roswell .....	(575) 624-2805
Tim Bussell/Drilling Superintendent .....	(575) 748-4221
Artesia Answering Service .....	(575) 748-4302
(During non-office hours)	

### **Agency Call List**

#### **Eddy County (575)**

##### **Artesia**

State Police .....	746-2703
City Police .....	746-2703
Sheriff's Office .....	746-9888
Ambulance .....	911
Fire Department .....	746-2701
LEPC (Local Emergency Planning Committee) .....	746-2122
NMOCD .....	748-1283

##### **Carlsbad**

State Police .....	885-3137
City Police .....	885-2111
Sheriff's Office .....	887-7551
Ambulance .....	911
Fire Department .....	885-2111
LEPC (Local Emergency Planning Committee) .....	887-3798
US Bureau of Land Management .....	887-6544
New Mexico Emergency Response Commission (Santa Fe) ..	(505) 476-9600
24 HR .....	(505) 827-9126
New Mexico State Emergency Operations Center .....	(505) 476-9635
National Emergency Response Center (Washington, DC) ...	(800) 424-8802

##### **Other**

Boots & Coots IWC .....	1-800-256-9688 or (281) 931-8884
Cudd Pressure Control .....	(915) 699-0139 or (915) 563-3356
Halliburton .....	(575) 746-2757
B. J. Services .....	(575) 746-3569

Flight For Life -4000 24th St, Lubbock, TX .....	(806) 743-9911
Aerocare -Rr 3 Box 49f, Lubbock, TX .....	(806) 747-8923
Med Flight Air Amb 2301 Yale Blvd SE #D3, Albuq, NM .....	(505) 842-4433
S B Air Med Svc 2505 Clark Carr Loop SE, Albuq, NM .....	(505) 842-4949