

# NM OIL CONSERVATION

DISTRICT I  
1625 N. French Dr., Hobbs, NM 88240

DISTRICT II  
1301 W. Grand Avenue, Artesia, NM 88210

DISTRICT III  
1000 Rio Brazos Rd., Aztec, NM 87410

DISTRICT IV  
1220 S. St. Francis Dr., Santa Fe, NM 87505

ARTESIA DISTRICT

SEP 29 2014

State of New Mexico  
Energy, Minerals and Natural Resources Department

Form C-102  
Revised July 16, 2010

Submit one copy to appropriate  
District Office

RECEIVED OIL CONSERVATION DIVISION  
1220 South St. Francis Dr.  
Santa Fe, New Mexico 87505

## WELL LOCATION AND ACREAGE DEDICATION PLAT

AMENDED REPORT  
"As Drilled"

API Number <b>30-015-40397</b>	Pool Code <b>49600</b>	Pool Name <b>PARALLEL; DELAWARE</b>
Property Code <b>305860</b>	Property Name <b>BIG EDDY UNIT DIS</b>	Well Number <b>4H</b>
OGRID No. <b>260737</b>	Operator Name <b>BOPCO, L.P.</b>	Elevation <b>3523'</b>

### Surface Location

UL or lot No.	Section	Township	Range	Lot Idn	Feet from the	North/South line	Feet from the	East/West line	County
G	27	20 S	31 E		1980	NORTH	1848	EAST	EDDY

### Bottom Hole Location If Different From Surface

UL or lot No.	Section	Township	Range	Lot Idn	Feet from the	North/South line	Feet from the	East/West line	County
H	25	20 S	31 E		2049	NORTH	350	EAST	EDDY

Dedicated Acres	Joint or Infill	Consolidation Code	Order No.
400			

NO ALLOWABLE WILL BE ASSIGNED TO THIS COMPLETION UNTIL ALL INTERESTS HAVE BEEN CONSOLIDATED  
OR A NON-STANDARD UNIT HAS BEEN APPROVED BY THE DIVISION

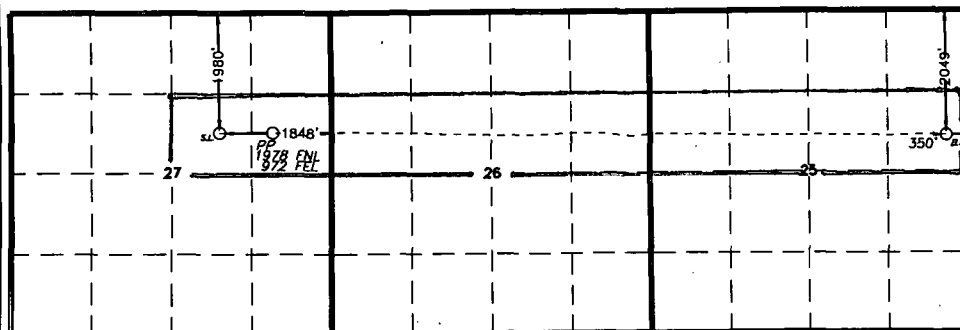

**SURFACE LOCATION**  
Lat - N 32°32'45.49"  
Long - W 103°51'14.19"  
NMSPCE- N 562668.476  
E 647722.356  
(NAD-27)

**BOTTOM HOLE LOCATION**  
Lat - N 32°32'44.93"  
Long - W 103°48'53.39"  
NMSPCE- N 562668.5  
E 659774.8  
(NAD-27)

SCALE 1" = 3000'

### OPERATOR CERTIFICATION

I hereby certify that the information contained herein is true and complete to the best of my knowledge and belief, and that this organization either owns a working interest or unleased mineral interest in the land including the proposed bottom hole location or has a right to drill this well at this location pursuant to a contract with an owner of such a mineral or working interest, or to a voluntary pooling agreement or a compulsory pooling order heretofore entered by the division.

Signature Tracie J Cherry Date 09/24/14

Printed Name Tracie J Cherry

Email Address tjcherry@basspet.com

### SURVEYOR CERTIFICATION

I hereby certify that the well location shown on this plat was plotted from field notes of actual surveys made by me or under my supervision and that the same is true and correct to the best of my belief.

Date Surveyed January 19, 2012  
Signature & Seal of Professional Surveyor Gary L. Jones

Certificate No. Gary L. Jones 7977

BASIN SURVEYS 26030