

District I  
1625 N. French Dr., Hobbs, NM 88240  
Phone: (575) 393-6161 Fax: (575) 393-0720  
District II  
811 S. First St., Artesia, NM 88210  
Phone: (575) 748-1283 Fax: (575) 748-9720  
District III  
1000 Rio Brazos Road, Aztec, NM 87410  
Phone: (505) 334-6178 Fax: (505) 334-6170  
District IV  
1220 S. St. Francis Dr., Santa Fe, NM 87505  
Phone: (505) 476-3460 Fax: (505) 476-3462

**NM OIL CONSERVATION**  
ARTESIA DISTRICT

JUN 29 2015

RECEIVED

State of New Mexico

**NM OIL CONSERVATION**  
ARTESIA DISTRICT

JUN 1 2015

RECEIVED

Form C-101  
Revised July 18, 2013

Energy Minerals and Natural Resources

Oil Conservation Division

1220 South St. Francis Dr.

Santa Fe, NM 87505

☐ AMENDED REPORT

**APPLICATION FOR PERMIT TO DRILL, RE-ENTER, DEEPEN, PLUGBACK, OR ADD A ZONE**

1. Operator Name and Address BC Operating, Inc. P.O. Box 50820 Midland, Texas 79710		2. OGRID Number 160825
		3. API Number 30-015-24097
4. Property Code 26417	5. Property Name Smith, 10 Corn	6. Well No. 1

**7. Surface Location**

UL - Lot	Section	Township	Range	Lot Idn	Feet from	N/S Line	Feet From	E/W Line	County
G	10	24S	27E		2310	North	1980	East	Eddy

**8. Proposed Bottom Hole Location**

UL - Lot	Section	Township	Range	Lot Idn	Feet from	N/S Line	Feet From	E/W Line	County

**9. Pool Information**

Pool Name	Pool Code
Wildcat; Upper Penn	

**Additional Well Information**

11. Work Type PB / Recompletion	12. Well Type Gas	13. Cable/Rotary Rotary	14. Lease Type Fee	15. Ground Level Elevation 3128'
16. Multiple No	17. Proposed Depth 11,600'	18. Formation Penn	19. Contractor TBD	20. Spud Date 2/22/1982
Depth to Ground water		Distance from nearest fresh water well		Distance to nearest surface water

☒ We will be using a closed-loop system in lieu of lined pits

**21. Proposed Casing and Cement Program**

Type	Hole Size	Casing Size	Casing Weight/ft	Setting Depth	Sacks of Cement	Estimated TOC
Surface	17 1/2"	13 3/8"	48#	550'	725	0'
Intermediate	12 1/4"	9 5/8"	47#	2150'	1700	0'
Production	8 1/2"	7"	23#	10,500'	1325	TBD

**Casing/Cement Program: Additional Comments**

Will get TOC on production casing with log.

**22. Proposed Blowout Prevention Program**

Type	Working Pressure	Test Pressure	Manufacturer
Double Ram Annular	3000#	2000#	Hydrill/Shaeffer

23. I hereby certify that the information given above is true and complete to the best of my knowledge and belief.  
I further certify that I have complied with 19.15.14.9 (A) NMAC ☒ and/or 19.15.14.9 (B) NMAC ☒, if applicable.  
Signature: *Pam Stevens*

Printed name: Pam Stevens

Title: Regulatory Analyst

E-mail Address: pstevens@bcoperating.com

Date: 05/12/2015

Phone: 432-684-9696

**OIL CONSERVATION DIVISION**

Approved By:

Title:

Approved Date:

Expiration Date:

Conditions of Approval Attached

**00 Denied**

*Submit "New" updated C-102 + resubmit  
Please see attached.*

JUN 29 2015

N MEXICO OIL CONSERVATION COMMISS  
WELL LOCATION AND ACREAGE DEDICATION PLAT

Form C-102  
Supersedes C-128  
Effective 1-4-65

All distances must be from the outer boundaries of the Section.

Operator <b>BC OPERATING INC.</b>		Lease <b>SMITH 10 COM</b>		Well No. <b>#1</b>
Unit Letter <b>G</b>	Section <b>10</b>	Township <b>T-24-S</b>	Range <b>R-27-E</b>	County <b>EDDY</b>
Actual Footage Location of Well: <b>2310</b> feet from the <b>NORTH</b> line and <b>1980</b> feet from the <b>EAST</b> line				
Ground Level Elev. <b>3128'</b>	Producing Formation <b>PENN</b>	Pool <b>WILD CAT; UPPER PENN</b>	Dedicated Acreage: <b>320</b> Acres	

1. Outline the acreage dedicated to the subject well by colored pencil or hatchure marks on the plat below.
2. If more than one lease is dedicated to the well, outline each and identify the ownership thereof (both as to working interest and royalty).
3. If more than one lease of different ownership is dedicated to the well, have the interests of all owners been consolidated by communitization, unitization, force-pooling, etc?

☐ Yes ☒ No If answer is "yes," type of consolidation \_\_\_\_\_

If answer is "no," list the owners and tract descriptions which have actually been consolidated. (Use reverse side of this form if necessary.) \_\_\_\_\_

No allowable will be assigned to the well until all interests have been consolidated (by communitization, unitization, forced-pooling, or otherwise) or until a non-standard unit, eliminating such interests, has been approved by the Commission.

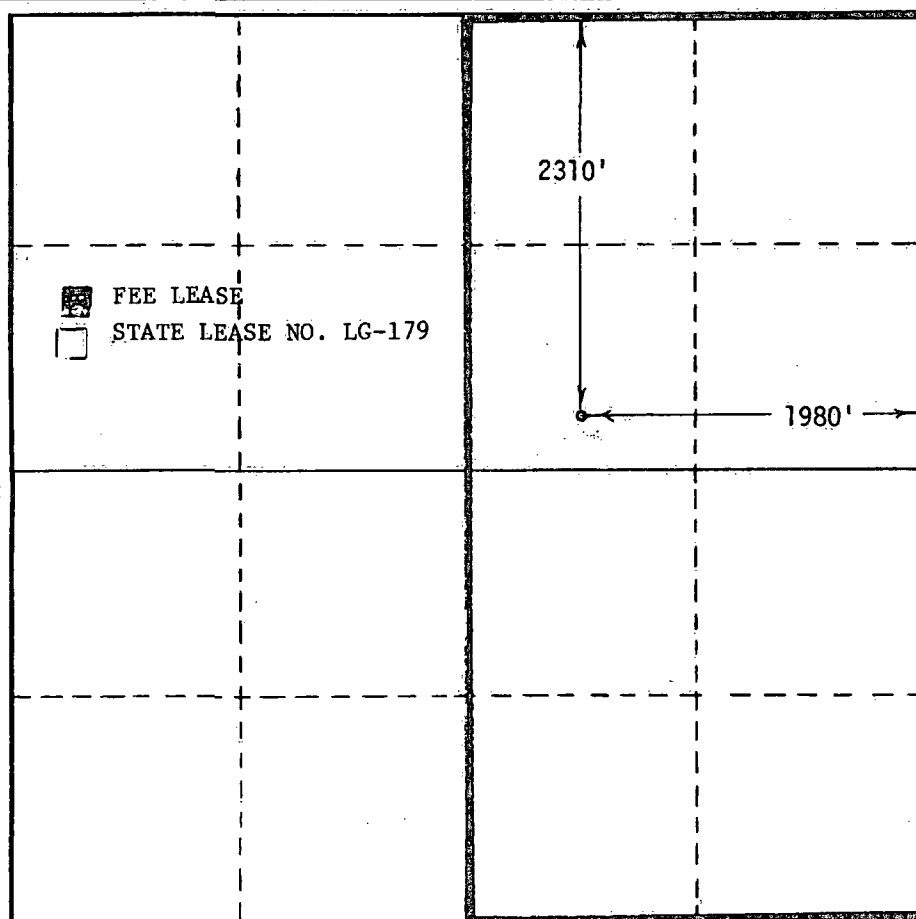

CERTIFICATION

I hereby certify that the information contained herein is true and complete to the best of my knowledge and belief.

*Betty Gildon*

Name  
**Betty Gildon**

Position  
**Regulatory Analyst**

Company  
**HNG OIL COMPANY**

Date  
**February 5, 1982**

I hereby certify that the well location shown on this plat was plotted from field notes of actual surveys made by me or under my supervision, and that the same is true and correct to the best of my knowledge and belief.

**4 FEBRUARY 1982**

Date Surveyed  
**GARY D. BOSWELL**

Registered Professional Engineer and/or Land Surveyor

*Gary D. Boswell*

Certificate No.  
**6689**

