

District I
1625 N. French Dr., Hobbs, NM 88240
District II
1301 W. Grand Avenue, Artesia, NM 88210
District III
1000 Rio Brazos Rd., Aztec, NM 87410
District IV
1220 S. St. Francis Dr., Santa Fe, NM 87505

State of New Mexico
Energy, Minerals & Natural Resources Department
OIL CONSERVATION DIVISION
1220 South St. Francis Dr.
Santa Fe, NM 87505

Form C-102
Revised October 12, 2005
Appropriate District Office
State Lease - 4 Copies
Fee Lease - 3 Copies

NEW MEXICO OIL CONSERVATION
ARTESIA DISTRICT
FEB 29 2016
RECEIVED

☒ AMENDED REPORT

WELL LOCATION AND ACREAGE DEDICATION PLAT

¹ API Number 30-015-41942	² Pool Code 96831	³ Pool Name Cedar Lake, Glorieta - Yeso
⁴ Property Code 315935	⁵ Property Name Cedar Lake Federal C A	⁶ Well Number 126H
⁷ OGRID No. 873	⁸ Operator Name Apache Corporation: 303 Veterans Airpark Lane, Suite 1000 Midland, TX 79705	⁹ Elevation

¹⁰ Surface Location

UL or lot no.	Section	Township	Range	Lot Idn	Feet from the	North/South line	Feet from the	East/West line	County
									Eddy Co, NM

¹¹ Bottom Hole Location If Different From Surface

UL or lot no.	Section	Township	Range	Lot Idn	Feet from the	North/South line	Feet from the	East/West line	County
¹² Dedicated Acres	¹³ Joint or Infill	¹⁴ Consolidation Code	¹⁵ Order No. SEE ATTACHED - ORIGINAL C-102						

No allowable will be assigned to this completion until all interests have been consolidated or a non-standard unit has been approved by the division.

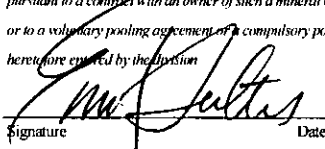
16					<p>¹⁷ OPERATOR CERTIFICATION</p> <p>I hereby certify that the information contained herein is true and complete to the best of my knowledge and belief, and that this organization either owns a working interest or unleased mineral interest in the land including the proposed bottom hole location or has a right to drill this well at this location pursuant to a contract with an owner of such a mineral or working interest, or to a voluntary pooling agreement or a compulsory pooling order heretofore entered by the Division.</p> <p> 02/16/2016 Signature Date Emily Follis Printed Name</p>
					<p>¹⁸ SURVEYOR CERTIFICATION</p> <p>I hereby certify that the well location shown on this plat was plotted from field notes of actual surveys made by me or under my supervision, and that the same is true and correct to the best of my belief.</p> <p>Date of Survey Signature and Seal of Professional Surveyor: Certificate Number</p>

DISTRICT I

1625 N. French Dr., Hobbs, NM 88240
Phone: (575) 393-6161 Fax: (575) 393-6162

DISTRICT II

811 S. First St., Artesia, NM 88210
Phone: (575) 748-1283 Fax: (575) 748-9720

DISTRICT III

1000 Rio Brazos Road, Aztec, NM 87410
Phone: (505) 334-6178 Fax: (505) 334-6170

DISTRICT IV

1220 S. St. Francis Dr., Santa Fe, NM 87505
Phone: (505) 476-3460 Fax: (505) 476-3462NM OIL CONSERVATION
ARTESIA DISTRICT
FEB 29 2015State of New Mexico
Energy, Minerals & Natural Resources Department

NM OIL CONSERVATION

ARTESIA DISTRICT

JAN 05 2015

Form C-102

Revised August 1, 2011

Submit one copy to appropriate
District Office

OIL CONSERVATION DIVISION

1220 South St. Francis Dr.
Santa Fe, New Mexico 87505

RECEIVED

□ AMENDED REPORT

WELL LOCATION AND ACREAGE DEDICATION PLAT

API Number 30-15-41942	Pool Code 26770	Pool Name FREN; GLORIETA-YESO
Property Code 26770	Property Name CROW FEDERAL	Well Number 26H
OGRID No. 873	Operator Name APACHE CORPORATION	Elevation 3941'

Surface Location

UL or lot No.	Section	Township	Range	Lot Idn	Feet from the	North/South line	Feet from the	East/West line	County
H	10	17-S	31-E		1650	NORTH	330	EAST	EDDY

As-Drilled Bottom Hole Location If Different From Surface

UL or lot No.	Section	Township	Range	Lot Idn	Feet from the	North/South line	Feet from the	East/West line	County
E	10	17-S	31-E		1642.7	NORTH	331.7	WEST	EDDY

Penetration Point Location

UL or lot No.	Section	Township	Range	Lot Idn	Feet from the	North/South line	Feet from the	East/West line	County
H	10	17-S	31-E		1633.3	NORTH	359.2	EAST	EDDY

Dedicated Acres	Joint or Infill	Consolidation Code	Order No.
160			

NO ALLOWABLE WILL BE ASSIGNED TO THIS COMPLETION UNTIL ALL INTERESTS HAVE BEEN CONSOLIDATED OR A NON-STANDARD UNIT HAS BEEN APPROVED BY THE DIVISION

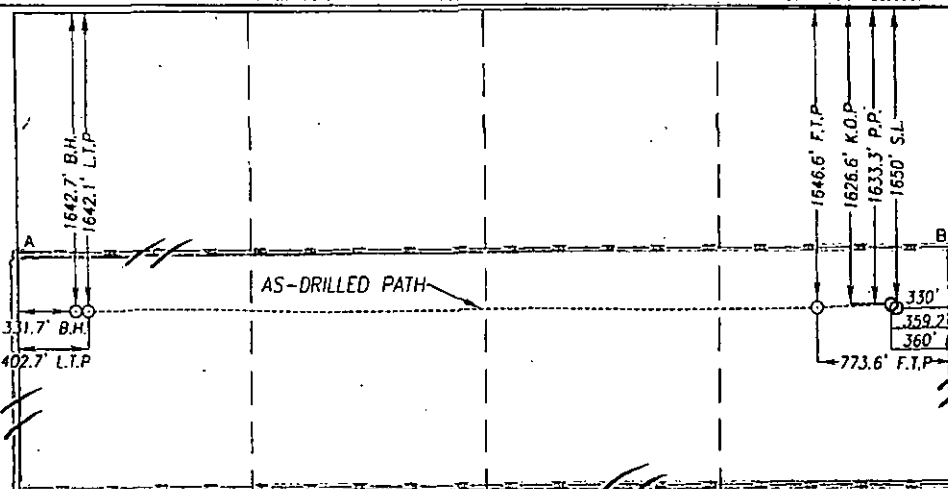

OPERATOR CERTIFICATION

I hereby certify that the information herein is true and complete to the best of my knowledge and belief, and that this organization either owns a working interest or unleased mineral interest in the land including the proposed bottom hole location or has a right to drill this well at this location pursuant to a contract with an owner of such mineral or working interest, or to a voluntary pooling agreement or a compulsory pooling order heretofore entered by the division.

Sandra J. Belt 12-29-14
Signature Date

Sandra J. Belt
Printed Name

Sandra.belt@apachecorp.com
E-mail Address

SURVEYOR CERTIFICATION

I hereby certify that the well location shown on this plat was plotted from field notes of actual surveys made by me or under my supervision, and that the same is true and correct to the best of my belief.

MAY 16, 2012

Date of Survey
Signature of Professional Surveyor:

RONALD J. EIDSON
NEW MEXICO
3239
Certified Number 3239
Gary B. Eidson 12641
Ronald J. Eidson 3239
ACK REL. W.O. 12/14/15 JWSC W.O. 14.13.0640

C GEODETIC COORDINATES

NAD 27 NME

AS-DRILLED

BOTTOM HOLE LOCATION

Y=673890.4 N

X=643972.8 E

LAT.=32.851731° N

LONG.=103.864514° W

LAT.=32° 51' 06" N

LONG.=103° 51' 52" W

GEODETIC COORDINATES

NAD 27 NME

LAST TAKE POINT

Y=673891.5 N

X=644043.8 E

LAT.=32.851733° N

LONG.=103.864283° W

LAT.=32° 51' 06" N

LONG.=103° 51' 51" W

GEODETIC COORDINATES

NAD 27 NME

KICK OFF POINT

Y=673937.7 N

X=648561.5 E

LAT.=32.851804° N

LONG.=103.849571° W

LAT.=32° 51' 06" N

LONG.=103° 50' 58" W

GEODETIC COORDINATES

NAD 27 NME

SURFACE LOCATION

Y=673914.5 N

X=648591.6 E

LAT.=32.851740° N

LONG.=103.849474° W

LAT.=32° 51' 06" N

LONG.=103° 50' 58" W

CORNER COORDINATES TABLE

NAD 27 NME

A - Y=674209.2 N, X=643639.5 E

B - Y=674246.0 N, X=648919.7 E

C - Y=672888.0 N, X=643646.5 E

D - Y=672925.7 N, X=648927.0 E

NOTE: AS-DRILLED BOTTOM HOLE AND PENETRATION
POINT PLOTTED FROM DATA FURNISHED BY
PHOENIX TECHNOLOGY SERVICES.

GEODETIC COORDINATES

NAD 27 NME

FIRST TAKE POINT

Y=673914.9 N

X=648148.0 E

LAT.=32.851746° N

LONG.=103.850918° W

LAT.=32° 51' 06" N

LONG.=103° 51' 03" W

GEODETIC COORDINATES

NAD 27 NME

PENETRATION POINT

Y=673930.9 N

X=648562.2 E

LAT.=32.851785° N

LONG.=103.849569° W

LAT.=32° 51' 06" N

LONG.=103° 50' 58" W