

Submit 1 Copy To Appropriate District  
Office  
District I - (575) 393-6161  
1625 N. French Dr., Hobbs, NM 88240  
District II - (575) 748-1283  
811 S. First St., Artesia, NM 88210  
District III - (505) 334-6178  
1000 Rio Brazos Rd., Aztec, NM 87410  
District IV - (505) 476-3460  
1220 S. St. Francis Dr., Santa Fe, NM  
87505

State of New Mexico  
Energy, Minerals and Natural Resources

OIL CONSERVATION DIVISION  
1220 South St. Francis Dr.  
Santa Fe, NM 87505

Form C-103  
Revised July 18, 2013

<b>SUNDRY NOTICES AND REPORTS ON WELLS</b> (DO NOT USE THIS FORM FOR PROPOSALS TO DRILL OR TO DEEPEN OR PLUG BACK TO A DIFFERENT RESERVOIR. USE "APPLICATION FOR PERMIT" (FORM C-101) FOR SUCH PROPOSALS.)		WELL API NO. 30-015-42728
1. Type of Well: Oil Well <input type="checkbox"/> Gas Well <input checked="" type="checkbox"/> Other <input type="checkbox"/>		5. Indicate Type of Lease STATE <input checked="" type="checkbox"/> FEE <input type="checkbox"/>
2. Name of Operator BC OPERATING, INC.		6. State Oil & Gas Lease No.
3. Address of Operator P.O. BOX 50820 MIDLAND, TX 79710		7. Lease Name or Unit Agreement Name BLACK RIVER 10 STATE COM
4. Well Location Unit Letter <u>B</u> : <u>240</u> feet from the <u>NORTH</u> line and <u>1680</u> feet from the <u>EAST</u> line Section <u>15</u> Township <u>24S</u> Range <u>27E</u> NMPM <u>EDDY</u> County		8. Well Number <u>2H</u>
11. Elevation (Show whether DR, RKB, RT, GR, etc.) 3192' GL		9. OGRID Number 160825
		10. Pool name or Wildcat BLACK RIVER; WOLFCAMP (GAS)

12. Check Appropriate Box to Indicate Nature of Notice, Report or Other Data

NOTICE OF INTENTION TO:		SUBSEQUENT REPORT OF:	
PERFORM REMEDIAL WORK <input type="checkbox"/>	PLUG AND ABANDON <input type="checkbox"/>	REMEDIAL WORK <input type="checkbox"/>	ALTERING CASING <input type="checkbox"/>
TEMPORARILY ABANDON <input type="checkbox"/>	CHANGE PLANS <input type="checkbox"/>	COMMENCE DRILLING OPNS. <input type="checkbox"/>	P AND A <input type="checkbox"/>
PULL OR ALTER CASING <input type="checkbox"/>	MULTIPLE COMPL <input type="checkbox"/>	CASING/CEMENT JOB <input type="checkbox"/>	
DOWNHOLE COMMINGLE <input type="checkbox"/>			
CLOSED-LOOP SYSTEM <input type="checkbox"/>			
OTHER: <input checked="" type="checkbox"/>		OTHER: <input type="checkbox"/>	

13. Describe proposed or completed operations. (Clearly state all pertinent details, and give pertinent dates, including estimated date of starting any proposed work). SEE RULE 19.15.7.14 NMAC. For Multiple Completions: Attach wellbore diagram of proposed completion or recompletion.

BC OPERATING, INC. RESPECTFULLY REQUESTS TO EXTEND THE CURRENT DRILLING PERMIT FOR 1 YEAR. THE CEMENT AND CASING WILL BE THE SAME AS LISTED ON THE ORIGINAL DRILLING PERMIT.

CURRENT EXPIRATION DATE: OCTOBER 14, 2016

**Additional requests for extension**

Must be accompanied by current work plan and current C-102

Spud Date:

Rig Release Date:

I hereby certify that the information above is true and complete to the best of my knowledge and belief.

SIGNATURE Sarah Presley TITLE REGULATORY ANALYST DATE 10/14/2016

Type or print name SARAH PRESLEY E-mail address: SPRESLEY@BCOPERATING.COM PHONE: 432-684-9696

**For State Use Only**

APPROVED BY: Karen Sharp TITLE Bus Oper Spec-Adm DATE 10-17-16  
Conditions of Approval (if any):

District I  
1625 N. French Dr., Hobbs, NM 88240  
Phone: (575) 393-6161 Fax: (575) 393-0720  
District II  
811 S. First St., Artesia, NM 88210  
Phone: (575) 748-1283 Fax: (575) 748-9720  
District III  
1000 Rio Brazos Road, Aztec, NM 87410  
Phone: (505) 334-6178 Fax: (505) 334-6170  
District IV  
1220 S. St. Francis Dr., Santa Fe, NM 87505  
Phone: (505) 476-3460 Fax: (505) 476-3462

State of New Mexico  
Energy, Minerals & Natural Resources Department  
OIL CONSERVATION DIVISION  
1220 South St. Francis Dr.  
Santa Fe, NM 87505

Form C-102  
Revised August 1, 2011  
Submit one copy to appropriate  
District Office  
☐ AMENDED REPORT

WELL LOCATION AND ACREAGE DEDICATION PLAT

<sup>1</sup> API Number 30-015-42728	<sup>2</sup> Pool Code 97442	<sup>3</sup> Pool Name BLACK RIVER; WOLFCAMP (GAS)
<sup>4</sup> Property Code 313739	<sup>5</sup> Property Name BLACK RIVER 10 STATE COM	<sup>6</sup> Well Number 2H
<sup>7</sup> OGRID No. 160825	<sup>8</sup> Operator Name B.C. OPERATING, INC.	<sup>9</sup> Elevation 3192'

<sup>10</sup> Surface Location

UL or lot no.	Section	Township	Range	Lot Idn	Feet from the	North/South line	Feet from the	East/West line	County
B	15	T24S	R27E		240'	NORTH	1680'	EAST	EDDY

<sup>11</sup> Bottom Hole Location If Different From Surface

UL or lot no.	Section	Township	Range	Lot Idn	Feet from the	North/South line	Feet from the	East/West line	County
B	10	T24S	R27E		240'	NORTH	1680'	EAST	EDDY

<sup>12</sup> Dedicated Acres 320.00	<sup>13</sup> Joint or Infill	<sup>14</sup> Consolidation Code	<sup>15</sup> Order No.
---	-------------------------------	----------------------------------	-------------------------

No allowable will be assigned to this completion until all interests have been consolidated or a non-standard unit has been approved by the division.

<p><sup>16</sup> SECTION 4</p> <p>SECTION 9</p> <p>SECTION 10</p> <p>BOTTOM HOLE LOCATION 240' FNL 1680' FEL NAD 83, SPCS NM EAST X:590144.83' / Y:450483.74' LAT:32.23835712N / LDN:104.17547461W NAD 27, SPCS NM EAST X:548962.08' / Y:450425.42' LAT:32.23823730N / LDN:104.17497771W</p> <p>LAST TAKE POINT 330' FNL 1680' FEL NAD 83, SPCS NM EAST X:590143.34' / Y:450393.71' LAT:32.23810964N / LDN:104.17547341W NAD 27, SPCS NM EAST X:548962.59' / Y:450333.39' LAT:32.23798981N / LDN:104.17497651W</p> <p>FIRST TAKE POINT 330' FNL 1680' FEL NAD 83, SPCS NM EAST X:590168.84' / Y:445741.88' LAT:32.22532215N / LDN:104.17541949W NAD 27, SPCS NM EAST X:548986.01' / Y:445683.65' LAT:32.22520215N / LDN:104.17492293W</p> <p>SURFACE HOLE LOCATION 240' FNL 1680' FEL NAD 83, SPCS NM EAST X:590174.68' / Y:445371.78' LAT:32.22375498N / LDN:104.17540334W NAD 27, SPCS NM EAST X:548991.83' / Y:445311.36' LAT:32.22363496N / LDN:104.17496833W</p> <p>SECTION 9</p> <p>SECTION 16</p> <p>CORNER COORDINATES NAD 83, SPCS NM EAST A - Y: 450743.64' / X: 589192.43' B - Y: 450688.80' / X: 591823.83' C - Y: 445391.38' / X: 591850.64' D - Y: 445423.66' / X: 589198.69' NAD 27, SPCS NM EAST A - Y: 450685.32' / X: 548009.70' B - Y: 450630.45' / X: 550641.05' C - Y: 445333.13' / X: 550667.77' D - Y: 445365.44' / X: 548015.87'</p>	<p>SECTION 3</p> <p>SECTION 10</p> <p>SECTION 11</p> <p>SECTION 14</p> <p>SECTION 15</p> <p>SECTION 16</p>	<p>240'</p> <p>1680'</p> <p>330'</p> <p>LAST TAKE POINT</p> <p>PRODUCING AREA</p> <p>FIRST TAKE POINT</p> <p>240'</p> <p>1680'</p> <p>330'</p>	<p><sup>17</sup> OPERATOR CERTIFICATION</p> <p>I hereby certify that the information contained herein is true and complete to the best of my knowledge and belief, and that this organization either owns a working interest or unleased mineral interest in the land including the proposed bottom hole location or has a right to drill this well at this location pursuant to a contract with an owner of such a mineral or working interest, or to a voluntary pooling agreement or a compulsory pooling order heretofore entered by the division.</p> <p><i>Sarah Presley</i> 10-14-16 Signature Date</p> <p>SARAH PRESLEY Printed Name</p> <p>SPRESLEY@BCOPERATING.COM E-mail Address</p> <p><sup>18</sup> SURVEYOR CERTIFICATION</p> <p>I hereby certify that the well location shown on this plat was plotted from field notes of actual surveys made by me or under my supervision, and that the same is true and correct to the best of my belief.</p> <p>SEPTEMBER 22, 2014 Date of Survey</p> <p><i>Lloyd P. Short</i> Signature and Seal of Professional Surveyor</p> <p>21653 Certificate Number</p> <p>LLOYD P. SHORT PROFESSIONAL SURVEYOR NEW MEXICO 21653</p>
--	--	--	---

# LOCATION VERIFICATION MAP

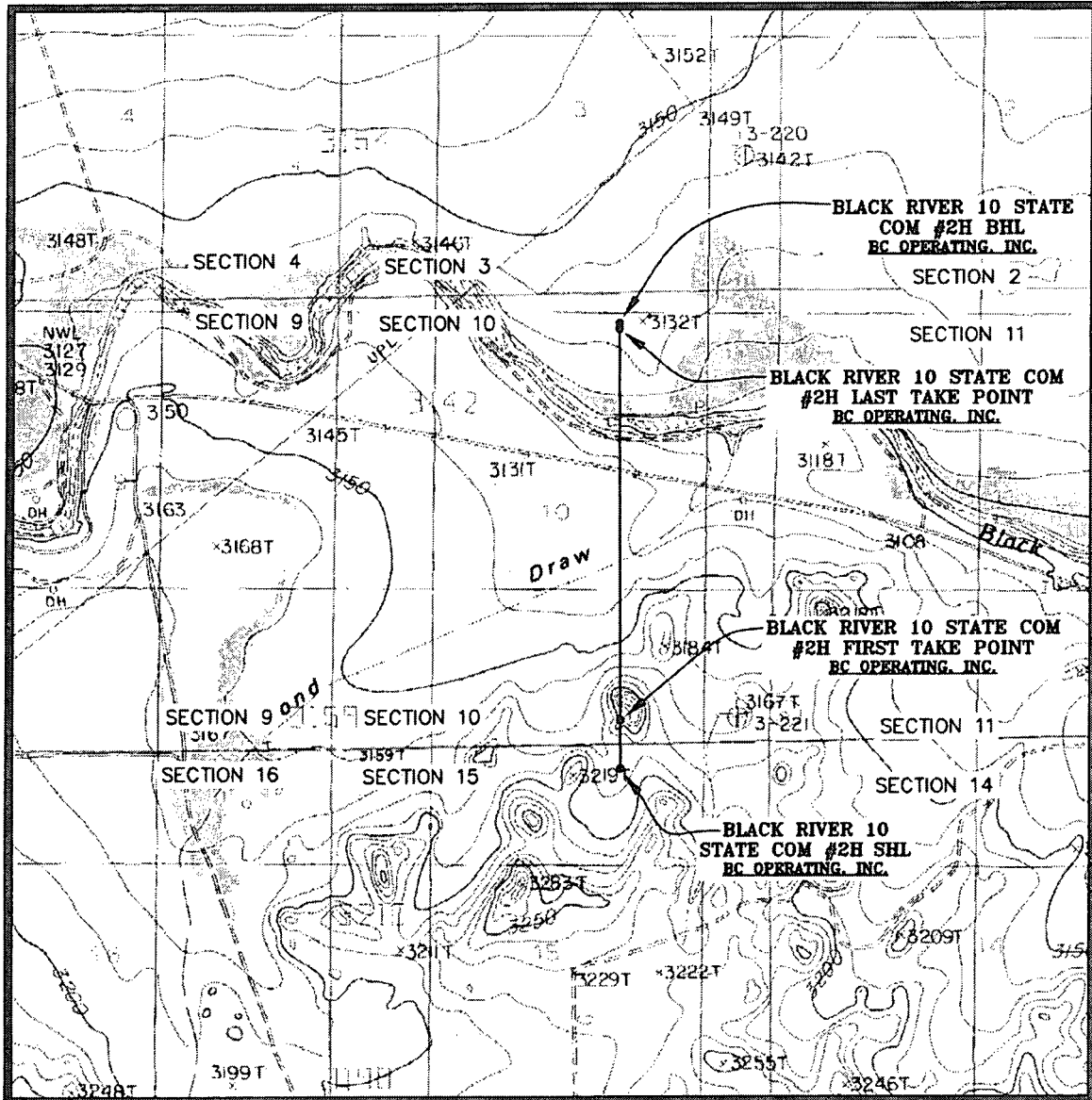

SEC. 15 TWP. 24-S RGE. 27-E  
 SURVEY: N.M.P.M.  
 COUNTY: EDDY  
 DESCRIPTION: 240' FNL & 1680' FEL  
 ELEVATION: 3192'  
 OPERATOR: B.C. OPERATING, INC.  
 EDDYSE: BLACK RIVER 10 STATE COM  
 U.S.G.S. TOPOGRAPHIC MAP: BOND DRAW, N.M.

SCALE: 1" = 2000'  
 CONTOUR INTERVAL = 10'

PREPARED BY:  
 R-SQUARED GLOBAL, LLC  
 1309 LOUISVILLE AVENUE, MONROE, LA 71201  
 318-323-6900 OFFICE  
 JOB No. R3421\_002

# VICINITY MAP

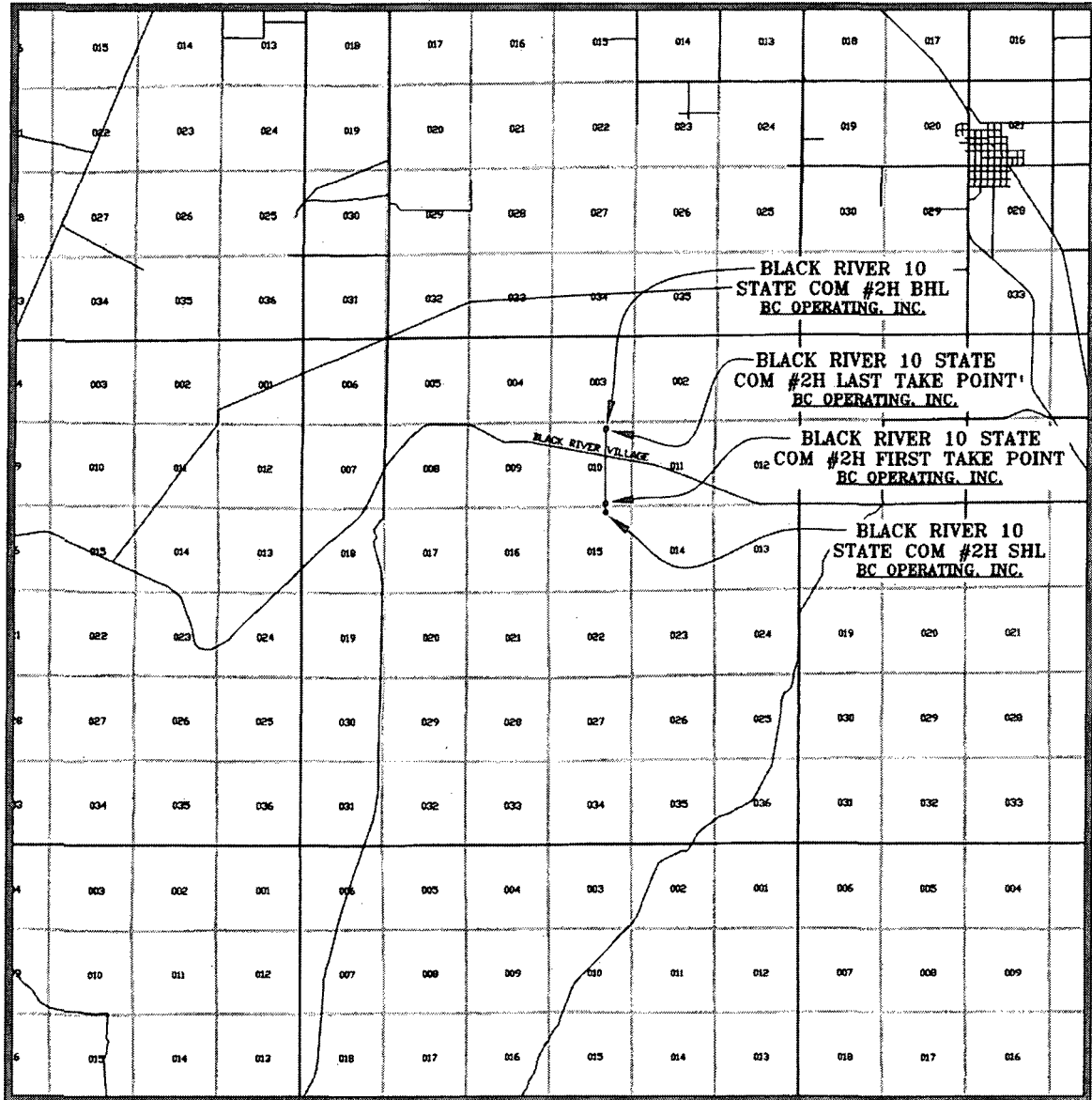

SEC. 15 TWP. 24-S RGE. 27-E  
 SURVEY: N.M.P.M.  
 COUNTY: EDDY  
 DESCRIPTION: 240' FNL & 1680' FEL  
 ELEVATION: 3192'  
 OPERATOR: B.C. OPERATING, INC.  
 EDDYSE: BLACK RIVER 10 STATE COM  
 U.S.G.S. TOPOGRAPHIC MAP: BOND DRAW, N.M.

SCALE: 1" = 2 MILES

PREPARED BY:  
 R-SQUARED GLOBAL, LLC  
 1309 LOUISVILLE AVENUE, MONROE, LA 71201  
 318-323-6900 OFFICE  
 JOB No. R3421\_002