

UNITED STATES
DEPARTMENT OF THE INTERIOR
BUREAU OF LAND MANAGEMENT

OCD Artesia

FORM APPROVED
OMB NO. 1004-0135
Expires: July 31, 2010**SUNDRY NOTICES AND REPORTS ON WELLS**
*Do not use this form for proposals to drill or to re-enter an abandoned well. Use form 3160-3 (APD) for such proposals.*5. Lease Serial No.
NMNM54290

6. If Indian, Allottee or Tribe Name

7. If Unit or CA/Agreement, Name and/or No.

SUBMIT IN TRIPLICATE - Other instructions on reverse side.

1. Type of Well

☒ Oil Well ☐ Gas Well ☐ Other2. Name of Operator
RKI EXP & PROD, LLCContact: JESSICA M DEMARCE
E-Mail: jessica.demarce@wpenergy.com8. Well Name and No.
NORTH BRUSHY DRAW FEDERAL 35 4H9. API Well No.
30-015-422903a. Address
3500 ONE WILLIAMS CENTER MD35
TULSA, OK 741723b. Phone No. (include area code)
Ph: 539-573-352110. Field and Pool, or Exploratory
CORRAL CANYON BONE SPR S

4. Location of Well (Footage, Sec., T., R., M., or Survey Description)

Sec 35 T25S R29E 175FSL 2365FWL

11. County or Parish, and State

EDDY COUNTY, NM

12. CHECK APPROPRIATE BOX(ES) TO INDICATE NATURE OF NOTICE, REPORT, OR OTHER DATA

TYPE OF SUBMISSION	TYPE OF ACTION			
<input type="checkbox"/> Notice of Intent	<input type="checkbox"/> Acidize	<input type="checkbox"/> Deepen	<input type="checkbox"/> Production (Start/Resume)	<input type="checkbox"/> Water Shut-Off
<input checked="" type="checkbox"/> Subsequent Report	<input type="checkbox"/> Alter Casing	<input type="checkbox"/> Fracture Treat	<input type="checkbox"/> Reclamation	<input type="checkbox"/> Well Integrity
<input type="checkbox"/> Final Abandonment Notice	<input type="checkbox"/> Casing Repair	<input type="checkbox"/> New Construction	<input type="checkbox"/> Recomplete	<input checked="" type="checkbox"/> Other
	<input type="checkbox"/> Change Plans	<input type="checkbox"/> Plug and Abandon	<input type="checkbox"/> Temporarily Abandon	Site Facility Diagram/Security Plan
	<input type="checkbox"/> Convert to Injection	<input type="checkbox"/> Plug Back	<input type="checkbox"/> Water Disposal	

13. Describe Proposed or Completed Operation (clearly state all pertinent details, including estimated starting date of any proposed work and approximate duration thereof. If the proposal is to deepen directionally or recompleat horizontally, give subsurface locations and measured and true vertical depths of all pertinent markers and zones. Attach the Bond under which the work will be performed or provide the Bond No. on file with BLM/BIA. Required subsequent reports shall be filed within 30 days following completion of the involved operations. If the operation results in a multiple completion or recompleat in a new interval, a Form 3160-4 shall be filed once testing has been completed. Final Abandonment Notices shall be filed only after all requirements, including reclamation, have been completed, and the operator has determined that the site is ready for final inspection.)

SFD DATED 6/21/2016 & ABSM DATED 6/21/2016 ATTACHED

NM OIL CONSERVATION

ARTESIA DISTRICT

NOV 14 2016

RECEIVED

Accepted for Record Purposes
Approval Subject to Onsite Inspection.

Date: 09-28-16

14. I hereby certify that the foregoing is true and correct.

Electronic Submission #348301 verified by the BLM Well Information System
For RKI EXP & PROD, LLC, sent to the Carlsbad
Committed to AFMSS for processing by DEBORAH MCKINNEY on 08/24/2016 ()

Name (Printed/Typed) JESSICA M DEMARCE

Title REGULATORY TECH

Signature (Electronic Submission)

Date 08/18/2016

THIS SPACE FOR FEDERAL OR STATE OFFICE USE

Approved By

Title

Date

Conditions of approval, if any, are attached. Approval of this notice does not warrant or certify that the applicant holds legal or equitable title to those rights in the subject lease which would entitle the applicant to conduct operations thereon.

Office

Title 18 U.S.C. Section 1001 and Title 43 U.S.C. Section 1212, make it a crime for any person knowingly and willfully to make to any department or agency of the United States any false, fictitious or fraudulent statements or representations as to any matter within its jurisdiction.

**** OPERATOR-SUBMITTED ** OPERATOR-SUBMITTED ** OPERATOR-SUBMITTED ****

LEGEND	
UG	UNDERGROUND
AG	ABOVE GROUND
UPI	UTILITY POLE
EP	ELECTRICAL PANEL/BOX
SP	SOLAR PANEL
GEN	GENERATOR
	OVERHEAD POWER LINE
	ELECTRIC LINE (UG)
	ELECTRIC LINE (AG)
	OIL FLOWLINE (UG)
	OIL FLOWLINE (AG)
	RECYCLE FLOWLINE (UG)
	RECYCLE FLOWLINE (AG)
	WATER FLOWLINE (UG)
	WATER FLOWLINE (AG)
	GAS FLOWLINE (UG)
	GAS FLOWLINE (AG)
	UNKNOWN FLOWLINE (UG)
	UNKNOWN FLOWLINE (AG)
	EDGE OF PAD
	FENCE
FWKO	FREE WATER KNOCKOUT
LOV	LOAD OUT VALVE (OIL)
LOVW	LOAD OUT VALVE (WATER)
MTR	METER
PU	PUMPING UNIT
RP	RECYCLE PUMP
SEP	SEPARATOR
T	TANK (OIL)
TW	TANK (WATER)
BLDG	BUILDING
CB	COMBUSTOR
HT	HEATER TREATER
FL	FLARE
FS	FLARE SEPARATOR
WH	WELLHEAD
SG	SALES GAS METER
FG	FLARE GAS METER
GL	GAS LIFT SKID
COMP	COMPRESSOR
ST	STAIRS
TP	TRANSFER PUMP

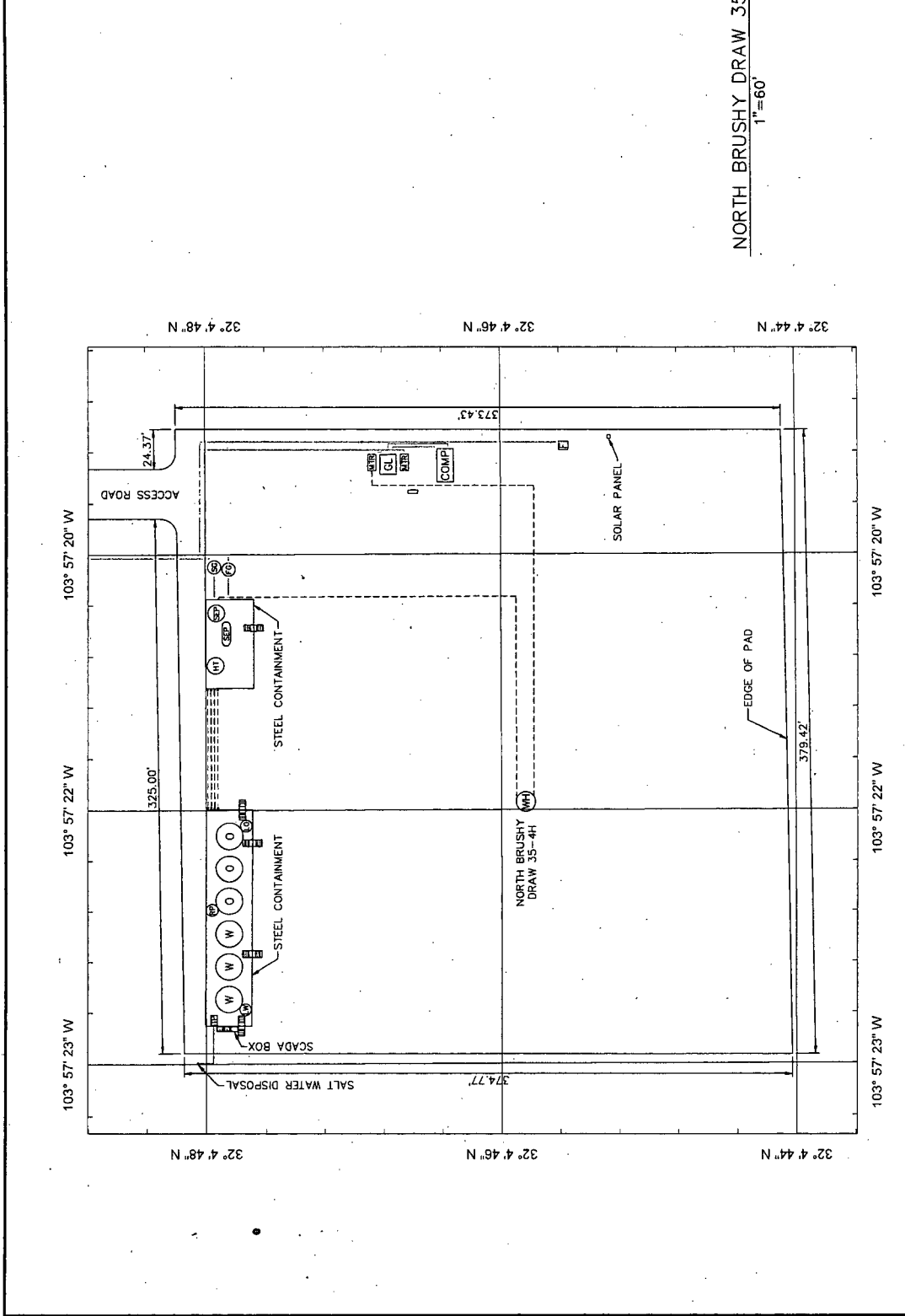

NORTH BRUSHY DRAW 35-4H
1"=60'

		NORTH BRUSHY DRAW 35-4H 1"=60' DATE: 09/28/16 DRAWN BY: [Signature] CHECKED BY: [Signature] PROJECT: [Blank] SHEET: 1 OF 1 SCALE: 1"=60' PROJECT: [Blank] SHEET: 1 OF 1 SCALE: 1"=60' PROJECT: [Blank] SHEET: 1 OF 1 SCALE: 1"=60'	
NORTH BRUSHY DRAW 35-4H 1"=60' DATE: 09/28/16 DRAWN BY: [Signature] CHECKED BY: [Signature] PROJECT: [Blank] SHEET: 1 OF 1 SCALE: 1"=60' PROJECT: [Blank] SHEET: 1 OF 1 SCALE: 1"=60'		NORTH BRUSHY DRAW 35-4H 1"=60' DATE: 09/28/16 DRAWN BY: [Signature] CHECKED BY: [Signature] PROJECT: [Blank] SHEET: 1 OF 1 SCALE: 1"=60' PROJECT: [Blank] SHEET: 1 OF 1 SCALE: 1"=60'	

Accepted for Record Purposes
Approval Subject to Onsite Inspection
Date: 09-28-16

