

Submit 1 Copy To Appropriate District Office  
District I  
1625 N. French Dr., Hobbs, NM 88240  
District II  
1301 W. Grand Ave., Artesia, NM 88210  
District III  
1000 Rio Brazos Rd., Aztec, NM 87410  
District IV  
1220 S. St. Francis Dr., Santa Fe, NM 87505

State of New Mexico  
Energy, Minerals and Natural Resources

Form C-103  
October 13, 2009

OIL CONSERVATION DIVISION  
1220 South St. Francis Dr.  
Santa Fe, NM 87505

<b>SUNDRY NOTICES AND REPORTS ON WELLS</b> (DO NOT USE THIS FORM FOR PROPOSALS TO DRILL OR TO DEEPEN OR PLUG BACK TO A DIFFERENT RESERVOIR. USE "APPLICATION FOR PERMIT" (FORM C-101) FOR SUCH PROPOSALS.)		WELL API NO. 30-015-41925
1. Type of Well: Oil Well <input checked="" type="checkbox"/> Gas Well <input type="checkbox"/> Other <input type="checkbox"/>		5. Indicate Type of Lease STATE <input checked="" type="checkbox"/> FEE <input type="checkbox"/>
2. Name of Operator COG Operating LLC		6. State Oil & Gas Lease No.
3. Address of Operator 2208 W. Main Street, Artesia, NM 88210		7. Lease Name or Unit Agreement Name SRO State Com
4. Well Location Unit Letter <u>M</u> : <u>380</u> feet from the <u>South</u> line and <u>760</u> feet from the <u>West</u> line Section <u>33</u> Township <u>25S</u> Range <u>28E</u> NMPM <u>Eddy</u> County		8. Well Number 35H
11. Elevation (Show whether DR, RKB, RT, GR, etc.) 2992' GR		9. OGRID Number 229137
		10. Pool name or Wildcat Delaware River; Bone Spring

12. Check Appropriate Box to Indicate Nature of Notice, Report or Other Data

**NOTICE OF INTENTION TO:**  
PERFORM REMEDIAL WORK ☐ PLUG AND ABANDON ☐  
TEMPORARILY ABANDON ☐ CHANGE PLANS ☐  
PULL OR ALTER CASING ☐ MULTIPLE COMPL ☐  
DOWNHOLE COMMINGLE ☐  
OTHER: ☒ APD Extension

**SUBSEQUENT REPORT OF:**  
REMEDIAL WORK ☐ ALTERING CASING ☐  
COMMENCE DRILLING OPNS. ☐ P AND A ☐  
CASING/CEMENT JOB ☐  
OTHER: ☐

13. Describe proposed or completed operations. (Clearly state all pertinent details, and give pertinent dates, including estimated date of starting any proposed work). SEE RULE 19.15.7.14 NMAC. For Multiple Completions: Attach wellbore diagram of proposed completion or recompletion.

COG Operating LLC respectfully requests approval for a 2 year extension on the above referenced APD.

C102 attached.

Spud Date:

Rig Release Date:

I hereby certify that the information above is true and complete to the best of my knowledge and belief.

SIGNATURE Mayte Reyes TITLE: Regulatory Analyst DATE: 11/15/2016  
Type or print name: Mayte Reyes E-mail address: mreyes1@conchoresources.com PHONE: (575) 748-6945  
**For State Use Only**  
APPROVED BY: Alexander Sharp TITLE: Bus Op Spec Adv DATE: 11-17-16  
Conditions of Approval (if any):

DISTRICT I  
1625 N. FRENCH DR., HOBBS, NM 88240  
Phone: (505) 383-8161 Fax: (505) 383-0720

DISTRICT II  
1301 S. GRAND AVENUE, ARTEAGA, NM 88210  
Phone: (505) 746-1283 Fax: (505) 746-0720

DISTRICT III  
1000 RIO BRAZOS RD., AZTEC, NM 87410  
Phone: (505) 334-6178 Fax: (505) 334-6170

DISTRICT IV  
11885 S. ST. FRANCIS DR., SANTA FE, NM 87505  
Phone: (505) 476-3480 Fax: (505) 476-3462

State of New Mexico  
Energy, Minerals & Natural Resources Department  
**OIL CONSERVATION DIVISION**  
11885 SOUTH ST. FRANCIS DR.  
Santa Fe, New Mexico 87505

Form C-102  
Revised August 1, 2011  
Submit one copy to appropriate

☐ AMENDED REPORT

**WELL LOCATION AND ACREAGE DEDICATION PLAT**

API Number <b>30-015-41925</b>	Pool Code <b>16800</b>	Pool Name <b>Delaware River; Bone Spring</b>
Property Code <b>40112</b>	Property Name <b>SRO STATE COM</b>	Well Number <b>35H</b>
OGRID No. <b>229137</b>	Operator Name <b>COG OPERATING, LLC</b>	Elevation <b>2992.1</b>

**Surface Location**

UL or lot No.	Section	Township	Range	Lot Idn	Feet from the	North/South line	Feet from the	East/West line	County
M	33	25-S	28-E		380	SOUTH	760	WEST	EDDY

**Bottom Hole Location If Different From Surface**

UL or lot No.	Section	Township	Range	Lot Idn	Feet from the	North/South line	Feet from the	East/West line	County
D	33	25-S	28-E		330	NORTH	660	WEST	EDDY

Dedicated Acres	Joint or Infill	Consolidation Code	Order No.
<b>160</b>			

**NO ALLOWABLE WILL BE ASSIGNED TO THIS COMPLETION UNTIL ALL INTERESTS HAVE BEEN CONSOLIDATED OR A NON-STANDARD UNIT HAS BEEN APPROVED BY THE DIVISION**

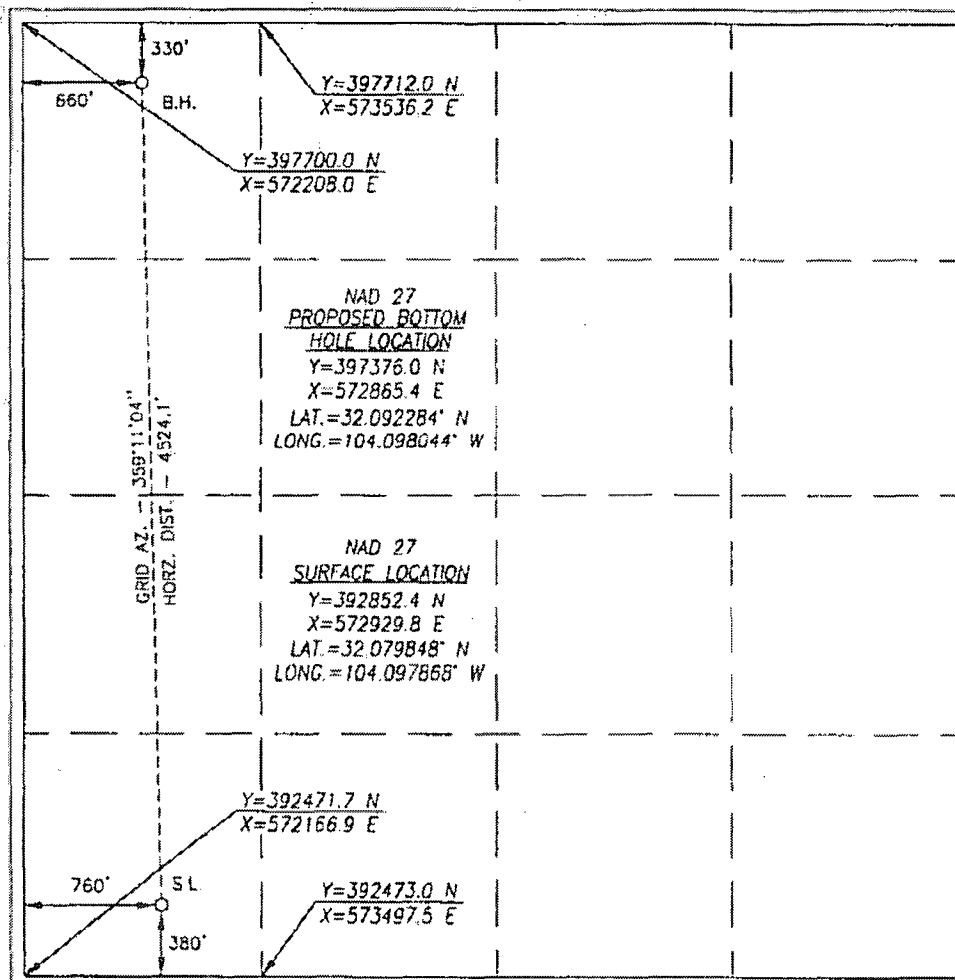

**OPERATOR CERTIFICATION**

I hereby certify that the information herein is true and complete to the best of my knowledge and belief, and that this organization either owns a working interest or unleased mineral interest in the land including the proposed bottom hole location or has a right to drill this well at this location pursuant to a contract with an owner of such mineral or working interest, or to a voluntary pooling agreement or a compulsory pooling order heretofore entered by the division.

*Mayte Reyes* 11-15-16  
Signature Date

**Mayte Reyes**

Printed Name

**mreyes1@concho.com**

E-mail Address

**SURVEYOR CERTIFICATION**

I hereby certify that the well location shown on this plat was plotted from field notes of actual surveys made by me or under my supervision, and that the same is true and correct to the best of my belief.

**MAY 28, 2013**

Date of Survey

Signature & Seal of Professional Surveyor

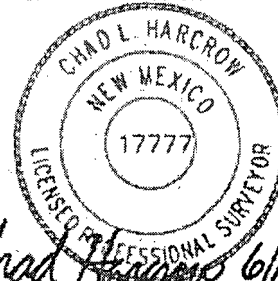

*Chad Harcrow* 6/12/13  
Certificate No. CHAD HARCROW 17777  
W.O. # 13-317 DRAWN BY: VD