

Submit 1 Copy To Appropriate District Office  
District I - (575) 393-6161  
1625 N. French Dr., Hobbs, NM 88240  
District II - (575) 748-1283  
811 S. First St., Artesia, NM 88210  
District III - (505) 334-6178  
1000 Rio Brazos Rd., Aztec, NM 87410  
District IV - (505) 476-3460  
1220 S. St. Francis Dr., Santa Fe, NM 87505

State of New Mexico  
Energy, Minerals and Natural Resources

Form C-103  
Revised July 18, 2013

OIL CONSERVATION DIVISION  
1220 South St. Francis Dr.  
Santa Fe, NM 87505

WELL API NO. 30-015-42888
5. Indicate Type of Lease STATE <input type="checkbox"/> FEE <input checked="" type="checkbox"/>
6. State Oil & Gas Lease No.
7. Lease Name or Unit Agreement Name Sherman 4 Fee
8. Well Number 26H
9. OGRID Number 229137
10. Pool name or Wildcat Atoka; Glorieta-Yeso 3250

SUNDRY NOTICES AND REPORTS ON WELLS (DO NOT USE THIS FORM FOR PROPOSALS TO DRILL OR TO DEEPEN OR PLUG BACK TO A DIFFERENT RESERVOIR. USE "APPLICATION FOR PERMIT" (FORM C-101) FOR SUCH PROPOSALS.)	
1. Type of Well: Oil Well <input checked="" type="checkbox"/> Gas Well <input type="checkbox"/> Other <input type="checkbox"/>	
2. Name of Operator COG Operating LLC	
3. Address of Operator One Concho Center, 600 W. Illinois Ave., Midland, Tx 79701	
4. Well Location Unit Letter <u>C</u> : <u>150</u> feet from the <u>North</u> line and <u>2310</u> feet from the <u>West</u> line Section <u>4</u> Township <u>19S</u> Range <u>26E</u> NMPM County <u>EDDY</u>	
11. Elevation (Show whether DR, RKB, RT, GR, etc.) 3345' GR	

12. Check Appropriate Box to Indicate Nature of Notice, Report or Other Data

NOTICE OF INTENTION TO:

PERFORM REMEDIAL WORK ☐ PLUG AND ABANDON ☐  
TEMPORARILY ABANDON ☐ CHANGE PLANS ☐  
PULL OR ALTER CASING ☐ MULTIPLE COMPL ☐  
DOWNHOLE COMMINGLE ☐  
CLOSED-LOOP SYSTEM ☐  
OTHER: ☐ APD Extension ☒

SUBSEQUENT REPORT OF:

REMEDIAL WORK ☐ ALTERING CASING ☐  
COMMENCE DRILLING OPNS. ☐ P AND A ☐  
CASING/CEMENT JOB ☐  
OTHER: ☐

13. Describe proposed or completed operations. (Clearly state all pertinent details, and give pertinent dates, including estimated date of starting any proposed work). SEE RULE 19.15.7.14 NMAC. For Multiple Completions: Attach wellbore diagram of proposed completion or recompletion.

NM OIL CONSERVATION  
ARTESIA DISTRICT

JAN 04 2017

RECEIVED

COG Operating LLC respectfully requests  
a two year extension to this APD  
scheduled to expire 01/06/2017.

Spud Date:

Rig Release Date:

I hereby certify that the information above is true and complete to the best of my knowledge and belief.

SIGNATURE Robyn M. Russell TITLE Regulatory Analyst DATE 01/03/2017

Type or print name Robyn M. Russell E-mail address: Russell@concho.com PHONE: 432-685-4385

For State Use Only

APPROVED BY: Benjamin TITLE OIL SUPERVISOR DATE 06 JAN 17  
Conditions of Approval (if any):

DISTRICT I  
1625 N. French Dr., Hobbs, NM 88240  
Phone (575) 393-6161 Fax (575) 393-0720

DISTRICT II  
811 S. First St., Artesia, NM 88210  
Phone (575) 748-1283 Fax (575) 748-9720

DISTRICT III  
1000 Rio Brazos Road, Aztec, NM 87410  
Phone (505) 334-6178 Fax (505) 334-6170

DISTRICT IV  
1220 S. St. Francis Dr., Santa Fe, NM 87505  
Phone (505) 476-3460 Fax (505) 476-3462

**State of New Mexico**  
**Energy, Minerals & Natural Resources Department**  
**OIL CONSERVATION DIVISION**  
**1220 South St. Francis Dr.**  
**Santa Fe, New Mexico 87505**

**RECEIVED**

Form C-102  
Revised August 1, 2011  
Submit one copy to appropriate  
District Office

☐ AMENDED REPORT

**WELL LOCATION AND ACREAGE DEDICATION PLAT**

API Number <b>30-015-42888</b>	Pool Code <b>3250</b>	Pool Name <b>Atoka; Glorieta-Yeso</b>
Property Code <b>38909</b>	Property Name <b>SHERMAN 4 FEE</b>	
OGRID No. <b>229137</b>	Operator Name <b>COG OPERATING, LLC</b>	
		Well Number <b>26H</b>
		Elevation <b>3345'</b>

Surface Location									
UL or lot No.	Section	Township	Range	Lot Idn	Feet from the	North/South line	Feet from the	East/West line	County
<b>C</b>	<b>9</b>	<b>19-S</b>	<b>26-E</b>		<b>150</b>	<b>NORTH</b>	<b>2310</b>	<b>WEST</b>	<b>EDDY</b>

Bottom Hole Location If Different From Surface									
UL or lot No.	Section	Township	Range	Lot Idn	Feet from the	North/South line	Feet from the	East/West line	County
<b>C</b>	<b>4</b>	<b>19-S</b>	<b>26-E</b>		<b>330</b>	<b>NORTH</b>	<b>2310</b>	<b>WEST</b>	<b>EDDY</b>
Dedicated Acres <b>159.06</b>		Joint or Infill		Consolidation Code		Order No.			

NO ALLOWABLE WILL BE ASSIGNED TO THIS COMPLETION UNTIL ALL INTERESTS HAVE BEEN CONSOLIDATED OR A NON-STANDARD UNIT HAS BEEN APPROVED BY THE DIVISION

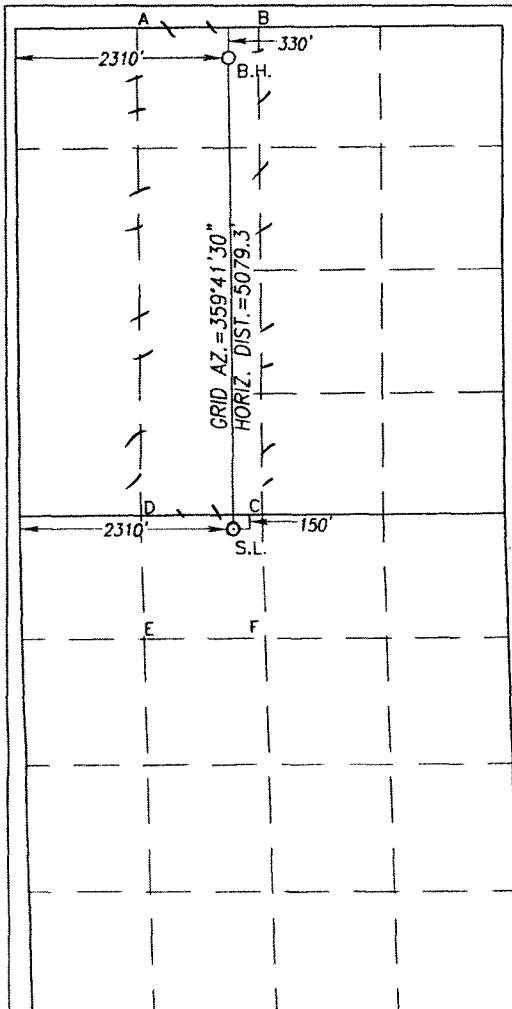

**BOTTOM HOLE LOCATION**  
Y = 616917.4 N  
X = 483284.6 E  
  
LAT. = 32.695993° N  
LONG. = 104.387669° W

**CORNER COORDINATES TABLE**

A - Y = 617241.1 N, X = 482293.4 E  
B - Y = 617249.4 N, X = 483613.2 E  
C - Y = 611991.5 N, X = 483626.0 E  
D - Y = 611983.0 N, X = 482312.6 E  
E - Y = 610646.0 N, X = 482342.8 E  
F - Y = 610652.7 N, X = 483658.5 E

**GEODETIC COORDINATES  
NAD 27 NME**

**SURFACE LOCATION**  
Y = 611839.5 N  
X = 483311.8 E  
  
LAT. = 32.682035° N  
LONG. = 104.387572° W

**OPERATOR CERTIFICATION**

I hereby certify that the information herein is true and complete to the best of my knowledge and belief, and that this organization either owns a working interest or unleased mineral interest in the land including the proposed bottom hole location or has a right to drill this well at this location pursuant to a contract with an owner of such mineral or working interest, or to a voluntary pooling agreement or a compulsory pooling order heretofore entered by the division.

01/03/17  
Date

*Robyn M. Russell*  
Signature

**Robyn M. Russell**  
Printed Name

**Russell@concho.com**  
E-mail Address

**SURVEYOR CERTIFICATION**

I hereby certify that the well location shown on this plat was plotted from field notes of actual surveys made by me or under my supervision, and that the same is true and correct to the best of my belief.

**SEPTEMBER 9, 2014**

Date of Survey  
Signature of Professional Surveyor:

**RONALD J. EIDSON**  
NEW MEXICO  
3239

*Ronald J. Eidson*  
Signature

**Ronald J. Eidson**  
Printed Name

**12641**  
Certificate Number

**3239**  
Professional Surveyor

**9/30/2014**  
Date

**LSL**  
JWSC W.O. 14.11.0912