

MAR 01 2017

DISTRICT I
1625 N. French Dr., Hobbs, NM 88240
Phone: (505) 393-6161 Fax: (505) 393-0720
DISTRICT II
811 S. First St., Artesia, NM 88210
Phone: (505) 748-1283 Fax: (505) 748-0720
DISTRICT III
1000 Rio Hondo Rd., Aztec, NM 87410
Phone: (505) 334-6178 Fax: (505) 334-6170
DISTRICT IV
1220 S. St. Francis Dr., Santa Fe, NM 87505
Phone: (505) 476-3460 Fax: (505) 476-3462

State of New Mexico
Energy, Minerals & Natural Resources Department
OIL CONSERVATION DIVISION
1220 South St. Francis Dr.
Santa Fe, New Mexico 87505

Form C-102
Revised August 1, 2011
Submit one copy to appropriate
District Office
☒ AMENDED REPORT

WELL LOCATION AND ACREAGE DEDICATION PLAT AS DRILLED PLAT

API Number 30-015-43634	Pool Code 98220	Pool Name PURPLE SAG E - WOLFCAMP GAS POOL
Property Code 313813	Property Name RDX FEDERAL COM 17	Well Number 40H
OGRID No. 246289	Operator Name RKI EXPLORATION & PRODUCTION	Elevation 3086'

Surface Location

UL or lot no.	Section	Township	Range	Lot Idn	Feet from the	North/South line	Feet from the	East/West line	County
A	17	26S	30E		175	N	1310	E	EDDY

Bottom Hole Location If Different From Surface

UL or lot no.	Section	Township	Range	Lot Idn	Feet from the	North/South line	Feet from the	East/West line	County
P	17	26S	30E		330	S	404	E	EDDY

Dedicated Acres 320.00 E 1/2 OF SEC. 17	Joint or Infill 160	Consolidated or a non-standard unit has been approved by the
--	-------------------------------	--

No allowable will be assigned to this well if the well is located on a consolidated or a non-standard unit has been approved by the division.
...wells having less than 320 dedicated acres may increase spacing to the standard 320-acre gas spacing by filing application to increase spacing as provided by Division rules...

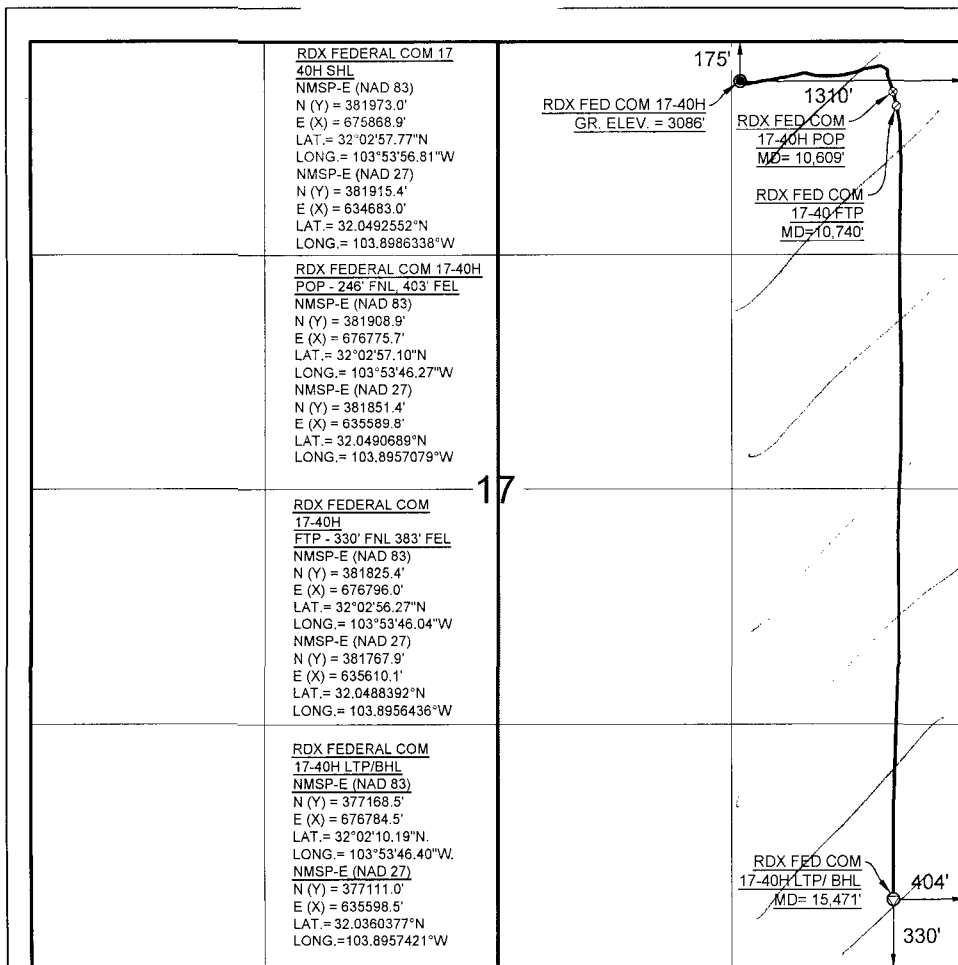

<p>OPERATOR CERTIFICATION</p> <p>I hereby certify that the information contained herein is true and complete to the best of my knowledge and belief, and that this organization either owns a working interest or unleased mineral interest in the land including the proposed bottom hole location or has a right to drill this well at this location pursuant to a contract with an owner of such a mineral or working interest, or to voluntary pooling agreement or a compulsory pooling order heretofore entered by the division.</p> <p>Signature: <i>Justin Bernore</i> Date: 02/27/2017</p> <p>Print Name: Justin Bernore</p> <p>E-mail Address: justin.bernore@rpxenergy.com</p>	
<p>SURVEYORS CERTIFICATION</p> <p>I hereby certify that the well location shown on this plat was plotted from field notes of actual surveys made by me or under my supervision, and that the same is true and correct to the best of my belief.</p> <p>AUGUST 22, 2016 Date of Survey</p> <p>Signature and Seal of Professional Surveyor: <i>James E. Tompkins</i></p> <p>Job No.: WTC51325 JAMES E. TOMPKINS 14729 Certificate Number</p>	