

DISTRICT I  
1625 N. French Dr., Hobbs, NM 88240  
Phone: (575) 393-6161 Fax: (575) 393-0720

DISTRICT II  
811 S. First St., Artesia, NM 88210  
Phone: (575) 748-1283 Fax: (575) 748-9720

DISTRICT III  
1000 Rio Brazos Rd., Aztec, NM 87410  
Phone: (505) 334-6178 Fax: (505) 334-6170

DISTRICT IV  
1220 S. St. Francis Dr., Santa Fe, NM 87505  
Phone: (505) 476-3460 Fax: (505) 476-3462

State of New Mexico  
Energy, Minerals & Natural Resources Department  
OIL CONSERVATION DIVISION  
1220 South St. Francis Dr.  
Santa Fe, New Mexico 87505

Form C-102  
Revised August 1, 2011

Submit one copy to appropriate  
District Office

☒ AMENDED REPORT

WELL LOCATION AND ACREAGE DEDICATION PLAT

API Number 30-015-43585	Pool Code 98220	Pool Name PURPLE SAGE-WOLFCAMP GAS POOL
Property Code 39386	Property Name EAST PECOS FEDERAL COM 22	Well Number 13H
OGRID No. 246289	Operator Name RKI Exploration & Production, LLC	Elevation 2882

Surface Location

UL or lot no.	Section	Township	Range	Lot Idn	Feet from the	North/South line	Feet from the	East/West line	County
P	22	26S	29E		310	S	1310	E	EDDY

Bottom Hole Location If Different From Surface

UL or lot no.	Section	Township	Range	Lot Idn	Feet from the	North/South line	Feet from the	East/West line	County
A	22	26S	29E		230	N	990	E	EDDY

Dedicated Acres 320.00 E 1/2 OF SEC. 22	Joint or Infill	Consolidated Code	Order No.
---	-----------------	-------------------	-----------

No allowable will be assigned to this completion until all interests have been consolidated or a non-standard unit has been approved by the division.

		<p>EAST PECOS FEDERAL COM 22 13H BHL NMSP-E (NAD 83) N (Y) = 376352.3' E (X) = 655070.5' LAT. = 32°02'02.91"N LONG. = 103°57'58.69"W NMSP-E (NAD 27) N (Y) = 376294.7' E (X) = 613884.7' LAT. = 32.0340162°N LONG. = 103.9658223°W</p>	<p>230' 990'</p> <p>LAST TAKE 330' FNL 990' FEL NMSP-E (NAD 83) N (Y) = 376252.2' E (X) = 655070.8' LAT. = 32°02'01.92"N LONG. = 103°57'58.69"W NMSP-E (NAD 27) N (Y) = 376194.6' E (X) = 613885.0' LAT. = 32.0337410°N LONG. = 103.9658224°W</p>
		<p>EAST PECOS FEDERAL COM 22 13H SHL NMSP-E (NAD 83) N (Y) = 371573.2' E (X) = 654768.4' LAT. = 32°01'15.62"N LONG. = 103°58'02.39"W NMSP-E (NAD 27) N (Y) = 371515.8' E (X) = 613582.5' LAT. = 32.0208816°N LONG. = 103.9668496°W</p>	<p>FIRST TAKE 330' FSL 990' FEL NMSP-E (NAD 83) N (Y) = 371569.9' E (X) = 655088.4' LAT. = 32°01'15.58"N LONG. = 103°57'58.67"W NMSP-E (NAD 27) N (Y) = 371512.5' E (X) = 613902.5' LAT. = 32.0208695°N LONG. = 103.9658174°W</p>

OPERATOR CERTIFICATION

I hereby certify that the information contained herein is true and complete to the best of my knowledge and belief, and that this organization either owns a working interest or unleased mineral interest in the land including the proposed bottom hole location or has a right to drill this well at this location pursuant to a contract with an owner of such a mineral or working interest, or to voluntary pooling agreement or a compulsory pooling order heretofore entered by the division.

Signature: *Justin Barmore* Date: 02/27/2017  
Print Name: Justin Barmore  
E-mail Address: justin.barmore@vprenergy.com

SURVEYORS CERTIFICATION

I hereby certify that the well location shown on this plat was plotted from field notes of actual surveys made by me or under my supervision, and that the same is true and correct to the best of my belief.

FEBRUARY 21, 2017

Date of Survey

Signature and Seal of Professional Surveyor

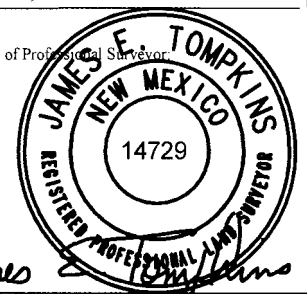

Job No.: WTC51667

JAMES E. TOMPKINS 14729

Certificate Number