

Submit 1 Copy To Appropriate District Office
District I
1625 N. French Dr., Hobbs, NM 88240
District II
1301 W. Grand Ave., Artesia, NM 88210
District III
1000 Rio Brazos Rd., Aztec, NM 87410
District IV
1220 S. St. Francis Dr., Santa Fe, NM 87505

State of New Mexico
Energy, Minerals and Natural Resources

Form C-103
October 13, 2009

OIL CONSERVATION DIVISION
1220 South St. Francis Dr.
Santa Fe, NM 87505

WELL API NO. 30-015-44005
5. Indicate Type of Lease STATE <input type="checkbox"/> FEE <input checked="" type="checkbox"/>
6. State Oil & Gas Lease No.
7. Lease Name or Unit Agreement Name Myox 21 State Com
8. Well Number 35H
9. OGRID Number 229137
10. Pool name or Wildcat Purple Sage; Wolfcamp

SUNDRY NOTICES AND REPORTS ON WELLS (DO NOT USE THIS FORM FOR PROPOSALS TO DRILL OR TO DEEPEN OR PLUG BACK TO A DIFFERENT RESERVOIR. USE "APPLICATION FOR PERMIT" (FORM C-101) FOR SUCH PROPOSALS.)	
1. Type of Well: Oil Well <input checked="" type="checkbox"/> Gas Well <input type="checkbox"/> Other	
2. Name of Operator COG Operating LLC	
3. Address of Operator 2208 W. Main Street, Artesia, NM 88210	
4. Well Location Unit Letter <u>N</u> : <u>200</u> feet from the <u>South</u> line and <u>1679</u> feet from the <u>West</u> line Section <u>21</u> Township <u>25S</u> Range <u>28E</u> NMPM <u>Eddy</u> County	
11. Elevation (Show whether DR, RKB, RT, GR, etc.) 2977.6	

12. Check Appropriate Box to Indicate Nature of Notice, Report or Other Data

NOTICE OF INTENTION TO:		SUBSEQUENT REPORT OF:	
PERFORM REMEDIAL WORK <input type="checkbox"/>	PLUG AND ABANDON <input type="checkbox"/>	REMEDIAL WORK <input type="checkbox"/>	ALTERING CASING <input type="checkbox"/>
TEMPORARILY ABANDON <input type="checkbox"/>	CHANGE PLANS <input checked="" type="checkbox"/>	COMMENCE DRILLING OPNS. <input type="checkbox"/>	P AND A <input type="checkbox"/>
PULL OR ALTER CASING <input type="checkbox"/>	MULTIPLE COMPL <input type="checkbox"/>	CASING/CEMENT JOB <input type="checkbox"/>	
DOWNHOLE COMMINGLE <input type="checkbox"/>			
OTHER: <input checked="" type="checkbox"/> BHL & Pool Change		OTHER: <input type="checkbox"/>	

13. Describe proposed or completed operations. (Clearly state all pertinent details, and give pertinent dates, including estimated date of starting any proposed work). SEE RULE 19.15.7.14 NMAC. For Multiple Completions: Attach wellbore diagram of proposed completion or recompletion.

COG Operating LLC respectfully requests approval for the following changes to the original approved APD..

POOL From: WC-05 G-06 S26280500; UPR Wolfcamp 98195
To: Purple Sage; Wolfcamp 98220

BHL From: 200' FNL & 1914' FWL Section 16, T25S, R28E
To: 200' FNL & 1650' FWL Section 16, T25S, R28E
C102 attached.

DRILLING CHANGES: Operator will drill to TD at 19,680' MD.

Spud Date:

Rig Release Date:

NM OIL CONSERVATION
ARTESIA DISTRICT

AUG 11 2017

RECEIVED

I hereby certify that the information above is true and complete to the best of my knowledge and belief.

SIGNATURE Mayte Reyes TITLE: Regulatory Analyst DATE: 8/10/2017
Type or print name: Mayte Reyes E-mail address: mreyes1@conchoresources.com PHONE: (575) 748-6945
For State Use Only
APPROVED BY: Raymond R. Bullock TITLE: Geologist DATE: 8-11-17
Conditions of Approval (if any):

District I
625 N. French Dr., Hobbs, NM 88240
Phone: (575) 393-6161 Fax: (575) 393-0720
District II
811 S. First St., Artesia, NM 88210
Phone: (575) 748-1283 Fax: (575) 748-9720
District III
1000 Rio Brazos Road, Aztec, NM 87410
Phone: (505) 334-6178 Fax: (505) 334-6170
District IV
1220 S. St. Francis Dr., Santa Fe, NM 87505
Phone: (505) 476-3460 Fax: (505) 476-3462

State of New Mexico
Energy, Minerals & Natural Resources Department
OIL CONSERVATION DIVISION
1220 South St. Francis Dr.
Santa Fe, NM 87505

Form C-102
Revised August 1, 2011
Submit one copy to appropriate
District Office

☐ AMENDED REPORT

WELL LOCATION AND ACREAGE DEDICATION PLAT

¹ API Number 30-015-44005		² Pool Code 98220	³ Pool Name Purple Sage; Wolfcamp
⁴ Property Code 38521	⁵ Property Name MYOX 21 STATE COM		⁶ Well Number 35H
⁷ OGRID No. 229137	⁸ Operator Name COG OPERATING, LLC.		⁹ Elevation 2977.6

10 Surface Location

UL or lot no.	Section	Township	Range	Lot Idn	Feet from the	North/South line	Feet from the	East/West line	County
N	21	25 S	28 E		200	SOUTH	1679	WEST	EDDY

11 Bottom Hole Location If Different From Surface

UL or lot no.	Section	Township	Range	Lot Idn	Feet from the	North/South line	Feet from the	East/West line	County
C	16	25 S	28 E		200	NORTH	1650	WEST	EDDY

¹² Dedicated Acres 640	¹³ Joint or Infill	¹⁴ Consolidation Code	¹⁵ Order No.
---	-------------------------------	----------------------------------	-------------------------

No allowable will be assigned to this completion until all interests have been consolidated or a non-standard unit has been approved by the division.

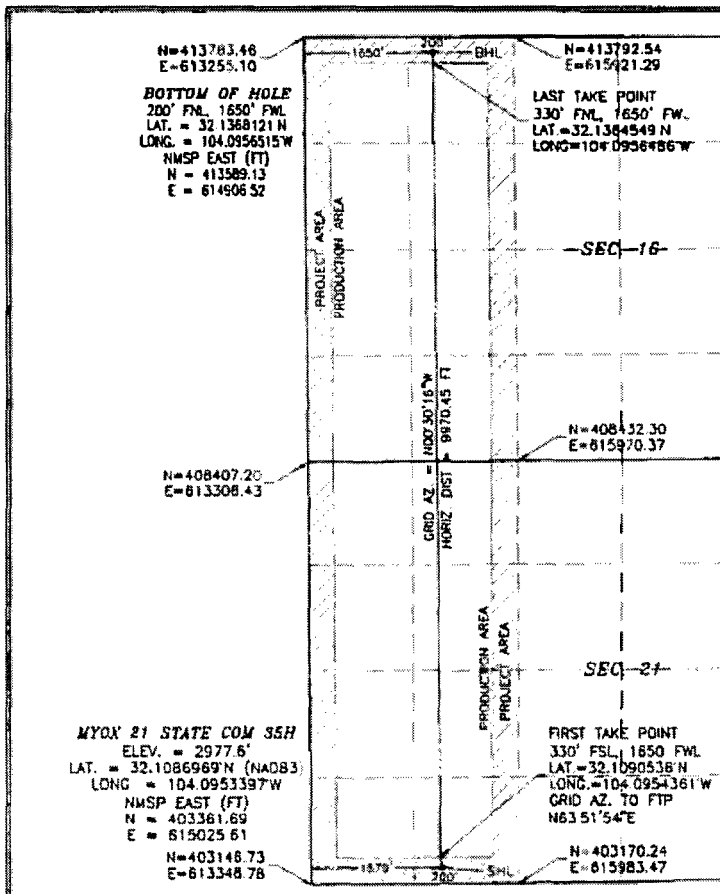

12 OPERATOR CERTIFICATION

I hereby certify that the information contained herein is true and complete to the best of my knowledge and belief, and that this organization either owns a working interest or unleased mineral interest in the land including the proposed bottom hole location or has a right to drill this well at this location pursuant to a contract with an owner of such a mineral or working interest, or is a voluntary pooling agreement or a compulsory pooling order heretofore entered by the division.

Signature: Mayte Reyes Date: 8-10-17

Printed Name: Mayte Reyes

E-mail Address: mreyes1@concho.com

13 SURVEYOR CERTIFICATION

I hereby certify that the well location shown on this plat was plotted from field notes of actual surveys made by me or under my supervision, and that the same is true and correct to the best of my belief.

Date of Survey: JUNE 8, 2017

Signature: William F. Jaramillo
Certificate Number: 12797
WILLIAM F. JARAMILLO, PLS 12797

SURVEY NO. 4891D