

Submit 3 Copies To Appropriate District
Office
District I
1625 N. French Dr., Hobbs, NM 88240
District II
1301 W. Grand Ave., Artesia, NM 88210
District III
1000 Rio Brazos Rd., Aztec, NM 87410
District IV
1220 S. St. Francis Dr., Santa Fe, NM
87505

State of New Mexico
Energy, Minerals and Natural Resources

Form C-103
June 19, 2008

OIL CONSERVATION DIVISION
1220 South St. Francis Dr.
Santa Fe, NM 87505

Record Clean Up

WELL API NO.
30-015-36840

5. Indicate Type of Lease
STATE ☒ FEE

6. State Oil & Gas Lease No.
VO-7289

7. Lease Name or Unit Agreement Name
MUZZY 2 STATE COM

8. Well Number *1*

9. OGRID Number 7377

10. Pool name or Wildcat
WC; Morrow (Gas)

SUNDRY NOTICES AND REPORTS ON WELLS
(DO NOT USE THIS FORM FOR PROPOSALS TO DRILL OR TO DEEPEN OR PLUG BACK TO A
DIFFERENT RESERVOIR. USE "APPLICATION FOR PERMIT" (FORM C-101) FOR SUCH
PROPOSALS.)

1. Type of Well: Oil Well ☐ Gas Well ☒ Other

2. Name of Operator
EOG RESOURCES, Inc.

3. Address of Operator
P.O. Box 2267 Midland, TX 79702

4. Well Location

Unit Letter D: 660 feet from the North line and 660 feet from the West line

Section 2 Township 25S Range 27E NMPM Eddy County

11. Elevation (Show whether DR, RKB, RT, GR, etc.)
3,174.2'

12. Check Appropriate Box to Indicate Nature of Notice, Report or Other Data

NOTICE OF INTENTION TO:

PERFORM REMEDIAL WORK ☐ PLUG AND ABANDON ☐
TEMPORARILY ABANDON ☐ CHANGE PLANS ☒
PULL OR ALTER CASING ☐ MULTIPLE COMPL ☐
DOWNHOLE COMMINGLE ☐

OTHER: ☐

SUBSEQUENT REPORT OF:

REMEDIAL WORK ☐ ALTERING CASING ☐
COMMENCE DRILLING OPNS. ☐ P AND A ☐
CASING/CEMENT JOB ☐

OTHER: CHANGE SURFACE HOLE LOCATION

13. Describe proposed or completed operations. (Clearly state all pertinent details, and give pertinent dates, including estimated date of starting any proposed work). SEE RULE 1103. For Multiple Completions: Attach wellbore diagram of proposed completion or recompletion.

EOG Resources, Inc. moved the Surface Hole Location as follows:

660' FNL & 660' FWL of Section 2 (UL/D), T25S-R27E, N.M.P.M., Eddy County, NM

Attached, please find the revised Casing, Cement and Mud Program.

Additionally, please amend CLEZ C-144 to recognize this new location.

NM OIL CONSERVATION

ARTESIA DISTRICT

SEP 06 2017

RECEIVED

Spud Date:

Rig Release Date:

I hereby certify that the information above is true and complete to the best of my knowledge and belief.

SIGNATURE *Donny G. Glanton*

TITLE: Sr. Lease Operations Rep.

DATE: 1/14/2009

Type or print name: Donny G. Glanton E-mail address: donny_glanton@eogresources.com

PHONE: 432-686-3642

For State Use Only

APPROVED BY:

Raymond W. Pordany TITLE: Geology

DATE

9-6-17

Conditions of Approval (if any):

District I
1625 N. French Dr., Hobbs, NM 88240
District II
1301 W. Grand Avenue, Artesia, NM 88210
District III
1000 Rio Brazos Rd., Aztec, NM 87410
District IV
1220 S. St. Francis Dr., Santa Fe, NM 87505

State of New Mexico
Energy, Minerals & Natural Resources Department
OIL CONSERVATION DIVISION
1220 South St. Francis Dr.
Santa Fe, NM 87505

Form G-102
Revised October 12, 2005
Submit to Appropriate District Office
State Lease- 4 Copies
Fee Lease- 3 Copies

☐ AMENDED REPORT

WELL LOCATION AND ACREAGE DEDICATION PLAT

API Number 30-015-36840	Pool Code 96070	Pool Name WC; Morrow Gas
Property Code 37528	Property Name MUZZY 2 STATE COM	Well Number 1
OGRID No. 7377	Operator Name EOG RESOURCES, INC.	Elevation 3174.2'

Surface Location

UL or lot no.	Section	Township	Range	Lot Idn	Feet from the	North/South line	Feet from the	East/West line	County
D	2	25 SOUTH	27 EAST, N.M.P.M.		660	NORTH	660	WEST	EDDY

Bottom Hole Location If Different From Surface

UL or lot no.	Section	Township	Range	Lot Idn	Feet from the	North/South line	Feet from the	East/West line	County

Dedicated Acres 320	Joint or Infill	Consolidation Code	Order No.
-------------------------------	-----------------	--------------------	-----------

No allowable will be assigned to this completion until all interests have been consolidated or a non-standard unit has been approved by the division.

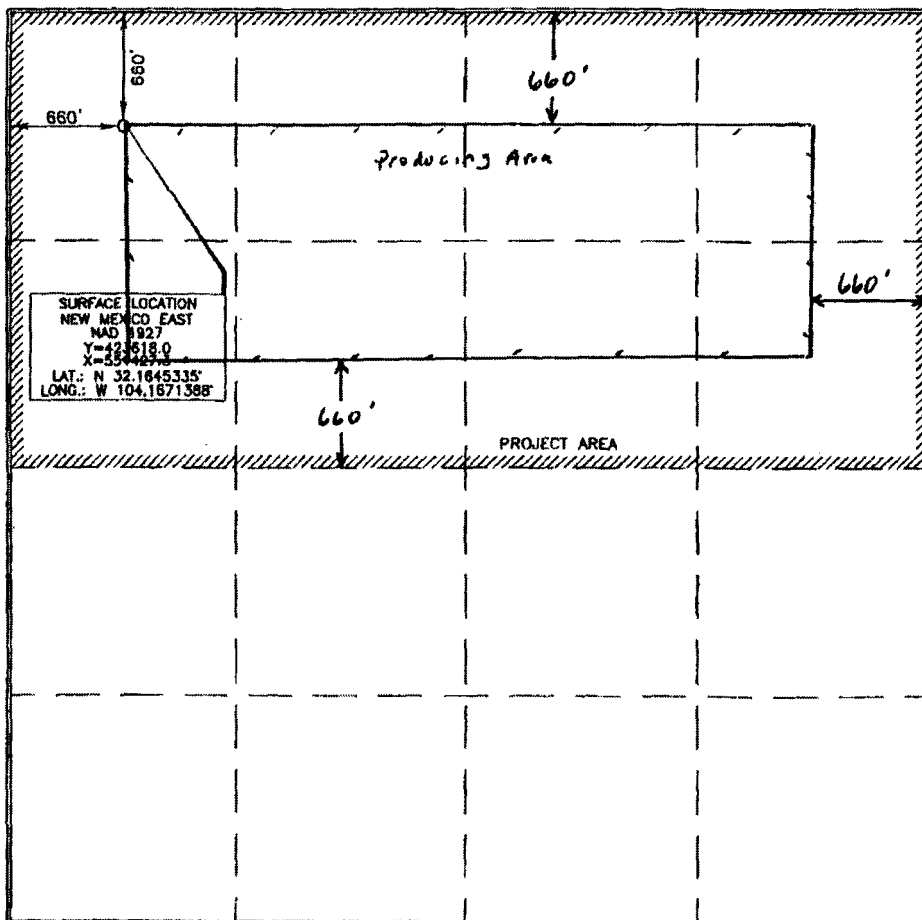

OPERATOR CERTIFICATION

I hereby certify that the information contained herein is true and complete to the best of my knowledge and belief, and that this organization either owns a working interest or unleased mineral interest in the land including the proposed bottom hole location or has a right to drill this well at this location pursuant to a contract with an owner of such a mineral or working interest, or to a voluntary pooling agreement or a compulsory pooling order heretofore entered by the division.

Donny G. Glanton 1/14/08
Signature Date

Donny G. Glanton
Printed Name

SURVEYOR CERTIFICATION

I hereby certify that the well location shown on this plat was plotted from field notes of actual surveys made by me or under my supervision, and that the same is true and correct to the best of my belief.

15079
JANUARY 8 2009
Date of Survey

Signature and Seal of Professional Surveyor

Terry J. Paul 1/14/2009
Certificate Number 15079

Permit Information:

Well Name: Muzzy 2 State Com #1

Revised 1/14/09

Location:

SL 660' FNL & 660' FWL, Section 2, T-25-S, R-27-E, Eddy Co., N.M.

BHL Same

Casing Program:

Casing	Setting Depth	Hole Size	Casing Size	Casing Weight	Casing Grade	Desired TOC
Surface	450'	17-1/2"	13-3/8"	48#	H-40	Surface
1 st Intermediate	2,300'	12-1/4"	9-5/8"	40#	J-55	Surface
2 nd Intermediate	9,500'	8-3/4"	7"	26#	HCP-110	1,900'
Production Liner	12,900'	6-1/8"	4-1/2"	11.6#	HCP-110	9,300' TOL

Cement Program:

Depth	No. Sacks	Slurries:
450'	500	Premium Plus C + 0.005 pps Static Free + 2% CaCl ₂ + 0.25 pps CelloFlake + 0.005 gps FP-6L
2,300'	400	Lead: 50:50 Poz C + 0.005 pps Static Free + 5% NaCl + 0.25 pps CelloFlake + 5 pps LCM-1 + 0.005 gps FP-6L + 10% Bentonite
	200	Tail: Premium Plus C + 0.005 pps Static Free + 2% CaCl ₂ + 0.25 pps CelloFlake + 0.005 gps FP-6L
9,500' <i>Stage 1</i>	175	Lead: 35:65 Poz H + 0.005 pps Static Free + 5% NaCl + 0.125 pps CelloFlake + 0.1% FL-52A + 0.005 gps FP-6L + 6% Bentonite + 0.1% ASA-301 + 0.1% SMS + 1% FL-62A
	465	Tail: 50:50 Poz H + 2% Bentonite + 0.005 gps FP-6L + 0.005 pps Static Free + 5% NaCl + 0.1% R-3 + 0.2% CD-32 + 0.3% FL-52A
<i>Stage 2</i>	435	Lead: 50:50 Poz C + 0.005 pps Static Free + 5% NaCl + 0.25 pps CelloFlake + 5 pps LCM-1 + 0.005 gps FP-6L + 10% Bentonite
	100	Tail: Class H + 0.005 pps Static Free + 0.005 gps FP-6L
12,900'	410	Premium Plus H + 0.005 gps FP-6L + 0.4% BA-10A + 0.005 pps Static Free + 0.4% R-3 + 0.3% CD-32 + 1% FL-62 + 0.1% ASA-301 + 0.1% SMS

Mud Program:

Depth	Type	Weight (ppg)	Viscosity	Water Loss
0 - 450'	Fresh - Gel	8.6-8.8	28-34	N/c
450' - 2,300'	Brine	10.0-10.2	28-34	N/c
2,300' - 9,500'	Fresh Water	8.4 - 8.6	28-34	N/c
9,500' - 11,600'	Cut Brine	8.8-9.6	28-34	N/c
11,600' - 12,900'	Cut Brine/ Polymer	8.8-10.6	30-40	10-15