

Submit 1 Copy To Appropriate District
Office
District I
1625 N. French Dr., Hobbs, NM 88240
District II
1301 W. Grand Ave., Artesia, NM 88210
District III
1000 Rio Brazos Rd., Aztec, NM 87410
District IV
1220 S. St. Francis Dr., Santa Fe, NM
87505

State of New Mexico
Energy, Minerals and Natural Resources

Form C-103
October 13, 2009

OIL CONSERVATION DIVISION
1220 South St. Francis Dr.
Santa Fe, NM 87505

WELL API NO. 30-015-41863
5. Indicate Type of Lease STATE <input type="checkbox"/> FEE <input checked="" type="checkbox"/>
6. State Oil & Gas Lease No.
7. Lease Name or Unit Agreement Name Daisy 24 Fee Com
8. Well Number 7H
9. OGRID Number 229137
10. Pool name or Wildcat Hay Hollow, Bone Spring, North

SUNDRY NOTICES AND REPORTS ON WELLS (DO NOT USE THIS FORM FOR PROPOSALS TO DRILL OR TO DEEPEN OR PLUG BACK TO A DIFFERENT RESERVOIR. USE "APPLICATION FOR PERMIT" (FORM C-101) FOR SUCH PROPOSALS.)	
1. Type of Well: Oil Well <input checked="" type="checkbox"/> Gas Well <input type="checkbox"/> Other <input type="checkbox"/> ARTESIA DISTRICT	
2. Name of Operator COG Operating LLC	DEC 01 2017
3. Address of Operator 2208 W. Main Street, Artesia, NM 88210	RECEIVED
4. Well Location Unit Letter <u>C</u> : <u>190'</u> feet from the <u>North</u> line and <u>1800'</u> feet from the <u>West</u> line Section <u>24</u> Township <u>25S</u> Range <u>27E</u> NMPM <u>Eddy</u> County	
11. Elevation (Show whether DR, RKB, RT, GR, etc.) 3058.7'	

12. Check Appropriate Box to Indicate Nature of Notice, Report or Other Data

NOTICE OF INTENTION TO:		SUBSEQUENT REPORT OF:	
PERFORM REMEDIAL WORK <input type="checkbox"/>	PLUG AND ABANDON <input type="checkbox"/>	REMEDIAL WORK <input type="checkbox"/>	ALTERING CASING <input type="checkbox"/>
TEMPORARILY ABANDON <input type="checkbox"/>	CHANGE PLANS <input type="checkbox"/>	COMMENCE DRILLING OPNS. <input type="checkbox"/>	P AND A <input type="checkbox"/>
PULL OR ALTER CASING <input type="checkbox"/>	MULTIPLE COMPL <input type="checkbox"/>	CASING/CEMENT JOB <input type="checkbox"/>	
DOWNHOLE COMMINGLE <input type="checkbox"/>			
OTHER: <input checked="" type="checkbox"/> APD Extension		OTHER: <input type="checkbox"/>	

13. Describe proposed or completed operations. (Clearly state all pertinent details, and give pertinent dates, including estimated date of starting any proposed work). SEE RULE 19.15.7.14 NMAC. For Multiple Completions: Attach wellbore diagram of proposed completion or recompletion.

COG Operating LLC respectfully requests approval for a 2 year extension on the above referenced APD.

C102 Attached.

4 pgs 12-13-2017

*new extension
12-13-2018*

Spud Date:

Rig Release Date:

I hereby certify that the information above is true and complete to the best of my knowledge and belief.

SIGNATURE Genesis Vasquez TITLE: Regulatory Assistant DATE: 11/30/2017
Type or print name: Genesis Vasquez E-mail address: ggazaperez@concho.com PHONE: (575) 748-6926
For State Use Only

APPROVED BY: [Signature] TITLE: Staff DATE: 12-15-17
Conditions of Approval (if any):

12-22-17

DISTRICT I
1625 N. FREYCH DR., NOBLES, NM 86248
Phone: (575) 359-8181 Fax: (575) 359-8728

DISTRICT II
1351 W. GRAND AVENUE, ARTESIA, NM 86210
Phone: (575) 748-1253 Fax: (575) 748-8720

DISTRICT III
1000 RIO BRAZOS RD., AZTEC, NM 87410
Phone: (505) 334-8178 Fax: (505) 334-8170

DISTRICT IV
11885 S. ST. FRANCIS DR., SANTA FE, NM 87505
Phone: (505) 478-3480 Fax: (505) 478-3482

State of New Mexico
Energy, Minerals & Natural Resources Department
OIL CONSERVATION DIVISION
11885 SOUTH ST. FRANCIS DR.
Santa Fe, New Mexico 87505

Form C-102
Revised August 1, 2011
Submit one copy to appropriate

☐ AMENDED REPORT

WELL LOCATION AND ACREAGE DEDICATION PLAT

API Number 30-015-41863	Pool Code 30216	Pool Name Hay Hollow; Bone Spring, North
Property Code 38519	Property Name DAISY 24 FEE COM	Well Number 7H
OGRID No. 229137	Operator Name COG OPERATING, LLC	Elevation 3058.7

Surface Location

UL or lot No.	Section	Township	Range	Lot Idn	Feet from the	North/South line	Feet from the	East/West line	County
C	24	25-S	27-E		190	NORTH	1800	WEST	EDDY

Bottom Hole Location If Different From Surface

UL or lot No.	Section	Township	Range	Lot Idn	Feet from the	North/South line	Feet from the	East/West line	County
N	25	25-S	27-E		330	SOUTH	1800	WEST	EDDY

Dedicated Acres	Joint or Infill	Consolidation Code	Order No.
320			

NO ALLOWABLE WILL BE ASSIGNED TO THIS COMPLETION UNTIL ALL INTERESTS HAVE BEEN CONSOLIDATED
OR A NON-STANDARD UNIT HAS BEEN APPROVED BY THE DIVISION

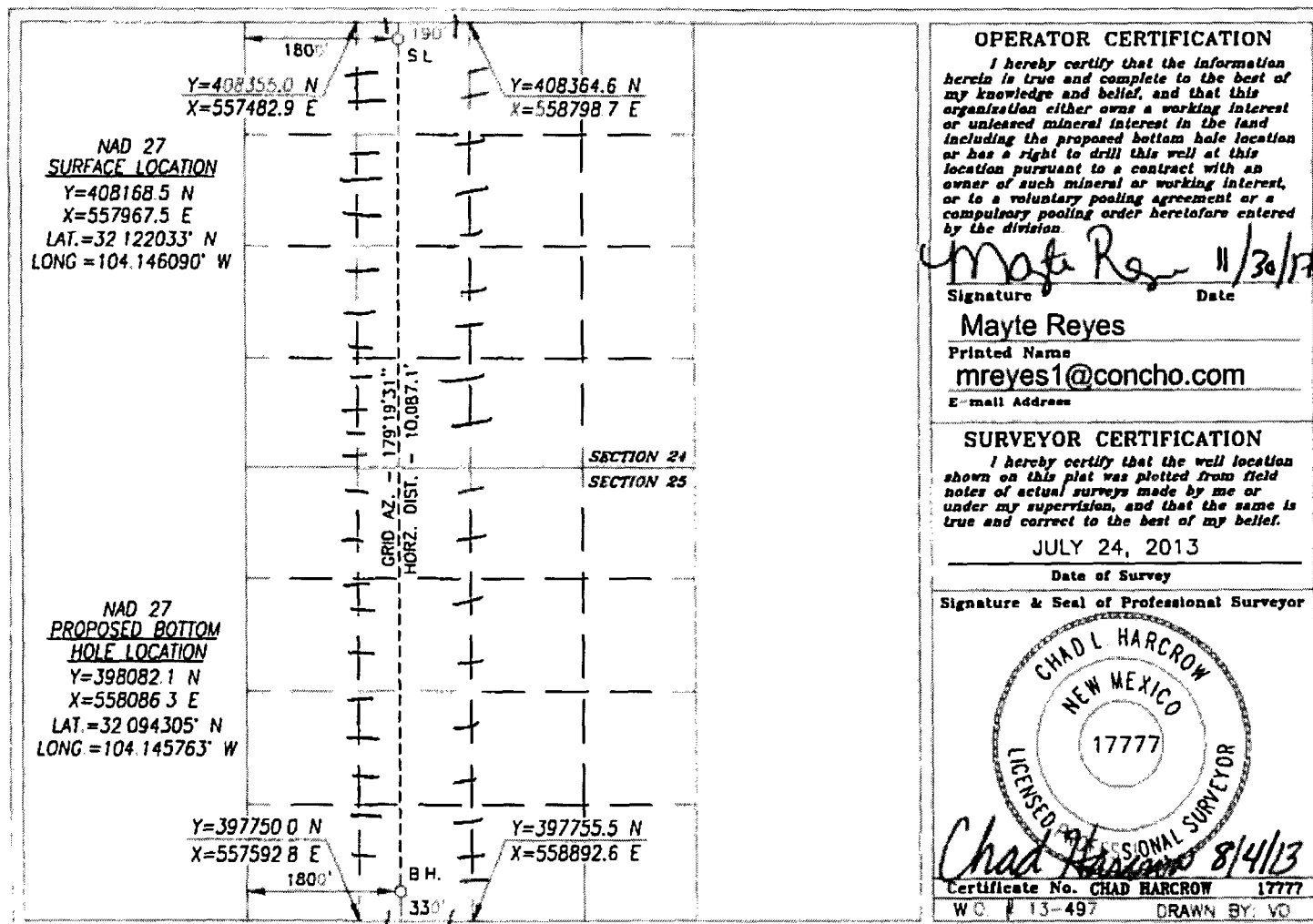

OPERATOR CERTIFICATION

I hereby certify that the information herein is true and complete to the best of my knowledge and belief, and that this organization either owns a working interest or unleased mineral interest in the land including the proposed bottom hole location or has a right to drill this well at this location pursuant to a contract with an owner of such mineral or working interest, or to a voluntary pooling agreement or a compulsory pooling order heretofore entered by the division.

Signature: *Mayte Reyes* Date: 11/30/13

Printed Name: Mayte Reyes

E-mail Address: mreyes1@concho.com

SURVEYOR CERTIFICATION

I hereby certify that the well location shown on this plat was plotted from field notes of actual surveys made by me or under my supervision, and that the same is true and correct to the best of my belief.

Date of Survey: JULY 24, 2013

Signature & Seal of Professional Surveyor

Signature & Seal of Professional Surveyor



Certificate No. CHAD HARCROW 17777
W.C. 13-497 DRAWN BY: VO