



PHOENIX
TECHNOLOGY SERVICES

December 20, 2017

Oil Conservation Division
State of New Mexico
811 S. First St.
Artesia, New Mexico 88210

Dear District 2 - Artesia

Re: EOG Resources
Federal CW B #6
Eddy Co., New Mexico
API #30-015-23240
Job No. 62148

NM OIL CONSERVATION
ARTESIA DISTRICT
DEC 26 2017
RECEIVED

Enclosed please find the Survey Data Certification, and the original Plat and one copy of the Survey Report performed on the above referenced Well by Phoenix Technology Services, Inc. (P-5 No. 606018). Other information required by your office is as follows:

Name & Title of Surveyor	Drainhole Number	Surveyed Depths		Dates Performed		Type of Survey
		From	To	Start	End	
Noe Garza	6	0	2,300	12/19/17	12/19/17	Gyro

A certified plat on which the bottom hole location is oriented both to the surface location and to the lease lines (or unit lines in case of pooling) is attached to the survey report. If any other information is required, please contact the undersigned at the letterhead address and phone number.

Best Regards,

Brittany Carley

Brittany Carley
Operations Administrator

SURVEY CERTIFICATION FORM



PHOENIX
TECHNOLOGY SERVICES

3610 Elkins Road Midland, TX 79705 t:432-684-0057 f: 432-686-7964

Company: EOG

Job #: 62148

Well Name: Federal CW B # 6

County/State: Eddy Co., New Mexico

Survey Instrument Type: North Seek Rate Gyro

API # 30-015-23240

TIE-IN DATA

Measure Depth (ft)	Vertical Depth (ft)	Inclination (°)	Azimuth (°)	N-S Coordinates	E-W Coordinates	Data Source
0	0	0	0	0	0	Surface

First Survey

Date	Depth (ft)	Inclination (°)	Azimuth (°)
2017-12-19	0	0	0

Last Survey

Date	Depth (ft)	Inclination (°)	Azimuth (°)
2017-12-19	2300	0.64	48.96

Projected TD Survey

Date	Depth (ft)	Inclination (°)	Azimuth (°)
0	0	0	0

Grid Correction
0.11

Gyro Operator: Phoenix Technology Services USA Ltd.

Gyro Supervisor: Angel Guebara

To the best of my knowledge I certify this survey data to be correct and true

Date:

12-19-17

Print Name: Noe Garza

Signature:

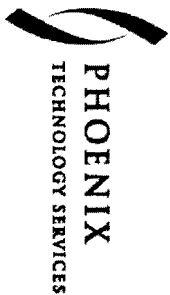

Company: EOG
Well: Federal CW B # 6
Location: Eddy Co., New Mexico
Rig: Pulling Unit

Job Number: 62148
Grid Corr.: 0.11
Lat: 32.684120
Long: -104.538390
Grid Ref: NAD 83

Date: 12-19-17
Calculation Method: Minimum Curvature
Proposed Azimuth: Ground
RKB - MSL in feet: Surface
Tie Info:

Survey Tool Type	Survey Depth (ft)	Inclination (deg)	Azimuth (deg)	Course Length (ft)	True Vertical Depth (ft)	Vertical Section (ft)	Coordinates		Closure		Dogleg Severity (d/100')	Build Rate (d/100')	Walk Rate (d/100')
							N/S (ft)	E/W (ft)	Distance (ft)	Angle (deg)			
FIELD COPY, NON-DEFINITIVE													
Enter Tie-In Survey on Line 10													
TIE IN	0			0	0	0	0	0					
Gyro	100.00	0.30	214.05	100	100.00	-0.22	0.22 S	0.15 W	0.26	214.05	0.30	0.30	214.05
	200.00	0.68	151.48	100	200.00	-0.96	0.96 S	0.01 W	0.96	180.59	0.60	0.38	-62.57
	300.00	1.32	146.59	100	299.98	-2.44	2.44 S	0.91 E	2.60	159.58	0.65	0.64	-4.89
	400.00	1.35	158.25	100	399.95	-4.49	4.49 S	1.98 E	4.91	156.24	0.27	0.03	11.66
	500.00	1.29	165.32	100	499.93	-6.68	6.68 S	2.70 E	7.20	157.98	0.17	-0.06	7.07
	600.00	1.22	162.05	100	599.90	-8.78	8.78 S	3.31 E	9.38	159.32	0.10	-0.07	-3.27
	700.00	1.26	144.74	100	699.88	-10.69	10.69 S	4.28 E	11.51	158.19	0.38	0.04	-17.31
	800.00	0.90	127.85	100	799.86	-12.07	12.07 S	5.53 E	13.28	155.38	0.48	-0.36	-16.89
	900.00	0.88	121.23	100	899.85	-12.95	12.95 S	6.81 E	14.63	152.27	0.10	-0.02	-6.62
	1000.00	0.90	117.79	100	999.84	-13.71	13.71 S	8.16 E	15.96	149.25	0.06	0.02	-3.44
	1100.00	0.88	123.40	100	1099.83	-14.50	14.50 S	9.50 E	17.33	146.78	0.09	-0.02	5.61
	1200.00	0.82	129.12	100	1199.82	-15.38	15.38 S	10.69 E	18.73	145.19	0.10	-0.06	5.72
	1300.00	0.57	163.89	100	1299.81	-16.31	16.31 S	11.38 E	19.89	145.08	0.48	-0.25	34.77
	1400.00	0.25	109.49	100	1399.81	-16.86	16.86 S	11.73 E	20.53	145.17	0.47	-0.32	-54.40
	1500.00	0.87	102.35	100	1499.80	-17.09	17.09 S	12.68 E	21.28	143.44	0.62	0.62	-7.14
	1600.00	0.96	112.53	100	1599.79	-17.57	17.57 S	14.19 E	22.59	141.08	0.19	0.09	10.18
	1700.00	0.49	83.90	100	1699.78	-17.85	17.85 S	15.39 E	23.57	139.23	0.58	-0.47	-28.63
	1800.00	0.91	74.73	100	1799.77	-17.60	17.60 S	16.58 E	24.18	136.70	0.43	0.42	-9.17
	1900.00	0.45	106.08	100	1899.76	-17.50	17.50 S	17.72 E	24.90	134.63	0.58	-0.46	31.35
	2000.00	0.44	54.65	100	1999.76	-17.38	17.38 S	18.42 E	25.32	133.35	0.39	-0.01	-51.43
	2100.00	0.47	107.54	100	2099.76	-17.28	17.28 S	19.12 E	25.77	132.11	0.41	0.03	52.89
	2200.00	0.35	40.68	100	2199.76	-17.18	17.18 S	19.71 E	26.14	131.07	0.46	-0.12	-66.86
	2300.00	0.64	48.96	100	2299.75	-16.58	16.58 S	20.33 E	26.23	129.19	0.30	0.29	8.28

NEW MEXICO OIL CONSERVATION COMMISSION
WELL LOCATION AND ACREAGE DEDICATION PLAT

Form C-102
Supersedes C-128
Effective 1-1-65

All distances must be from the outer boundaries of the Section.

Operator YATES PETROLEUM CORPORATION			Lease Federal CW		Well No. 6
Unit Letter O	Section 1	Township 19 South	Range 24 East	County Eddy	
Actual Footage Location of Well: 1650 feet from the East line and 330 feet from the South line					
Ground Level Elev. 3648.8	Producing Formation San Andres		Pool Penasco Draw S.A.-Yeso		Dedicated Acreage: 40 Acres

1. Outline the acreage dedicated to the subject well by colored pencil or highlighters on the plat below.
2. If more than one lease is dedicated to the well, outline each and identify the ownership thereof (both as to working interest and royalty).
3. If more than one lease of different ownership is dedicated to the well, have all interests of all owners been consolidated by communitization, unitization, force-pooling, etc?

☐ Yes ☐ No If answer is "yes," type of consolidation _____

If answer is "no," list the owners and tract descriptions which have actually been consolidated. (Use reverse side of this form if necessary.) _____

No allowable will be assigned to the well until all interests have been consolidated (by communitization, unitization, forced-pooling, or otherwise) or until a non-standard unit, eliminating such interests, has been approved by the Commission.

RECEIVED

FEB 11, 1980

**U.S. GEOLOGICAL SURVEY
ARTESIA, NEW MEXICO**



111-439491

330' 1650'

CERTIFICATION

I hereby certify that the information contained herein is true and complete to the best of my knowledge and belief.

Gliserio Rodriguez
Name

Gliserio Rodriguez

Position
Geographer

Company
Yates Petroleum Corp.

Date
February 4, 1980

I hereby certify that the well location shown on this plat was plotted from field notes of actual surveys made by me or under my supervision, and that the same is true and correct to the best of my knowledge and belief.

Date Surveyed
Jan. 25, 1980

Registered Professional Engineer and/or Land Surveyor

Dan R. Reddy
Certificate No.

NM PE&LS #5412

0 330 660 990 1320 1650 1980 2310 2640 2970 3300 3630 3960 4290 4620 4950 5280 5610 5940 6270 6600

NEW MEXICO OIL CONSERVATION COMMISSION
WELL LOCATION AND ACREAGE DEDICATION PLAT

Form C-102
Supersedes C-128
Effective 1-1-65

All distances must be from the outer boundaries of the Section.

Operator Yates Petroleum Corporation			Lease Federal CW		Well No. 6
Unit Letter 0	Section 1	Township 19S	Range 24E	County Eddy	
Actual Footage Location of Well: 1650 feet from the East line and 430 feet from the South line					
Ground Level Elev. 3648.8	Producing Formation San Andres		Pool Penasco Draw S.A.-Yeso Assoc.		Dedicated Acreage: 40 Acres

1. Outline the acreage dedicated to the subject well by colored pencil or hachure marks on the plat below.
2. If more than one lease is dedicated to the well, outline each and identify the ownership interest (both as to working interest and royalty).
3. If more than one lease of different ownership is dedicated to the well, have the interests of all owners been consolidated by communitization, unitization, force-pooling, etc?

☐ Yes ☐ No If answer is "yes," type of consolidation _____

If answer is "no," list the owners and tract descriptions which have actually been consolidated. (Use reverse side of this form if necessary.) _____

No allowable will be assigned to the well until all interests have been consolidated (by communitization, unitization, forced-pooling, or otherwise) or until a non-standard unit, eliminating such interests, has been approved by the Commission.

RECEIVED
MAR 21 1980
U.S. GEOLOGICAL SURVEY
ARTESIA, NEW MEXICO

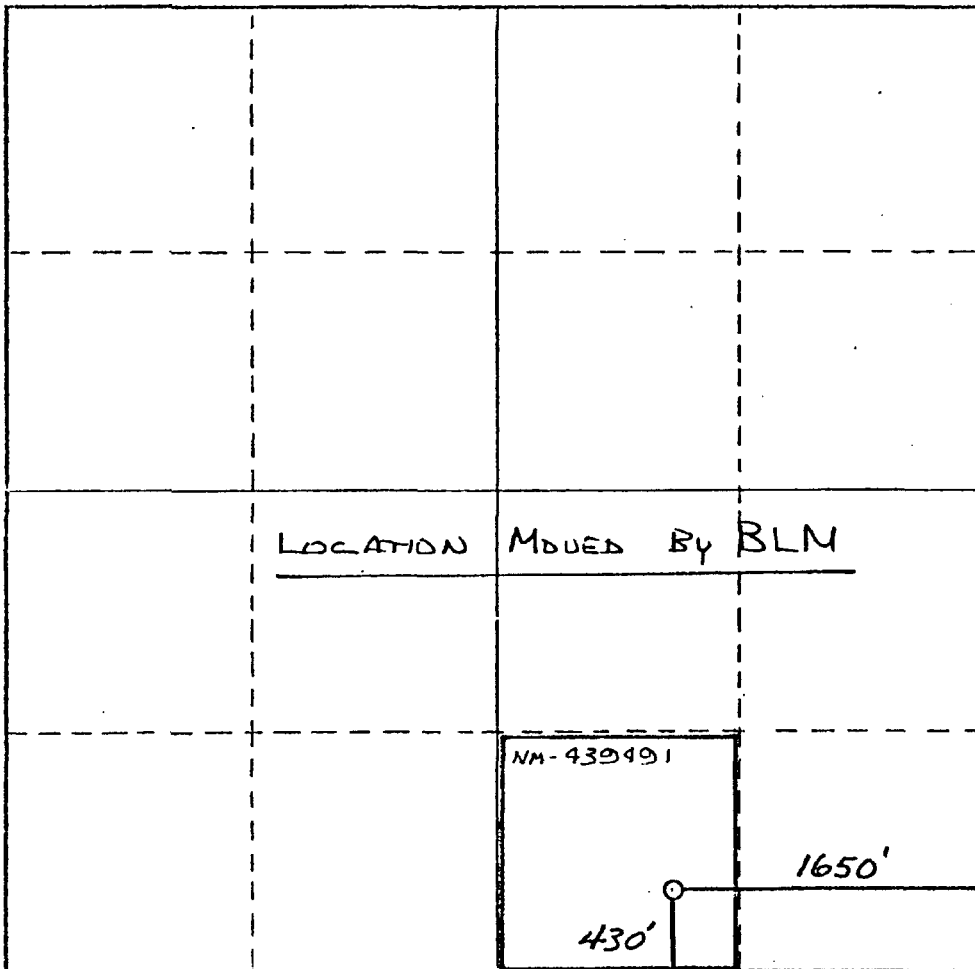

CERTIFICATION

I hereby certify that the information contained herein is true and complete to the best of my knowledge and belief.

Gliserio Rodriguez

Name
Gliserio Rodriguez

Position
Geographer

Company
Yates Petroleum Corp.

Date
3/21/80

I hereby certify that the well location shown on this plat was plotted from field notes of actual surveys made by me or under my supervision, and that the same is true and correct to the best of my knowledge and belief.

REFER TO ORIGINAL PLAT
DATED 1-25-80

Date Surveyed

Registered Professional Engineer
and/or Land Surveyor

Certificate No.

