

Form C-102  
Revised August 1, 2011  
Submit one copy to appropriate District Office  
**NM OIL CONSERVATION**  
ARTESIA DISTRICT  
☐ AMENDED REPORT  
DEC 21 2017

SECTION 24	SECTION 19		SECTION 20	
SECTION 25	SECTION 30	<p style="text-align: center;">CALLED 320 ACRE PRODUCING AREA</p>	SECTION 29	
SECTION 26	SECTION 31		SECTION 28	SECTION 32

**LAST TAKE POINT/BOTTOM HOLE LOCATION**  
330' FNL 330' FEL  
NAD 83, SPCS NM EAST  
X:607515.51' / Y:466539.22'  
LAT:32.28240890N / LDN104.11918889W  
NAD 27, SPCS NM EAST  
X:566332.81' / Y:466480.28'  
LAT:32.28228858N / LDN104.11869287W

**FIRST TAKE POINT**  
330' FSL 330' FEL  
NAD 83, SPCS NM EAST  
X:607539.38' / Y:461911.26'  
LAT:32.26968715N / LDN104.11914156W  
NAD 27, SPCS NM EAST  
X:566356.57' / Y:461852.44'  
LAT:32.26956675N / LDN104.11864597W

**SURFACE HOLE LOCATION**  
368' FSL 738' FEL  
NAD 83, SPCS NM EAST  
X:607131.10' / Y:461950.67'  
LAT:32.26979771N / LDN104.12046225W  
NAD 27, SPCS NM EAST  
X:565948.30' / Y:461891.85'  
LAT:32.26967733N / LDN104.11996660W

**CORNER COORDINATES**  
NAD 83, SPCS NM EAST  
A - X: 605195.28' / Y: 466881.59'  
B - X: 607843.03' / Y: 466867.47'  
C - X: 607871.09' / Y: 461580.40'  
D - X: 605201.88' / Y: 461587.35'

**CORNER COORDINATES**  
NAD 27, SPCS NM EAST  
A - X: 564012.63' / Y: 466822.68'  
B - X: 566661.13' / Y: 466808.52'  
C - X: 566688.27' / Y: 461521.58'  
D - X: 564019.10' / Y: 461528.57'

**17 OPERATOR CERTIFICATION**

I hereby certify that the information contained herein is true and complete to the best of my knowledge and belief, and that this organization either owns a working interest or unleased mineral interest in the land including the proposed bottom hole location or has a right to drill this well at this location pursuant to a contract with an owner of such a mineral or working interest, or to a voluntary pooling agreement or a compulsory pooling order heretofore entered by the division.

Signature

12/19/2017

Date

**Melissa Szudera**

Printed Name

**mszudera@marathonoil.com**

E-mail Address

**18 SURVEYOR CERTIFICATION**

I hereby certify that the well location shown on this plat was plotted from field notes of actual surveys made by me or under my supervision, and that the same is true and correct to the best of my belief.

NOVEMBER 29, 2017

Date of Survey

Signature and Seal of Professional Surveyor

Certificate Number

LLOYD P. SHORT 21653

# LOCATION VERIFICATION MAP

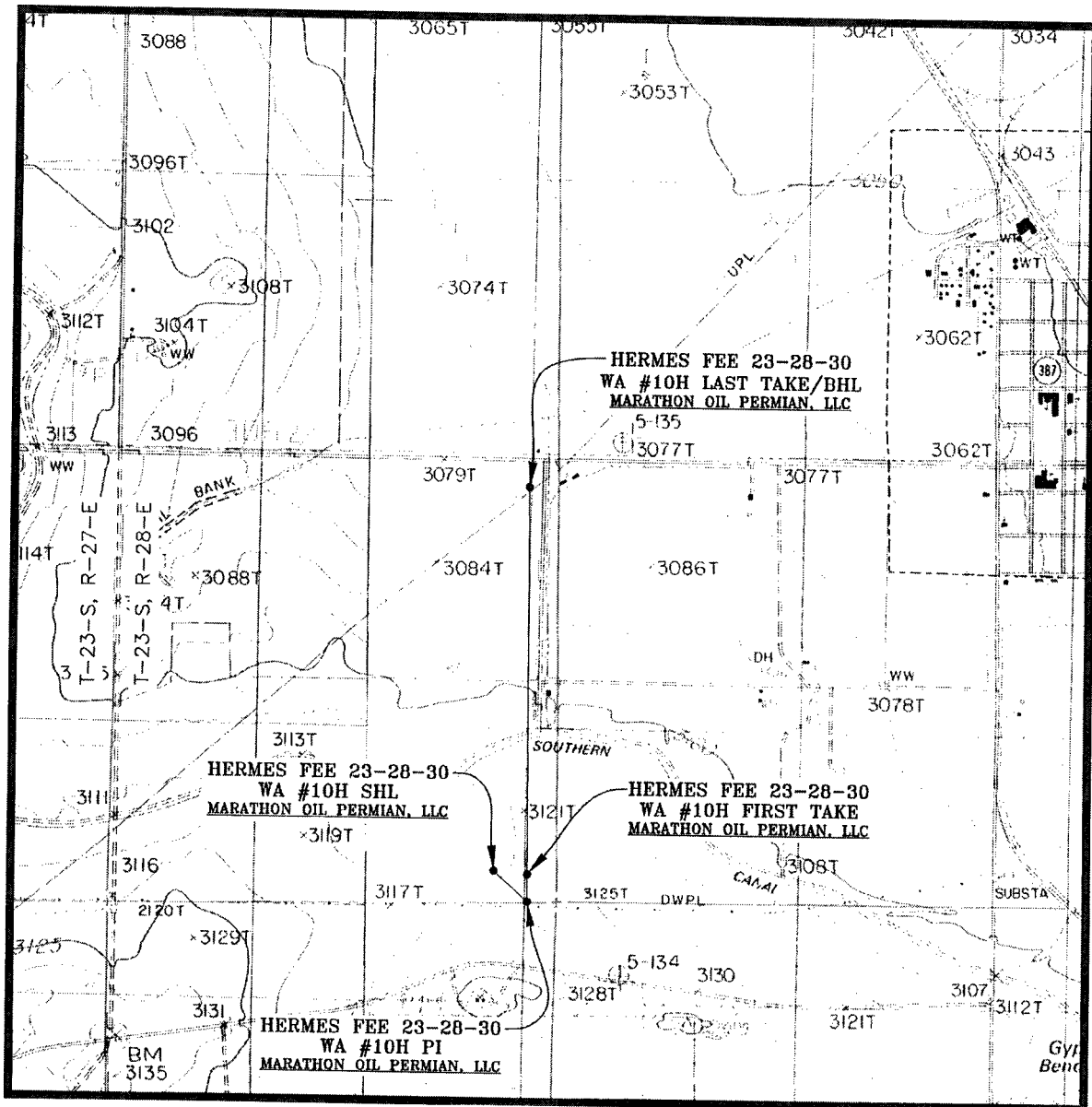

SEC. 30 TWP. 23-S RGE. 28-E

SURVEY: N.M.P.M.

COUNTY: EDDY

DESCRIPTION: 368' FSL & 738' FEL

ELEVATION: 3205'

OPERATOR: MARATHON OIL PERMIAN, LLC

LEASE: HERMES FEE 23-28-30

U.S.G.S. TOPOGRAPHIC MAP: LOVING, N.M.

SCALE: 1" = 2000'

CONTOUR INTERVAL = 10'

PREPARED BY:  
R-SQUARED GLOBAL, LLC  
1309 LOUISVILLE AVENUE, MONROE, LA 71201  
318-323-6900 OFFICE  
JOB No. R3701\_008

# VICINITY MAP

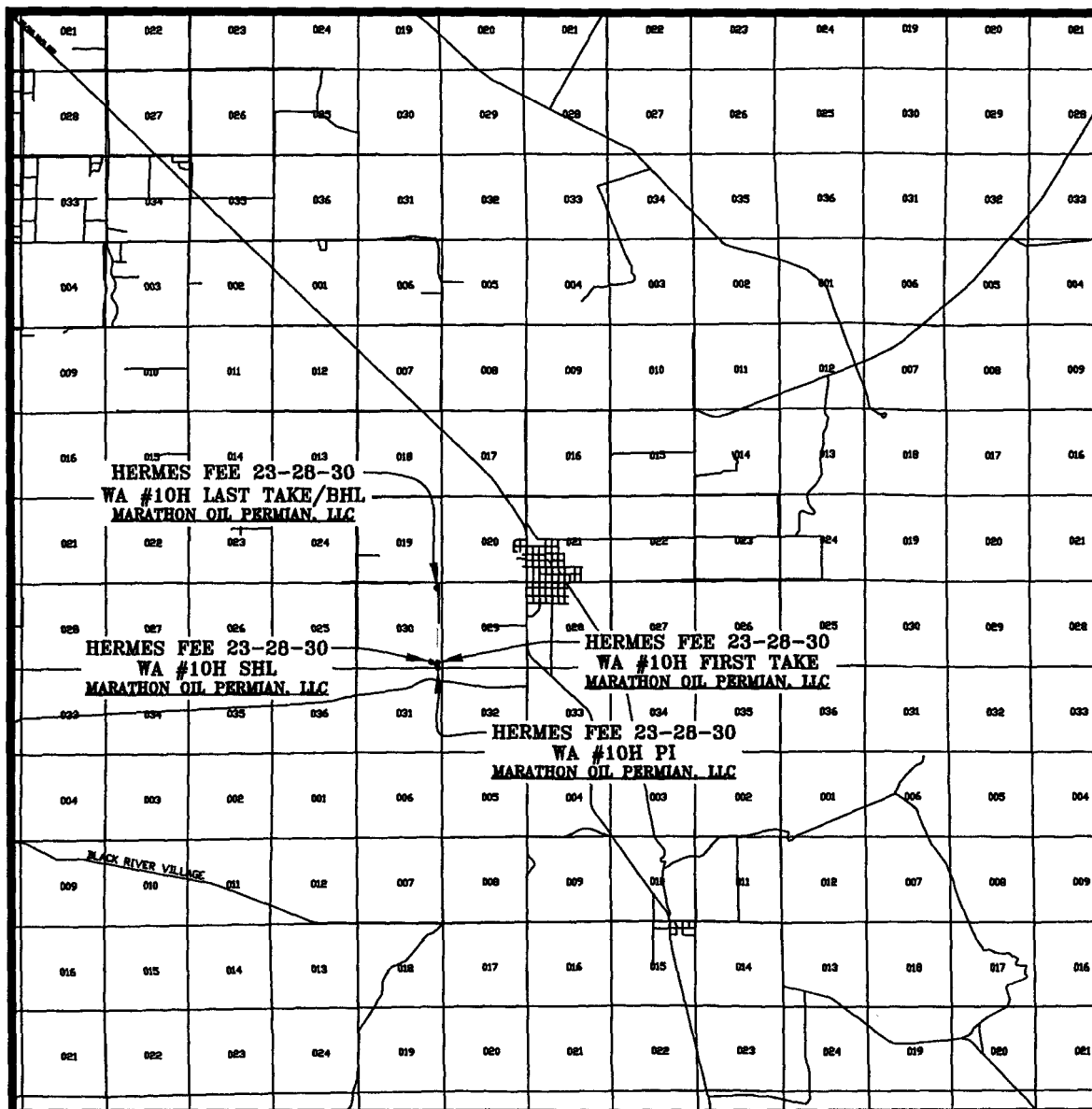

SEC. 30 TWP. 23-S RGE. 28-E  
 SURVEY: N.M.P.M.  
 COUNTY: EDDY  
 DESCRIPTION: 368' FSL & 738' FEL  
 ELEVATION: 3205'  
 OPERATOR: MARATHON OIL PERMIAN, LLC  
 LEASE: HERMES FEE 23-28-30  
 U.S.G.S. TOPOGRAPHIC MAP: LOVING, N.M.

SCALE: 1" = 2 MILES

PREPARED BY:  
 R-SQUARED GLOBAL, LLC  
 1309 LOUISVILLE AVENUE, MONROE, LA 71201  
 318-323-6900 OFFICE  
 JOB No. R3791\_006