

District I
1625 N. French Dr., Hobbs, NM 88240
Phone: (575) 393-6161 Fax: (575) 393-0720
District II
811 S. First St., Artesia, NM 88210
Phone: (575) 748-1283 Fax: (575) 748-9720
District III
1000 Rio Brazos Road, Aztec, NM 87410
Phone: (505) 334-6178 Fax: (505) 334-6170
District IV
1220 S. St. Francis Dr., Santa Fe, NM 87505
Phone: (505) 476-3460 Fax: (505) 476-3462

State of New Mexico
Energy, Minerals & Natural Resources Department
OIL CONSERVATION DIVISION
1220 South St. Francis Dr.
Santa Fe, NM 87505

Form C-102
Revised August 1, 2011
Submit one copy to appropriate
District Office

FEB 02 2018 ☐ AMENDED REPORT

WELL LOCATION AND ACREAGE DEDICATION

¹ API Number 30-015-44662	² Pool Code 98220	³ Pool Name PURPLE SAGE; WOLFCAMP
⁴ Property Code 320694	⁵ Property Name SWEET TEA STATE 24-29-31 WA	⁶ Well Number 5H
⁷ OGRID No. 372098	⁸ Operator Name MARATHON OIL PERMIAN LLC	⁹ Elevation 2,921'

¹⁰ Surface Location

UL or lot no.	Section	Township	Range	Lot Idn	Feet from the	North/South line	Feet from the	East/West line	County
L (LOT 3)	31	T24S	R29E		2,407	SOUTH	356	WEST	EDDY

¹¹ Bottom Hole Location If Different From Surface

UL or lot no.	Section	Township	Range	Lot Idn	Feet from the	North/South line	Feet from the	East/West line	County
M (LOT 7)	6	T25S	R29E		330	SOUTH	330	WEST	EDDY

¹² Dedicated Acres 475.65	¹³ Joint or Infill	¹⁴ Consolidation Code	¹⁵ Order No.
--	-------------------------------	----------------------------------	-------------------------

No allowable will be assigned to this completion until all interests have been consolidated or a non-standard unit has been approved by the division.

¹⁶ SECTION 25 SECTION 36 FIRST TAKE POINT 2,339' FSL 330' FWL, SECTION 31 NAD 83, SPCS NM EAST Y426769.35 / X634825.66 LAT:32.1729064N / LON:104.03117922W NAD 27, SPCS NM EAST Y426710.89 / X593641.55 LAT:32.17278319N / LON:104.03069034W 330' 330' FIRST TAKE POINT SECTION 36 SECTION 1 LAST TAKE POINT/BOTTOM HOLE LOCATION 330' FSL 330' FWL, SECTION 6 NAD 83, SPCS NM EAST Y419441.73 / X634836.42 LAT:32.15276311N / LON:104.03121092W NAD 27, SPCS NM EAST Y419383.42 / X593652.14 LAT:32.15264002N / LON:104.03072270W SECTION 1 SECTION 12 R-28-E R-29-E 330' BHL/ LAST TAKE POINT				SECTION 30 SECTION 31 SURFACE HOLE LOCATION 2,407' FSL 356' FWL, SECTION 31 NAD 83, SPCS NM EAST Y426836.64 / X634851.12 LAT:32.17309082N / LON:104.03109628W NAD 27, SPCS NM EAST Y426776.18 / X593667.02 LAT:32.17296797N / LON:104.03060740W CORNER COORDINATES NAD 83, SPCS NM EAST A - Y: 427097.80 / X: 634494.93 B - Y: 427111.01 / X: 637144.06 C - Y: 419151.27 / X: 637140.03 D - Y: 419106.02 / X: 634506.81 CORNER COORDINATES NAD 27, SPCS NM EAST A - Y: 427039.34 / X: 593310.84 B - Y: 427052.52 / X: 593595.91 C - Y: 419092.94 / X: 593595.70 D - Y: 419047.72 / X: 593322.53 SECTION 31 SECTION 6 SECTION 7 SECTION 32 SECTION 5 SECTION 8 T-24-S T-25-S CALLED 475.65 ACRE PRODUCING AREA				¹⁷ OPERATOR CERTIFICATION I hereby certify that the information contained herein is true and complete to the best of my knowledge and belief, and that this organization either owns a working interest or unleased mineral interest in the land including the proposed bottom hole location or has a right to drill this well at this location pursuant to a contract with an owner of such a mineral or working interest, or to a voluntary pooling agreement or a compulsory pooling order heretofore entered by the division. Signature <i>Melissa Szudera</i> Date 2/1/2018 Printed Name Melissa Szudera E-mail Address mszudera@marathonoil.com ¹⁸ SURVEYOR CERTIFICATION I hereby certify that the well location shown on this plat was plotted from field notes of actual surveys made by me or under my supervision, and that the same is true and correct to the best of my belief. JANUARY 10, 2018 Date of Survey Signature and Seal of Professional Surveyor <i>Lloyd P. Short</i> Certificate Number LLOYD P. SHORT 21653			
--	--	--	--	---	--	--	--	--	--	--	--

1 01/04/2018 ANC
REV. DATE BY

NSP Required

REP 2-2-2018

LOCATION VERIFICATION MAP

NM OIL CONSERVATION
ARTESIA DISTRICT
FEB 02 2018

RECEIVED

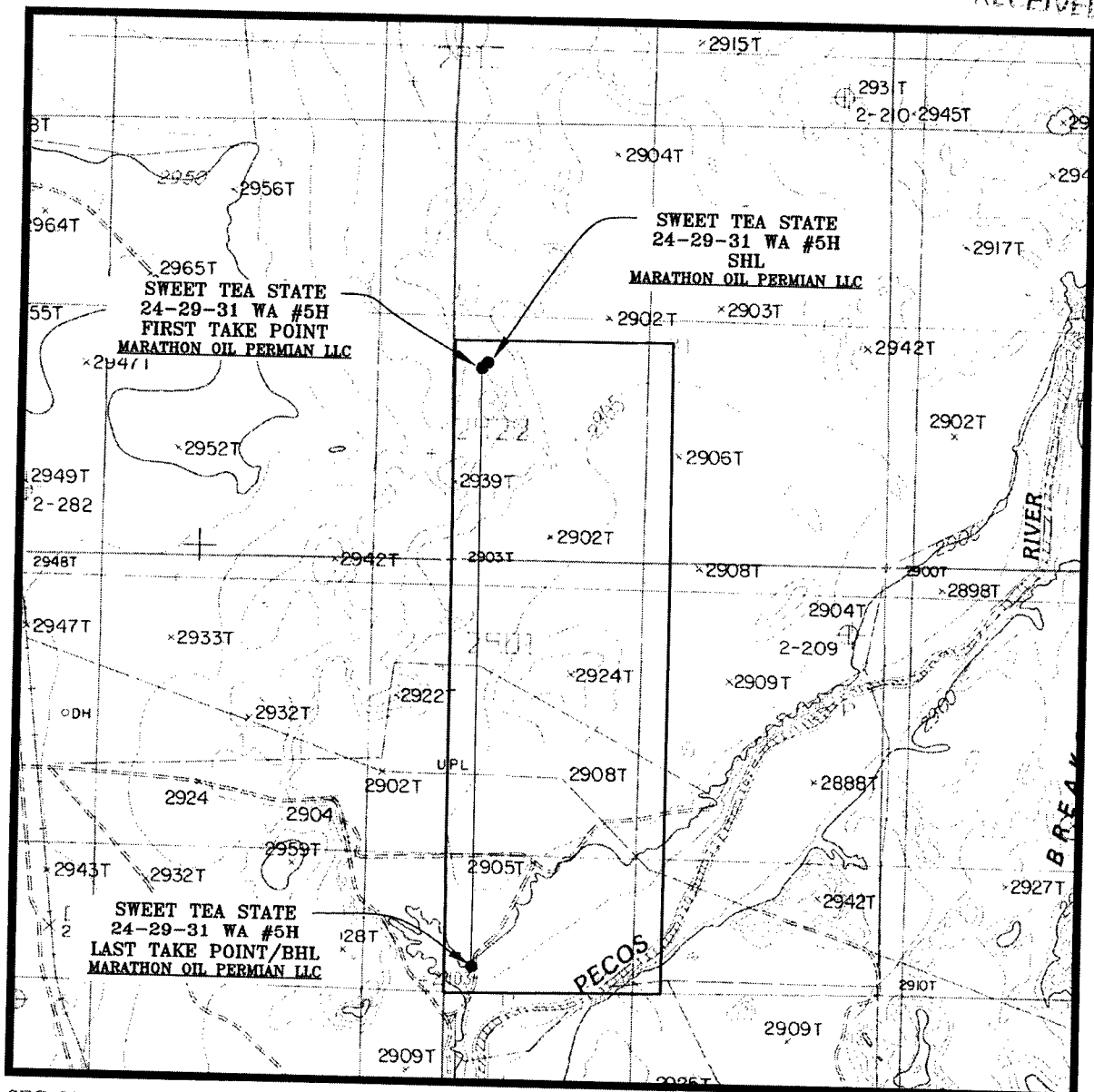

SEC. 31 TWP. 24-S RGE. 29-E
SURVEY: N.M.P.M.
COUNTY: EDDY
DESCRIPTION: 2,407' FSL & 356' FWL
ELEVATION: 2921'
OPERATOR: MARATHON OIL PERMIAN LLC
LEASE: SWEET TEA STATE 24-29-31
U.S.G.S. TOPOGRAPHIC MAP: MALAGA, N.M.

SCALE: 1" = 2000'
CONTOUR INTERVAL = 10'

PREPARED BY:
R-SQUARED GLOBAL, LLC
1309 LOUISVILLE AVENUE, MONROE, LA 71201
318-323-8900 OFFICE
JOB No. R3815_001

NM OIL CONSERVATION
ARTESTA DISTRICT
FEP 02 2018

VICINITY MAP

RECEIVED

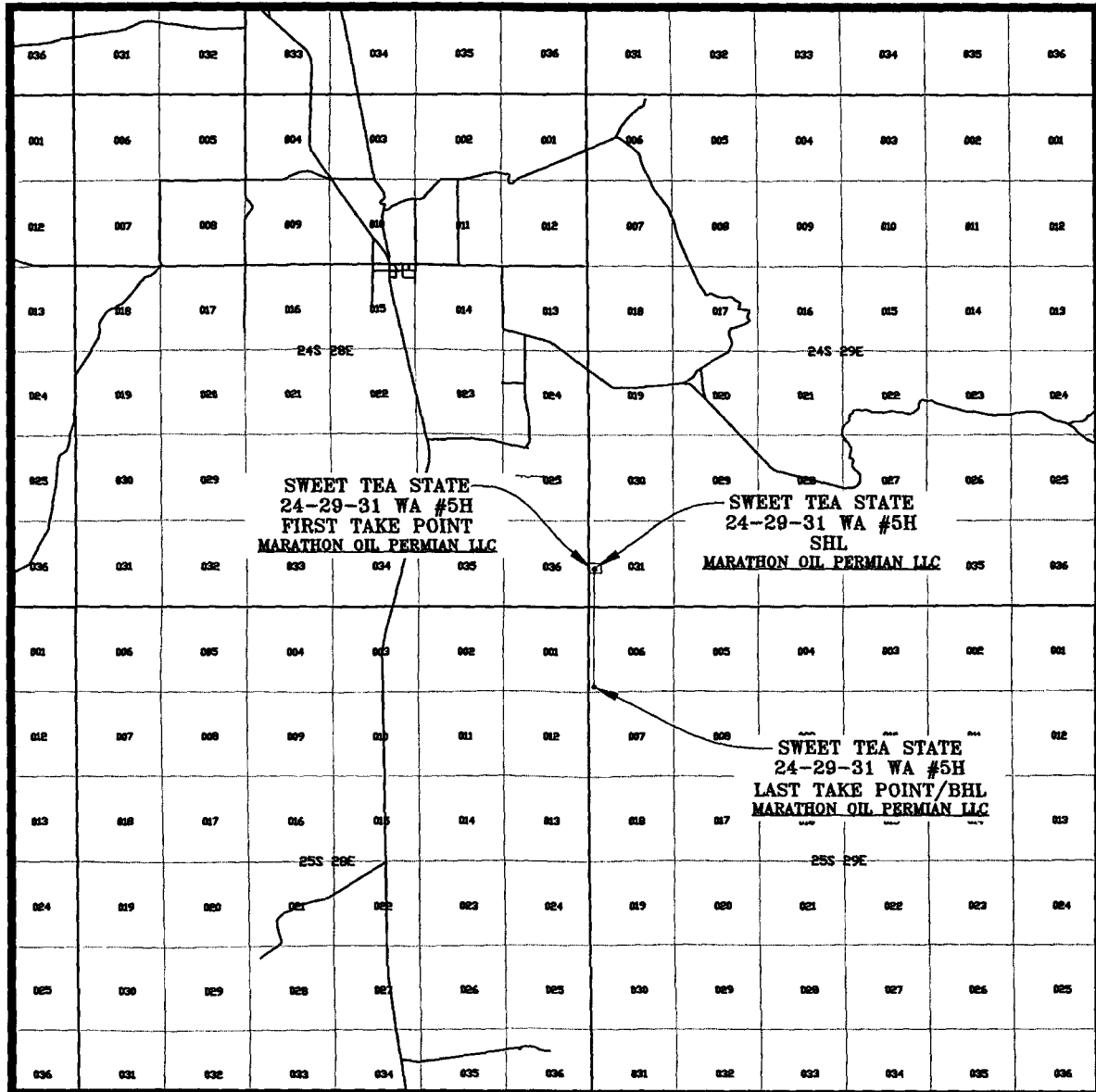

SEC. 31 TWP. 24-S RGE. 29-E
SURVEY: N.M.P.M.
COUNTY: EDDY
DESCRIPTION: 2,407' FSL & 356' FWL
ELEVATION: 2921'
OPERATOR: MARATHON OIL PERMIAN LLC
LEASE: SWEET TEA STATE 24-29-31
U.S.G.S. TOPOGRAPHIC MAP: MALAGA, N.M.

SCALE: 1" = 2 MILES

PREPARED BY:
R-SQUARED GLOBAL, LLC
1309 LOUISVILLE AVENUE, MONROE, LA 71201
318-323-6900 OFFICE
JOB No. RSB15_001