

**17 OPERATOR CERTIFICATION**  
I hereby certify that the information contained herein is true and complete to the best of my knowledge and belief, and that this organization either owns a working interest or unleased mineral interest in the land including the proposed bottom hole location or has a right to drill this well at this location pursuant to a contract with an owner of such a mineral or working interest or to a voluntary pooling agreement or a compulsory pooling order heretofore entered by the division.

 2/9/2018

Signature \_\_\_\_\_ Date \_\_\_\_\_

**Melissa Szudera**  
Printed Name \_\_\_\_\_

**mszudera@marathonoil.com**  
E-mail Address \_\_\_\_\_

**18 SURVEYOR CERTIFICATION**  
I hereby certify that the well location shown on this plat was plotted from field notes of actual surveys made by me or under my supervision, and that the same is true and correct to the best of my belief.

**FEBRUARY 02, 2018**

Date of Survey \_\_\_\_\_

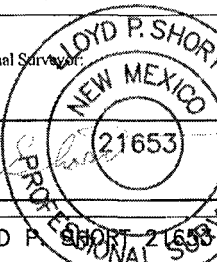
Signature and Seal of Professional Surveyor: 

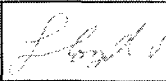
 \_\_\_\_\_

\_\_\_\_\_  
Professional Surveyor

\_\_\_\_\_  
LLOYD P. SHORT 21653

# LOCATION VERIFICATION MAP

FEB 15 2018

RECEIVED

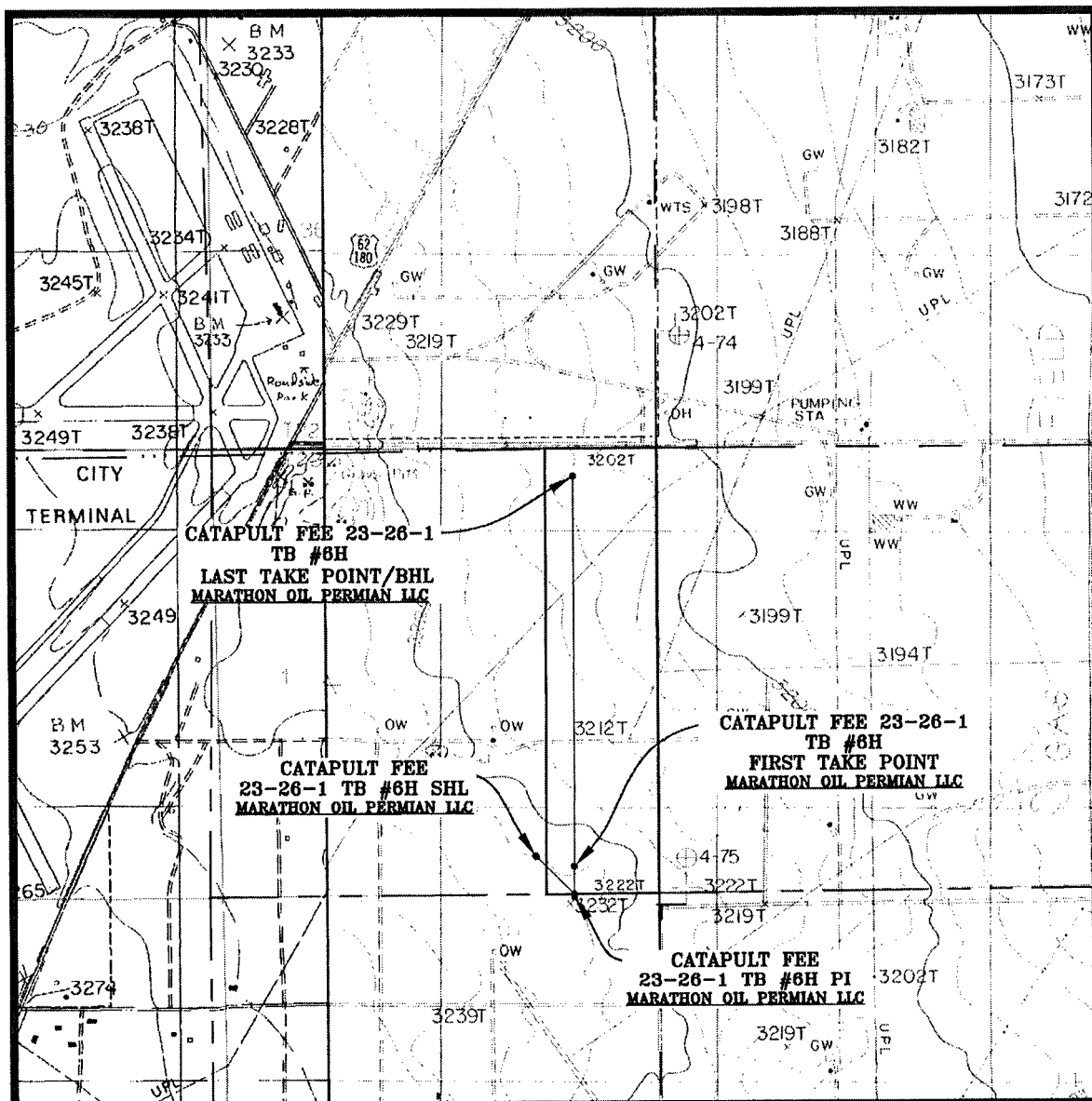

SEC. 1 TWP. 23-S RGE. 26-E  
SURVEY: N.M.P.M.  
COUNTY: EDDY  
DESCRIPTION: 463' FSL & 1467' FEL  
ELEVATION: 3219'  
OPERATOR: MARATHON OIL PERMIAN LLC  
LEASE: CATAPULT FEE 23-26-1  
U.S.G.S. TOPOGRAPHIC MAP: OTIS, N.M.

SCALE: 1" = 2000'  
CONTOUR INTERVAL = 5'

PREPARED BY:  
R-SQUARED GLOBAL, LLC  
1309 LOUISVILLE AVENUE, MONROE, LA 71201  
318-323-8900 OFFICE  
JOB No. R3798\_004

FEB 15 2018

# VICINITY MAP

RECEIVED

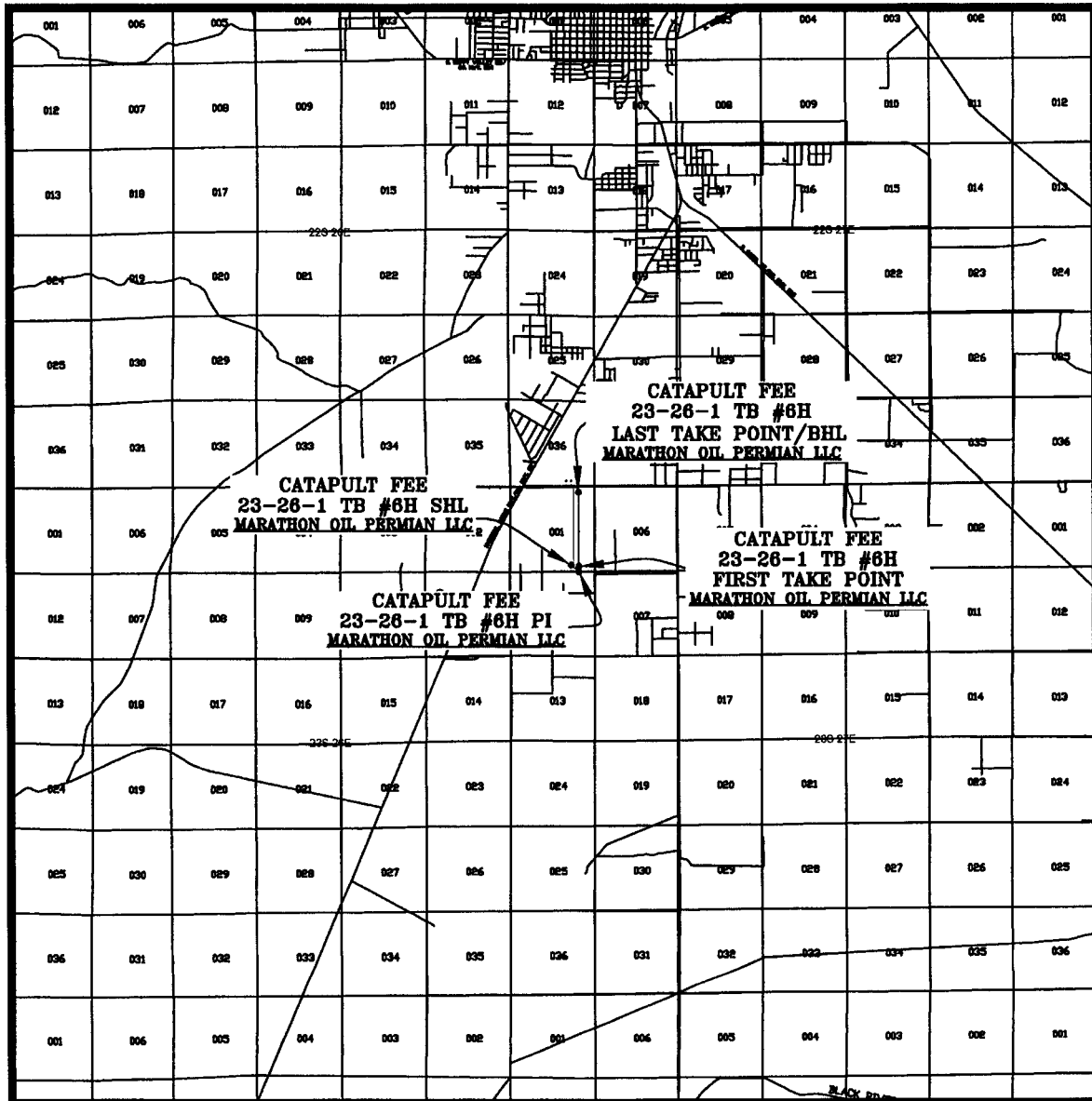

SEC. 1 TWP. 23-S RGE. 26-E  
SURVEY: N.M.P.M.  
COUNTY: EDDY  
DESCRIPTION: 463' FSL & 1,467' FEL  
ELEVATION: 3219'  
OPERATOR: MARATHON OIL PERMIAN LLC  
LEASE: CATAPULT FEE 23-26-1  
U.S.G.S. TOPOGRAPHIC MAP: OTIS, N.M.

SCALE: 1" = 2 MILES

PREPARED BY:  
R-SQUARED GLOBAL, LLC  
1309 LOUISVILLE AVENUE, MONROE, LA 71201  
318-323-8900 OFFICE  
JOB No. R3798\_004