

Form C-102  
Revised August 1, 2011  
Submit one copy to appropriate  
ARTESIA DISTRICT District Office  
FEB 15 2012  
AMENDED REPORT

## RECEIVED

2	02/01/2018	CAP
REV.	DATE	BY

# LOCATION VERIFICATION MAP

ARTESIAN DISTRICT  
FEB 15 2018

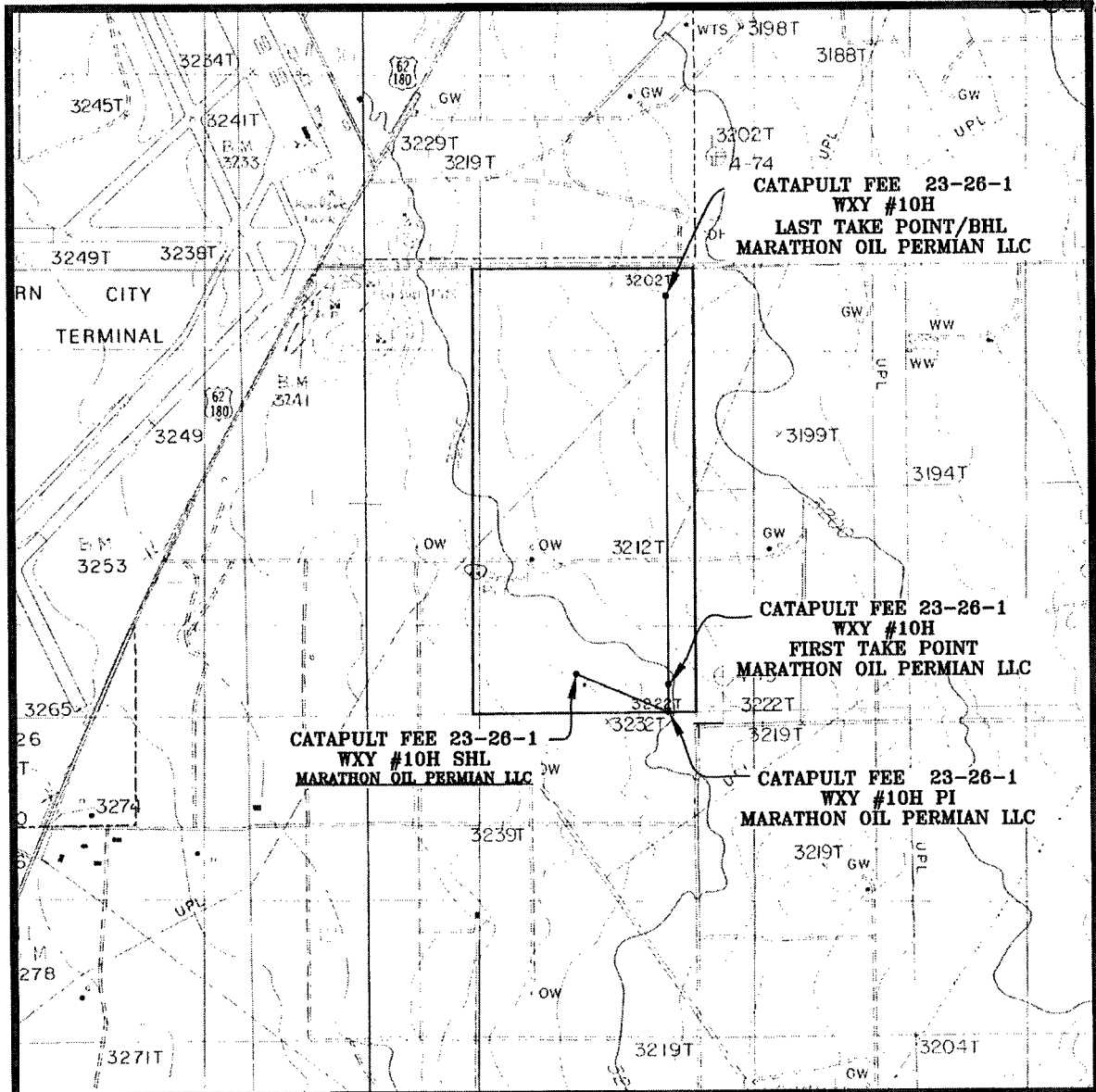

SEC. 1 TWP. 23-S RGE. 26-E  
SURVEY: N.M.P.M.  
COUNTY: EDDY  
DESCRIPTION: 463' FSL & 1,437' FEL  
ELEVATION: 3219'  
OPERATOR: MARATHON OIL PERMIAN LLC  
LEASE: CATAPULT FEE 23-26-1  
U.S.G.S. TOPOGRAPHIC MAP: OTIS, N.M.

SCALE: 1" = 2000'  
CONTOUR INTERVAL = 5'

PREPARED BY:  
R-SQUARED GLOBAL, LLC  
1309 LOUISVILLE AVENUE, MONROE, LA 71201  
318-323-8900 OFFICE  
JOB No. R3798\_001

# VICINITY MAP

NM OIL CONSERVATION  
ARTESIA DISTRICT

FEB 15 2010

RECEIVED

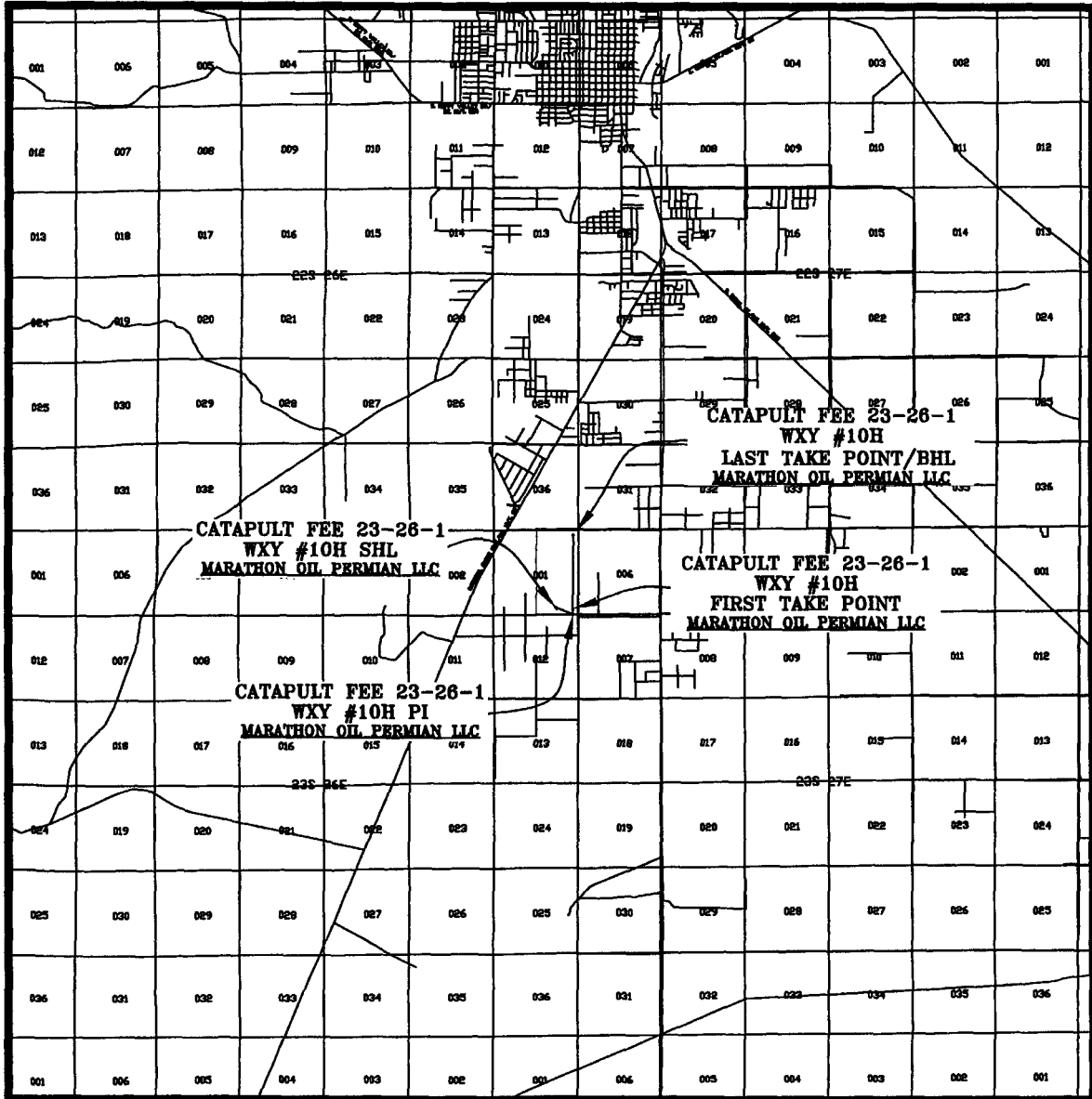

SEC. 1 TWP. 23-S RGE. 26-E  
SURVEY: N.M.P.M.  
COUNTY: EDDY  
DESCRIPTION: 463' FSL & 1,437' FEL  
ELEVATION: 3219'  
OPERATOR: MARATHON OIL PERMIAN LLC  
LEASE: CATAPULT FEE 23-26-1  
U.S.G.S. TOPOGRAPHIC MAP: OTIS, N.M.

SCALE: 1" = 2 MILES

PREPARED BY:  
R-SQUARED GLOBAL, LLC  
1309 LOUISVILLE AVENUE, MONROE, LA 71201  
318-323-8900 OFFICE  
JOB No. R3798\_001