

Form C-102  
Revised August 1, 2011  
Submit one copy to appropriate  
District Office  
FEB 15 2012 ☐ AMENDED REPORT

<sup>1</sup> API Number 30-015-44691	<sup>2</sup> Pool Code 98220	<sup>3</sup> Pool Name PURPLE SAGE; WOLFCAMP (GAS)
<sup>4</sup> Property Code 320796	<sup>5</sup> Property Name CATAPULT FEE 23-26-1 WA	<sup>6</sup> Well Number 5H
<sup>7</sup> OGRID No. 372098	<sup>8</sup> Operator Name MARATHON OIL PERMIAN LLC	<sup>9</sup> Elevation 3219'

UL or lot no.	Section	Township	Range	Lot Idn	Feet from the	North/South line	Feet from the	East/West line	County
0	1	T23S	R26E		463	SOUTH	1497	EAST	EDDY

UL or lot no.	Section	Township	Range	Lot 1dn	Feet from the	North/South line	Feet from the	East/West line	County
B (LOT2)	1	T23S	R26E		330	NORTH	1328	EAST	EDDY

No allowable will be assigned to this completion until all interests have been consolidated or a non-standard unit has been approved by the division.

T-22-S  SECTION 1  <b>CORNER COORDINATES</b> NAD 83, SPCS NM EAST A - Y: 487840.96' / X: 569827.81' B - Y: 487843.47' / X: 570881.56' C - Y: 482551.56' / X: 570883.00' D - Y: 482533.94' / X: 569803.23'	<div style="text-align: center;"> </div>	SECTION 31  SECTION 6
T-23-S  SECTION 1  <b>CORNER COORDINATES</b> NAD 27, SPCS NM EAST A - Y: 487781.95' / X: 527046.14' B - Y: 487784.43' / X: 529699.85' C - Y: 482492.66' / X: 529701.19' D - Y: 482475.08' / X: 527021.46'		
<b>LAST TAKE POINT/ BOTTOM HOLE LOCATION</b> 330' FNL 1328' FEL, SECTION 1 NAD 83, SPCS NM EAST X569553.96' / Y487512.21' LAT32.3482094N / LON104.2419700W NAD 27, SPCS NM EAST X528372.27' / Y487453.28' LAT32.3489121N / LON104.24146760W		
<b>FIRST TAKE POINT</b> 330' FSL 1339' FEL, SECTION 1 NAD 83, SPCS NM EAST X569543.83' / Y482872.76' LAT32.32745624N / LON104.24201560W NAD 27, SPCS NM EAST X523362.05' / Y482813.87' LAT32.32733799N / LON104.2415136W		
<b>SURFACE HOLE LOCATION</b> 463' FSL 1497' FEL, SECTION 1 NAD 83, SPCS NM EAST X569386.19' / Y483004.66' LAT32.32781919N / LON104.24252565W NAD 27, SPCS NM EAST X528204.41' / Y482945.77' LAT32.32770095N / LON104.2420236V		
SECTION 1  SECTION 12	SECTION 6  SECTION 7	

**17 OPERATOR CERTIFICATION**

I hereby certify that the information contained herein is true and complete to the best of my knowledge and belief, and that this organization either owns a working interest or unleased mineral interest in the land including the proposed bottom hole location or has a right to drill this well at this location pursuant to a contract with an owner of such a mineral or working interest, or to a voluntary pooling agreement or a compulsory pooling order heretofore entered by the division.

Signature 
2/9/2018

Date

---

Melissa Szudera

Printed Name

[mszudera@marathonoil.com](mailto:mszudera@marathonoil.com)

E-mail Address

**18 SURVEYOR CERTIFICATION**

I hereby certify that the well location shown on this plat was plotted from field notes of actual surveys made by me or under my supervision, and that the same is true and correct to the best of my belief.

FEBRUARY 02, 2018

Date of Survey

Signature and Seal of Professional Surveyor:

Certificate Number      LLOYD P. SHORT 21653

## LOCATION VERIFICATION MAP

RECEIVED

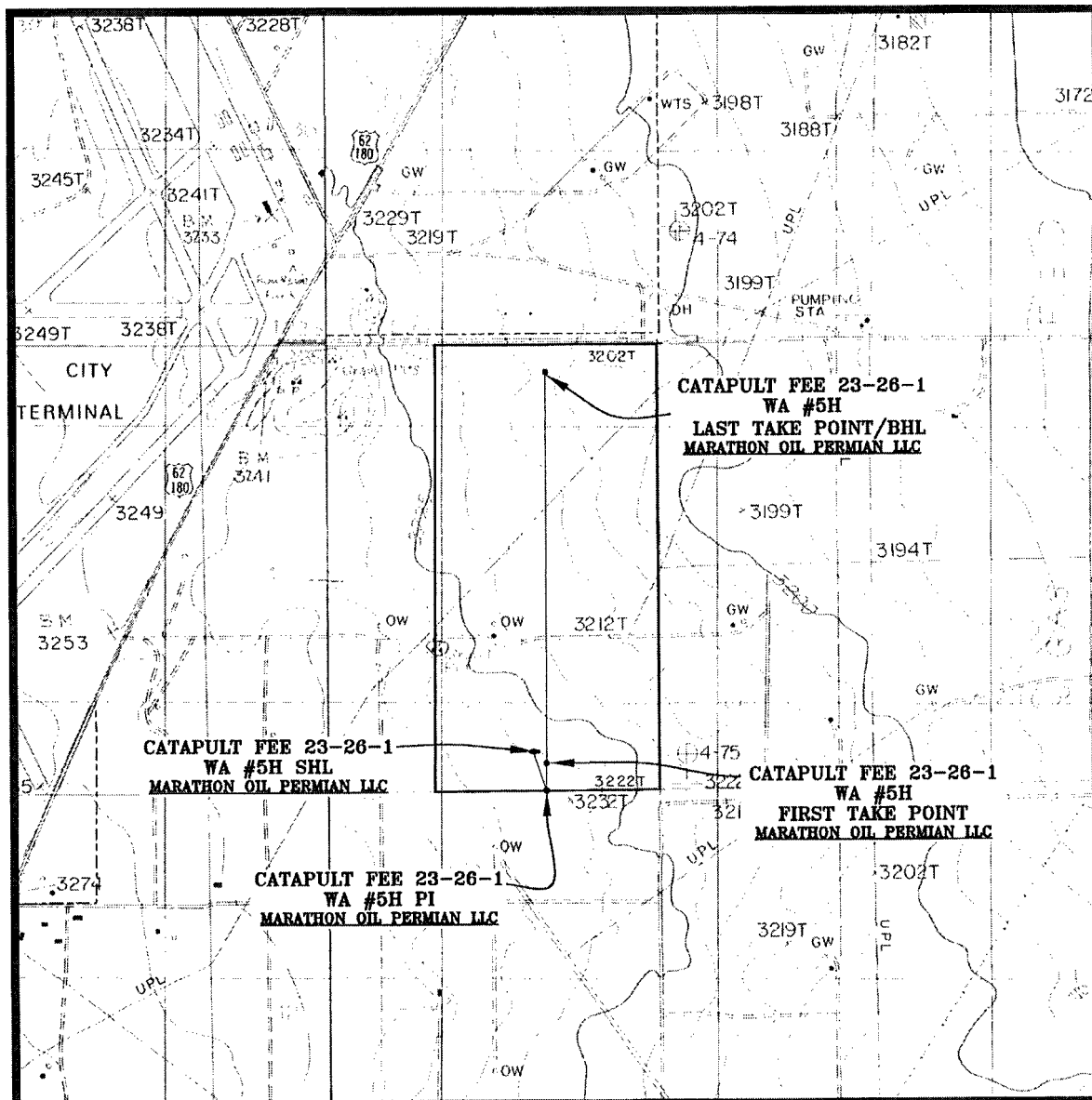

SEC. 1 TWP. 23-S RGE. 26-E  
SURVEY: N.M.P.M.  
COUNTY: EDDY  
DESCRIPTION: 463' FSL & 1497' FEL  
ELEVATION: 3219'  
OPERATOR: MARATHON OIL PERMIAN LLC  
LEASE: CATAPULT FEE 23-26-1  
U.S.G.S. TOPOGRAPHIC MAP: OTIS, N.M.

SCALE: 1" = 2000'  
CONTOUR INTERVAL = 5'

PREPARED BY:  
R-SQUARED GLOBAL, LLC  
1309 LOUISVILLE AVENUE, MONROE, LA 71201  
318-323-6900 OFFICE  
JOB No. R3798\_003

FEB 15 2018

100-100000

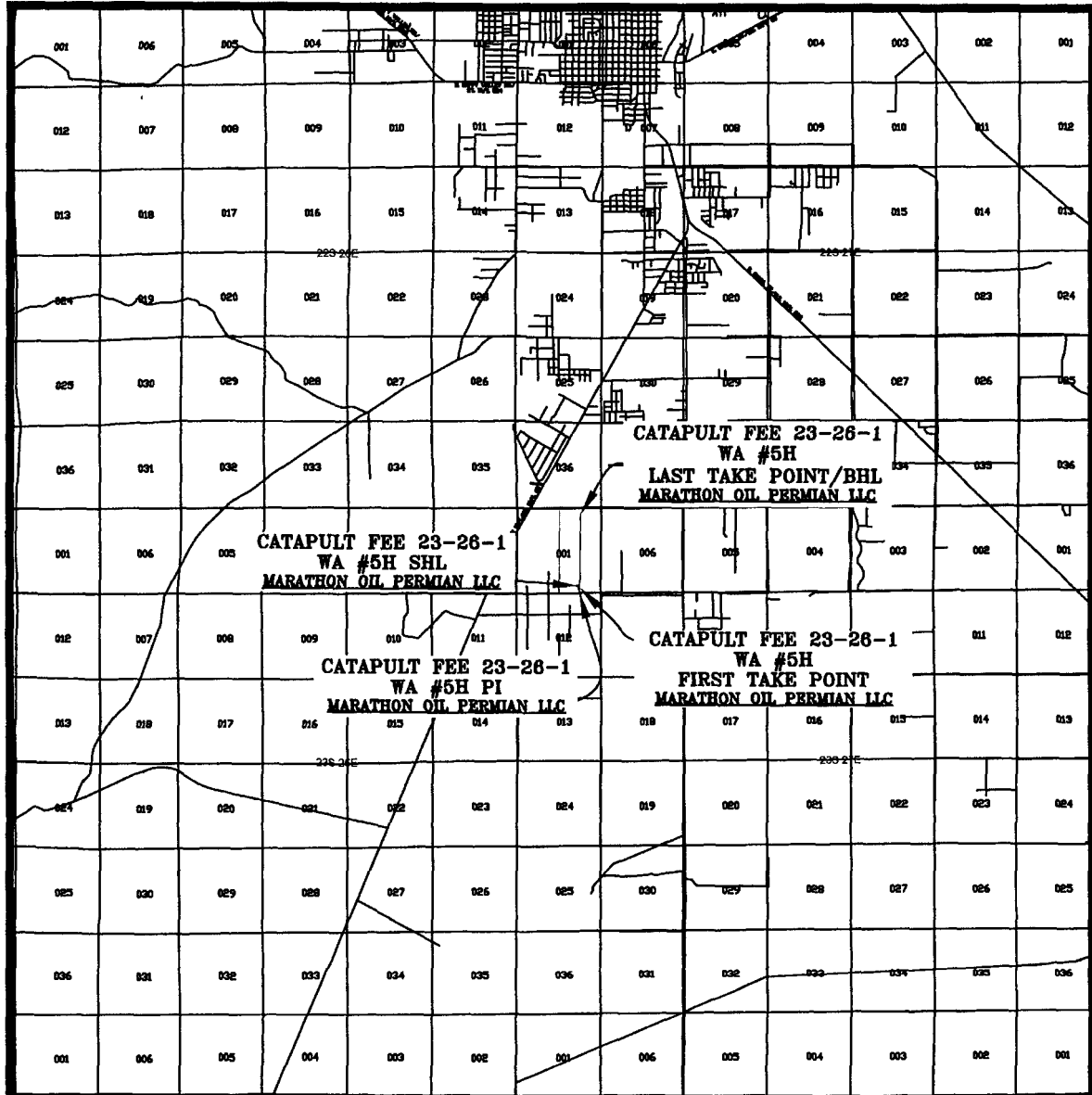

SEC. 1 TWP. 23-S RGE. 26-E  
SURVEY: N.M.P.M.  
COUNTY: EDDY  
DESCRIPTION: 463' FSL & 1497' FEL  
ELEVATION: 3219'  
OPERATOR: MARATHON OIL PERMIAN LLC  
LEASE: CATAPULT FEE 23-26-1  
U.S.G.S. TOPOGRAPHIC MAP: OTIS, N.M.

SCALE: 1" = 2 MILES

PREPARED BY:  
R-SQUARED GLOBAL, LLC  
1309 LOUISVILLE AVENUE, MONROE, LA 71201  
318-323-6900 OFFICE  
JOB No. R3798\_003