

UNITED STATES  
DEPARTMENT OF THE INTERIOR  
BUREAU OF LAND MANAGEMENT**Carlsbad Field Office**  
**OCD Artesia**FORM APPROVED  
OMB NO. 1004-0137  
Expires: January 31, 2018**SUNDRY NOTICES AND REPORTS ON WELL**  
*Do not use this form for proposals to drill or to re-enter an abandoned well. Use form 3160-3 (APD) for such proposals.*5. Lease Serial No.  
Multiple--See Attached

6. If Indian, Allottee or Tribe Name

7. If Unit or CA/Agreement, Name and/or No.  
NMNM88525X8. Well Name and No.  
Multiple--See Attached9. API Well No.  
Multiple--See Attached10. Field and Pool or Exploratory Area  
Multiple--See Attached11. County or Parish, State  
EDDY COUNTY, NM**SUBMIT IN TRIPLICATE - Other instructions on page 2**

1. Type of Well

☒ Oil Well ☐ Gas Well ☐ Other2. Name of Operator  
COG OPERATING LLCContact: DANA KING  
E-Mail: dking@concho.com3a. Address  
600 W ILLINOIS AVENUE  
MIDLAND, TX 797013b. Phone No. (include area code)  
Ph: 432-818-22674. Location of Well (Footage, Sec., T., R., M., or Survey Description)  
Multiple--See Attached**12. CHECK THE APPROPRIATE BOX(ES) TO INDICATE NATURE OF NOTICE, REPORT, OR OTHER DATA**

TYPE OF SUBMISSION	TYPE OF ACTION			
<input checked="" type="checkbox"/> Notice of Intent	<input type="checkbox"/> Acidize	<input type="checkbox"/> Deepen	<input type="checkbox"/> Production (Start/Resume)	<input type="checkbox"/> Water Shut-Off
<input type="checkbox"/> Subsequent Report	<input type="checkbox"/> Alter Casing	<input type="checkbox"/> Hydraulic Fracturing	<input type="checkbox"/> Reclamation	<input type="checkbox"/> Well Integrity
<input type="checkbox"/> Final Abandonment Notice	<input type="checkbox"/> Casing Repair	<input type="checkbox"/> New Construction	<input type="checkbox"/> Recomplete	<input checked="" type="checkbox"/> Other
	<input type="checkbox"/> Change Plans	<input type="checkbox"/> Plug and Abandon	<input type="checkbox"/> Temporarily Abandon	Off-Lease Measuremen
	<input type="checkbox"/> Convert to Injection	<input type="checkbox"/> Plug Back	<input type="checkbox"/> Water Disposal	t

13. Describe Proposed or Completed Operation: Clearly state all pertinent details, including estimated starting date of any proposed work and approximate duration thereof. If the proposal is to deepen directionally or recompleat horizontally, give subsurface locations and measured and true vertical depths of all pertinent markers and zones. Attach the Bond under which the work will be performed or provide the Bond No. on file with BLM/BIA. Required subsequent reports must be filed within 30 days following completion of the involved operations. If the operation results in a multiple completion or recompleat in a new interval, a Form 3160-4 must be filed once testing has been completed. Final Abandonment Notices must be filed only after all requirements, including reclamation, have been completed and the operator has determined that the site is ready for final inspection.

COG OPERATING LLC RESPECTFULLY REQUEST OFF LEASE MEASUREMENT OF GAS PRODUCTION FOR THE ATTACHED WELLS LOCATED AT THE BURCH KEELY UNIT 13C BATTERY, S13, T17S, R29E.

PRODUCTION FROM THESE WELLS ARE ROUTED AND MEASURED AT THE TANK BATTERY LOCATED AT THE MARY DODD B DEEP FEDERAL #1, AT S14, T17S, R29E. PLEASE SEE ATTACHED SUMMARY AND ATTACHMENTS. ALL INTEREST OWNERS HAVE BEEN NOTIFIED.

NM OIL CONSERVATION  
ARTESIA DISTRICT

MAR 08 2018

BC 3-8-18  
Accepted for record - NMOCD

RECEIVED

14. I hereby certify that the foregoing is true and correct.

**Electronic Submission #376767 verified by the BLM Well Information System  
For COG OPERATING LLC, sent to the Carlsbad  
Committed to AFMSS for processing by DEBORAH MCKINNEY on 05/24/2017 (17DLM1781SE)**

Name (Printed/Typed) DANA KING

Title SUBMITTING CONTACT

Signature (Electronic Submission)

Date 05/19/2017

**THIS SPACE FOR FEDERAL OR STATE OFFICE USE**

Approved By DUNCAN WHITLOCK

Title TECHNICAL LEAD PET

Date 03/06/2018

Conditions of approval, if any, are attached. Approval of this notice does not warrant or certify that the applicant holds legal or equitable title to those rights in the subject lease which would entitle the applicant to conduct operations thereon.

Office Carlsbad

Title 18 U.S.C. Section 1001 and Title 43 U.S.C. Section 1212, make it a crime for any person knowingly and willfully to make to any department or agency of the United States any false, fictitious or fraudulent statements or representations as to any matter within its jurisdiction.

(Instructions on page 2)

**\*\* BLM REVISED \*\* BLM REVISED \*\* BLM REVISED \*\* BLM REVISED \*\* BLM REVISED \*\***

## Additional data for EC transaction #376767 that would not fit on the form

### 5. Lease Serial No., continued

NMLC028784A  
NMLC028784B  
NMLC028784C  
NMLC028793A  
NMLC028793C  
NMLC054406

### Wells/Facilities, continued

Agreement	Lease	Well/Fac Name, Number	API Number	Location
NMNM88525X	NMLC028784A	BURCH KEELY UNIT 215	30-015-27573-00-S1	Sec 13 T17S R29E SESW 1295FSL 1345FWL
NMNM88525X	NMLC028784A	BURCH KEELY UNIT 255	30-015-29020-00-S1	Sec 13 T17S R29E SWSW 1295FSL 330FWL
NMNM88525X	NMLC028784A	BURCH KEELY UNIT 35	30-015-20378-00-S1	Sec 13 T17S R29E SWSW 660FSL 660FWL
NMNM88525X	NMLC028784C	BURCH KEELY UNIT 371	30-015-33801-00-S1	Sec 13 T17S R29E NWSW 1900FSL 660FWL
NMNM88525X	NMLC028784A	BURCH KEELY UNIT 381	30-015-33806-00-S1	Sec 13 T17S R29E SWSW 660FSL 710FWL
NMNM88525X	NMLC028784A	BURCH KEELY UNIT 543	30-015-39565-00-S1	Sec 24 T17S R29E NENW 125FNL 1370FWL
NMNM88525X	NMLC054406	BURCH KEELY UNIT 616	30-015-38517-00-S1	Sec 24 T17S R29E NWNW 532FNL 660FWL
NMNM88525X	NMLC028784A	BURCH KEELY UNIT 620	30-015-39569-00-S1	Sec 24 T17S R29E SWNW 1870FNL 730FWL
NMNM88525X	NMLC028784A	BURCH KEELY UNIT 621	30-015-40325-00-S1	Sec 24 T17S R29E SENW 2042FNL 1531FWL
NMNM88525X	NMLC028784A	BURCH KEELY UNIT 857	30-015-40381-00-S1	Sec 24 T17S R29E SWNW 1493FNL 752FWL
NMNM88525X	NMLC028784A	BURCH KEELY UNIT 902	30-015-40329-00-S1	Sec 24 T17S R29E SWNW 1359FNL 213FWL
NMNM88525X	NMLC028784A	BURCH KEELY UNIT 905	30-015-40540-00-S1	Sec 13 T17S R29E SWSW 330FSL 330FWL
NMNM88525X	NMLC028784B	BURCH KEELY UNIT 935H	30-015-42748-00-S1	Sec 13 T17S R29E NWSW 1650FSL 200FWL 32.831708 N Lat, 104.036927 W Lon
NMNM88525X	NMLC028784A	BURCH KEELY UNIT 936H	30-015-40888-00-S1	Sec 13 T17S R29E SWSW 990FSL 330FWL
NMNM88525X	NMLC028793A	BURCH KEELY UNIT 937H	30-015-42759-00-S1	Sec 13 T17S R29E SWSW 330FSL 200FWL 32.828081 N Lat, 104.035693 W Lon
NMNM88525X	NMLC028784B	BURCH KEELY UNIT 946H	30-015-44100-00-S1	Sec 23 T17S R29E NENE 487FNL 342FEL 32.825954 N Lat, 104.037971 W Lon
NMNM88525X	NMLC028793C	BURCH KEELY UNIT 947H	30-015-40637-00-S1	Sec 23 T17S R29E NENE 990FNL 330FEL
NMNM88525X	NMLC028793C	BURCH KEELY UNIT 948H	30-015-42723-00-S1	Sec 23 T17S R29E SENE 1630FNL 335FEL 32.822696 N Lat, 104.037439 W Lon
NMNM88525X	NMLC028784A	BURCH KEELY UNIT 954H	30-015-42240-00-S1	Sec 23 T17S R29E NENE 507FNL 172FEL 32.825780 N Lat, 104.036910 W Lon
NMNM88525X	NMLC028784A	BURCH KEELY UNIT 955H	30-015-44150-00-S1	Sec 24 T17S R29E NWNW 1035FNL 222FWL 32.824444 N Lat, 104.036133 W Lon
NMNM88525X	NMLC028784A	BURCH KEELY UNIT 956H	30-015-42241-00-S1	Sec 23 T17S R29E SENE 1650FNL 165FEL 32.822641 N Lat, 104.036886 W Lon
NMNM88525X		FAC BKU13C BKU 13-C FEDERAL FACILITY		Sec 13 T17S R29E Mer NMP SWSW

### 10. Field and Pool, continued

GRAYBURG  
UNKNOWN

**APPLICATION FOR OFF LEASE MEASUREMENT SUMMARY****Burch Keely Unit 13C Battery****DCP Gas Meter Number 742544**

Located at the Mary Dodd B Deep Federal Battery, Lease NMNM11789X

**Burch Keely Unit Number NMNM85525X**

COG Operating is requesting Off Lease Measurement for the following wells:

**Federal Lease Number NMLC 028784A**

Well Name	Location	API #	Pool 28509	BOPD	Gravity	MCFPD	BTU
Burch Keely Unit #215	SESW Unit N S13 T17S R29E	30-015-27573	Grayburg Jackson; SR-Q-G-SA	2.6	39.2	36.49	4,417
Burch Keely Unit #255	SWSW Unit M S13 T17S R29E	30-015-29020	Grayburg Jackson; SR-Q-G-SA	3.4	39.2	24.29	4,417
Burch Keely Unit #35	SWSW Unit M S13 T17S R29E	30-015-20378	Grayburg Jackson; SR-Q-G-SA	0.8	39.2	15.60	4,417
Burch Keely Unit #857	SWNW Unit E S24 T17S R29E	30-015-40381	Grayburg Jackson; SR-Q-G-SA	5.5	39.2	31.65	4,417

Well Name	Location	API #	Pool 97918	BOPD	Gravity	MCFPD	BTU
Burch Keely Unit #381	SWSW Unit M S13 T17S R29E	30-015-33806	BK;Glorieta-Up Yeso	2.8	39.2	40.35	4,417
Burch Keely Unit #543	NENW Unit C S24 T17S R29E	30-015-39565	BK;Glorieta-Up Yeso	7.9	39.2	72.91	4,417
Burch Keely Unit #620	SWNW Unit E S24 T17S R29E	30-015-39569	BK;Glorieta-Up Yeso	3.5	39.2	38.24	4,417
Burch Keely Unit #621	SENW Unit F S24 T17S R29E	30-015-40325	BK;Glorieta-Up Yeso	2.1	39.2	40.88	4,417x
Burch Keely Unit #902	SWNW Unit E S24 T17S R29E	30-015-40329	BK;Glorieta-Up Yeso	4.4	39.2	70.32	4,417
Burch Keely Unit #905	SWSW Unit M S13 T17S R29E	30-015-40540	BK;Glorieta-Up Yeso	12.8	39.2	58.98	4,417
Burch Keely Unit #936H	SWSW Unit M S13 T17S R29E	30-015-40888	BK;Glorieta-Up Yeso	55.4	39.2	138.88	4,417
Burch Keely Unit #954H	NENE Unit A S23 T17S R29E	30-015-42240	BK;Glorieta-Up Yeso	81.0	39.2	99.99	4,417
Burch Keely Unit #956H	SENE Unit H S23 T17S R29E	30-015-42241	BK;Glorieta-Up Yeso	63.1	39.2	148.3	4,417

Future:

Burch Keely Unit #955H NWNW Unit D S24 T17S R29E

\*\*\*APD Submitted\*\*\*

**Federal Lease Number NMLC 028784B**

Well Name	Location	API #	Pool 97918	BOPD	Gravity	MCFPD	BTU
Burch Keely Unit #935H	NWSW Unit L S13 T17S R29E	30-015-42748	BK;Glorieta-Up Yeso	73.4	39.2	115.87	4,417

Future:

Burch Keely Unit #946H NENE Unit A S23 T17S R29E BK;Glorieta-Up Yeso

\*\*\*New, Not Drilled\*\*\*

**Federal Lease Number NMLC 028784C**

Well Name	Location	API #	Pool 97918	BOPD	Gravity	MCFPD	BTU
Burch Keely Unit #371	NWSW Unit L S13 T17S R29E	30-015-33801	BK;Glorieta-Up Yeso	2.0	39.2	22.97	4,417

**Federal Lease Number NMLC 028793A**

Well Name	Location	API #	Pool 97918	BOPD	Gravity	MCFPD	BTU
Burch Keely Unit #937H	SWSW Unit M S13 T17S R29E	30-015-42759	BK;Glorieta-Up Yeso	283.8	39.2	468.83	4,417

**Federal Lease Number NMLC 028793C**

Well Name	Location	API #	Pool 97918	BOPD	Gravity	MCFPD	BTU
Burch Keely Unit #947H	NENE Unit A S23 T17S R29E	30-015-40637	BK;Glorieta-Up Yeso	23.7	39.2	60.14	4,417
Burch Keely Unit #948H	SENE Unit H S23 T17S R29E	30-015-42723	BK;Glorieta-Up Yeso	101.3	39.2	165.61	4,417

**Federal Lease Number NMLC 054406**

<u>Well Name</u>	<u>Location</u>	<u>API #</u>	<u>Pool 97918</u>	<u>BOPD</u>	<u>Gravity</u>	<u>MCFPD</u>	<u>BTU</u>
Burch Keely Unit #616	NWNW Unit D S24 T17S R29E	30-015-38517	BK; Glorieta-Up Yeso	5.9	39.2	88.00	4,417

**APPLICATION FOR OFF LEASE MEASUREMENT**

**Burch Keely Unit 13C Battery**  
**DCP Gas Meter Number 742544**

**DESCRIPTION:** During normal operations, gas produced from the BKU 13C battery is sold on location to Frontier Gas Sales meter #6631235 on Lease NMNM88525X. If Frontier has pipeline or plant problems, the gas is off-loaded to DCP meter #742544 Lease NMNM11789X located approximately 1250 ft NW of the BKU 13C Tank Battery on the Mary Dodd B Deep Fed #1 Location.

A site diagram for the off lease measurement is attached.

# **SITE FACILITY DIAGRAM**

BKU 13C BATTERY  
 SECT 13, T17S, R29E  
 LEASE NO.: NMNM88525X

## **WELLS:**

BURCH-KEELY UNIT #215 - 30-015-27573  
 BURCH-KEELY UNIT #255 - 30-015-29020  
 BURCH-KEELY UNIT #35 - 30-015-20378  
 BURCH-KEELY UNIT #371 - 30-015-33801  
 BURCH-KEELY UNIT #381 - 30-015-33806  
 BURCH-KEELY UNIT #543 - 30-015-39565  
 BURCH-KEELY UNIT #616 - 30-015-38517  
 BURCH-KEELY UNIT #620 - 30-015-39569  
 BURCH-KEELY UNIT #621 - 30-015-40325  
 BURCH-KEELY UNIT #857 - 30-015-40381  
 BURCH-KEELY UNIT #902 - 30-015-40329

BURCH-KEELY UNIT #905 - 30-015-40540  
 BURCH-KEELY UNIT #935H - 30-015-42748  
 BURCH-KEELY UNIT #936H - 30-015-40888  
 BURCH-KEELY UNIT #937H - 30-015-42759  
 BURCH-KEELY UNIT #947H - 30-015-40637  
 BURCH-KEELY UNIT #948H - 30-015-42723  
 BURCH-KEELY UNIT #954H - 30-015-42240  
 BURCH-KEELY UNIT #956H - 30-015-42241  
 BURCH-KEELY UNIT #946H - 30-015- FUTURE  
 BURCH-KEELY UNIT #955H - 30-015- FUTURE

WELLS (SEE ABOVE)

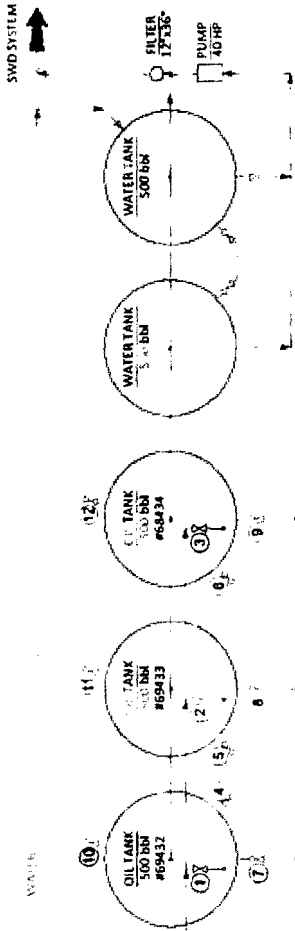
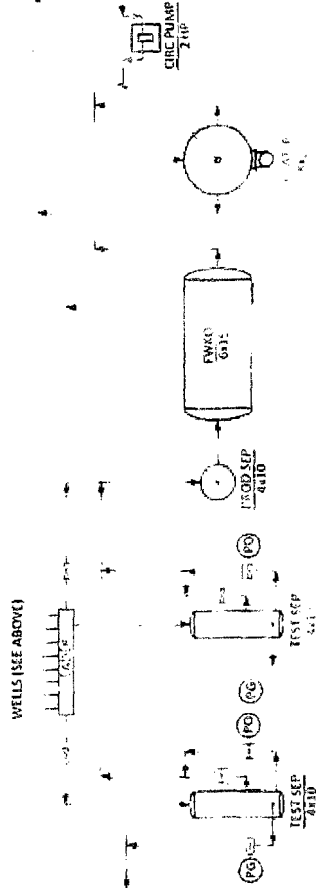

**Production Phase - Oil Tank #1**  
 - Valve 1 open  
 - Valves 2 and 3 closed  
 - Valves 4, 5, and 6 open  
 - Valves 7, 8, and 9 closed  
 - Valves 10, 11, and 12 closed

**Sales Phase - Oil Tank #1**  
 - Valve 1 closed  
 - Valves 2 or 3 open  
 - Valve 4 closed  
 - Valves 5 and 6 open  
 - Valve 7 open  
 - Valves 8 and 9 closed  
 - Valves 10, 11, and 12 closed

OFF LEASE GAS METER  
 DCP GAS SALES  
 METER #742544  
 32.832154, -104.039495

GAS METER  
 FRONTIER GAS SALES  
 METER #6631235

**Ledger for Site Diagram**  
 Produced Fluid: ---  
 Produced Oil: ---  
 Produced Gas: ---  
 Produced Water: ---

**Location of Site Security Plan:**  
 COG Operating, LLC.  
 600 W. Illinois  
 Midland, TX 79701

## **SITE FACILITY DIAGRAM**

DATE: March 8, 2017  
 DRAWN BY: KHINSHAW  
 BKU 13C TANK BATTERY  
 EDDY COUNTY, NEW MEXICO

# OFF LEASE MEASUREMENT

BKU 13C Battery to Mary Dodd B Deep Fed Location  
SECT 13, T17S, R29E ----> SECT 14, T17S, R29E  
LEASE NO.: NMNM88525X ----> LEASE NO.: NMNM11789X

OFF LEASE GAS METER FOR BKU 13C Battery  
DCP GAS SALES  
METER #742544  
32.832154, -104.039495  
LEASE NO.: NMNM88525X

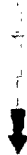
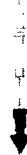

MARY DODD B DEEP FEDERAL  
DCP GAS SALES METER  
METER #710702  
LEASE NO.: NMNM11789X  
SECT 14, T17S, R29E

Gas Line from BKU 13C Battery

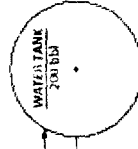
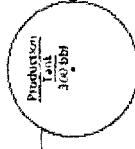

Mary Dodd B Deep Fed #1  
API 30-015-29286

Ledger for Site Diagram  
Produced Fluid: \_\_\_\_\_  
Produced Oil: \_\_\_\_\_  
Produced Gas: \_\_\_\_\_  
Produced Water: \_\_\_\_\_

Location of Site Security Plan:  
COG Operating, LLC.  
600 W. Illinois  
Midland, TX 79701

## OFF LEASE MEASUREMENT APPLICATION

DATE	April 26, 2017	BKU 13C TANK BATTERY
DRAWN BY	KHINSHAW	EDDY COUNTY, NEW MEXICO

# BKU 13C Battery Off Load Meter

Gas Sales Line from BKU 13C Battery to Mary Dodd B Deep Federal Battery

DCP Meter #742544

Mary Dodd B Deep Fed Battery - NMINM11785X

BKU 13C Battery Unit No. NMINM38525X

Dodd Unit shaded in Green

Buren Keely Unit Shaded in Blue

Google earth

© 2016 Google

500 ft



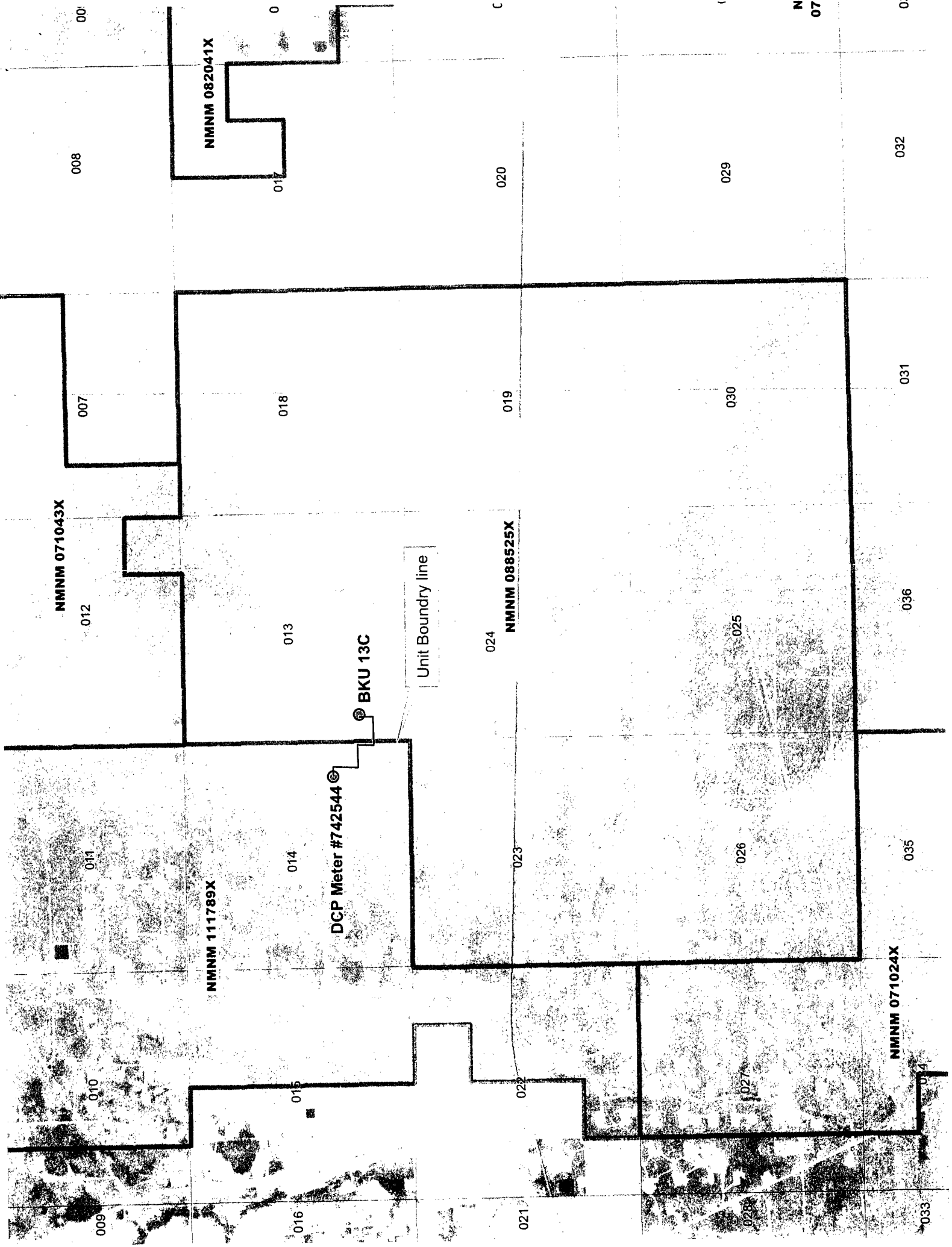

NMNM 071043X

NMNM 111789X

NMNM 088525X

NMNM 071024X

NMNM 082041X

DCP Meter #742544

BKU 13C

Unit Boundary line

008

007

012

011

010

009

017

018

013

014

015

016

020

019

024

023

022

021

029

030

025

026

027

028

032

031

036

035

034

033



RECEIVED:	REVIEWER:	TYPE:	APP NO:
-----------	-----------	-------	---------

ABOVE THIS TABLE FOR OCD DIVISION USE ONLY

**NEW MEXICO OIL CONSERVATION DIVISION**  
 - Geological & Engineering Bureau -  
 1220 South St. Francis Drive, Santa Fe, NM 87505



**ADMINISTRATIVE APPLICATION CHECKLIST**

THIS CHECKLIST IS MANDATORY FOR ALL ADMINISTRATIVE APPLICATIONS FOR EXCEPTIONS TO DIVISION RULES AND  
 REGULATIONS WHICH REQUIRE PROCESSING AT THE DIVISION LEVEL IN SANTA FE

**Applicant:** COG Operating LLC **OGRID Number:** 229137  
**Well Name:** Burch Keely Unit #215 (Burch Keely Unit 13C Battery) **API:** 30-015-27573  
**Pool:** Grayburg Jackson, SR-Q-G-SA **Pool Code:** 28509

**SUBMIT ACCURATE AND COMPLETE INFORMATION REQUIRED TO PROCESS THE TYPE OF APPLICATION  
 INDICATED BELOW**

**1) TYPE OF APPLICATION:** Check those which apply for [A]

A. Location - Spacing Unit - Simultaneous Dedication

☐ NSL ☐ NSP (PROJECT AREA) ☐ NSP (PRORATOR UNIT) ☐ SD

B. Check one only for [ I ] or [ II ]

[ I ] Commingling - Storage - Measurement

☐ DHC ☐ CTB ☐ PLC ☐ PC ☐ OLS ☒ OLM

[ II ] Injection - Disposal - Pressure Increase - Enhanced Oil Recovery

☐ WFX ☐ PMX ☐ SWD ☐ IPI ☐ EOR ☐ PPR

**2) NOTIFICATION REQUIRED TO:** Check those which apply.

- A. ☐ Offset operators or lease holders  
 B. ☒ Royalty, overriding royalty owners, revenue owners  
 C. ☐ Application requires published notice  
 D. ☐ Notification and/or concurrent approval by SLO  
 E. ☐ Notification and/or concurrent approval by BLM  
 F. ☐ Surface owner  
 G. ☐ For all of the above, proof of notification or publication is attached, and/or,  
 H. ☐ No notice required

**FOR OCD ONLY**

<input type="checkbox"/>	Notice Complete
<input type="checkbox"/>	Application Content Complete

- 3) CERTIFICATION:** I hereby certify that the information submitted with this application for administrative approval is **accurate** and **complete** to the best of my knowledge. I also understand that **no action** will be taken on this application until the required information and notifications are submitted to the Division.

**Note:** Statement must be completed by an individual with managerial and/or supervisory capacity.

Kanicia Castillo

Print or Type Name

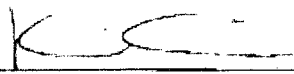
  
 Signature

5/4/17  
 Date

432.685.4332

Phone Number

kcastillo@concho.com

e-mail Address

District I  
1625 N French Drive, Hobbs, NM 88240  
District II  
811 S First St., Artesia, NM 88210  
District III  
1000 Rio Brazos Road, Aztec, NM 87410  
District IV  
1220 S. St Francis Dr, Santa Fe, NM  
87505

State of New Mexico  
Energy, Minerals and Natural Resources Department

Form C-107-B  
Revised August 1, 2011

**OIL CONSERVATION DIVISION**  
1220 S. St Francis Drive  
Santa Fe, New Mexico 87505

Submit the original  
application to the Santa Fe  
office with one copy to the  
appropriate District Office.

**APPLICATION FOR SURFACE COMMINGLING (DIVERSE OWNERSHIP)**

OPERATOR NAME: COG Operating LLC  
OPERATOR ADDRESS: One Concho Center, 600 West Illinois Ave, Midland, Texas 79701  
APPLICATION TYPE:

☐ Pool Commingling ☐ Lease Commingling ☐ Pool and Lease Commingling ☒ Off-Lease Storage and Measurement (Only if not Surface Commingled)

LEASE TYPE: ☐ Fee ☐ State ☒ Federal

Is this an Amendment to existing Order? ☐ Yes ☒ No If "Yes", please include the appropriate Order No. \_\_\_\_\_  
Have the Bureau of Land Management (BLM) and State Land office (SLO) been notified in writing of the proposed commingling  
☒ Yes ☐ No

**(A) POOL COMMINGLING**

Please attach sheets with the following information

(1) Pool Names and Codes	Gravities / BTU of Non-Commingled Production	Calculated Gravities BTU of Commingled Production		Calculated Value of Commingled Production	Volumes

- (2) Are any wells producing at top allowables? ☐ Yes ☐ No  
(3) Has all interest owners been notified by certified mail of the proposed commingling? ☐ Yes ☐ No  
(4) Measurement type ☐ Metering ☐ Other (Specify)  
(5) Will commingling decrease the value of production? ☐ Yes ☐ No If "yes" describe why commingling should be approved

**(B) LEASE COMMINGLING**

Please attach sheets with the following information

- (1) Pool Name and Code  
(2) Is all production from same source of supply? ☐ Yes ☐ No  
(3) Has all interest owners been notified by certified mail of the proposed commingling? ☐ Yes ☐ No  
(4) Measurement type ☐ Metering ☐ Other (Specify)

**(C) POOL and LEASE COMMINGLING**

Please attach sheets with the following information

- (1) Complete Sections A and E

**(D) OFF-LEASE STORAGE and MEASUREMENT**

Please attach sheets with the following information

- (1) Is all production from same source of supply? ☒ Yes ☐ No  
(2) Include proof of notice to all interest owners

**(E) ADDITIONAL INFORMATION (for all application types)**

Please attach sheets with the following information

- (1) A schematic diagram of facility, including legal location  
(2) A plat with lease boundaries showing all well and facility locations Include lease numbers if Federal or State lands are involved  
(3) Lease Names, Lease and Well Numbers and API Numbers

I hereby certify that the information above is true and complete to the best of my knowledge and belief

SIGNATURE Dana King TITLE Regulatory Permitting Tech DATE 5/4/2017

TYPE OR PRINT NAME Dana King TELEPHONE NO 432.818.2267

E-MAIL ADDRESS dking@concho.com

[illegible]





May 17, 2017

THE PANSAM TRUST  
C/O RAYMON NEWTON CHILDRESS SHARP, CO-TRUSTEE  
P O BOX 66  
JOPLIN, MO 64802

Re: Notice of Off Lease Measurement  
BKU 13C

To Whom It May Concern:

This letter will serve as notice under Rule 104.F (3) that COG Operating LLC has requested administrative approval from the Oil Conservation Division in Santa Fe, NM for Off Lease Measurement of gas. Please see Application for Off Lease Measurement Summary for well information.

Gas production from Burch Keely Unit 13C Battery, Unit Number NMNM85525X to be measured at the Mary Dodd B Deep Federal Battery, Lease NMNM11789X.

Should your company have any objection, it must be filed in writing within twenty (20) days from the date of this notice. The Division Director may approve the Office Lease Measurement if no objection has been made within 20 days after the application has been received.

Please contact me at 432-818-2267 should you have any questions.

Sincerely,

*Dana King*

Dana King  
COG Operating LLC  
Regulatory Permitting Tech

Attachments: OCD Admin App Checklist  
OCD Form C107-B  
Site Facility Diagram  
Off Lease Measurement Diagram  
Off Load Route Map  
Off Lease Measurement Summary

**Bureau of Land Management  
Carlsbad Field Office  
620 East Greene Street  
Carlsbad, New Mexico 88220  
575-234-5972**

**Off-Lease/Unit Measurement and Sales of gas production  
Conditions of Approval**

**COG Operating LLC  
Burch Keely Wells – BKU 13C Battery  
NMNM88525X**

Approval of off-lease/Unit measurement is subject to the following conditions of approval:

1. This agency shall be notified of any change in sales method or location of the Sales point.
2. This agency shall be notified of any spill or discharge as required by NTL-3A. No gas may be vented/flared without proper measurement and prior approval. Any gas vented must be flared.
3. This agency reserves the right to modify or rescind approval whenever it determines continued use of the approved method may adversely affect the surface or subsurface environments and/or product accountability.
4. This approval is subject to like approval by the New Mexico Oil Conservation Division.
5. Additional wells require additional approvals.
6. This approval does not constitute right-of-way approval for any off-lease/Unit activities. Within 30 days, an application for right-of-way approval must be submitted to the Realty Section if not already done.
7. Approval for off-lease/Unit from various sources is a privilege which is granted to lessees/operators for the purpose of aiding conservation and extending the economic life of leases. Applicants should be cognizant that failure to operate in accordance with the provisions outlined in the Authorized Officer's conditions of approval and/or subsequent stipulations or modifications will subject such approval to revocation.