

UNITED STATES
DEPARTMENT OF THE INTERIOR
BUREAU OF LAND MANAGEMENT

OCD Artesia

FORM APPROVED
OMB NO. 1004-0137
Expires: January 31, 2018**SUNDRY NOTICES AND REPORTS ON WELLS**
*Do not use this form for proposals to drill or to re-enter an abandoned well. Use form 3160-3 (APD) for such proposals.*5. Lease Serial No.
NMNM14124

6. If Indian, Allottee or Tribe Name

7. If Unit or CA/Agreement, Name and/or No.

8. Well Name and No.
MARQUARDT FEDERAL 12H9. API Well No.
30-015-4185010. Field and Pool or Exploratory Area
COTTONWOOD DRAW BS11. County or Parish, State
EDDY COUNTY, NM**SUBMIT IN TRIPLICATE - Other instructions on page 2**

1. Type of Well

☐ Oil Well ☒ Gas Well ☐ Other

2. Name of Operator

CIMAREX ENERGY CO.

Contact: AMITHY E CRAWFORD

E-Mail: acrawford@cimarex.com

3a. Address

202 S CHEYENNE AVE. SUITE 1000
TULSA, OK 74103

3b. Phone No. (include area code)

Ph: 432-620-1909

4. Location of Well (Footage, Sec., T., R., M., or Survey Description)

Sec 12 T25S R26E 330FSL 400FEL

12. CHECK THE APPROPRIATE BOX(ES) TO INDICATE NATURE OF NOTICE, REPORT, OR OTHER DATA

TYPE OF SUBMISSION	TYPE OF ACTION			
<input checked="" type="checkbox"/> Notice of Intent	<input type="checkbox"/> Acidize	<input type="checkbox"/> Deepen	<input type="checkbox"/> Production (Start/Resume)	<input type="checkbox"/> Water Shut-Off
<input type="checkbox"/> Subsequent Report	<input type="checkbox"/> Alter Casing	<input type="checkbox"/> Hydraulic Fracturing	<input checked="" type="checkbox"/> Reclamation	<input type="checkbox"/> Well Integrity
<input type="checkbox"/> Final Abandonment Notice	<input type="checkbox"/> Casing Repair	<input type="checkbox"/> New Construction	<input type="checkbox"/> Recomplete	<input type="checkbox"/> Other
	<input type="checkbox"/> Change Plans	<input type="checkbox"/> Plug and Abandon	<input type="checkbox"/> Temporarily Abandon	
	<input type="checkbox"/> Convert to Injection	<input type="checkbox"/> Plug Back	<input type="checkbox"/> Water Disposal	

13. Describe Proposed or Completed Operation: Clearly state all pertinent details, including estimated starting date of any proposed work and approximate duration thereof. If the proposal is to deepen directionally or recompleat horizontally, give subsurface locations and measured and true vertical depths of all pertinent markers and zones. Attach the Bond under which the work will be performed or provide the Bond No. on file with BLM/BIA. Required subsequent reports must be filed within 30 days following completion of the involved operations. If the operation results in a multiple completion or recompleat in a new interval, a Form 3160-4 must be filed once testing has been completed. Final Abandonment Notices must be filed only after all requirements, including reclamation, have been completed and the operator has determined that the site is ready for final inspection.

Cimarex respectfully requests a new interim reclamation plan to accommodate for the battery and flare. See attached interim reclamation diagram.

Thank you.

OC 3-29-18
Accepted for record - NMOCD

BLM CONSERVATION
ARTESIA DISTRICT
MAR 28 2018

14. I hereby certify that the foregoing is true and correct.

Electronic Submission #408114 verified by the BLM Well Information System
For CIMAREX ENERGY CO., sent to the Carlsbad

Name (Printed/Typed) AMITHY E CRAWFORD

Title REGULATORY ANALYST

Signature (Electronic Submission)

Date 03/15/2018

THIS SPACE FOR FEDERAL OR STATE OFFICE USE

Approved By

Title

Supr. AGT

Date

3-16-18

Conditions of approval, if any, are attached. Approval of this notice does not warrant or certify that the applicant holds legal or equitable title to those rights in the subject lease which would entitle the applicant to conduct operations thereon.

Office

Carlsbad

Title 18 U.S.C. Section 1001 and Title 43 U.S.C. Section 1212, make it a crime for any person knowingly and willfully to make to any department or agency of the United States any false, fictitious or fraudulent statements or representations as to any matter within its jurisdiction.

(Instructions on page 2)

**** OPERATOR-SUBMITTED ** OPERATOR-SUBMITTED ** OPERATOR-SUBMITTED ****

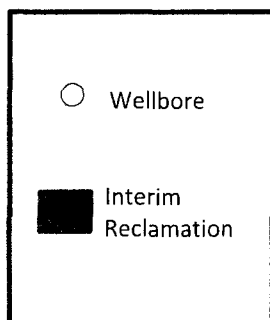
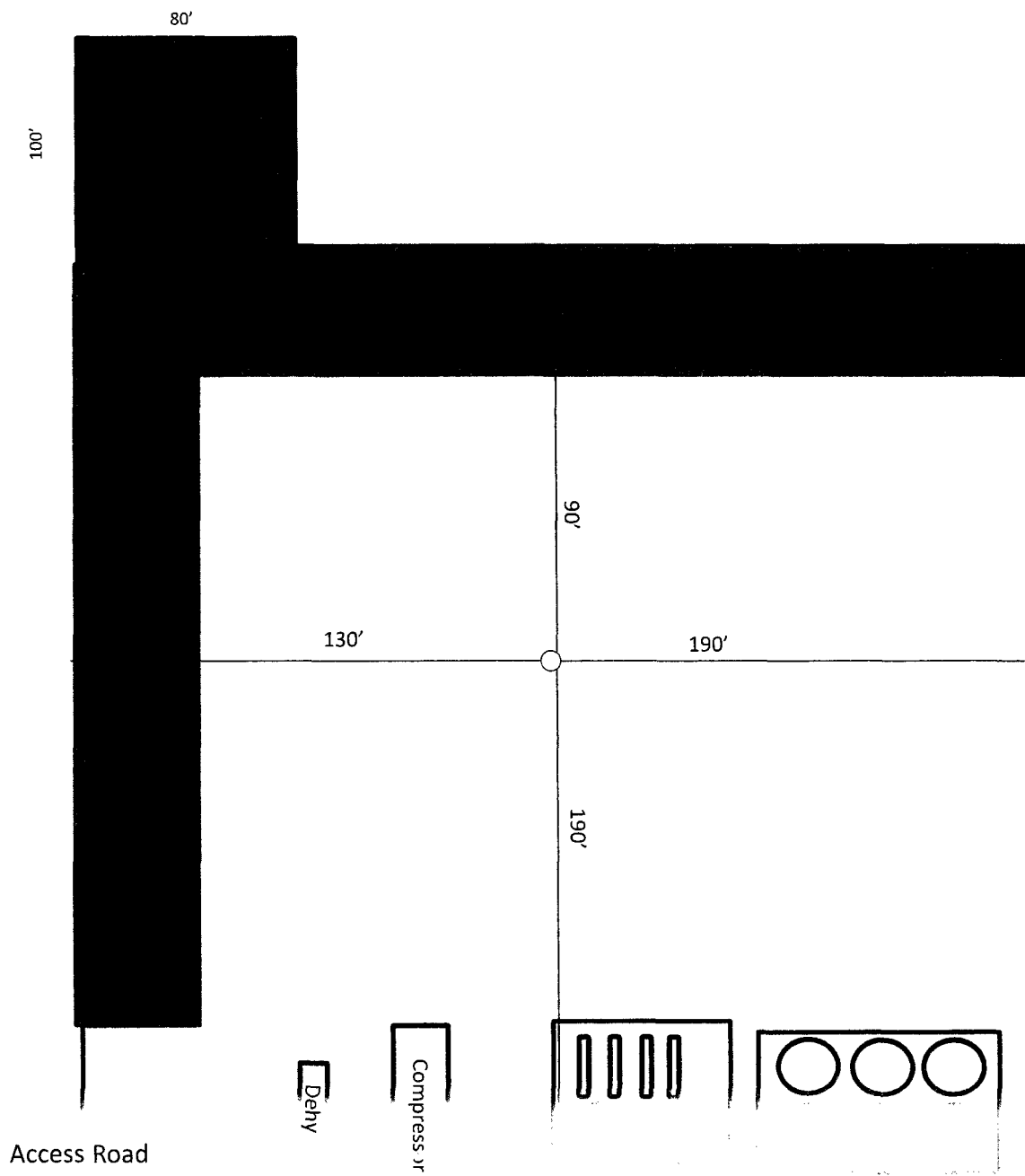

Exhibit D-1 – Production Facilities
& Interim Reclamation
Marquardt Federal 12H
Cimarex Energy Co.
12-25S-26E
SHL 330 FSL & 400 FEL
BHL 330 FNL & 400 FEL
Eddy County, NM