

# **OIL CONSERVATION**

ARTESIA DISTRICT

DISTRICT I

1625 N. Francis Dr., Santa Fe, NM 87505  
Phone (505) 476-3460 Fax (505) 393-0720

DISTRICT II

811 S. First St., Artesia, NM 88210  
Phone (505) 748-1283 Fax (505) 748-9720

DISTRICT III

1000 N. B. Road, Aztec, NM 87410  
Phone (505) 334-6178 Fax (505) 334-6170

DISTRICT IV

1220 S. St. Francis Dr., Santa Fe, NM 87505  
Phone (505) 476-3460 Fax (505) 476-3462

## State of New Mexico Energy, Minerals & Natural Resources Department

### **OIL CONSERVATION DIVISION**

1220 South St. Francis Dr.  
Santa Fe, New Mexico 87505

Form C-102

Revised August 1, 2011

Submit one copy to appropriate  
District Office

☐ AMENDED REPORT

#### **WELL LOCATION AND ACREAGE DEDICATION PLAT**

API Number <b>30-015-44270</b>	Pool Code <b>98220</b>	Pool Name <b>Purple Sage, Wolfcamp</b>
Property Code <b>318096 321172</b>	Property Name <b>ROADHOUSE Federal</b>	Well Number <b>1H</b>
OGRID No. <b>005380</b>	Operator Name <b>XTO ENERGY</b>	Elevation <b>2914'</b>

#### Surface Location

UL or lot No.	Section	Township	Range	Lot Idn	Feet from the	North/South line	Feet from the	East/West line	County
<b>O</b>	<b>6</b>	<b>25-S</b>	<b>29-E</b>		<b>180</b>	<b>SOUTH</b>	<b>1680</b>	<b>EAST</b>	<b>EDDY</b>

#### Bottom Hole Location If Different From Surface

UL or lot No.	Section	Township	Range	Lot Idn	Feet from the	North/South line	Feet from the	East/West line	County
<b>J</b>	<b>31</b>	<b>24-S</b>	<b>29-E</b>		<b>2440</b>	<b>SOUTH</b>	<b>1680</b>	<b>EAST</b>	<b>EDDY</b>

Dedicated Acres	Joint or Infill	Consolidation Code	Order No
<b>480</b>			<b>NSP Rnding</b>

NO ALLOWABLE WILL BE ASSIGNED TO THIS COMPLETION UNTIL ALL INTERESTS HAVE BEEN CONSOLIDATED OR A NON-STANDARD UNIT HAS BEEN APPROVED BY THE DIVISION

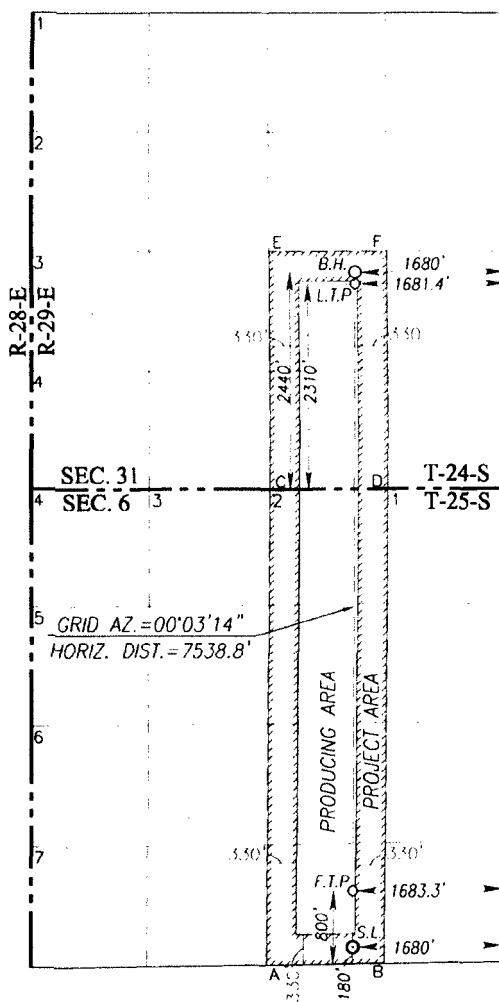

SCALE: 1"=2000'

GEODETIC COORDINATES  
NAD 83 NME  
BOTTOM HOLE LOCATION  
Y= 426883.9 N  
X= 638117.5 E  
LAT.=32.173195° N  
LONG.=104.020539° W

LAST TAKE POINT  
NAD 83 NME  
Y= 426753.9 N  
X= 638117.4 E  
LAT.=32.172838° N  
LONG.=104.020541° W

#### CORNER COORDINATES TABLE

NAD 27 NME  
A - Y= 419090.8 N, X= 595949.4 E  
B - Y= 419114.6 N, X= 597277.1 E  
C - Y= 424379.3 N, X= 595978.8 E  
D - Y= 424388.4 N, X= 597307.8 E  
E - Y= 427051.4 N, X= 595960.0 E  
F - Y= 427057.5 N, X= 597288.3 E

#### CORNER COORDINATES TABLE

NAD 83 NME  
A - Y= 419149.1 N, X= 637133.7 E  
B - Y= 419172.9 N, X= 638461.4 E  
C - Y= 424437.8 N, X= 637163.0 E  
D - Y= 424446.9 N, X= 638492.0 E  
E - Y= 427109.9 N, X= 637144.2 E  
F - Y= 427116.0 N, X= 638472.5 E

FIRST TAKE POINT  
NAD 83 NME  
Y= 419966.6 N  
X= 638111.0 E  
LAT.=32.154180° N  
LONG.=104.020625° W

SURFACE LOCATION  
NAD 83 NME  
Y=419346.7 N  
X=638110.4 E  
LAT.=32.152476° N  
LONG.=104.020633° W

FIRST TAKE POINT  
NAD 27 NME  
Y= 419908.2 N  
X= 596926.6 E  
LAT.=32.154057° N  
LONG.=104.020137° W

SURFACE LOCATION  
NAD 27 NME  
Y=419288.3 N  
X=596926.0 E  
LAT.=32.152353° N  
LONG.=104.020145° W

#### **OPERATOR CERTIFICATION**

I hereby certify that the information herein is true and complete to the best of my knowledge and belief, and that this organization either owns a working interest or unleased mineral interest in the land including the proposed bottom hole location or has a right to drill this well at this location pursuant to a contract with an owner of such mineral or working interest, or to a voluntary pooling agreement or a compulsory pooling order heretofore entered by the division.

*Stephanie Rabadue* 7-1-17  
Signature Date

*Stephanie Rabadue*  
Printed Name

*Stephanie.rabadue@xtoenergy.com*  
E-mail Address

#### **SURVEYOR CERTIFICATION**

I hereby certify that the well location shown on this plat was plotted from field notes of actual surveys made by me or under my supervision, and that the same is true and correct to the best of my belief.

JUNE 1, 2017  
Date of Survey  
Signature & Title of Professional Surveyor

*Ronald J. Eidson*  
NEW MEXICO  
3239  
REGISTERED PROFESSIONAL SURVEYOR  
Certificate Number  
Ronald J. Eidson 12641  
Ronald J. Eidson 3239

ACK REL W.O. 17130470 JWSC W.O. 17110571

*RWP 4-9-18*



Stephanie Rabadue  
Regulatory Analyst  
XTO Energy Inc.  
500 W. Illinois St Ste 100  
Midland, Texas 79701  
(432) 620-6714  
stephanie\_rabadue@xtoenergy.com

July 1, 2017

Bureau of Land Management  
Carlsbad Field Office  
620 E. Greene Street  
Carlsbad, NM 88220

RE: Operating Agreement/Rights for Golden Corral Federal 2H, Cattle Baron Federal 2H, Roadhouse  
Federal 1H, Roadhouse Federal 2H, Sizzler Federal 2H

To Whom It May Concern:

This is to hereby certify that XTO Energy, Inc. is has operating rights over: NMNM 111533 through  
acreage trades, acquisitions, and pooling orders.

Stephanie Rabadue  
Regulatory Analyst  
XTO Energy, Inc